

Yuma International Airport



Yuma County Airport Authority 2191 E 32nd St, Ste 218, Yuma, AZ 85365 (928) 726-5882

PORT OF OPPORTUNITY

March 26, 2020

Dave Wostenberg, PE
Senior Civil Engineer
Yuma County Engineering
2351 W 26th St
Yuma, AZ 85364
David.wostenberg@yumacountyaz.gov

Subject: Avenue E, SR-195 to US Highway 95 project – Letter of Support

Dear Mr. Wostenberg,

This letter is intended to indicate our support of Yuma County's application for funding for the extension of Avenue E from State Route 195 north to connect to US Highway 95 from the Arizona Federal Lands Access Program (FLAP).

The Yuma County Airport Authority (YCAA) manages Rolle Airfield in San Luis, Arizona. The airfield was annexed into the City of San Luis in June 1999. It lies approximately four (4) nautical miles northeast of the center of the City of San Luis, Arizona and five (5) nautical miles south of the City of Somerton, Arizona. U.S. Highway 95 connects both of the communities to the City of Yuma. Rolle Airfield supports general aviation users in Yuma County and the customers of Yuma International Airport's aerospace industrial base, which supports government, civilian and military operations.

Our team has and continues to work closely with the City of San Luis for community planning and development, particularly around Rolle Airfield. Construction of this direct north-south roadway is of extreme interest and importance to the YCAA, and aligns with the YCAA's Rolle Airfield Master Plan by significantly improving access to Rolle Airfield for general aviation and future commercial services, and contribution to the economic development of the City of San Luis as it grows with the expansion of the new Port of Entry at San Luis II.

Aviation activity in Yuma County is an important contributor to the local economy. Successful award and completion of this project will also provide a direct route from the San Luis II border crossing to the Yuma International Airport.

If our team can be of further assistance, please let me know.

YUMA COUNTY AIRPORT AUTHORITY, INC.

Gladys D. Brown, CM, CAE
Airport Director



AIRPORT LAYOUT PLAN

ROLLE FIELD

SAN LUIS, ARIZONA

PREPARED FOR
 YUMA COUNTY AIRPORT
 AUTHORITY
 MAY, 2015

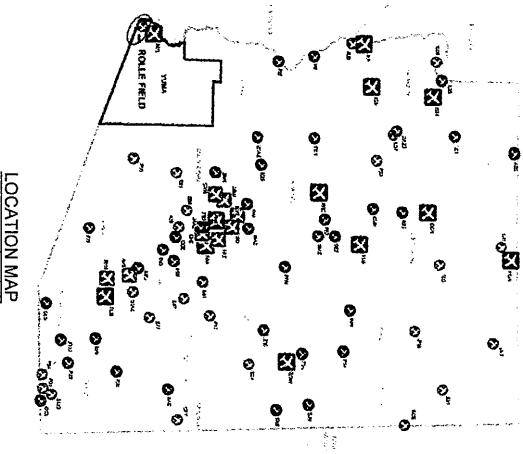

LOCATION MAP

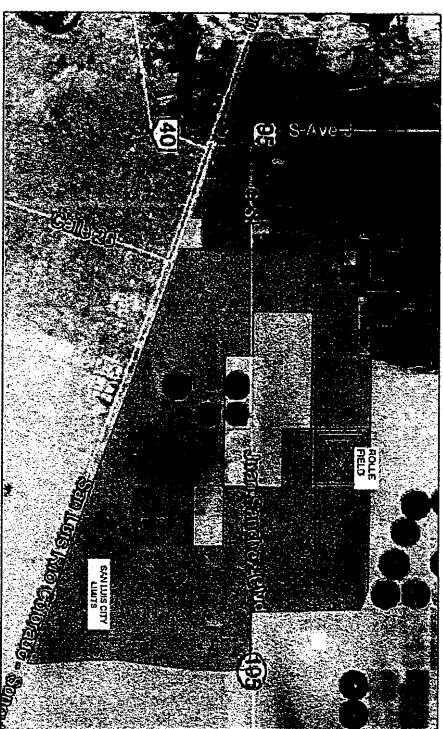

VICINITY MAP

ADOT APPROVAL

MICHAEL ALVIN
 NAME
[Signature]
 SIGNATURE
AERONAUTICS GROUP MANAGER
 TITLE
 May 5, 2015
 DATE

SHEET TITLE

1	DATA SHEET
2	AIRPORT LAYOUT PLAN
3	AIRPORT AIRSPACE DRAWING
4	INNER APPROACH SURFACE DRAWING RWY 17
5	INNER APPROACH SURFACE DRAWING RW 35
6	TERMINAL AREA DRAWING
7	LAND USE DRAWING
8	EXHIBIT "A" - AIRPORT PROPERTY MAP
9	PUBLIC AIRPORT DISCLOSURE MAP
10	

SHEET NO. REVISION DATE

SPONSOR APPROVAL

Glady's Wiggins
 NAME
[Signature]
 SIGNATURE
AIRPORT DIRECTOR
 TITLE
 May 5, 2015
 DATE

NO.	DESCRIPTION	DATE	BY



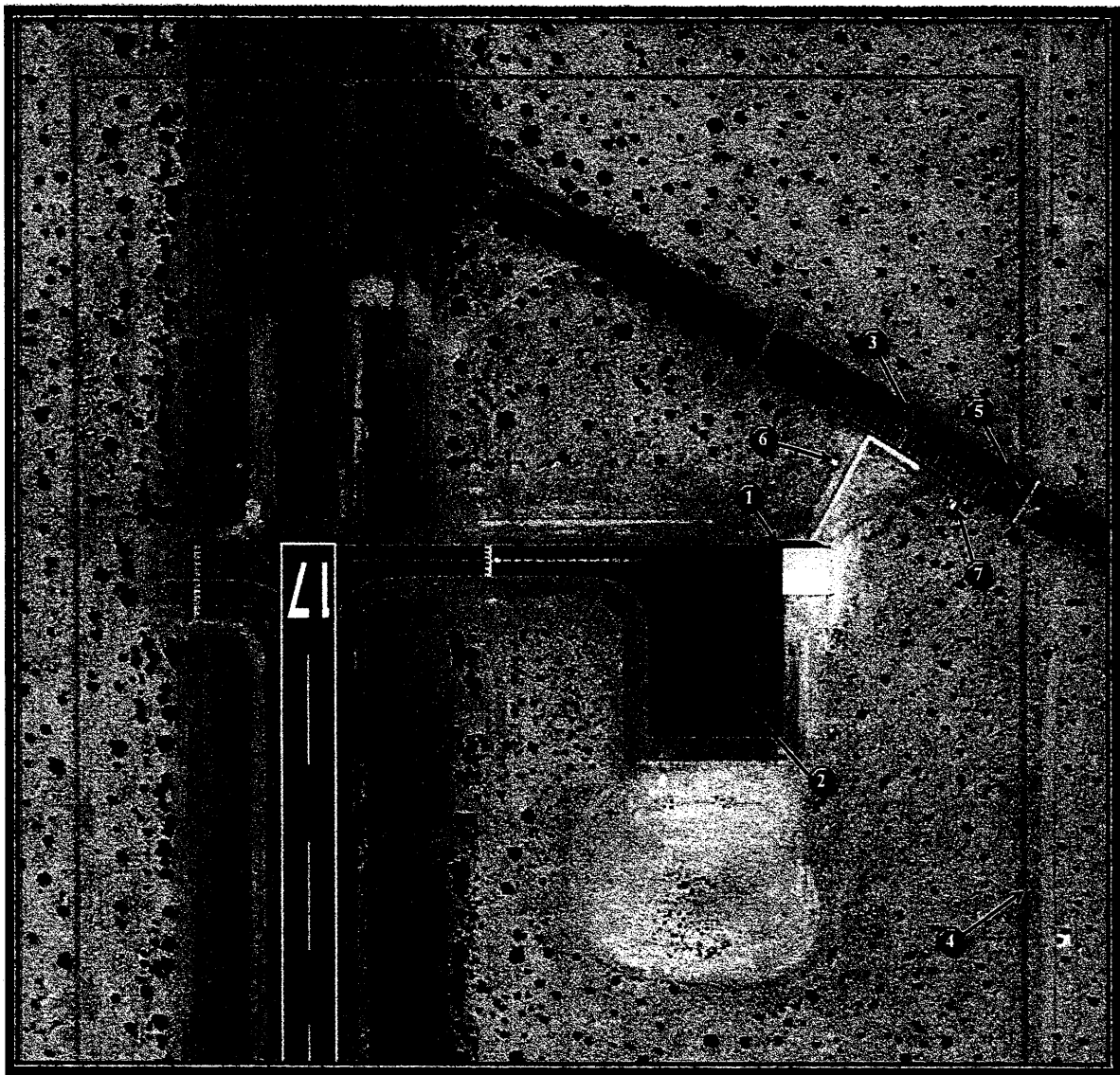

Existing Facilities - Landside	
1	Aircraft Hangar (50' X 50')
2	Aircraft Parking Apron (4 Tie Downs)
3	Automobile Parking (18 spaces)
4	Chain Link Security Fence - 8'
5	Controlled Access Gate
6	Water Well
7	Diesel Generator

Figure 1-4: Terminal Area

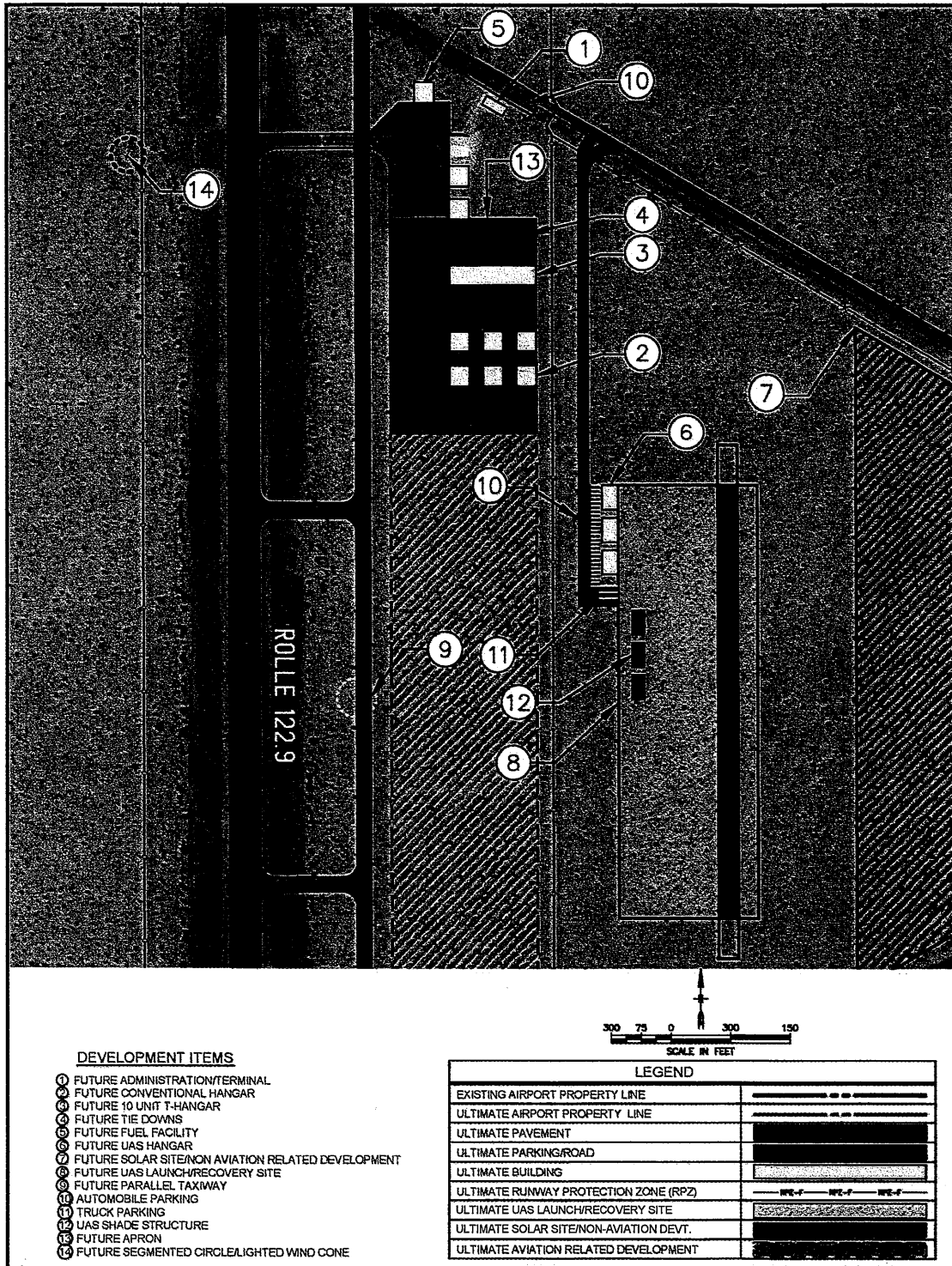

Figure 4-3: Alternative 1 Landside

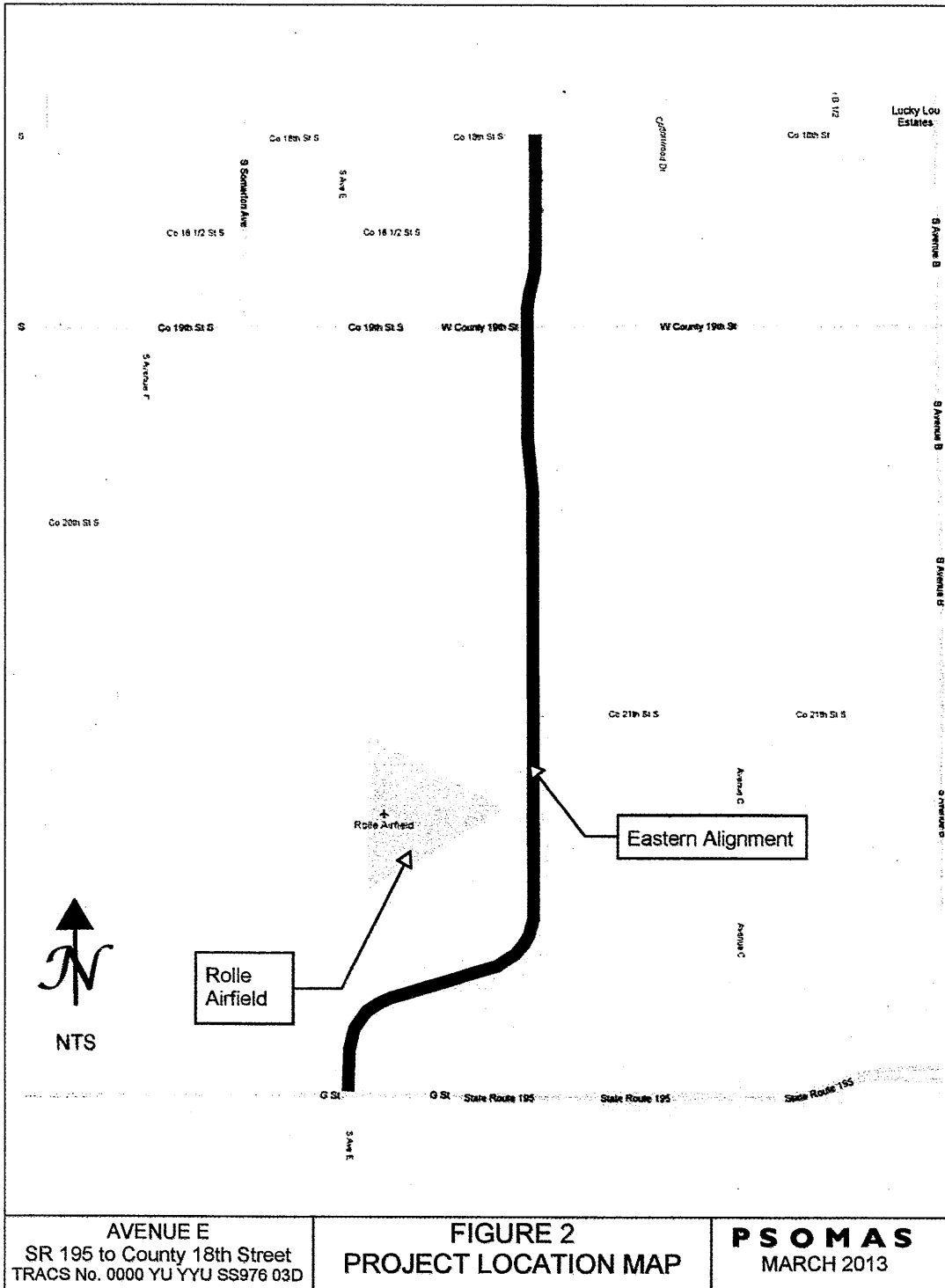

Figure 1- 11 Extension of Ave E., Proposed Alignment

\$100,000
DESIGN RAMP
EXPANSION

Grant Number E1S2G 01D
State/Local Grant
Yuma County Airport Authority
Rolle Airfield Airport

EXHIBIT A

90/10

Sponsor Assurances

Upon acceptance of the grant offer by the Sponsor, these assurances will become a part of this Agreement. The Sponsor hereby covenants and agrees with the State as follows:

General

- 1) That the Project is consistent with plans (existing at the time of approval of the Project) of political jurisdictions authorized by the State to plan for the development of the area surrounding the Airport and has given fair consideration to the interest of communities in or near where the Project is to be located. In making a decision to undertake any airport development Project under this Agreement the Sponsor insures that it has undertaken reasonable consultation with affected parties using the Airport at which the Project is proposed. All appropriate development standards of Federal Aviation Administration (FAA) Advisory Circulars, Orders, or Federal Regulations shall be complied with. All related state and federal laws shall be complied with.
- 2) That these covenants shall become effective upon execution of this Agreement for the Project or any portion thereof, made by the State and shall remain in full force and effect throughout the useful life of the facilities or the planning project's duration developed under the grant, but in any event, not less than twenty (20) years from the date of acceptance of the grant offer by the Sponsor.
- 3) The Sponsor certifies in this Agreement that it is a political subdivision of the State and is the public agency with control over a public-use Airport and/or on behalf of the possible future development of an Airport and is eligible to receive grant funds for the development or possible development of an Airport under its jurisdiction.
- 4) The Sponsor further agrees it holds good title, satisfactory to the State, to the landing area of the Airport or site thereof, or will give assurance satisfactory to the State that good title will be acquired.
- 5) That the Sponsor is the owner or lessee of the property or properties on which the Airport is located and that the lease guarantees that the Sponsor has full control of the use of the property for a period of not less than twenty (20) years from the date of this Agreement. All changes in airport ownership or to an airport lease shall be approved by the State.
- 6) The Sponsor agrees that it has sufficient funds available for that portion of the project costs which are not to be paid by the State (or the United States).
- 7) The Sponsor agrees to provide and maintain competent supervision to complete the Project in conformance with this Agreement.