

IGLESIA DE CRISTO EN SAN LUIS AZ INC.

1050 E Arizona St
 San Luis, AZ 8536
 APN: 775-31-901

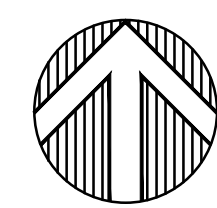
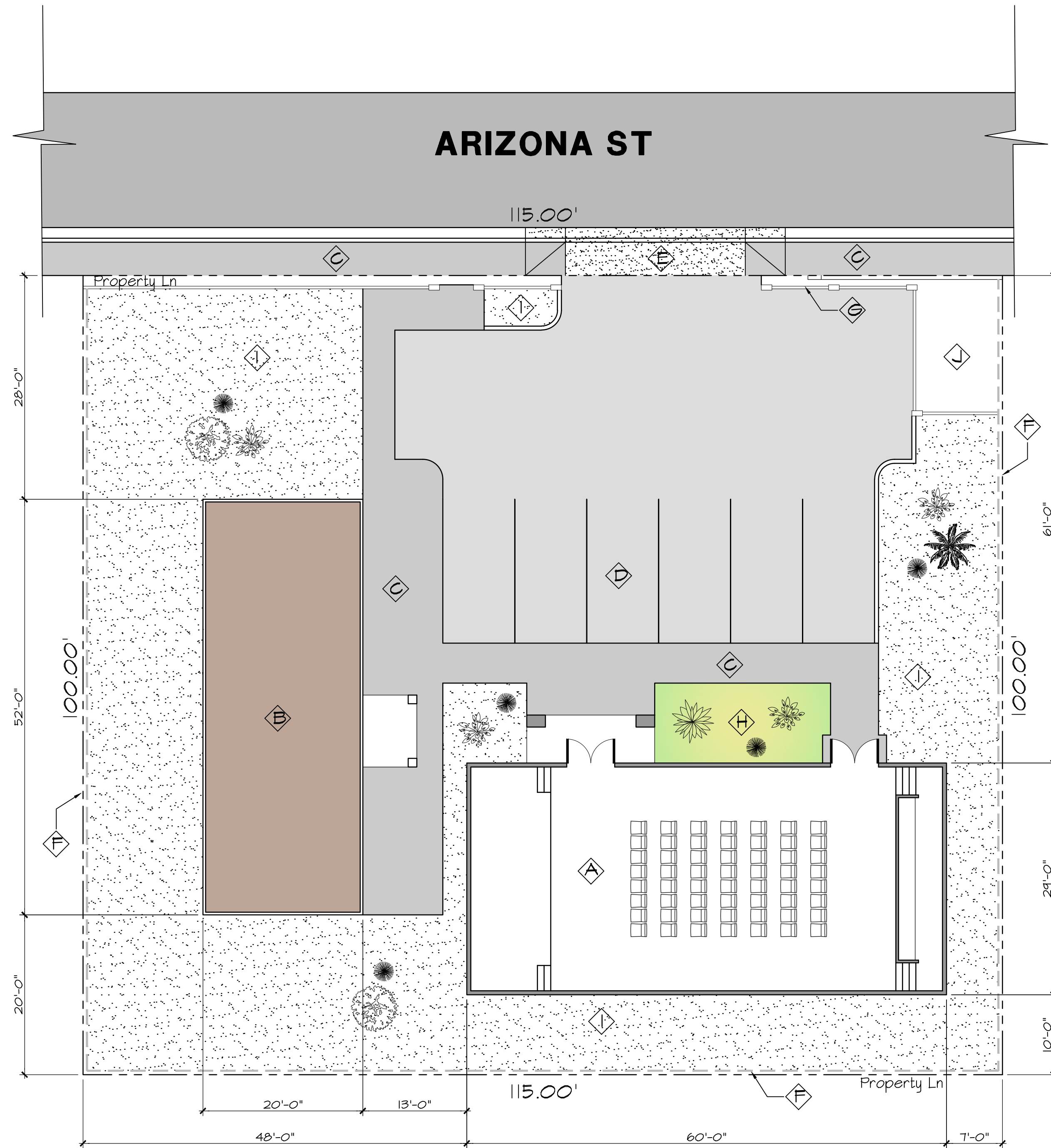

SITE PLAN

Scale: 1/10"=1'-0"

LANDSCAPE ELEMENTS

- Blue Palo verde
- Bottle Tree
- Mexican Sage
- Yellow Lantana
- Palm Tree
- Decorative Rock

KEYNOTES:

- Proposed Sanctuary Building Area: 1,740 Sq.Ft.
- Existing Multipurpose Building Area: 1,040 Sq.Ft.
- Concrete Sidewalk
- 9' x 18' Parking Space
- Ex. Concrete Driveway
- 6" Non Retaining Concrete Block Wall
- 4" Non Retaining Concrete Block Wall
- Grass Landscape
- Decorative Rock Landscape
- APS Pad-Mounted Transformer

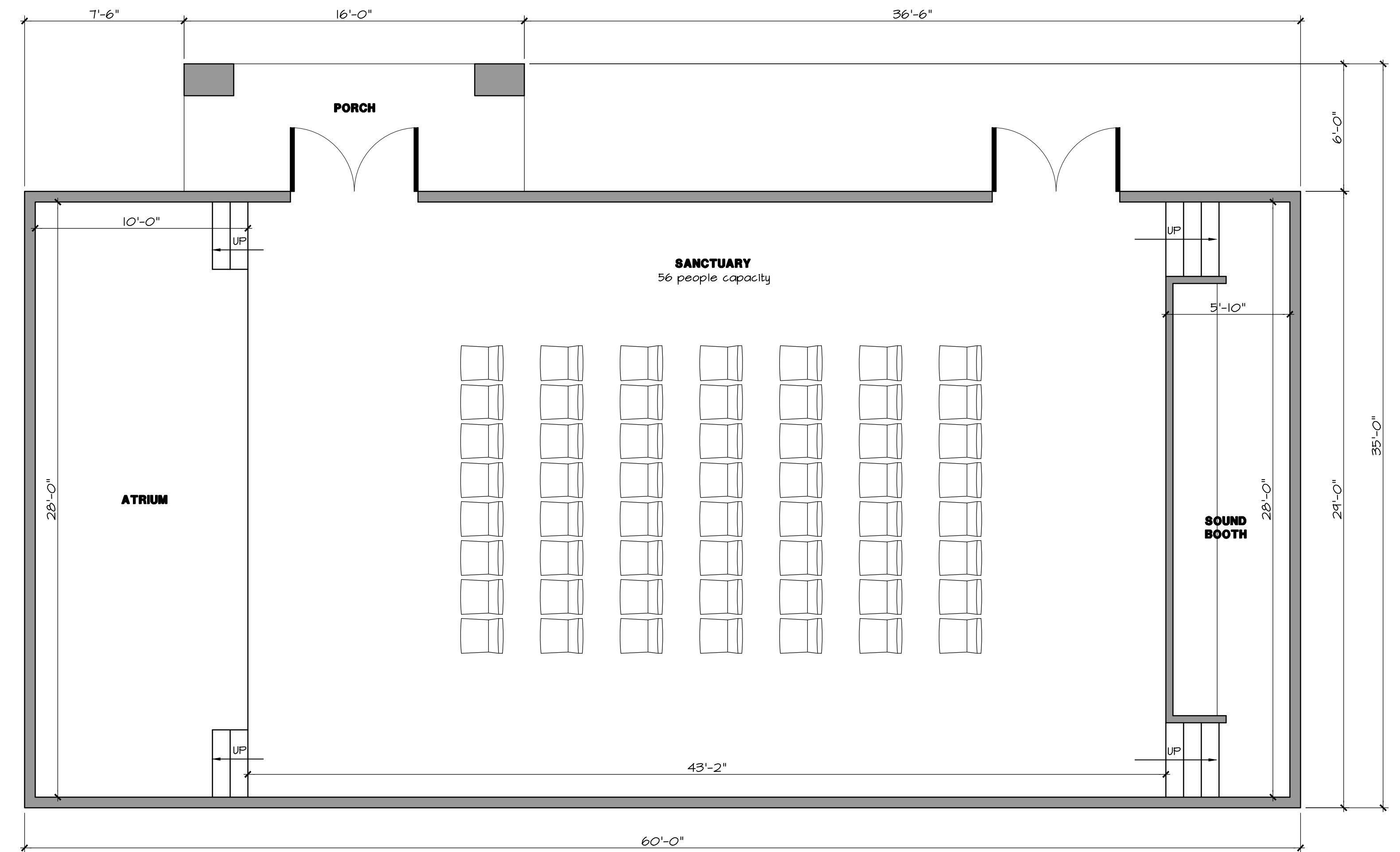

FLOOR PLAN

Scale: 1/4"=1'-0"

