



# *Resolution*

OFFICE OF THE  
MAYOR  
CITY OF SAN LUIS

**No. 2296**

**A RESOLUTION OF THE MAYOR AND CITY COUNCIL OF THE CITY OF SAN LUIS, ARIZONA, APPROVING AN INTERGOVERNMENTAL AGREEMENT WITH THE UNITED STATES GENERAL SERVICES ADMINISTRATION JOINTLY TO IMPROVE URTUZUASTEGUI STREET, REPEALING ANY CONFLICTING PROVISIONS; AND PROVIDING FOR SEVERABILITY.**

**BE IT RESOLVED** by the Mayor and City Council of the City of San Luis, Arizona, that the Intergovernmental Agreement with the United States General Services Administration and the City of San Luis regarding the parties' joint responsibilities for improvements on Urtuzuastegui Street is approved.

**PASSED, ADOPTED, and APPROVED** by the Mayor and City Council of the City of San Luis, Yuma County, Arizona, this \_\_\_\_ day of November 2023.

\_\_\_\_\_  
Nieves Riedel, Mayor

**ATTEST:**

**APPROVED AS TO FORM:**

\_\_\_\_\_  
Sonia Cornelio, City Clerk

\_\_\_\_\_  
Kay Marion Macuil, City Attorney

**Agreement  
for the  
San Luis I Land Port of Entry  
Urtuzuastegui Street Improvements**

This Agreement by and between the City of San Luis (“City”) and the United States General Services Administration (“GSA”) is for the funding, design and construction of street improvements along the port’s urban edge at Urtuzuastegui Street, from Archibald Street on the west to 4th Avenue on the east, in San Luis, Arizona, due to GSA’s San Luis I Land Port of Entry Modernization and Expansion Project.

**I. Definitions**

The following are defined terms for purposes of this Agreement.

A. San Luis I Land Port of Entry (“LPOE”) means the inspection facility located at 431 Main Street at the Mexican border in San Luis, Arizona, eventually comprising approximately 182 thousand gross square feet, which is owned by GSA and operated by United States Customs and Border Protection.

B. Project means the work described in Exhibit 2 (City approved November, 1, 2023, Final SLLPOE Urtuzuastegui St Improvements Drawings by Hensel Phelps) and in the agreed to Scope of Work attached as Exhibit 1, with the extent of the work being located along Urtuzuastegui Street from Archibald Street to 4th Avenue.

C. Party means City or GSA. Parties means both City and GSA.

**II. Purpose**

A. GSA is in the process of modernizing and expanding the San Luis I Land Port of Entry through its San Luis I Modernization and Expansion Project in order to facilitate cross border inspection activities, to reduce wait times and improve downtown City vehicle and pedestrian circulation. The port experiences much higher traffic volumes than it was originally designed to accommodate. Furthermore, the port’s facilities are significantly undersized and require upgrading to meet the U.S. Customs and Border Protection’s current mission requirements. The modernization and expansion project will improve efficiencies and traffic flows and reduce wait times through the expansion of inbound pedestrian lanes from 10 to 14 and inbound vehicle lanes from 8 to 16, and increase CBP’s processing capacity and operational security by effectively deploying the latest technology. The design is also intended to solve potentially unsafe existing conditions due to pedestrian traffic crossing the outbound vehicle traffic at Urtuzuastegui Street. To address the needs of the community, GSA has designed and is building a new, larger and safer LPOE facility.

2. The Modernization and Expansion Project includes newly constructed inbound lanes that will route traffic to Urtuzuastegui Street intersections at both William Brooks and 2<sup>nd</sup> Avenues and includes a newly constructed outbound vehicle entrance and inspection lanes at the intersection of Urtuzuastegui and Archibald Streets. A new entrance for port employees will be created at the Urtuzuastegui Street roundabout at Main Street, and a maintenance and emergency entrance and trash pick-up gated entrance will be created at the Urtuzuastegui Street and Williams Brooks Avenue intersection. Both inbound and outbound pedestrian traffic will be routed through a newly constructed pedestrian plaza on the south side of Urtuzuastegui Street at the Main Street intersection. A pull out for deliveries to the new Mission Support building and accessible drop off point will be constructed on the south side of Urtuzuastegui Street between Archibald and Main Streets and a new return to the U.S. lane will exit onto Urtuzuastegui Street just east of the new inbound lanes at Archibald Street.

3. The creation of these new vehicle and pedestrian traffic entrances and exits along Urtuzuastegui Street for the benefit of the LPOE will necessitate the widening of the sidewalks on the south side of Urtuzuastegui Street; the modification of the traffic signal at the Archibald Street intersection; the additional of a new traffic signal at the William Brooks Avenue intersection; and new signage, striping, crosswalks, lighting, landscaping, and other miscellaneous controls and appurtenances for the safe and directed flow of vehicle and pedestrian traffic through the new routes as further described in Exhibits 1 and 2.

### III. Agreement

#### THE CITY AGREES:

A. It has given final approval for the Project Scope of Work, as evidenced by the signed Scope of Work at Exhibit 1 and the City approved November 1, 2023, Final SLLPOE Urtuzuastegui St Improvements Drawings at Exhibit 2.

B. To grant to GSA for a mutually agreeable time, without any condition, cost or delay, an Encroachment Permit to complete the work described to be done by GSA in Exhibits 1 and 2.

C. That GSA has no obligation to complete the Project work at all unless City timely grants an Encroachment Permit.

D. It will timely complete the work detailed to be done by the City in Exhibits 1 and 2 so as to not cause delay to GSA's use of the newly created in-bound and out-bound lanes and other access points to the LPOE.

E. To approve in a timely manner, which approval will not be unreasonably withheld, GSA's traffic management plan for the Project that is the subject of this Agreement at no cost to GSA.

F. To inspect in a timely manner so as to avoid delay to GSA and/or its contractor(s)/agent(s) the Project work, and that it will receive from GSA a lump sum fee of \$16,480.00 for its inspection services.

G. To not unreasonably withhold its inspection approval(s) throughout the Project that is the subject of this Agreement. And in the case of any objection during inspection, the City will immediately, but no later than one (1) business day, inform GSA and cooperate with GSA in removing the objection so that the Project may be completed without delay.

H. To accept, and operate and maintain in perpetuity, the newly constructed and installed items of the Project work with no conditions or requirements beyond those written in this Agreement when GSA declares in writing to the City that the Project is Substantially Complete and simultaneously provides As-Built plans and copies of manuals, inspection reports and all testing, after which GSA will have no interest in the Project elements.

I. City Council approval and acceptance of this Project work occurred in the regularly scheduled Council Meeting held on November 21, 2023.

J. That it will solely maintain and operate the newly constructed and installed Signal Lights, sidewalks, gutters, drainage, lighting, and other street improvements as described in the Scope of Work items in perpetuity for the benefit of the LPOE as outlined in Exhibits 1 and 2, at its own costs, with no further costs to GSA.

K. It shall not request or require that GSA and the United States of America provide any funds for accepting, maintaining and operating the Project work items.

L. It shall continue its account with the Arizona Public Service ("APS") for electrical power to Urtuzustegui Street signals and street lighting between and inclusive of the Archbald Street and 2<sup>nd</sup> Avenue intersections.

M. It approves and adopts the design for all elements of the Project, and assumes full responsibility for such design and construction of all elements of the Project.

N. The GSA contracting officer is the only individual with authority to accept or reject the work of GSA's contractor performing the Project work.

O. Neither GSA nor any of its contractors will be required to pay for any City permit, (including but not limited to encroachment, street, hauling or temporary use).

P. It will not unreasonably withhold approval of any inspection or permit or review of any material or design change for the Project.

Q. It will promptly review any design changes during construction and at no additional cost to GSA.

R. To indemnify and hold GSA harmless from any claim or cause of action related in any manner to any part of the design, construction, operation or maintenance of each and every element of the Project.

GSA AGREES:

A. It shall undertake and complete the Project work as detailed to be done by GSA in Exhibits 1 and 2.

B. To provide a traffic management plan to the City for approval, which approval will not be unreasonably withheld, prior to commencing Project work.

C. To coordinate directly with and pay APS for the electrical work associated with the Project scope of work detailed to be done by GSA. This will not include payment to APS for any ongoing costs once the Project scope is completed.

D. To provide to the City for review any material changes to the final City approved construction documents.

E. To include in its construction contract a requirement for its Project contractor to provide a one (1) year warranty covering all Project work and to require the contractor to name the City as an additional insured during the time period it is performing Project work.

THE PARTIES AGREE:

A. Nothing in this Agreement obligates GSA to provide funding or improvements on any site other than that where the Project is located, as described in and depicted on Exhibits 1 and 2 of this Agreement.

B. GSA shall not commit any funds to any contracts related to the Project until this Agreement is fully executed.

D. If it is determined that the allotted budget for the Project will be exceeded, the City and GSA will reduce the cost of the Project through value engineering. GSA shall not be responsible for any additional scope beyond the Project budget.

E. To cooperate fully with one another for the timely completion of the Project because time is of the essence.

F. The City will conduct inspections during construction and GSA will pay a lump sum fee of \$16,480.00 to the City for all inspection services.

G. GSA will not provide any funding for the operation and maintenance of any element of the Project.

H. Covenant and warrant that the persons executing this Agreement for their respective entities is a duly authorized and existing entity, is qualified to do business in Arizona, with full right and authority to enter in this Agreement, and that each and every person signing on behalf of the City is authorized to do so.

I. This Agreement shall be governed by applicable federal laws.

J This Agreement may be executed in counterparts, each of which shall be deemed to be an original, but all of which taken together, shall constitute one and the same document.

K. The parties will cooperate timely with one another in carrying out the work and purpose of this Agreement.

L. This Agreement and its exhibits constitute the whole understanding, discussion and agreement of the Parties.

M. This Agreement may not be changed, amended or altered in any way except in writing and executed by all Parties to the Agreement

N. This Agreement may only be terminated by mutual agreement of the Parties in writing, or if the events occurring during performance of the Project make completion impossible without additional funds and neither Party can contribute such funds.

O. No Party shall be liable to the other for any consequential damages in connection with a breach of this Agreement.

### III. EXHIBITS

The following exhibits are included as a part of this Agreement:

Exhibit 1 – November, 14, 2023, City accepted, Scope of Work

Exhibit 2 – November, 1, 2023, City approved, Urtuzuastegui Street Improvements Drawings provided by Hensel Phelps

IN WITNESS WHEREOF, the Parties hereto have executed this Agreement, which is effective as of the latest date of execution.

CITY OF SAN LUIS

\_\_\_\_\_  
By: Nieves G. Riedel  
Title: Mayor of San Luis, AZ

Date: \_\_\_\_\_

UNITED STATES OF GENERAL SERVICES ADMINISTRATION

\_\_\_\_\_  
By: Dan Brown  
Title: Regional Commissioner, PBS, Region 9

Date: \_\_\_\_\_



November 14, 2023

## Exhibit 1

### **Scope of Work for Urtuzuastegui Street Improvements at San Luis I LPOE, San Luis, AZ**

#### I. SCOPE OF WORK

Construction of Urtuzuastegui Street improvements related to the San Luis I Land Port of Entry Modernization and Expansion Project as detailed in Exhibit 2 – November 1, 2023, Final SLLPOE Urtuzuastegui St Improvements Drawings.

#### II. DIVISION OF RESPONSIBILITY

The General Services Administration (the GSA) and the City of San Luis (the City) agree to the division of responsibility for execution of the Scope of Work as described below.

##### A. General Services Administration Scope of Work

The GSA agrees to provide funding, administration, engineering, contracting, performance, and QA/QC for the Scope of Work items summarized as follows (see Exhibit 2 for detailed requirements within these general items of work):

##### **Urtuzuastegui Street**

- Obliterate Existing Striping & Directional Arrows
- Slurry Seal Existing Pavement from William Brooks Ave to 4th Ave
- New Striping
- New Directional Arrows
- Fixed Traffic Signage with Posts
- Remove and Replace Street Lights at Urtuzuastegui St and Main St
- SWPPP

##### **Urtuzuastegui Street - Southside**

- Demolish Curb / Gutter / Sidewalk
- Replace Curb / Gutter / Sidewalk /



November 14, 2023

- Replace catch basins and storm drain pipe.
- Replace ADA Access Ramps

### **William Brooks Avenue / Urtuzuastegui Street Intersection Signalization**

- Mast / Arm Structures
- Mast Structure Foundations
- Traffic Signal Heads
- Added Crosswalk Push Button SW Corner
- Traffic Signal Controller with Cabinet
- All associated conduit pull boxes and wires

### **Miscellaneous Work (as needed for the above GSA items)**

- Temporary Traffic Control
- Temporary Traffic Barricades
- Temporary Traffic Signage
- Relocation / Maintenance of Barricades
- Concrete Demo, Cutting, Replacement, and Asphalt Repairs

### **General Notes**

- Coordinate Work with the City of San Luis Public Works for inspection of the GSA items.
- Before removing traffic light signals, coordinate with Arizona Public Service (APS) to disconnect power.
- Following any demo work restore the area in kind.
- Before purchasing new traffic control signal poles, controllers or other equipment as outlined in the Exhibit 1, ensure City reviews and approves submittals. These submittals will be given to the Public Works/City Engineer for the City of San Luis for their approval.
- After dismantling and removing traffic signal lights, pedestrian signal poles, traffic camera and accessories, traffic controllers, or other existing equipment as shown in Exhibit 1, deliver these items to a location within the City of San Luis as coordinated with the Public Works/City Engineer for the City of San Luis.
- Connect a traffic controller override at the 1st Street signal to allow CBP the capability to manually override the traffic controller standard signal timing from the Headhouse Building for emergency purposes. GSA will provide location in the Headhouse where the override switch will be installed.



November 14, 2023

- The contractor is to ensure the vertical height of any new equipment is in alignment with City standards and meets APS standards for distances from any overhead power lines.
- Provide a traffic control plan to the City for approval.
- Provide sequence and logic for all traffic controllers.
- Open cuts in asphalt for the conduit work are to be coordinated with the City inspector.
- All work to be coordinated with City of San Luis Public Works Engineering/Inspections.
- The GSA will coordinate with the City of San Luis for an "Encroachment Permit". No work can begin unless the Encroachment Permit is approved by the City.

#### B. City of San Luis Scope of Work

The City agrees to provide funding, administration, engineering, contracting, performance, and QA/QC for the Scope of Work items summarized as follows (see Exhibit 2 for detailed requirements within these general items of work):

##### **U-Street - Northside**

- Demolish Curb / Gutter / Sidewalk
- Replace Curb / Gutter / Sidewalk
- Replace ADA Access Ramps

##### **Main Street / U-Street Intersection Signalization**

- Remove / Salvage Existing Flashing Beacons (HAWK)
- HAWK Mast / Arm / Push Button Structure at East Crosswalk
- Mast Structure Foundation
- HAWK Signal Heads
- HAWK Crosswalk Push Button with Post
- HAWK Signal controller cabinet and foundation

##### **Archibald / U-Street Intersection Signalization**

- Existing Signal Head Modification
- Existing Controller Modification
- Crosswalk Push Button with Post SE Corner and associated conduit pullboxes and wires
- Crosswalk Push Button SW Corner and associated conduit pull boxes and wires



November 14, 2023

**Miscellaneous (as needed for the above City items)**

- Temporary Traffic Control
- Temporary Traffic Barricades
- Temporary Traffic Signage
- Relocation / Maintenance of Barricades
- Concrete Demo, Cutting, Replacement, and Asphalt Repairs

**General Notes**

- Once traffic signalization or other work is completed by the GSA, in phases or in whole, the City will inspect and approve the work for City operation and maintenance of the work.

Accepted by \_\_\_\_\_ Date: \_\_\_\_\_

Nieves G. Riedel, Mayor,  
City of San Luis, AZ



# NOTES & LEGEND

## GENERAL NOTES

- ALL MATERIALS AND CONSTRUCTION HEREON SHALL CONFORM TO CITY OF SAN LUIS CONSTRUCTION STANDARDS, YUMA CONSTRUCTION STANDARD DETAIL DRAWINGS, MARICOPA ASSOCIATION OF GOVERNMENTS (MAG) UNIFORM STANDARD SPECIFICATIONS FOR PUBLIC WORKS CONSTRUCTION, THE CITY OF SAN LUIS SUPPLEMENT TO MAG UNIFORM STANDARD SPECIFICATIONS FOR PUBLIC WORKS CONSTRUCTION, LATEST EDITION, LATEST ADOT SIGNAL AND LIGHTING STANDARD DRAWINGS, AND SHALL BE IN ACCORDANCE WITH THE ARIZONA DEPARTMENT OF ENVIRONMENTAL QUALITY REGULATIONS.
- THE CONTRACTOR SHALL BE RESPONSIBLE FOR THE PREPARATION AND FURNISHING TO THE ENGINEER OF "AS-BUILT" REBORDRAWINGS. THE CONTRACTOR SHALL OBTAIN ONE SET OF PLANS FROM THE ENGINEER AND SHALL RECORD IN RED ALL CASES WHERE ACTUAL FIELD CONSTRUCTION DIFFERS FROM WORK SHOWN ON PLANS. ALL CONCEALED WORK AND UTILITIES SHALL BE DIMENSIONED. THE CONTRACTOR SHALL SUBMIT THE FINAL "AS-BUILT" DRAWINGS TO THE PROJECT MANAGER FOR REVIEW AND APPROVAL NO LATER THAN 14 CALENDAR DAYS AFTER COMPLETION OF THE PROJECT.
- ANY UNACCEPTABLE WORK, WHETHER THE RESULT OF POOR WORKMANSHIP, USE OF DEFECTIVE MATERIALS, DAMAGE THROUGH CARELESSNESS OR ANY OTHER CAUSE, FOUND TO EXIST PRIOR TO THE FINAL ACCEPTANCE OF WORK, SHALL BE REMOVED AND REPLACED IN A TRADY AND ACCEPTABLE MANNER TO THE CITY OF SAN LUIS.
- PRIOR TO COMMENCEMENT OF ANY CONSTRUCTION, THE CONTRACTOR SHALL PROVIDE THE ENGINEER WITH ALL PROPOSED PROJECT MATERIAL DATA SHEETS AND ANY SHOP DRAWINGS. ANY MATERIAL SUPPLIED NOT IN CONFORMANCE WITH THE SPECIFICATIONS WILL BE REJECTED.
- THE CONTRACTOR WILL BE RESPONSIBLE, IN ACCORDANCE WITH ARIZONA REVISED STATUTES, TO NOTIFY ARIZONA 811 AT LEAST FORTY-EIGHT (48) HOURS IN ADVANCE OF COMMENCING CONSTRUCTION ACTIVITIES. LOCATIONS OF EXISTING PUBLIC UTILITY LINES SHOWN ON THE PLANS ARE APPROXIMATE. THE CONTRACTOR MUST VERIFY THE LOCATIONS IN THE FIELD AND TAKE NECESSARY PRECAUTIONS, ANY DAMAGE TO A UTILITY SHALL BE REPAIRED AT THE EXPENSE OF THE CONTRACTOR.
- THE CONTRACTOR SHALL MAINTAIN DUST ABATEMENT ACTIVITIES FOR THE DURATION OF THE PROJECT, INCLUDING WEEKENDS AND HOLIDAYS. THE CONTRACTOR SHALL MAINTAIN ADEQUATE MOISTURE LEVELS IN THE SURFACE MATERIALS TO ELIMINATE BLOTTING DUST FROM THESE MATERIALS. ALL HAUL TRUCKS, WHETHER INVOLVED IN DELIVERY OR REMOVAL ACTIVITIES, SHALL BE COVERED AND/OR TARPED IN ORDER TO NEGATE THE REMOVAL OF MATERIAL FROM TRUCKS BY WIND, EITHER NATURAL OR CAUSED BY THE MOVEMENT OF THE TRUCK.
- THE CONTRACTOR SHALL BE RESPONSIBLE FOR PROVIDING A TRAFFIC CONTROL PLAN (TCP) TO THE ENGINEER FOR REVIEW AND APPROVAL AT LEAST SEVEN (7) CALENDAR DAYS PRIOR TO IMPLEMENTATION. THE TRAFFIC CONTROL PLAN SHALL BE PREPARED AND SUBMITTED BY PERSONNEL CERTIFIED IN THE AREA OF CONSTRUCTION TRAFFIC CONTROL BY THE AMERICAN SAFETY SERVICES ASSOCIATION (ATSSSA) OR BY THE INTERNATIONAL MUNICIPAL SIGNAL ASSOCIATIONS (IMS), THE CONTRACTOR WILL BE RESPONSIBLE FOR PROVIDING AND MAINTAINING PROPER SIGNS, BARRICADES, AND WARNING LIGHTS TO CONTROL THE TRAFFIC AND TO ASSURE THE PUBLIC'S HEALTH, WELFARE, AND SAFETY. ALL TRAFFIC CONTROL DEVICES SHALL CONFORM TO THE MOST RECENT FOLLOWING DOCUMENTS ADOPTED BY THE ARIZONA DEPARTMENT OF TRANSPORTATION (ADOT). THE CONTRACTOR SHALL BE RESPONSIBLE FOR THE INSPECTION OF ALL TRAFFIC CONTROL INSTALLATIONS USED IN CONJUNCTION WITH THIS PROJECT AND SHALL INSPECT, AT LEAST TWICE DAILY, TO ENSURE CONFORMANCE WITH THE TRAFFIC CONTROL PLAN.
- THE CONTRACTOR SHALL GUARANTEE THE WORK COMPLETED AGAINST DEFECTIVE MATERIAL AND/OR WORKMANSHIP FOR A PERIOD OF ONE (1) YEAR FROM THE DATE OF FINAL ACCEPTANCE GRANTED BY THE CITY OF SAN LUIS.
- ANY SURVEY MONUMENT DISTURBED DURING CONSTRUCTION ACTIVITIES SHALL BE REPLACED IN ACCORDANCE WITH THE CITY OF SAN LUIS STANDARD DETAILS BY THE CONTRACTOR AT NO EXTRA COST TO THE OWNER. THE CONTRACTOR SHALL UTILIZE A REGISTERED LAND SURVEYOR TO ASSURE PROPER PLACEMENT OF SAID MONUMENT. THE REGISTERED LAND SURVEYOR SHALL PROVIDE A SEALED DESCRIPTION OF THE NEW MONUMENT AND ITS LOCATION.
- PRIOR TO CONSTRUCTION THE CONTRACTOR SHALL "POTHOLE" ALL POTENTIAL POINTS OF CONFLICT BETWEEN NEW UTILITIES AND EXISTING UTILITIES. THE CONTRACTOR SHALL NOTIFY THE ENGINEER IF DISCREPANCIES EXIST BETWEEN DESIGN DESIGN INFORMATION AND ACTUAL FIELD CONDITIONS.
- THE CONTRACTOR SHALL IMPLEMENT ALL APPLICABLE BEST MANAGEMENT PRACTICES (BMPs) FOR THE DURATION OF THE PROJECT PER CITY OF YUMA ORDINANCES AND ADEQ GUIDELINES.
- OCCUPATIONAL SAFETY AND HEALTH ACT (OSHA) STANDARD FOR CONSTRUCTION (TITLE 29, CODE OF FEDERAL REGULATIONS, PART 1926 AS AMENDED) AND CITY OF SAN LUIS SAFETY REGULATIONS ARE APPLICABLE FOR THE COMPLETION OF THE WORK ON THIS PROJECT.
- CONTRACTOR SHALL PROTECT ALL CATCH BASINS AND/OR CURB INLETS THAT EXIST WITHIN 50 FEET OF THE PROJECT LIMITS OR ANY OTHERS THAT NEED PROTECTION FROM CONSTRUCTION ACTIVITIES RUNOFF.
- CONTRACTOR SHALL CONSULT WITH CITY OF SAN LUIS STAFF TO DETERMINE IF REMOVED VALVE AND MANHOLE FRAMES AND COVERS CAN BE REUSED.
- IF HIGH SOIL MOISTURE CONDITIONS AND/OR SHALLOW GROUNDWATER IS ENCOUNTERED RESULTING IN LOW COMPACTION TESTING RESULTS DURING SUBGRADE PROCESSING, IT WILL BE THE RESPONSIBILITY OF THE CONTRACTOR TO REMEDIATE THE WET SOIL CONDITIONS IN ORDER TO ACHIEVE THE REQUIRED PASSING COMPACTION TEST RESULTS. THE CONTRACTOR WILL PERFORM THIS REMEDIATION OF THE WET SUBGRADE SOILS AT NO ADDITIONAL COST TO THE CITY OF SAN LUIS.

## LEGEND

| EXISTING | PROPOSED | EXISTING | PROPOSED | MAJOR CONTOUR |
|----------|----------|----------|----------|---------------|
|          |          |          |          |               |
|          |          |          |          |               |
|          |          |          |          |               |
|          |          |          |          |               |
|          |          |          |          |               |
|          |          |          |          |               |
|          |          |          |          |               |
|          |          |          |          |               |
|          |          |          |          |               |
|          |          |          |          |               |
|          |          |          |          |               |
|          |          |          |          |               |

## ABBREVIATIONS

ALL ABBREVIATIONS ARE PER SECTION 1.3 OF THE 2021 "GREENBOOK" STANDARD SPECIFICATIONS FOR PUBLIC WORKS CONSTRUCTION WITH THE ADDITIONS INDICATED BELOW.

|           |                                      |             |                                     |
|-----------|--------------------------------------|-------------|-------------------------------------|
| ABAND     | ABANDONED                            | FL          | FLOW LINE                           |
| ABC       | AGGREGATE BASE COURSE                | FNC         | FENCE                               |
| AC, ASPH. | ASPHALTIC CONCRETE                   | FDW         | FACE OF WALL                        |
| ADA       | AMERICAN DISABILITY ACT              | FS          | FRESH SURFACE                       |
| ADOT      | ARIZONA DEPARTMENT OF TRANSPORTATION | FTG         | FOOTING                             |
| AP        | ANGLE POINT                          | FW          | FACE OF WALL                        |
| AC, ASPH. | ASPHALTIC CONCRETE                   | G           | GUTTER ELEVATION                    |
| ACSMAS    | ALUMINUM CAP SURVEY MONUMENT STAMPED | GB          | GRADE BREAK                         |
| AVE       | AVE                                  | GRD         | GROUND                              |
| BC        | BEGINNING OF CURB                    | GP          | GUARD POST                          |
| BC, BOX&B | BACK OF CURB                         | GV          | GATE VALVE                          |
| BC&S      | BRASS CAP IN HANDHOLE STAMPED        | HL, HORIZ   | HORIZONTAL                          |
| BCR       | BEGIN CURB RETURN                    | HH          | HANDHOLE                            |
| BEG       | BEGINNING                            | HP          | HIGH PRESSURE                       |
| BM        | BENCH MARK                           | HP          | HIGH POINT                          |
| BLDG      | BUILDING                             | ICV         | IRRIGATION CONTROL VALVE            |
| BLK       | BLOCK                                | IE, IE      | INVERT ELEVATION                    |
| BK        | BACK                                 | INT         | INTERSECTION                        |
| BMP       | BEST MANAGEMENT PRACTICE             | L           | LENGTH                              |
| BSW       | BACK OF SIDEWALK                     | LP          | LOW POINT                           |
| BOIT      | BOTTOM                               | LT          | LEFT                                |
| BVCS      | BEGIN VERTICAL CURVE STATION         | M&S         | MARI CAS                            |
| BVCE      | BEGIN VERTICAL CURVE ELEVATION       | MEX         | MEXICO                              |
| CAB       | CABINET                              | MH          | MANHOLE                             |
| CB        | CATCH BASIN                          | MTR         | METER                               |
| CBP       | CUSTOMS AND BORDER PROTECTION        | M&G         | MARICOPA ASSOCIATION OF GOVERNMENTS |
| CI        | CURB INLET                           | MATL        | MATERIAL                            |
| CL        | CENTERLINE                           | M&M         | M&M                                 |
| CG        | CURB AND GUTTER                      | MN          | NORTH                               |
| C.L.F.    | CHAIN LINK FENCE                     | NTS         | NOT TO SCALE                        |
| C, CONC   | CONCRETE                             | OFF         | OFFSET                              |
| CMP       | CORRUGATED METAL PIPE                | ONE         | OVERHEAD ELECTRIC                   |
| COM       | COMBINATION                          | P           | PAVING                              |
| CONC.     | CONCRETE                             | PIB         | PULL BOX                            |
| CONSTR.   | CONSTRUCTION                         | PC          | POINT OF CURVATURE                  |
| CONT.     | CONTINUES                            | PI          | POINT OF TANGENT INTERSECTION       |
| COR       | CORNER                               | PKG         | PACKING                             |
| CTR       | CENTER                               | PNL         | PANEL                               |
| CTRL      | CONTROL                              | PP          | POWER POLE                          |
| COY       | CITY OF YUMA                         | PRC         | POINT OF REVERSE CURVE              |
| DET       | DETAIL                               | PT          | POINT OF TANGENCY                   |
| D.O.      | DRAIN INLET                          | PWR         | POWER                               |
| DG        | DECOMPOSED GRANITE                   | PVC         | POLYVINYL CHLORIDE                  |
| D&L       | DAMETER                              | PUE         | PUBLIC UTILITY EASEMENT             |
| DWD       | DRAWING                              | RCP         | REINFORCED CONCRETE PIPE            |
| DWY, DWY  | DRIVEWAY                             | R/W, ROW    | RIGHT OF WAY                        |
| E         | EASTERLY                             | RT          | RIGHT                               |
| EA        | END OF CURVE                         | S           | SOUTH                               |
| EJ        | EXPANSION JOINT                      | SB          | SOUTHBOUND                          |
| E, ELEC   | ELECTRICAL                           | SD          | STORM DRAIN                         |
| EVCY      | ELECTRICAL VAULT                     | SD&I        | STORM DRAIN MANHOLE                 |
| ELEV.     | ELEVATION                            | SS&SMH      | SEWER MANHOLE                       |
| EG        | EXISTING GRADE                       | SR          | STATEROUTE                          |
| EL        | ELEVATION                            | ST          | STREET                              |
| EP        | EDGE OF PAVEMENT                     | STA         | STATION                             |
| ES&T      | EASEMENT                             | STLT        | STREET LIGHT                        |
| ETW       | EDGE TRAVELED WAY                    | SQL         | SQUARE                              |
| EVCS      | END VERTICAL CURVE STATION           | SW, SW, S&W | SIDEWALK                            |
| EVCSE     | END VERTICAL CURVE ELEVATION         | S, S, S&W   | SANITARY SEWER                      |
| EXIST     | EXISTING                             | TC          | TOP OF CURB                         |
| FC        | FACE OF CURB                         | T, TELE     | TELEPHONE                           |
| FD        | FOUND                                | TF          | TOP OF FOUNDATION                   |
| F&T       | FOUNDATION                           | TS          | TRAFFIC SIGNAL                      |
| FG        | FRESH GRADE                          | TV          | TELEVISION                          |
|           |                                      | UG          | UNDERGROUND                         |
|           |                                      | UGE         | UNDERGROUND ELECTRIC                |
|           |                                      | UGG         | UNDERGROUND GAS                     |
|           |                                      | U.S.A.      | UNITED STATES OF AMERICA            |
|           |                                      | UNK         | UNKNOWN                             |
|           |                                      | UTL         | UTILITY                             |
|           |                                      | V, VERT.    | VERTICAL                            |
|           |                                      | VC          | VERTICAL CURVE                      |
|           |                                      | VG          | VALLEY GUTTER                       |
|           |                                      | W           | WESTERLYOR WEST                     |
|           |                                      | WAS         | WATER AGENCY STANDARDS              |
|           |                                      | W&I         | WATER METER                         |
|           |                                      | WTR         | WATER                               |
|           |                                      | WV          | WATER VALVE                         |
|           |                                      | X&G         | CROSSING                            |

Know what's below.  
Call before you dig.



|                                     |                         |                             |   |
|-------------------------------------|-------------------------|-----------------------------|---|
|                                     |                         |                             | 333 E. WILSON ROAD<br>SUITE 400<br>SAN LUIS, AZ 85350<br>520.755.5555 |
|                                     | SCALE:<br>DATE: 8/31/23 | APPROVED BY:<br>[Signature] | DRAWN: J.V. RC, AP<br>C.I.P. NO.                                      |
| SAN LUIS LAND PORT OF ENTRY OFFSITE |                         |                             | GENERAL NOTES 2 of 38   |

# SHEET INDEX

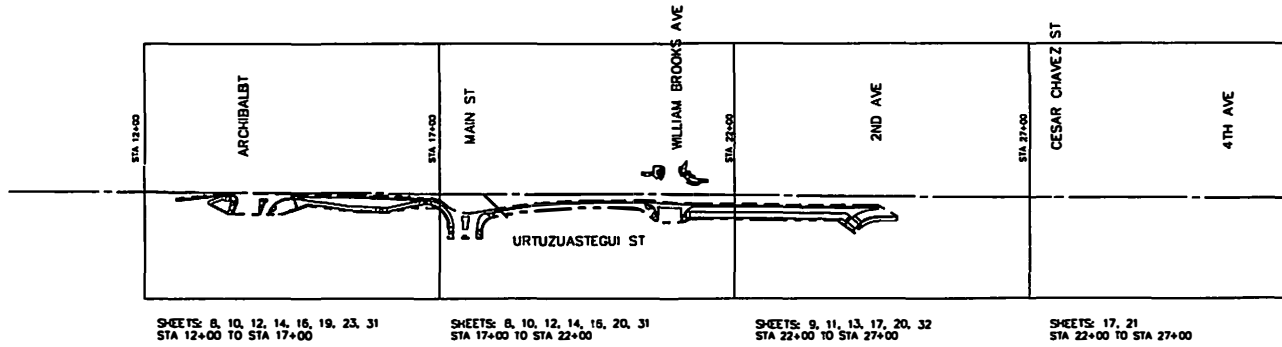

SHEETS: 8, 10, 12, 14, 15, 19, 23, 31  
STA 12+00 TO STA 17+00

SHEETS: 8, 10, 12, 14, 15, 20, 31  
STA 17+00 TO STA 22+00

SHEETS: 9, 11, 13, 17, 20, 32  
STA 22+00 TO STA 27+00

SHEETS: 17, 21  
STA 22+00 TO STA 27+00

# DESIGN NOTES

## BASIS OF COORDINATES AND ELEVATIONS:

**HORIZONTAL CONTROL:**  
THIS PROJECT IS BASED UPON THE ARIZONA COORDINATE SYSTEM, 1983 (ACS 83), NAD83 (2011) (2010.0000) REFERENCE FRAME. USES INTERNATIONAL FEET, AND IS LOCATED IN THE WESTERN ZONE OF SAID COORDINATE SYSTEM. THE CONTROL NETWORK WAS SURVEYED IN DECEMBER, 2022 USING TRIMBLE GNSS UNITS UTILIZING POST-PROCESSED STATIC METHODS THROUGH NGS OPUS.

**STATION (REFERENCE)**  
PT#1 OPUS \*PRIMARY CONTROL POINT & CENTRAL POINT

SURFACE COORDINATES AND/OR DISTANCES WERE COMPUTED FROM THE ACS 83 COORDINATES BY APPLYING A PROJECT SPECIFIC GRID TO SURFACE COMBINED ELEVATION AND SCALE FACTOR (CF) AT A CENTRAL POINT (NCP/CEP) AND TRANSLATING THE RESULTING COORDINATES AS FOLLOWS:

NP LOC = (NP ACS83 - NCP ACS83) \* CF + NCP ACS83 - IN

EP LOC = (EP ACS83 - ECP ACS83) \* CF + ECP ACS83 - VE

WHERE:

NP LOC = LOCAL NORTH NP ACS83 = ACS 83 NORTH  
NCP ACS83 = ACS 83 AT CENTRAL POINT  
EP LOC = LOCAL EAST EP ACS83 = ACS 83 EAST  
ECP ACS83 = ACS 83 AT CENTRAL POINT

COMBINED FACTOR (CF) = 0.9999484527  
NCP = 542 435.53 (ACS83) ECP = 380 374.47 (ACS83)  
IN = 0.00 VE = 0.00

**VERTICAL CONTROL:**  
THIS SURVEY UTILIZED THE ORTHOMETRIC HEIGHTS AS DETERMINED BY THE STATIC GPS SURVEY THROUGH OPUS. THE BENCHMARK INCORPORATED IN THIS SURVEY ARE:

**STATION REFERENCE ELEVATION**  
PT#1 OPUS 68.19 \*PROJECT BENCHMARK

ORTHOMETRIC HEIGHTS (ELEVATIONS) WERE DERIVED FROM GPS ELLIPSOID HEIGHT MEASUREMENTS AND THE APPLICATION OF A HIGH-RESOLUTION HYBRID GEOID MODEL, GEOID 18.

## DESIGN DATA

DESIGN SPEED = 25 MPH  
POSTED SPEED = 25 MPH

## MIDPOINT OF PROJECT

Western Zone  
State Plane Coordinates  
X=382004.76  
Y=542845.25

## LENGTH OF PROJECT

Urtuzastegui Street  
Sta 12+53.88 to 30+06.00 = 1752.12'

# SHEET INDEX

| SHEET NO. | SHEET TITLE                        |
|-----------|------------------------------------|
| 1         | COVER                              |
| 2         | GENERAL NOTES                      |
| 3         | INDEX AND DESIGN PLAN              |
| 4         | TYPICAL SECTIONS                   |
| 5         | TYPICAL SECTIONS                   |
| 6         | STORM DRAIN SUMMARY                |
| 7         | HORIZONTAL CONTROL PLAN            |
| 8         | DEMOLITION PLAN                    |
| 9         | DEMOLITION PLAN                    |
| 10        | GEOMETRY PLAN                      |
| 11        | GEOMETRY PLAN                      |
| 12        | PAVEMENT PLAN                      |
| 13        | PAVEMENT PLAN                      |
| 14        | STORM DRAIN PLAN                   |
| 15        | PAVEMENT MARKING AND SIGNING NOTES |
| 16        | PAVEMENT MARKING PLAN              |
| 17        | PAVEMENT MARKING PLAN              |
| 18        | SIGNING LAYOUT                     |
| 19        | SIGNING PLAN                       |
| 20        | SIGNING PLAN                       |
| 21        | SIGNING PLAN                       |
| 22        | TRAFFIC SIGNAL NOTES               |
| 23        | TRAFFIC SIGNAL PLAN                |
| 24        | TRAFFIC SIGNAL POLE SCHEDULE       |
| 25        | TRAFFIC SIGNAL CONDUCTOR SCHEDULE  |
| 26        | TRAFFIC SIGNAL PLAN                |
| 27        | TRAFFIC SIGNAL POLE SIGNAL         |
| 28        | TRAFFIC SIGNAL CONDUCTOR SCHEDULE  |
| 29        | LIGHTING NOTES                     |
| 30        | LIGHTING MODIFICATION PLAN         |
| 31        | EROSION CONTROL PLAN               |
| 32        | EROSION CONTROL PLAN               |
| 33        | RAMP DETAILS                       |
| 34        | RAMP DETAILS                       |
| 35        | RAMP DETAILS                       |
| 36        | SIGNAL POLE DETAILS                |
| 37        | SIGNAL POLE DETAILS                |
| 38        | SIGNAL POLE DETAILS                |

Keep what's below.  
Call before you dig.



|  |                         |              |   |
|--|-------------------------|--------------|---|
|  |                         |              | <small>SEE 6 MEMORANDUM, REPLY AND RETURN AT 88200 209-355-2270</small> |
|  | SCALE:<br>DATE: 8/31/23 | APPROVED BY: | DRAWN: J.V. RC, AP<br>C.I.P. NO.  |
| SAN LUIS 1 LAND PORT OF ENTRY OFFSITE<br>INDEX & DESIGN PLAN |                         |              | 3 OF 38   |

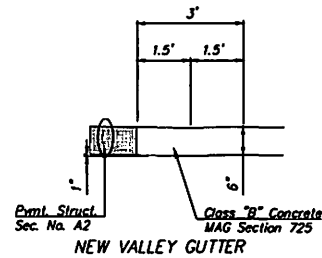
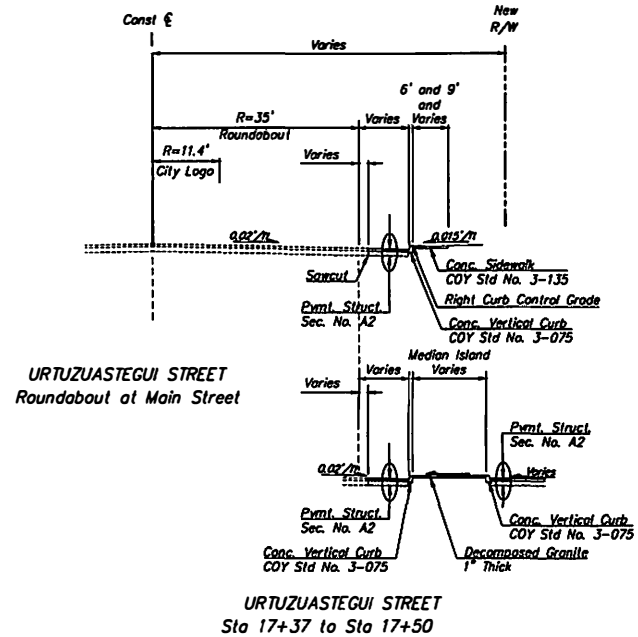
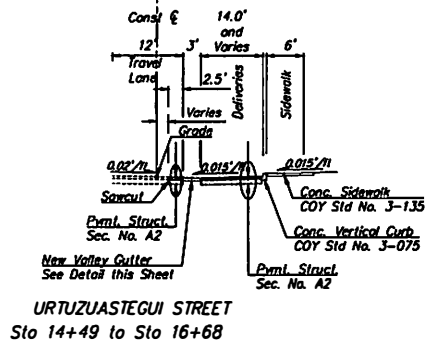
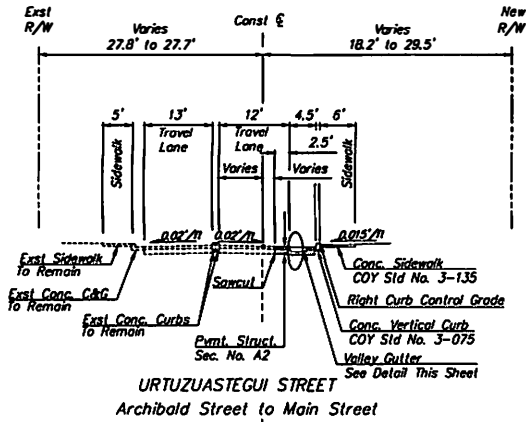
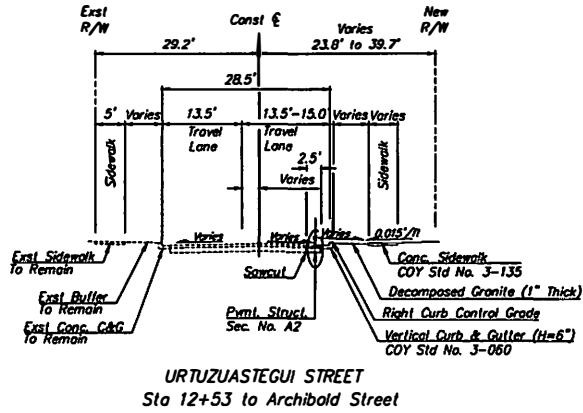

- Notes:
1. See Geometry Sheets for curb information and south Right-of-Way line.
  2. Pavement Marking Sheets for striping layout.
  3. See Details for Pavement Structural Sections

Keep what's below.  
Call before you dig.



|                                       |  |   |
|---------------------------------------|--|---|
|                                       | <b>PSOMAS</b><br>231 E. WINDY ROAD,<br>SUITE 400<br>SAN LUIS, CA 95050<br>505-992-2225 |   |
|                                       | SCALE: N.T.S.<br>DATE: 6/31/23   | APPROVED BY:<br>DRAWN: JV, RC, AP<br>CLIP NO. |
| SAN LUIS I LAND PORT OF ENTRY OFFSITE |  | TYPICAL SECTIONS 4 of 38                      |

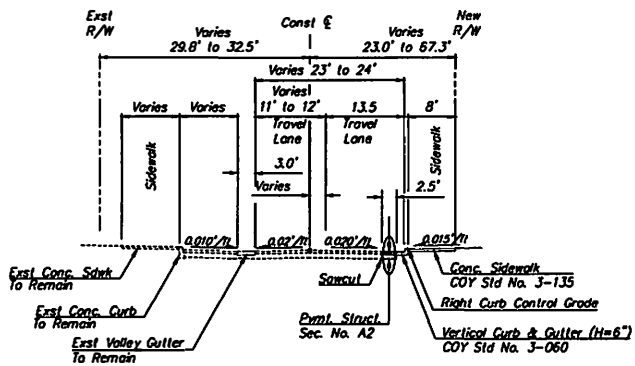

URTUZUASTEGUI STREET  
Main Street to William Brooks Avenue (1st Street)

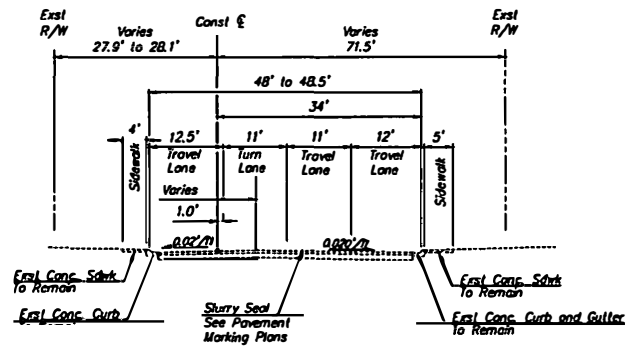

URTUZUASTEGUI STREET  
2nd Avenue to Cesar Chavez Street

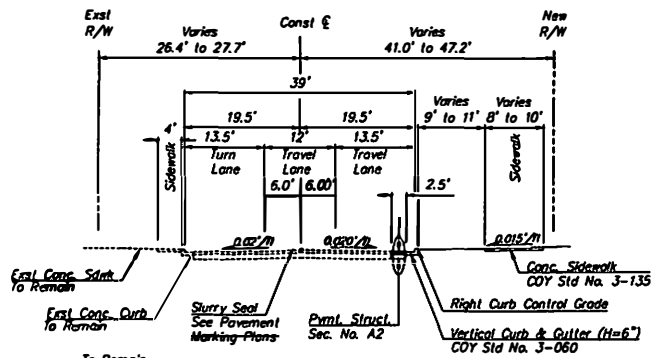

URTUZUASTEGUI STREET  
William Brooks Avenue (1st Street) to 2nd Avenue

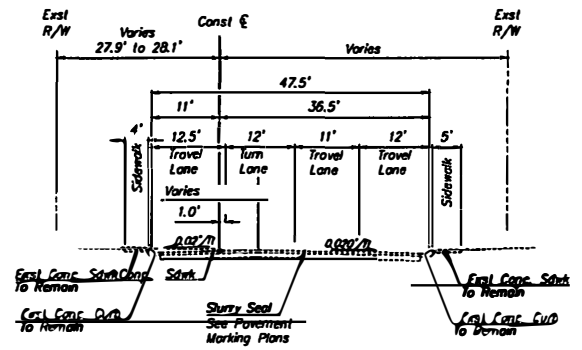

URTUZUASTEGUI STREET  
Cesar Chavez Street to 4th Avenue

- Notes:
1. See Geometry Sheets for curb information and south Right-of-Way line.
  2. Pavement Marking Sheets for striping layout.
  3. See Details for Pavement Structural Sections

Keep what's below.  
Call before you dig.



|                                       |               |              |  |
|---------------------------------------|---------------|--------------|--|
|                                       | <b>PSOMAS</b> |              | 333 E. METROPOLE ROAD<br>SUITE 400<br>SAN LUIS, CA 94503<br>505-762-2020 |
|                                       | SCALE: N.T.S. | APPROVED BY: | DRAWN: JV, RC, AP  |
|                                       | DATE: 8/31/23 | CLIP NO.     |  |
| SAN LUIS I LAND PORT OF ENTRY OFFSITE |               |              | TYPICAL SECTIONS   |
|                                       |               |              | 5 of 38  |

8/31/2023 8:45 AM PM 11, Revised - 8/27/2023 8:45 AM PM 11, 13, 14, 15, 16, 17, 18, 19, 20, 21, 22, 23, 24, 25, 26, 27, 28, 29, 30, 31, 32, 33, 34, 35, 36, 37, 38, 39, 40, 41, 42, 43, 44, 45, 46, 47, 48, 49, 50, 51, 52, 53, 54, 55, 56, 57, 58, 59, 60, 61, 62, 63, 64, 65, 66, 67, 68, 69, 70, 71, 72, 73, 74, 75, 76, 77, 78, 79, 80, 81, 82, 83, 84, 85, 86, 87, 88, 89, 90, 91, 92, 93, 94, 95, 96, 97, 98, 99, 100





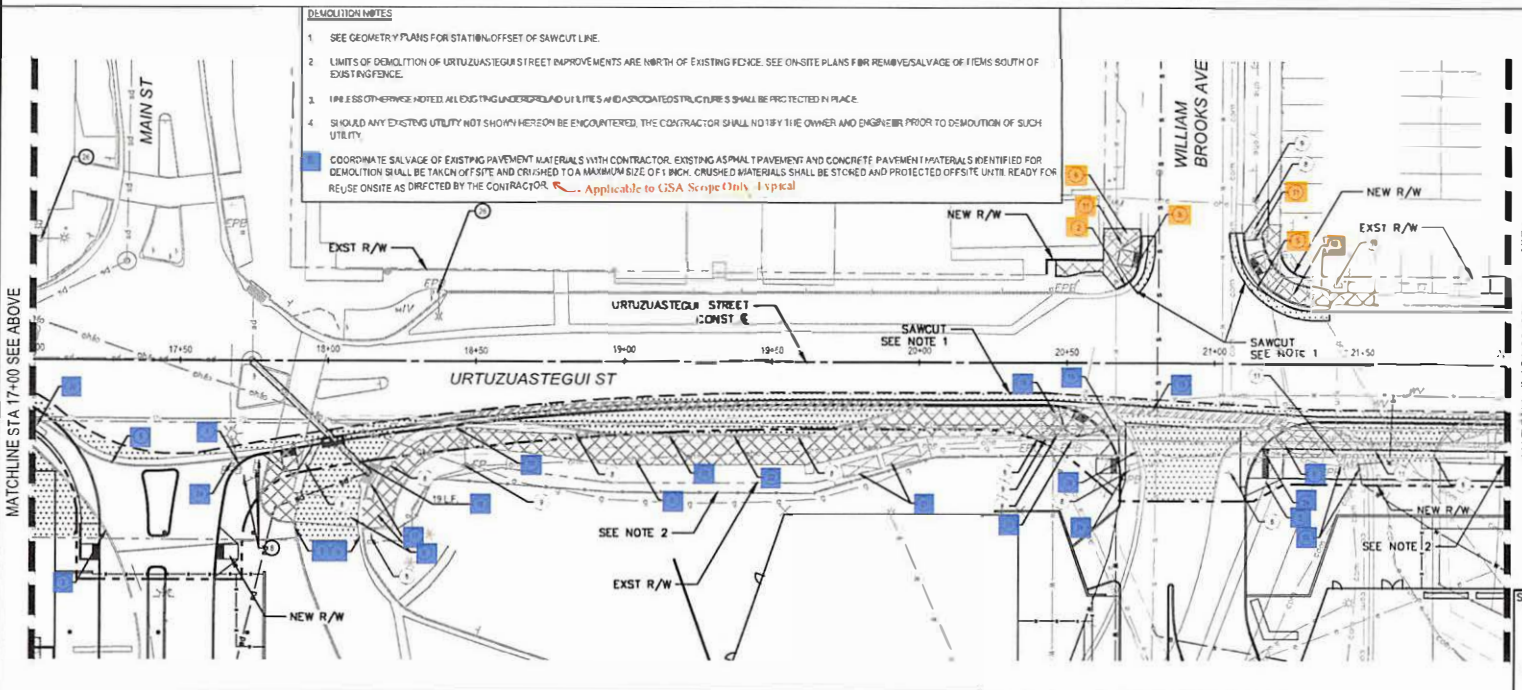
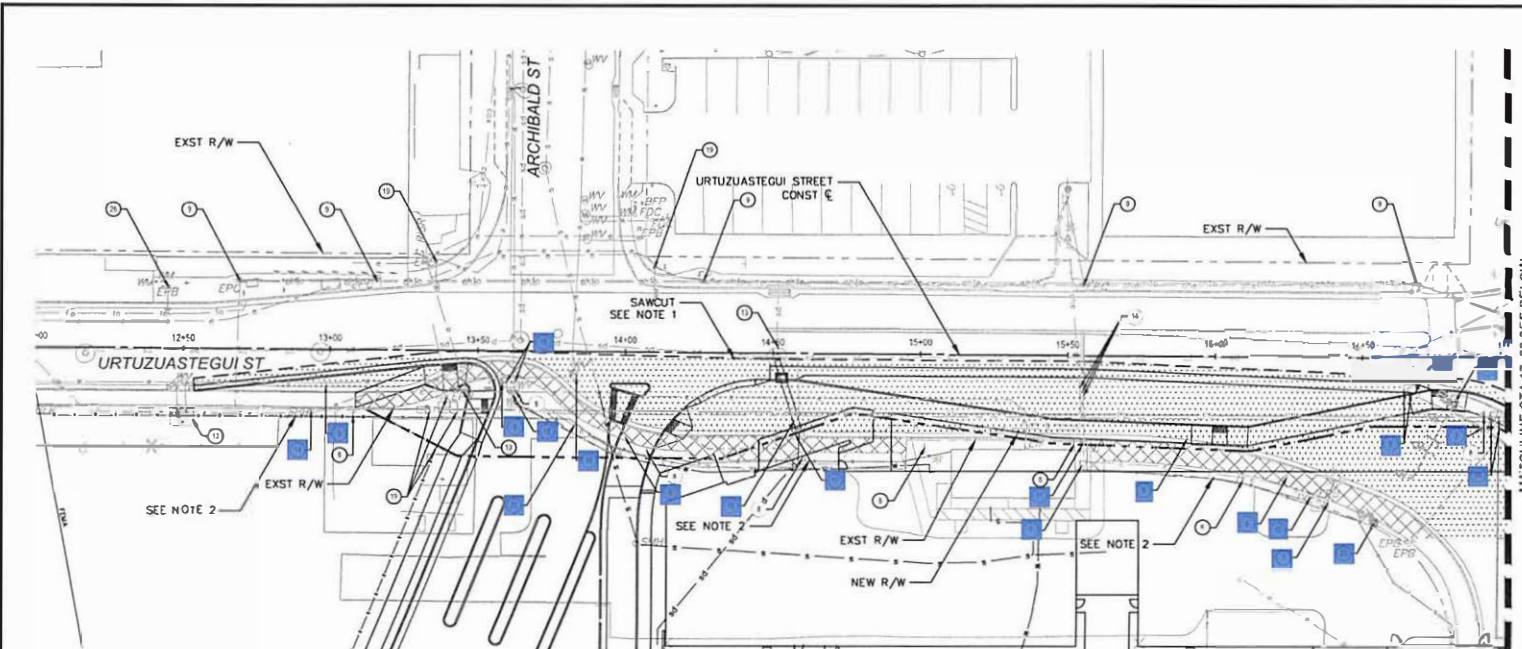

**DEMOLITION NOTES**

- SEE GEOMETRY PLANS FOR STATION/OFFSET OF SAWCUT LINE.
- LIMITS OF DEMOLITION OF URTZUASTEGUI STREET IMPROVEMENTS ARE NORTH OF EXISTING FENCE. SEE ON-SITE PLANS FOR REMOVAL/SALVAGE OF ITEMS SOUTH OF EXISTING FENCE.
- UNLESS OTHERWISE NOTED, ALL EXISTING UNDERGROUND UTILITIES AND ASSOCIATED STRUCTURES SHALL BE PROTECTED IN PLACE.
- SHOULD ANY EXISTING UTILITY NOT SHOWN HEREON BE ENCOUNTERED, THE CONTRACTOR SHALL NOTIFY THE OWNER AND ENGINEER PRIOR TO DEMOLITION OF SUCH UTILITY.

COORDINATE SALVAGE OF EXISTING PAVEMENT MATERIALS WITH CONTRACTOR. EXISTING ASPHALT PAVEMENT AND CONCRETE PAVEMENT MATERIALS IDENTIFIED FOR DEMOLITION SHALL BE TAKEN OFF-SITE AND CRUSHED TO A MAXIMUM SIZE OF 1 INCH. CRUSHED MATERIALS SHALL BE STORED AND PROTECTED OFF-SITE UNTIL READY FOR RE-USE ON-SITE AS DIRECTED BY THE CONTRACTOR. *Applicable to GSA Scope Only - Typical*

**SHEET NOTES**

- REMOVE EXISTING LIGHT, REMOVE EXISTING PULL BOXES, CONDUIT AND ELECTRICAL WIRING SEE LIGHTING PLAN FOR MORE INFORMATION.
- REMOVE AND SALVAGE EXISTING CHAIN LINK FENCE, IRON FENCE AND GATES INCLUDING FOUNDATIONS.
- REMOVE AND DISPOSE EXISTING CONCRETE CURB.
- REMOVE AND DISPOSE EXISTING SITE RETAINING WALLS AND FOUNDATIONS.
- REMOVE AND DISPOSE EXISTING CONCRETE CURB AND GUTTER.
- REMOVE AND DISPOSE EXISTING SIDEWALK CONCRETE, PAVEMENT PLATFORMS AND BASE, FULL DEPTH. SEE DEMO NOTES.
- RELOCATE EXISTING SERVICE METER FOR TRAFFIC SIGNAL CONTROLLER AT ARCHIBALD ST. AND STREET LIGHTS. SEE TRAFFIC SIGNAL PLANS.
- EXISTING SIGNS SEE SIGNING PLANS.
- PROTECT IN PLACE EXISTING OVERHEAD UTILITY POLE.
- EXISTING IRRIGATION VALVE TO BE REMOVED.
- ADJUST TOP FINISHED GRADE MISCELLANEOUS DRY UTILITY EQUIPMENT: PULL BOXES, MANHOLES.
- PROTECT IN PLACE EXISTING WET UTILITY STRUCTURE.
- EXISTING STORM DRAIN MANHOLE, RESET TO FINISHED GRADE.
- PROTECT IN PLACE EXISTING MISCELLANEOUS DRY UTILITY EQUIPMENT: PULL BOXES AND CONDUIT.
- EXISTING WET UTILITY (44 VES. METERS) ADJUST TO FINISHED GRADE.
- REMOVE EXISTING WATER METER.
- REMOVE AND DISPOSE EXISTING STORM DRAIN CATCH BASIN.
- REMOVE AND DISPOSE EXISTING STORM DRAIN PIPE, SEE STORM DRAIN PLAN.
- PROTECT IN PLACE EXISTING TRAFFIC SIGNAL EQUIPMENT, POLE, ARM, FOUNDATION, EXISTING PULL BOXES, CONDUIT AND ELECTRICAL WIRING. SEE TRAFFIC SIGNAL PLAN FOR MORE INFORMATION.
- REMOVE EXISTING TRAFFIC SIGNAL POLE, MAST ARM, AND FOUNDATION. EXISTING CONTROLLER CABINET, CABINET FOUNDATION, EXISTING PULL BOXES, CONDUIT AND ELECTRICAL WIRING. SEE TRAFFIC SIGNAL PLAN.
- REMOVE AND DISPOSE EXISTING STRUCTURES, CANOPY, COLUMNS, MISC. EQUIPMENT, AND CONCRETE BARRIERS, INCLUDING FOUNDATIONS WHERE APPLICABLE.
- REMOVE AND DISPOSE EXISTING TIE BOLTS AND POSTS, FULL DEPTH INCLUDING FOUNDATION.
- SEE SEPARATE ON-SITE WORK OUTSIDE EXISTING STREET RIGHT-OF-WAY.
- REMOVE EXISTING PULLBOX, SEE LIGHTING OR TRAFFIC SIGNAL SHEETS.
- REMOVE AND DISPOSE EXISTING SIDEWALK SCOURPER.
- PROTECT IN PLACE EXISTING LIGHT POLE, PULL BOXES AND CONDUIT.

**LEGEND**

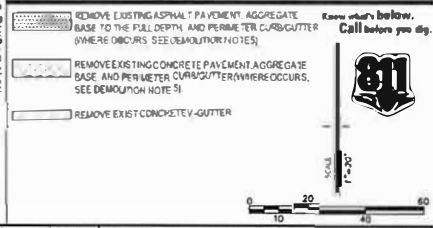

**PSOMAS**  
 SCALE: 1"=20' APPROVED BY: [Signature] DRAWN: J.V. RC AP  
 DATE: 8/31/23 C.I.P. NO.  
 SAN LUIS I LAND PORT OF ENTRY OFFSITE  
 DEMOLITION PLAN B of 38

MATCHLINE STA 17+00 SEE ABOVE  
 MATCHLINE STA 22+00 SEE SHEET 9  
 MATCHLINE STA 17+00 SEE BELOW  
 MATCHLINE STA 17+00 SEE BELOW



**SHEET NOTES**

| Curve # | Length | Radius  | Delta      | Tangent |
|---------|--------|---------|------------|---------|
| C1      | 70.75  | 100.00  | 118°02'30" | 16.02   |
| C2      | 2.86   | 1.00    | 163°36'42" | 6.94    |
| C3      | 2.43   | 1.50    | 131°02'54" | 3.30    |
| C4      | 2.04   | 57.00   | 2°03'48"   | 1.02    |
| C5      | 2.33   | 2.00    | 87°23'58"  | 1.33    |
| C6      | 48.71  | 40.00   | 71°4'49"   | 28.66   |
| C7      | 88.61  | 45.00   | 87°23'58"  | 43.00   |
| C8      | 3.72   | 7.00    | 108°35'28" | 2.68    |
| C9      | 15.35  | 61.00   | 14°23'05"  | 7.72    |
| C10     | 3.11   | 2.00    | 90°00'18"  | 2.00    |
| C11     | 8.13   | 48.50   | 10°01'12"  | 4.08    |
| C12     | 3.76   | 7.00    | 108°35'28" | 2.79    |
| C13     | 18.48  | 296.00  | 1°27'20"   | 9.23    |
| C14     | 1.82   | 7.00    | 83°38'21"  | 1.79    |
| C15     | 31.28  | 334.00  | 7°38'32"   | 15.66   |
| C16     | 16.18  | 15.00   | 88°33'20"  | 10.38   |
| C17     | 175.34 | 1000.00 | 1°01'38"   | 89.41   |
| C18     | 39.24  | 25.00   | 88°58'20"  | 24.93   |
| C19     | 8.52   | 11.20   | 137°27'27" | 3.36    |
| C20     | 6.81   | 25.00   | 201°15'55" | 4.45    |
| C21     | 39.54  | 25.00   | 90°37'37"  | 25.23   |
| C22     | 38.54  | 25.00   | 90°37'08"  | 25.23   |
| C23     | 2.77   | 1.50    | 103°46'43" | 1.98    |
| C24     | 2.58   | 1.50    | 88°23'17"  | 1.74    |
| C25     | 11.34  | 100.00  | 6°38'33"   | 5.77    |
| C26     | 10.83  | 80.92   | 7°40'16"   | 5.42    |
| C27     | 3.14   | 2.00    | 90°00'42"  | 2.00    |
| C28     | 3.75   | 2.00    | 83°04'36"  | 2.11    |
| C29     | 7.32   | 250.00  | 0°31'53"   | 1.16    |

- GEOMETRY PLAN NOTES:**
- XXXXX = BACK OF CURB ELEVATION
  - XXXXX EOG = EDGE OF OUTLET ELEVATION
  - SEE DETAILS FOR GEOMETRY POINTS

**LEGEND**



**PSOMAS** 421 S. Bay St., Suite 100, San Diego, CA 92101  
 SCALE: 1"=20' APPROVED BY: [Signature] DATE: 8/21/23  
 SAN LUIS I LAND PORT OF ENTRY OFFSITE  
 GEOMETRY PLAN 10 OF 38

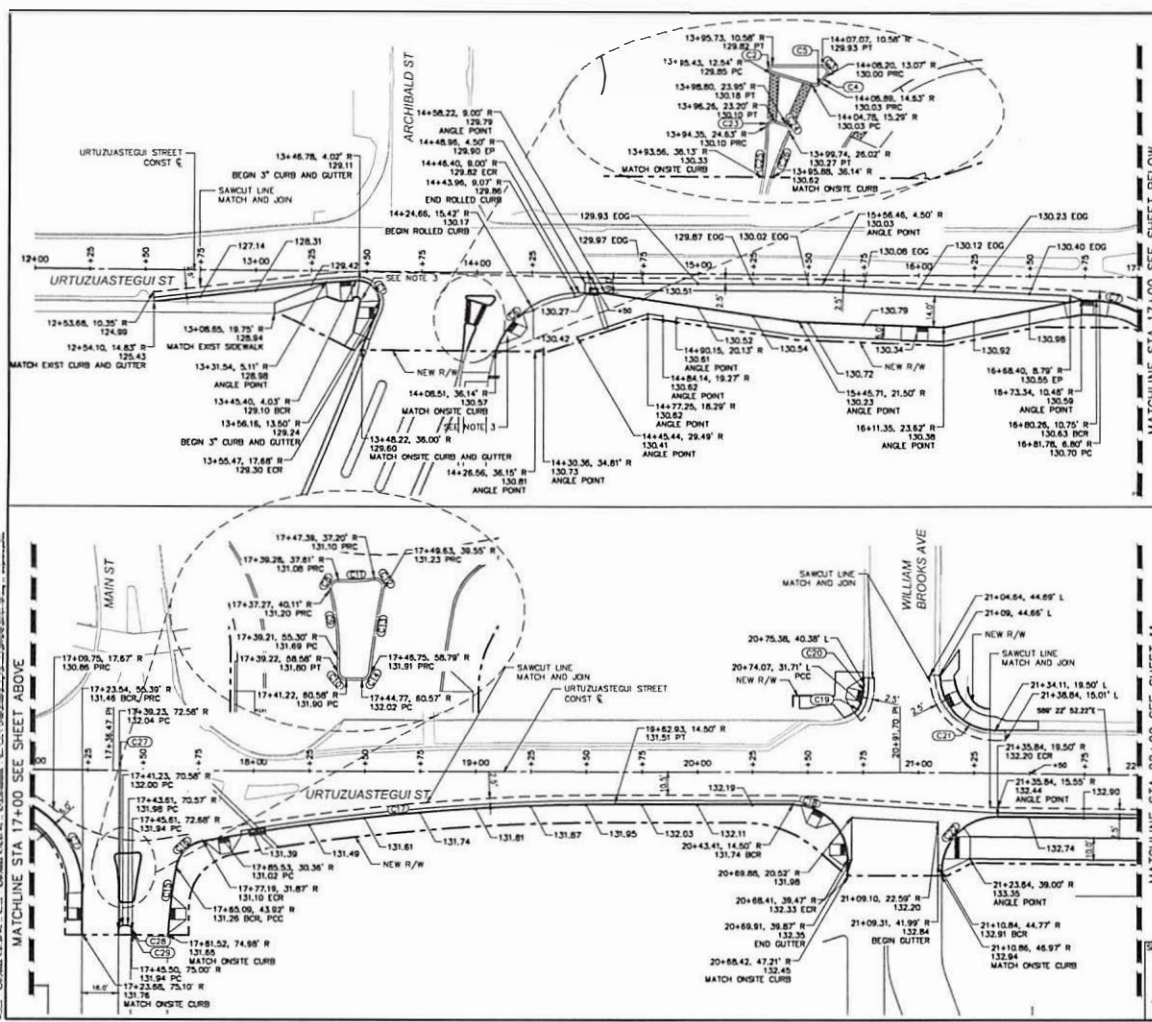

MATCHLINE STA 17+00 SEE SHEET ABOVE

MATCHLINE STA 17+00 SEE SHEET BELOW

MATCHLINE STA 17+00 SEE SHEET 11



CUI / PHS / FEDCOM. Controlled by: General Services Administration Pacific Rim Region & Contact: Christopher Lee, 415-522-2877, christopher.lee@gsa.gov

**SHEET NOTES**

| CURVE TABLE |        |        |            |         |
|-------------|--------|--------|------------|---------|
| Curve #     | Length | Radius | Delta      | Tangent |
| C30         | 61.88  | 66.00  | 53°43'10"  | 33.43   |
| C31         | 51.50  | 50.00  | 59°01'02"  | 28.30   |
| C32         | 4.71   | 1.50   | 180°00'00" | INF     |

**GEOMETRY PLAN NOTES.**

1. XXXXX = BACK OF CURB ELEVATION
2. XXXXX EOG = EDGE OF GUTTER ELEVATION

**LEGEND**

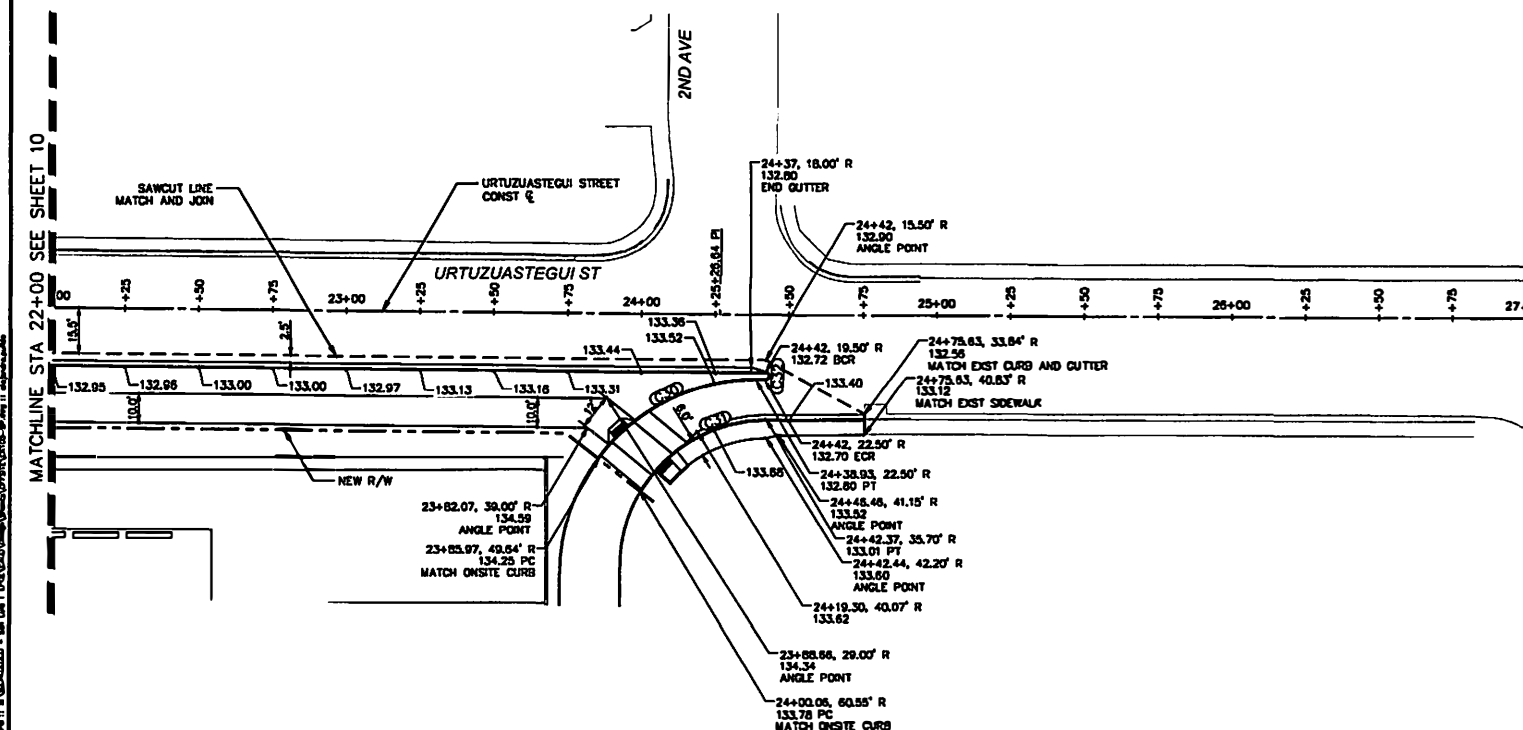
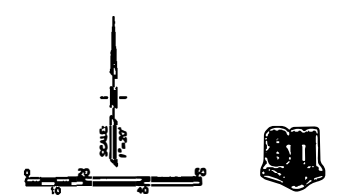

MATCHLINE STA. 22+00 SEE SHEET 10

DATE: 04/27/2023 08:57:57 PM 11: Revised - 02/07/2023 08:54:08 PM 11: B:\PROJECTS\2023\San Luis I Land Port of Entry\Drawings\PLAN\11.dwg

DRAFT

PSOMAS

333 E WENTWORTH ROAD,  
SUITE 400  
SAN ANTONIO, TX 78203  
78752-3229

|                                       |              |                    |
|---------------------------------------|--------------|--------------------|
| SCALE: 1"=20'                         | APPROVED BY: | DRAWN: J.V. RC, AP |
| DATE: 9/31/23                         | CLIP NO.     | CLIP NO.           |
| SAN LUIS I LAND PORT OF ENTRY OFFSITE |              |                    |
| GEOMETRY PLAN                         |              | 11 of 38           |

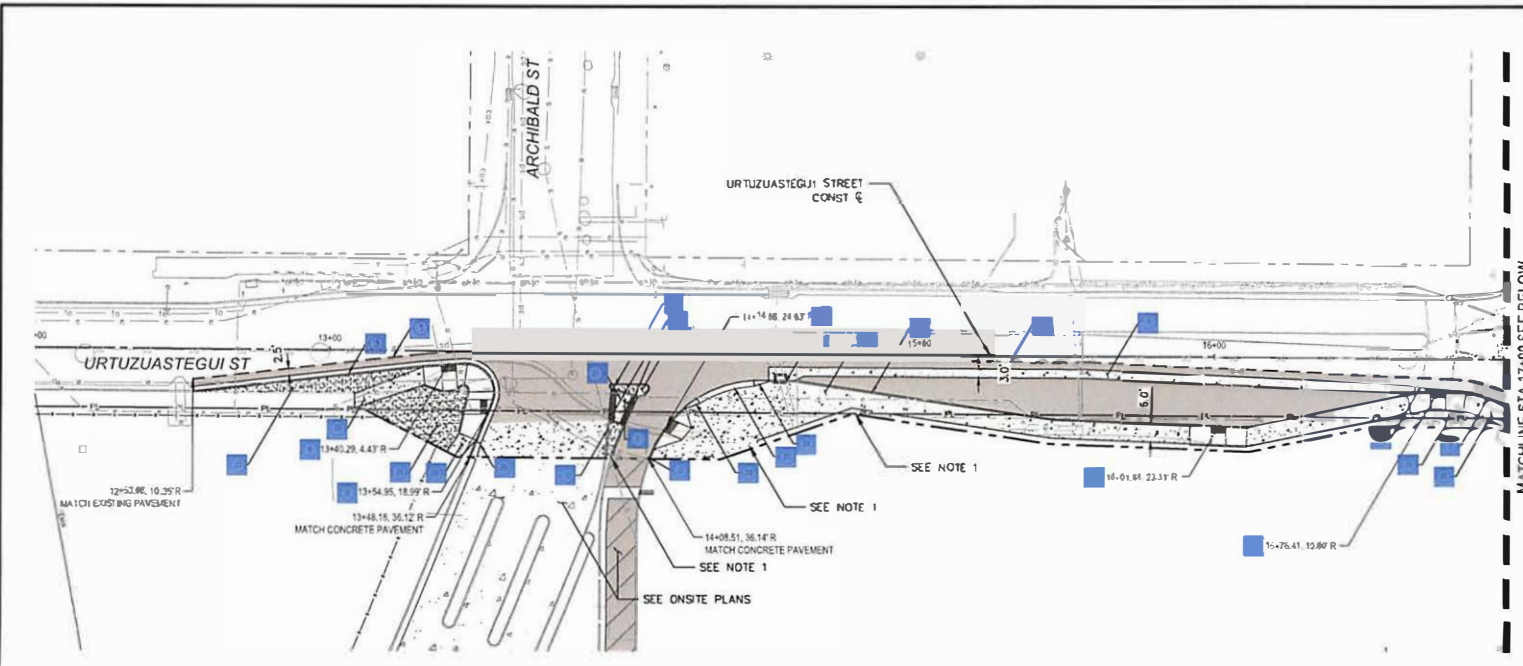

**SHEET NOTES**

- 1 SAWCUT TACK AND JOIN.
- 2 CONSTRUCT 1" CONCRETE CURB PER COY STD 3-075.
- 3 CONSTRUCT 1" CONCRETE CURB AND GUTTER PER COY STD 3-069.
- 4 CONSTRUCT CURB AND GUTTER TRANSITION PER ADOT TYPE 7 C-05-12.
- 5 CONSTRUCT VALLEY GUTTER PER COY STD 3-050 AND DETAIL ON TYPICAL SECTION SHEET 4.
- 6 CONSTRUCT CURB RAMP SEE DETAIL R1.
- 7 CONSTRUCT CURB RAMP SEE DETAIL R2.
- 8 CONSTRUCT CURB RAMP SEE DETAIL R3.
- 9 CONSTRUCT CURB RAMP SEE DETAIL R4.
- 10 CONSTRUCT CURB RAMP SEE DETAIL R5.
- 11 CONSTRUCT CURB RAMP SEE DETAIL R6.
- 12 CONSTRUCT CURB RAMP SEE DETAIL R7.
- 13 CONSTRUCT CURB RAMP SEE DETAIL R8.
- 14 CONSTRUCT CURB RAMP SEE DETAIL R9.
- 15 CONSTRUCT CONCRETE VALLEY GUTTER DRIVEWAY PER COY STD 3-085.
- 16 CONSTRUCT PEDESTRIAN SPEED TABLE PER COY STD 3-205.
- 17 CONSTRUCT CATCH BASIN 1 SEE STORM DRAIN PLAN SHEET 14.
- 18 CONSTRUCT CATCH BASIN 2 SEE STORM DRAIN PLAN SHEET 14.
- 19 CONSTRUCT TRUNCATED DOME SIDEWALK PER MAG DET. 238-17 THROUGH 238-4.
- 20 CONSTRUCT SIDEWALK PER COY STD 3-135.
- 21 INSTALL COMPOSED GRANULE PER MAG DET. 60-7-1.
- 22 CONSTRUCT CURB RAMP SEE DETAIL R10.
- 23 CONSTRUCT NEW ROLLED CURB TYPE D PER MAG DETAIL 220-1.
- 24 CONSTRUCT NEW CURB TO ROLLED CURB TRANSITION PER MAG DETAIL 221.
- 25 CONSTRUCT CURB AND GUTTER TRANSITION PER COY STD 3-100.
- 26 CONSTRUCT PARALLEL CURB RAMP PER MAG DETAIL 238-3.

MATCHLINE STA 17+00 SEE BELOW

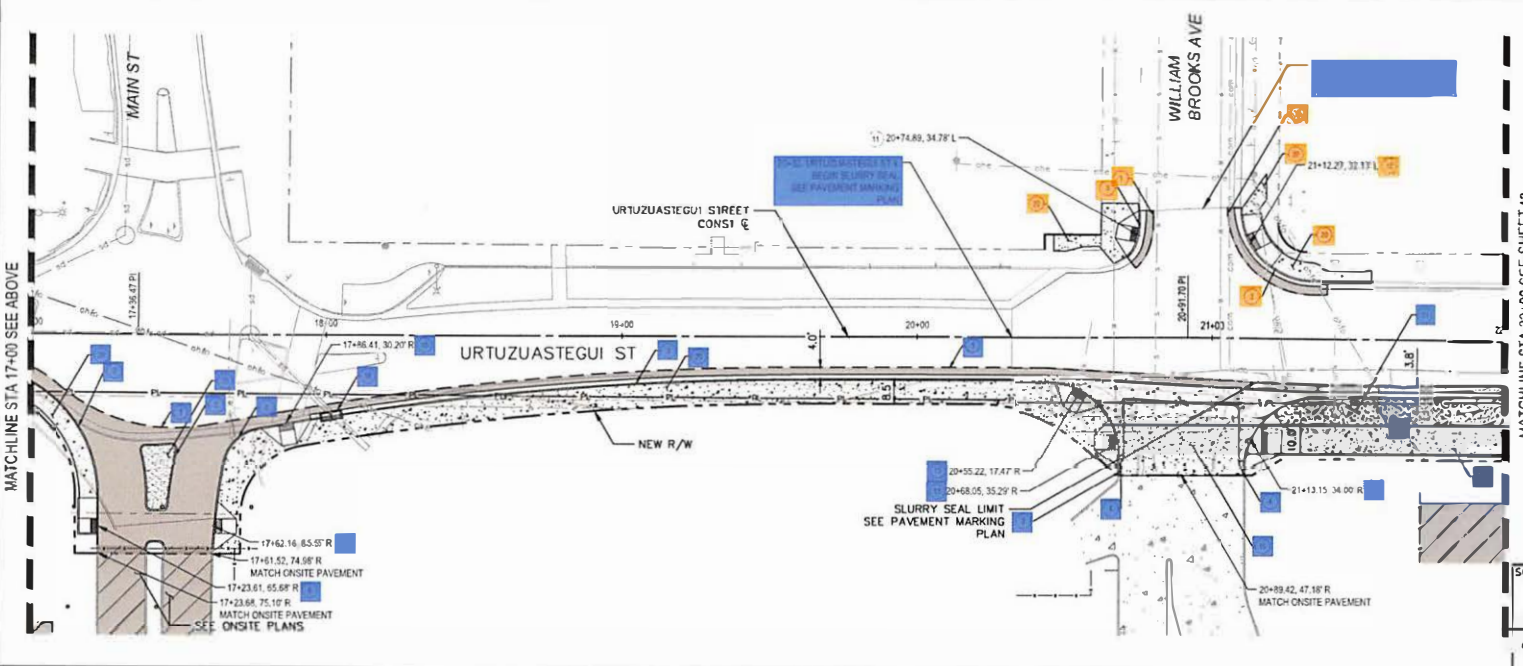

PAVEMENT PLAN NOTES  
1. SEE ONSITE PLANS FOR DETAILS.

Keep what's below.  
Call before you dig.

0 10 20 40 60

MATCHLINE STA 22+00 SEE SHEET 13

**LEGEND**

- CONCRETE PAVEMENT. SEE ONSITE PLANS FOR ONSITE LIMITS AND DETAIL. ALL SHEET 33 FOR OFFSET LIMITS. @CONCRETE SIDEWALK.
- AC PAVEMENT. SEE DETAIL A2 SHEET 33.
- SLURRY SEAL EXISTING PAVEMENT.
- DOG-EARED AREA. SEE ONSITE LANDSCAPE PLANS.
- UTILITY EASEMENT LINE.
- R/W LINE.

**PSOMAS**

SCALE: 1" = 20'

DATE: 1

APPROVED BY: [Signature]

DRAWN: J.V. RC, AP

CIP NO.

SAN LUIS LAND PORT OF ENTRY OFFSITE PAVEMENT PLAN

12 of 38

MATCHLINE STA 17+00 SEE ABOVE

**SHEET NOTES**

- 1 SAW CUT TACK AND JOINT
- 2 CONSTRUCT 16" CONCRETE CURB PER COY STD 3-015.
- 3 CONSTRUCT 6" CONCRETE CURB AND OUTER PER COY STD. 3-050
- 4 CONSTRUCT CURB AND GUTTER TRANSMISSION PER ADD TYPE TC 05 12.
- 5 CONSTRUCT 3" VALLEY GUTTER PER COY STD. 3-090 AND DETAIL ON TYPICAL SECTION SHEET 4.
- 6 CONSTRUCT CURB RAMP SEE DETAIL R1
- 7 CONSTRUCT CURB RAMP SEE DETAIL R2.
- 8 CONSTRUCT CURB RAMP SEE DETAIL R3
- 9 CONSTRUCT CURB RAMP SEE DETAIL R4
- 10 CONSTRUCT CURB RAMP SEE DETAIL R5
- 11 CONSTRUCT CURB RAMP SEE DETAIL R6
- 12 CONSTRUCT CURB RAMP SEE DETAIL R7
- 13 CONSTRUCT CURB RAMP SEE DETAIL R8
- 14 CONSTRUCT CURB RAMP SEE DETAIL R9
- 15 CONSTRUCT CONCRETE VALLEY GUTTER DRIVEWAY PER COY STD. 3-095.
- 16 CONSTRUCT PEDESTRIAN SPEED TABLE PER COY STD 3-205.
- 17 CONSTRUCT CAT CH BASIN 1 SEE STORM DRAIN PLAN SHEET 14.
- 18 CONSTRUCT CAT CH BASIN 2 SEE STORM DRAIN PLAN SHEET 14.
- 19 CONSTRUCT TRUNCATED DOME S IN SIDEWALK PER MAG DET. 238 ; THROUGH 238-5
- 20 CONSTRUCT SIDEWALK PER COY STD 3-135
- 21 INSTALL DECOMPOSED GRANITE PER MAG DET. 607.1.
- 22 CONSTRUCT CURB RAMP SEE DETAIL R10
- 23 CONSTRUCT NEW ROLLED CURB TYPED PER MAG DETAIL 220-1.
- 24 CONSTRUCT NEW ROLLED CURB TRANSITION PER MAG DETAIL 221
- 25 CONSTRUCT CURB AND GUTTER TRANSMISSION PER COY STD. 3-100
- 26 CONSTRUCT PARALLEL CURB RAMP PER MAG DETAIL 235-3

PAVEMENT PLAN NOTES:  
1. SEE ON-SITE PLANS FOR DETAILS

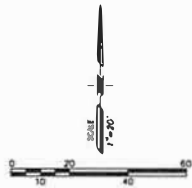

Know what's below. Call before you dig.



**LEGEND**

- CONCRETE PAVEMENT (SEE ON-SITE PLANS FOR ON-SITE LIMITS AND DETAIL AT SHEET 337 DROFF-SITE LIMITS). CONCRETE SIDEWALK.
- AC PAVEMENT (SEE DETAIL A2 SHEET 331).
- SLURRY SEAL EXISTING PAVEMENT.
- DGF FILL AREA. SEE ON-SITE LANDSCAPE PLANS.
- UTILITY EASEMENT LINE.
- NEW LINE.

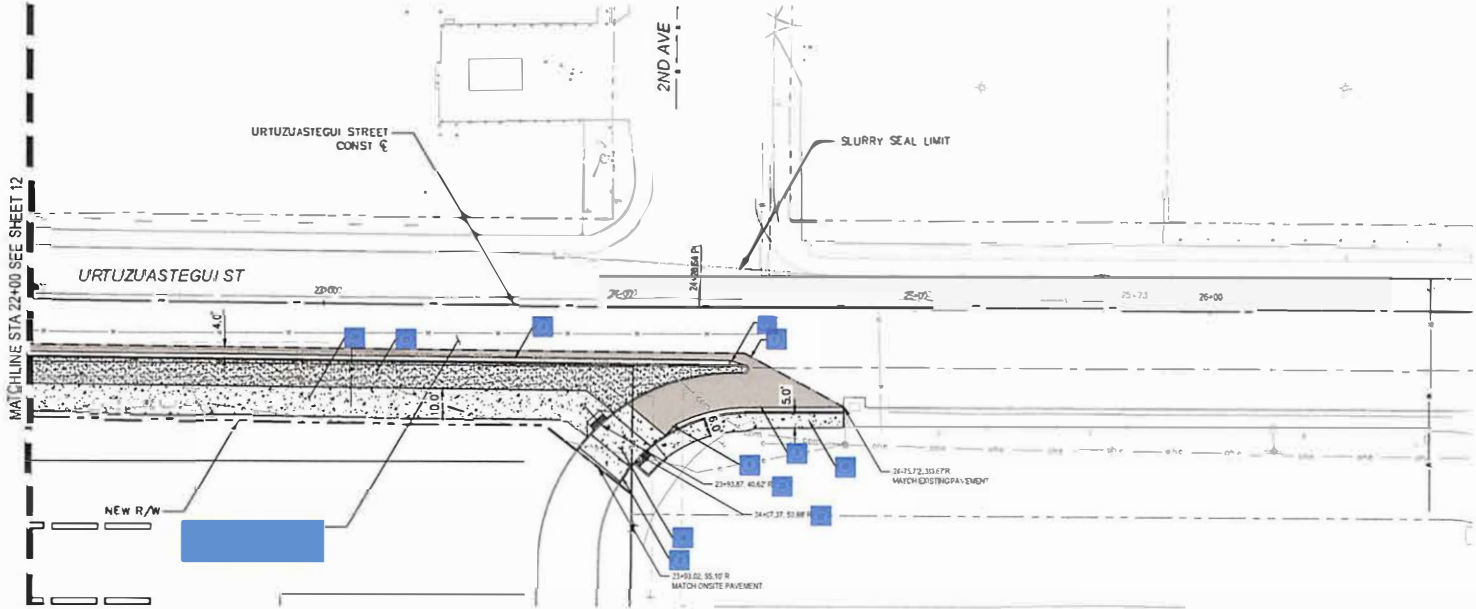

MATCHLINE STA 22+00 SEE SHEET 12

URTUZASTEGUI ST

2ND AVE

SLURRY SEAL LIMIT

NEW R/W

24+75.72, 35.67 R  
MATCH EXISTING PAVEMENT

23+93.52, 55.10 R  
MATCH ON-SITE PAVEMENT

Project: 8/17/2023 8:28:46 AM ... 8/17/2023 8:50:38 PM ...



**PSOMAS**

SCALE: 1" = 30' APPROVED BY: DRAWN: JY RC AP  
 DATE: 8/31/23 C.I.P. NO.  
 SAN LUIS I LAND PORT OF ENTRY OFFSITE  
 PAVEMENT PLAN 13 OF 35



**PAVEMENT MARKING NOTES:**

1. THE CONTRACTOR SHALL BE RESPONSIBLE FOR THE LAYOUT AND INSTALLATION OF THE PERMANENT PAVEMENT MARKING FOLLOWING CONTROL POINT THAT HAVE BEEN SET NO MORE THAN 50 FEET APART ALONG THE LINES TO BE STRIPED.
2. THE FINAL STRIPING SHALL BE 90 MIL (0.90 INCHES) THICK EXTRUDED THERMOPLASTIC REFLECTORIZED STRIPING PLACE AS SHOWN IN THE PROJECT PLANS.
3. ALL FINAL STOP BARS, PAVEMENT ARROWS, CROSSWALK LINES, "ONLY" LEGENDS, AND YIELD TRIANGLES SHALL BE WHITE 90 MIL (0.90 INCHES) THICK ALKYD EXTRUDED THERMOPLASTIC REFLECTORIZED MARKINGS.
4. ALL RAISED PAVEMENT MARKERS SHALL HAVE AN ABRASION-RESISTANT COATING ON THE FACE OF THE PRISMATIC REFLECTORS AND SHALL CONFORM TO THE DETAILS OF ADOT STD. DRNGS. THEY SHALL BE INSTALLED WITH BITUMINOUS ADHESIVE WHICH IS ON THE ADOT APPROVED PRODUCTS LIST.
5. ALL RAISED PAVEMENT MARKERS SHALL BE INSTALLED SO THAT THE REFLECTIVE FACE OF EACH MARKER IS FACING THE DIRECTION OF TRAFFIC AND IS PERPENDICULAR TO THE DIRECTION OF TRAFFIC FLOW.
6. TYPE "C" PAVEMENT MARKERS SHALL BE INSTALLED SO THAT THE CLEAR REFLECTIVE FACE OF EACH MARKER IS FACING APPROACHING TRAFFIC AND IS PERPENDICULAR TO THE DIRECTION OF THE TRAFFIC FLOW.
7. WHERE RAISED PAVEMENT MARKERS ARE PLACED ALONG SOLID STRIPING, THE NEAREST EDGE OF EACH MARKER SHALL BE OFFSET ONE INCH FROM THE NEAREST EDGE OF THE STRIPING.
8. WHEN STRIPE OBLITERATION IS NECESSARY, IT SHALL BE ACCOMPLISHED BY WATER BLASTING OR OTHER APPROVED METHODS. THE CONTRACTOR SHALL THEN SLURRY THE AREA AS PER MAG STANDARD SPECIFICATION 715, WITH EMULSIFIED ASPHALT SLURRY SEALANT TYPE II OR AS DIRECTED BY THE PROJECT INSPECTOR. THE CONTRACTOR SHALL NOT INSTALL NEW PAVEMENT MARKINGS UNTIL THE SLURRY SEAL HAS CURED AT A MINIMUM OF 72 HOURS. PAINTING OVER PAVEMENT MARKING DOES NOT CONSTITUTE PAVEMENT MARKING OBLITERATION.
9. THE CONTRACTOR SHALL CLEAN THE ROADWAY SURFACE TO THE SATISFACTION OF THE ENGINEER, BY SWEEPING AND AIR-JET BLOWING. IMMEDIATELY PRIOR TO THE PLACEMENT OF ALL PAVEMENT MARKINGS, THE ROADWAY SURFACE SHOULD BE DRY. THE PAVEMENT TEMPERATURE SHALL NOT BE LESS THAN 40 DEGREES F AND THE AIR TEMPERATURE SHALL NOT BE LESS THAN 35 DEGREES F FOR THE PLACEMENT OF EPOXY PAVEMENT MARKINGS. THE ROADWAY SURFACE SHALL BE DRY AND THE AIR AND PAVEMENT TEMPERATURES SHALL NOT BE LESS THAN 50 DEGREES F FOR THE INSTALLATION OF TYPE I PAVEMENT MARKING TAPE, AND SHALL NOT BE LESS THAN 50 DEGREES F FOR THE INSTALLATION OF EXTRUDED THERMOPLASTIC.
10. THE PAVEMENT MARKING DRAWINGS ARE SCHEMATIC ONLY AND NOT TO SCALE. THE CONTRACTOR SHALL FOLLOW ALL DIMENSIONS AND DETAILS WHEN INSTALLING PAVEMENT MARKINGS.
11. STRIPING AT END OF ROADWAY WORK TO MATCH EXISTING STRIPING.
12. DIMENSIONS SHOWN TO THE PAVEMENT STRIPING ARE TO THE CENTER OF THE STRIPING OR, IN THE CASE OF DOUBLE STRIPING, TO THE CENTER OF THE DOUBLE STRIPING.

**SIGNING NOTES:**

1. ALL SIGNS SHALL BE IN COMPLIANCE WITH THE MANUAL OF UNIFORM TRAFFIC CONTROL DEVICES (2009 MUTCD), THE 2012 ARIZONA SUPPLEMENT, ADOT SIGNING AND MARKING STANDARD DRAWINGS, AND THE TRAFFIC ENGINEERING MANUAL OF APPROVED SIGNS.
2. THE SIGN LOCATIONS AND POST LENGTHS ARE APPROXIMATE. THE CONTRACTOR SHALL VERIFY THE SIGN LOCATIONS AND ACTUAL POST LENGTHS WITH THE ENGINEER PRIOR TO CONSTRUCTING THE FOUNDATION FOR THE SIGN SUPPORTS.
3. THE BOTTOM OF EACH SIGN SHALL BE AT LEAST 7 FEET ABOVE THE NEAREST EDGE OF PAVEMENT AND AT LEAST 7 FEET ABOVE THE GROUND UNDER THE SIGN.
4. OFFSETS FOR ALL SIGNS SHALL BE MEASURED FROM THE EDGE OF THE ROADWAY TO THE NEAREST SIGN POST.
5. THE RETRO-REFLECTIVE SHEETING ON ALL NEW SIGNS SHALL MEET THE MINIMUM CRITERIA ESTABLISHED FOR TYPE XI SHEETING IN THE REVISED ASTM D4956 AND THE ADOT SPECIFICATIONS. SEE SECTION 1007 IN THE SPECIFICATIONS.
6. ALL NEW SIGNS SHALL BE INSTALLED ON SQUARE TUBE POSTS WITH FOUNDATIONS AS INDICATED IN ADOT DWG. S-1.
7. SHOP DRAWINGS ARE REQUIRED FOR ALL GUIDE SIGNS.
8. THE CONTRACTOR SHALL REMOVE EXISTING SIGNING WHERE INDICATED ON PLANS, AND SALVAGED TO THE CITY OF SAN LUIS. CONTACT THE CITY OF SAN LUIS STREETS DIVISIONS, (520) 344-8599 48 HOURS PRIOR TO SIGN REMOVAL FOR INFORMATION ON WHERE TO DELIVER THE SIGNS.
9. THE CONTRACTOR SHALL INVENTORY ALL SIGNS TO BE REMOVED OR COVERED, AND NOT DAMAGED SIGNS TO THE ENGINEER AT THE TIME OF COVERING OR REMOVAL. ALL SIGNS DAMAGED BY COVERING OR REMOVAL SHALL BE REPLACED BY THE CONTRACTOR AT NO COST TO THE CITY OF SAN LUIS.
10. NEW STREET NAME SIGNS SHALL HAVE QJ25 TREATED ALUMINUM GAUGE WITH CUTTABLE FILM OR SILK SCREEN INKS WITH I60 PROTECTIVE FILM.

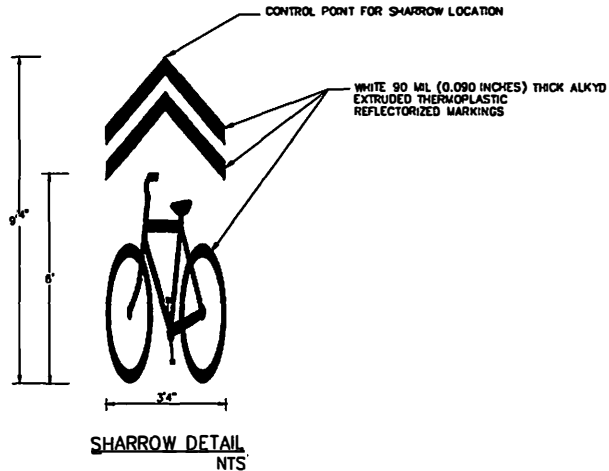

Keep what's below.  
Call before you dig.



|  |                             |              |   |
|--|-----------------------------|--------------|---|
|  | <b>PSOMAS</b>               |              | 333 E. WILSON ROAD,<br>SUITE 200<br>PHOENIX, AZ 85028<br>(602) 998-1000 |
|  | SCALE: N/A<br>DATE: 8/31/23 | APPROVED BY: | DRAWN: JV, RC, AP<br>C.I.P. NO.   |
| SAN LUIS I LAND PORT OF ENTRY OFFSITE<br>MARKING AND SIGNING NOTES |                             |              | 15 of 38  |

Revision: 8/27/2023 8:08:41 AM by: J. [unclear] Date: 8/27/2023 8:08:41 AM File: 13 - SAN LUIS I LAND PORT OF ENTRY OFFSITE MARKING AND SIGNING NOTES.dwg

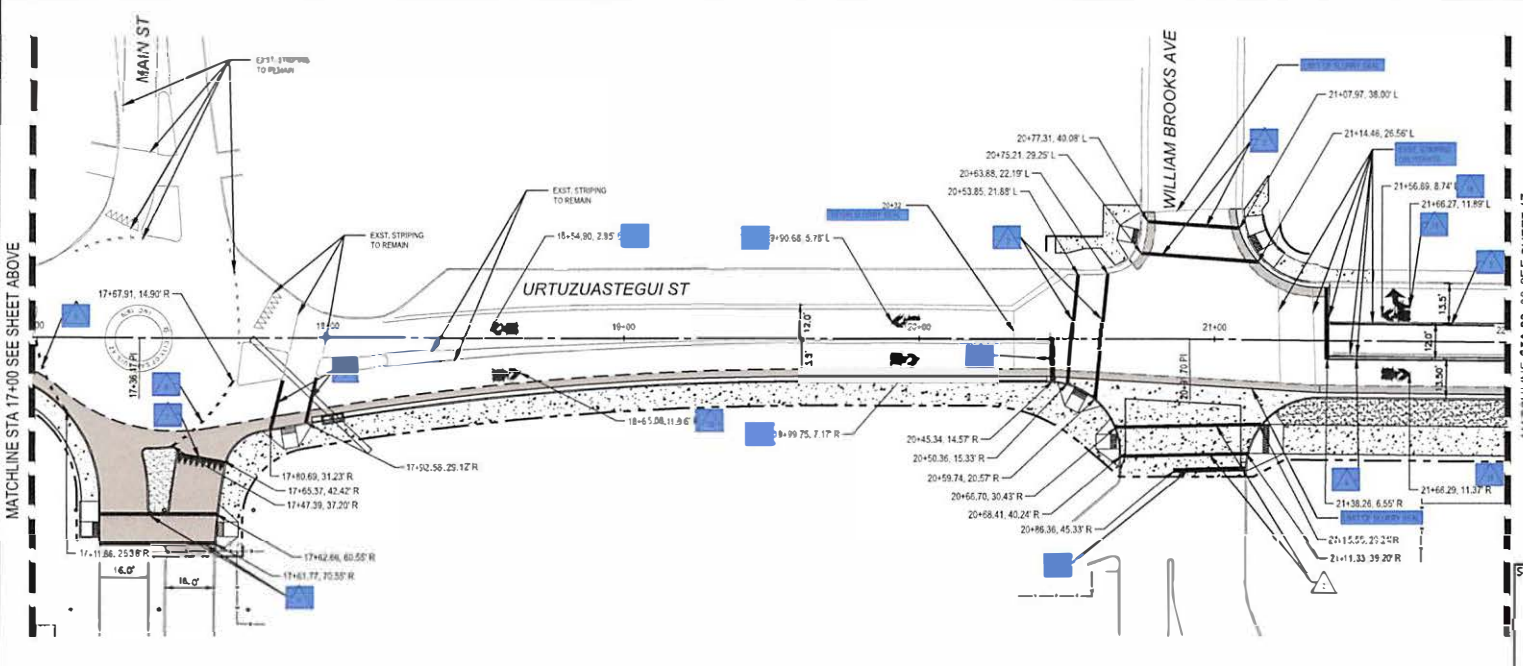
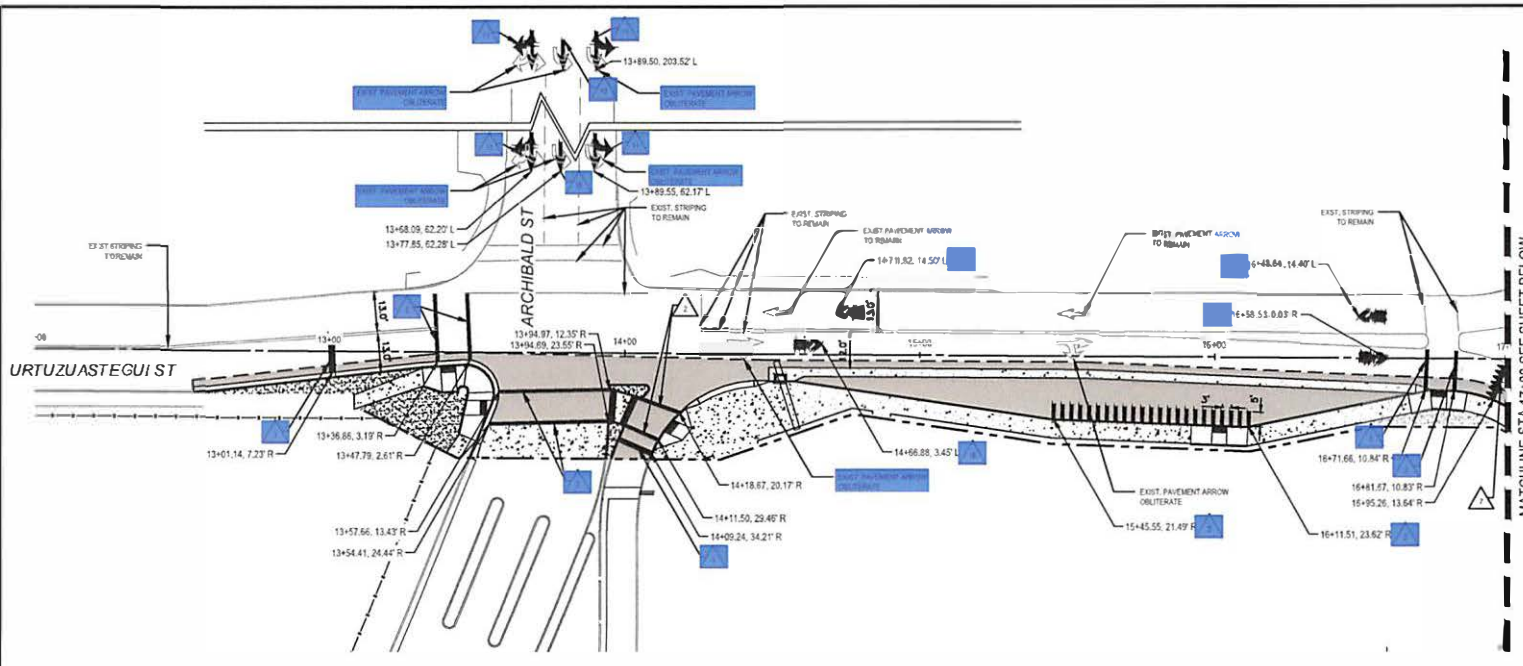

### SHEET NOTES

- ▲ NEW 18" WHITE SOLID (18SW) PER COY STD. NO. 10-020 AND 10-025. L.F.
- ▲ NEW 12" WHITE SOLID (12SW) PER COY STD. NO. 10-020 AND 10-025. L.F.
- ▲ NO ITEM L.F.
- ▲ NEW 24" WHITE SOLID (24SW) PER COY STD. NO. 10-020 AND 10-025. L.F.
- ▲ NEW 12" WIDE DOTTED WHITE LANE LINE (12LDW) PER COY STD. NO. 10-025. L.F.
- ▲ NEW 6" DOTTED WHITE (6DW) PER COY STD. NO. 10-025. L.F.
- ▲ NEW 24"x 36" WHITE YIELD LINE. L.F.
- ▲ NEW 6" DOUBLE SOLID YELLOW (6SDY) PER COY STD. NO. 10-025. L.F.
- ▲ NEW 6" COMBINATION YELLOW (6CY) PER COY STD. NO. 10-025. L.F.
- ▲ NEW 12" YELLOW SOLID (12SY) PER COY STD. NO. 10-025. L.F.
- ▲ NEW DOUBLE ARROW PER AOOT STANDARD DRAWING M-10 L.F.
- ▲ NEW STRAIGHT ARROW PER AOOT STANDARD DRAWING M-10 L.F.
- ▲ NEW RIGHT ARROW PER AOOT STANDARD DRAWING M-10 L.F.
- ▲ NEW LEFT ARROW PER AOOT STANDARD DRAWING M-10 L.F.
- ▲ NEW MERGING RIGHT TO LEFT PER AOOT STANDARD DRAWING M-11 L.F.
- ▲ NO ITEM L.F.
- ▲ NEW 6" BROKEN WHITE PER COY STD. 10-205 L.F.
- ▲ NEW "SHARROFF". SEE DETAIL. E.A.

\* ALL STRIPING SHALL BE THERMOPLASTIC MARKING.

### LEGEND

Know what's below.  
Call before you dig.

333 E. WENTWORTH ROAD  
SUITE 400  
SAN LUIS I. CA 95050  
TEL: 916.434.3200

SCALE: 1" = 20'  
DATE: / /

APPROVED BY: [Signature]  
DRAWN BY: J.V. R.C. A.P.

SAN LUIS I. LAND PORT OF ENTRY OFFSITE  
PAVEMENT MARKING PLAN 16 OF 38

Project No. = 13/17/2023 - 13/17/2023 & 13/17/2023 - San Luis I. Land Port of Entry Offsite Pavement Marking Plan  
 Date: 13/17/2023  
 Scale: 1" = 20'  
 Drawn by: J.V. R.C. A.P.  
 Checked by: J.V. R.C. A.P.  
 Approved by: J.V. R.C. A.P.  
 Date: 13/17/2023

MATCHLINE STA 17+00 SEE SHEET ABOVE

MATCHLINE STA 17+00 SEE SHEET BELOW

MATCHLINE STA 22+00 SEE SHEET 17





6.8 14.2 3 14.7 3 9.7 9.8 4.8

D1-2 (conventional road);

3.0" Radius, 1.0" Border, White on Green;

Arrow 6" Type D2 - 13.5" 90°;

"MEXICO", D;

3.0" Radius, 1.0" Border, White on Green;

"SAN LUIS", D 50% spacing;

Arrow 6" Type D1 - 9.8" 180°;

Arrow 6" Type D1 - 9.8" 0°;

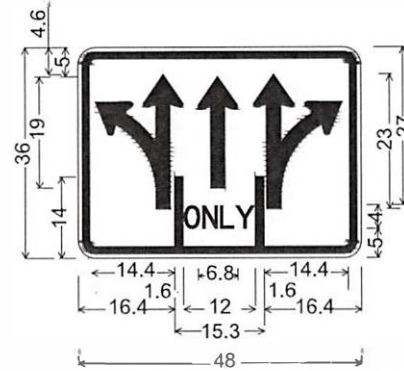

3.0" Radius, 1.3" Border, 0.7" Indent, LaneMarker height: 12.0 LaneMarker width: 1.5 Black on White;  
3.0" Radius, 1.3" Border, 0.8" Indent, Black on White;

"ONLY", D 2K specified length;

3.0" Radius, 1.3" Border, 0.8" Indent, LaneMarker height: 12.0 LaneMarker width: 1.5 Black on White;

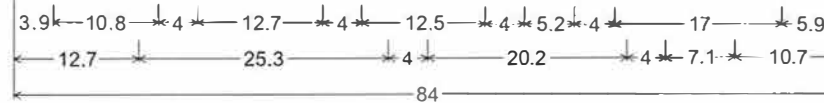

D8-102 (conventional road);

3.0" Radius, 1.0" Border, White on Green;

"San Luis Port of Entry", E; "Employee Parking", D;

Arrow 4" T type D2 - 9.0" 45°;

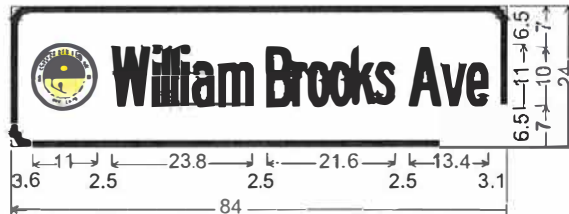

Metro OST;

3.0" Radius, 1.0" Border, White on Blue;

Rounded Rectangle 5.5" Radius; "William", Highway B 2K 160% spacing;

"Brooks", Highway B 2K; "Ave", Highway B 2K;



Metro OST;

3.0" Radius, 1.0" Border, White on Blue;

Rounded Rectangle 5.5" Radius; "Urtuzuastegui", Highway B 2K 160% spacing;

"St", Highway B 2K;

Know what's below.  
Call before you dig.



|                                       |              |  |
|---------------------------------------|--------------|--|
| <b>PSOMAS</b>                         |              | 331 E NETWORK ROAD,<br>SUITE 450<br>TUCSON, AZ 85705<br>520.792.3300 |
| SCALE: N.T.S.                         | APPROVED BY: | DRAWN: JV, RC, AP  |
| DATE: 8/31/23                         |              | C.I.P. NO.   |
| SAN LUIS I LAND PORT OF ENTRY OFFSITE |              |  |
| SIGNING LAYOUT                        |              | 18 OF 38   |





SHEET NOTES

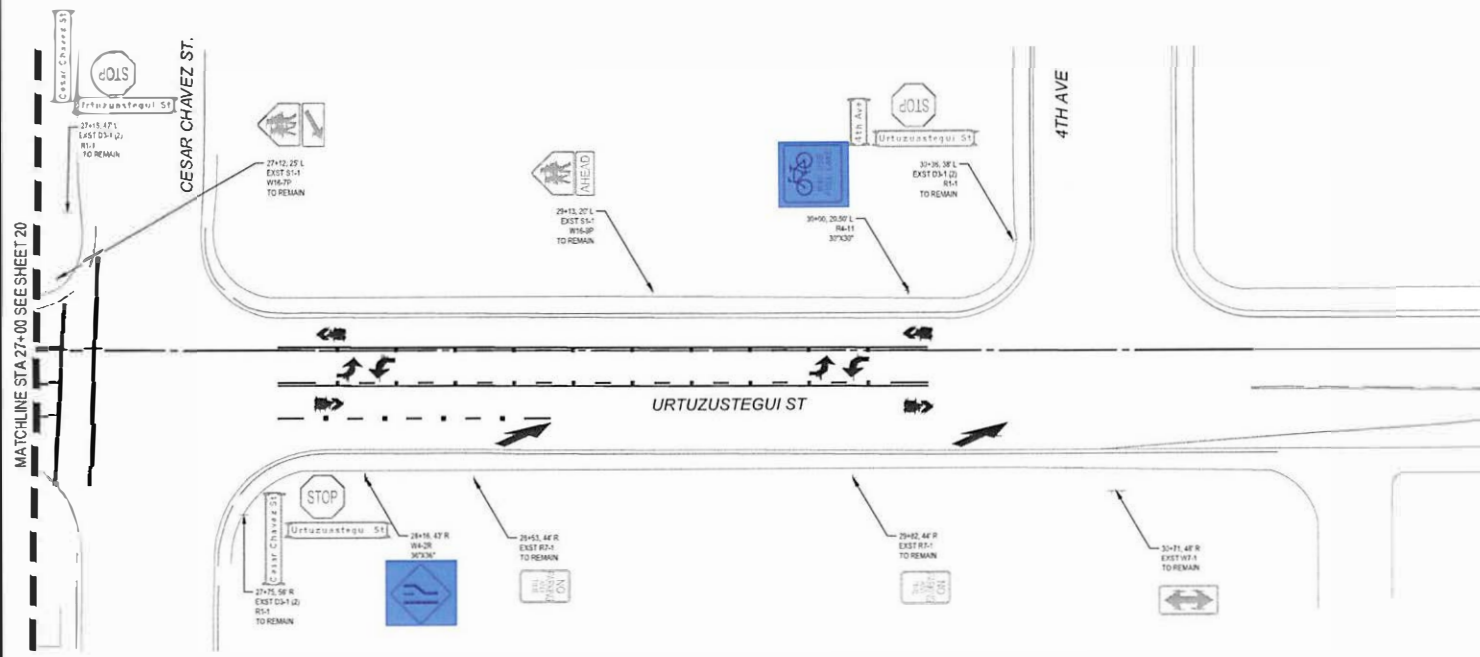

LEGEND

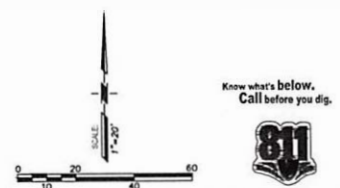

Know what's below. Call before you dig.



**PSOMAS** 333 E. METROPLEX ROAD, SUITE 400, FOLSOM, CA 95759, 916.792.3300

SCALE: 1"=20' DATE: 8/31/23 APPROVED BY: DRAWN: JV, RC, AP C.I.P. NO.

SAN LUIS I LAND PORT OF ENTRY OFFSITE SIGNING PLAN 21 OF 38

Printed - 8/31/2023 7:02:24 PM :: Saved - 8/27/2023 6:36:41 PM :: 9:13:40 AM 20230809 - San Luis I Land Port of Entry Offsite - See Link 1: \\P:\L\2023\08\09\San Luis I Land Port of Entry Offsite\0812-SP.dwg :: 8/31/2023















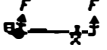



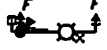



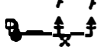



| CABINET SCHEDULE  |      |   |                |   |                   |                                   |
|---|------|---|----------------|---|-------------------|-----------------------------------|
| CABINET   | TYPE | CONTROLLER  | AUX CONTROLLER | REMARKS   | STATION, OFFSET   | STANDARDS                         |
|  | -    | APS<br>METER PEDESTAL   |                | MEYERS MEUG16A-M100-AZ, 138<br>1 PHASE 100 AMP, W/PHOTOCELL<br>1-3 SERV. DISC, 100 AMP 2-POLE<br>2-4 LIGHTING, 20 AMP 2-POLE<br>6 CONTROL, 15 AMP 1-POLE<br>8 SIGNAL, 60 AMP 1-POLE | 21+33.9, 27.7' RI | T.S. 2-6<br>T.S. 3-5              |
|  | -    | ZINCBLUE BBS<br>WITH 500W BATTERY   |                | UNIT RATED 5 KW, 120/240V<br>1 PH IN NEMA 3R ENCLOSURE  | 21+39.1, 27.7' RI | T.S. 2-7                          |
|  | IV   | ECONOLITE COBALT ATC<br>CONTROLLER<br>W/ECONOLITE CABINET<br>POWER SUPPLY<br>PS-2412-5A |                | ECONOLITE 77 INCH "R" CABINET<br>ADOT TYPE V (ADOT T.S. 3-9)<br>INCLUDE GENERATOR HOOK-UP<br>ON CABINET   | 21+45.0, 27.7' RI | T.S. 2-4<br>T.S. 3-9<br>T.S. 3-10 |

| POLE SCHEDULE   |                    |           |     |                      |                                 |                     |  |  |  |
|---|--------------------|-----------|-----|----------------------|---------------------------------|---------------------|--|--|--|
| POLE<br>NUMBER  | TYPE               | MAST ARMS |     | SIGNALS              |                                 | LUMINAIRE           | PED. P.B.<br>TYPE/SIGN                           | REMARKS  | STATION, OFFSET  |
|   |                    | SIG       | LUM | FACE                 | ASSEMBLY                        |                     |  |  |  |
|    | J<br>See<br>Note 6 | 25        | -   | (2) - F<br>(1) - PED | (1) - II<br>(1) - V<br>(1) - XI | -                   | (1) TYPE 1<br>2" ADA PB<br>PPB SIGN<br>R10-3a(L) | PRE-EMPT BEACON, SEE NOTE 2<br>PRE-EMPT GPS SENSOR, SEE NOTE 2<br>STREET NAME SIGN, SEE SIGNING PLAN             |  21+29.3, 27.2' RI  |
|    | A<br>(10 FT)       | -         | -   | (1) - PED            | (1) - XI                        | -                   | (1) TYPE 1<br>2" ADA PB<br>PPB SIGN<br>R10-3a(R) | PPB, SEE NOTE 4  |  20+59.2, 31.2' RI<br> 20+48.2, 22.9' RI |
|    | O<br>See<br>Note 6 | 25        | 15  | (2) - F<br>(1) - PED | (1) - II<br>(1) - V<br>(1) - XI | 1.35W<br>SEE NOTE 5 | TYPE 1<br>2" ADA PB<br>PPB SIGN<br>R10-3a(L)     | PRE-EMPT BEACON, SEE NOTE 2<br>STREET NAME SIGN, SEE SIGNING PLAN<br>VIDEO CAMERA, SEE NOTE 3<br>PPB, SEE NOTE 4 |  20+48.2, 31.4' LI  |
|    | A<br>(10 FT)       | -         | -   | (1) - PED            | (1) - XI                        | -                   | (1) TYPE 1<br>2" ADA PB<br>PPB SIGN<br>R10-3a(L) | PPB, SEE NOTE 4  |  20+65.5, 33.4' LI  |
|    | J<br>See<br>Note 6 | 25        | -   | (2) - F<br>(1) - PED | (2) - II<br>(1) - XI            | -                   | TYPE 1<br>2" ADA PB<br>PPB SIGN<br>R10-3a(L)     | PRE-EMPT BEACON, SEE NOTE 2<br>STREET NAME SIGN, SEE SIGNING PLAN<br>VIDEO CAMERA, SEE NOTE 3<br>PPB, SEE NOTE 4 |  21+19.0, 36.7' LI  |
|  | G                  | -         | 15  | -                    | -                               | 1.35W<br>SEE NOTE 5 | -  | PHOTOCELL ON LUMINAIRE   |  21+48.5, 24.7' LI  |
|  | PPB                | -         | -   | -                    | -                               | -                   | TYPE PB<br>2" ADA PB<br>PPB SIGN<br>R10-3a(L)    | PPB, SEE NOTE 4  |  21+24.5, 28.3' RI  |

**SHEET NOTES**

**POLE SCHEDULE NOTE**

THE CONTRACTOR SHALL PREPARE SIGNED AND SEALED SHOP DRAWINGS FOR ALL TRAFFIC SIGNAL POLES, MAST ARMS, AND FOUNDATIONS TO SUPPORT THE LOAD SHOWN ON THESE PLANS AND TO THE STANDARDS DRAWINGS. DESIGN OF SIGNALS SHALL BE COMPLIANT WITH THE 2013 AASHTO STANDARD SPECIFICATIONS FOR STRUCTURAL SUPPORTS FOR HIGHWAY SIGNS, LUMINAIRES, AND TRAFFIC SIGNALS, 6TH EDITION. SHOP DRAWINGS SHALL BE SUBMITTED TO THE SENIOR TRAFFIC TECHNICIAN FOR REVIEW AND APPROVAL PRIOR TO FABRICATION.

**NOTES**

- THE EXISTING TRAFFIC SIGNAL WAS CONSTRUCTED FOLLOWING THE ARIZONA DEPARTMENT OF TRANSPORTATION (ADOT) SIGNALS AND LIGHTING STANDARD (SLS) DRAWINGS, 2010. REFERENCE IS MADE TO THESE STANDARD DETAILS.
- PRE-EMPTION SHALL BE OPTICOM GPS AND INCLUDE:
  - GPS RADIO UNIT MODEL #3100
  - GPS INSTALLATION CABLE MODEL #1700, EXT. 500'
  - 4-CHANNEL 1 SLOT OPTICOM CARD RACK MODEL #760
  - OPTICOM MULTI-MODE PHASE SELECTOR MODEL #764
- VIDEO DETECTION SHALL BE MOVISION WITH VIDEO IMAGE VEHICLE TRACKING AND DETECTION SYSTEM (V.I.V.T.D.S.) AND INCLUDE:
  - MOVISION SMARTVIEW 360 BELL CAMERA
    - INCLUDE CAMERA MOUNT AND UNIVERSAL HUB FOR MOUNTING TO TRAFFIC SIGNAL POLE.
  - SHIELDED CAT5E ETHERNET CABLE
  - MOVISION CORE WITH DIRECT COUNTS MODULE (DCM)
- PEDESTRIAN PUSH BUTTONS SHALL BE POLARIS APS BUTTONS WITH IN29W0X-X R10-3 SIGN, ICCU-S CENTRAL CABINET CONTROL UNIT, 060-390 CABLE HARNESS, AND IN2-ICB INTERCONNECT BOARD.
- LUMINAIRE SHALL BE LEOTEX MODEL GCL1, 135, 3000K, 60G OR EQUIVALENT.
- TYPE J AND O TRAFFIC SIGNAL POLES SHALL BE PER ADOT SPECIFICATION, BUT WITH HINGED COVER ON TERMINAL COMPARTMENT PER FIG FOR REFERENCE ONLY DETAILS.

**LEGEND**

How much below.  
Call before you dig.



**PSOMAS** EST. 1978  
 SCALE: N.T.S. APPROVED BY: DRAWN: J.V. RC, AP  
 DATE: 8/31/2018 CHECKED BY: I.C.P. NO.  
 SAN LUIS I LAND PORT OF ENTRY OFFSITE  
 TRAFFIC SIGNAL POLE SCHEDULE 27 OF 38

1: L:\Projects\2018\San Luis I Land Port of Entry\Drawings\Traffic Signal Pole Schedule.dwg, 11/15/2018, 11:00 AM, J.V. RC



== LEGEND ==

| EXIST | PROPOSED |  |
|-------|----------|--|
|       |          | LUMINAIRE, MAST ARMS, POLE & POLE BASE |
|       |          | *7 PULLBOX WITH EXTENSION              |
|       |          | *3/2 PULLBOX                           |
|       |          | *5 PULLBOX                             |
|       |          | *7 PULLBOX                             |
|       |          | LOAD CENTER CABINET                    |
|       |          | METER PEDESTAL                         |
|       |          | CONDUIT RUN                            |
|       |          | LUMINAIRE W/PHOTOCELL                  |
|       |          | LUMINAIRE                              |
|       |          | STREET NAME SIGN (SNS)                 |
|       |          | POLE ID KEY LETTER                     |
|       |          | CONDUIT RUN NUMBER                     |
|       |          | CONSTRUCTION KEY NOTE                  |
|       |          | GAS LINE                               |
|       |          | TELEPHONE LINE                         |
|       |          | ELECTRIC LINE                          |
|       |          | SEWER LINE                             |
|       |          | WATER LINE                             |
|       |          | CABLE TV LINE                          |
|       |          | FIBER OPTIC LINE                       |

**STREET LIGHTING GENERAL NOTES:**

- ALL LIGHTING AND RELATED CONDUIT/WIRE WORK SHALL CONFORM UNLESS NOTED OTHERWISE TO THE 2021 EDITION OF THE ADOT STANDARD SPECIFICATIONS FOR ROAD AND BRIDGE CONSTRUCTION AND THE CURRENT STANDARD DRAWINGS FOR TRAFFIC SIGNALS AND LIGHTING ALONG WITH ANY SUBSEQUENT AMENDMENTS PRIOR TO BID DATE FOR HIGHWAY LIGHTING.
- EXISTING CONDUIT RUNS ARE DIAGRAMMATIC AND ARE BASED SOLELY ON EXISTING AS-BUILT PLANS. EXACT LOCATION OF CONDUIT RUNS AND PULL BOX LOCATIONS SHALL BE FIELD VERIFIED PRIOR TO ANY EXCAVATION OR REMOVAL WORK.
- POLE OFFSET SHALL BE MEASURED FROM CONSTRUCTION CENTERLINE INDICATED TO THE CENTER OF POLE AS INDICATED ON POLE SCHEDULE. REFER TO LIGHTING PLAN SHEETS FOR ADDITIONAL INFORMATION.
- ALL EXISTING EQUIPMENT AND LIGHTING SYSTEMS SHALL REMAIN IN OPERATION UNLESS OTHERWISE NOTED. COORDINATE AND RECEIVE APPROVAL OF ANY OUTAGES FROM ENGINEER.
- CONTRACTOR IS TO NOTIFY ENGINEER IN WRITING WHEN FIELD ADJUSTMENT OF POLES IS NECESSARY TO AVOID CONFLICT WITH UTILITIES OR CONSTRUCTION. STAKE NEW LOCATION OF POLES FOR REVIEW BY ENGINEER PRIOR TO ANY WORK.
- CONTRACTOR IS RESPONSIBLE FOR LOCATION ALL EXISTING UTILITIES WHETHER SHOWN HEREIN OR NOT AND SHALL PROTECT THEM FROM DAMAGE. CONTRACTOR SHALL BEAR ALL EXPENSES FOR REPAIR OR REPLACEMENT IN CONJUNCTION WITH EXECUTION OF THIS CONTRACT.
- WHERE INDICATED ON THE PLANS, REMOVE EXISTING FOUNDATION PER SPECIAL PROVISIONS. POLES AND HARDWARE SHALL BE CLEANED AND DELIVERED TO APS, OR CITY OF SAN LUIS AS INDICATED ON THE PLANS.
- DIRECT BURIED POLES SHALL BE SET IN AN AUGURED HOLE IN UNDISTURBED EARTH. POLE SHALL BE SET PLUMB IN TWO DIRECTIONS 90 DEGREES APART. BACKFILL SHALL BE IN ACCORDANCE WITH ADOT 2021 STANDARD SPECIFICATIONS, SUBSECTION 203-5.03(B).
- EXISTING APS POWER SOURCE SHALL REMAIN IN PLACE AND FULLY OPERATIONAL THROUGHOUT THE CONSTRUCTION PERIOD UNLESS OTHERWISE NOTED.
- CONTRACTOR SHALL RECIRCUIT AND RECONNECT ALL ELECTRICAL EQUIPMENT CIRCUITS, ETC. NOT INDICATED TO BE REMOVED WHICH MAY BECOME SEVERED FROM IT NORMAL POWER SUPPLY.
- DIRECT BURY POLE BURY DEPTH SHALL BE IN ACCORDANCE WITH APS REQUIREMENTS.
- CONTRACTOR SHALL CONTACT JOHN P. MAHON OF APS AT (928-336-9820) A MINIMUM OF 10 DAYS BEFORE ANY SERVICE WORK IS REQUIRED.
- CONTRACTOR SHALL REFER TO STORM DRAIN PLAN SHEETS FOR COORDINATION OF CONDUIT INSTALLATIONS ROUTED ADJACENT TO AND OVER EXISTING OR NEW CATCH BASIN AREAS.
- EACH LUMINAIRE SHALL BE INDIVIDUALLY PROTECTED BY FUSE.
- ORIENT POLE BASE TO ROADWAY SUCH THAT THE LUMINAIRES ARE 90 DEGREES TO THE DIRECTION OF TRAVEL.
- CONTRACTOR TO REPLACE AND BURNED-OUT LAMPS OF NEW EQUIPMENT AT ANY TIME DURING THE CONSTRUCTION PERIOD UP TO FINAL ACCEPTANCE OF THE PROJECT BY THE CITY OF SAN LUIS. COST FOR MATERIAL AND LABOR TO BE INCLUDED AS PART OF "MAINTAIN EXISTING HIGHWAY LIGHTING AND TRAFFIC SIGNALS".
- CONTRACTOR TO FURNISH AND INSTALL A LOCATOR BALL IN THE CONDUIT TRENCH ADJACENT TO PULL BOXES. PULL BOX COVERS TO BE BURIED 12 INCHES BELOW GRADE. TYPICAL UNIT IS 3W-EM5-XR/D POWER. LOCATOR BALLS TO BE INCLUDED IN PULL BOX PRICES.
- EXISTING LIGHTS ARE POWERED BY APS
- CONTRACTOR TO PROVIDE CONDUIT TRENCH, 1 INCH AND 2 1/2 INCH CONDUIT AND INSTALL 2500 LB. RATED MULE TAPE IN CONDUIT. CLOSE TRENCH AFTER CONDUIT/PULL BOX SYSTEM HAS BEEN INSPECTED AND APPROVED BY APS.
- APS TO SUPPLY PULL BOXES (J BOXES) AND INSTALL LIGHTING CONDUCTORS IN CONDUIT. PULL BOX TO PULL BOX, AND IN LIGHT POLES TO LUMINAIRE ALONG WITH THE NECESSARY FUSES FOR THE ROADWAY STREETLIGHT AND PEDESTRIAN LIGHT. APS TO SUPPLY AND INSTALL LIGHT POLES.
- CONTRACTOR TO INSTALL APS FURNISHED GROUND RODS IN EACH APS FURNISHED PULL BOX. GROUT THE PULL BOXES PER APS REQUIREMENTS. GROUND RODS TO BE INCLUDED AS PART OF PULL BOX INSTALLATION.

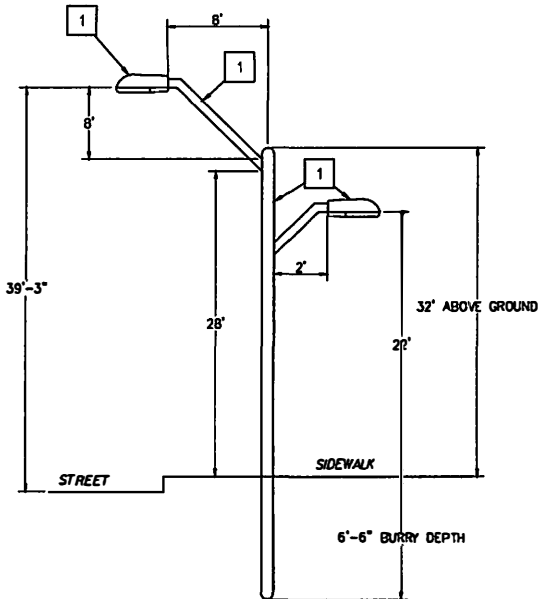

**KEYNOTES: THIS SHEET**

- 1 REFER TO POLE SCHEDULE, LIGHTING MODIFICATION PLAN

Know what's below.  
Call before you dig.



**A COMBINATION POLE DETAIL - APS POLE CODE 1944.38**

HTS

|                                       |               |              |  |
|---------------------------------------|---------------|--------------|--|
|                                       | <b>PSOMAS</b> |              | 255 E NETWORK ROAD<br>SUITE 420<br>SUCTION, AZ 85005<br>520-292-2529 |
|                                       | SCALE: N.T.S. | APPROVED BY: | DRAWN: JV, RC, AP  |
|                                       | DATE: 8/31/23 |              | CLP NO.  |
| SAN LUIS 1 LAND PORT OF ENTRY OFFSITE |               |              |  |
| LIGHTING NOTES                        |               |              | 28 OF 38   |

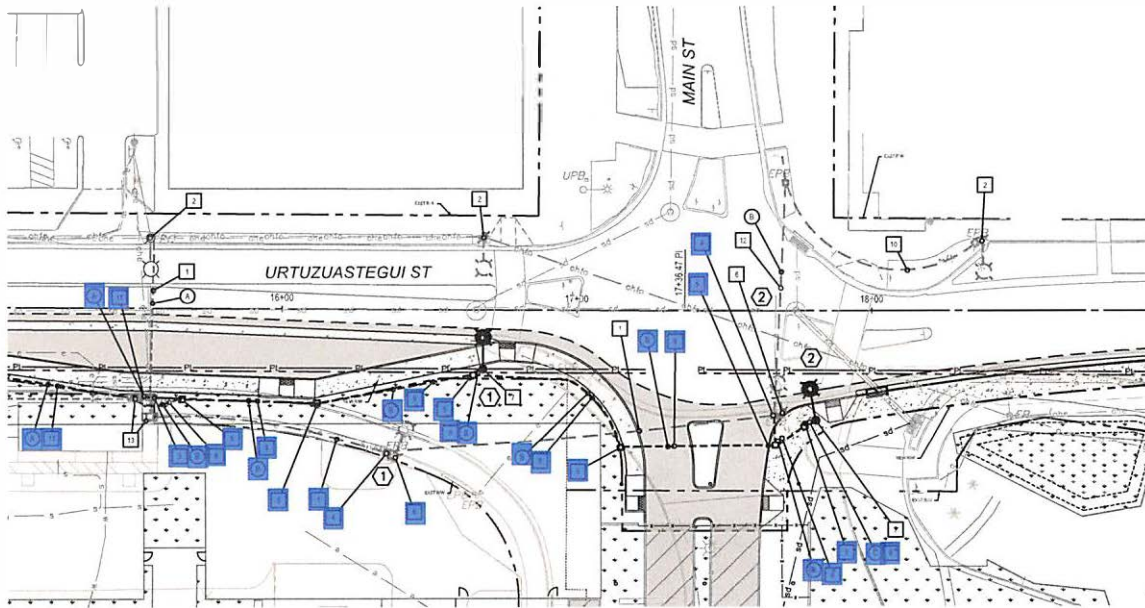

**SHEET NOTES**

**KEYNOTES: THIS SHEET**

- 1 EXISTING ELECTRIC SERVICE CONDUIT RUN NO. 1 FROM APS CONNECTION POINT. 2 1/2 INCH CONDUIT. 3#3 Ø WRES TO REMAIN.
- 2 EXISTING LIGHT AND POLE TO REMAIN.
- 3 EXISTING NO. 5 PULL BOX TO BE RESET.
- 4 EXISTING NO. 5 PULL BOX TO BE REMOVED. NEW 2 1/2 INCH CONDUIT TO CONNECT TO EXISTING CONDUIT.
- 5 NEW NO. 5 PULL BOX TO BE INSTALLED.
- 6 EXISTING DIRECTORY APS ARCHITECTURAL LIGHT POLE TO BE REMOVED.
- 7 NEW DIRECT BURY APS ARCHITECTURAL LIGHT POLE TO BE INSTALLED.
- 8 NEW 2 1/2 INCH CONDUIT INSTALLED BY CONTRACTOR 2 Ø19 ALUMINUM - GROUND INSTALLED BY APS.
- 9 NEW 2 INCH CONDUIT WITH 2 Ø10 ALUMINUM #10 GROUND FROM PULL BOX TO POLE WRES CONTINUE TO BALLAST AND INSTALLED BY CONTRACTOR.
- 10 EXISTING CONDUIT AND CONDUCTORS TO REMAIN IN PLACE.
- 11 NEW 2 1/2 INCH CONDUIT INSTALLED BY CONTRACTOR 3 Ø3 Ø WRES TO RELOCATED SERVICE METER PEDESTAL BY APS.
- 12 EXISTING CONDUIT TO REMAIN IN PLACE. APS TO INSTALL NEW CONDUCTORS BETWEEN PULL BOXES.
- 13 SEE TRAFFIC SIGNAL PLANS FOR NOTES ON RELOCATED SERVICE METER PEDESTAL.

**POLE SCHEDULE - STREET LIGHTING SYSTEM**

| ADOT NUMBER | LOAD CENTER | CIRCUIT NUMBER | POLE NO. | CONSTRUCTION CENTERLINE | STATION NO. | OFFSET FROM CENTERLINE | POLE HEIGHT | LAMP     | LAMP QUANTITY | POLE TYPE | MAST ARM                 | LUMINAIRE ORIENTATION | REMARKS      | NOTES         |
|-------------|-------------|----------------|----------|-------------------------|-------------|------------------------|-------------|----------|---------------|-----------|--------------------------|-----------------------|--------------|---------------|
|             | EXISTING    |                | 1        | Urtuzuastegui Street    | 16+64.3     | 18.4' RT               | 32 FT       | 160 / 25 | 2             | APS 1944  | 8 FT HI-RISE 2' MID-POLE | STREET / SW           | APS SUPPLIED | 1, 2, 3, 4, 5 |
|             | EXISTING    |                | 2        | Urtuzuastegui Street    | 17+81.0     | 37.4' RT               | 32 FT       | 160 / 25 | 2             | APS 1944  | 8 FT HI-RISE 2' MID-POLE | STREET / SW           | APS SUPPLIED | 1, 2, 3, 4, 5 |

**CONDUIT AND CONDUCTOR SCHEDULE**

| AWG     | CONDUIT RUN LETTER | CONDUIT SIZE IN INCHES |     |   |     |   |   |
|---------|--------------------|------------------------|-----|---|-----|---|---|
|         |                    | A                      | B   | C | D   | E | F |
| #3/0    | ALUMINUM - BY APS  | 2                      | 1/2 | 2 | 1/2 | 1 |   |
| #1/0    | ALUMINUM - BY APS  |                        |     | 2 |     |   |   |
| #8 GND  |                    | 1                      | 1   |   |     |   |   |
| #10     | COPPER, BLACK      |                        |     |   | 4   |   |   |
| #10 GND | COPPER, BARE       |                        |     |   |     | 1 |   |
| Notes:  |                    |                        | 2   | 3 |     |   |   |

**CONDUIT AND CONDUCTOR SCHEDULE NOTES**

- 1. All conduit is new and supplied and installed by the contractor.
- 2. Conductors supplied and installed by APS.
- 3. Wires to the light fixtures installed by APS.

**POLE SCHEDULE NOTES**

- 1. New poles supplied and installed by APS.
- 2. 8 foot mast arm faces street side full cut-off.
- 3. 2 foot mast arm faces sidewalk side full cut-off.
- 4. APS Light Code CL54, 160 W LED, Type II Distribution for street.
- 5. APS Light Code CL50, 26 W LED, Type II Distribution 3000K, 3,400 Initial Lumens for sidewalk.

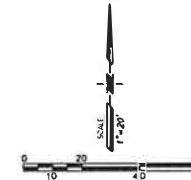

**LEGEND**

- CONCRETE PAVEMENT PER PAVING PLAN, SHEETS C1121-SP THROUGH C125-S. CONCRETE SIDEWALK PER COV NO. 3-135.
- AC PAVEMENT PER PAVING PLAN, SHEETS C1121-SP THROUGH C125-SP.
- FOG SEAL EXISTING PAVEMENT.
- UTILITY EASEMENT LINE
- PROPERTY LINE

Know what's below. Call before you dig.



**PSOMAS** SAN LUIS LAND PORT OF ENTRY

SCALE: 1" = 20' DATE: 8/31/23 DRAWN: JV, RC, AP C.I.P. NO. LIGHTING MODIFICATION PLAN 30 OF 38

Project: 6/17/2023 7:54:30 PM 11. Server: 6/17/2023 11:13:04 PM 13. S:\CADD\2023\11\1125-SP\1125-SP.dwg 14. User: jv

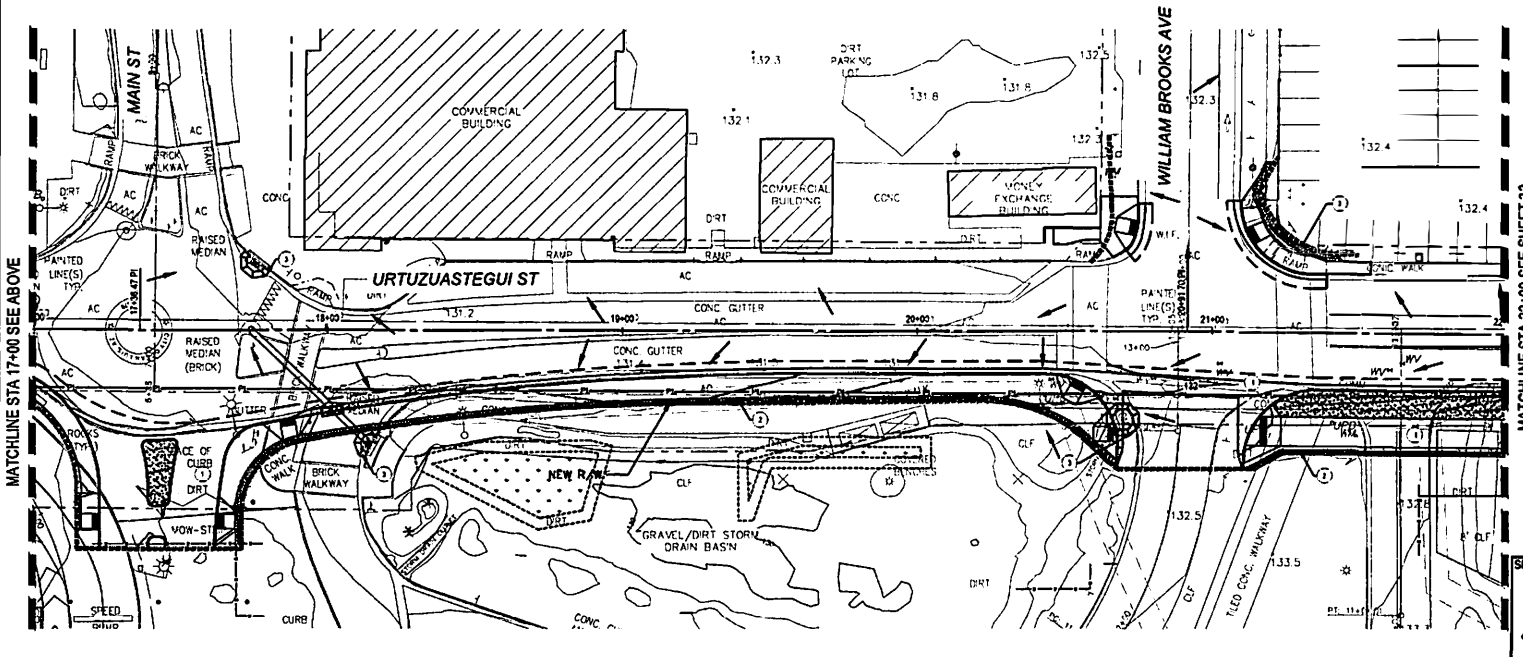
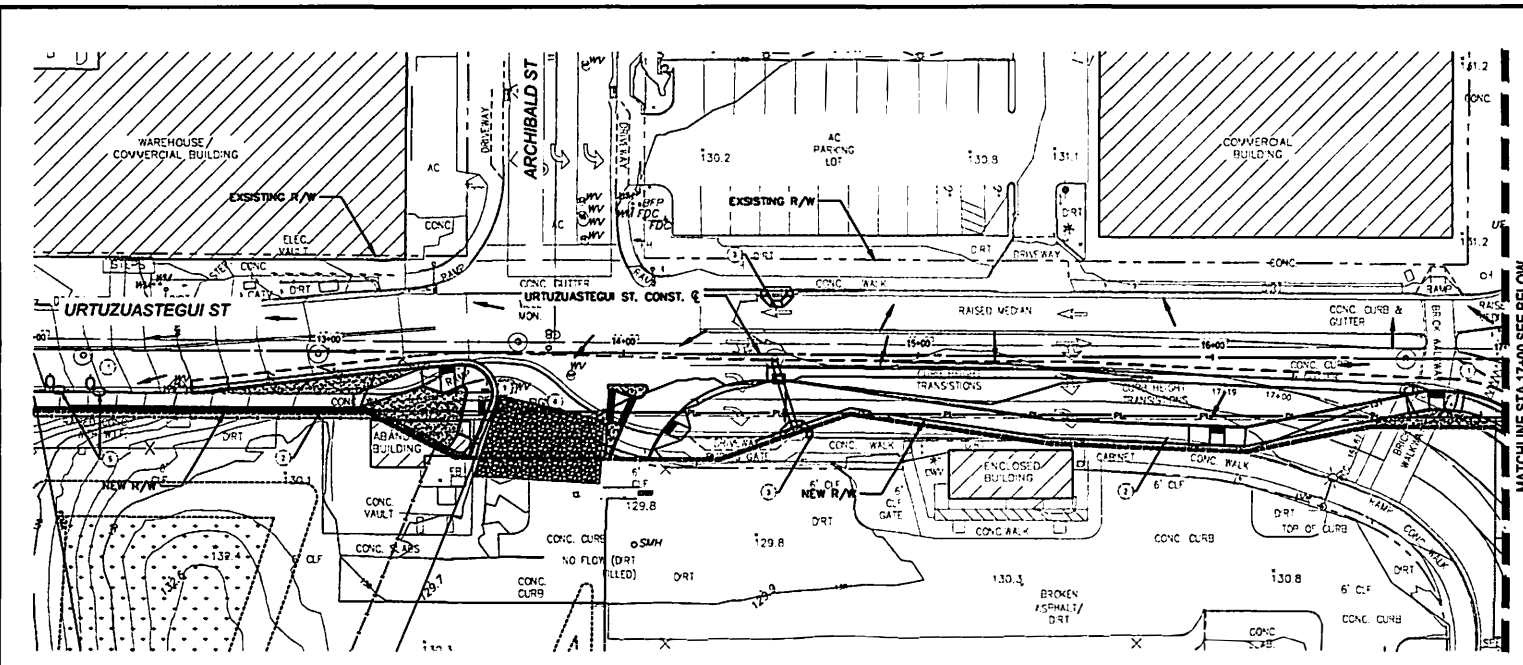

**SHEET NOTES**

- ① SWEEP STREETS DAILY AT POINTS OF INGRESS AND EGRESS ACROSS PROJECT EXTENTS
  - ② INSTALL FIBER ROLL BARRIER
  - ③ INSTALL BASIN AND STEEL GRATE PROTECTION
  - ④ INSTALL CONSTRUCTION TRACK-OUT CONTROLS (STABILIZED CONSTRUCTION ENTRANCE)
  - ⑤ INSTALL SANDBAG CHECK DAMS
1. REFER TO THE LATEST EDITION OF THE UNITED STATES ENVIRONMENTAL PROTECTION AGENCY (EPA) STORMWATER BEST MANAGEMENT PRACTICE FOR THE BMP OUTLINED ON THIS PLAN.
  2. INSTALL INLET PROTECTION ON ALL EXISTING INLETS PRIOR TO DEMOLITION.
  3. THE LOCATION AND PROTECTION OF ALL UTILITIES IS RESPONSIBILITY OF THE CONTRACTOR.
  4. DISTURBANCE LIMIT IS APPROX. 1 ACRE
  5. IMPROVEMENTS SOUTH OF WAY ARE PER SEPARATE ON-SITE PLANS.

MATCHLINE STA 17+00 SEE BELOW

MATCHLINE STA 22+00 SEE SHEET 32

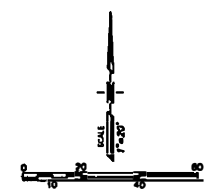

Know what's below.  
Call before you dig.



**LEGEND**

- SLOPE ARROW
- NEW CONTOUR
- - - EXISTING CONTOUR
- - - EXISTING NEW R/W
- - - OFFSITE EROSION CONTROL LIMIT
- FIBER ROLL BARRIER
- INLET PROTECTION
- CONSTRUCTION TRACK OUT CONTROLS



**PSOMAS**  
 333 F. WETMORE ROAD  
 SUITE 400  
 RAYNES, CA 95070  
 (925) 722-2222

SCALE: 1"=20'  
 DATE: 8/31/23  
 APPROVED BY: \_\_\_\_\_  
 DRAWN: JV, RC, AP  
 C.I.P. NO. \_\_\_\_\_

SAN LUIS I LAND PORT OF ENTRY OFFSITE  
 EROSION CONTROL PLAN | 31 OF 38

MATCHLINE STA 17+00 SEE ABOVE

## SHEET NOTES

- ① SWEEP STREETS DAILY AT POINTS OF INGRESS AND EGRESS ACROSS PROJECT EXTENTS
  - ② INSTALL FIBER ROLL BARRIER.
  - ③ INSTALL BASIN AND STEEL GRATE PROTECTION.
  - ④ INSTALL CONSTRUCTED TRACK-OUT CONTROLS (STABILIZED CONSTRUCTION ENTRANCE).
  - ⑤ INSTALL SANDBAG CHECK DAMS.
1. REFER TO THE LATEST EDITION OF THE UNITED STATES ENVIRONMENTAL PROTECTION AGENCY (EPA) STORMWATER BEST MANAGEMENT PRACTICE FOR THE BMP OUTLINED ON THIS PLAN.
  2. INSTALL INLET PROTECTION ON ALL EXISTING INLETS PRIOR TO DEMOLITION.
  3. THE LOCATION AND PROTECTION OF ALL UTILITIES IS RESPONSIBILITY OF THE CONTRACTOR.
  4. DISTURBANCE LIMIT IS APPROX. 1 ACRE
  5. IMPROVEMENTS SOUTH OF RIGHT OF WAY ARE PER SEPARATE ONSITE PLANS.

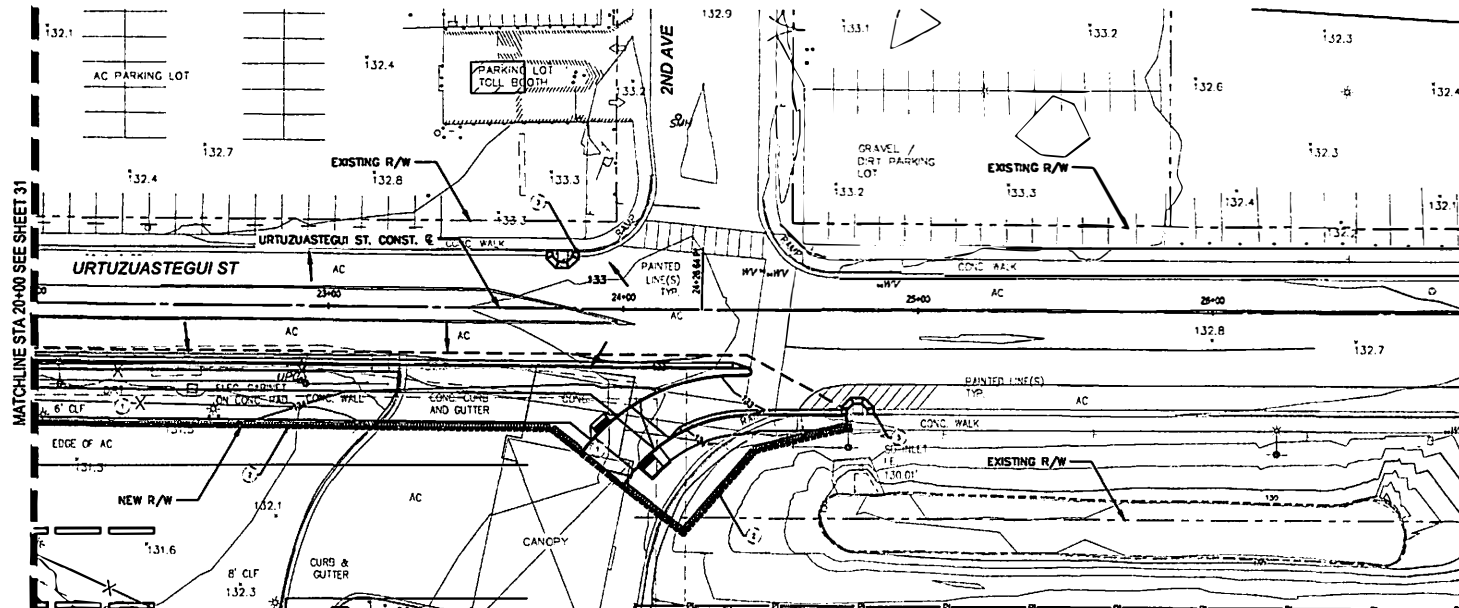

## LEGEND

- ← SLOPE ARROW
- 500 — NEW CONTOUR
- +X— EXISTING CONTOUR
- EXISTING NEW R/W
- OFFSITE EROSION CONTROL LIMIT
- FIBER ROLL BARRIER
- ⊗ INLET PROTECTION
- ▭ CONSTRUCT TRACK OUT CONTROLS



**PSOMAS**  
 233 F. WENIGER ROAD  
 SUITE 402  
 RICHMOND, CA 94804  
 925.982.2500

SCALE: 1"=20'  
 DATE: 8/31/23  
 APPROVED BY: [Signature]  
 DRAWN BY: RC, AP  
 C.I.P. NO.

SAN LUIS I LAND PORT OF ENTRY OFFSITE  
 EROSION CONTROL PLAN 32 of 38

Project: 07/2023 100330 Rev. 11; Revised: 07/2023 08/08/23 Rev. 11; 8/31/2023; San Luis I Land Port of Entry Offsite Erosion Control Plan; Sheet 32 of 38

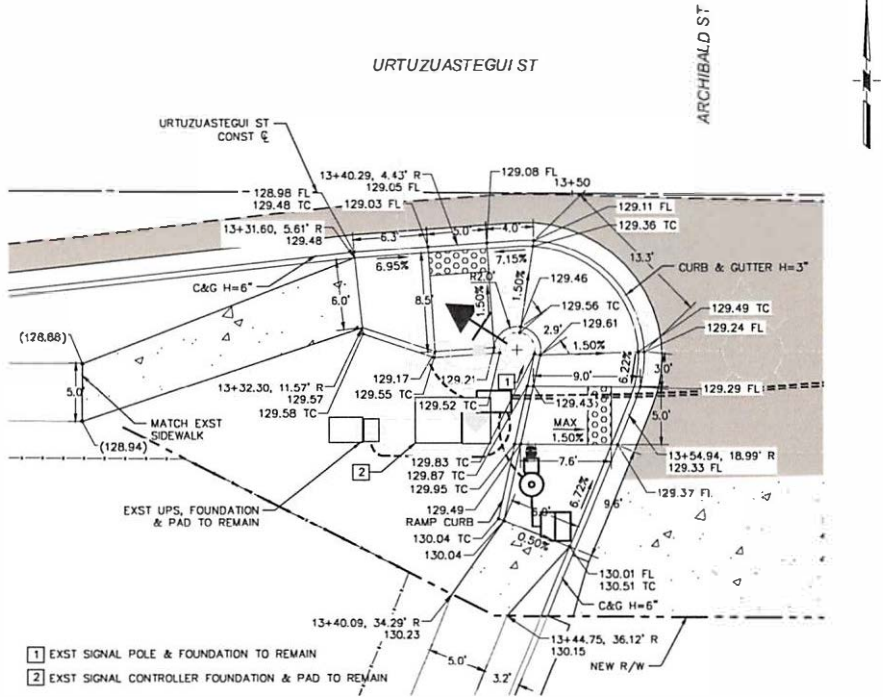

- 1 EXST SIGNAL POLE & FOUNDATION TO REMAIN
- 2 EXST SIGNAL CONTROLLER FOUNDATION & PAD TO REMAIN

**81** DIRECTIONAL CURB RAMP  
3" CURB AND GUTTER

(xxx.xx) EXISTING ELEVATION  
xxx.xx PROPOSED ELEVATION

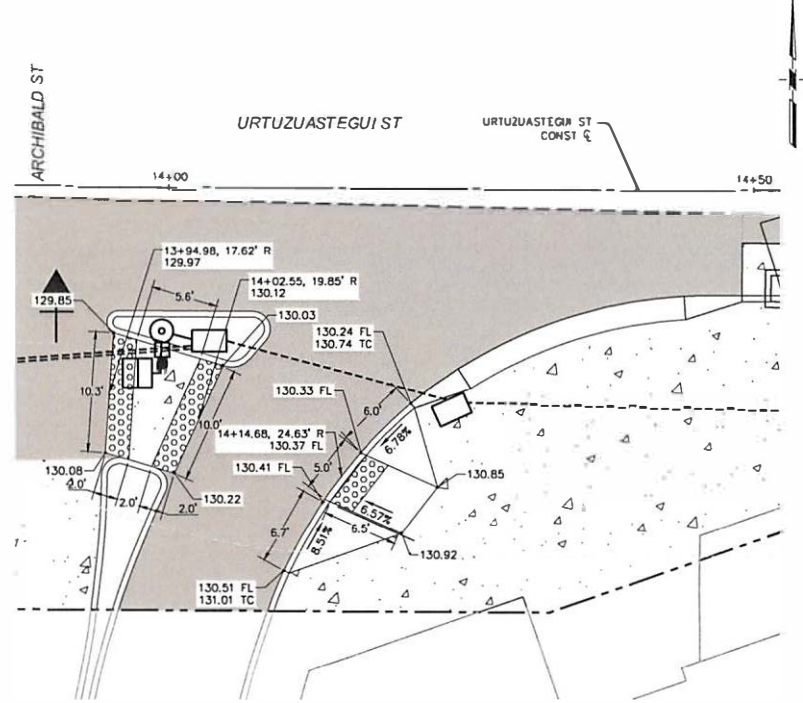

**82** RADIAL CURB RAMP ATTACHED  
SIDEWALK PER MAG STD DTL 236-1

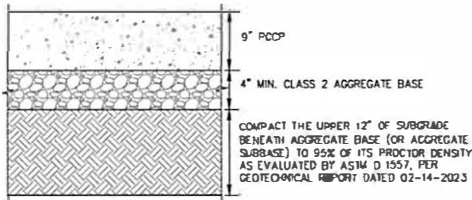

**A1** CONCRETE PAVEMENT (RIGID)  
12/13 N.T.S.

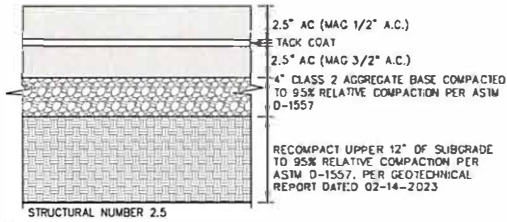

**A2** ASPHALT PAVEMENT (FLEXIBLE) FOR  
URTUZUASTEGUI ST  
N.T.S.

Know what's below.  
Call before you dig.



**PSOMAS** 213 E NETWORK ROAD, SUITE 400, RUSCON, AZ 85705, 520.792.3300

|                                       |              |                   |
|---------------------------------------|--------------|-------------------|
| SCALE: N.T.S.                         | APPROVED BY: | DRAWN: JV, RC, AP |
| DATE: 8/31/23                         |              | C.I.P. NO.        |
| SAN LUIS I LAND PORT OF ENTRY OFFSITE |              |                   |
| DETAILS                               |              | 33 OF 38          |





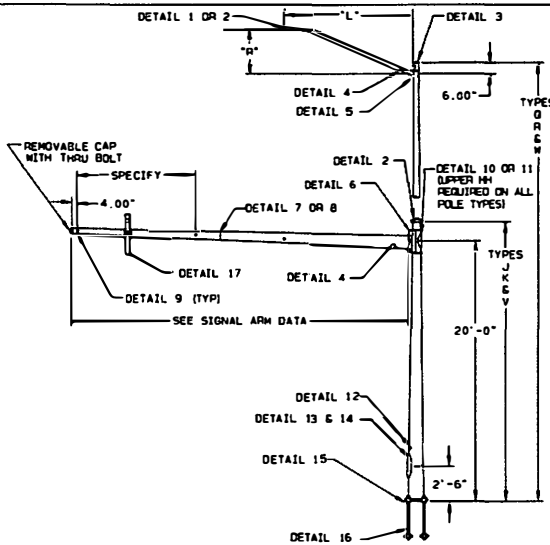

THE MAST ARM TRAFFIC STRUCTURES SHOWN ON THIS DRAWING HAVE BEEN DESIGNED IN ACCORDANCE WITH THE LOADING AND THE ALLOWABLE STRESS REQUIREMENTS OF THE 2013 AASHTO STANDARD SPECIFICATIONS FOR STRUCTURAL SUPPORTS FOR HIGHWAY SIGNS, LUMINAIRE AND TRAFFIC SIGNALS, SIXTH EDITION, L15-6. THE WIND LOADS WERE CALCULATED FROM A BASIC WIND VELOCITY OF 90 MPH WITH A RECURRENCE INTERVAL OF 50 YEARS, AND A FATIGUE CATEGORY OF 2. THE FATIGUE LOADS WERE CALCULATED ON THE REQUIREMENTS OF SECTION 11 OF THE CODE, AND THE FOLLOWING DESIGN CONDITIONS:

- STRUCTURES ARE DESIGNED TO RESIST NATURAL WIND GUSTS BASED ON THE YEARLY MEAN WIND VELOCITY OF 11.2 MPH.
- STRUCTURES ARE NOT DESIGNED TO RESIST GALLOPING-INDUCED CYCLIC LOADS.
- STRUCTURES ARE DESIGNED FOR TRUCK-INDUCED GUST LOADS, AS REQUIRED BY THE OWNER OF THE STRUCTURES.
- THE WIND LOADS WERE CALCULATED FROM A BASIC WIND VELOCITY OF 90 MPH WITH A RECURRENCE INTERVAL OF 50 YEARS, DESIGN BASED ON FATIGUE CATEGORY 1 WITHOUT VIBRATION MITIGATION DEVICE OR FATIGUE CATEGORY 2 WITH INDEPENDENTLY TESTED VIBRATION MITIGATION DEVICE THAT IS GREATER THAN 85% EFFECTIVE OVER ENTIRE RANGE OF STRUCTURES.
- THE VIBRATION MITIGATION DEVICE SHALL BE AN ACTIVE, NON-AERODYNAMIC VIBRATION DAMPER SYSTEM TO EFFECTIVELY MITIGATE THE VERTICAL MOVEMENT UNDER FATIGUE LOADS. THE POLE MANUFACTURER WILL BE REQUIRED TO SUBMIT ALL THE NECESSARY DOCUMENTATION AND INDEPENDENT 3RD PARTY TESTING OF THE DEVICE TO PROVE THE DEVICE EFFECTIVENESS. THE DEVICE SHOULD BE ROBUST TO DAMPENING LARGE DISPLACEMENTS AND SMALL DISPLACEMENTS AND BE SELF-ADAPTING, NOT REQUIRE STRUCTURE-SPECIFIC TUNING. THE MITIGATION DEVICE SHALL BE TESTED TO WITHSTAND OVER 17 MILLION LARGE AMPLITUDE CYCLES WITH NO DETEIORATION OF THE DAMPENING PERFORMANCE

AASHTO 2013 SPECIFICATIONS

| MATERIAL DATA                  |                    |                  |
|--------------------------------|--------------------|------------------|
| COMPONENT                      | ASTM DESIGNATION   | MIN. YIELD (KSI) |
| TAPERED TUBES                  | A595 GR. A OR A572 | 55               |
| BASE PLATE                     | A36                | 36               |
| ARM SIMPLEX PLATES             | A36                | 36               |
| SIGNAL ARM CONNECTING BOLTS    | F3125 GR. A325     |                  |
| LUMINAIRE ARM CONNECTING BOLTS | F3125 GR. A325     |                  |
| ANCHOR BOLTS                   | F1554 GR. 55       | 55               |
| ANCHOR BOLT NUTS               | A563 GR. D1        |                  |
| ANCHOR BOLT WASHERS            | F436               |                  |
| GALVANIZING-HARDWARE           | F2329              |                  |

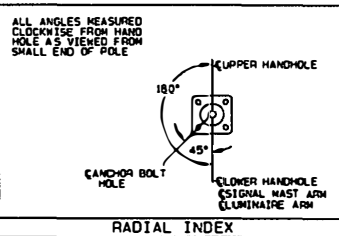

| SIGNAL ARM DATA |      |                   |                     |                     |                     |                     |                            |
|-----------------|------|-------------------|---------------------|---------------------|---------------------|---------------------|----------------------------|
| TYPE            | QTY. | ARM SPAN "L" (FT) | LARGE END DIA. (IN) | SMALL END DIA. (IN) | GAUGE OR THICK (IN) | SECTION LENGTH (FT) | ARM PLATE CENTER HOLE (IN) |
| J & Q           |      | 20                | 9.00                | 6.20                | 7                   | 20                  | 7.00                       |
|                 |      | 25                | 9.00                | 5.50                | 7                   | 25                  | 7.00                       |
|                 |      | 30                | 10.00               | 5.80                | 7                   | 30                  | 7.00                       |
|                 |      | 35                | 10.50               | 5.60                | 7                   | 35                  | 8.00                       |
|                 |      | 40                | 11.00               | 5.40                | 7                   | 40                  | 8.00                       |
| K & R           |      | 45                | 12.50               | 6.20                | 5                   | 45                  | 8.00                       |
|                 |      | 50                | 12.50               | 5.50                | 5                   | 50                  | 8.00                       |
|                 |      | 55                | 12.50               | 6.62                | 3                   | 42.00               | 7.00                       |
| V & W           |      |                   | 6.50                | 4.67                | 7                   | 13.00               |                            |
|                 |      | 60                | 13.50               | 10.79               | 0.250               | 19.35               | 7.00                       |
|                 |      |                   | 11.50               | 5.45                | 7                   | 43.24               |                            |
|                 |      | 65                | 13.50               | 10.79               | 0.250               | 19.35               | 7.00                       |
|                 |      |                   | 11.50               | 4.75                | 7                   | 48.25               |                            |

| LUMINAIRE ARM DATA |                   |                     |                    |       |               |
|--------------------|-------------------|---------------------|--------------------|-------|---------------|
| QTY.               | ARM SPAN "L" (FT) | FIXED END DIA. (IN) | FREE END DIA. (IN) | GAUGE | RISE "R" (FT) |
|                    | 6.00              | 3.31                | 2.40               | 11    | 2.00          |
|                    | 8.00              | 3.61                | 2.40               | 11    | 2.50          |
|                    | 10.00             | 3.93                | 2.40               | 11    | 3.33          |
|                    | 12.00             | 4.23                | 2.40               | 11    | 4.25          |
|                    | 15.00             | 4.65                | 2.40               | 11    | 4.75          |
|                    | 18.00             | 5.10                | 2.40               | 11    | 5.75          |
|                    | 20.00             | 5.90                | 3.00               | 7     | 5.75          |

POLE, BASE PLATE, ANCHOR BOLT DATA

| QTY. | POLE TYPE | POLE TUBE   |                |               |             | POLE BASE       |                      |                       |               |                         | ANCHOR BOLT |             |                                 |
|------|-----------|-------------|----------------|---------------|-------------|-----------------|----------------------|-----------------------|---------------|-------------------------|-------------|-------------|---------------------------------|
|      |           | LENGTH (FT) | BASE DIA. (IN) | TOP DIA. (IN) | WALL GA/THK | SQUARE "B" (IN) | BOLY CIRCLE "C" (IN) | CENTER HOLE DIA. (IN) | THK. "D" (IN) | SLOT/HOLE SIZE "Z" (IN) | DIA. (IN)   | LENGTH (IN) | PLATE SIZE "e" x "f" x "g" (IN) |
|      | J         | 21.25       | 15.50          | 12.53         | 0.250       | 22.00           | 21.00                | 10.00                 | 2.00          | 2.25 x 2.75             | 2.00        | 70 00       | 1.50 x 5.50 x 5.50              |
|      | K         | 21.25       | 15.50          | 12.53         | 0.250       | 22.00           | 21.00                | 10.00                 | 2.00          | 2.25 x 2.75             | 2.00        | 70 00       | 1.50 x 5.50 x 5.50              |
|      | Q         | 30.00       | 15.50          | 11.30         | 0.250       | 22.00           | 21.00                | 10.00                 | 2.00          | 2.25 x 2.75             | 2.00        | 70 00       | 1.50 x 5.50 x 5.50              |
|      | R         | 30.00       | 15.50          | 11.30         | 0.250       | 22.00           | 21.00                | 10.00                 | 2.00          | 2.25 x 2.75             | 2.00        | 70 00       | 1.50 x 5.50 x 5.50              |
|      | V         | 21.25       | 16.00          | 13.03         | 0.250       | 23.00           | 22.00                | 11.50                 | 2.00          | 2.25                    | 2.00        | 70 00       | 1.50 x 5.50 x 5.50              |
|      | W         | 30.00       | 16.00          | 11.80         | 0.250       | 23.00           | 22.00                | 11.50                 | 2.00          | 2.25                    | 2.00        | 70 00       | 1.50 x 5.50 x 5.50              |



Digitally signed by Stephen R Osborn  
Date: 2023-05-09 16:17:05:00

| REV  | DATE     | BY   | DESCRIPTION |
|------|----------|------|-------------|
| RBC2 | 05/02/23 | RBC2 | 05/02/23    |

TITLE CITY OF BOONVILLE  
TYPE J, K, Q, R, V & W POLES  
TRAFFIC SIGNAL STRUCTURES

VALMONT INDUSTRIES, INC. RESERVES THE RIGHT TO INSTALL VARIOUS ENGINEER APPROVED MATERIAL HANGING ACCOMMODATIONS TO FACILITATE THE MANUFACTURING PROCESS.

**valmont**  
valley, NE 68064  
(402) 359-2201

|                |         |    |   |
|----------------|---------|----|---|
| PROJECT NUMBER | 1       | OF | 5 |
| DRAWING NUMBER | DB01403 |    |   |

FOR REFERENCE ONLY DETAILS

Know what's below. Call before you dig.



**PSOMAS**  
SCALE: N.T.S. APPROVED BY: DRAWN: J.V. RC, AP  
DATE: 8/31/23  
SAN LUIS I LAND PORT OF ENTRY OFFSITE  
DETAILS 36 OF 38

8/27/2023 10:27 PM: 11: Revise - 8/27/2023 10:28:02 AM: 11: B. MARSHALL - San Luis I Land Port of Entry Offsite Traffic Signal Structures 11.dwg



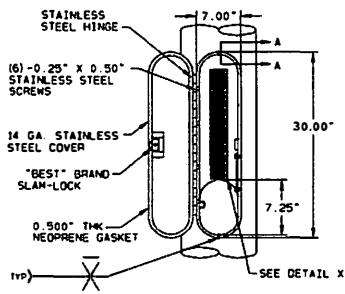
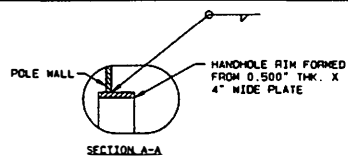

DETAIL 13 | TERMINAL COMPARTMENT W/HINGED COVER

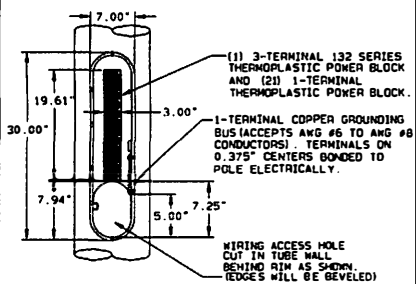

DETAIL 14 | TERMINAL BLOCKS

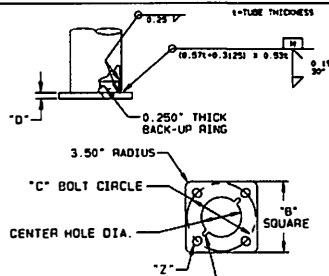

DUE TO MANUFACTURING CRITERIA, BASEPLATES MAY HAVE SLOTS FOR GALVANIZING DRAINAGE

DETAIL 15 | POLE BASE

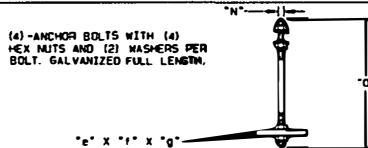

DETAIL 16 | ANCHOR BOLT

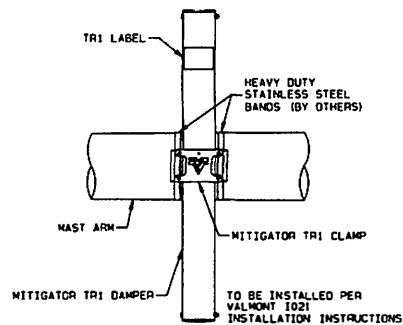

DETAIL 17 | TRI MITIGATOR

TITLE  
CITY OF GOODYEAR  
TYPE J, K, Q, R, V & W POLES  
TRAFFIC SIGNAL STRUCTURES

VALMONT INDUSTRIES, INC. RESERVES THE RIGHT TO INSTALL VARIOUS, ENGINEER APPROVED, MATERIAL HANGING ACCOMMODATIONS TO FACILITATE THE MANUFACTURING PROCESS.

**valmont**  
Valley, NE 68064  
(402) 359-2201

PAGE NUMBER 4 OF 5  
DRAWING NUMBER DB01403  
REV

FOR REFERENCE ONLY DETAILS

Keep what's below.  
Call before you clip.



SCALE: N.T.S. APPROVED BY: DRAWN: J.V. RC, AP  
DATE: 8/31/23 C.L.P. NO.  
SAN LUIS I LAND PORT OF ENTRY OFFSITE  
DETAILS 38 OF 38

333 E. WENMORE ROAD  
SUITE 400  
SAN LUIS, MO 63103  
573.282.2500