

City of San Luis
Finance Wing Reconfiguration Project
BID PROPOSAL
Bid Submittal Form

Bid Schedule

Section 1: Addition of 3 Enclosed Offices					
Bid Item	Item Description	Estimated Quantities	Unit	Unit Price	Total
1	Labor: Demolition of existing walls, preparation of surfaces, and installation of new improvements.	1	Lump Sum		19,000.00
2	All materials and equipment	1	Lump Sum		17,000.00
3	Taxes and Fees	1	Lump Sum		6,800.00
Subtotal					42,800.00
5% Contingency					2,140.00
Total					44,940.00

Section 2: Expansion of Conference Room					
Bid Item	Item Description	Estimated Quantities	Unit	Unit Price	Total
1	Labor: Demolition of existing walls, preparation of surfaces, and installation of new improvements.	1	Lump Sum		5,778.12
2	All materials and equipment	1	Lump Sum		3,500.00
3	Taxes and Fees	1	Lump Sum		3,000.00
Subtotal					12,278.12
5% Contingency					613.90
Total					12,892.02

Section 3: Addition of Restroom					
Bid Item	Item Description	Estimated Quantities	Unit	Unit Price	Total
1	Labor: Demolition of existing walls, preparation of surfaces, and installation of new improvements.	1	Lump Sum		18,000.00
2	All materials and equipment	1	Lump Sum		17,000.00
3	Taxes and Fees	1	Lump Sum		6,000.00
Subtotal					41,000.00
5% Contingency					2,050.00
Total					43,050.00

GRAND

TOTAL

100,882.02

(Bidder understands that City reserves the right to award a Contract for each section separately and may award a contract for one, two, or all sections in its discretion and may award different Sections to different Bidders.)

THIS PROPOSAL IS SUBMITTED BY DWD CONSTRUCTION

A corporation organized under the laws of the State of _____,

or a partnership consisting of _____,

or individual trading as DWD CONSTRUCTION

of the City of YUMA, AZ (City, State) and is the holder of Arizona State Contractor's license(s): ROC 248137 (type) Classification KB-01 License No. 248137.

The bidder hereby certifies that as of the below date, the bond amount posted with the Arizona Registrar of Contractors is \$ 24,000 and the Bidder's actual volume of work has not exceeded the contemplated gross volume pursuant to Arizona Administrative Code, Title 4 Chapter 9 [Authority: ARS 32-1101 et seq.]

Respectfully submitted,

Bidders Firm DWD CONSTRUCTION

Address 13461 S. Avenue B

City, State, ZIP Yuma AZ 85365

By [Signature] 3/6/24
[Signature] [Date]

Name SHANE DARNELL

Title MANAGER

ATTEST:
[If Bidder is an individual]

Witness: [Signature] 3/6/24
[Signature] [Date]

ESTIMATE

DWD construction
13461 S AVE B
Yuma, AZ 85365

SHANE.DWDCONSTRUCTION@OU
TLOOK.COM
+1 (928) 581-1011

WEST WING

Bill to
WEST WING

Ship to
WEST WING

Estimate details

Estimate no.: 1355
Estimate date: 03/05/2024

#	Date	Product or service	SKU	Qty	Rate	Amount
1.		1000 DEMO		1	\$3,570.00	\$3,570.00
2.		1000 FRAMING		1	\$8,840.00	\$8,840.00
3.		1000 DRYWALL TAPE AND TEXTURE		1	\$6,500.00	\$6,500.00
4.		1000 T-BAR		1	\$3,750.00	\$3,750.00
5.		1000 ELECTRICAL		1	\$11,500.00	\$11,500.00
6.		1000 INSULATION		1	\$2,100.00	\$2,100.00
7.		1000 HVAC		1	\$5,128.00	\$5,128.00
8.		1000 PLUMBING		1	\$7,800.00	\$7,800.00
9.		1000 DOORS AND WINDOWS		1	\$14,300.00	\$14,300.00
10.		1000 TILE AND FLOORING		1	\$5,750.00	\$5,750.00

11.	1000 PAINT	1	\$4,880.00	\$4,880.00
12.	101 PROFIT AND OVER HEAD	1	\$22,235.40	\$22,235.40
13.	SUB FOR PROJECT CONFIGURATION AIR/HVAC DESERT INSULATION LLC/ INSULATION NU-WAVE INNOVATIONSLLC/ ELECTRICAL DESERT DOORS/ DOORS SUPREME PLUMBING/ PLUMBING			\$0.00

Subtotal \$96,353.40

Sales tax \$4,528.62

Total \$100,882.02

STATUTORY PROPOSAL BOND
PURSUANT TO TITLE 34, CHAPTER 2, ARTICLE 1
OF THE ARIZONA REVISED STATUTES (Penalty of this bond must not be
less than 100% of the Proposal amount)

KNOW ALL MEN BY THESE PRESENTS:

That _____ we, DWD Construction (hereinafter referred to as "Principal") as Principal, and Philadelphia Indemnity Insurance Company (hereinafter called the Surety) a corporation organized and existing under the laws of the State of Pennsylvania with its principal offices in the County of _____, as Surety, are held and firmly bound unto Yuma County (hereinafter "Obligee") in the amount of Dollars (\$100882.02) for the payment whereof, the said Principal and Surety bind themselves, and their heirs, administrators, successors and assigns, jointly and severally, firmly by these presents.

WHEREAS, the said Principal has submitted a Proposal for: CITY OF SAN LUIS FINANCE WING RECONFIGURATION PROJECT AT SAN LUIS CITY HALL

NOW, THEREFORE, if the Obligee shall accept the proposal of the Principal and the Principal shall enter into a contract with the Obligee in accordance with the terms of the proposal and give the Bonds and Certificates of Insurance as specified in the Standard Specifications with good and sufficient Surety for the faithful performance of the Contract and for the prompt payment of labor and material furnished in the prosecution of the contract, or in the event of the failure of the Principal to enter into such contract and give the Bonds and Certificates of Insurance, if the Principal pays to the Obligee the difference not to exceed the penalty of the bond between the amount specified in the Proposal and such larger amount for which the Obligee may in good faith contract with another party to perform the work covered by the Proposal, then this obligation is void. Otherwise, it remains in full force and effect provided, however, that this bond is executed pursuant to the provisions of Section 34-201, Arizona Revised Statutes, and all liabilities on this bond shall be determined in accordance with the provisions of the section to the extent as if it were copied at length herein.

Witness our hands this 5th day of MARCH, 20 24 .

PRINCIPAL SEAL

By: _____

SURETY SEAL

AGENCY OF RECORD



FAITHFUL PERFORMANCE BOND

Whereas, CITY OF SAN LUIS , State of ARIZONA, and DWD CONSTRUCTION (hereinafter designated as Principal") have entered into an agreement whereby principal agrees to install and complete certain designated public improvements, which said agreement, dated, 3/5/2024 , and identified as project WHEREA, CITY OF SAN LUIS FINANCE WING RECONFIGURATION PROJECT AT SAN LUIS CITY HALL , is hereby referred to and made a part hereof; and

Whereas, said Principal is required under the terms of said agreement to furnish a bond for the faithful performance of said agreement.

Now, therefore, we, the Principal and PHILADELPHIA INDEMNITY INSURANCE COMPANY, as surety, are held and firmly bound unto the CITY OF SAN LUIS WEST WING(hereinafter called ("City")), in the penal sum of. (\$ 100,882.02) lawful money of the United States, for the payment of which sum well and truly to be made, we bind ourselves, our heirs, successors, executors and administrators, jointly and severally, firmly by these presents.

The condition of this obligation is such that if the above-bounded Principal, his or its heirs, executors, administrators, successors or assigns, shall in all things stand to and abide by, and well and truly keep and perform the covenants, conditions and provisions in the said agreement and any alteration thereof made as therein provided, on his or their part, to be kept and performed at the time and in the manner therein specified, and in all respects according to their true intent and meaning, and shall indemnify and save harmless CITY OF SAN LUYIS WEST WING, its officers, agents and employees, as therein stipulated, then this obligation shall become null and void; otherwise it shall be and remain in full force and effect.

As a part of the obligation secured hereby and in addition to the face amount specified therefor, there shall be included costs and reasonable expenses and fees, including reasonable attorney's fees, incurred City in successfully enforcing such obligation, all to be taxed as costs and included in any judgment rendered.

The surety hereby stipulates and agrees that no change, extension of time, alteration or addition to the terms of the agreement or to the work to be performed thereunder or the specifications accompanying the same shall in anywise affect its obligations on this bond, and it does hereby waive notice of any such change, extension of time, alteration or addition to the terms of the agreement or to the work or to the specifications.

In witness whereof, this instrument has been duly executed by the principal and surety above named, on

5th day of MARCH, 20 24.

PRINCIPAL SEAL

By: _____

SURETY SEAL

AGENCY OF RECORD



ENGINEERING CONSULTANTS SECTION
NON-COLLUSION AFFIDAVIT

Project Name: Finance wing Reconfiguration
Project No. _____

NON-COLLUSION AFFIDAVIT

State of Arizona)) ss
County of _____)

DWD construction / Shane Darnell
(Affiant)

the manager
(Title)

of DWD construction
(Contractor)

the persons, corporation, or company who makes the accompanying Proposal, having first been duly sworn, deposes and says:

That such Proposal is genuine and not sham or collusive, nor made in the interest or behalf of any person not herein named, and that the Bidder has not directly or indirectly induced or solicited any other Bidder to put in a sham bid, or any other person, firm, or corporation to refrain from bidding, and that the Bidder has not in any manner sought by collusion to secure for itself an advantage over any other Bidder.

[Signature]
(Signature)

manager
(Title)

Subscribed and sworn to before me this

March Day of 5, 2020
[Signature]

Signature of Notary Public in and for

the County of Yuma



Yuma Carpets
aarons@yumacarpets.com
(928)-328-1045

Supreme Plumbing Solutions
supremeplumbingsolutions@outlook.com
(928)-920-5683

Nu-Wave Innovations LLC
Work Phone: (928) 580-4066
Work Email: josh@nu-waveinnovations.com

Lighthouse Painting
lhousepaint@aol.com
(928)-627-5871

Configuration Air LLC
o.configurationair@gmail.com
(928)-726-9886

Desert Insulation LLC
desertinsulationllc@gmail.com
(928) 941-2272

Desert Door & Building Supply
sales@desertbuilding.com
(928)783-8333

Carlson Glass Inc
jeff@carlsonglass.com
(520)661-6866

Benji Drywall LLC
benjidrywall_llc@hotmail.com
(928)446-0608



City of San Luis

Department of Facilities

CITY OF SAN LUIS

FINANCE WING RECONFIGURATION PROJECT AT CITY HALL

Bid Addendum #1

This Addendum Changes/Updates the following:

Date Issued: 2/22/24

To: **All prospective bidders**

Addition 1: Any surface where walls will be removed must be replaced with carpet to match existing carpet color and height. Replacement of the carpet area must be kept to a minimum. We are replacing the flooring soon; however, we want to prevent tripping hazards from this construction until new flooring is installed. This will be required for the two walls that will be removed. Section 1: wall demolition going into old HR section. Section 2: conference room expansion where wall will be removed.

Addition 2: City staff will be responsible for moving partitions, cubicles, desks, and paperwork prior to construction. After construction, city staff is responsible for returning materials.

Addition 3: Colors for walls and trim will be provided to the lowest responsible bidder. Two different color tones: 1 for walls, and 1 for trims.

Addition 4: New offices shall have their own light switches and work independently.

Addition 5: Wall going into old HR's section that will be removed, must be removed as later as possible in the project. This will serve as a separation from construction area to existing area.

Question 1: Will any fire sprinklers need to be relocated?

Response 1: Fire sprinklers will not need to be replaced or relocated.

Question 2: Can existing door frames and doors be used in new locations? This will save some cost.

Response 2: Yes, doors and door frames can be utilized to save cost if doors swing in the same direction and follow code. Doors can be re-purposed in the following order: (See diagram below)

- Section 1: Existing office door that will be sealed (West wall of office) relocated to north wall of same office.
- Section 1: Door of wall that will be removed to be relocated to one of the three new offices.
- Section 3: Door in current office to be relocated in new storage room.

(3) New doors will be needed at: 2 new offices at section 1 and restroom door at section 3. Contractor to match door by Oshkosh Door, Oshkosh Series. If unable to find the exact door, the new door must be approved by City staff/coordinator.



City of San Luis

Department of Facilities

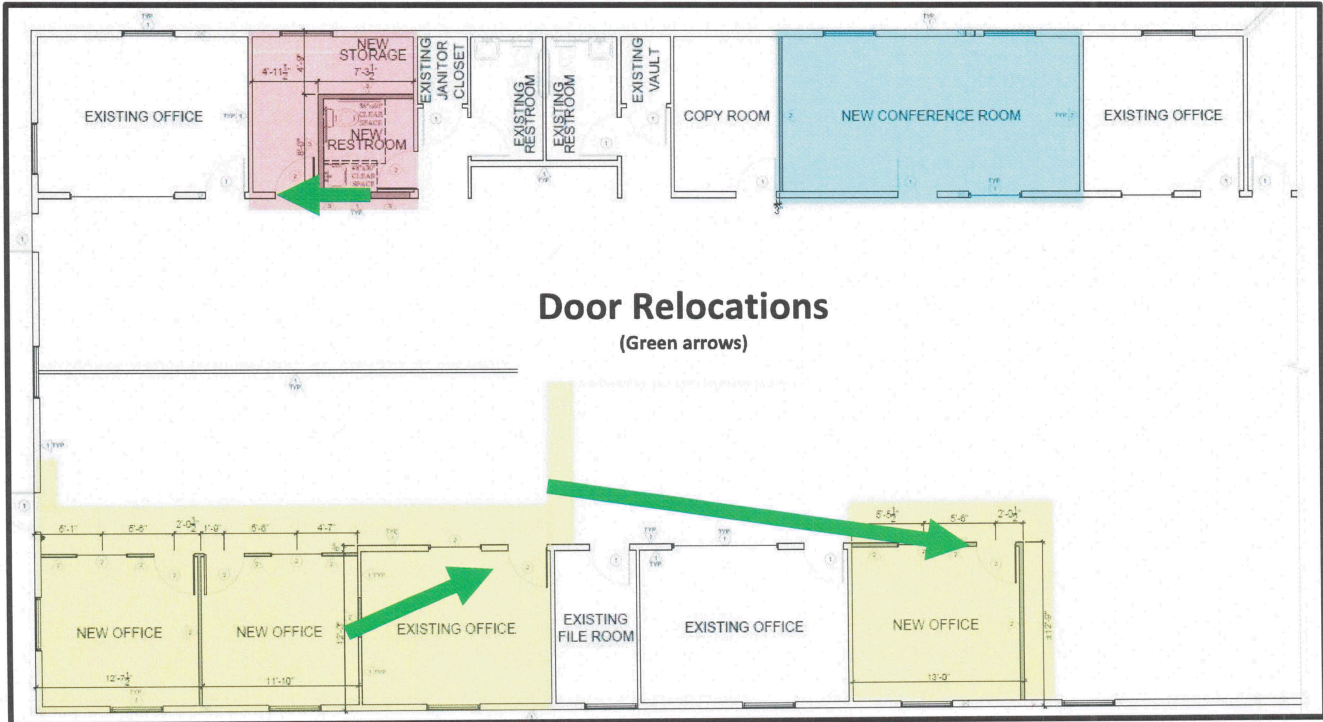

Question 3: Will there be someone present after hours to open, close, and supervise?

Response 3: Assigned city staff will be at location only to open facility. There will be no physical supervision other than remote camera access by City staff. On call staff will be available over the phone for any questions. The contractor is responsible for closing facilities once they are done with daily work.

Question 4: Will we need to isolate electricity where partitioners will be removed?

Response 4: Practitioners for this project do not have any electricity going through them. Any reconfigurations must follow Edais Engineering plans.

This Addendum is incorporated into the contract documents. Please acknowledge receipt of this addendum as part of the submittal of bid. All other terms and conditions remain the same.

Edgar Juarez
Facilities Project Coordinator

PRODUCER Stampede Insurance Services, Inc. N. Altadena Drive, Ste. 205 Pasadena, CA 91107	THIS CERTIFICATE IS ISSUED AS A MATTER OF INFORMATION ONLY AND CONFERS NO RIGHTS UPON THE CERTIFICATE HOLDER. THIS CERTIFICATE DOES NOT AMEND, EXTEND OR ALTER THE COVERAGE AFFORDED BY THE POLICIES BELOW.	
INSURED W D Construction Nathaniel Darnell S. Avenue B Yuma, AZ 85365	INSURERS AFFORDING COVERAGE	
	INSURER A: Third Coast Insurance Company	NAIC # 10713
	INSURER B: United Financial Casualty Company	11770
	INSURER C:	
	INSURER D: Clear Spring Property & Casualty	15563
	INSURER E:	

COVERAGES
 THE POLICIES OF INSURANCE LISTED BELOW HAVE BEEN ISSUED TO THE INSURED NAMED ABOVE FOR THE POLICY PERIOD INDICATED. NOTWITHSTANDING ANY REQUIREMENT, TERM OR CONDITION OF ANY CONTRACT OR OTHER DOCUMENT WITH RESPECT TO WHICH THIS CERTIFICATE MAY BE ISSUED OR MAY PERTAIN, THE INSURANCE AFFORDED BY THE POLICIES DESCRIBED HEREIN IS SUBJECT TO ALL THE TERMS, EXCLUSIONS AND CONDITIONS OF SUCH POLICIES. AGGREGATE LIMITS SHOWN MAY HAVE BEEN REDUCED BY PAID CLAIMS.

INSR LTR	ADD'L INSRD	TYPE OF INSURANCE	POLICY NUMBER	POLICY EFFECTIVE DATE (MM/DD/YY)	POLICY EXPIRATION DATE (MM/DD/YY)	LIMITS	
A	<input checked="" type="checkbox"/>	GENERAL LIABILITY <input checked="" type="checkbox"/> COMMERCIAL GENERAL LIABILITY <input type="checkbox"/> CLAIMS MADE <input checked="" type="checkbox"/> OCCUR <input type="checkbox"/> _____ <input type="checkbox"/> _____ GEN'L AGGREGATE LIMIT APPLIES PER: <input checked="" type="checkbox"/> POLICY <input type="checkbox"/> PROJECT <input type="checkbox"/> LOC	GLSISTC005713624	03/01/2024	03/01/2025	EACH OCCURENCE	\$1,000,000
						DAMAGE TO RENTED PREMISES (Ea occurrence)	\$50,000
						MED EXP (Any one person)	\$5,000
						PERSONAL & ADV INJURY	\$1,000,000
						GENERAL AGGREGATE	\$2,000,000
						PRODUCTS - COMP/OP AGG	\$2,000,000
							\$
B	<input type="checkbox"/>	AUTOMOBILE LIABILITY <input type="checkbox"/> ANY AUTO <input type="checkbox"/> ALL OWNED AUTOS <input checked="" type="checkbox"/> SCHEDULED AUTOS <input type="checkbox"/> HIRED AUTOS <input type="checkbox"/> NON-OWNED AUTOS <input type="checkbox"/> _____ <input type="checkbox"/> _____	971496840	07/13/2023	07/13/2024	COMBINED SINGLE LIMIT (Each Occurrence)	\$1,000,000
						BODILY INJURY (Per person)	\$
						BODILY INJURY (Per accident)	\$
						PROPERTY DAMAGE (Per accident)	\$
	<input type="checkbox"/>	GARAGE LIABILITY <input type="checkbox"/> ANY AUTO <input type="checkbox"/> _____				AUTO ONLY - EA ACCIDENT	\$
						OTHER THAN AUTO ONLY: EA ACC	\$
						AGG	\$
	<input type="checkbox"/>	EXCESS/UMBRELLA LIABILITY <input type="checkbox"/> OCCUR <input type="checkbox"/> CLAIMS MADE <input type="checkbox"/> DEDUCTIBLE <input type="checkbox"/> RETENTION \$_____				EACH OCCURRENCE	\$
						AGGREGATE	\$
							\$
							\$
							\$
D	<input type="checkbox"/>	WORKERS COMPENSATION AND EMPLOYERS' LIABILITY ANY PROPRIETOR/PARTNER/EXECUTIVE OFFICER/MEMBER EXCLUDED? If yes, describe under SPECIAL PROVISIONS below	CWC02035300	05/22/2023	05/22/2024	<input checked="" type="checkbox"/> WC STATUTORY LIMITS <input type="checkbox"/> OTHER	
						E.L. EACH ACCIDENT	\$1,000,000
						E.L. DISEASE - EA EMPLOYEE	\$1,000,000
						E.L. DISEASE - POLICY LIMIT	\$1,000,000
	<input type="checkbox"/>	OTHER					

DESCRIPTION OF OPERATIONS / LOCATIONS / VEHICLES / EXCLUSIONS ADDED BY ENDORSEMENT / SPECIAL PROVISIONS
 Certificate Holder is listed as an Additional Insured.
 The City of San Luis it's officers and employees are added as additional insureds.

CERTIFICATE HOLDER

CANCELLATION

City of San Luis

EXPIRATION DATE THEREOF, THE INSURER AFFORDING COVERAGE WILL ENDEAVOR TO MAIL 30 DAYS WRITTEN NOTICE TO THE CERTIFICATE HOLDER NAMED TO THE LEFT, BUT FAILURE TO DO SO SHALL IMPOSE NO OBLIGATION OR LIABILITY OF ANY KIND UPON THE INSURER, ITS AGENTS OR REPRESENTATIVES.

AUTHORIZED REPRESENTATIVE



Rene Rebollo

ACORD 25 (2001/08)

© ACORD CORPORATION 1988

IMPORTANT

If the certificate holder is an ADDITIONAL INSURED, the policy(ies) must be endorsed. A statement on this certificate does not confer rights to the certificate holder in lieu of such endorsement(s).

If SUBROGATION IS WAIVED, subject to the terms and conditions of the policy, certain policies may require an endorsement. A statement on this certificate does not confer rights to the certificate holder in lieu of such endorsement(s).

DISCLAIMER

The Certificate of Insurance on the reverse side of this form does not constitute a contract between the issuing insurer(s), authorized representative or producer, and the certificate holder, nor does it affirmatively or negatively amend, extend or alter the coverage afforded by the policies listed thereon.

STATE OF ARIZONA

Office of the
Registrar of Contractors

License No. ROC248137

This is to Certify That

D W D CONSTRUCTION (INDIV.)

*having been shown to possess all the necessary qualifications, and having complied with all the requirements of the law,
is by order of the Registrar of Contractors duly licensed and admitted to engage in and pursue the business of*

KB-01

DUAL BUILDING CONTRACTOR

Contractor in the State of Arizona. Given under my hand and the seal of the Registrar of Contractors

in my office, City of Phoenix, this 3RD day of SEPTEMBER, 2008.

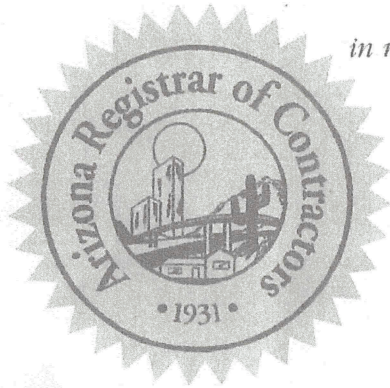

Fidelis V. Garcia

DIRECTOR

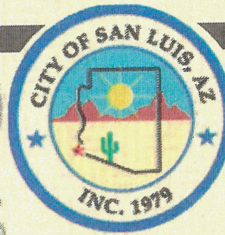

NO: 30731

City of San Luis

2024 Business License

13461 S. AVE. B YUMA, AZ 85365

IN CONSIDERATION OF: \$100.00 Dollars, Receipt of which is hereby acknowledged
The firm listed below is licensed to engage in and carry on business in the City of San Luis at the address indicated.

PERIOD ENDING: 12/31/2024

DWD CONSTRUCTION
NATHANIEL DAVID DARNELL
13461 S. AVE. B
YUMA, AZ 85365

Edgar Espinoza

THIS LICENSE MUST BE DISPLAYED IN A CONSPICUOUS PLACE SO AS TO BE EASILY VISIBLE TO THE PUBLIC AT ALL TIMES

**Request for Taxpayer
 Identification Number and Certification**

Give form to the requester. Do not send to the IRS.

Name (as shown on your income tax return) **D.W.D. Construction**

Business name, if different from above

Check appropriate box: Individual/sole proprietor Corporation Partnership
 Limited liability company. Enter the tax classification (D: disregarded entity, C: corporation, P: partnership): Exempt payee
 Other (see instructions)

Address number, street, and apt. or suite no.: **13461 S. AVE B**

City, state, and ZIP code: **Yuma, AZ 85365**

List account number(s) here (optional)

Requester's name and address (optional)

Part I Taxpayer Identification Number (TIN)

Enter your TIN in the appropriate box. If the provided TIN matches the name given or, to avoid backup withholding, for individuals, this is your social security number (SSN). However, for a resident alien, proprietor, or disregarded entity, see the "Part I" instructions on page 3. If you do not have a TIN, see "Get a TIN" on page 3. Note: if the account is in your name, see the chart on page 10 for guidelines on whose number to enter.

Social security number

Employer identification number **86 0753622** mbr

Part II Certification

Under penalties of perjury, I certify that:

- The number shown on this form is my correct taxpayer identification number (or am waiting for a number to be issued to me and am not subject to backup withholding because: (a) I am exempt from backup withholding or have not been notified by the Internal Revenue Service (IRS) that I am subject to backup withholding as a result of a failure to report all interest or dividends, or (c) the IRS has notified me that I am no longer subject to backup withholding, and
- I am not subject to backup withholding because: (a) I am exempt from backup withholding or have not been notified by the Internal Revenue Service (IRS) that I am subject to backup withholding as a result of a failure to report all interest or dividends, or (c) the IRS has notified me that I am no longer subject to backup withholding, and
- I am a U.S. citizen or other U.S. person (defined below).

Certification instructions: You must check out item 2 above if you have been notified by the IRS that you are currently subject to backup withholding because you have failed to report all interest and dividends on your tax return. If you have real estate transactions, 2 does not apply to your mortgage interest paid acquisition or abandonment of secured property, cancellation debt, contributions to an individual retirement arrangement and generally, payments other than interest and dividends, you are not required to sign the Certification, but you must

provide your correct TIN. See the instructions on page 10.

Sign Here: Signature of **[Signature]** U.S. person Date **3/5/2024**

General Instructions

Section references are to the Internal Revenue Code unless otherwise noted.

Purpose of Form

A person who is required to file an information return with the IRS must file this form with the return if the person is a U.S. person (as defined in the instructions) or a foreign estate, or a foreign person as defined in Regulations.