

Tue, 12 Mar 2024 4:38pm Z:\2021\21-099\Drawings\Drawings\21-099 Base Layout.dwg - Core Engineering Group, PLLC

30' 0' 30' 60'
SCALE: 1" = 30'

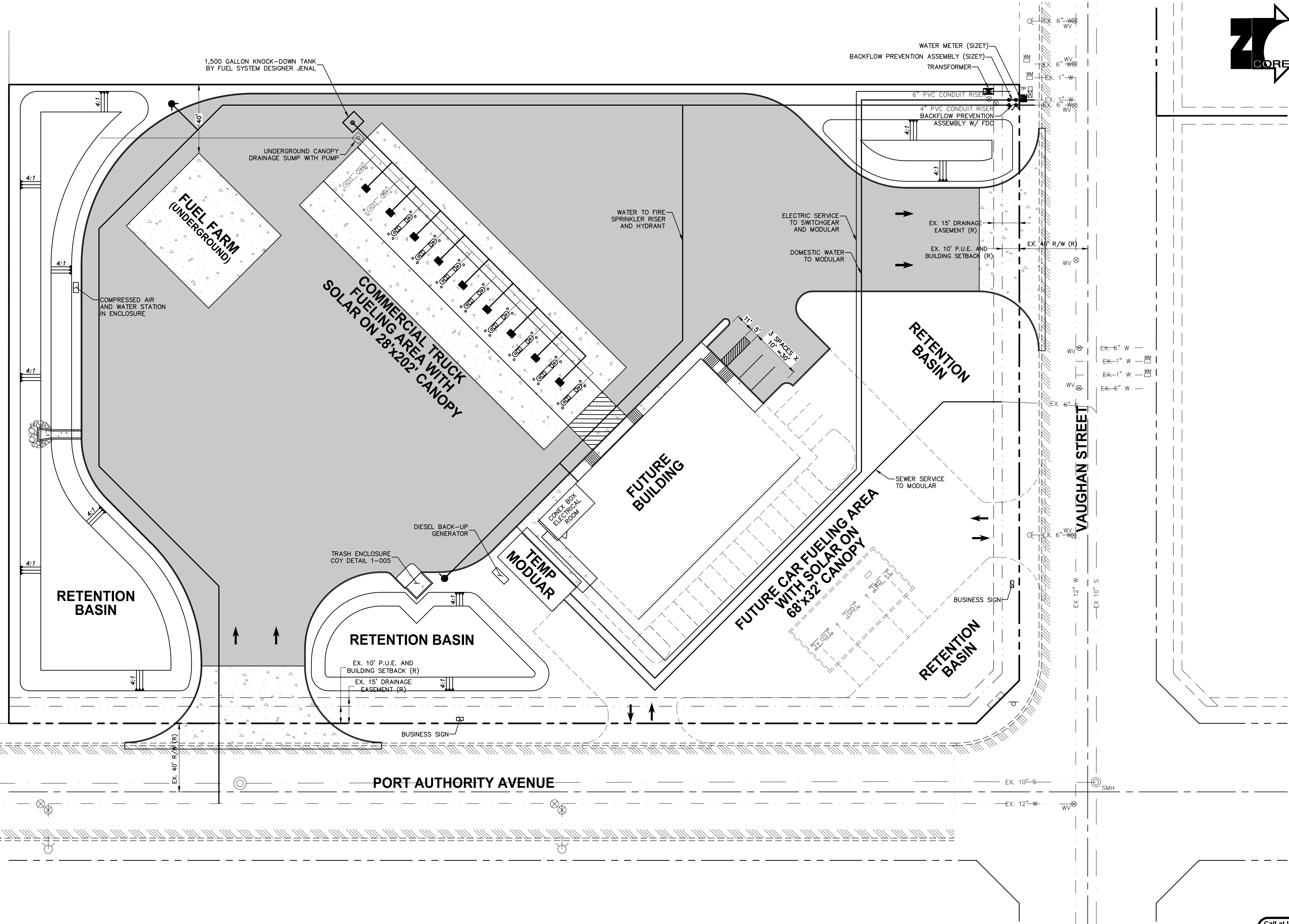
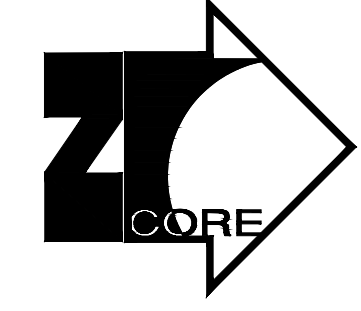

EX-6" W
EX-1" W
EX-1" W
EX-6" W

VAUGHAN STREET

PORT AUTHORITY AVENUE

UTILITY DISCLAIMER

THE UNDERGROUND UTILITIES SHOWN HAVE BEEN LOCATED FROM THE FIELD SURVEY INFORMATION AND EXISTING DRAWINGS. THE SURVEYOR MAKES NO GUARANTEE THAT THE UNDERGROUND UTILITIES SHOWN COMPRISE ALL SUCH UTILITIES IN THE AREA, EITHER IN SERVICE OR ABANDONED. THE SURVEYOR FURTHER DOES NOT WARRANT THAT THE UNDERGROUND UTILITIES SHOWN ARE IN THE EXACT LOCATION INDICATED ALTHOUGH HE DOES CERTIFY THAT THEY ARE LOCATED AS ACCURATELY AS POSSIBLE FROM INFORMATION AVAILABLE. THE SURVEYOR HAS NOT PHYSICALLY LOCATED THE UNDERGROUND UTILITIES.



PRELIMINARY PLAN
NOT FOR CONSTRUCTION

Date: MARCH 2024
Designed: D.J.N.
Drawn: J.R.K.
Checked: J.A.L.
Proj. No.: 21-099

C1.0
SHEET

MAGRINO INDUSTRIAL PARK
APN 227-23-023
CITY OF SAN LUIS
YUMA COUNTY, ARIZONA
PRELIMINARY SITE PLAN

CORE ENGINEERING GROUP, PLLC
200 East 16th Street, Suite 150
Yuma, AZ 85364
V - 928.344.5931 F - 928.344.5932
www.CoreEngineeringGroup.com
Core@core-e-g.com

DRAWING RECORD:

No.	DATE:

THIS DRAWING AND THE DATA CONTAINED HEREON ARE THE PROPERTY OF CORE ENGINEERING GROUP, PLLC AND SHALL NOT BE USED, REPRODUCED OR TRANSMITTED, WITHOUT THE PRIOR EXPRESS CONSENT OF THE COMPANY, NOR SHALL ANY DATA OR INFORMATION CONTAINED HEREON BE USED IN A MANNER INCONSISTENT WITH THE PRIOR EXPRESS WRITTEN AUTHORIZATION OF THE COMPANY.