

**WHEN RECORDED MAIL TO:**

**City Clerk's Office  
City of San Luis  
P.O. Box 1170  
San Luis, Arizona 85349**

CONFORMED COPY  
2024-17750 ANNEXATION  
07/25/2024 11:36:03 AM Pages: 5 Fees: \$15.00  
Requested By: CITY OF SAN LUIS CLERK

Richard Colwell County Recorder, YUMA County AZ



The above area is to be reserved for recording information

\*\*\*\*\*

**CAPTION HEADING:**

**ANNEXATION 2024-01**

**AFFIDAVIT IN COMPLIANCE WITH A.R.S. §9-471.A.6  
FOR RECORDING WITH BLANK ANNEXATION PETITION  
FOR THE CITY OF SAN LUIS, STATE OF ARIZONA**

STATE OF ARIZONA)

)ss.

COUNTY OF YUMA )

Jose A. Guzman, being first fully sworn, upon oath, deposes and says that he files this Affidavit in compliance with A.R.S. §9-471.A.6. This Affiant is the Director of Development Services for the City of San Luis, an Arizona municipal corporation, and has been assigned the duties of preparing the Petition for Annexation in compliance with A.R.S. §9-471.A on the property described in said Annexation Petition which is attached hereto for recording.

The Affiant, as an authorized agent of the City of San Luis, Arizona, has made a diligent search of the records of the Yuma County Recorder, and hereby verifies, to the best of the Affiant's knowledge, information, and belief that no part of the territory for which the filing is made is already subject to an earlier filing for annexation by another jurisdiction.

Therefore, this Affiant hereby requests that the Office of the Recorder of Yuma County, State of Arizona accept for recording the attached Petition for Annexation, pursuant to A.R.S. §9-471.

Dated this 25<sup>th</sup> day of July 2024

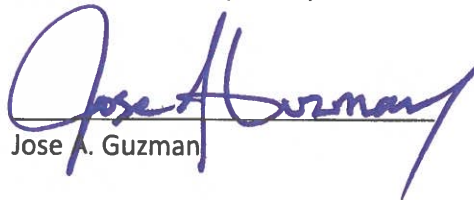
  
Jose A. Guzman

Subscribed and sworn to before me this 25<sup>TH</sup> day of July, 2024 by Jose A. Guzman, Director of Development Services for the City of San Luis, Arizona.

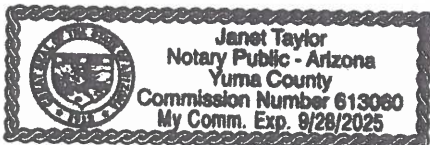

  
Notary Public

My commission expires:

09/28/2025

**CITY OF SAN LUIS ANNEXATION PETITION NO. 2024-01**

TO THE HONORABLE MAYOR AND COUNCIL OF THE CITY OF SAN LUIS, ARIZONA:

We, the undersigned, the owners of one-half or more in value of the real and/or personal property and more than one-half of the persons owning real and personal property that would be subject to taxation by the City of San Luis in the event of annexation within the territory proposed to be annexed, which is hereafter described, said territory being contiguous to the corporate limits of the City of San Luis, with the exterior boundaries of the territory proposed to be annexed shown on the map attached hereto, marked Exhibit A, and made a part hereof, request the City of San Luis, State of Arizona, to annex the following described territory, provided that the requirements of §9-471, and any amendments hereto are fully observed.

The description of the territory proposed to be annexed, not already within the present limits of the City of San Luis, Arizona, and located in Yuma County, Arizona is as follows:

*SECTIONS 3 AND 4, TOWNSHIP 11 SOUTH, RANGE 24 WEST, GILA AND SALT RIVER BASE AND MERIDIAN, YUMA COUNTY, ARIZONA;*

*AND*

*THE EAST 50 FEET OF THE WEST HALF OF THE SOUTHEAST QUARTER AND THE EAST 50 FEET OF THE SOUTHWEST QUARTER OF THE NORTHEAST QUARTER OF SECTION 33, TOWNSHIP 10 SOUTH, RANGE 24 WEST, GILA AND SALT RIVER BASE AND MERIDIAN, YUMA COUNTY, ARIZONA CONTAINING APPROXIMATELY 1,285 ACRES, MORE OR LESS.*

In addition to the above description, any and all county right-of-way and roadways with no taxable value that are within or contiguous to the exterior boundaries of the proposed annexation are part of the territory proposed to be annexed and will be included in any ordinance of annexation adopted as a result of this petition.

The City of San Luis shall be responsible, upon completed annexation, for the maintenance of all public roadways and rights-of-way within any territory that is annexed, except for state highways, which shall remain the responsibility of the State of Arizona. All public roadways and rights-of-way that are contiguous to, but not within, any territory annexed as a result of this petition shall remain the responsibility of the legal entity that is presently maintaining said roadway or rights-of-way, whether it is presently the Yuma County or the State of Arizona.



Includes 50ft strip of parcel 21133002  
-Created with Annexation 99-01  
Ordinance 158

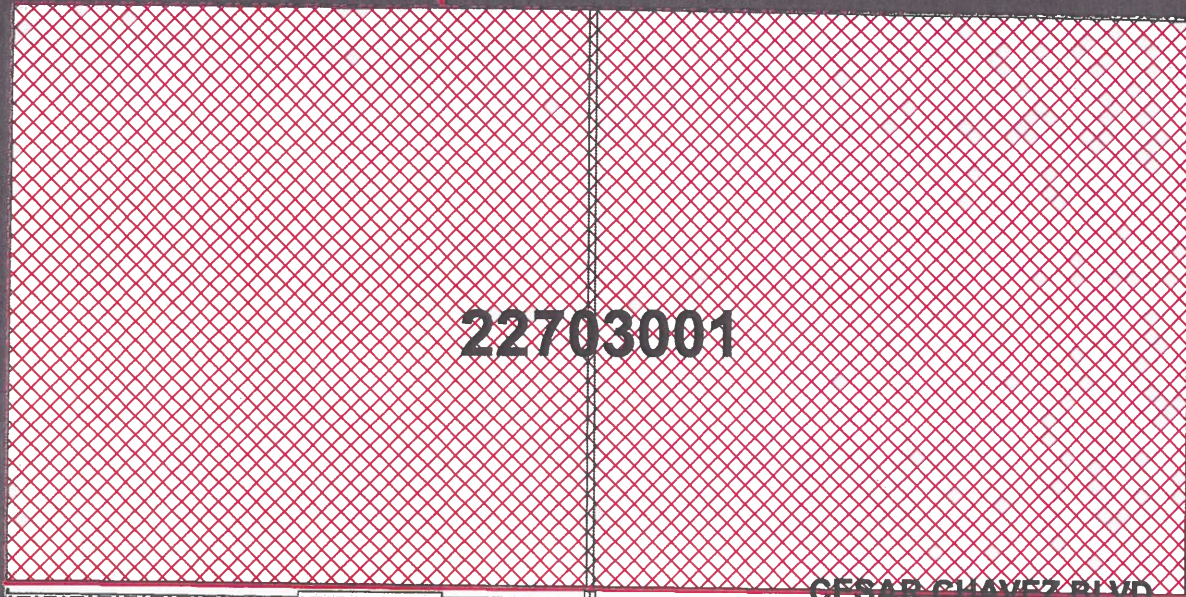

SAN LUIS

AVE F

CESAR CHAVEZ BLVD



## ANNEXATION 2024-01



SAN LUIS



PROPOSED ANNEXATION

**LEGAL:**

Sections 3 and 4, Township 11 South, Range 24 West, Gila and Salt River Base and Meridian, Yuma County, Arizona;

And

The East 50 feet of the West Half of the Southeast Quarter and the East 50 feet of the Southwest Quarter of the Northeast Quarter of Section 33, Township 10 South, Range 24 West, Gila and Salt River Base and Meridian, Yuma County, Arizona

Containing an area of approximately 1,285 acres, more or less.

In addition to the territory shown on this map, shaded in red, the proposed annexation includes any and all county right-of-way and roadways with not taxable value that are within or contiguous to the exterior boundaries of shaded area and said right of way and roadways are part of the territory proposed to be annexed and will be included in any ordinance of annexation adopted as a result of this petition.