



Resolution

No. 2384

OFFICE OF THE
MAYOR
CITY OF SAN LUIS

A RESOLUTION OF THE MAYOR AND CITY COUNCIL OF THE CITY OF SAN LUIS, ARIZONA, DECLARING THAT THE CITY COUNCIL DEEMS THE SALE OF THE REAL AND PERSONAL PROPERTY OF THE SAN LUIS FACILITY DEVELOPMENT CORPORATION FOR THE SAN LUIS REGIONAL DETENTION AND SUPPORT CENTER BENEFICIAL FOR THE CITY OF SAN LUIS; ORDERING AND CALLING A SPECIAL ELECTION TO BE HELD ON MAY 19, 2026, TO SUBMIT TO THE QUALIFIED ELECTORS OF THE CITY OF SAN LUIS THE QUESTION AS TO WHETHER OR NOT SAID PROPERTY SHOULD BE SOLD WITHIN 5 YEARS STARTING JUNE 1, 2026.

WHEREAS, the Mayor and City Council of the City of San Luis, Arizona ("City") order an election on the question of whether to sell real and personal property; and

WHEREAS, on May 14, 2025, the San Luis Facility Development Corporation recommended that the City Council call an election for the purpose of selling the real and personal property of the San Luis Regional Detention and Support Center; and

WHEREAS, on May 28, 2025, the San Luis City Council called an election for November 4, 2025, to sell the property; and

WHEREAS, the November 4, 2025, Election resulted in a rejection of the proposal to sell the property; and

WHEREAS, A.R.S. § 9-403(C) requires the voters to approve selling a city's real property if its value is fifteen million dollars (\$15,000,000) or more; and

WHEREAS, San Luis Facility Development Corporation abides by A.R.S. § 9-403(C), the same as the City, because the City created the corporation and appoints its directors; and

WHEREAS, for purposes of the foregoing, the Mayor and City Council order an election (the "Election");

NOW, THEREFORE, BE IT RESOLVED by the Mayor and City Council:

Section 1: Deemed Beneficial. The Mayor and City Council deem that it would be

beneficial to the citizens of the City of San Luis to authorize the San Luis Facility Development Corporation to sell the real and personal property of the San Luis Regional Detention and Support Center it currently owns and use the proceeds to continue the detention and support center project, to maintain local jobs for the local economy, and to support other public purposes.

Section 2: Designation of Election Date: Purpose. The Election, in and for the City, is ordered and called to be held on **Tuesday, May 19, 2026**, at which Election the question shall be submitted to the qualified electors of the City whether the real and personal property of the San Luis Facility Development Corporation of the San Luis Regional Detention and Support Center shall be sold.

Section 3: Question for the Official Ballot. The official ballot for the Election (the "Official Ballot") shall be in substantially the same form as follows:

OFFICIAL TITLE:

Special Election on whether to sell the San Luis Facility Development Corporation's real and personal property known as the San Luis Regional Detention and Support Center.

DESCRIPTIVE TITLE:

Shall the City of San Luis ("City") or the City's San Luis Facility Development Corporation ("SLFDC") or both be authorized to sell at public auction all SLFDC's real and personal property known as the San Luis Regional Detention and Support Center at 406 North Avenue D, San Luis, Arizona under A.R.S. § 9-403 (C) for five (5) years beginning June 1, 2026?

ANSWER:

A Yes vote: would authorize the City & the San Luis Facility Development Corporation to sell the San Luis Regional Detention and Support Center real and personal property.

A No vote: would not allow the City & the San Luis Facility Development Corporation to sell the San Luis Regional Detention and Support Center real and personal property if it is valued at \$15,000,000 or more.

NOTES/COMMENTS:

The full legal description is available from the City of San Luis, and it is posted on the City's website.

Deadlines:

Arguments for and against (pro and con) deadline, February 18, 2026, at 5:00 p.m.
Voter registration: The last day to register to vote is April 20, 2026, at 11:49 p.m.
Early voting starts April 22, 2026.

Section 4: The City Clerk is directed to revise the above Official Ballot language to include the legal description of the property, which is the subject of the question.

Section 5: The legal description is attached to this Resolution as Exhibit "A."

Section 6: Informational Pamphlet.

(A) The City Clerk shall give notice of the Election by mailing an informational pamphlet (the "Informational Pamphlet") and a sample of the Official Ballot in substantially the form attached hereto as Exhibit "B," to be revised as needed, and sent to every household within the City not less than thirty-five (35) days before the date of the Election.

(B) The City Clerk shall prepare the Informational Pamphlet, and the City Clerk is authorized and directed to cause the Informational Pamphlet to be provided in the form she deems acceptable.

(C) The City Clerk is authorized to request arguments for and against the subject matter of the Election by providing the notice. The deadline to submit to the City Clerk's Office at City Hall, 1090 East Union Street, San Luis, Arizona, arguments for and against shall be **5:00 p.m., Wednesday, February 18, 2026.**

Section 7: Absentee and Early Voting. Absentee/early voting with respect to the Election shall be permitted in accordance with the provisions of Title 16, Chapter 4, Article 8, Arizona Revised Statutes.

Section 8: The City Clerk is authorized and directed to have the Official Ballot printed and delivered to the election officials at the polling places for the election officials to furnish to the qualified electors of the City at the Election.

Section 9: To comply with the Voting Rights Act of 1965, as amended, the following materials pertaining to the Election shall be translated into Spanish and mailed or distributed in each instance where mailing or distributing of such materials is required, specifically:

- Request for Arguments (for and against),
- Informational Pamphlet,
- Official Ballot,
- Absentee and Early Voting Materials, and
- Instructions at the Polling Places.

Section 10: The Mayor and City Council approve the consolidation of any election precincts deemed necessary for purposes of the Election.

Section 11: Holding the Election.

(A) The Election shall be held, conducted, and canvassed in conformity with the provisions of the regular election laws of the State of Arizona, except as otherwise provided by law, and only such persons shall be permitted to vote at the Election who are qualified electors of the City.

(B) The Election may be conducted (i) using either electromechanical or electronic vote recording and ballot counting equipment or paper ballots at polling places, or (ii) as a mailed ballot election as provided in Section 16-409, Arizona Revised Statutes, as shall be determined to be in the best interests of the City by the Elections Services of Yuma County, Arizona (the "County") and the City Clerk. The City Clerk is authorized to enter into a contract with the County Recorder of the County to obtain precinct registers for the Election and to enter into an agreement with Yuma County to conduct the Election for the City.

(C) The Mayor and City Council authorize all expenditures as may be necessary to order, notice, hold, and administer the Election, which expenditure shall be paid from the current operating funds of the City.

(D) The Mayor and City Council authorize the City Clerk to take all necessary actions to facilitate the Election, including all such actions as are necessary to assist the Elections Services of the County in conducting the Election and performing its duties.

Section 12: If a conflict arises between the provisions of this Resolution and any other ordinance, Resolution, order, regulation, or policy of the City of San Luis, the conflicting provisions are amended, superseded, and replaced, and this Resolution shall govern.

Section 13: If any section, subsection, paragraph, sentence, clause, phrase, or portion of this Resolution is held to be invalid or unconstitutional by the final decision of any court of competent jurisdiction or controlling legislation, such decision or law shall not affect the validity of the remaining portion of this Resolution.

Section 14: The City officers and employees are authorized and directed to perform all acts necessary or desirable to give effect to this Resolution.

[Remainder of page intentionally left blank. Signature page follows.]

PASSED, ADOPTED, and APPROVED by the Mayor and City Council of the City of San Luis, Yuma County, Arizona, this ____ day of November 2025.

City of San Luis, Arizona

Nieves Riedel, Mayor

Attest:

Approved As to Form

Sonia Cornelio, City Clerk

Kay Marion Macuil, City Attorney

Exhibit A

BEING A PORTION OF THE SOUTHEAST QUARTER OF SECTION 11, TOWNSHIP 11 SOUTH, RANGE 24 WEST, OF THE GILA AND SALT RIVER BASE AND MERIDIAN, YUMA COUNTY, ARIZONA, MORE PARTICULARLY DESCRIBED AS FOLLOWS:

BEGINNING AT THE CENTER QUARTER CORNER OF SECTION 11, AT A FOUND IRON PIN;

THENCE SOUTH 89 DEGREES 56 MINUTES 51 SECONDS EAST ALONG THE EAST-WEST MID SECTION LINE OF SECTION 11, A DISTANCE OF 1888.25 FEET TO THE TRUE POINT OF BEGINNING;

THENCE SOUTH 89 DEGREES 56 MINUTES 51 SECONDS EAST CONTINUING ALONG THE EAST-WEST MID SECTION LINE OF SECTION 11, A DISTANCE OF 751.25 FEET TO A FOUND 1" PIPE, SAID PIPE BEING THE EAST QUARTER CORNER OF SECTION 11;

THENCE SOUTH 00 DEGREES 01 MINUTES 00 SECONDS EAST, A DISTANCE OF 1449.58 FEET TO A SET IRON PIN & CAP (R.L.S. # 16528);

THENCE NORTH 89 DEGREES 56 MINUTES 51 SECONDS WEST, A DISTANCE OF 751.25 FEET TO A POINT FOR CORNER;

THENCE NORTH 00 DEGREES 01 MINUTES 00 SECONDS WEST, A DISTANCE OF 1449.58 FEET TO THE TRUE POINT OF BEGINNING;

EXCEPT THE EAST 33 FEET AS CONVEYED TO YUMA COUNTY IN INSTRUMENT RECORDED AS DOCKET 686, PAGE 893; AND

EXCEPT 1/16TH OF ALL OIL, GASES AND OTHER HYDROCARBON SUBSTANCES, COAL, STONE, METALS, MINERALS, FOSSILS AND FERTILIZERS OF EVERY NAME AND DESCRIPTION AND EXCEPT ALL MATERIALS WHICH MAY BE ESSENTIAL TO PRODUCTION OF FISSIONABLE MATERIAL AS RESERVED IN ARIZONA REVISED STATUTES; AND

EXCEPT 1/4TH OF ALL OIL, GAS AND OTHER MINERALS AS RESERVED IN DEED RECORDED AS DOCKET 1351, PAGE 289, RECORDS OF YUMA COUNTY, ARIZONA.

Exhibit B

ELECTION 2026

CITY OF SAN LUIS, ARIZONA

INFORMATIONAL PAMPHLET AND SAMPLE BALLOT

SPECIAL ELECTION
MAY 19, 2026



CIUDAD DE SAN LUIS, ARIZONA

FOLLETO INFORMATIVO Y BOLETA DE MUESTRA

ELECCION ESPECIAL
19 DE MAYO DE 2026

(Spanish version begins on Page 11) - (La version en Español empieza en la Pagina 11)

Intentionally left blank

TO THE ELECTORS OF THE CITY OF SAN LUIS, ARIZONA:

The Mayor and Council of the City of San Luis, Arizona, pursuant to Resolution No. xxxx adopted on xxx, 2025, have ordered that a special election be held in and for the City of San Luis, Arizona (the "city"), on May 19, 2026 (the "Special Election"). The qualified electors of the city will be asked to vote on the sale of real and personal property of the San Luis Regional Detention and Support Center.

A person is entitled to vote in the Special Election who has resided in a precinct in the boundaries of the city for 29 days preceding the Special Election, who is qualified to register to vote as provided in Section 16-101, Arizona Revised Statutes, as amended, and whose registration has been received by the Recorder's Office of Yuma County, Arizona, before midnight on the 29th day preceding the date of the Special Election. The last day to register for the Special Election is April 20, 2026.

The purpose of this Informational Pamphlet is to provide you with information on the question that will appear on the ballot for the Special Election. A sample ballot and a list of the polling places for the Special Election are included in this Informational Pamphlet.

Preparation of this Informational Pamphlet is required by State law and in compliance with the Federal Voting Rights Act. It has been printed in both English and Spanish. To be prepared to fully exercise your right to vote at the Special Election, you are urged to read all the material thoroughly. This Informational Pamphlet may be taken into the voting booth on the day of the Special Election.

Polling places for the Special Election will be open from 6 a.m. to 7 p.m. on May 19, 2026. Each elector may vote at any vote center listed on Page 5.

/s/ Sonia Cornelio
City Clerk, City of San Luis, Arizona

INTRODUCTORY STATEMENT

The city has prepared this sample ballot and Informational Pamphlet to provide qualified electors of the city with information concerning the Special Election.

The question being submitted for your consideration is whether to sell real and personal property known as the San Luis Regional Detention and Support Center, located at 406 North Avenue D, San Luis, Arizona.

SALE OF REAL AND PERSONAL PROPERTY INFORMATION

By Arizona State Statute (A.R.S. § 9-403(C)), the sale of a city's real property valued at \$15,000,000 or more must be authorized by the electors. Since the SLFDC is a corporation created by the city, it must also abide by this statute.

POLLING LOCATIONS

Yuma County Library
San Luis Branch
1075 North 6th Avenue
San Luis, Arizona 85349

San Luis Medical Mall
151 Oak Avenue
San Luis, Arizona 85349

HOURS DURING THE DAY WHEN THE POLLS WILL BE OPEN

The polling place shall be open from 6:00 a.m. to 7:00 p.m. on the date of the Special Election.

OTHER IMPORTANT ELECTOR INFORMATION

A person is entitled to vote in the Special Election who has resided in a precinct in the boundaries of the city for 29 days preceding the Special Election, who is qualified to register to vote as provided in Section 16-101, Arizona Revised Statutes, as amended. The last day to register for the Special Election is April 20, 2026.

1. Please check the vote centers listed on Page 5 of this informational pamphlet for the polling place information.
2. Polling places will be open from 6:00 a.m. to 7:00 p.m.
3. Any qualified elector who is either physically or visually impaired or who is unable to read or understand the contents of the ballot may be accompanied into the voting booth by a person of such elector's choice to assist such elector in casting a vote.
4. Sample ballots may be brought to the voting place and may be taken into the voting booth on the day of the Special Election.
5. Any qualified elector who, at 7:00 p.m., is in line to vote will be allowed to prepare and cast a ballot.

EARLY/ABSENTEE VOTING INFORMATION

Any qualified elector may vote an early/absentee ballot for the Special Election. Absentee/early voting concerning the Special Election shall be permitted by the provisions of Title 16, Chapter 4, Article 8, Arizona Revised Statutes, as amended. Absentee/early voting information for the Special Election may be obtained by contacting:

Yuma County Recorder's Office
102 South Main Street
Yuma, Arizona 85364
Telephone: (928) 373-6034
8:00 a.m. to 5:00 p.m., Monday through Friday

TO VOTE AN EARLY/ABSENTEE BALLOT IN PERSON

Appear in person at:

Yuma County Recorder's Office
102 South Main Street
Yuma, Arizona 85364
Telephone: (928) 373-6034
8:00 a.m. to 5:00 p.m., Monday through Friday

TO OBTAIN AN EARLY/ABSENTEE BALLOT BY MAIL

Submit a written, signed request or call:

Yuma County Recorder's Office
102 South Main Street
Yuma, Arizona 85364
Telephone: (928) 373-6034
8:00 a.m. to 5:00 p.m., Monday through Friday

- a. If confined because of physical disability or illness, indicate the address of confinement and if assistance is needed.
- b. If you will be out of the city, indicate where to mail the early/absentee ballot.

The Yuma County Recorder's Office must receive written or verbal requests for an early or absentee ballot before 5:00 p.m. on May 8, 2026, for the ballot to be mailed.

The returned early/absentee ballot must be received in the Yuma County Recorder's Office not later than 7:00 p.m. on election day, May 19, 2026, for the vote to be counted.

TO OBTAIN FURTHER INFORMATION, CONTACT

For election process, voting information and voter registration, and early/absentee ballot information:

Yuma County Election Services
102 South Main Street
Yuma, Arizona 85364
Telephone: (928) 373-1014
8:00 a.m. to 5:00 p.m., Monday through Friday

Yuma County Recorder's Office
102 South Main Street
Yuma, Arizona 85364
Telephone: (928) 373-6034
8:00 a.m. to 5:00 p.m., Monday through Friday

If you are unsure if you are qualified to vote, please contact Yuma County Recorder's Office at the telephone number listed for that office.

FORM OF OFFICIAL BALLOT

QUESTION NO. 1
SALE OF REAL AND PERSONAL PROPERTY

Shall the City of San Luis ("city") or the City's San Luis Facility Development Corporation ("SLFDC") or both, be authorized to sell at public auction all SLFDC's real and personal property known as the San Luis Regional Detention and Support Center at 406 North Avenue D, San Luis, Arizona, under A.R.S. § 9-403 (C) for five (5) years beginning June 1, 2026?

YES

NO

MAP

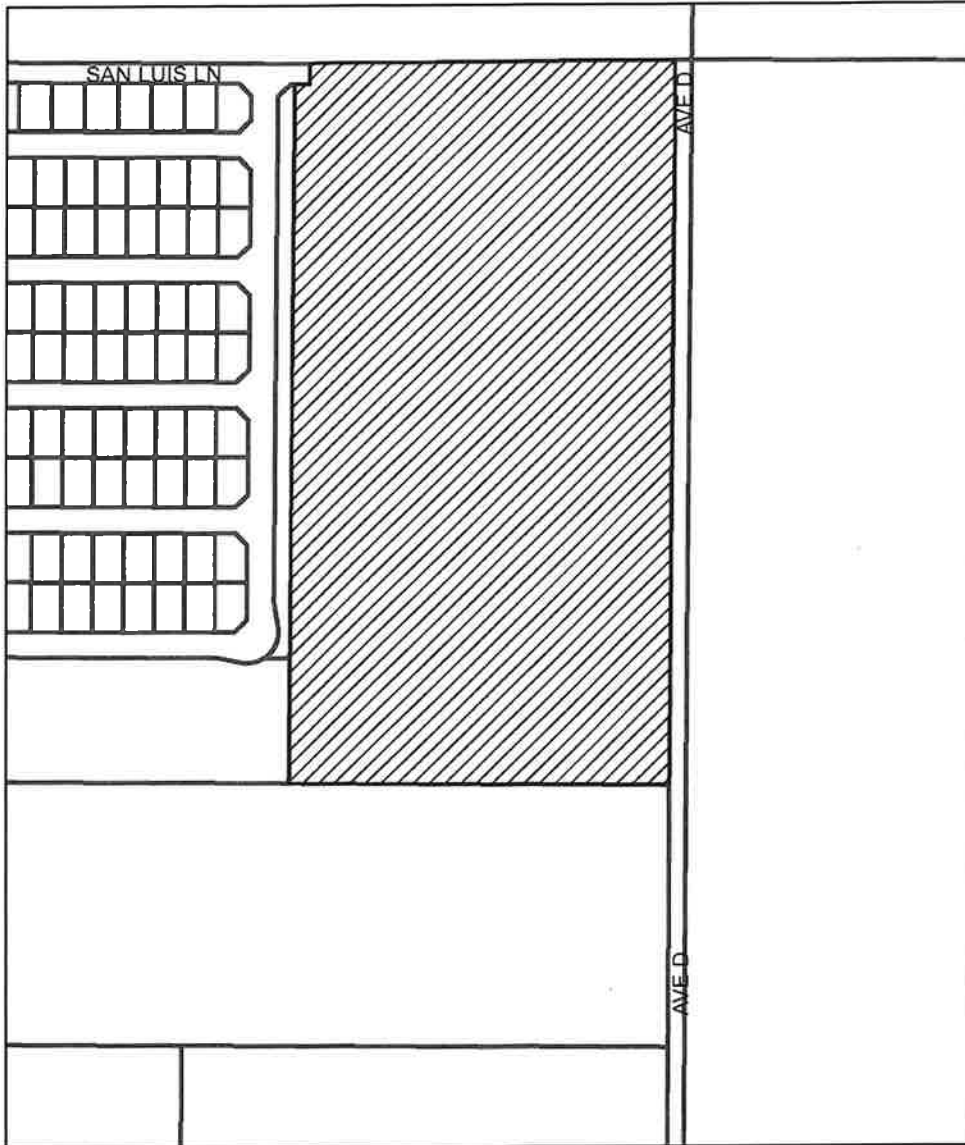

 **SAN LUIS REGIONAL SUPPORT AND DETENTION CENTER
(CENTRO REGIONAL DE DETENCION Y APOYO DE SAN LUIS)**

LEGAL DESCRIPTION

BEING A PORTION OF THE SOUTHEAST QUARTER OF SECTION 11, TOWNSHIP 11 SOUTH, RANGE 24 WEST, OF THE GILA AND SALT RIVER BASE AND MERIDIAN, YUMA COUNTY, ARIZONA, MORE PARTICULARLY DESCRIBED AS FOLLOWS:

BEGINNING AT THE CENTER QUARTER CORNER OF SECTION 11, AT A FOUND IRON PIN;

THENCE SOUTH 89 DEGREES 56 MINUTES 51 SECONDS EAST ALONG THE EAST WEST MID SECTION LINE OF SECTION 11, A DISTANCE OF 1888.48 FEET TO THE TRUE POINT OF BEGINNING;

THENCE SOUTH 89 DEGREES 56 MINUTES 51 SECONDS EAST ALONG THE EAST WEST MID SECTION LINE OF SECTION 11, A DISTANCE OF 751.25 FEET TO A FOUND 1" PIPE, SAID PIPE BEING THE EAST QUARTER CORNER OF SECTION 11;

THEN SOUTH 00 DEGREES 01 MINUTES 00 SECONDS EAST, A DISTANCE OF 1449.58 FEET TO A FOUND IRON PIN AND CAP (R.L.S. #16528);

THEN NORTH 89 DEGREES 56 MINUTES 51 SECONDS WEST, A DISTANCE OF 781.25 FEET;

THENCE NORTH 00 DEGREES 01 MINUTES 00 SECONDS WEST, A DISTANCE OF 1409.58 FEET TO A POINT 40.00 FEET SOUTH OF THE EAST WEST MID SECTION LINE OF SAID SECTION 11, SAID POINT ALONG BEING ALONG THE SOUTH RIGHT OF WAY LINE OF SAN LUIS LANE;

THENCE SOUTH 89 DEGREES 56 MINUTES 51 SECONDS EAST ALONG THE SOUTH RIGHT OF WAY LINE OF SAN LUIS LANE, A DISTANCE OF 30.00 FEET;

THENCE NORTH 00 DEGREES 01 MINUTES 00 SECONDS WEST, A DISTANCE OF 40.00 FEET TO THE TRUE POINT OF BEGINNING;

EXCEPT THE EAST 33 FEET AS CONEYED TO YUMA COUNTY IN INSTRUMENT RECORDED AS DOCKET 686, PAGE 893; AND

EXCEPT 1/16TH OF ALL OIL, GASES AND OTHER HYDROCARBON SUBSTANCES, COAL, STONE, METALS, MINERALS, FOSSILS AND FERTILIZERS OF EVERY NAME AND DESCRIPTION AND EXCEPT ALL MATERIALS WHICH MAY BE ESSENTIAL TO PRODUCTION OF FISSIONABLE MATERIAL AS RESERVED IN ARIZONA REVISED STATUTES; AND

EXCEPT 1/4TH OF ALL OIL, GAS AND OTHER MINERALS AS RESERVED IN DEED RECORDED AS DOCKET 1351, PAGE 289, RECORD OF YUMA COUNTY, ARIZONA.

QUESTION NO. 1
ARGUMENTS FOR/AGAINST

ARGUMENTS FOR:

XXXX

ARGUMENTS AGAINST:

XXXX

A LOS ELECTORES DE LA CIUDAD DE SAN LUIS, ARIZONA:

La Alcaldesa y el Concilio de la Ciudad de San Luis, Arizona, de conformidad con la Resolucion Num. xxxx adoptada el xx de xxx del 2025, han ordenado que se lleve a cabo una eleccion especial en y para la Ciudad de San Luis, Arizona (la "ciudad"), el 19 de Mayo del 2026 (la "Eleccion Especial"). A los electores calificados de la ciudad se les pedira que voten sobre la pregunta referente a la venta de bienes muebles e inmuebles del Centro Regional de Detencion y Apoyo de San Luis (San Luis Regional Detention and Support Center).

Las personas que tienen derecho a votar en la Eleccion Especial deben haber residido en un recinto dentro de los limites de la ciudad durante los 29 dias anteriores a la Eleccion Especial, tener derecho a registrarse para votar segun lo dispuesto en la Seccion 16-101, Estatutos Revisados de Arizona, en su forma enmendada, y que cuya inscripcion haya sido recibida por el Departamento de Elecciones del Condado de Yuma, Arizona, antes de la medianoche del dia 29 anterior a la fecha de la Eleccion Especial. El ultimo dia para registrarse para la Eleccion Especial es el 20 de Abril del 2026.

El proposito de este Folleto Informativo es proporcionarle a usted informacion sobre la pregunta y propuesta que aparecieran en la boleta electoral para la Eleccion Especial. Este Folleto Informativo incluye una muestra de la boleta electoral y una lista de los lugares de votacion para la Eleccion Especial.

La preparacion de este Folleto Informativo es requerida por la ley Estatal y, en cumplimiento con la ley Federal de Derecho al Voto (Federal Voting Rights Act), ha sido impreso en Ingles y Español. Con el fin de estar preparado para ejercer plenamente su derecho al voto en la Eleccion Especial, se le insta a usted a leer detenidamente todo el material. Este Folleto Informativo puede llevarse a la urna de votacion el dia de la Eleccion Especial.

Los lugares de votacion para la Eleccion Especial estaran abiertos de 6 a.m. a 7 p.m. el 19 de Mayo del 2026. Cada elector puede votar en el centro de votacion enumerado en la Pagina 13.

/s/ Sonia Cornelio
Secretaria Municipal, Ciudad de San Luis, Arizona

DECLARACION INTRODUCTORIA

La ciudad ha preparado una muestra de la boleta electoral y un Folleto Informativo para proporcionar a los electores calificados de la ciudad informacion sobre la Eleccion Especial.

La pregunta que se esta presentando para su consideracion es la venta de bienes muebles e inmuebles del Centro Regional de Detencion y Apoyo de San Luis (San Luis Regional Detention and Support Center), ubicado en el 406 North Avenue D, San Lui, Arizona.

INFORMACION SOBRE LA VENTA DE PROPIEDAD

Segun el Estatuto del Estado de Arizona (A.R.S. § 9-403(C)), la venta de bienes inmuebles de una ciudad con un valor de \$15,000,000 o mas debe ser autorizada por los electores. Dado que SLFDC es una corporacion creada por la ciudad, tambien debe cumplir con este estatuto.

LUGARES DE VOTACION

Biblioteca del Condado de Yuma
Sucursal de San Luis
(Yuma County Library – San Luis Branch)
1075 North 6th Avenue
San Luis, Arizona 85349

Centro Comercial Medico San Luis
(Medical Mall)
151 Oak Avenue
San Luis, Arizona 85349

HORAS DURANTE EL DIA EN LAS QUE LAS URNAS ESTARAN ABIERTAS

Los lugares de votacion estaran abiertos a las 6:00 a.m. y cerraran a las 7:00 p.m. en la fecha de la Eleccion Especial.

OTRA INFORMACION IMPORTANTE PARA LOS ELECTORES

Para tener derecho a votar en la Eleccion Especial, una persona debe haber residido en un recinto en los limites de la ciudad durante los 29 dias anteriores a la Eleccion Especial, estar calificada para registrarse para votar segun lo dispuesto en la Seccion 16-101, Estatutos Revisados de Arizona, en su forma enmendada. El ultimo dia para registrarse para la Eleccion Especial es el 20 de Abril del 2026.

1. Por favor, revise la lista de lugares de votacion en este folleto informativo para obtener informacion sobre los lugares de votacion, Pagina 13.
2. Los lugares de votacion estaran abiertos de 6:00 a.m. a 7:00 p.m.
3. Cualquier elector con derecho a voto que tenga una discapacidad fisica o visual y que no pueda leer o entender el contenido de la boleta electoral, puede ser acompañado en la urna de votacion por una persona de su eleccion con el proposito de ayudar a dicho elector a emitir su voto.
4. Las boletas de muestra se pueden llevar al lugar de votacion y a la urna de votacion el dia de la Eleccion Especial.
5. A cualquier elector calificado que se encuentre en la fila de los electores en espera a las 7:00 p.m., se le permitira preparar y emitir su voto.

INFORMACION SOBRE LA VOTACION TEMPRANA/EN AUSENCIA

Cualquier elector calificado puede votar con una boleta temprana/en ausencia para la Eleccion Especial. La votacion en ausencia/temprana con respecto a la Eleccion Especial se permitira de acuerdo con las disposiciones del Titulo 16, Capitulo 4, Articulo 8, Estatutos Revisados de Arizona, en su forma enmendada. Informacion sobre la votacion en ausencia/temprana con respecto a la Eleccion Especial se puede obtener comunicandose con:

Oficina del Registrador del Condado de Yuma
(Yuma County Recorder's Office)
102 South Main Street
Yuma, Arizona 85364
Telefono: (928) 373-6034
8:00 a.m. a 5:00 p.m., de Lunes a Viernes

PARA VOTAR EN PERSONA EN UNA BOLETA TEMPRANA/EN AUSENCIA

Presentarse en persona en:

Oficina del Registrador del Condado de Yuma
(Yuma County Recorder's Office)
102 South Main Street
Yuma, Arizona 85364
Telefono: (928) 373-6034
8:00 a.m. a 5:00 p.m., de Lunes a Viernes

PARA OBTENER POR CORREO UNA BOLETA TEMPRANA/EN AUSENCIA

Presentar una solicitud por escrito firmada o llamar a:

Oficina del Registrador del Condado de Yuma
(Yuma County Recorder's Office)
102 South Main Street
Yuma, Arizona 85364
Telefono: (928) 373-6034
8:00 a.m. a 5:00 p.m., de Lunes a Viernes

Si esta confinado debido a una discapacidad fisica o enfermedad, indique la direccion del lugar de confinamiento y si se necesita asistencia.

Si usted va a estar fuera de la ciudad, indique a donde enviar por correo la boleta temprana/en ausencia.

Las solicitudes escritas o verbales para una boleta temprana/en ausencia deben ser recibidas por la Oficina del Registrador del Condado de Yuma (Yuma County Recorder's Office) antes de las 5:00 p.m. del 8 de Mayo del 2026, para que los Servicios al Elector envíen la boleta por correo.

La boleta temprana/en ausencia debe recibirse en la Oficina del Registrador del Condado de Yuma (Yuma County Recorder's Office) a mas tardar a las 7:00 p.m. del dia de la eleccion, el 19 de Mayo del 2026, para que la boleta se incluya en el conteo.

PARA OBTENER MAS INFORMACION, PONGASE EN CONTACTO CON

Para el proceso electoral, informacion sobre la votacion y el registro de elector, e informacion sobre las boletas tempranas/en ausencia:

Servicios de Elecciones del Condado de Yuma
(Yuma County Election Services)

102 South Main Street

Yuma, Arizona 85364

Telefono: (928) 373-1014

8:00 a.m. a 5:00 p.m., de Lunes a Viernes

Oficina del Registrador del Condado de Yuma

(Yuma County Recorder's Office)

102 South Main Street

Yuma, Arizona 85364

Telefono: (928) 373-6034

8:00 a.m. a 5:00 p.m., de Lunes a Viernes

Si usted no sabe si esta calificado para votar, usted debe comunicarse con la Oficina del Registrador del Condado de Yuma (Yuma County Recorder's Office) al numero de telefono de esa oficina.

FORMATO DE LA BOLETA ELECTORAL OFICIAL

PREGUNTA NUM. 1 VENTA DE BIENES MUEBLES E INMUEBLES

¿Debería autorizarse a la Ciudad de San Luis o a la Corporación de Desarrollo de Instalaciones de San Luis de la Ciudad (City of San Luis Facility Development Corporation ("SLFDC") o a ambas, vender en subasta pública todos los bienes inmuebles y personales de SLFDC conocidos como el Centro de Detención y Apoyo Regional de San Luis (San Luis Regional Detention and Support Center) en el 406 North Avenue D, San Luis, Arizona, de conformidad con A.R.S. § 9-403 (C) durante cinco (5) años a partir del 1^o de Junio de 2026?

SI

NO

MAPA

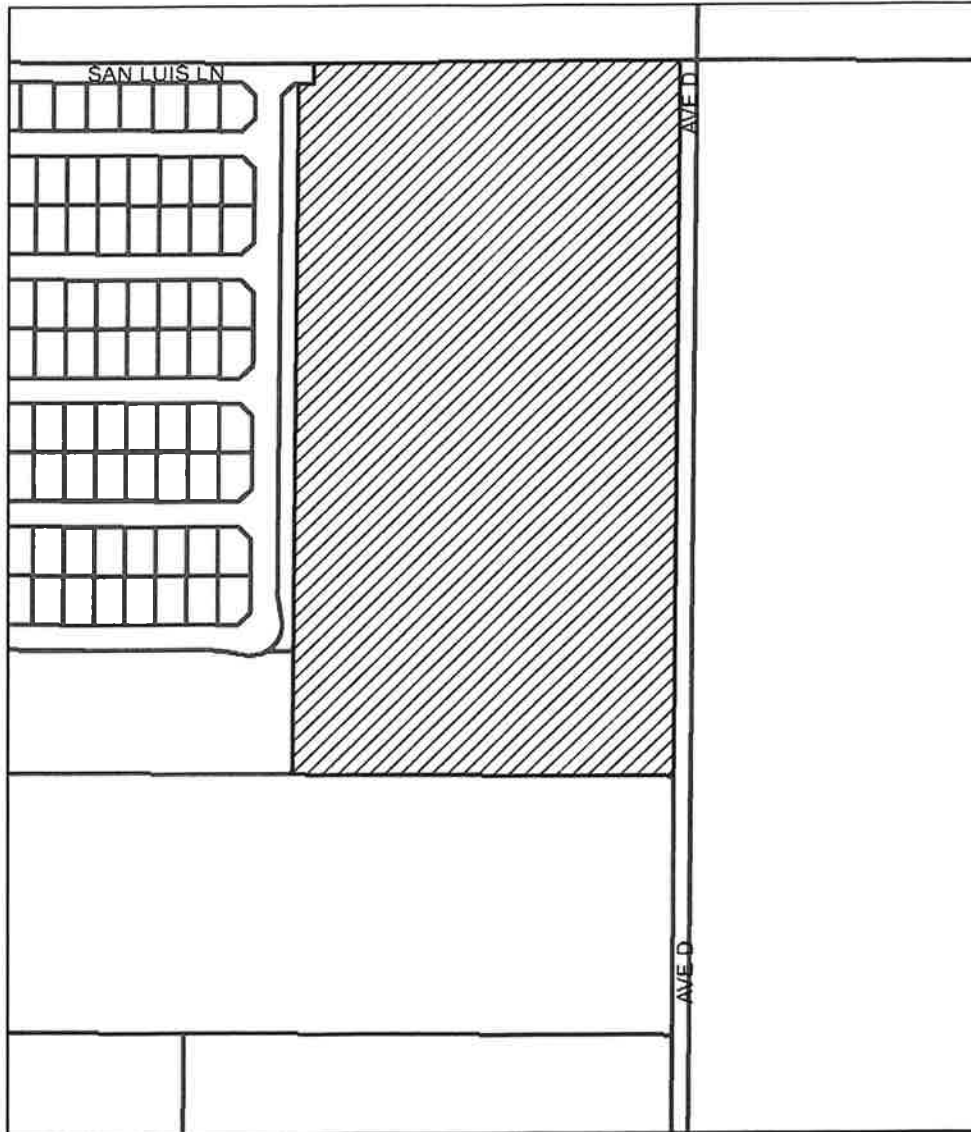

 **SAN LUIS REGIONAL SUPPORT AND DETENTION CENTER
(CENTRO REGIONAL DE DETENCION Y APOYO DE SAN LUIS)**

DESCRIPCION LEGAL

SIENDO UNA PORCION DEL CUARTO SURESTE DE LA SECCION 11, MUNICIPIO 11 SUR, RANGO 24 OESTE, DE LA BASE Y MERIDIANO DEL RIO GILA Y SALADO, CONDADO DE YUMA, ARIZONA, MAS PARTICULARMENTE DESCRITO COMO SIGUE:

COMENZANDO EN LA ESQUINA CENTRAL DEL CUARTO DE LA SECCION 11, EN UNA CLAVIJA DE HIERRO ENCONTRADA;

DE ALLI AL SUR 89 GRADOS 56 MINUTOS 51 SEGUNDOS ESTE A LO LARGO DE LA LINEA MEDIA ESTE-OESTE DE LA SECCION 11, UNA DISTANCIA DE 1888.48 PIES HASTA EL PUNTO VERDADERO DE COMIENZO;

DE ALLI AL SUR 89 GRADOS 56 MINUTOS 51 SEGUNDOS ESTE A LO LARGO DE LA LINEA MEDIA ESTE-OESTE DE LA SECCION 11, UNA DISTANCIA DE 751.25 PIES HASTA UNA TUBERIA DE 1" ENCONTRADA, DICHA TUBERIA SIENDO LA ESQUINA ESTE DEL CUARTO DE LA SECCION 11;

LUEGO SUR 00 GRADOS 01 MINUTO 00 SEGUNDOS ESTE, UNA DISTANCIA DE 1449.58 PIES HASTA UNA CLAVIJA DE HIERRO Y TAPA ENCONTRADA (R.L.S. #16528);

LUEGO NORTE 89 GRADOS 56 MINUTOS 51 SEGUNDOS OESTE, UNA DISTANCIA DE 781.25 PIES;

DE ALLI NORTE 00 GRADOS 01 MINUTO 00 SEGUNDOS NORTE, UNA DISTANCIA DE 1409.58 PIES HASTA UN PUNTO 40.00 PIES AL SUR DE LA LINEA MEDIA ESTE-OESTE DE DICHA SECCION 11, DICHO PUNTO ESTANDO TAMBIEN A LO LARGO DE LA LINEA SUR DEL DERECHO DE PASO DE SAN LUIS LANE;

DE ALLI SUR 89 GRADOS 56 MINUTOS 51 SEGUNDOS ESTE A LO LARGO DE LA LINEA SUR DEL DERECHO DE PASO DE SAN LUIS LANE, UNA DISTANCIA DE 30.00 PIES;

DE ALLI NORTE 00 GRADOS 01 MINUTO 00 SEGUNDOS NORTE, UNA DISTANCIA DE 40.00 PIES HASTA EL PUNTO VERDADERO DE COMIENZO;

EXCEPTO LOS 33 PIES DEL ESTE COMO TRANSMITIDO AL CONDADO DE YUMA EN EL INSTRUMENTO REGISTRADO COMO TOMO 686, PAGINA 893; Y

EXCEPTO 1/16 DE TODO EL PETROLEO, GASES Y OTRAS SUSTANCIAS HIDROCARBONADAS, CARBON, PIEDRA, METALES, MINERALES, FOSILES Y FERTILIZANTES DE TODO NOMBRE Y DESCRIPCION Y EXCEPTO TODOS LOS MATERIALES QUE PUEDAN SER ESENCIALES PARA LA PRODUCCION DE MATERIAL FISIONABLE COMO RESERVADO EN LOS ESTATUTOS REVISADOS DE ARIZONA; Y

EXCEPTO 1/4 DE TODO EL PETROLEO, GAS Y OTROS MINERALES COMO RESERVADO EN LA ESCRITURA REGISTRADA COMO TOMO 1351, PAGINA 289, REGISTRO DEL CONDADO DE YUMA, ARIZONA.

PREGUNTA NUM. 1
ARGUMENTOS A FAVOR/EN CONTRA

ARGUMENTOS A FAVOR:

XXXX

ARGUMENTOS EN CONTRA:

XXXX

PRESORTED STD
U.S. POSTAGE
PAID
TUCSON, AZ
PERMIT NO. 690



OFFICIAL VOTING MATERIALS - ONLY ONE PAMPHLET HAS BEEN MAILED TO EACH HOUSEHOLD CONTAINING A REGISTERED VOTER. PLEASE MAKE IT AVAILABLE TO ALL REGISTERED ELECTORS IN THE HOUSEHOLD.

MATERIALES OFICIALES ELECTORALES - SOLAMENTE UN FOLLETO SE HA ENVIADO A CADA DOMICILIO EN EL CUAL RESIDE UN ELECTOR REGISTRADO. FAVOR DE UTILIZARLO PARA TODOS LOS ELECTORES REGISTRADOS EN SU DOMICILIO.