

# Greenfield Village

## Units 1 & 2

- Chip seal
- Provides a new driving surface
- Spot drainage (valley gutters) and base repairs and chip seal



City of Schertz  
Greenfield Village Units 1 & 2

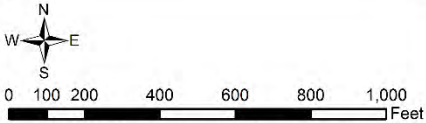

This product is for informational purposes and may not have been prepared for or be suitable for legal, engineering, or surveying purposes. It does not represent an on-the-ground survey and represents only the approximate relative location of property boundaries.

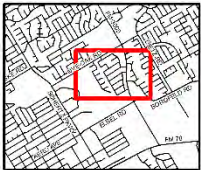

# The Estates at Wilson's Preserve

- Chip seal
- Provides a new driving surface
- Localized base repairs

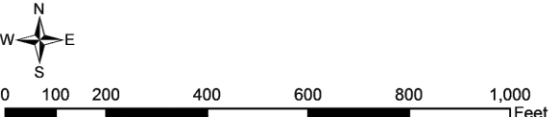

This product is for informational purposes and may not have been prepared for or be suitable for legal, engineering, or surveying purposes. It does not represent an on-the-ground survey and represents only the approximate relative location of property boundaries.

City of Schertz  
The Estates at Wilson's Preserve



# Deer Haven

Units 1, 2, & 3

- Chip seal
- Provides a new driving surface
- Localized base repairs

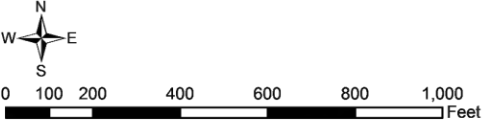

This product is for informational purposes and may not have been prepared for or be suitable for legal, engineering, or surveying purposes. It does not represent an on-the-ground survey and represents only the approximate relative location of property boundaries.

City of Schertz  
Deer Haven Units 1,2 & 3



# Lone Oak

## Units 1 & 2

- Chip seal
- Provides a new driving surface
- Localized base repairs

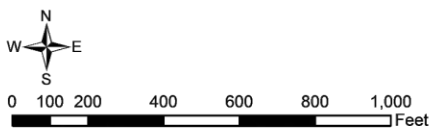
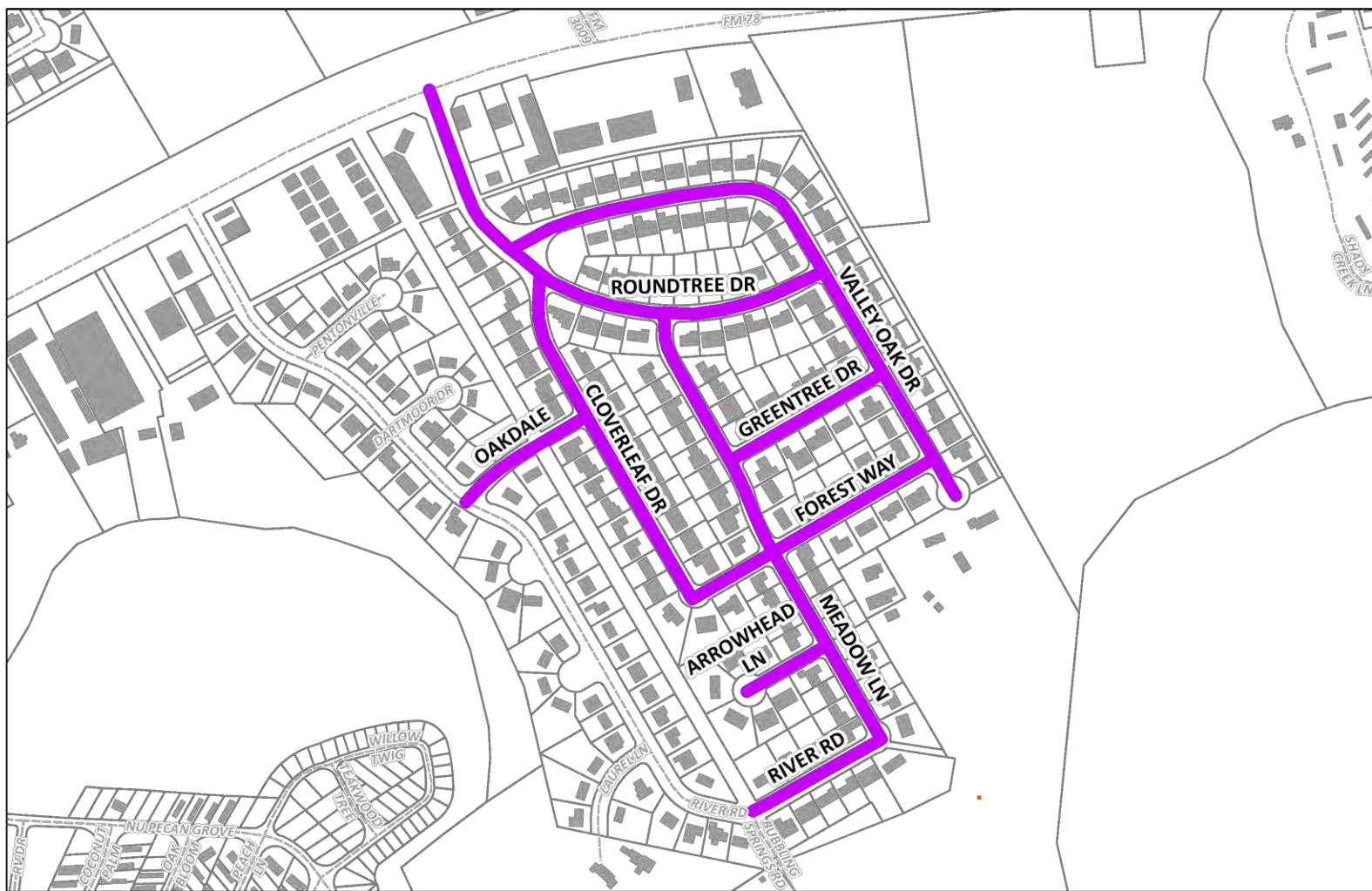

City of Schertz  
Lone Oak Units 1 & 2



This product is for informational purposes and may not have been prepared for or be suitable for legal, engineering, or surveying purposes. It does not represent an on-the-ground survey and represents only the approximate relative location of property boundaries.

# Live Oak Road



## City of Schertz Live Oak Road



This product is for informational purposes and may not have been prepared for or be suitable for legal, engineering, or surveying purposes. It does not represent an on-the-ground survey and represents only the approximate relative location of property boundaries.

- Completes earlier effort
- Will need to coordinate with Parks MPO project
- Spot base repairs; asphalt leveling; and chip seal

# Randolph Avenue



- “Prep work” already completed by Public Works
- Provides a new driving surface
- Chip seal

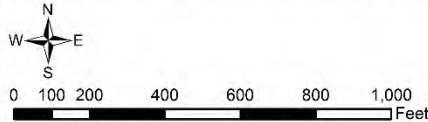

City of Schertz  
Curtiss Avenue

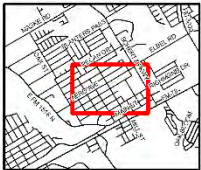

This product is for informational purposes and may not have been prepared for or be suitable for legal, engineering, or surveying purposes. It does not represent an on-the-ground survey and represents only the approximate relative location of property boundaries.

# Curtiss Avenue

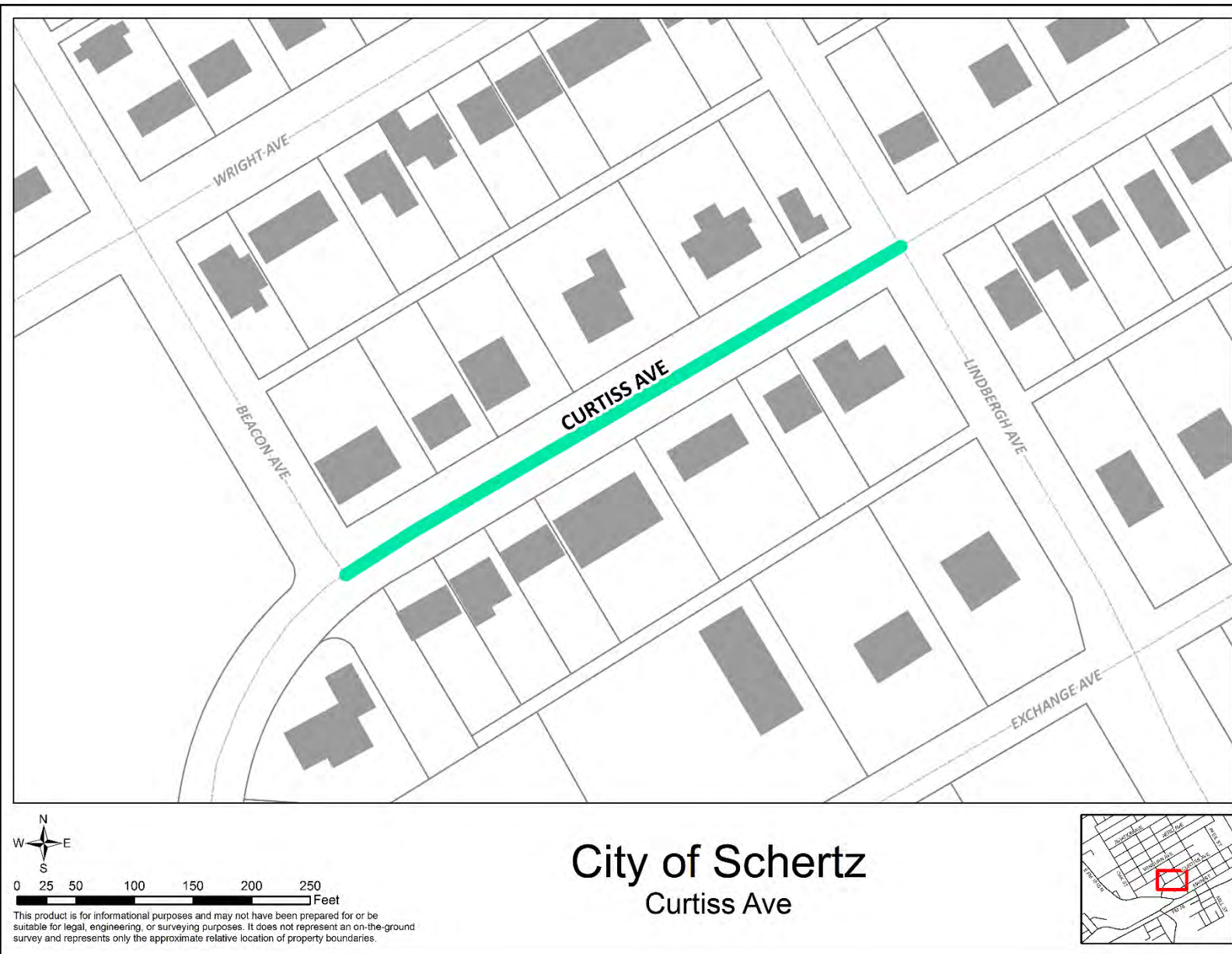

Completes the “list” from the PCI report

Spot base repairs; crack sealing; and chip seal