

TRACT 1: 2.010 ac

FIELD NOTES

September 18, 2019

BEING 2.010 acres of land, more or less, out of the Julian Diaz Survey No. 66, Abstract 187, County Block 5059, Bexar County, Texas and also being out of a 4.991 acre tract described in Volume 8354, . Pag 909 of the Real Property Records of Bexar County, Texas and being more particularly described as follows:

BEGINNING at an iron rod found in the common line with a 5.000 acre tract described in Volume 14514, Page 528 of the Real Property Records of Bexar County, Texas for the most southerly corner of this tract and the most southerly corner of the above reference 4.991 acre tract, said point also being the most easterly corner of a 4.000 acre tract described in Volume 8354, Page 460 of the Real Property Records of Bexar County, Texas;

THENCE, N 30°00'54" W, (*N 30 °20'23" W-8354/460*) 119.06 feet generally along an existing wire fence and the common line with said 4.000 acre tract to an iron found in same for a corner of this tract and the most southerly corner of a 0.50 acre tract described in Volume 9392, Page 1253 of the Real Property Records of Bexar County, Texas;

THENCE, N 59°50'29" E, 170.29 feet (*N 59 °35'37" E, 168.32 feet-9392/1253*) along the common line with said 0.50 acre tract to an iron rod found for an interior corner of this tract and the most easterly corner of said 0.50 acre tract;

THENCE, N 30°23'56" W, 129.62 feet (*N 30 °21'45" W, 129.45 feet-9392/1253*) along the common line with said 0.50 acre tract to an iron rod found in the common line with a 9.977 acre tract described in Volume 18693, Page 578 of the Real Property Records of Bexar County, Texas for a corner of this tract and the most northerly corner of said 0.50 acre tract;

THENCE, N 59°37'47" E, (*N 59 °39'37" E-8354/909*) 271.61 feet generally along an existing wire fence and the common line with said 9.977 acre tract to a metal fence corner post found for the most northerly corner of this tract and the most westerly corner of a 2.49 acre tract described in Volume 16138, Page 967 of the Real Property Records of Bexar County, Texas;

THENCE, S 29°54'52" E, 248.79 feet (*S 30 °19'18" E, 248.25 feet-16138/967*) generally along an existing wire fence and the common line with said 2.49 acre tract, crossing said 4.991 acre tract to an iron rod found in the common line with a 15.00 acre tract described in Volume 18733, Page 1544 of the Real Property Records of Bexar County, Texas for the most easterly corner of this tract and the most southerly corner of said 2.49 acre tract;

THENCE, S 59°42'23" W, (*S 59 °40'39" W-8354/909*) 251.17 feet along the common line with said 15.00 acre tract to an iron rod found for an angle point of this tract and the most northerly corner of said 5.000 acre tract;

THENCE, S 59°44'20" W, (*S 59 °40'39" W-8354/909*) 189.42 feet along the common lline with said 5.000 acre tract to the POINT OF BEGINNING and containing 2.010 acres of land, more or less.

Note: Plat also prepared this day.

J. M. Butz, Jr.
Registered Professional Land Surveyor
No. 2024



FN19-149

EXHIBIT 1

TRACT 2: 0.504

FIELD NOTES

August 11, 2017

BEING 0.504 acre of land, more or less, out of the Julian Diaz Survey No. 66, Abstract 187, County Block 5059, Bexar County, Texas and being described as a 0.50 acre tract in Volume 9392, Page 1253 of the Real Property Records of Bexar County, Texas and being more particularly described as follows:

BEGINNING at an iron rod found in the common line with a 10.000 acre tract described in Volume 13868, Page 1327 of the Real Property Records of Bexar County, Texas for the most westerly corner of this tract and the most westerly corner of said 0.50 acre tract, said point also being the most northerly corner of a 4.000 acre tract described in Volume 8354, Page 460 of the Real Property Records of Bexar County, Texas;

THENCE, N 59°37'47" E, 169.42 feet (*N 59°35'19" E, 168.41 feet-9392/1253*) generally along an existing fence and the common line with said 10.000 acre tract to an iron rod found in same for the most northerly corner of this tract and the most northerly corner of said 0.50 acre tract, said point being S 59°37'47" E, 881.93 feet from an iron rod found in the existing southwest R.O.W. line of F. M. Highway 1518 for the most easterly corner of said 10.000 acre tract;

THENCE, S 30°23'56" E, 129.65 feet (*S 30°21'45" E, 129.45 feet-9392/1253*) along the common line with the remaining portion of a 4.991 acre tract described in Volume 8354, Page 909 of the Real Property Records of Bexar County, Texas to an iron rod found for the most easterly corner of this tract and the most easterly corner of said 0.50 acre tract;

THENCE, S 59°50'29" W, 170.29 feet (*S 59°35'37" W, 168.32 feet-9392/1253*) along the common line with the remaining portion of said 4.991 acre tract to an iron rod found in the common line with said 4.000 acre tract;

THENCE, N 30°00'54" W, 129.02 feet (*N 30°24'04" W, 129.24 feet-9392/1253*) generally along an existing fence and the common line with said 4.000 acre tract to the POINT OF BEGINNING and containing 0.504 acre of land, more or less.

Note: Plat also prepared this day.

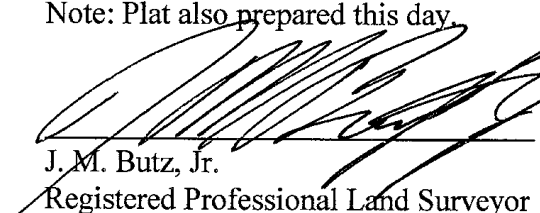
J. M. Butz, Jr.
Registered Professional Land Surveyor
No. 2024

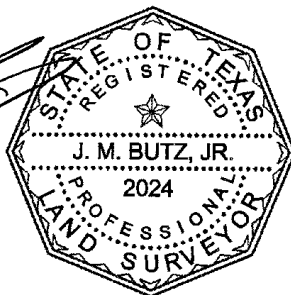

FN17-127

EXHIBIT 2

TRACT 3: 9.977 ac

FIELD NOTES

July 27, 2017

BEING 9.977 acres of land, more or less, out of the Julian Diaz Survey No. 66, Abstract 187, County Block 5059, Bexar County, Texas and also being described as a 10.00 acre tract in Volume 13868, Page 1327 of the Real Property Records of Bexar County, Texas and being more particularly described as follows:

BEGINNING at an iron rod found in the existing southwest R.O.W. line of F. M. Highway 1518 for the most easterly corner of this tract and the most easterly corner of the above referenced 10.00 acre tract, said point also being the most northerly corner of a 1.000 acre tract described in Volume 11742, Page 1697 of the Real Property Records of Bexar County, Texas;

THENCE, S 59°43'33" W, (S 59°39'04" W-13868/1327) 434.47 feet (S 59°46'11" W, 435.60 feet-11742/1697) generally along an existing fence and the common line with said 1.000 acre tract to an iron rod found for the an angle point of this tract and the most westerly corner of said 1.000 acre tract;

THENCE, S 59°37'47" W, (S 59°39'04" W-13868/1327) 616.88 feet (S 59°39'37" W, 615.98 feet-8354/909) generally along an existing fence and the common line with a 2.49 acre tract described in Volume 16138, Page 967 of the Real Property Records of Bexar County, Texas: the remaining portion of a 4.991 acre tract described in Volume 8354, Page 909 of the Real Property Records of Bexar County, Texas and the common line with a 0.500 acre tract described in Volume 10187, Page 27 of the Real Property Records of Bexar County, Texas to an iron rod found for an angle point of this tract and the most westerly corner of said 0.500 acre tract;

THENCE, S 59°37'09" W, (S 59°39'04" W-13868/1327) 698.97 feet (S 59°39'37" W, 700.04 feet-8354/460) generally along an existing fence and the common line with a 4.000 acre tract described in Volume 8354, Page 460 of the Real Property Records of Bexar County, Texas to an iron rod found for the most southerly corner of this tract and the most westerly corner of said 4.000 acre tract;

THENCE, N 28°59'16" W, 249.16 feet (N 29°00'13" W, 248.80 feet-13868/1327) generally along an existing fence and the common line with a 9.968 acre tract described in Volume 9231, Page 2119 of the Real Property Records of Bexar County, Texas to an iron rod found in the common line with a 145.427 acre tract described in Volume 11564, Page 1814 of the Real Property Records of Bexar County, Texas for the most westerly corner of this tract and the most northerly corenr of said 9.968 acre tract;

THENCE, N 59°39'37" E, 1745.68 feet (Ref. Brg. N 59°39'37" E, 1745.52 feet-13868/1327) generally along an existing fence and the common line with said 145.427 acre tract to an iron rod found in the existing southwest R.O.W. line of F. M. Highway 1518 for the most northerly corner of this tract and the most easterly corner of said 145.427 acre tract;

THENCE, S 30°03'26" E, 248.76 feet (S 30°11'36" E, 248.45 feet-13868/1327) along said southwest R.O.W. line to the POINT OF BEGINNING and containing 9.977 acres of land, more or less.

Note: Plat also prepared this day

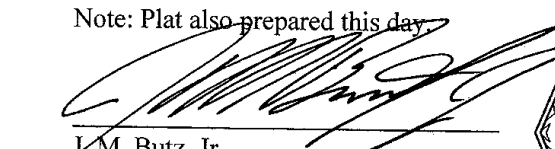
J. M. Butz, Jr.
Registered Professional Land Surveyor
No. 2024

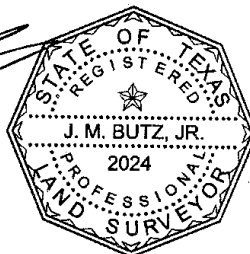

FN17-124

EXHIBIT 3

TRACT 4: 14.994 ac

FIELD NOTES

August 11, 2017

BEING 14.994 acres of land, more or less, out of the Julian Diaz Survey No. 66, Abstract 187, County Block 5059, Bexar County, Texas and being comprised of a 10.000 acre tract described in Volume 1638, Page 193 of the Real Property Records of Bexar County, Texas and 4.994 acres out of a 10.000 acre tract described in Volume 1599, Page 315 of the Real Property Records of Bexar County, Texas and being more particularly described as follows:

BEGINNING at an iron rod found in the existing southwest R.O.W. line of F. M. Highway 1518 for the most northerly corner of this tract and the most northerly corner of said 10.000 acre tract described in Volume 1599, Page 315, said point also being the most easterly corner of a 2.49 acre tract described in Volume 16138, Page 967 of the Real Property Records of Bexar County, Texas;

THENCE, S 30°05'54" E, (*S 30°16'00" E-1599/315*) along said southwest R.O.W. line passing the most easterly corner of said 10.000 acre tract described in Volume 1599, Page 315 at 247.71 feet and continuing a total distance of 494.33 feet to an iron rod found in same for the most easterly corner of this tract and the most easterly corner of said 10.000 acre tract described in Volume 1638, Page 193;

THENCE, S 59°42'25" W, 1767.14 feet (*S 59°39'37" W, 1766.07 feet-1638/193*) generally along an existing fence and the common line with a 10.000 acre tract described in Volume 1839, Page 504 of the Real Property Records of Bexar County, Texas; Lot 1, Block 2 of Boenig Subdivision as recorded in Volume 8600, Page 159 of the Deed and Plat Records of Bexar County, Texas and a 14.199 acre tract described in Volume 17653, Page 2384 of the Real Property Records of Bexar County, Texas to an iron rod found in the common line with a 10.000 acre tract described in Volume 10054, Page 1692 of the Real Property Records of Bexar County, Texas for the most southerly corner of this tract and the most southerly corner of said 10.000 acre tract described in Volume 1638, Page 193;

THENCE, N 28°58'19" W, 246.78 feet (*N 29°06'11" W, 247.05 feet-1638/193*) generally along an existing fence and the common line with said 10.000 acre tract described in Volume 10054, Page 1692 to an iron rod set for the most westerly corner of this tract and the most westerly corner of said 10.000 acre tract described in Volume 1638, Page 193, and also being the most southerly corner of a 5.000 acre tract described in Volume 14514, Page 528 of the Real Property Records of Bexar County, Texas;

THENCE, N 59°44'23" E, 795.24 feet (*N 59°39'37" E, 794.80 feet-14514/528*) along the common line with said 5.000 acre tract to an iron rod set for a corner of this tract and a corner of said 5.000 acre tract and the beginning of a curve to the right;

THENCE, along the common line with said 5.000 acre tract in a northeasterly direction and having a central angle of 141°03'36" , a radius of 50.00 feet (*50.00 feet-14514/528*), a tangent distance of 141.43 feet, an arc length of 123.10 feet (*122.17 feet-14514/528*) and chord bearing and distance of N 39°37'07" E, 94.28 feet (*N 39°39'27" E, 93.97 feet-14514/528*) to an iron rod set for the end of this curve and the beginning of a curve to the left;

TRACT 4

Page 2 (14.994 acres)

THENCE, along the common line with said 5.000 acre tract in an easterly direction and having a central of $49^{\circ}55'25''$, a radius of 20.00 feet, (*20.00 feet-14514/528*) a tangent distance of 9.31 feet, an arc length of 17.43 feet, (*17.45 feet-14514/528*) and a chord bearing an distance of $N 84^{\circ}41'46'' E$, 16.88 feet (*N 84^{\circ}39'12'' E, 16.90 feet-14514/528*) to an iron rod found for the end of this curve and a corner of this tract and a corner of said 5.000 acre tract, said point also being a corner of a 50' Ingress-Egress Easement described in Volume 14514, Page 528 of the Real Property Records of Bexar County, Texas;

THENCE, $N 30^{\circ}17'43'' W$, 222.81 feet (*N 30^{\circ}20'57'' W, 220.70 feet-14514/528*) along the common line with said 5.000 acre tract to an iron rod found in the common line with a 4.991 acre tract described in Volume 8354, Page 909 of the Real Property Records of Bexar County, Texas for a corner of this tract and the most northerly corner of said 5.000 acre tract;

THENCE, $N 59^{\circ}42'23'' E$, (*N 59^{\circ}39'37'' E-1599/315*) 864.04 feet generally along an existing fence and the common line with said 4.991 acre tract and said 2.49 acre tract to the POINT OF BEGINNING and containing 14.994 acres of land, more or less.

Note: Plat also prepared this day

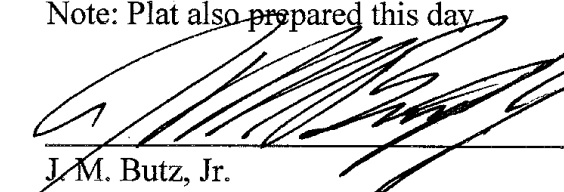

J. M. Butz, Jr.
Registered Professional Land Surveyor
No. 2024

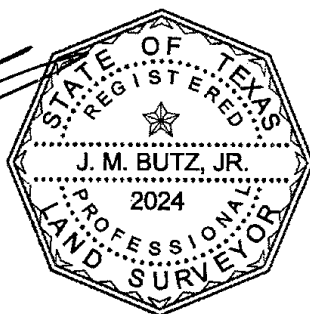

FN17-126.1

TRACT 5: 3.987 ac

FIELD NOTES

August 11, 2017

BEING 3.987 acres of land, more or less, out of the Julian Diaz Survey No. 66, Abstract 187, County Block 5059, Bexar County, Texas and being described as a 4.000 acre tract in Volume 8354, Page 460 of the Real Property Records of Bexar County, Texas and being more particularly described as follows:

BEGINNING at an iron rod found in the common line with a 10.000 acre tract described in Volume 13868, Page 1327 of the Real Property Records of Bexar County, Texas for the most northerly corner of this tract and the most northerly corner of the above referenced 4.000 acre tract, said point also being the most westerly corner of a 0.50 acre tract described in Volume 9392, Page 1253 of the Real Property Records of Bexar County, Texas;

THENCE, S 30°00'54" E, (*S 30°20'23" E-8354/460*) generally along an existing fence and the common line with said 0.50 acre tract passing an iron rod found at 129.02 feet (*129.24 feet-9392/1253*) and continuing along the common line with the remaining portion of a 4.991 acre tract described in Volume 8354, Page 909 of the Real Property Records of Bexar County, Texas a total distance of 248.09 feet (*248.10 feet-8354/460*) to an iron rod found in the common line with a 5.000 acre tract described in Volume 14514, Page 528 of the Real Property Records of Bexar County, Texas for the most easterly corner of this tract and the most easterly corner of said 4.000 acre tract;

THENCE, S 59°42'15" W, 703.95 feet (*S 59°42'11" W, 706.03 feet-8354/460*) along the common line with said 5.000 acre tract to an iron rod found in the common line with a 10.000 acre tract described in Volume 10054, Page 1692 of the Real Property Records of Bexar County, Texas for the most southerly corner of this tract and the most southerly corner of said 4.000 acre tract;

THENCE, N 28°51'36" W, 247.13 feet (*N 28°57'15" W, 247.65 feet-8354/460*) generally along an existing fence and the common line with said 10.000 acre tract and a 9.968 acre tract described in Volume 9231, Page 2119 of the Real Property Records of Bexar County, Texas to an iron rod found in same for the most westerly corner of this tract and the most westerly corner of said 4.000 acre tract, said point also being the most southerly corner of said 10.000 acre tract described in Volume 13868, Page 1327;

THENCE, N 59°37'09" E, 698.97 feet (*N 59°39'37" E, 700.04 feet-8354/460*) generally along an existing fence and the common line with said 10.000 acre tract to the POINT OF BEGINNING and containing 3.987 acres of land, more or less.

Note: Plat also prepared this day.

J. M. Butz, Jr.
Registered Professional Land Surveyor
No. 2024

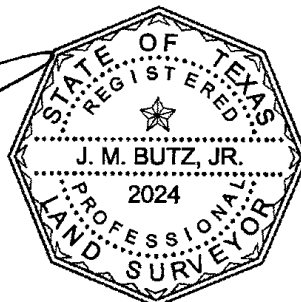

FN17-126.2

EXHIBIT 5

TRACT 6: 5.01 ac

STATE OF TEXAS COUNTY OF BEXAR

Field note description of a 5.01 acre tract of land out of the Julian Diaz Survey No. 66, Abstract No. 187, County Block 5059 in Bexar County, Texas. Said 5.01 acre tract of land being the same land as described in a Corrective Foreclosure Sale Deed to U.S. Bank, N.A. as Trustee for the Registered Holders of Structured Asset Securities Corporation Mortgage Pass-through Certificates, Series 2007-TC1, recorded in Volume 14514, Page 528 of the Official Public Records of Bexar County, Texas. Said 5.01 acre tract of land also being out of a called 10.0 acre tract of land as described in a Deed to Salustiano A. Pino, recorded in Volume 1599, Page 315 of the Official Public Records of Bexar County, Texas. Said 5.01 acre tract of land being more particularly described by metes and bounds as follows:

COMMENCING at a one half inch iron rod found on the southwest right-of-way line of F.M. Highway 1518 (80' ROW), for the north corner of a called 10.0 acre tract of land as described in a deed to Roy B. Juarez and wife Edna M. Juarez, recorded in Volume 1839, Page 504 of the Deed Records of Bexar County, Texas.

THENCE along the southwest right-of-way line of F.M. Highway 1518, North 30° 32' 00" West, a distance of 247.59 feet to a "x" found in concrete in the center of a fifty-foot wide ingress and egress easement and being the east corner of a called 10.000 acre tract of land as described in a deed to Salustiano A. Pino, recorded in Volume 1599, Page 315 of the Deed Records of Bexar County, Texas, and North 30° 32' 00" West, a distance of 247.65 feet to a "x" found for the north corner of the aforesaid 10.000 acre tract of land.

THENCE along the northwest line of the aforesaid 10.000 acre tract of land, South 59° 13' 49" West, a distance of 663.70 feet to a one half inch iron rod found for the north corner and point of **BEGINNING** of the herein described 5.01 acre tract of land.

THENCE cutting into the aforesaid 10.000 acre tract of land, **South 30° 48' 21" East**, a distance of **222.73** feet, (record being South 30° 20' 57" East, a distance of 220.70 feet) to a one half inch iron rod found for the east corner of this tract and being the P.C. of a curve to the right.

THENCE with said curve to the right (whose radius is 20.00 feet, central angle is 49° 59' 06" and whose chord bears South 84° 11' 48" West, a distance of 16.90 feet) an arc distance of 17.45 feet to a one half inch iron rod set for the P.R.C. of a curve to the left.

THENCE with said curve to the left (whose radius is 50.00 feet, central angle is 139° 44' 10" and whose chord bears South 39° 19' 16" West, a distance of 93.89 feet) an arc distance of 121.94 feet to a one half inch iron rod set for the end of the curve and being on the southeast line of the aforesaid 10.000 acre tract of land.

THENCE with the southeast line of the aforesaid 10.000 acre tract, **South 59° 13' 31" West**, a distance of **795.26 feet**, (record being South 59° 39' 37" West, a distance of 794.80 feet) to a one half inch iron rod found for the south corner of this tract, same being the south corner of the aforesaid 10.000 acre tract of land.

THENCE with the southwest line of this tract and the northeast line of a tract of land as conveyed to Jennifer Varelans, recorded in Volume 10054, Page 1692 of the Official Public Records of Bexar County, Texas, **North 29° 23' 43" West**, a distance of **248.54** feet (record being North 29° 06' 10" West, a distance of 245.77 feet) to a one half inch iron rod found for the west corner of this tract and the south corner of a tract of land as conveyed to Salustiano A Pino, recorded in Volume 8354, Page 460 of the Official Public Records of Bexar County, Texas.

THENCE with the northwest line of this tract and the southeast line of the Salustiano A. Pino tract, **North 59° 17' 02" East**, a distance of **892.76** feet (record being North 59° 39' 37" East, a distance of 893.07 feet) to a the **POINT OF BEGINNING**.

TRACT 6

STATE OF TEXAS COUNTY OF BEXAR

Field note description of a non-exclusive ingress and egress easement over a 1.18 acre tract of land out of the Julian Diaz Survey No. 66, Abstract No. 187, County Block 5059 in Bexar County, Texas. Said ingress and egress easement being the same easement as described in a Corrective Foreclosure Sale Deed to U.S. Bank, N.A. as Trustee for the Registered Holders of Structured Asset Securities Corporation Mortgage Pass-through Certificates, Series 2007-TC1, recorded in Volume 14514, Page 528 of the Official Public Records of Bexar County, Texas. Said ingress and egress easement being partially out of a called 10.0 acre tract of land as described in a Deed to Salustiano A. Pino, recorded in Volume 1599, Page 315 of the Official Public Records of Bexar County, Texas. Said ingress and egress easement being more particularly described by metes and bounds as follows:

COMMENCING at a one half inch iron rod found on the southwest right-of-way line of F.M. Highway 1518 (80' ROW), for the north corner of a called 10.0 acre tract of land as described in a deed to Roy B. Juarez and wife Edna M. Juarez, recorded in Volume 1839, Page 504 of the Deed Records of Bexar County, Texas.

THENCE along the southwest right-of-way line of F.M. Highway 1518, **North 30° 32' 00" West**, a distance of **247.59** feet to a point for the center of a fifty foot wide ingress and egress easement and being the point of **BEGINNING** of the herein described ingress and egress easement.

Thence continuing along the southwest right-of-way line of F.M. Highway 1518, **North 30° 32' 00" West**, a distance of **25.32** feet to a point for the north corner of this ingress and egress easement.

THENCE along the northwest line of this ingress and egress easement, **South 59° 12' 13" West**, a distance of **862.65** feet to a point for the P.C. of a curve to the right.

THENCE with said curve to the right (whose radius is 20.00 feet, central angle is 49° 59' 06" and whose chord bears South 84° 11' 48" West, a distance of 16.90 feet) an arc distance of 17.45 feet to a one half inch iron rod set for the P.R.C. of a curve to the left.

THENCE with said curve to the left (whose radius is 50.00 feet, central angle is 139° 44' 10" and whose chord bears South 39° 19' 16" West, a distance of 93.89 feet) an arc distance of 121.94 feet to a one half inch iron rod set for the P.C.C. of the curve and being on the southeast line of the aforesaid 10.000 acre tract of land.

THENCE continuing with said curve to the left (whose radius is 50.00 feet, central angle is 140° 15' 24" and whose chord bears North 79° 19' 28" East, a distance of 94.05 feet) an arc distance of 122.40 feet to a point for the P.R.C. of a curve to the right.

THENCE with said curve to the right (whose radius is 20.00 feet, central angle is 49° 59' 26" and whose chord bears North 84° 11' 29" East, a distance of 16.90 feet) an arc distance of 17.45 feet to a point for the P.T. of the curve.

THENCE with the southeast line of this ingress and egress easement, **North 59° 12' 13" East**, a distance of **862.41** feet to a point on the southwest right-of-way line of F.M. Highway 1518.

THENCE along the southwest right-of-way line of F.M. 1518, **North 30° 32' 00" West**, a distance of **24.67** feet to the **POINT OF BEGINNING**.

TRACT 7: 20.003 ac

FIELD NOTES

August 11, 2017

BEING 20.003 acres of land, more or less, out of the Julian Diaz Survey No. 66, Abstract 187, County Block 5059, Bexar County, Texas and being comprised of a 9.968 acre tract described in Volume 9231, Page 2119 and a 10.000 acre tract described in Volume 10054, Page 1692, both in the Real Property Records of Bexar County, Texas and being more particularly described as follows:

BEGINNING at an iron rod found in the existing northeast R.O.W. line of Ware-Seguin Road for the most southerly corner of this tract and the most southerly corner of the above referenced 10.000 acre tract, said point also being the most westerly corner of Lot 2 of the Boenig Subdivision, Unit 1 as recorded in Volume 7800, Page 85 of the Deed and Plat Records of Bexar County, Texas;

THENCE, N 40°41'55" W, 85.28 feet (*N 40°48'00" W, 85.28 feet-10054/1692*) along said northeast R.O.W. line to an iron rod set in same for an angle point of this tract;

THENCE, N 33°11'23" W, 30.62 feet (*N 28°54'23" W, 30.64 feet-10054/1692*) along said northeast R.O.W. line to an iron rod set for an interior corner of this tract, and the common corner with said 9.968 acre tract;

THENCE, S 58°29'07" W, 30.44 feet (*S 58°27'31" W, 30.41 feet-9231/2119*) along the northwest R.O.W. line of said Ware-Seguin Road to an iron rod set for a corner of this tract and the southerly corner of said 9.968 acre tract;

THENCE, N 28°56'17" W, 1598.70 feet (*N 29°06'10" W, 1598.01 feet-9231/2119*) generally along an existing fence and the common line with a 91.288 acre tract described in Volume 11601, Page 2280 of the Real Property Records of Bexar County, Texas to an iron rod found for the most westerly corner of this tract and the most westerly corner of said 9.968 acre tract;

THENCE, N 59°59'10" E, 509.96 feet (*N 59°39'37" E, 509.12 feet-9231/2119*) generally along an existing fence and the common line with a 145.276 acre tract described in Volume 11564, Page 1814 of the Real Property Records of Bexar County, Texas to an iron rod found for the most northerly corner of this tract and the most northerly corner of said 9.968 acre tract, said point also being the most westerly corner of a 10.000 acre tract described in Volume 13868, Page 1327 of the Real Property Records of Bexar County, Texas;

THENCE, S 28°59'16" E, 249.16 feet (*S 28°00'13" E, 248.80 feet-13868/1327*) generally along an existing fence and the common line with said 10.000 acre tract to an iron rod found for an angle point of this tract and the most southerly corner of said 10.000 acre tract;

THENCE, S 28°51'36" E, 247.12 feet (*S 28°57'15" E, 247.65 feet-8354/460*) generally along an existing fence and the common line with a 4.000 acre tract described in Volume 8354, Page 460 of the Real Property Records of Bexar County, Texas to an iron rod found for an angle point of this tract and the most southerly corner of said 4.000 acre tract;

TRACT 7

Page 2 (20.003 acre tract)

THENCE, S 28°58'19" E, (S 29°06'10" E-10054/1692) 494.53 feet generally along an existing fence and the common line with a 5.000 acre tract described in Volume 14514, Page 528 of the Real Property Records of Bexar County, Texas and a 10.000 acre tract described in Volume 1638, Page 193 of the Real Property Records of Bexar County, Texas to an iron rod found for an angle point of this tract and the most southerly corner of said 10.000 acre tract;

THENCE, S 29°02'59" E, (S 29°06'10" E-10054/1692) 730.22 feet generally along an existing fence and the common line with a 14.199 acre tract described in Volume 17653, Page 2384 of the Real Property Records of Bexar County, Texas to an iron rod found for the most easterly corner of this tract and the most easterly corner of the 10.00 acre tract described in Volume 10054, Page 1692 of the Real Property Records of Bexar County, Texas, said point also being the most northerly corner of said Lot 2 of the Boenig Subdivision, Unit 1;

THENCE, S 61°04'30" W, 461.40 feet (S 61°58'25" W, 461.71 feet-10054/1692) generally along an existing fence and the common line with said Lot 2 to the POINT OF BEGINNING and containing 20.003 acres of land, more or less.

Note: Plat also prepared this day.

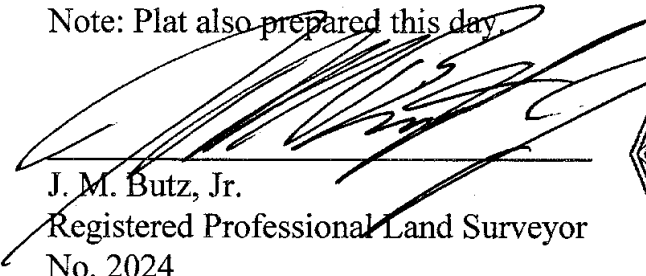

J. M. Butz, Jr.
Registered Professional Land Surveyor
No. 2024

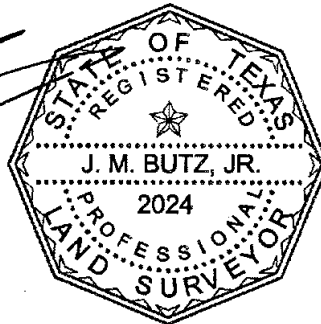

FN17-125

TRACT 8: 1.00 ac

A 1.00 ACRE TRACT OUT OF THE JULIAN DIAZ SURVEY NO. 66, ABSTRACT NO. 187, COUNTY BLOCK 5059, BEXAR COUNTY, TEXAS, SAME BEING THE CALLED 1.00 ACRE TRACT, DESCRIBED IN A DEED TO SAUL MENDOZA AND LAURA MENDOZA, IN VOLUME 11742, PAGE 1697, REAL PROPERTY RECORDS OF BEXAR COUNTY, TEXAS, SAID 1.00 ACRE TRACT BEING MORE PARTICULARLY DESCRIBED IN EXHIBIT "A" ATTACHED HERETO AND MADE A PART HEREOF.

