



November 13, 2023

City of Schertz
Engineering and Public Works
11 Commercial Place
Schertz, TX 78154

Re: Waiver Request - Requirement to Connect and/or Extend Public Sanitary Sewer
Preliminary Plat Application - Schertz Logistics

To Whom it May Concern,

GarzaEMC is requesting on behalf of our client a waiver to UDC Section 21.15.3 which requires connection to a public wastewater system as per UDC Section 21.15.3.A, extension of wastewater systems to the property as per UDC Sections 21.15.3.D and a waiver of the installation of a privately owned On-Site Sewage Facility (OSSF) as per UDC Section 21.15.3.E with the Schertz Logistics Preliminary Plat Application.

This site is located on 43-acres in the 22000 Block of FM 2252, Schertz, Comal County, Texas 78154. The closest public wastewater connection available to serve the site is over 4,000 feet away from the property as shown on the attached Site Location Map. A public sanitary sewer extension is planned for this area and once that service has been extended the subdivision will then be required to connect to the public system as per Section 90-78 of the Schertz Code of Ordinances. The proposed plat lot layout is configured such that future wastewater connections can be made to the proposed system as shown on the City of Schertz Sewer Master Plan.

Sincerely,

A handwritten signature in blue ink, appearing to read 'Darren Huckert', written over a circular professional engineer seal.

Darren Huckert, P.E.
Vice President
GarzaEMC, LLC



11/13/2023

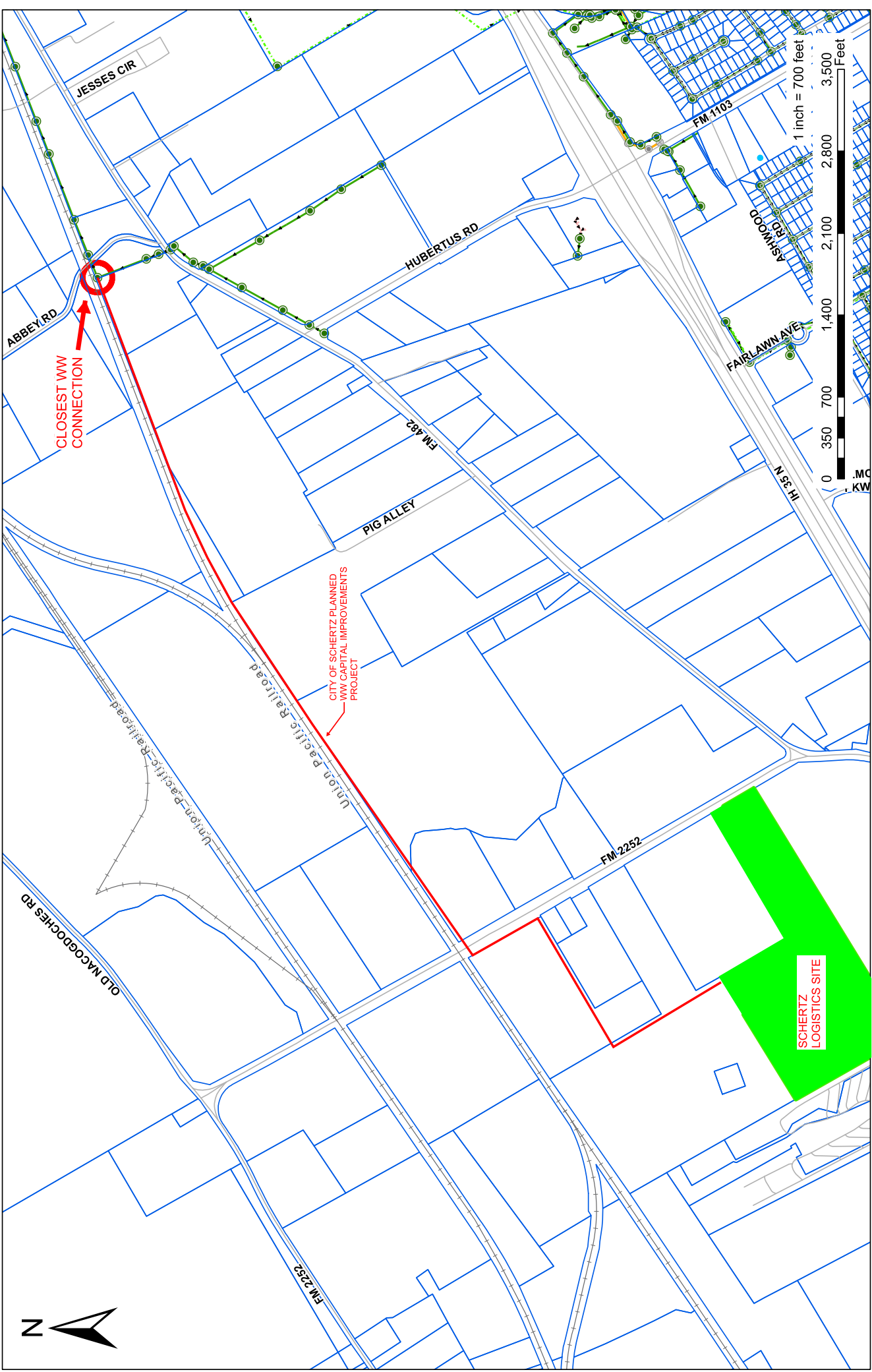

CLOSEST WW CONNECTION

CITY OF SCHERTZ PLANNED WW CAPITAL IMPROVEMENTS PROJECT

SCHERTZ LOGISTICS SITE

1 inch = 700 feet

0 350 700 1,400 2,100 2,800 3,500 Feet