

SCHWERTNER FARMS INC  
148.6 AC.  
PO BOX 1 SCHWERTNER, TX DOC. NO.  
20000394801

# GRAPHIC SCALE

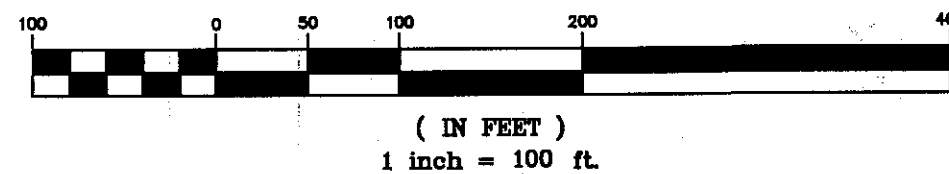

## THIBODEAUX ACRES

STATE OF TEXAS  
COUNTY OF WILLIAMSON

THAT I, MICHAEL THIBODEAUX, BEING OWNER OF THAT CERTAIN 10.012 ACRE TRACT OF LAND OUT OF MIGUEL DAVILLA SURVEY, ABSTRACT NO. 4, IN WILLIAMSON COUNTY, TEXAS, CONVEYED IN DOCUMENT NO. 2007010536, OFFICIAL RECORDS, WILLIAMSON COUNTY, TEXAS, DO HEREBY SUBDIVIDE SAID 15.004 ACRE TRACT IN ACCORDANCE WITH THE ATTACHED MAP OR PLAT TO BE KNOWN AS "THIBODEAUX ACRES" SUBJECT TO ANY EASEMENTS AND/OR RESTRICTIONS HERETOFORE GRANTED AND DO HEREBY DEDICATE TO THE PUBLIC USE OF STREETS AND EASEMENTS SHOWN HEREON. IT IS THE RESPONSIBILITY OF THE OWNER, NOT THE COUNTY, TO ASSURE COMPLIANCE WITH THE PROVISIONS OF ALL APPLICABLE STATE, FEDERAL AND LOCAL LAWS AND REGULATIONS RELATING TO THE ENVIRONMENT, INCLUDING (BUT NOT LIMITED TO) THE ENDANGERED SPECIES ACT, STATE AQUIFER REGULATIONS

WITNESS MY HAND THIS THE 11<sup>th</sup> DAY OF April, 2012 A.D.

Michael Thibodeaux  
MICHAEL THIBODEAUX  
1015 W UNIVERSITY AVE STE #420  
GEORGETOWN, TX 78628-5352  
PH. 512-825-8587

STATE OF TEXAS  
COUNTY OF WILLIAMSON

BEFORE ME, THE UNDERSIGNED AUTHORITY, ON THIS DAY PERSONALLY APPEARED MICHAEL THIBODEAUX, KNOWN TO ME TO BE THE PERSON WHOSE NAME IS SUBSCRIBED TO THE FOREGOING INSTRUMENT AND ACKNOWLEDGED TO ME THAT HE EXECUTED THE SAME IN THE CAPACITY THEREIN STATED FOR THE PURPOSES AND CONSIDERATION THEREIN EXPRESSED. GIVEN UNDER MY HAND AND SEAL OF OFFICE, THIS THE 11<sup>th</sup> DAY OF April, 2012 A.D.

Jenny Rogers  
NOTARY PUBLIC FOR THE STATE OF TEXAS  
Jenny Rogers  
(TYPE OR PRINT NAME)  
MY COMMISSION EXPIRES: 3/21/2015

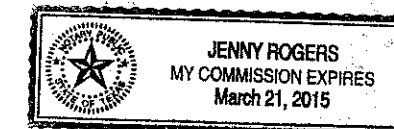

### SURVEYOR'S CERTIFICATE

I, HERMAN CRICHTON, AM AUTHORIZED UNDER THE LAWS OF THE STATE OF TEXAS TO PRACTICE THE PROFESSION OF SURVEYING AND HEREBY CERTIFY THAT THIS PLAT IS TRUE AND CORRECT, AND WAS PREPARED FROM AN ACTUAL SURVEY OF THE PROPERTY MADE BY ME OR MADE UNDER MY SUPERVISION, MADE ON THE GROUND IN MAY 2007.

NO PORTION OF THIS TRACT IS ENCLOSED BY A FLOOD AREA AS DEFINED BY FEDERAL EMERGENCY MANAGEMENT ADMINISTRATION FLOOD HAZARD BOUNDARY MAP, COMMUNITY PANEL NUMBER 481079 0175 C, EFFECTIVE DATE SEPTEMBER 27, 1991.

THIS TRACT IS NOT LOCATED WITHIN THE EDWARDS AQUIFER RECHARGE ZONE.

HERMAN CRICHTON, R.P.L.S. 4046 APRIL 8, 2012

SURVEYING BY:  
CRICHTON & ASSOCIATES, INC.  
6448 HIGHWAY 290 E. SUITE B-105  
AUSTIN, TEXAS 78723  
PH. 512-244-3395  
FAX 512-244-9508

### FIELD NOTES

FIELD NOTES FOR 10.012 ACRES OUT OF THE MIGUEL DAVILLA SURVEY, ABSTRACT NO. 4 IN WILLIAMSON COUNTY, TEXAS BEING THE SAME TRACT CONVEYED TO MICHAEL THIBODEAUX IN DOC. NO. 2007010536 OF THE OFFICIAL RECORDS OF WILLIAMSON COUNTY, TEXAS. SAID TRACT BEING MORE PARTICULARLY DESCRIBED BY METES AND BOUNDS AS FOLLOWS:

BEGINNING at a 1/2" iron pin found on the East line of County Road 363 at the Southwest corner of a 10.01 acre tract conveyed to Lydia Gonzales in Doc. No. 2007066892 of the Official Records of Williamson County, Texas for the Northwest corner of this tract and the POINT OF BEGINNING.

THENCE S 70° 06' 15" E, 1238.44 feet to a 1/2" iron pin found at the Southeast corner of said Gonzales tract, also being on the West line of a 148.6 acre tract conveyed to Schwertner Farms Inc. in Doc. No. 20000394801 of the Official Record of Williamson County, Texas for the Northeast corner of this tract.

THENCE S 19° 18' 55" W with the West line of said 148.6 acre tract, 352.19 feet to a 1/2" iron pin found at the Northeast corner of a 10.01 acre tract conveyed to Arturo Del Real in Doc. No. 2007019982 of the Official Records of Williamson County, Texas for the Southeast corner of this tract.

THENCE N 70° 00' 00" W, 1238.75 feet to a 1/2" iron pin found at the West common corner of said Del Real tract and this tract, said point being on the East R.O.W. of County Road 363 for the Southwest corner of this tract.

THENCE N 19° 51' 28" E with the East R.O.W. of County Road 363, 352.09 feet to the POINT OF BEGINNING and containing 10.012 acres more or less.

ROAD NAME AND ADDRESS ASSIGNMENTS VERIFIED THIS THE 11 DAY OF April, 2012

AUTHORIZED ADDRESS COORDINATOR Jessica Barr

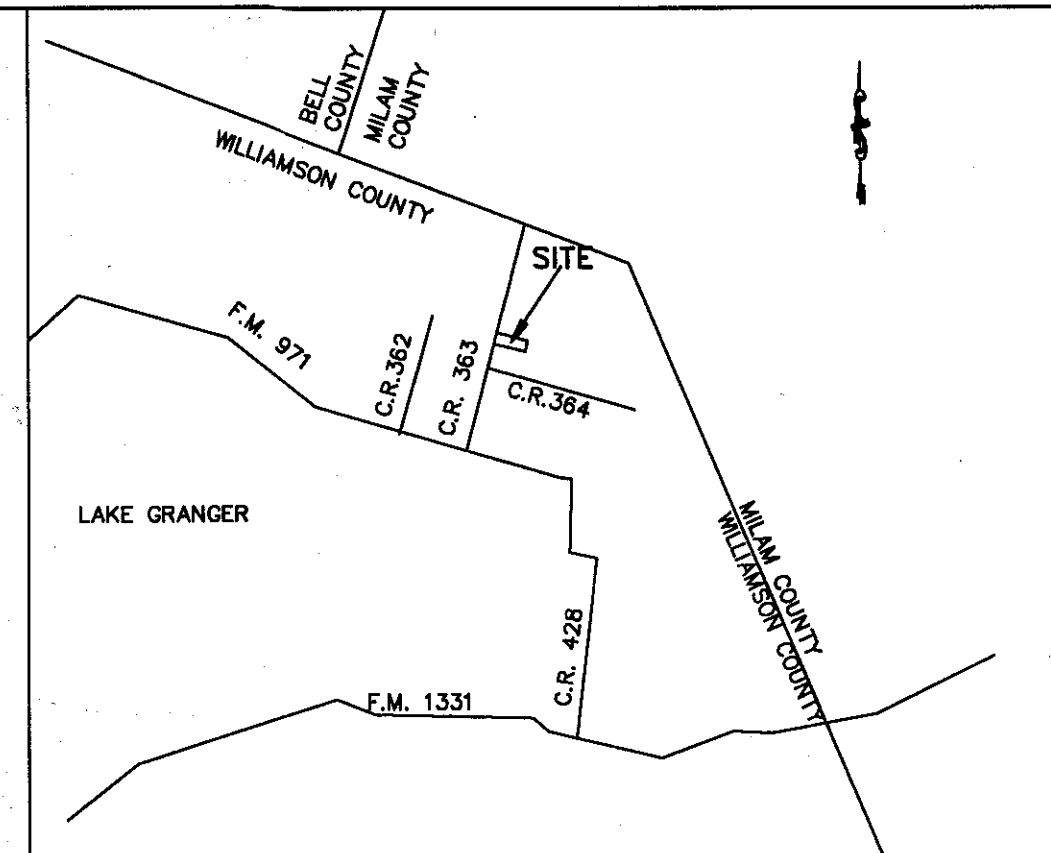

### LOCATION MAP

NOTE: CONTOURS SHOWN BASED ON USGS OVERLAY

### HEALTH DEPARTMENT NOTES:

- 1) ON-SITE-SEWAGE-FACILITIES MUST BE DESIGNED BY A REGISTERED PROFESSIONAL ENGINEER OR REGISTERED SANITARIAN.
- 2) NO STRUCTURE OR LAND ON THIS PLAT SHALL HEREAFTER BE LOCATED OR ALTERED WITHOUT FIRST SUBMITTING A CERTIFICATE OF COMPLIANCE APPLICATION FORM TO THE WILLIAMSON COUNTY FLOOD PLAIN ADMINISTRATOR.
- 3) WATER WILL BE PROVIDED WELL.  
SEPTIC WILL BE PROVIDED BY SEPTIC TANK.  
ELECTRICITY WILL BE PROVIDED BY BARTLETT ELECTRIC COOPERATIVE

BASED UPON THE ABOVE REPRESENTATIONS OF THE ENGINEER OR SURVEYOR WHOSE SEAL IS AFFIXED HERETO, AND AFTER REVIEW OF THE PLAT AS REPRESENTED BY THE SAID ENGINEER OR SURVEYOR, I FIND THAT THIS PLAT COMPLIES WITH THE REQUIREMENTS OF EDWARDS AQUIFER REGULATIONS AND WILLIAMSON COUNTY ON-SITE-SEWAGE FACILITY REGULATIONS. THIS CERTIFICATION IS MADE SOLELY UPON SUCH REPRESENTATIONS AND SHOULD NOT BE RELIED UPON FOR VERIFICATIONS OF THE FACTS ALLEGED. THE WILLIAMSON COUNTY AND CITIES HEALTH DISTRICT AND WILLIAMSON COUNTY DISCLAIMS ANY RESPONSIBILITY TO ANY MEMBER OF THE PUBLIC FOR INDEPENDENT VERIFICATION OF THE REPRESENTATIONS, FACTUAL OR OTHERWISE, CONTAINED IN THIS PLAT AND THE DOCUMENTS ASSOCIATED WITHIN IT.

Deborah K. Marlow, R.S. Date: 04/11/2012  
Director of Environmental Services OSDP 29596

STATE OF TEXAS  
COUNTY OF WILLIAMSON:

I, DAN A. GATTIS, COUNTY JUDGE OF WILLIAMSON COUNTY, TEXAS, DO HEREBY CERTIFY THAT THIS MAP OR PLAT, WITH WRITTEN FIELD NOTES SHOWN HEREON, AND THE SURVEYOR'S CERTIFICATE APPEARING HEREON, KNOWN AS "HARMONY FOREST" HAVING BEEN DULY PRESENTED TO THE COMMISSIONERS COURT OF WILLIAMSON COUNTY, TEXAS AND BY SAID COURT WAS DULY CONSIDERED, WAS ON THIS DAY APPROVED, AND SAID PLAT IS AUTHORIZED TO BE REGISTERED AND RECORDED IN THE PROPERTY RECORDS OF THE COUNTY CLERK OF WILLIAMSON COUNTY, TEXAS.

DAN A. GATTIS, COUNTY JUDGE, WILLIAMSON COUNTY, TEXAS DATE

STATE OF TEXAS  
COUNTY OF WILLIAMSON:

I, NANCY RISTER, CLERK OF THE COUNTY COURT, WITHIN AND FOR THE COUNTY AND STATE AFORESAID, DO HEREBY CERTIFY THAT THE FOREGOING INSTRUMENT OF WRITING, WITH ITS CERTIFICATE OF AUTHENTICATION, WAS FILED FOR RECORD IN MY OFFICE ON THE \_\_\_\_\_ DAY OF \_\_\_\_\_ 20\_\_\_\_ A.D., AT \_\_\_\_\_ O'CLOCK \_\_\_\_\_ M., IN THE PLAT RECORDS OF SAID COUNTY IN CABINET \_\_\_\_\_ SLIDES  
WITNESS MY HAND AND SEAL OF THE COUNTY COURT OF SAID COUNTY, AT MY OFFICE IN GEORGETOWN, TEXAS, THE LAST DATE WRITTEN ABOVE.

BY \_\_\_\_\_  
NANCY RISTER, CLERK, COUNTY COURT, WILLIAMSON COUNTY, TEXAS

LEGEND  
● 1/2" IRON PIN FOUND  
○ 1/2" IRON PIN SET  
( ) RECORD INFORMATION