

FIELDNOTE DESCRIPTION:

OF A 11.058 ACRE TRACT OF LAND OUT OF THE BARNEY C. LOW SURVEY, ABSTRACT NO. 385, SITUATED IN WILLIAMSON COUNTY, TEXAS, BEING A PART OF THE REMAINING PORTION OF THAT CERTAIN 895.35 ACRE TRACT OF LAND CONVEYED TO NNP-TERAVISTA, LP BY DEED OF RECORD IN DOCUMENT NO. 9801109 OF THE OFFICIAL RECORDS OF WILLIAMSON COUNTY, TEXAS, SAID 11.058 ACRE TRACT BEING MORE PARTICULARLY DESCRIBED BY METES AND BOUNDS AS FOLLOWS:

BEGINNING, AT A 1/2 INCH IRON ROD WITH CAP FOUND IN THE EASTERLY RIGHT-OF-WAY LINE OF TERAVISTA CLUB DRIVE (R.O.W. VARIES), BEING THE SOUTHWESTERLY CORNER OF LOT 1, BLOCK "A", TERAVISTA SECTION 5, A SUBDIVISION OF RECORD IN DOCUMENT NO. 2012009235 OF THE OFFICIAL PUBLIC RECORDS OF WILLIAMSON COUNTY, TEXAS, FOR THE NORTHWESTERLY CORNER HEREOF;

THENCE, LEAVING THE EASTERLY RIGHT-OF-WAY LINE OF TERAVISTA CLUB DRIVE, ALONG A PORTION OF THE SOUTHERLY LINE OF SAID LOT 1, FOR A PORTION OF THE NORTHERLY LINE HEREOF, THE FOLLOWING SEVEN (7) COURSES AND DISTANCES:

- N76°15'29"E, A DISTANCE OF 33.50 FEET TO A 1/2 INCH IRON ROD WITH CAP FOUND FOR AN ANGLE POINT;
- S78°58'29"E, A DISTANCE OF 49.44 FEET TO A 1/2 INCH IRON ROD WITH CAP FOUND FOR AN ANGLE POINT;
- N14°42'26"E, A DISTANCE OF 26.81 FEET TO A 1/2 INCH IRON ROD WITH CAP FOUND FOR AN ANGLE POINT;
- N69°51'48"E, A DISTANCE OF 376.99 FEET TO A 1/2 INCH IRON ROD WITH CAP FOUND AT THE POINT OF CURVATURE OF A CURVE TO THE LEFT;
- ALONG SAID CURVE, HAVING A RADIUS OF 114.50 FEET, A CENTRAL ANGLE OF 90°00'00", AN ARC LENGTH OF 179.86 FEET, AND A CHORD WHICH BEARS, N24°51'48"E, A DISTANCE OF 161.93 FEET TO A 1/2 INCH IRON ROD WITH CAP FOUND AT THE END OF SAID CURVE;
- N20°08'12"W, A DISTANCE OF 201.52 FEET TO A 1/2 INCH IRON ROD WITH CAP FOUND FOR AN ANGLE POINT;
- N19°50'24"E, A DISTANCE OF 68.58 FEET TO A 1/2 INCH IRON ROD WITH CAP FOUND IN THE SOUTHERLY LINE OF LOT 6, BLOCK "A", TERAVISTA SECTION 4, A SUBDIVISION OF RECORD IN DOCUMENT NO. 2011082500 OF SAID OFFICIAL PUBLIC RECORDS, FOR AN ANGLE POINT HEREOF;

THENCE, ALONG THE SOUTHERLY LINE OF LOT 6 THRU LOT 12, BLOCK "A" OF SAID TERAVISTA SECTION 4, FOR A PORTION OF THE NORTHERLY LINE HEREOF, THE FOLLOWING SEVEN (7) COURSES AND DISTANCES:

- S70°09'36"E, A DISTANCE OF 100.27 FEET TO A 1/2 INCH IRON ROD WITH CAP FOUND FOR AN ANGLE POINT;
- S71°38'50"E, A DISTANCE OF 56.99 FEET TO A 1/2 INCH IRON ROD WITH CAP FOUND FOR AN ANGLE POINT;
- S76°36'49"E, A DISTANCE OF 59.48 FEET TO A 1/2 INCH IRON ROD WITH CAP FOUND FOR AN ANGLE POINT;
- S82°54'33"E, A DISTANCE OF 84.38 FEET TO A 1/2 INCH IRON ROD WITH CAP FOUND FOR AN ANGLE POINT;
- S88°30'19"E, A DISTANCE OF 54.78 FEET TO A 1/2 INCH IRON ROD WITH CAP FOUND FOR AN ANGLE POINT;
- S89°13'15"E, A DISTANCE OF 50.00 FEET TO A 1/2 INCH IRON ROD WITH CAP FOUND FOR AN ANGLE POINT;
- S86°00'55"E, A DISTANCE OF 32.84 FEET TO A 1/2 INCH IRON ROD WITH CAP FOUND AT THE SOUTHEASTERLY CORNER OF SAID LOT 12, FOR AN ANGLE POINT HEREOF;

THENCE, ALONG THE WESTERLY LINE OF SAID LOT 12, FOR A PORTION OF THE NORTHERLY LINE HEREOF, THE FOLLOWING TWO (2) COURSES AND DISTANCES:

- N16°26'08"W, A DISTANCE OF 110.80 FEET TO A 1/2 INCH IRON ROD WITH "BURY" CAP SET FOR AN ANGLE POINT;
- N00°46'45"E, A DISTANCE OF 26.00 FEET TO A POINT IN THE SOUTHERLY RIGHT-OF-WAY LINE OF HIDDEN SPRINGS PATH (50' R.O.W.), BEING THE NORTHEASTERLY CORNER OF SAID LOT 12, FOR AN ANGLE POINT HEREOF;

THENCE, S89°16'30"E, LEAVING THE NORTHEASTERLY CORNER OF SAID LOT 12, ALONG THE SOUTHERLY RIGHT-OF-WAY LINE OF HIDDEN SPRINGS PATH, FOR A PORTION OF THE NORTHERLY LINE HEREOF, A DISTANCE OF 66.95 FEET TO A 1/2 INCH IRON ROD WITH CAP FOUND AT THE NORTHWESTERLY CORNER OF LOT 1, BLOCK "1", TERAVISTA SECTION 18A, OF RECORD IN CABINET "BB" SLIDES 1-5 OF SAID PLAT RECORDS, FOR THE NORTHEASTERLY CORNER HEREOF;

THENCE, LEAVING THE SOUTHERLY RIGHT-OF-WAY LINE OF HIDDEN SPRINGS PATH, ALONG THE WESTERLY LINE OF SAID LOT 1, FOR A PORTION OF THE EASTERLY LINE HEREOF, THE FOLLOWING TWO (2) COURSES AND DISTANCES:

- S00°49'40"W, A DISTANCE OF 100.08 FEET TO A 1/2 INCH IRON ROD WITH CAP FOUND FOR AN ANGLE POINT;
- S43°37'53"E, A DISTANCE OF 21.52 FEET TO A 1/2 INCH IRON ROD WITH CAP FOUND AT THE SOUTHWESTERLY CORNER OF SAID LOT 1, FOR AN ANGLE POINT HEREOF;

THENCE, LEAVING THE SOUTHWESTERLY CORNER OF SAID LOT 1, OVER AND ACROSS SAID 895.35 ACRE REMAINDER TRACT, FOR A PORTION OF THE EASTERLY AND THE SOUTHERLY LINES HEREOF, THE FOLLOWING ELEVEN (11) COURSES AND DISTANCES:

- S39°35'27"W, A DISTANCE OF 43.61 FEET TO A 1/2 INCH IRON ROD WITH "BURY" CAP SET FOR AN ANGLE POINT;
- S50°24'33"E, A DISTANCE OF 35.09 FEET TO A 1/2 INCH IRON ROD WITH CAP FOUND FOR AN ANGLE POINT;
- S74°02'04"E, A DISTANCE OF 76.19 FEET TO A 1/2 INCH IRON ROD WITH CAP FOUND FOR AN ANGLE POINT;
- S11°27'20"W, A DISTANCE OF 91.41 FEET TO A 1/2 INCH IRON ROD WITH CAP FOUND FOR AN ANGLE POINT;
- S28°47'27"W, A DISTANCE OF 478.86 FEET TO A 1/2 INCH IRON ROD WITH CAP FOUND FOR AN ANGLE POINT;
- S34°13'52"W, A DISTANCE OF 222.30 FEET TO A 1/2 INCH IRON ROD WITH "BURY" CAP SET FOR THE SOUTHEASTERLY CORNER HEREOF;
- S75°40'14"W, A DISTANCE OF 272.95 FEET TO A 1/2 INCH IRON ROD WITH CAP FOUND SET FOR AN ANGLE POINT;
- S80°57'22"W, A DISTANCE OF 60.52 FEET TO A 1/2 INCH IRON ROD WITH CAP FOUND FOR AN ANGLE POINT;

# FINAL PLAT OF TERAVISTA SECTION 5, PHASE 2

BEING 11.058 ACRES OUT OF THE BARNEY C. LOW SURVEY, ABSTRACT NO. 385, WILLIAMSON COUNTY, TEXAS.

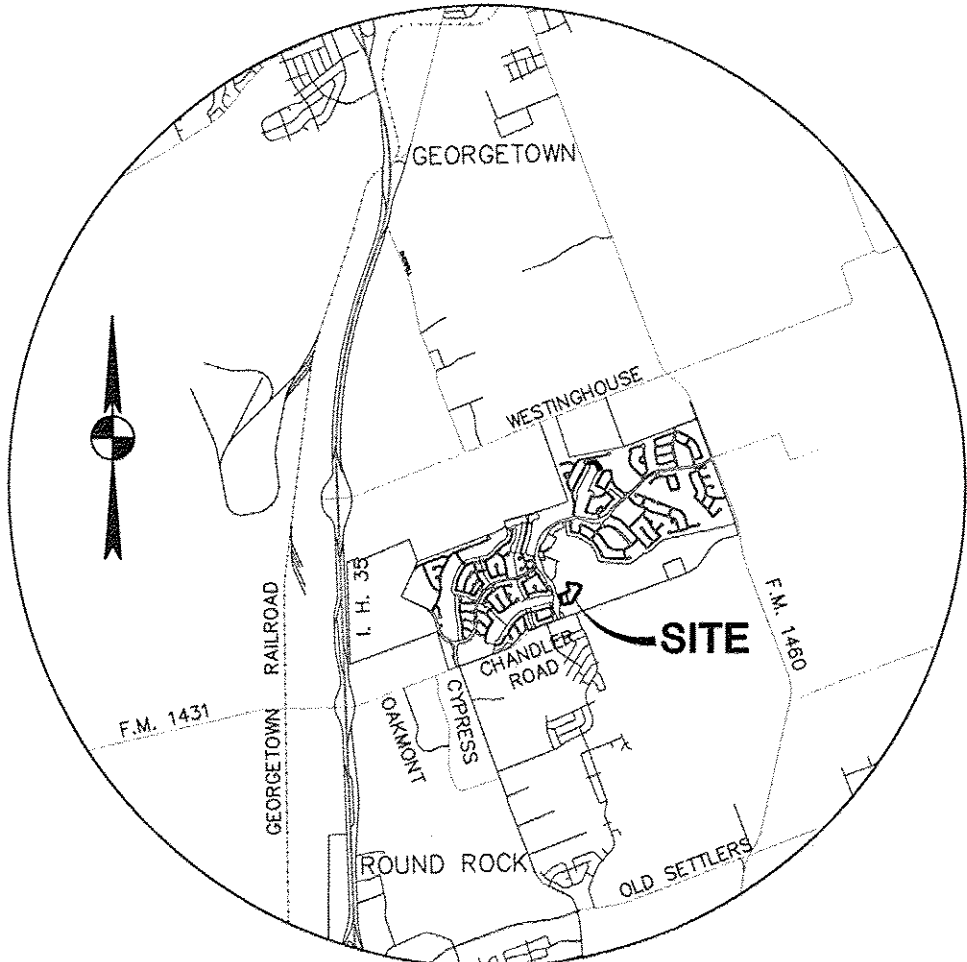

VICINITY MAP  
N.T.S.

## SHEET INDEX

SHEET NO.	DESCRIPTION
1	COVER SHEET AND NOTES
2	FINAL PLAT LAYOUT, LINE TABLES, AREA SUMMARIES
3	CERTIFICATIONS AND SIGNATURES

### GENERAL INFORMATION:

OWNER.....NNP-TERAVISTA, LLC  
TOTAL ACREAGE.....11.058 ACRES  
SURVEY OF.....BARNEY C. LOW (A-385)  
DATE.....AUGUST 2014  
TOTAL # OF LOTS.....5  
TOTAL # OF OPEN SPACE LOTS.....3  
TOTAL # OF BLOCKS.....1

### FIELDNOTE DESCRIPTION: CONTINUED

- N87°06'16"W, A DISTANCE OF 71.27 FEET TO A 1/2 INCH IRON ROD WITH CAP FOUND FOR AN ANGLE POINT;
- N65°27'28"W, A DISTANCE OF 51.19 FEET TO A 1/2 INCH IRON ROD WITH "BURY" CAP SET FOR AN ANGLE POINT;
- S73°39'44"W, A DISTANCE OF 87.67 FEET TO A 1/2 INCH IRON ROD WITH "BURY" CAP SET IN THE CURVING EASTERLY RIGHT-OF-WAY LINE OF TERAVISTA CLUB DRIVE, FOR THE SOUTHWESTERLY CORNER HEREOF;

THENCE, ALONG THE CURVING EASTERLY RIGHT-OF-WAY LINE OF TERAVISTA CLUB DRIVE, FOR A PORTION OF THE WESTERLY LINE HEREOF, THE FOLLOWING SEVEN (7) COURSES AND DISTANCES:

- ALONG A NON-TANGENT CURVE TO THE LEFT, HAVING A RADIUS OF 527.00 FEET, A CENTRAL ANGLE OF 14°29'13", AN ARC LENGTH OF 133.25 FEET, AND A CHORD WHICH BEARS, N09°30'29"W, A DISTANCE OF 132.89 FEET TO A 1/2 INCH IRON ROD WITH "BURY" CAP SET AT THE POINT OF REVERSE CURVATURE OF A CURVE TO THE RIGHT;
- ALONG SAID REVERSE CURVE, HAVING A RADIUS OF 25.00 FEET, A CENTRAL ANGLE OF 90°09'05", AN ARC LENGTH OF 39.34 FEET, AND A CHORD WHICH BEARS, N28°19'27"E, A DISTANCE OF 35.40 FEET TO A 1/2 INCH IRON ROD WITH "BURY" CAP SET AT THE END OF SAID CURVE, FOR AN ANGLE POINT HEREOF;
- N16°36'01"W, A DISTANCE OF 50.00 FEET TO A 1/2 INCH IRON ROD WITH "BURY" CAP SET TO THE POINT OF CURVATURE OF A CURVE TO THE RIGHT;
- ALONG SAID CURVE, HAVING A RADIUS OF 875.00 FEET, A CENTRAL ANGLE OF 00°31'30", AN ARC LENGTH OF 8.02 FEET, AND A CHORD WHICH BEARS, S73°39'45"W, A DISTANCE OF 8.02 FEET TO A 1/2 INCH IRON ROD WITH "BURY" CAP SET AT THE POINT OF COMPOUND CURVATURE OF A CURVE TO THE RIGHT;
- ALONG SAID COMPOUND CURVE, HAVING A RADIUS OF 25.00 FEET, A CENTRAL ANGLE OF 83°15'21", AN ARC LENGTH OF 36.33 FEET, AND A CHORD WHICH BEARS, N64°26'49"W, A DISTANCE OF 33.21 FEET TO A 1/2 INCH IRON ROD WITH "BURY" CAP SET AT THE END OF SAID CURVE;
- N22°49'09"W, A DISTANCE OF 125.86 FEET TO A 1/2 INCH IRON ROD WITH "BURY" CAP SET AT THE POINT OF CURVATURE OF A CURVE TO THE RIGHT;
- ALONG SAID CURVE, HAVING A RADIUS OF 473.00 FEET, A CENTRAL ANGLE OF 02°24'52", AN ARC LENGTH OF 19.93 FEET, AND A CHORD WHICH BEARS, N21°36'42"W, A DISTANCE OF 19.93 FEET TO THE POINT OF BEGINNING, CONTAINING AN AREA OF 11.058 ACRES (481,690 SQ. FT.) OF LAND, MORE OR LESS, WITHIN THESE METES AND BOUNDS.

### GENERAL NOTES:

- ALL PLAT BOUNDARY CORNERS ARE STAKED WITH 1/2-INCH IRON RODS WITH PLASTIC CAPS STAMPED "BURY&PARTNERS" UNLESS OTHERWISE INDICATED.
- GAS SERVICE WILL BE PROVIDED BY ATMOS ENERGY.
- ELECTRIC SERVICE WILL BE PROVIDED BY ONCOR.
- NO PORTION OF THIS PLAT LIES WITHIN THE BOUNDARIES OF THE 100-YEAR FLOOD PLAIN OF A WATERWAY THAT IS WITHIN THE LIMITS OF STUDY OF THE FEDERAL FLOOD INSURANCE ADMINISTRATION PANEL NO 48491C0485E, DATED SEPTEMBER 26, 2008. ALL PORTIONS OF THIS PLAT LIE IN ZONE X.
- SIDEWALKS SHALL BE CONSTRUCTED IN ACCORDANCE WITH THE DEVELOPMENT AGREEMENT BY AND BETWEEN THE CITY OF ROUND ROCK AND THE OWNER AS DATED AUGUST 27, 1998.
- THE FOLLOWING PUBLIC UTILITY EASEMENTS (P.U.E.) SHALL APPLY: 10' P.U.E. PARALLEL AND ABUTTING ALL STREET R.O.W. IS HEREBY DEDICATED.
- BUILDING SLAB ELEVATIONS SHALL BE A MINIMUM ONE FOOT ABOVE ANY POINT ON THE LOT WITHIN FIVE FEET OF THE PERIMETER OF THE BUILDING.
- NO STRUCTURE OR LAND ON THIS PLAT SHALL HEREAFTER BE LOCATED OR ALTERED WITHOUT FIRST SUBMITTING A CERTIFICATE OF COMPLIANCE APPLICATION FORM TO THE WILLIAMSON COUNTY FLOOD PLAIN ADMINISTRATOR. (PHONE NO.: 512-930-4390)
- THIS TRACT IS LOCATED WITHIN THE EDWARDS AQUIFER TRANSITION ZONE. A WATER POLLUTION ABATEMENT PLAN WAS APPROVED BY THE TEXAS NATURAL RESOURCES CONSERVATION COMMISSION ON AUGUST 18, 1998 AND RECORDED IN DOCUMENT NO. 9853770 IN THE OFFICIAL RECORDS OF WILLIAMSON COUNTY, TEXAS.
- WATER AND SEWER SERVICE FOR THIS SUBDIVISION WILL BE PROVIDED BY WILLIAMSON COUNTY M.U.D. NO. 10.
- ALL BEARINGS SHOWN HEREON ARE REFERENCED TO THE STATE PLANE COORDINATE SYSTEM, TEXAS CENTRAL ZONE IN TERMS OF NAD83/93 DATUM EXPRESSED IN U.S. SURVEY FEET. SURFACE DISTANCES SHOWN HEREON MAY BE CONVERTED TO GRID BY MULTIPLYING BY THE COMBINED FACTOR OF 0.999870053.
- BUILDING SETBACKS WILL BE IN ACCORDANCE WITH THE CITY OF ROUND ROCK ZONING ORDINANCE IN EFFECT AS OF SEPTEMBER 10, 1998, IN ACCORDANCE WITH THE DEVELOPMENT AGREEMENT BETWEEN THE CITY OF ROUND ROCK, TEXAS AND NEWLAND-ROUND ROCK ASSOCIATES, L.P. PER CITY ORDINANCE NO. G-98-08-27-9C1.
- THE COUNTY ASSUMES NO RESPONSIBILITY FOR THE ACCURACY OF REPRESENTATIONS BY OTHER PARTIES IN THIS PLAT. FLOOD PLAIN DATA, IN PARTICULAR, MAY CHANGE DEPENDING ON SUBSEQUENT DEVELOPMENT. IT IS FURTHER UNDERSTOOD THAT THE OWNERS OF THE TRACT OF LAND COVERED BY THIS PLAT MUST INSTALL AT THEIR OWN EXPENSE ALL TRAFFIC CONTROL DEVICES AND SIGNAGE THAT MAY BE REQUIRED BEFORE THE STREETS IN THE SUBDIVISION HAVE FINALLY BEEN ACCEPTED FOR MAINTENANCE BY THE COUNTY.
- LOTS 1 AND 2 MAY NOT BE FURTHER SUBDIVIDED.
- ALL SIDEWALKS IN THIS SUBDIVISION ARE TO BE MAINTAINED BY THE ADJACENT LANDOWNERS.
- ACCESS ACROSS LOT 5 IS LIMITED TO LOT 1, LOT 2 AND THE ADJACENT GOLF COURSE PROPERTY.
- ACCESS ACROSS THE 20' WIDE ACCESS AND IRRIGATION EASEMENT IS LIMITED TO LOTS 1-4 AND THE ADJACENT GOLF COURSE PROPERTY.

## FINAL PLAT OF TERAVISTA SECTION 5, PHASE 2

DATE: AUGUST, 2014

# BURY

221 West Sixth Street, Suite 600  
Austin, Texas 78701  
Tel. (512) 328-0011 Fax (512) 328-0325  
TBPE # F-1048 TBPLS # F-10107500  
Copyright © 2014

FIELD NOTE: FN14-277(KWA)  
Drawn by: KWA Approved by: JTB Project No.: R0102640-10069 File: H:\102640\069\102640069PL2.dwg

OWNER/DEVELOPER  
**NNP-Teravista, LLC, a Texas Limited Liability Company**  
13809 RESEARCH BOULEVARD, SUITE 475  
AUSTIN, TEXAS 78750  
(512) 244-6667 FAX (512) 244-6875

ENGINEER  
**BURY**  
221 WEST SIXTH STREET, SUITE 600  
AUSTIN, TEXAS 78701  
(512) 328-0011 FAX (512) 328-0325

SURVEYOR  
**BURY**  
221 WEST SIXTH STREET, SUITE 600  
AUSTIN, TEXAS 78701  
(512) 328-0011 FAX (512) 328-0325

SHEET

1

OF 3

[illegible]

LINE TABLE		
NO.	BEARING	DISTANCE
L1	N76°15'29"E	33.50'
L2	S78°58'29"E	49.44'
L3	N14°42'26"E	26.81'
L4	N19°50'24"E	68.58'
L5	S70°09'36"E	100.27'
L6	S71°38'50"E	56.99'
L7	S76°36'49"E	59.48'
L8	S82°54'33"E	84.38'
L9	S88°30'19"E	54.78'
L10	S89°13'15"E	50.00'
L11	S86°00'55"E	32.84'
L12	N16°26'08"W	110.80'
L13	N04°46'45"E	26.00'
L14	S89°16'30"E	66.95'
L15	S0°49'40"W	100.08'
L16	S43°37'53"E	21.52'
L17	S39°35'27"W	43.61'
L18	S50°24'33"E	35.09'
L19	S74°02'04"E	76.19'
L20	S11°27'20"W	91.41'
L21	S80°57'22"W	60.52'
L22	N87°06'16"W	71.27'
L23	N65°27'28"W	51.19'
L24	S73°39'44"W	87.67'
L25	S16°36'01"E	50.00'

AREA SUMMARY		
LOT #	AREA (ACRES)	AREA (SQ. FT.)
1	4.853	211,388
2	5.300	230,861
3	0.422	18,390
4	0.307	13,395
5	0.175	7,656
TOTAL	11.058	481,690

# BURY

221 West Sixth Street, Suite 600  
Austin, Texas 78701  
Tel. (512) 328-0011 Fax (512) 328-0325  
TBPE # F-1048 TBPLS # F-10107500  
Copyright © 2014

Drawn by: KWA Approved by: JTB Project No.: R0102640-10069 File: H:\102640\069\102640069PL2.dwg

LOT 1, BLOCK "A"  
VISTA HEIGHTS SECTION 3-G  
CABINET G, SLIDE 73

**EAGLES NEST STREET**  
(R.O.W. VARIES)

BARNEY C. LOW SURVEY, A-385  
ABEL L. FAVES SURVEY, A-215

6.01 ACRES  
GRACE J. MAY  
DOCUMENT NO. 2004028784

1.908 ACRES  
KANG LEE



# FINAL PLAT OF TERAVIDA SECTION 5, PHASE 2

STATE OF TEXAS  
COUNTY OF WILLIAMSON

§  
§ KNOW ALL MEN BY THESE PRESENTS;

THAT NNP-TERAVISTA, LLC, SOLE OWNER OF THE CERTAIN TRACT OF LAND SHOWN HEREON AND BEING A PORTION OF THE TRACT OF LAND DESCRIBED IN DEED RECORDED IN DOCUMENT NO. 9801109 OF THE OFFICIAL RECORDS OF WILLIAMSON COUNTY, TEXAS, DOES HEREBY SUBDIVIDE THE 11.058 ACRES AS SHOWN HEREON AND DEDICATE TO THE PUBLIC USE FOREVER THE STREETS, ALLEYS, EASEMENTS AND ALL OTHER LANDS INTENDED FOR PUBLIC DEDICATION AS SHOWN HEREON. THIS SUBDIVISION IS TO BE KNOWN AS "FINAL PLAT OF TERAVIDA SECTION 5, PHASE 2". THE OWNER ACKNOWLEDGES THAT IT IS THE RESPONSIBILITY OF THE OWNER, NOT THE COUNTY, TO ASSURE COMPLIANCE WITH THE PROVISIONS OF ALL APPLICABLE STATE, FEDERAL, AND LOCAL LAWS AND REGULATIONS RELATING TO THE ENVIRONMENT, INCLUDING BUT NOT LIMITED TO THE ENDANGERED SPECIES ACT, STATE AQUIFER REGULATIONS, AND MUNICIPAL WATERSHED ORDINANCES.

NNP-TERAVISTA, LLC, A TEXAS LIMITED LIABILITY COMPANY

TO CERTIFY WHICH, WITNESS BY MY HAND THIS 18<sup>th</sup> DAY OF September, 2014.

NNP-TERAVISTA, LLC  
A TEXAS LIMITED LIABILITY COMPANY

E. William Meyer  
BY: E. WILLIAM MEYER  
SENIOR VICE PRESIDENT  
13809 RESEARCH BOULEVARD, SUITE 475  
AUSTIN, TEXAS 78750

STATE OF TEXAS  
COUNTY OF WILLIAMSON

§  
§ KNOW ALL MEN BY THESE PRESENTS

BEFORE ME, THE UNDERSIGNED AUTHORITY, ON THIS DAY PERSONALLY APPEARED E. WILLIAM MEYER, OF NNP-TERAVISTA, LLC, A TEXAS LIMITED LIABILITY COMPANY, KNOWN TO ME TO BE THE PERSON WHOSE NAME IS SUBSCRIBED TO THE FOREGOING INSTRUMENT AND ACKNOWLEDGED TO ME THAT THEY EXECUTED THE SAME FOR THE PURPOSES AND CONSIDERATION THEREIN EXPRESSED, IN THE CAPACITY THEREIN STATED.

GIVEN UNDER MY HAND AND SEAL OF OFFICE THIS 18<sup>th</sup> DAY OF September, 2014.

Vilia Bailey  
NOTARY PUBLIC IN AND FOR THE STATE OF TEXAS

PRINTED NAME: Vilia Bailey

MY COMMISSION EXPIRES ON: 12-5-15

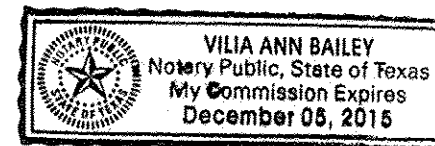

## ENGINEER'S CERTIFICATION:

I, JOHN A. PICKENS, REGISTERED PROFESSIONAL ENGINEER IN THE STATE OF TEXAS, DO HEREBY CERTIFY THAT THIS SUBDIVISION IS NOT IN THE EDWARDS AQUIFER RECHARGE ZONE AND IS NOT ENCLOSED BY A ZONE A FLOOD AREA, AS DENOTED HEREIN, AND IS DEFINED BY FEDERAL EMERGENCY MANAGEMENT ADMINISTRATION FLOOD HAZARD BOUNDARY MAP (FIRM), COMMUNITY PANEL NUMBER 48491C0485E, EFFECTIVE DATE SEPTEMBER 26, 2008, FOR WILLIAMSON COUNTY, TEXAS AND THAT EACH LOT CONFORMS TO THE WILLIAMSON COUNTY REGULATIONS.

THE FULLY DEVELOPED, CONCENTRATED STORMWATER RUNOFF RESULTING FROM THE ONE HUNDRED (100) YEAR FREQUENCY STORM IS CONTAINED WITHIN THE DRAINAGE EASEMENTS SHOWN AND/OR PUBLIC RIGHTS-OF-WAY DEDICATED BY THIS PLAT.

TO CERTIFY WHICH, WITNESS MY HAND AND SEAL AT AUSTIN, TRAVIS COUNTY, TEXAS,

THIS 12 DAY OF SEPT, 2014.

John A. Pickens  
JOHN A. PICKENS  
REGISTERED PROFESSIONAL ENGINEER  
NO. 110631 STATE OF TEXAS  
221 WEST SIXTH STREET, SUITE 600  
AUSTIN, TEXAS 78701

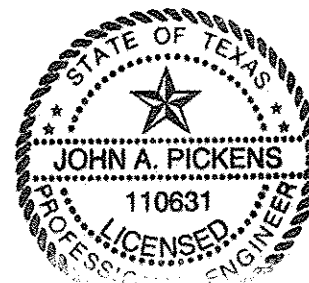

STATE OF TEXAS  
COUNTY OF WILLIAMSON

§  
§ KNOW ALL MEN BY THESE PRESENTS

WE, NASH FINANCING, LLC, A DELAWARE LIMITED LIABILITY COMPANY, LIEN HOLDER OF CERTAIN TRACT OF LAND SHOWN HEREON AND DESCRIBED IN A DEED RECORDED IN DOCUMENT NO. 2006072574 OF THE OFFICIAL PUBLIC RECORDS OF WILLIAMSON COUNTY, TEXAS, DO HEREBY CONSENT TO THE SUBDIVISION OF SAID TRACT AS SHOWN HEREON, AND DO FURTHER HEREBY JOIN, APPROVE AND CONSENT TO ALL PLAT NOTE REQUIREMENTS SHOWN HEREON, AND DO HEREBY DEDICATE TO THE CITY OF ROUND ROCK THE STREETS, ALLEYS, RIGHTS-OF-WAY, EASEMENTS AND PUBLIC PLACES SHOWN HEREON FOR SUCH PUBLIC PURPOSES AS THE CITY OF ROUND ROCK MAY DEEM APPROPRIATE. THIS SUBDIVISION IS TO BE KNOWN AS "FINAL PLAT OF TERAVIDA SECTION 5, PHASE 2".

TO CERTIFY WHICH, WITNESS BY MY HAND THIS 19 DAY OF September, 2014.

NASH FINANCING, LLC,  
A DELAWARE LIMITED LIABILITY COMPANY

BY: NORTH AMERICA SEKISUI HOUSE, LLC,  
A DELAWARE LIMITED LIABILITY COMPANY  
ITS SOLE MEMBER

BY: Koji Yamada 9-19-14  
Authorized Signatory DATE

STATE OF CALIFORNIA )

COUNTY OF San Diego )

ON September 19, 2014, BEFORE  
ME, K. Paxton, Notary Public PERSONALLY

APPEARED, Koji Yamada WHO PROVED  
TO ME ON THE BASIS OF SATISFACTORY EVIDENCE TO BE THE PERSON(S) WHOSE NAME(S) IS/ARE  
SUBSCRIBED TO THE WITHIN INSTRUMENT AND ACKNOWLEDGED TO ME THAT HE/SHE/THEY EXECUTED THE  
SAME IN HIS/HER/THEIR AUTHORIZED CAPACITY(IES), AND THAT BY HIS/HER/THEIR SIGNATURE(S) ON THE  
INSTRUMENT THE PERSON(S), OR THE ENTITY UPON BEHALF OF WHICH THE PERSON(S) ACTED, EXECUTED  
THE INSTRUMENT.

I CERTIFY UNDER PENALTY OF PERJURY UNDER THE LAWS OF THE STATE OF CALIFORNIA THAT THE  
FOREGOING PARAGRAPH IS TRUE AND CORRECT.

WITNESS MY HAND AND OFFICIAL SEAL

SIGNATURE K. Paxton

SEAL

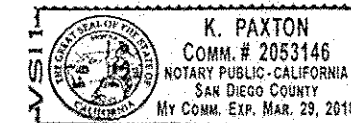

## SURVEYOR'S CERTIFICATION:

THAT I, JOHN T. BILNOSKI, A REGISTERED PROFESSIONAL LAND SURVEYOR, DO HEREBY CERTIFY THAT I PREPARED THIS PLAT FROM AN ACTUAL AND ACCURATE ON-THE-GROUND SURVEY OF THE LAND AND THAT THE CORNER MONUMENTS SHOWN THEREON WERE PROPERLY PLACED UNDER MY PERSONAL SUPERVISION, IN ACCORDANCE WITH THE SUBDIVISION REGULATIONS OF WILLIAMSON COUNTY, TEXAS, AND THE FIELD NOTES SHOWN HEREON MATHEMATICALLY CLOSE.

John T. Bilnoski  
JOHN T. BILNOSKI, R.P.L.S.  
TEXAS REGISTRATION NO. 4998  
BURY, INC.  
221 WEST SIXTH STREET, SUITE 600  
AUSTIN, TEXAS 78701

9/22/14  
DATE

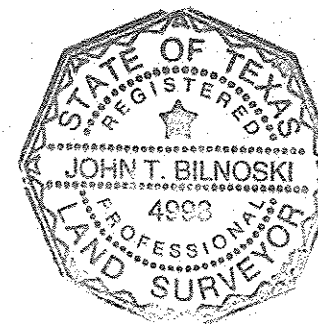

Craig Bridges 9/22/14  
WILLIAMSON COUNTY ADDRESSING COORDINATOR DATE

STATE OF TEXAS  
COUNTY OF WILLIAMSON

§  
§ KNOW ALL MEN BY THESE PRESENTS;

I, DAN A. GATTIS, COUNTY JUDGE OF WILLIAMSON COUNTY, TEXAS DO HEREBY CERTIFY THAT THIS MAP OR PLAT, WITH FIELD NOTES ATTACHED HEREON, THAT A SUBDIVISION KNOWN AS, FINAL PLAT OF TERAVIDA SECTION 5, PHASE 2, HAVING BEEN FULLY PRESENTED TO THE COMMISSIONER'S COURT OF WILLIAMSON COUNTY, TEXAS AND BY THE SAID COURT DULY CONSIDERED, WAS ON THIS DAY APPROVED AND SAID PLAT IS AUTHORIZED TO BE REGISTERED AND RECORDED IN THE PROPERTY RECORDS OF THE COUNTY CLERK OF WILLIAMSON COUNTY, TEXAS.

DAN A. GATTIS, COUNTY JUDGE  
WILLIAMSON COUNTY, TEXAS

DATE:

STATE OF TEXAS  
COUNTY OF WILLIAMSON

§  
§ KNOW ALL MEN BY THESE PRESENTS

I, NANCY RISTER, CLERK OF THE COUNTY COURT OF SAID COUNTY, DO HEREBY CERTIFY THAT THE FOREGOING INSTRUMENT IN WRITING, WITH ITS CERTIFICATE WAS FILED FOR

RECORD IN MY OFFICE ON THE DAY \_\_\_\_\_ OF \_\_\_\_\_, 2014 A.D., AT \_\_\_\_\_ O'CLOCK, \_\_\_\_ M.,

AND DULY RECORDED THIS THE DAY \_\_\_\_\_ OF \_\_\_\_\_, 2014 A.D., AT \_\_\_\_\_ O'CLOCK \_\_\_\_ M.,

IN THE PLAT RECORDS OF SAID COUNTY, IN DOCUMENT NUMBER \_\_\_\_\_.

TO CERTIFY WHICH, WITNESS MY HAND AND SEAL AT THE COUNTY COURT OF SAID COUNTY, AT MY OFFICE IN GEORGETOWN, TEXAS, THE DATE LAST SHOWN ABOVE WRITTEN.

NANCY RISTER, CLERK, COUNTY COURT  
OF WILLIAMSON COUNTY, TEXAS

BY: \_\_\_\_\_ DEPUTY

FINAL PLAT OF  
TERAVISTA SECTION 5, PHASE 2

DATE: AUGUST, 2014

**BURY**

221 West Sixth Street, Suite 600  
Austin, Texas 78701  
Tel. (512) 328-0011 Fax (512) 328-0325  
TBPE # F-1048 TBPLS # F-10107500  
Copyright © 2014

SHEET

3

OF 3