

FINAL PLAT OF RANCHO SIENNA SECTION 14, PHASE 1

BEING 23.437 ACRES OUT OF THE GREENLEAF FISK SURVEY,
ABSTRACT NO. 5 WILLIAMSON COUNTY, TEXAS.

FIELDNOTE DESCRIPTION:

OF 23.437 ACRES OF LAND, OUT OF THE GREENLEAF FISK SURVEY, ABSTRACT NO. 5, SITUATED IN WILLIAMSON COUNTY, TEXAS, BEING A PORTION OF THAT CERTAIN TRACT 3E, 30.103 ACRE TRACT OF LAND AND THAT CERTAIN TRACT 4A, 50.407 ACRE TRACT OF LAND CONVEYED TO NASH RANCHO HILLS, LLC, BY DEEDS OF RECORD IN DOCUMENT NOS. 2014001964 AND 2015038403, BOTH OF THE OFFICIAL PUBLIC RECORDS OF WILLIAMSON COUNTY, TEXAS; SAID 23.437 ACRES OF LAND BEING MORE PARTICULARLY DESCRIBED BY METES AND BOUNDS AS FOLLOWS:

BEGINNING, AT A 1/2 INCH IRON ROD WITH "BURY" CAP SET IN THE SOUTHERLY LINE OF LOT 58, BLOCK "S", RANCHO SIENNA SECTION 8, A SUBDIVISION OF RECORD IN DOCUMENT NO. 2014099344 OF SAID OFFICIAL PUBLIC RECORDS, BEING THE NORTHERLY LINE OF SAID TRACT 3E, FOR AN ANGLE POINT HEREOF;

THENCE, S86°52'50"E, ALONG THE SOUTHERLY LINE OF LOTS 58-60 OF SAID BLOCK "S", WITH THE NORTHERLY LINE OF SAID TRACT 3E, FOR A PORTION OF THE NORTHERLY LINE HEREOF, A DISTANCE OF 160.59 FEET TO A 1/2 INCH IRON ROD WITH "BURY" CAP SET FOR THE NORTHEASTERLY CORNER HEREOF;

THENCE, LEAVING THE SOUTHERLY LINE OF SAID LOT 60, OVER AND ACROSS SAID TRACT 3E AND SAID TRACT 4A, FOR THE EASTERLY, SOUTHERLY AND WESTERLY LINES HEREOF, THE FOLLOWING THIRTY-SIX (36) COURSES AND DISTANCES:

- S05°25'18"W, A DISTANCE OF 410.72 FEET TO A 1/2 INCH IRON ROD WITH "BURY" CAP SET FOR AN ANGLE POINT HEREOF;
- S09°40'29"W, A DISTANCE OF 50.14 FEET TO A 1/2 INCH IRON ROD WITH "BURY" CAP SET FOR AN ANGLE POINT HEREOF;
- S06°14'44"W, A DISTANCE OF 566.43 FEET TO A 1/2 INCH IRON ROD WITH "BURY" CAP SET FOR THE SOUTHEASTERLY CORNER HEREOF;
- N83°45'16"W, A DISTANCE OF 5.17 FEET TO A 1/2 INCH IRON ROD WITH "BURY" CAP SET AT THE POINT OF CURVATURE OF A CURVE TO THE LEFT;
- ALONG SAID CURVE, HAVING A RADIUS OF 25.00 FEET, A CENTRAL ANGLE OF 90°00'00", AN ARC LENGTH OF 39.27 FEET, AND A CHORD WHICH BEARS S51°14'44" W, A DISTANCE OF 35.36 FEET TO A 1/2 INCH IRON ROD WITH "BURY" CAP SET AT THE END OF SAID CURVE;
- S06°14'44"W, A DISTANCE OF 8.12 FEET TO A 1/2 INCH IRON ROD WITH "BURY" CAP SET FOR AN ANGLE POINT HEREOF;
- N83°45'16"W, A DISTANCE OF 50.00 FEET TO A 1/2 INCH IRON ROD WITH "BURY" CAP SET AT THE POINT OF CURVATURE OF A NON-TANGENT CURVE TO THE LEFT;
- ALONG SAID NON-TANGENT CURVE, HAVING A RADIUS OF 25.00 FEET, A CENTRAL ANGLE OF 104°47'36", AN ARC LENGTH OF 45.72 FEET, AND A CHORD WHICH BEARS N46°09'04"W, A DISTANCE OF 39.61 FEET TO A 1/2 INCH IRON ROD WITH "BURY" CAP SET AT THE POINT OF CURVATURE OF A COMPOUND CURVE TO THE LEFT;
- ALONG SAID COMPOUND CURVE, HAVING A RADIUS OF 270.00 FEET, A CENTRAL ANGLE OF 15°07'14", AN ARC LENGTH OF 71.25 FEET, AND A CHORD WHICH BEARS S73°53'31"W, A DISTANCE OF 71.05 FEET TO A 1/2 INCH IRON ROD WITH "BURY" CAP SET AT THE END OF SAID CURVE;
- S66°19'54"W, A DISTANCE OF 100.89 FEET TO A 1/2 INCH IRON ROD WITH "BURY" CAP SET AT THE POINT OF CURVATURE OF A CURVE TO THE RIGHT;
- ALONG SAID CURVE, HAVING A RADIUS OF 380.00 FEET, A CENTRAL ANGLE OF 4°46'40", AN ARC LENGTH OF 31.69 FEET, AND A CHORD WHICH BEARS S68°43'15"W, A DISTANCE OF 31.68 FEET TO A 1/2 INCH IRON ROD WITH "BURY" CAP SET AT THE END OF SAID CURVE;
- S18°53'25"E, A DISTANCE OF 121.50 FEET TO A 1/2 INCH IRON ROD WITH "BURY" CAP SET FOR AN ANGLE POINT HEREOF;
- S26°28'55"W, A DISTANCE OF 7.02 FEET TO A 1/2 INCH IRON ROD WITH "BURY" CAP SET FOR AN ANGLE POINT HEREOF;
- S71°51'15"W, A DISTANCE OF 83.34 FEET TO A 1/2 INCH IRON ROD WITH "BURY" CAP SET FOR AN ANGLE POINT HEREOF;
- S85°58'58"W, A DISTANCE OF 88.67 FEET TO A 1/2 INCH IRON ROD WITH "BURY" CAP SET FOR AN ANGLE POINT HEREOF;
- N84°06'07"W, A DISTANCE OF 88.67 FEET TO A 1/2 INCH IRON ROD WITH "BURY" CAP SET FOR AN ANGLE POINT HEREOF;
- N74°11'12"W, A DISTANCE OF 88.67 FEET TO A 1/2 INCH IRON ROD WITH "BURY" CAP SET FOR AN ANGLE POINT HEREOF;
- N64°16'17"W, A DISTANCE OF 88.67 FEET TO A 1/2 INCH IRON ROD WITH "BURY" CAP SET FOR AN ANGLE POINT HEREOF;
- N54°21'10"W, A DISTANCE OF 88.67 FEET TO A 1/2 INCH IRON ROD WITH "BURY" CAP SET FOR AN ANGLE POINT HEREOF;
- N44°41'01"W, A DISTANCE OF 149.34 FEET TO A 1/2 INCH IRON ROD WITH "BURY" CAP SET FOR AN ANGLE POINT HEREOF;
- N66°22'56"W, A DISTANCE OF 155.75 FEET TO A 1/2 INCH IRON ROD WITH "BURY" CAP SET FOR AN ANGLE POINT HEREOF;
- N62°33'53"W, A DISTANCE OF 85.28 FEET TO A 1/2 INCH IRON ROD WITH "BURY" CAP SET FOR AN ANGLE POINT HEREOF;
- N52°15'36"W, A DISTANCE OF 85.45 FEET TO A 1/2 INCH IRON ROD WITH "BURY" CAP SET FOR AN ANGLE POINT HEREOF;
- N44°19'53"W, A DISTANCE OF 85.91 FEET TO A 1/2 INCH IRON ROD WITH "BURY" CAP SET FOR AN ANGLE POINT HEREOF;
- N36°17'24"W, A DISTANCE OF 79.21 FEET. TO A 1/2 INCH IRON ROD WITH "BURY" CAP SET FOR THE SOUTHWESTERLY CORNER HEREOF;
- N08°42'36" E, A DISTANCE OF 9.62 FEET TO A 1/2 INCH IRON ROD WITH "BURY" CAP SET FOR AN ANGLE POINT HEREOF;
- N57°43'57"E, A DISTANCE OF 129.69 FEET TO A 1/2 INCH IRON ROD WITH "BURY" CAP SET FOR THE POINT OF CURVATURE OF A NON-TANGENT CURVE TO THE RIGHT;
- ALONG SAID NON-TANGENT CURVE, HAVING A RADIUS OF 480.00 FEET, A CENTRAL ANGLE OF 2°53'17", AN ARC LENGTH OF 24.19 FEET, AND A CHORD WHICH BEARS N30°49'25"W, A DISTANCE OF 24.19 FEET TO A 1/2 INCH IRON ROD WITH "BURY" CAP SET AT THE POINT OF CURVATURE OF A REVERSE CURVE TO THE LEFT;
- ALONG SAID REVERSE CURVE, HAVING A RADIUS OF 20.00 FEET, A CENTRAL ANGLE OF 84°03'47", AN ARC LENGTH OF 29.34 FEET, AND A CHORD WHICH BEARS N71°24'40"W, A DISTANCE OF 26.78 FEET TO A 1/2 INCH IRON ROD WITH "BURY" CAP SET AT THE END OF SAID CURVE;
- S66°33'27"W, A DISTANCE OF 1.21 FEET TO A 1/2 INCH IRON ROD WITH "BURY" CAP SET FOR AN ANGLE POINT HEREOF;
- N23°26'34"W, A DISTANCE OF 50.00 FEET TO A 1/2 INCH IRON ROD WITH "BURY" CAP SET AT THE POINT OF CURVATURE OF A NON-TANGENT CURVE TO THE LEFT;
- ALONG SAID NON-TANGENT CURVE, HAVING A RADIUS OF 20.00 FEET, A CENTRAL ANGLE OF 85°36'32", AN ARC LENGTH OF 29.88 FEET, AND A CHORD WHICH BEARS N23°45'11"E, A DISTANCE OF 27.18 FEET TO A 1/2 INCH IRON ROD WITH "BURY" CAP SET AT THE POINT OF CURVATURE OF A REVERSE CURVE TO THE RIGHT;
- ALONG SAID REVERSE CURVE, HAVING A RADIUS OF 480.00 FEET, A CENTRAL ANGLE OF 39°59'09", AN ARC LENGTH OF 334.98 FEET, AND A CHORD WHICH BEARS N00°56'30"E, A DISTANCE OF 328.23 FEET TO A 1/2 INCH IRON ROD WITH "BURY" CAP SET AT THE END OF SAID CURVE;
- N20°56'04"E, A DISTANCE OF 101.75 FEET TO A 1/2 INCH IRON ROD WITH "BURY" CAP SET AT THE POINT OF CURVATURE OF A CURVE TO THE LEFT;
- ALONG SAID CURVE, HAVING A RADIUS OF 770.00 FEET, A CENTRAL ANGLE OF 24°31'30", AN ARC LENGTH OF 329.59 FEET, AND A CHORD WHICH BEARS N08°40'19"E, A DISTANCE OF 327.08 FEET TO A 1/2 INCH IRON ROD WITH "BURY" CAP SET AT THE END OF SAID CURVE;
- N03°35'26"W, A DISTANCE OF 149.13 FEET TO A 1/2 INCH IRON ROD WITH "BURY" CAP SET AT THE SOUTHWESTERLY CORNER OF THE TERMINUS OF RANCHO SIENNA LOOP (60' R.O.W.), BEING THE NORTHERLY LINE OF SAID TRACT 3E, FOR THE NORTHWESTERLY CORNER HEREOF;

THENCE, N86°24'34"E, ALONG THE SOUTHERLY TERMINUS OF RANCHO SIENNA LOOP, WITH THE NORTHERLY LINE OF SAID TRACT 3E, FOR A PORTION OF THE NORTHERLY LINE HEREOF, A DISTANCE OF 60.00 FEET TO A 1/2 INCH IRON ROD WITH "BURY" CAP SET AT THE SOUTHEASTERLY CORNER OF THE TERMINUS OF RANCHO SIENNA LOOP, FOR AN ANGLE POINT HEREOF;

THENCE, LEAVING THE SOUTHERLY TERMINUS OF RANCHO SIENNA LOOP, OVER AND ACROSS SAID TRACT 3E AND SAID TRACT 4A, FOR A PORTION OF THE NORTHERLY LINE HEREOF, THE FOLLOWING FIFTY (50) COURSES AND DISTANCES:

- S03°35'26"E, A DISTANCE OF 78.74 FEET TO A 1/2 INCH IRON ROD WITH "BURY" CAP SET AT THE POINT OF CURVATURE OF A CURVE TO THE LEFT;
- ALONG SAID CURVE, HAVING A RADIUS OF 25.00 FEET, A CENTRAL ANGLE OF 90°00'00", AN ARC LENGTH OF 39.27 FEET, AND A CHORD WHICH BEARS S48°35'26"E, A DISTANCE OF 35.36 FEET TO A 1/2 INCH IRON ROD WITH "BURY" CAP SET AT THE END OF SAID CURVE;
- S03°35'26"E, A DISTANCE OF 50.00 FEET TO A 1/2 INCH IRON ROD WITH "BURY" CAP SET FOR AN ANGLE POINT HEREOF;
- N86°24'34"E, A DISTANCE OF 49.52 FEET TO A 1/2 INCH IRON ROD WITH "BURY" CAP SET AT THE POINT OF CURVATURE OF A CURVE TO THE RIGHT;

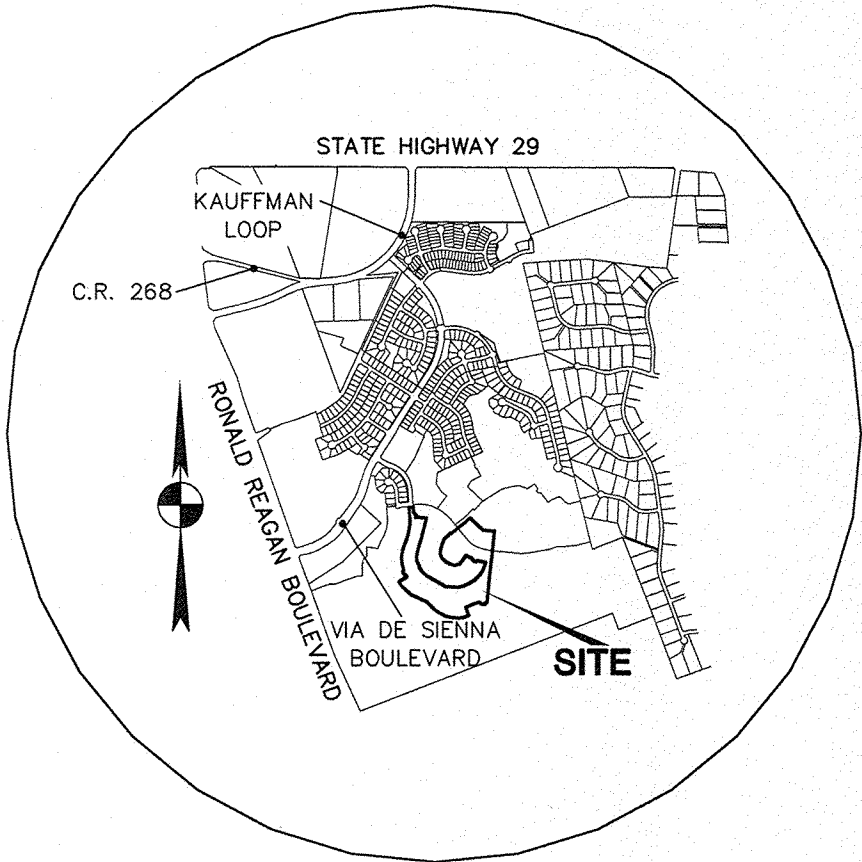

VICINITY MAP
N.T.S.

SHEET INDEX

SHEET NO.	DESCRIPTION
1	COVER SHEET AND FIELD NOTE DESCRIPTION
2	FINAL PLAT LAYOUT
3	LINE AND CURVE TABLE AND NOTES
4	CERTIFICATIONS AND SIGNATURES

GENERAL INFORMATION:

OWNER.....NASH RANCHO HILLS, LLC
TOTAL ACREAGE.....23.437 ACRES
SURVEY OF.....GREENLEAF FISK SURVEY(A-5)
DATE.....OCTOBER, 2015
OF SINGLE FAMILY LOTS.....51
OF OPEN SPACE LOTS.....3
TOTAL # OF LOTS.....54
OF BLOCKS.....3

OWNER/DEVELOPER
NASH RANCHO HILLS, LLC
13809 RESEARCH BOULEVARD, SUITE 475
AUSTIN, TEXAS 78750
(512) 244-6667 FAX (512) 244-6875

ENGINEER
Bury-Aus, Inc.
221 WEST SIXTH STREET, SUITE 600
AUSTIN, TEXAS 78701
(512) 328-0011 FAX (512) 328-0325

SURVEYOR
Bury-Aus, Inc.
221 WEST SIXTH STREET, SUITE 600
AUSTIN, TEXAS 78701
(512) 328-0011 FAX (512) 328-0325

FIELDNOTE DESCRIPTION:

- ALONG SAID CURVE, HAVING A RADIUS OF 370.00 FEET, A CENTRAL ANGLE OF 16°30'03", AN ARC LENGTH OF 106.56 FEET, AND A CHORD WHICH BEARS S85°20'25"E, A DISTANCE OF 106.19 FEET TO A 1/2 INCH IRON ROD WITH "BURY" CAP SET AT THE END OF SAID CURVE;
- S14°29'40"W, A DISTANCE OF 158.57 FEET TO A 1/2 INCH IRON ROD WITH "BURY" CAP SET FOR AN ANGLE POINT HEREOF;
- S14°47'58"W, A DISTANCE OF 163.08 FEET TO A 1/2 INCH IRON ROD WITH "BURY" CAP SET FOR AN ANGLE POINT HEREOF;
- S18°16'38"W, A DISTANCE OF 97.34 FEET TO A 1/2 INCH IRON ROD WITH "BURY" CAP SET FOR AN ANGLE POINT HEREOF;
- S13°14'03"W, A DISTANCE OF 82.77 FEET TO A 1/2 INCH IRON ROD WITH "BURY" CAP SET FOR AN ANGLE POINT HEREOF;
- S09°03'02"W, A DISTANCE OF 67.78 FEET TO A 1/2 INCH IRON ROD WITH "BURY" CAP SET FOR AN ANGLE POINT HEREOF;
- S03°17'45"E, A DISTANCE OF 65.22 FEET TO A 1/2 INCH IRON ROD WITH "BURY" CAP SET FOR AN ANGLE POINT HEREOF;
- S23°51'23"E, A DISTANCE OF 74.65 FEET TO A 1/2 INCH IRON ROD WITH "BURY" CAP SET FOR AN ANGLE POINT HEREOF;
- S05°18'13"E, A DISTANCE OF 25.81 FEET TO A 1/2 INCH IRON ROD WITH "BURY" CAP SET FOR AN ANGLE POINT HEREOF;
- S33°37'08"E, A DISTANCE OF 54.23 FEET TO A 1/2 INCH IRON ROD WITH "BURY" CAP SET FOR AN ANGLE POINT HEREOF;
- S44°19'41"E, A DISTANCE OF 61.32 FEET TO A 1/2 INCH IRON ROD WITH "BURY" CAP SET FOR AN ANGLE POINT HEREOF;
- S51°58'38"E, A DISTANCE OF 64.68 FEET TO A 1/2 INCH IRON ROD WITH "BURY" CAP SET FOR AN ANGLE POINT HEREOF;
- S61°33'08"E, A DISTANCE OF 70.23 FEET TO A 1/2 INCH IRON ROD WITH "BURY" CAP SET FOR AN ANGLE POINT HEREOF;
- S61°41'33"E, A DISTANCE OF 85.51 FEET TO A 1/2 INCH IRON ROD WITH "BURY" CAP SET FOR AN ANGLE POINT HEREOF;
- S59°38'36"E, A DISTANCE OF 94.17 FEET TO A 1/2 INCH IRON ROD WITH "BURY" CAP SET FOR AN ANGLE POINT HEREOF;
- S47°03'58"E, A DISTANCE OF 26.18 FEET TO A 1/2 INCH IRON ROD WITH "BURY" CAP SET FOR AN ANGLE POINT HEREOF;
- S85°07'16"E, A DISTANCE OF 186.70 FEET TO A 1/2 INCH IRON ROD WITH "BURY" CAP SET FOR AN ANGLE POINT HEREOF;
- N74°00'42"E, A DISTANCE OF 92.53 FEET TO A 1/2 INCH IRON ROD WITH "BURY" CAP SET FOR AN ANGLE POINT HEREOF;
- N68°12'06"E, A DISTANCE OF 91.11 FEET TO A 1/2 INCH IRON ROD WITH "BURY" CAP SET FOR AN ANGLE POINT HEREOF;
- N56°41'12"E, A DISTANCE OF 91.38 FEET TO A 1/2 INCH IRON ROD WITH "BURY" CAP SET FOR AN ANGLE POINT HEREOF;
- N45°09'22"E, A DISTANCE OF 91.82 FEET TO A 1/2 INCH IRON ROD WITH "BURY" CAP SET FOR AN ANGLE POINT HEREOF;
- N33°34'07"E, A DISTANCE OF 91.99 FEET TO A 1/2 INCH IRON ROD WITH "BURY" CAP SET FOR AN ANGLE POINT HEREOF;
- N20°59'12"E, A DISTANCE OF 114.11 FEET TO A 1/2 INCH IRON ROD WITH "BURY" CAP SET FOR AN ANGLE POINT HEREOF;
- N84°34'42"W, A DISTANCE OF 3.27 FEET TO A 1/2 INCH IRON ROD WITH "BURY" CAP SET AT THE POINT OF CURVATURE OF A CURVE TO THE RIGHT;
- ALONG SAID CURVE, HAVING A RADIUS OF 325.00 FEET, A CENTRAL ANGLE OF 12°55'45", AN ARC LENGTH OF 73.34 FEET, AND A CHORD WHICH BEARS N78°06'49"W, A DISTANCE OF 73.18 FEET TO A 1/2 INCH IRON ROD WITH "BURY" CAP SET AT THE END OF SAID CURVE;
- N71°38'57"W, A DISTANCE OF 33.43 FEET TO A 1/2 INCH IRON ROD WITH "BURY" CAP SET AT THE POINT OF CURVATURE OF A CURVE TO THE LEFT;
- ALONG SAID CURVE, HAVING A RADIUS OF 25.00 FEET, A CENTRAL ANGLE OF 90°00'00", AN ARC LENGTH OF 39.27 FEET, AND A CHORD WHICH BEARS S63°20'59"W, A DISTANCE OF 35.36 FEET TO A 1/2 INCH IRON ROD WITH "BURY" CAP SET AT THE END OF SAID CURVE;
- N71°38'57"W, A DISTANCE OF 50.00 FEET TO A 1/2 INCH IRON ROD WITH "BURY" CAP SET FOR AN ANGLE POINT HEREOF;
- N18°21'03"E, A DISTANCE OF 1.68 FEET TO A 1/2 INCH IRON ROD WITH "BURY" CAP SET AT THE POINT OF CURVATURE OF A CURVE TO THE LEFT;
- ALONG SAID CURVE, HAVING A RADIUS OF 25.00 FEET, A CENTRAL ANGLE OF 85°31'00", AN ARC LENGTH OF 37.31 FEET, AND A CHORD WHICH BEARS N24°24'27"W, A DISTANCE OF 33.95 FEET TO A 1/2 INCH IRON ROD WITH "BURY" CAP SET AT THE POINT OF CURVATURE OF A REVERSE CURVE TO THE RIGHT;
- ALONG SAID REVERSE CURVE, HAVING A RADIUS OF 525.00 FEET, A CENTRAL ANGLE OF 10°34'54", AN ARC LENGTH OF 96.96 FEET, AND A CHORD WHICH BEARS N61°52'30"W, A DISTANCE OF 96.82 FEET TO A 1/2 INCH IRON ROD WITH "BURY" CAP SET AT THE END OF SAID CURVE;
- S33°51'05"W, A DISTANCE OF 98.58 FEET TO A 1/2 INCH IRON ROD WITH "BURY" CAP SET FOR AN ANGLE POINT HEREOF;
- S41°29'02"W, A DISTANCE OF 63.18 FEET TO A 1/2 INCH IRON ROD WITH "BURY" CAP SET FOR AN ANGLE POINT HEREOF;
- S77°01'08"W, A DISTANCE OF 65.23 FEET TO A 1/2 INCH IRON ROD WITH "BURY" CAP SET FOR AN ANGLE POINT HEREOF;
- N75°21'30"W, A DISTANCE OF 60.81 FEET TO A 1/2 INCH IRON ROD WITH "BURY" CAP SET FOR AN ANGLE POINT HEREOF;
- N61°39'37"W, A DISTANCE OF 79.50 FEET TO A 1/2 INCH IRON ROD WITH "BURY" CAP SET FOR AN ANGLE POINT HEREOF;
- N49°42'15"W, A DISTANCE OF 71.34 FEET TO A 1/2 INCH IRON ROD WITH "BURY" CAP SET FOR AN ANGLE POINT HEREOF;
- N21°58'31"W, A DISTANCE OF 68.34 FEET TO A 1/2 INCH IRON ROD WITH "BURY" CAP SET FOR AN ANGLE POINT HEREOF;
- N05°33'35"E, A DISTANCE OF 69.86 FEET TO A 1/2 INCH IRON ROD WITH "BURY" CAP SET FOR AN ANGLE POINT HEREOF;
- N17°14'58"E, A DISTANCE OF 75.00 FEET TO A 1/2 INCH IRON ROD WITH "BURY" CAP SET FOR AN ANGLE POINT HEREOF;
- N19°16'20"E, A DISTANCE OF 77.50 FEET TO A 1/2 INCH IRON ROD WITH "BURY" CAP SET FOR AN ANGLE POINT HEREOF;
- N50°21'31"E, A DISTANCE OF 73.33 FEET TO A 1/2 INCH IRON ROD WITH "BURY" CAP SET FOR AN ANGLE POINT HEREOF;
- N38°58'26"W, A DISTANCE OF 5.00 FEET TO A 1/2 INCH IRON ROD WITH "BURY" CAP SET FOR AN ANGLE POINT HEREOF;
- N51°01'34"E, A DISTANCE OF 50.00 FEET TO A 1/2 INCH IRON ROD WITH "BURY" CAP SET FOR AN ANGLE POINT HEREOF;
- S38°58'26"E, A DISTANCE OF 9.92 FEET TO A 1/2 INCH IRON ROD WITH "BURY" CAP SET FOR AN ANGLE POINT HEREOF;
- N51°01'34"E, A DISTANCE OF 357.73 FEET TO A 1/2 INCH IRON ROD WITH "BURY" CAP SET IN THE SOUTHERLY LINE OF LOT 54 OF SAID BLOCK "S", BEING THE NORTHERLY LINE OF SAID TRACT 3E, FOR AN ANGLE POINT HEREOF;

THENCE, S46°14'09"E, ALONG THE SOUTHERLY LINE OF SAID LOTS 54-58 OF SAID BLOCK "S", WITH THE NORTHERLY LINE OF SAID TRACT 3E, FOR A PORTION OF THE NORTHERLY LINE HEREOF, A DISTANCE OF 255.14 FEET TO THE POINT OF BEGINNING, AND CONTAINING AN AREA OF 23.437 ACRES (1,020,907 SQUARE FEET) OF LAND, MORE OR LESS, WITHIN THESE METES AND BOUNDS.

FINAL PLAT OF RANCHO SIENNA SECTION 14, PHASE 1

DATE: OCTOBER, 2015

BURY

221 West Sixth Street, Suite 600
Austin, Texas 78701
Tel. (512) 328-0011 Fax (512) 328-0325
TBPE # F-1048 TBPLS # F-10107500
Copyright © 2015

SHEET

1

OF 4

RANCHO SIENNA SECTION 14 STREET SUMMARY

STREET NAME	LENGTH	DESIGN SPEED
RANCHO SIENNA LOOP	1,530 LINEAR FEET	30 MILES PER HOUR
PIENZA DRIVE	750 LINEAR FEET	25 MILES PER HOUR
VENTUNO COVE	78 LINEAR FEET	25 MILES PER HOUR

FINAL PLAT OF RANCHO SIENNA SECTION 14, PHASE 1

BEING 23.437 ACRES OUT OF THE GREENLEAF FISK SURVEY,
ABSTRACT NO. 5 WILLIAMSON COUNTY, TEXAS.

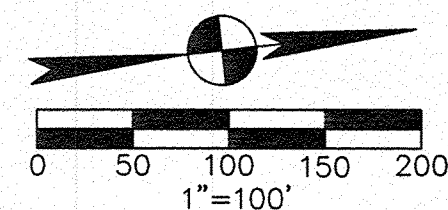

FOURTH TAKE DOWN
TRACT 4A 50.407 ACRES
NASH RANCHO HILLS, LLC
DOCUMENT NO. 2015038403

REMAINDER OF 606.19 ACRES
RANCHO SIENNA KC, LP
DOCUMENT NO. 2007081893

REMAINDER OF TRACT 1A
34.166 ACRES
NASH RANCHO HILLS, LLC
DOCUMENT NO. 2013060667

2
1 RANCHO SIENNA
SECTION 12A
DOCUMENT NO. 2013081958

RANCHO SIENNA LOOP
(60' R.O.W.)

LEGEND

- 1/2" IRON ROD WITH "BURY" CAP SET
- 1/2" IRON ROD FOUND (UNLESS NOTED)
- ③ BLOCK
- O/S OPEN SPACE
- S/W SIDEWALK EASEMENT
- PUE PUBLIC UTILITY EASEMENT
- D/E DRAINAGE EASEMENT
- BL BUILDING SETBACK LINE
- F/W FENCE/WALL EASEMENT
- P.O.B. POINT OF BEGINNING
- R.O.W. RIGHT-OF-WAY

REMAINDER OF TRACT 1A
34.166 ACRES
NASH RANCHO HILLS, LLC
DOCUMENT NO. 2013060667

GREENLEAF FISK SURVEY
ABSTRACT NO. 5

REMAINDER OF 606.19 ACRES
RANCHO SIENNA KC, LP
DOCUMENT NO. 2007081893

THIRD TAKE DOWN
TRACT 3E 30.103 ACRES
NASH RANCHO HILLS, LLC
DOCUMENT NO. 2014001964

REMAINDER OF
8.915 ACRES
NASH RANCHO HILLS, LLC
DOCUMENT NO. 2013109919

REMAINDER OF 606.19 ACRES
RANCHO SIENNA KC, LP
DOCUMENT NO. 2007081893

BEARING BASIS NOTE:

THE BASIS OF BEARING OF THE SURVEY SHOWN
HEREON IS TEXAS STATE PLANE COORDINATE
SYSTEM, CENTRAL ZONE, NAD 83(96), UTILIZING
WESTERN DATA SYSTEMS CONTINUALLY OPERATING
REFERENCE STATION (CORS) NETWORK.

SHEET
2
OF 4

FOURTH TAKE DOWN
TRACT 4A 50.407 ACRES
NASH RANCHO HILLS, LLC
DOCUMENT NO. 2015038403

THIRD TAKE DOWN
TRACT 3E 30.103 ACRES
NASH RANCHO HILLS, LLC
DOCUMENT NO. 2014001964

FINAL PLAT OF RANCHO SIENNA SECTION 14, PHASE 1

DATE: OCTOBER, 2015

BURY

221 West Sixth Street, Suite 600
Austin, Texas 78701
Tel. (512) 328-0011 Fax (512) 328-0325
TBPE # F-1048 TBPLS # F-10107500
Copyright © 2015

FINAL PLAT OF RANCHO SIENNA SECTION 14, PHASE 1

BEING 23.437 ACRES OUT OF THE GREENLEAF FISK SURVEY,
ABSTRACT NO. 5 WILLIAMSON COUNTY, TEXAS.

LINE TABLE		
NO.	BEARING	DISTANCE
L1	S9°40'29"W	50.14'
L2	N83°45'16"W	5.17'
L3	S6°14'44"W	8.12'
L4	N83°45'16"W	50.00'
L5	S66°19'54"W	100.89'
L6	S18°53'25"E	121.50'
L8	S71°51'15"W	83.34'
L9	S85°58'58"W	88.67'
L10	N84°06'07"W	88.67'
L11	N74°11'12"W	88.67'
L12	N64°16'17"W	88.67'
L13	N54°21'10"W	88.67'
L14	N44°41'01"W	149.34'
L15	N66°22'56"W	155.75'
L16	N62°33'53"W	85.28'
L17	N52°15'36"W	85.45'
L18	N44°19'53"W	85.91'
L19	N36°17'24"W	79.21'
L20	N8°42'36"E	9.62'
L21	S66°33'27"W	1.21'

LINE TABLE		
NO.	BEARING	DISTANCE
L22	N23°26'34"W	50.00'
L23	N20°56'04"E	101.75'
L24	N3°35'26"W	149.13'
L25	N86°24'34"E	60.00'
L26	S3°35'26"E	78.74'
L27	S3°35'26"E	50.00'
L28	N86°24'34"E	49.52'
L29	S18°16'38"W	97.34'
L30	S13°14'03"W	82.77'
L31	S9°03'02"W	67.78'
L32	S3°17'45"E	65.22'
L33	S23°51'23"E	74.65'
L34	S5°18'13"E	25.81'
L35	S33°37'06"E	54.23'
L36	S44°19'41"E	61.32'
L37	S51°58'38"E	64.68'
L38	S61°33'08"E	70.23'
L39	S61°41'33"E	85.51'
L40	S59°38'36"E	94.17'
L41	S47°03'58"E	26.18'

LINE TABLE		
NO.	BEARING	DISTANCE
L42	N74°00'42"E	92.53'
L43	N68°12'06"E	91.11'
L44	N56°41'12"E	91.38'
L45	N45°09'22"E	91.82'
L46	N33°34'07"E	91.99'
L47	N20°59'12"E	114.11'
L48	N84°34'42"W	3.27'
L49	N71°38'57"W	33.43'
L50	N71°38'57"W	50.00'
L51	N18°21'03"E	1.68'
L52	S33°51'05"W	98.58'
L53	S41°29'02"W	63.18'
L54	S77°01'08"W	65.23'
L55	N75°21'30"W	60.81'
L56	N61°39'37"W	79.50'
L57	N49°42'15"W	71.34'
L58	N21°58'31"W	68.34'
L59	N5°33'35"E	69.86'
L60	N17°14'58"E	75.00'
L61	N19°16'20"E	77.50'

LINE TABLE		
NO.	BEARING	DISTANCE
L62	N50°21'31"E	73.33'
L63	N38°58'26"W	5.00'
L64	N51°01'34"E	50.00'
L65	S38°58'26"E	9.92'
L66	N47°03'58"W	46.89'
L67	S38°58'33"E	88.78'
L68	S45°39'57"E	67.41'
L69	S56°48'16"E	67.07'
L70	S67°50'18"E	67.74'
L71	S71°38'57"E	71.00'
L72	S80°14'08"E	61.53'
L73	S37°24'25"E	7.33'
L74	N84°34'42"W	82.17'
L75	S71°38'57"E	90.44'
L76	N84°34'42"W	75.19'
L77	N83°45'16"W	42.62'
L78	S66°19'54"W	100.89'
L79	N45°51'54"W	101.28'
L80	N66°08'36"W	101.48'
L81	N20°56'04"E	101.75'

LINE TABLE		
NO.	BEARING	DISTANCE
L82	N86°24'34"E	0.51'
L83	N45°51'54"W	101.28'
L84	N66°08'36"W	101.48'
L85	N38°45'16"W	7.07'
L86	S83°45'16"E	80.25'
L87	N83°46'08"E	93.94'
L88	N72°18'52"E	90.00'
L89	N60°55'30"E	78.35'
L90	N71°39'27"E	66.49'
L91	S88°09'48"E	66.49'
L92	S58°04'33"E	65.46'
L93	S42°22'55"E	77.09'
L97	N23°40'06"W	60.00'
L98	N69°03'55"W	60.00'

PLAT NOTES:

- THIS PLAT LIES WITHIN THE BOUNDARY OF THE WILLIAMSON COUNTY MUNICIPAL UTILITY DISTRICT NO. 12 (WCMUD 12). WATER AND WASTEWATER SERVICE FOR THIS SUBDIVISION WILL BE PROVIDED THROUGH SERVICE AGREEMENTS ENTERED INTO BETWEEN WCMUD 12 AND THE CHISHOLM TRAIL SPECIAL UTILITY DISTRICT AND THE LCRA. WATER SERVICE FOR THIS SUBDIVISION WILL BE PROVIDED BY THE CITY OF GEORGETOWN SEWER SERVICE WILL BE PROVIDED BY THE CITY OF LIBERTY HILL.
- BUILDING SLAB ELEVATION SHALL BE A MINIMUM OF ONE (1) FOOT ABOVE ANY POINT ON THE LOT WITHIN FIVE (5) FEET OF THE PERIMETER OF THE BUILDING.
- NO LOT IN THIS SUBDIVISION SHALL BE OCCUPIED UNTIL CONNECTION IS MADE TO AN APPROVED PUBLIC SEWER SYSTEM.
- NO LOT IN THIS SUBDIVISION SHALL BE OCCUPIED UNTIL WATER SATISFACTORY FOR HUMAN CONSUMPTION IS AVAILABLE FROM A SOURCE IN ADEQUATE AND SUFFICIENT SUPPLY.
- NO STRUCTURE OR LAND IN THIS PLAT SHALL HEREFTER BE LOCATED OR ALTERED WITHOUT FIRST OBTAINING A CERTIFICATE OF COMPLIANCE APPLICATION FORM TO THE WILLIAMSON COUNTY FLOOD PLAIN ADMINISTRATOR.
- THE OPEN SPACE LOTS WILL BE OWNED AND MAINTAINED BY THE HOME OWNERS ASSOCIATION.
- NO CONSTRUCTION IN THIS SUBDIVISION MAY BEGIN UNTIL THE TEXAS COMMISSION ON ENVIRONMENTAL QUALITY (TCEQ) HAS APPROVED, IN WRITING, THE WATER POLLUTION ABATEMENT PLAN (WPAP).
- SIDEWALKS LOCATED ADJACENT TO OPEN SPACE AND HOMEOWNER ASSOCIATION LOTS WILL BE MAINTAINED BY THE HOMEOWNERS ASSOCIATION. SIDEWALKS LOCATED ADJACENT TO SINGLE FAMILY RESIDENTIAL LOTS (WITHIN PUBLIC RIGHT OF WAY) SHALL BE MAINTAINED BY THE RESPECTIVE ADJACENT PROPERTY OWNER.
- FENCE/WALL EASEMENTS WITHIN THE BOUNDARIES OF THIS PLAT AND MAINTENANCE OF FENCES/WALLS LOCATED WITHIN THESE EASEMENTS SHALL BE MAINTAINED BY THE HOMEOWNERS ASSOCIATION.
- PEC EASEMENTS SHALL BE LOCATED AS FOLLOWS: FRONT EASEMENT SHALL BE A STRIP OF LAND TEN (10') FEET IN WITH LOCATED ALONG ALL RIGHT-OF-WAYS (ROADS) AND SIDE-LOT EASEMENT SHALL BE TWO AND ONE HALF (2.5') FEET IN WIDTH LOCATED ALONG ALL SIDE LOT LINES AS NEEDED FOR THE CONSTRUCTION OF SAID DISTRIBUTION POWER LINE IN THE SUBDIVISION, THE CENTERLINE OF SUCH EASEMENT TO BE LOCATED ALONG THE COMMON BOUNDARY LINE OF EACH RESIDENTIAL SINGLE-FAMILY LOT. THE PURPOSE OF AN UNDERGROUND ELECTRIC DISTRIBUTION SYSTEM CONSISTING OF VARIABLE NUMBER OF UNDERGROUND CABLES AND ALL NECESSARY OR DESIRABLE APPURTENANCES (INCLUDING CONDUITS, PRIMARY CABLES, SECONDARY CONDUCTORS, ENCLOSURES, CONCRETE PADS, GROUND RODS, GROUND CLAMPS, TRANSFORMERS, CABLE TERMINATORS, CABLE RISER SHIELDS, CUTOUTS, AND LIGHTING ARRESTORS OVERGROUND) AT OR NEAR THE GENERAL COURSE WHICH SHALL BECOME FIXED AT THE LOCATION OF BURIED BY GRANTEE, THROUGH, ACROSS, AND UNDER THE DESCRIBED LOCATIONS WITHIN THIS FINAL PLAT, TOGETHER WITH THE RIGHT OF INGRESS AND EGRESS OVER THE SAID EASEMENTS FOR THE PURPOSE OF CONSTRUCTING, RECONSTRUCTING, INSPECTING, PATROLLING, PULLING NEW WIRE ON, MAINTAINING AND REMOVING SAID LINES AND APPURTENANCES; THE RIGHT TO RELOCATE WITHIN THE LIMITS OF SAID RIGHT-OF-WAY; THE RIGHT TO RELOCATE SAID FACILITIES IN THE SAME RELATIVE POSITION TO ANY ADJACENT ROAD IF AND SUCH ROAD IS WIDENED IN THE FUTURE; THE RIGHT TO REMOVE FROM SAID LANDS ALL TREES AND PARTS THEREOF, OR OTHER OBSTRUCTIONS WHICH ENDANGER OR MAY INTERFERE WITH THE EFFICIENCY OF SAID LINES OR THEIR APPURTENANCES.

CURVE TABLE					
NO.	LENGTH	RADIUS	DELTA	CHORD BEARING	CHORD LENGTH
C1	39.27'	25.00'	90°00'00"	S51°14'44"W	35.36'
C2	45.72'	25.00'	104°47'36"	N46°09'04"W	39.61'
C3	71.25'	270.00'	15°07'14"	S73°53'31"W	71.05'
C4	31.69'	380.00'	4°46'40"	S68°43'15"W	31.68'
C5	24.19'	480.00'	2°53'17"	N30°49'25"W	24.19'
C6	29.34'	20.00'	84°03'47"	N71°24'40"W	26.78'
C7	29.88'	20.00'	85°36'32"	N23°45'11"E	27.18'
C8	334.98'	480.00'	39°59'09"	N00°56'30"E	328.23'
C9	329.59'	770.00'	24°31'30"	N08°40'19"E	327.08'
C10	39.27'	25.00'	90°00'00"	S48°35'26"E	35.36'
C11	106.56'	370.00'	16°30'03"	S85°20'25"E	106.19'
C12	73.34'	325.00'	12°55'45"	N78°06'49"W	73.18'
C13	39.27'	25.00'	90°00'00"	N63°21'03"E	35.36'
C14	37.31'	25.00'	85°31'00"	N24°24'27"W	33.95'
C15	96.96'	525.00'	10°34'54"	N61°52'30"W	96.82'
C16	62.06'	275.00'	12°55'45"	S78°06'49"E	61.92'
C17	270.89'	475.00'	32°40'31"	S55°18'41"E	267.23'
C18	112.46'	525.00'	12°16'26"	S50°26'50"E	112.25'
C19	37.53'	25.00'	86°00'59"	N87°19'06"W	34.11'

CURVE TABLE					
NO.	LENGTH	RADIUS	DELTA	CHORD BEARING	CHORD LENGTH
C20	20.01'	25.00'	45°51'56"	S26°44'26"W	19.48'
C21	237.31'	50.00'	271°56'07"	S40°13'28"E	69.51'
C22	58.78'	25.00'	134°43'01"	N28°23'05"E	46.15'
C23	172.29'	330.00'	29°54'50"	S81°17'19"W	170.34'
C24	378.68'	320.00'	67°48'11"	S79°46'00"E	356.97'
C25	116.79'	330.00'	20°16'41"	N56°00'15"W	116.19'
C26	638.31'	420.00'	87°04'40"	S22°36'16"E	578.63'
C27	326.53'	830.00'	22°32'27"	N09°39'51"E	324.43'
C28	38.40'	25.00'	88°00'56"	S42°24'05"W	34.74'
C29	76.82'	475.00'	9°15'59"	S67°00'57"E	76.74'
C30	92.49'	475.00'	11°09'23"	S56°48'16"E	92.34'
C31	92.96'	475.00'	11°12'45"	S45°37'12"E	92.81'
C32	8.62'	475.00'	1°02'24"	S39°29'38"E	8.62'
C33	37.45'	50.00'	42°54'38"	N25°15'48"E	36.58'
C34	51.59'	50.00'	59°07'11"	N76°16'42"E	49.33'
C35	51.59'	50.00'	59°07'11"	S44°36'06"E	49.33'
C36	51.59'	50.00'	59°07'11"	S14°31'05"W	49.33'
C37	45.09'	50.00'	51°39'54"	S69°54'38"W	43.57'
C38	418.00'	380.00'	63°01'31"	S77°22'40"E	397.24'

CURVE TABLE					
NO.	LENGTH	RADIUS	DELTA	CHORD BEARING	CHORD LENGTH
C39	95.56'	270.00'	20°16'41"	N56°00'15"W	95.06'
C40	283.80'	480.00'	33°52'33"	S49°12'19"E	279.68'
C41	65.76'	380.00'	9°54'55"	N76°04'02"E	65.68'
C42	65.76'	380.00'	9°54'55"	N85°58'58"E	65.68'
C43	65.76'	380.00'	9°54'55"	S84°06'07"E	65.68'
C44	65.76'	380.00'	9°54'55"	S74°11'12"E	65.68'
C45	65.76'	380.00'	9°54'55"	S64°16'17"E	65.68'
C46	65.76'	380.00'	9°54'55"	S54°21'22"E	65.68'
C47	23.43'	380.00'	3°32'00"	S47°37'54"E	23.43'
C48	31.28'	270.00'	6°38'17"	N49°11'03"W	31.26'
C49	64.28'	270.00'	13°38'24"	N59°19'23"W	64.13'
C50	16.28'	480.00'	1°56'35"	S65°10'18"E	16.28'
C51	66.59'	480.00'	7°56'54"	S60°13'34"E	66.53'
C52	66.59'	480.00'	7°56'54"	S52°16'40"E	66.53'
C53	66.95'	480.00'	7°59'29"	S44°18'29"E	66.89'
C54	67.40'	480.00'	8°02'41"	S36°17'24"E	67.34'
C55	46.88'	330.00'	8°08'19"	N87°49'25"W	46.84'
C56	66.78'	330.00'	11°35'43"	S82°18'34"W	66.67'
C57	58.63'	330.00'	10°10'48"	S71°25'18"W	58.56'

CURVE TABLE					
NO.	LENGTH	RADIUS	DELTA	CHORD BEARING	CHORD LENGTH
C58	86.03'	320.00'	15°24'16"	N74°02'03"E	85.78'
C59	112.58'	320.00'	20°09'26"	S88°11'06"E	112.00'
C60	112.58'	320.00'	20°09'26"	S68°01'40"E	112.00'
C61	67.49'	320.00'	12°05'02"	S51°54'26"E	67.36'
C62	65.32'	330.00'	11°20'31"	N52°52'56"W	65.22'
C63	43.72'	330.00'	7°35'25"	N62°20'53"W	43.68'
C64	87.66'	420.00'	11°57'31"	S60°09'50"E	87.50'
C65	98.22'	420.00'	13°23'58"	S47°29'06"E	98.00'
C66	101.62'	420.00'	13°51'45"	S33°51'14"E	101.37'
C67	31.75'	420.01'	4°19'52"	S24°45'26"E	31.74'
C68	115.49'	420.00'	15°45'19"	S14°42'50"E	115.13'
C69	103.86'	420.00'	14°10'08"	S00°14'54"W	103.60'
C70	99.70'	420.00'	13°36'06"	S14°08'01"W	99.47'
C71	68.23'	830.00'	4°42'35"	N18°34'46"E	68.21'
C72	70.40'	830.00'	4°51'35"	N13°47'42"E	70.38'
C73	67.61'	830.00'	4°40'03"	N09°01'53"E	67.60'
C74	69.84'	830.00'	4°49'15"	N04°17'14"E	69.81'
C75	50.46'	830.00'	3°28'59"	N00°08'07"E	50.45'
C76	7.75'	330.00'	1°20'46"	N46°32'17"W	7.75'

FINAL PLAT OF RANCHO SIENNA
SECTION 14, PHASE 1

DATE: OCTOBER, 2015

BURY

221 West Sixth Street, Suite 600
Austin, Texas 78701
Tel. (512) 328-0011 Fax (512) 328-0325
TBPE # F-1048 TBPLS # F-10107500
Copyright © 2015

SHEET

3

OF 4

FINAL PLAT OF RANCHO SIENNA SECTION 14, PHASE 1

BEING 23.437 ACRES OUT OF THE GREENLEAF FISK SURVEY,
ABSTRACT NO. 5 WILLIAMSON COUNTY, TEXAS.

STATE OF TEXAS §
COUNTY OF WILLIAMSON § KNOW ALL MEN BY THESE PRESENTS

THAT NASH RANCHO HILLS, LLC, SOLE OWNER OF THE CERTAIN TRACTS OF LAND SHOWN HEREON AND BEING A PORTION OF THAT CERTAIN TRACT 3E-30.103 ACRE TRACT OF LAND DESCRIBED IN DEED RECORDED IN DOCUMENT NO. 2014001964 AND TRACT 4A-50.407 ACRE TRACT OF LAND DESCRIBED IN DEED RECORDED IN DOCUMENT NO. 2015038403, BOTH OF THE OFFICIAL PUBLIC RECORDS OF WILLIAMSON COUNTY, TEXAS, DOES HEREBY SUBDIVIDE THE 23.437 ACRES AS SHOWN HEREON AND DEDICATE TO THE PUBLIC USE FOREVER THE STREETS, ALLEYS, EASEMENTS AND ALL OTHER LANDS INTENDED FOR PUBLIC DEDICATION AS SHOWN HEREON. THIS SUBDIVISION IS TO BE KNOWN AS "FINAL PLAT OF RANCHO SIENNA SECTION 14, PHASE 1". THE OWNER ACKNOWLEDGES THAT IT IS THE RESPONSIBILITY OF THE OWNER, NOT THE COUNTY, TO ASSURE COMPLIANCE WITH THE PROVISIONS OF ALL APPLICABLE STATE, FEDERAL, AND LOCAL LAWS AND REGULATIONS RELATING TO THE ENVIRONMENT, INCLUDING BUT NOT LIMITED TO THE ENDANGERED SPECIES ACT, STATE AQUIFER REGULATIONS, AND MUNICIPAL WATERSHED ORDINANCES.

NASH RANCHO HILLS, LLC,, A DELAWARE LIMITED LIABILITY COMPANY

BY: -----

BY: E. William Meyer

NAME: E. William Meyer 11-13-15
DATE

TITLE: Authorized Signatory

STATE OF TEXAS §
COUNTY OF WILLIAMSON § KNOW ALL MEN BY THESE PRESENTS

BEFORE ME, THE UNDERSIGNED AUTHORITY, ON THIS DAY PERSONALLY APPEARED E. WILLIAM MEYER, OF NASH RANCHO HILLS, LLC,, A DELAWARE LIMITED LIABILITY COMPANY, KNOWN TO ME TO BE THE PERSON WHOSE NAME IS SUBSCRIBED TO THE FOREGOING INSTRUMENT AND ACKNOWLEDGED TO ME THAT THEY EXECUTED THE SAME FOR THE PURPOSES AND CONSIDERATION THEREIN EXPRESSED, IN THE CAPACITY THEREIN STATED.

GIVEN UNDER MY HAND AND SEAL OF OFFICE THIS 13th DAY OF November, 2015.

R. Hinojosa
NOTARY PUBLIC IN AND FOR THE STATE OF TEXAS

PRINTED NAME: R. Hinojosa

MY COMMISSION EXPIRES ON: 3-1-16

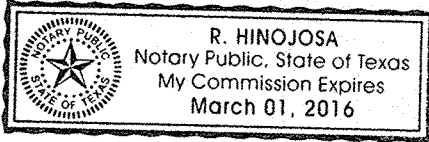

ENGINEER'S CERTIFICATION:

I, JOHN A. PICKENS, REGISTERED PROFESSIONAL ENGINEER IN THE STATE OF TEXAS, DO HEREBY CERTIFY THAT THIS SUBDIVISION IS IN THE EDWARDS AQUIFER RECHARGE ZONE AND IS NOT ENCROACHED BY A ZONE A FLOOD AREA, AS DENOTED HEREIN, AND IS DEFINED BY FEDERAL EMERGENCY MANAGEMENT ADMINISTRATION FLOOD HAZARD BOUNDARY MAP, COMMUNITY PANEL NUMBERS 48491C0275E AND 48491C0460E, EFFECTIVE DATE SEPTEMBER 26, 2008, WILLIAMSON COUNTY, TEXAS, AND COMPLY WITH THE WILLIAMSON COUNTY SUBDIVISION ORDINANCE.

THE FULLY DEVELOPED, CONCENTRATED STORMWATER RUNOFF RESULTING FROM THE ONE HUNDRED (100) YEAR FREQUENCY STORM IS CONTAINED WITHIN THE DRAINAGE EASEMENTS SHOWN AND/ OR PUBLIC RIGHTS-OF-WAY DEDICATED BY THIS PLAT.

TO CERTIFY WHICH, WITNESS MY HAND AND SEAL AT AUSTIN, TRAVIS COUNTY, TEXAS,

THIS 9 DAY OF Nov, 2015.

John A. Pickens
JOHN A. PICKENS, P.E.
NO. 110631 STATE OF TEXAS
BURY-AUS, INC.
221 WEST SIXTH STREET, SUITE 600
AUSTIN, TEXAS 78701

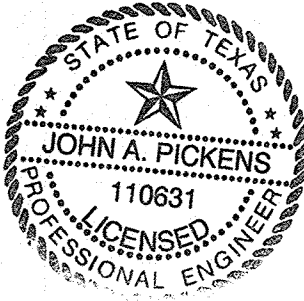

SURVEYOR'S CERTIFICATION:

THAT I, JOHN T. BILNOSKI, A REGISTERED PROFESSIONAL LAND SURVEYOR, DO HEREBY CERTIFY THAT I PREPARED THIS PLAT FROM AN ACTUAL AND ACCURATE ON-THE-GROUND SURVEY OF THE LAND AND THAT THE CORNER MONUMENTS SHOWN THEREON WERE PROPERLY PLACED UNDER MY PERSONAL SUPERVISION, IN ACCORDANCE WITH THE SUBDIVISION REGULATIONS OF WILLIAMSON COUNTY, TEXAS, AND THE FIELD NOTES SHOWN HEREON MATHEMATICALLY CLOSE.

John T. Bilnoski
JOHN T. BILNOSKI, R.P.L.S.
TEXAS REGISTRATION NO. 4998
BURY-AUS, INC.
221 WEST SIXTH STREET, SUITE 600
AUSTIN, TEXAS 78701

11/9/15
DATE



STATE OF TEXAS §
COUNTY OF WILLIAMSON § KNOW ALL MEN BY THESE PRESENTS

WE, NASH FINANCING, LLC, A DELAWARE LIMITED LIABILITY COMPANY, LIEN HOLDER OF CERTAIN TRACT OF LAND SHOWN HEREON AND DESCRIBED IN A DEED RECORDED IN DOCUMENT NO. 2013109919 OF THE OFFICIAL PUBLIC RECORDS OF WILLIAMSON COUNTY, TEXAS, DO HEREBY CONSENT TO THE SUBDIVISION OF SAID TRACT AS SHOWN HEREON, AND DO FURTHER HEREBY JOIN, APPROVE AND CONSENT TO ALL PLAT NOTE REQUIREMENTS SHOWN HEREON, AND DO HEREBY DEDICATE TO WILLIAMSON COUNTY, TEXAS THE STREETS, ALLEYS, RIGHTS-OF-WAY, EASEMENTS AND PUBLIC PLACES SHOWN HEREON FOR SUCH PUBLIC PURPOSES AS WILLIAMSON COUNTY, TEXAS MAY DEEM APPROPRIATE. THIS SUBDIVISION IS TO BE KNOWN AS "FINAL PLAT OF RANCHO SIENNA SECTION 14, PHASE 1".

TO CERTIFY WHICH, WITNESS BY MY HAND THIS 16 DAY OF Nov, 2015.

NASH FINANCING, LLC,
A DELAWARE LIMITED LIABILITY COMPANY

BY: NORTH AMERICA SEKISUI HOUSE, LLC,
A DELAWARE LIMITED LIABILITY COMPANY
ITS SOLE MEMBER

BY: Koji Yamada 11-16-15
DATE

STATE OF CALIFORNIA X
COUNTY OF San Diego X

ON November 16, 2015, BEFORE

ME, K. Paxton, notary public PERSONALLY

APPEARED, Koji Yamada WHO PROVED TO ME ON THE BASIS OF SATISFACTORY EVIDENCE TO BE THE PERSON(S) WHOSE NAME(S) IS/ARE SUBSCRIBED TO THE WITHIN INSTRUMENT AND ACKNOWLEDGED TO ME THAT HE/SHE/THEY EXECUTED THE SAME IN HIS/HER/THEIR AUTHORIZED CAPACITY(IES), AND THAT BY HIS/HER/THEIR SIGNATURE(S) ON THE INSTRUMENT THE PERSON(S), OR THE ENTITY UPON BEHALF OF WHICH THE PERSON(S) ACTED, EXECUTED THE INSTRUMENT.

I CERTIFY UNDER PENALTY OF PERJURY UNDER THE LAWS OF THE STATE OF CALIFORNIA THAT THE FOREGOING PARAGRAPH IS TRUE AND CORRECT.

WITNESS MY HAND AND OFFICIAL SEAL

SIGNATURE K. Paxton



Jenisa Bar 11/19/15
WILLIAMSON COUNTY ADDRESSING COORDINATOR DATE

IN APPROVING THIS PLAT BY THE COMMISSIONERS' COURT OF WILLIAMSON COUNTY, TEXAS, IT IS UNDERSTOOD THAT THE BUILDING OF ALL STREETS, ROADS, AND OTHER PUBLIC THOROUGHFARES AND ANY BRIDGES OR CULVERTS NECESSARY TO BE CONSTRUCTED OR PLACED IS THE RESPONSIBILITY OF THE OWNERS OF THE TRACT OF LAND COVERED BY THIS PLAT IN ACCORDANCE WITH THE PLANS AND SPECIFICATIONS PRESCRIBED BY THE COMMISSIONERS' COURT OF WILLIAMSON COUNTY, TEXAS. SAID COMMISSIONERS' COURT ASSUMES NO OBLIGATION TO BUILD ANY STREETS, ROADS, AND OTHER PUBLIC THOROUGHFARES SHOWN ON THIS PLAT OR OF CONSTRUCTING ANY OF THE BRIDGES OR DRAINAGE IMPROVEMENTS IN CONNECTION THEREWITH. THE COURT WILL ASSUME NO RESPONSIBILITY FOR DRAINAGE WAYS OR EASEMENTS IN THE SUBDIVISION, OTHER THAN THOSE DRAINING OR PROTECTING THE ROAD SYSTEM AND STREETS.

THE COUNTY ASSUMES NO RESPONSIBILITY FOR THE ACCURACY OR REPRESENTATIONS BY OTHER PARTIES IN THIS PLAT. FLOOD PLAIN DATA, IN PARTICULAR, MAY CHANGE DEPENDING ON SUBSEQUENT DEVELOPMENT. IT IS FURTHER UNDERSTOOD THAT THE OWNERS OF THE TRACT OF LAND COVERED BY THIS PLAT MUST INSTALL AT THEIR OWN EXPENSE ALL TRAFFIC CONTROL DEVICES AND SIGNAGE THAT MAY BE REQUIRED BEFORE THE STREETS IN THE SUBDIVISION HAVE FINALLY BEEN ACCEPTED FOR MAINTENANCE BY THE COUNTY.

STATE OF TEXAS §
COUNTY OF WILLIAMSON § KNOW ALL MEN BY THESE PRESENTS

I, _____, COUNTY JUDGE OF WILLIAMSON COUNTY, TEXAS, DO HEREBY CERTIFY THAT THIS MAP OR PLAT, WITH FIELD NOTES HEREON, THAT A SUBDIVISION HAVING BEEN FULLY PRESENTED TO THE COMMISSIONERS' COURT OF WILLIAMSON COUNTY, TEXAS, AND BY THE SAID COURT DULY CONSIDERED, WERE ON THIS DAY APPROVED AND PLAT IS AUTHORIZED TO BE REGISTERED AND RECORDED IN THE PROPER RECORDS OF THE COUNTY CLERK OF WILLIAMSON COUNTY, TEXAS.

_____, COUNTY JUDGE
WILLIAMSON COUNTY, TEXAS

STATE OF TEXAS §
COUNTY OF WILLIAMSON § KNOW ALL MEN BY THESE PRESENTS

I, NANCY RISTER, CLERK OF THE COUNTY COURT OF SAID COUNTY, DO HEREBY CERTIFY THAT THE FOREGOING INSTRUMENT IN WRITING, WITH ITS CERTIFICATE WAS FILED FOR RECORD IN MY OFFICE ON THE DAY ____ OF _____, 2015 A.D., AT ____ O'CLOCK, ____ M., AND DULY RECORDED THIS THE DAY ____ OF _____, 2015 A.D., AT ____ O'CLOCK ____ M., IN THE PLAT RECORDS OF SAID COUNTY, IN DOCUMENT NUMBER _____.

TO CERTIFY WHICH, WITNESS MY HAND AND SEAL AT THE COUNTY COURT OF SAID COUNTY, AT MY OFFICE IN GEORGETOWN, TEXAS, THE DATE LAST SHOWN ABOVE WRITTEN.

NANCY RISTER, CLERK, COUNTY COURT
OF WILLIAMSON COUNTY, TEXAS

BY: _____ DEPUTY

FINAL PLAT OF RANCHO SIENNA
SECTION 14, PHASE 1

DATE: OCTOBER, 2015

BURY

221 West Sixth Street, Suite 600
Austin, Texas 78701
Tel. (512) 328-0011 Fax (512) 328-0325
TBPE # F-1048 TBPLS # F-10107500
Copyright © 2015