

FINAL PLAT OF THE RIDGE AT CROSS CREEK PHASE 2

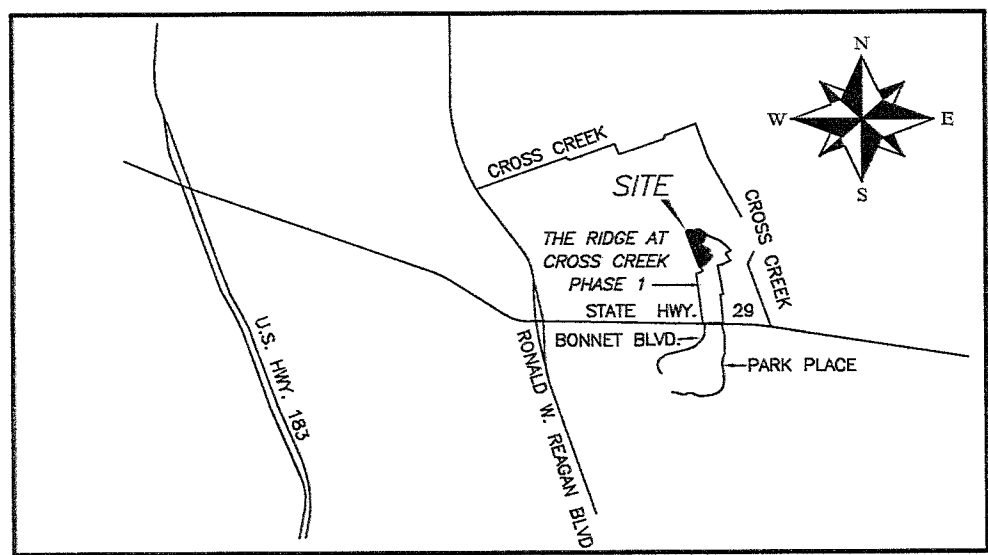

LOCATION MAP
(NOT TO SCALE)

LEGEND:

- = IRON ROD WITH CAP FOUND
- = IRON ROD WITH G&R CAP SET
- ⊙ = 40d NAIL FOUND IN FENCE POST
- △ = CALCULATED POINT
- Ⓐ = BLOCK NAME
- PUE = PUBLIC UTILITY EASEMENT
- B.L. = BUILDING LINE

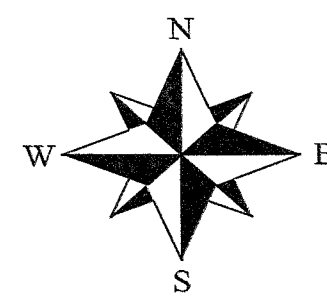

SCALE: 1" = 100'



BEARING BASIS: TEXAS CENTRAL ZONE,
STATE PLANE COORDINATES (NAD 83)

158.017 AC.
RAS LEVEL 2 HOLDINGS, LP
(DOC. NO. 2014099265)

GREENLEAF FISK SURVEY, ABS. NO. 5

REMAINDER OF 133.366 AC.
RAS LEVEL 2 HOLDINGS, LP
(DOC. NO. 2014041528)

243.811 AC.
OMEGA RANCH, LLC
(DOC. NO. 2009000750)

30.66 AC.
NANCY N. BLOM
(VOL. 608, PG. 661)

DATE: JULY 26, 2017

OWNER:
RAS LEVEL 2 HOLDINGS, LP
PO BOX 519
LIBERTY HILL, TX 78642
512-299-6617 FAX: 512-299-6617
luke@clearrockllc.com

SURVEYOR:
G&R SURVEYING, LLC
1805 OUIDA DRIVE
AUSTIN, TX 78728
512-267-7430 FAX: 512-836-8385
pmclaughlin@grsurveying.com

ENGINEER:
JAY ENGINEERING COMPANY, INC.
P.O. BOX 1220
LEANDER, TX 78646
512-259-3882 FAX: 512-259-8016
skiger@jaeco.net



SURVEYING, LLC
1805 OUIDA DR.
AUSTIN, TEXAS 78728
PHONE: (512) 267-7430
FAX: (512) 836-8385
FIRM NO. 10032000
SHEET 1 OF 3

GREENLEAF FISK SURVEY, ABS. NO. 5

28.36 AC.
6660 WEST, LLC
(DOC. NO. 2007101943)

FINAL PLAT OF
THE RIDGE AT CROSS CREEK
PHASE 2

METES AND BOUNDS DESCRIPTION:

DESCRIPTION OF 14.068 ACRES OF LAND SITUATED IN WILLIAMSON COUNTY, TEXAS, OUT OF THE GREENLEAF FISK SURVEY, ABSTRACT NO. 5, BEING A PORTION OF A 133.366 ACRE TRACT DESCRIBED IN A DEED OF RECORD TO RAS LEVEL 2 HOLDINGS, LP IN DOCUMENT NUMBER 2014041528 AND A PORTION OF A 158.017 ACRE TRACT DESCRIBED IN A DEED OF RECORD TO RAS LEVEL 2 HOLDINGS, LP IN DOCUMENT NUMBER 2014099265, OF THE OFFICIAL PUBLIC RECORDS OF WILLIAMSON COUNTY, TEXAS; SAID 14.068 ACRE TRACT BEING MORE PARTICULARLY DESCRIBED BY METES AND BOUNDS AS FOLLOWS:

BEGINNING AT AN IRON ROD WITH CAP FOUND AT THE MOST NORTHERLY OR NORTHWEST CORNER OF THE RIDGE AT CROSS CREEK PHASE 1, A SUBDIVISION OF RECORD IN DOCUMENT NUMBER 2016073172, OFFICIAL PUBLIC RECORDS OF WILLIAMSON COUNTY, TEXAS, FOR THE NORTHEASTERLY CORNER OF THE HEREIN DESCRIBED TRACT;

THENCE OVER AND ACROSS SAID 133.366 ACRE TRACT, WITH THE WESTERLY LINE OF SAID THE RIDGE AT CROSS CREEK PHASE 1, THE FOLLOWING TWELVE (12) COURSES:

- S24°27'18"W, A DISTANCE OF 299.45 FEET TO AN IRON ROD WITH CAP FOUND;
- S22°52'57"W, A DISTANCE OF 70.00 FEET TO AN IRON ROD WITH CAP FOUND;
- ALONG A CURVE TO THE LEFT, HAVING A RADIUS OF 665.00 FEET, AN ARC LENGTH OF 199.23 FEET AND A CHORD WHICH BEARS N75°42'00"W, A DISTANCE OF 198.48 FEET TO AN IRON ROD WITH CAP FOUND;
- S16°12'00"W, A DISTANCE OF 119.01 FEET TO AN IRON ROD WITH CAP FOUND;
- S67°09'02"E, A DISTANCE OF 298.79 FEET TO AN IRON ROD WITH CAP FOUND;
- S26°16'18"W, A DISTANCE OF 36.91 FEET TO AN IRON ROD WITH CAP FOUND;
- S63°43'42"E, A DISTANCE OF 60.00 FEET TO AN IRON ROD WITH CAP FOUND;
- S63°10'22"E, A DISTANCE OF 238.83 FEET TO AN IRON ROD WITH CAP FOUND;
- S29°54'28"W, A DISTANCE OF 183.09 FEET TO AN IRON ROD WITH CAP FOUND;
- S66°20'23"E, A DISTANCE OF 193.35 FEET TO AN IRON ROD WITH CAP FOUND;
- S45°54'33"W, A DISTANCE OF 445.44 FEET TO AN IRON ROD WITH CAP FOUND;
- S43°41'27"W, A DISTANCE OF 149.30 FEET TO AN IRON ROD WITH CAP FOUND IN THE WESTERLY LINE OF SAID 133.366 ACRE TRACT, SAME BEING THE EASTERLY LINE OF A 30.66 ACRE TRACT OF LAND DESCRIBED IN A DEED OF RECORD TO NANCY N. BLOW, IN VOLUME 608, PAGE 661 OF THE DEED RECORDS OF WILLIAMSON COUNTY, TEXAS, AT THE COMMON WESTERLY CORNER OF LOT 16 AND 17, BLOCK B OF SAID THE RIDGE AT CROSS CREEK PHASE 1, FOR THE MOST SOUTHERLY CORNER OF THE HEREIN DESCRIBED TRACT;

THENCE IN PART WITH THE EASTERLY LINE OF SAID 30.66 ACRE TRACT AND IN PART WITH THE EASTERLY LINE OF A 243.811 ACRE TRACT OF LAND DESCRIBED IN A DEED OF RECORD TO OMEGA RANCH, LLC IN DOCUMENT NUMBER 2009000750, OFFICIAL PUBLIC RECORDS OF WILLIAMSON COUNTY, TEXAS, SAME BEING IN PART THE WESTERLY LINES OF SAID 133.366 ACRE TRACT AND SAID 158.017 ACRE TRACT, THE FOLLOWING TWO (2) COURSES:

- N21°12'06"W, A DISTANCE OF 660.12 FEET TO A 40D NAIL FOUND IN FENCE POST;
- N21°00'34"W, A DISTANCE OF 837.15 FEET TO AN IRON ROD WITH CAP FOUND AT A COMMON CORNER OF SAID 243.811 ACRE TRACT AND SAID 158.017 ACRE TRACT;

THENCE LEAVING THE EASTERLY LINE OF SAID 243.811 ACRE TRACT AND THE WESTERLY LINE OF SAID 158.017 ACRE TRACT, AND CONTINUING OVER AND ACROSS SAID 133.366 ACRE TRACT AND SAID 158.017 ACRE TRACT, THE FOLLOWING SIX (6) COURSES:

- N05°39'30"E, A DISTANCE OF 66.81 FEET TO AN IRON ROD WITH G&R CAP SET, FOR THE MOST NORTHWESTERLY CORNER OF THE HEREIN DESCRIBED TRACT;
- N89°06'24"E, A DISTANCE OF 489.96 FEET TO AN IRON ROD WITH G&R CAP SET;
- S10°38'40"W, A DISTANCE OF 245.38 FEET TO AN IRON ROD WITH G&R CAP SET;
- S79°21'20"E, A DISTANCE OF 60.00 FEET TO AN IRON ROD WITH G&R CAP SET;
- N10°38'40"E, A DISTANCE OF 213.29 FEET TO AN IRON ROD WITH G&R CAP SET;
- S63°29'51"E, A DISTANCE OF 198.22 FEET TO THE POINT OF BEGINNING, CONTAINING AN AREA OF 14.068 ACRES OF LAND MORE OR LESS.

CURVE TABLE						
NO.	DELTA	RADIUS	ARC	CHORD BEARING	CHORD	TANGENT
C1	17°09'54"	665.00'	199.23'	N75°42'00"W	198.48'	100.36'
C2	21°26'34"	665.00'	248.88'	N77°50'20"W	247.43'	125.91'
C3	7°56'16"	735.00'	101.83'	N71°05'11"W	101.75'	51.00'
C4	85°41'59"	20.00'	29.91'	S32°12'19"E	27.20'	18.55'
C5	86°42'20"	20.00'	30.27'	N53°59'50"E	27.46'	18.88'
C6	5°54'37"	735.00'	75.82'	N85°36'18"W	75.78'	37.94'
C7	26°05'51"	270.00'	122.98'	S13°13'22"W	121.92'	62.58'
C8	26°05'51"	330.00'	150.31'	S13°13'22"W	149.02'	76.48'
C9	51°19'04"	20.00'	17.91'	N25°49'59"E	17.32'	9.61'
C10	282°38'08"	60.00'	295.98'	S89°49'33"E	75.00'	48.04'
C11	51°19'04"	20.00'	17.91'	S25°29'05"E	17.32'	9.61'
C12	5°54'37"	735.00'	75.82'	N85°36'18"W	75.78'	37.94'
C13	4°16'40"	665.00'	49.65'	N86°25'17"W	49.64'	24.84'
C14	18°21'03"	270.00'	86.48'	S17°05'47"W	86.11'	43.61'
C15	7°44'49"	270.00'	36.51'	S04°02'51"W	36.48'	18.28'
C16	20°20'42"	330.00'	117.18'	S16°05'57"W	116.56'	59.21'
C17	5°45'10"	330.00'	33.13'	S03°03'01"W	33.12'	16.58'
C18	95°44'54"	60.00'	100.27'	S03°37'04"W	89.00'	66.34'
C19	64°19'54"	60.00'	67.37'	S76°25'21"E	63.88'	37.73'
C20	122°33'20"	60.00'	128.34'	N10°08'02"E	105.24'	109.49'
C21	108°37'46"	60.00'	113.76'	S88°33'37"E	97.47'	83.54'
C22	108°37'46"	60.00'	113.76'	N88°33'37"W	97.47'	83.54'

LINE TABLE		
NUMBER	DIRECTION	DISTANCE
L1	S22°52'57"W	70.00'
L2	S26°16'18"W	36.91'
L3	S63°43'42"E	60.00'
L4	N05°39'30"E	66.81'
L5	S79°21'20"E	60.00'
L6	N10°38'40"E	97.09'
L7	N10°38'40"E	96.22'
L8	S26°16'18"W	109.77'
L9	S26°16'18"W	109.77'
L10	S00°10'27"W	66.20'
L11	S00°10'27"W	66.20'

STREET LENGTH AND DESIGN SPEED TABLE

STREET NAME	LENGTH	DESIGN SPEED
DEER VALLEY DRIVE	150'	25 MPH
VIEW DRIVE	481'	30 MPH
CLEAR BROOK COVE	375'	25 MPH

FINAL PLAT OF
THE RIDGE AT CROSS CREEK
PHASE 2

STATE OF TEXAS:
COUNTY OF WILLIAMSON:

THAT, RAS LEVEL 2 HOLDINGS, LP, OWNER OF THE CERTAIN TRACT OF LAND SHOWN HEREON AND DESCRIBED IN DEEDS RECORDED IN DOCUMENT NO. 2014041528 AND DOCUMENT NO. 2014099265 OF THE OFFICIAL PUBLIC RECORDS OF WILLIAMSON COUNTY, TEXAS, AND DO HEREBY STATE THAT THERE ARE NO LIEN HOLDERS OF THE CERTAIN TRACT OF LAND, DO HEREBY CONSENT TO ALL PLAT NOTE REQUIREMENTS SHOWN HEREON, AND DO HEREBY FOREVER DEDICATE TO THE PUBLIC THE ROADS, ALLEYS, RIGHTS-OF-WAY, EASEMENTS AND PUBLIC PLACES SHOWN HEREON FOR SUCH PUBLIC PURPOSES AS WILLIAMSON COUNTY MAY DEEM APPROPRIATE, AND DO HEREBY STATE THAT ALL PUBLIC ROADS AND EASEMENTS AS SHOWN ON THIS PLAT ARE FREE OF LIENS. THIS SUBDIVISION IS TO BE KNOWN AS THE RIDGE AT CROSS CREEK PHASE 2.

LUKE BASEY, MANAGER
RAS LEVEL 2 HOLDINGS, LP
PO BOX 519
LIBERTY HILL, TX 78642

DATE:

STATE OF TEXAS:
COUNTY OF WILLIAMSON:

BEFORE ME, THE UNDERSIGNED AUTHORITY, ON THIS DAY PERSONALLY APPEARED, LUKE BASEY, KNOWN TO ME TO BE THE PERSON WHOSE NAME IS SUBSCRIBED TO THE FOREGOING INSTRUMENT AND ACKNOWLEDGED TO ME THAT THEY EXECUTED THE SAME FOR THE PURPOSES AND CONSIDERATION THEREIN EXPRESSED, IN THE CAPACITY THEREIN STATED.

GIVEN UNDER MY HAND AND SEAL OF OFFICE THIS 11TH DAY OF NOVEMBER, 2017.

Christy Owen
NOTARY PUBLIC IN AND FOR THE STATE OF TEXAS

MY COMMISSION EXPIRES ON 07/07/19

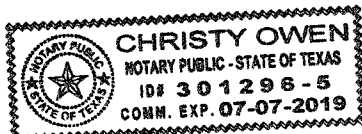

PLAT NOTES

1. IN APPROVING THIS PLAT BY THE COMMISSIONER'S COURT OF WILLIAMSON COUNTY, TEXAS, IT IS UNDERSTOOD THAT THE BUILDING OF ALL ROADS, AND OTHER PUBLIC THOROUGHFARES AND ANY BRIDGES OR CULVERTS NECESSARY TO BE CONSTRUCTED OR PLACED IS THE RESPONSIBILITY OF THE OWNER(S) OF THE TRACT OF LAND COVERED BY THIS PLAT IN ACCORDANCE WITH THE PLANS AND SPECIFICATIONS PRESCRIBED BY THE COMMISSIONER'S COURT OF WILLIAMSON COUNTY, TEXAS. SAID COMMISSIONER'S COURT ASSUMES NO OBLIGATION TO BUILD ANY OF THE ROADS, OR OTHER PUBLIC THOROUGHFARES SHOWN ON THIS PLAT, OR OF CONSTRUCTING ANY BRIDGES OR DRAINAGE IMPROVEMENTS IN CONNECTION THEREWITH. THE COUNTY WILL ASSUME NO RESPONSIBILITY FOR DRAINAGE WAYS OR EASEMENTS IN THE SUBDIVISION, OTHER THAN THOSE DRAINING OR PROTECTING THE ROAD SYSTEM.
2. IT IS THE RESPONSIBILITY OF THE OWNER, NOT THE COUNTY, TO ASSURE COMPLIANCE WITH THE PROVISIONS OF ALL APPLICABLE STATE, FEDERAL, AND LOCAL LAWS AND REGULATIONS RELATING TO THE PLATTING AND DEVELOPMENT OF THIS PROPERTY.
THE COUNTY ASSUMES NO RESPONSIBILITY FOR THE ACCURACY OF REPRESENTATION BY OTHER PARTIES IN THIS PLAT. FLOOD PLAIN DATA, IN PARTICULAR, MAY CHANGE DEPENDING ON SUBSEQUENT DEVELOPMENT. IT IS FURTHER UNDERSTOOD THAT THE OWNERS OF THE TRACT OF LAND CONVEYED BY THIS PLAT MUST INSTALL AT THEIR OWN EXPENSE ALL TRAFFIC CONTROL DEVICES AND SIGNAGE THAT MAY BE REQUIRED BEFORE THE STREETS IN THE SUBDIVISION HAVE FINALLY BEEN ACCEPTED FOR MAINTENANCE BY THE COUNTY.
3. NO PORTION OF THIS PROPERTY LIES WITHIN ZONE "AE" AS IDENTIFIED ON FEMA MAP PANEL NO. 48491C0275E, EFFECTIVE SEPTEMBER 26, 2008.
4. A TEN (10') FOOT WIDE PUBLIC UTILITY EASEMENT IS DEDICATED ALONG AND ADJACENT TO ALL RIGHT-OF-WAY AND A TWO AND A HALF (2.5') FOOT WIDE PUBLIC UTILITY EASEMENT IS DEDICATED ALONG ALL SIDE LOT LINES.
5. RURAL MAILBOXES SHALL BE SET THREE FEET FROM THE EDGE OF THE PAVEMENT OR BEHIND CURBS, WHEN USED. ALL MAILBOXES WITHIN COUNTY ARTERIAL RIGHT-OF-WAY SHALL MEET THE CURRENT TXDOT STANDARDS. ANY MAILBOX THAT DOES NOT MEET THIS REQUIREMENT MAY BE REMOVED BY WILLIAMSON COUNTY.
6. THE OWNER SHALL CREATE A MANDATORY HOMEOWNERS ASSOCIATION THAT SHALL BE RESPONSIBLE FOR MAINTENANCE AND LIABILITY OF ANY LANDSCAPING, IRRIGATION, SIDEWALKS, ILLUMINATION, SUBDIVISION IDENTIFICATION SIGNS, WATER QUALITY FEATURES, ETC. PLACED WITHIN THE WILLIAMSON COUNTY RIGHT-OF-WAY. THE HOMEOWNERS ASSOCIATION SHALL HAVE ASSESSMENT AUTHORITY TO INSURE THE PROPER FUNDING FOR MAINTENANCE.
7. RESIDENTIAL DRIVEWAYS ARE TO BE LOCATED NO CLOSER TO THE CORNER OF INTERSECTING RIGHTS OF WAY THAN 60 PERCENT OF THE PARCEL FRONTAGE OR 50 FEET, WHICHEVER IS LESS.
8. A DE FACTO CERTIFICATE OF COMPLIANCE IS HEREBY ISSUED FOR ALL LOTS WITHIN THIS SUBDIVISION. THIS CERTIFICATE IS VALID UNTIL SUCH TIME AS FEMA REVISES OR NEWLY ADOPTS FLOODPLAIN BOUNDARIES IN THIS AREA.
9. EXCEPT IN CERTAIN ISOLATED AREAS REQUIRED TO MEET ACCESSIBILITY REQUIREMENTS, THE MINIMUM FINISHED FLOOR ELEVATION SHALL BE ONE FOOT HIGHER THAN THE HIGHEST SPOT ELEVATION THAT IS LOCATED WITHIN FIVE FEET OUTSIDE THE PERIMETER OF THE BUILDING, OR ONE FOOT ABOVE THE BFE, WHICHEVER IS HIGHER.

WILLIAMSON COUNTY AND CITIES HEALTH DISTRICT (WCCHD) NOTES

1. NO CONSTRUCTION IN THE SUBDIVISION MAY BEGIN UNTIL THE TEXAS COMMISSION ON ENVIRONMENTAL QUALITY (TCEQ) HAS APPROVED THE WATER POLLUTION ABATEMENT PLAN (WPAP) IN WRITING.
2. ON SITE SEWAGE FACILITIES MUST BE DESIGNED BY A REGISTERED PROFESSIONAL ENGINEER OR REGISTERED SANITARIAN.
3. WATER SERVICE FOR THIS SUBDIVISION WILL BE PROVIDED BY THE CITY OF GEORGETOWN. SEWER SERVICE FOR THIS SUBDIVISION WILL BE PROVIDED BY ON-SITE SEWAGE FACILITIES (OSSF).

STATE OF TEXAS:
COUNTY OF WILLIAMSON:

I, PHILLIP L. McLAUGHLIN, AM AUTHORIZED UNDER THE LAWS OF THE STATE OF TEXAS TO PRACTICE THE PROFESSION OF LAND SURVEYING, AND HEREBY STATE THAT THIS PLAT CONFORMS WITH APPLICABLE ORDINANCES OF WILLIAMSON COUNTY, TEXAS AND HEREBY CERTIFY THAT A SURVEY OF THE PROPERTY SHOWN HEREON WAS ACTUALLY MADE UPON THE GROUND UNDER MY DIRECTION AND SUPERVISION ON THE DATE SHOWN.

Phillip L. McLaughlin
PHILLIP L. McLAUGHLIN 08-15-17
REGISTERED PROFESSIONAL LAND SURVEYOR
STATE OF TEXAS NO. 5300

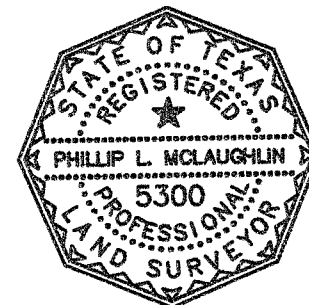

STATE OF TEXAS:
COUNTY OF WILLIAMSON:

I, SAMUEL D. KIGER, AM AUTHORIZED UNDER THE LAWS OF THE STATE OF TEXAS TO PRACTICE THE PROFESSION OF ENGINEERING, AND DO HEREBY STATE THAT THIS PLAT CONFORMS WITH APPLICABLE ORDINANCES OF WILLIAMSON COUNTY, TEXAS AND THAT NO PORTION OF THIS SUBDIVISION IS WITHIN THE LIMITS OF A 100 YEAR FLOOD PLAIN AS PER FLOOD PLAIN STUDY SHOWN HEREON. THIS TRACT IS LOCATED WITHIN THE EDWARDS AQUIFER RECHARGE ZONE

Samuel D. Kiger
SAMUEL D. KIGER, P.E.
STATE OF TEXAS NO. 89353
P.O. BOX 1220
LEANDER, TEXAS 78646-1220
512-259-3882

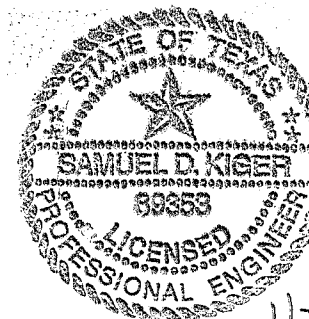
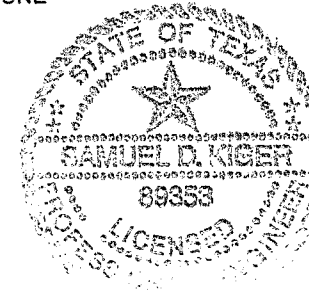

ROAD NAME AND ADDRESS ASSIGNMENTS VERIFIED THIS THE 16TH DAY OF November 2017 A.D.

Cindy Bridges
WILLIAMSON COUNTY ADDRESSING COORDINATOR
Cindy Bridges

STATE OF TEXAS:
COUNTY OF WILLIAMSON:

BASED UPON THE ABOVE REPRESENTATIONS OF THE ENGINEER OR SURVEYOR WHOSE SEAL IS AFFIXED HERETO, AND AFTER A REVIEW OF THE PLAT AS REPRESENTED BY THE SAID ENGINEER OR SURVEYOR, I FIND THAT THIS PLAT COMPLIES WITH THE REQUIREMENTS OF EDWARDS AQUIFER REGULATIONS FOR WILLIAMSON COUNTY AND WILLIAMSON COUNTY ON-SITE SEWAGE FACILITY REGULATIONS. THIS CERTIFICATION IS MADE SOLELY UPON SUCH REPRESENTATIONS AND SHOULD NOT BE RELIED UPON FOR VERIFICATIONS OF THE FACTS ALLEGED. THE WILLIAMSON COUNTY AND CITIES HEALTH DISTRICT (WCCHD) AND WILLIAMSON COUNTY DISCLAIM ANY RESPONSIBILITY TO ANY MEMBER OF THE PUBLIC FOR INDEPENDENT VERIFICATION OF THE REPRESENTATIONS, FACTUAL OR OTHERWISE, CONTAINED IN THIS PLAT AND THE DOCUMENTS ASSOCIATED WITH IT.

Deborah L. Marlow RS 08/18/2017
DEBORAH L. MARLOW, RS, OS0029596 DATE
DIRECTOR, ENVIRONMENTAL HEALTH SERVICES, WCCHD

STATE OF TEXAS:
COUNTY OF WILLIAMSON:

I, DAN A. GATTIS, COUNTY JUDGE OF WILLIAMSON COUNTY, TEXAS, DO HEREBY CERTIFY THAT THIS MAP OR PLAT, WITH FIELD NOTES SHOWN HEREON, FOR A SUBDIVISION HAVING BEEN FULLY PRESENTED TO THE COMMISSIONER'S COURT OF WILLIAMSON COUNTY, TEXAS, AND BY THE SAID COURT DULY CONSIDERED, WERE ON THIS DAY APPROVED AND THAT THIS PLAT IS AUTHORIZED TO BE REGISTERED AND RECORDED IN THE PROPER RECORDS OF THE COUNTY CLERK OF WILLIAMSON COUNTY, TEXAS.

Dan A. Gattis DATE
WILLIAMSON COUNTY, TEXAS

THE STATE OF TEXAS:
COUNTY OF WILLIAMSON:

I, NANCY RISTER, CLERK OF WILLIAMSON COUNTY, TEXAS DO HEREBY CERTIFY THAT THE FOREGOING INSTRUMENT OF WRITING AND ITS CERTIFICATE OF AUTHENTICATION WAS FILED FOR RECORD IN MY

OFFICE ON THE _____ DAY OF _____, 20____, A.D. AT _____ O'CLOCK ____M., AND

DULY RECORDED ON THE _____ DAY OF _____, 20____, A.D. AT _____ O'CLOCK

____M., OFFICIAL PUBLIC RECORDS OF SAID COUNTY AND STATE IN DOCUMENT NO. _____

WITNESS MY HAND AND SEAL OF OFFICE OF THE COUNTY CLERK, THE _____ DAY

OF _____, 20____, A.D.

NANCY RISTER, COUNTY CLERK, WILLIAMSON COUNTY, TEXAS

BY _____
DEPUTY



SURVEYING, LLC

1805 OUIDA DR.
AUSTIN, TEXAS 78728
PHONE: (512) 267-7430
FAX: (512) 836-8385
FIRM NO. 10032000

SHEET 3 OF 3