

SONTERRA SECTION III COMMERCIAL, PHASE I

BEING a 1.458 acre tract of land situated in the ISAAC BUNKER SURVEY, ABSTRACT No. 54, Williamson County, Texas and being all of that certain 1.458 acres of land described as Block 1 and Block 2, Sonterra Section III Commercial, Phase I according to the map or plat of record in Document No. 2008068713, Official Public Records of Williamson County, Texas and being more particularly described by metes and bounds as follows:

BLOCK 1

BEGINNING at a 1/2" Iron rod with cap stamped "RPLS 2475" found being in the north right-of-way line of Sonterra Boulevard as described in the map or plat of Sonterra West Phase IB being of record in Cabinet AA, Slides 367-370, Plat Records of Williamson County, Texas and being the southwest corner of the said Lot 1, Block 1, Sonterra Section III Commercial, Phase I and being the southeast corner of that certain Lot 1, Block 1, Sonterra Section III Commercial, Phase II for corner;

THENCE departing the said Sonterra West Phase IB and the said north right-of-way line the following three (3) calls:

1) N. 20° 30' 44" E., 125.00 feet with the west boundary line of the said Lot 1, Block 1, Sonterra Section III Commercial, Phase I and with the east boundary line of the said Lot 1, Block 1, Sonterra Section III Commercial, Phase II to a 1/2" iron rod with cap stamped "RPLS 2475" found being the northwest corner of the said Lot 1, Block 1, Sonterra Section III Commercial, Phase I and being the southwest corner of that certain 0.138 acre tract of land described in a Deed to Beta Tres Holding LLC, Et Al for corner;

2) S. 69° 30' 15" E., 300.22 feet departing the said Lot 1, Block 1, Sonterra Section III Commercial, Phase II and with the north boundary line of the said Lot 1, Block 1, Sonterra Section III Commercial, Phase I and with the south boundary line of the said 0.138 acre tract to a 1/2" iron rod with cap stamped "RPLS 2475" found being the southeast corner of the said 0.138 acre tract and being the northeast corner of the said Lot 1, Block 1, Sonterra Section III Commercial, Phase I and being in the west right-of-way line of Condra Lane as described in the map or plat of Sonterra West Section III, Phase I of record in Document No. 2010081335, Official Public Records of Williamson County, Texas for corner;

3) S. 20° 30' 44" W., 100.00 feet departing the said 0.138 acre tract and with the east boundary line of the said Lot 1, Block 1, Sonterra Section III Commercial, Phase I and with the said west right-of-way line to a 1/2" iron rod found being at the beginning of a curve to the right having a radius equals 25.00 feet, chord bearing equals S.65° 29' 45" W., 35.36 feet, central angle equals 90° 00' 54" and being in the said north right-of-way line of Sonterra Boulevard for corner;

THENCE departing the said west right-of-way line and with the south boundary line of the said Lot 1, Block 1, Sonterra Section III Commercial, Phase I and with the said north right-of-way line of Sonterra Boulevard the following two (2) calls:

- 1) 39.28 feet along the arc of said curve to the right to a 1/2" iron rod found for corner;
- 2) N. 69° 30' 15" W., 275.23 feet to the Point of BEGINNING and containing 0.858 acres of land.

TOGETHER WITH THE FOLLOWING:

BLOCK 2

BEGINNING at a 1/2" Iron rod found which bears S.69° 30' 15" E., 70.00 feet from the most northerly southeast corner of the above described tract and being the most westerly southwest corner of Block 2, Sonterra Section III Commercial, Phase I and being in the said north right-of-way line of Sonterra Boulevard and being in the east right-of-way line of the said Condra Lane for corner;

THENCE departing the said north right-of-way line the following three (3) calls:

1) N. 20° 30' 44" E., 100.00 feet with the west boundary line of the said Block 2, Sonterra Section III Commercial, Phase I and with the said east right-of-way line to a 1/2" iron rod with cap stamped "RPLS 2475" found being the northwest corner of the said Block 2, Sonterra Section III Commercial, Phase I and being the southwest corner of Lot 1, Block 2, Sonterra West Section III, Phase I according to the map or plat of record in Document No. 2010081335, Official Public Records of Williamson County, Texas for corner;

2) S. 69° 30' 15" E., 210.00 feet departing the said east right-of-way line and with the north boundary line of the said Block 2, Sonterra Section III Commercial, Phase I and with the south boundary line of the said Block 2, Sonterra West Section III, Phase I to a 1/2" iron rod with cap stamped "RPLS 2475" found being the northeast corner of the said Block 2, Sonterra Section III Commercial, Phase I and being the southeast corner of Lot 10, Block 2, said Sonterra West Section III, Phase I and being in the right-of-way line of Foster Lane as described in said Document No. 2010081335 and being the northwest corner of Lot 1, Block 3, said Sonterra West Section III, Phase I for corner;

3) S. 20° 30' 44" W., 125.00 feet departing the said Lot 10, Block 2, Sonterra West Section III, Phase I and the said right-of-way line of Foster Lane and with the east boundary line of the said Block 2, Sonterra Section III Commercial, Phase I and with the west boundary line of the said Lot 1, Block 3, Sonterra West Section III, Phase I to a 1/2" iron rod with cap stamped "RPLS 2475" found being the southeast corner of the said Block 2, Sonterra Section III Commercial, Phase I and being the southwest corner of the said Lot 1, Block 3, Sonterra West Section III, Phase I and being in the said north right-of-way line of Sonterra Boulevard for corner;

THENCE departing the said Lot 1, Block 3, Sonterra West Section III, Phase I and with the south boundary line of the said Block 2, Sonterra Section III Commercial, Phase I and with the said north right-of-way line of Sonterra Boulevard the following two (2) calls:

- 1) N. 69° 30' 15" W., 184.99 feet to a 1/2" iron rod found being the most southerly southwest corner of the said Block 2, Sonterra Section III Commercial, Phase I and being at the beginning of a curve to the right having a radius equals 25.00 feet, chord bearing equals N. 24° 30' 15" W., 35.36 feet, central angle equals 90° 00' 54" for corner;
- 2) 39.28 feet along the arc of said curve to the right to the Point of BEGINNING and containing 0.600 acres of land.

I, Michael E. Alvis, a Registered Professional Land Surveyor in the State of Texas, do hereby certify that these field notes are a correct representation of a survey made on the ground.

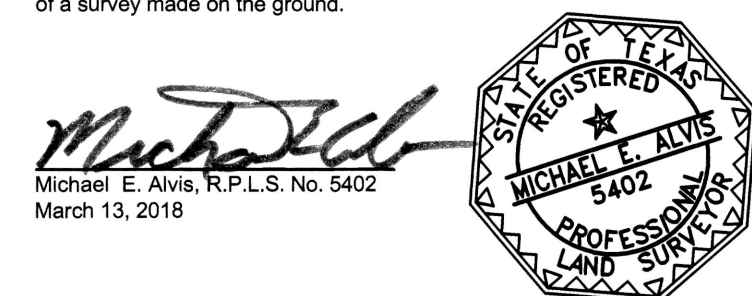

bearing base: Texas State Plane Coordinate System, NAD 1983, Central Zone.

GENERAL NOTES

1. TOTAL ACRES: 1.458 ACRES
2. NUMBER OF LOTS: 5
3. NUMBER OF BLOCKS: 2
4. AREA OF SMALLEST LOT: 0.143 AC. - 6250 SQ. FT.
5. PROPOSED USES: COMMERCIAL OR RESIDENTIAL

LAND USE SUMMARY	
DETENTION AREA	0 AC.
PARK	0 AC.
COMMERCIAL LOTS	0.858 AC.
RESIDENTIAL LOTS	0.600 AC.
SUBDIVISION RIGHT-OF-WAY	0 AC.

6. IN ORDER TO PROMOTE DRAINAGE AWAY FROM A STRUCTURE, THE ELEVATION OF ALL SLABS SHOULD BE BUILT AT LEAST ONE FOOT ABOVE THE SURROUNDING GROUND, AND THE GROUND SHOULD BE GRADED AWAY FROM THE STRUCTURE AT A SLOPE OF 1/2" PER FOOT FOR A DISTANCE OF 10 FEET.

7. THIS TRACT IS NOT LOCATED IN THE CONTRIBUTING ZONE OF THE EDWARDS AQUIFER RECHARGE ZONE.

8. NO STRUCTURE OR LAND ON THIS PLAT SHALL HEREAFTER BE LOCATED OR ALTERED WITHOUT FIRST SUBMITTING A CERTIFICATE OF COMPLIANCE APPLICATION FORM TO THE WILLIAMSON COUNTY FLOOD PLAIN ADMINISTRATOR.

9. MAINTENANCE OF DRAINAGE EASEMENTS SHALL BE THE RESPONSIBILITY OF THE PROPERTY OWNER.

10. THIS SUBDIVISION IS LOCATED WITHIN THE JURISDICTION OF WILLIAMSON COUNTY.

11. EACH LOT IN THIS SUBDIVISION SHALL BE RESPONSIBLE FOR PROVIDING POSITIVE DRAINAGE CONDITIONS. ANY CHANGES IN SURFACE DRAINAGE PATTERNS WILL REQUIRE THE APPROVAL OF THE PROPER REGULATORY AUTHORITY.

12. THE ELECTRIC SERVICE PROVIDER IS BARTLETT ELECTRIC COMPANY.

13. BUILDING SETBACK LINES SHALL BE IN ACCORDANCE WITH SETBACKS SHOWN HEREON, APPLICABLE OWNER RESTRICTIONS RECORDED IN COUNTY RECORDS OR APPLICABLE ORDINANCE.

14. CONSTRUCTION OF IMPROVEMENTS ON ANY LOT IN THE SUBDIVISION IS SUBJECT TO THE COVENANTS AND RESTRICTIONS FOR SONTERRA WEST SUBDIVISION TO BE RECORDED BY SEPARATE INSTRUMENT IN THE OFFICIAL RECORDS OF WILLIAMSON COUNTY, TEXAS.

15. DRIVEWAY ACCESS IS PROHIBITED FROM ALL LOTS TO REAR STREETS. ALL DRIVEWAYS WILL ACCESS FRONT OR SIDE AND INTERNAL STREETS WITHIN THE SUBDIVISION.

16. NO STRUCTURE OR IMPROVEMENT ON ANY LOT SHALL BE OCCUPIED UNTIL IT IS CONNECTED TO A PUBLIC OR PRIVATE WATER SUPPLY SYSTEM APPROVED BY THE TEXAS COMMISSION OF ENVIRONMENTAL QUALITY (TCEQ).

17. NO STRUCTURE OR IMPROVEMENT ON ANY LOT IN THIS SUBDIVISION SHALL BE OCCUPIED UNTIL IT IS CONNECTED TO A COLLECTIVE PUBLIC OR PRIVATE WASTEWATER SYSTEM AS PERMITTED BY THE TEXAS COMMISSION ON ENVIRONMENTAL QUALITY (TCEQ).

18. THE OWNER OF THIS SUBDIVISION AND HIS OR HER SUCCESSORS AND ASSIGNS ASSUMES THE RESPONSIBILITY FOR PLANS FOR CONSTRUCTION OF SUBDIVISION IMPROVEMENTS WHICH COMPLY WITH APPLICABLE CODES, RULES, REGULATIONS AND REQUIREMENTS OF WILLIAMSON COUNTY, TEXAS OR THE CITY OF JARRELL, TEXAS, WHICHEVER ARE IN EFFECT OR ARE MORE STRINGENT AND APPLICABLE TIME THAT THE IMPROVEMENTS ARE DESIGNED AND CONSTRUCTED. THE OWNER UNDERSTANDS AND AGREES THAT PLAT VACATION AND REPLATING MAY BE REQUIRED AT THE OWNER'S SOLE EXPENSE, IF PLANS TO CONSTRUCT THIS SUBDIVISION DO NOT COMPLY WITH SUCH CODES AND REQUIREMENTS.

19. WATER AND SEWER SERVICE: "WATER AND SEWER SERVICE FOR THIS SUBDIVISION WILL BE PROVIDED BY SONTERRA MUNICIPAL UTILITY DISTRICT."

20. WATER AND WASTEWATER SYSTEMS SERVING THIS SUBDIVISION SHALL BE DESIGNED AND INSTALLED IN ACCORDANCE WITH THE DESIGN AND CONSTRUCTION STANDARDS OF THE TEXAS COMMISSION FOR ENVIRONMENTAL QUALITY (TCEQ), WILLIAMSON COUNTY (IF ANY ARE APPLICABLE) OR THE CITY OF JARRELL (IF ANY ARE APPLICABLE). PLANS AND SPECIFICATIONS SHALL BE SUBMITTED TO TCEQ AND OTHER AGENCIES, AS APPROPRIATE, AT THE TIME SUCH PLANS ARE PREPARED.

21. ALL STREETS ARE TO BE DEDICATED FOR PUBLIC USE.

22. THERE ARE NO CEMETERY SITES, EXISTING OR PROPOSED SCHOOL SITES OR OTHER PUBLIC SITES PROPOSED WITHIN THIS SUBDIVISION.

23. A 10 FOOT WIDE PUBLIC UTILITY EASEMENT IS HEREBY DEDICATED ADJACENT TO ALL STREET RIGHT-OF-WAYS.

"IN ACCORDANCE WITH SECTION B10.1 OF WILLIAMSON COUNTY'S SUBDIVISION REGULATIONS, STORMWATER MANAGEMENT FACILITIES FOR 2, 10 & 100-YEAR FLOOD EVENTS IS REQUIRED FOR EACH NON-RESIDENTIAL LOT SHOWN HEREON. AN EXCEPTION TO THIS REQUIREMENT MAY BE GRANTED IF IT CAN BE SHOWN THAT DOWNSTREAM PROPERTY IS NOT ADVERSELY AFFECTED BY RUNOFF FROM THE ACCUMULATIVE DEVELOPMENT ACTIVITIES WITHIN THIS SUBDIVISION."



ENGINEERING • PLANNING • SURVEYING
CONSTRUCTION MANAGEMENT

TURLEY ASSOCIATES, INC.

(254) 773-2400
(254) 773-3998

TEMPLE, TEXAS

301 N. 3rd ST.
E-MAIL: VDTURLEY@AOL.COM

AMENDING FINAL PLAT of:
SONTERRA SECTION III COMMERCIAL, PHASE I
ISAAC BUNKER SURVEY, ABSTRACT #54
A SUBDIVISION IN
WILLIAMSON COUNTY, TEXAS

DEVELOPED BY:
SONTERRA DEVELOPMENT, LLC.
P.O. BOX 54
11900 IH-35
JARRELL, TEXAS, 76537

REVISIONS	

DATE:	MARCH 13, 2018
DRN. BY:	MEA
REF.:	
FIELD BOOK	SONTERRA 1
JOB NO.:	18-471
SHEET	2 OF 3
COMPUTER DWG. NO.	SEC3PHICOMM

18471-C
DRAWING NUMBER

SONTERRA SECTION III COMMERCIAL, PHASE I

OWNER APPROVAL AND DEDICATION:

STATE OF TEXAS *
 COUNTY OF WILLIAMSON * KNOW ALL MEN BY THESE PRESENTS;

THAT WE, RVEST L.P., A TEXAS LIMITED PARTNERSHIP AND SONWEST CO., A TEXAS CORPORATION, ACTING BY AND THROUGH ANDY BILGER, VICE PRESIDENT, AND SONTERRA RETAIL CONDO ASSOCIATION, OWNERS OF 1.458 ACRES OF LAND LOCATED OUT OF THE ISAAC BUNKER SURVEY, ABSTRACT NUMBER 54, WILLIAMSON COUNTY, TEXAS, BEING ALL OF THAT CERTAIN 1.458 ACRES OF LAND DESCRIBED AS BLOCK 1 AND BLOCK 2, SONTERRA SECTION III COMMERCIAL, PHASE I ACCORDING TO THE MAP OR PLAT OF RECORD IN DOCUMENT NUMBER 2008068713 OF THE OFFICIAL PUBLIC RECORDS OF WILLIAMSON COUNTY, TEXAS, DO HEREBY SUBDIVIDE SAID 1.458 ACRES OF LAND IN ACCORDANCE WITH THE PLAT AS SHOWN HEREON TO BE KNOWN AS "AMENDING FINAL PLAT OF SONTERRA SECTION III COMMERCIAL, PHASE I" AND DO HEREBY DEDICATE TO THE PUBLIC, THE USE OF ALL STREETS AND EASEMENTS AS SHOWN HEREON, SUBJECT TO ANY EASEMENTS AND/OR RESTRICTIONS HERETOFORE GRANTED AND NOT RELEASED. WE UNDERSTAND THAT IT IS THE RESPONSIBILITY OF THE OWNER, NOT THE COUNTY, TO ASSURE COMPLIANCE WITH THE PROVISIONS OF ALL APPLICABLE STATE, FEDERAL, AND LOCAL LAWS AND REGULATIONS RELATING TO THE ENVIRONMENT, INCLUDING (BUT NOT LIMITED TO) THE ENDANGERED SPECIES ACT, STATE AQUIFER REGULATIONS, AND MUNICIPAL WATERSHED ORDINANCES.

WITNESS MY HAND THIS THE 8 DAY OF May, 2018 A.D.

SONWEST CO., A TEXAS CORPORATION
 BY: ANDY BILGER, VICE PRESIDENT
 3939 BEE CAVES ROAD, BLDG C100
 AUSTIN, TX, 78746

RVEST L.P., A TEXAS LIMITED LIABILITY COMPANY
 BY: R. SHAWN BREEDLOVE, PRESIDENT
 3939 BEE CAVES ROAD, BLDG C100
 AUSTIN, TEXAS 78746

SONTERRA RETAIL CONDO ASSOCIATION
 BY: TOM SLOWBE, PRESIDENT
 PO BOX 81, JARRELL, TEXAS 76537

BEFORE ME, THE UNDERSIGNED AUTHORITY, ON THIS DAY PERSONALLY APPEARED ANDY BILGER, KNOWN BY ME TO BE THE PERSON WHOSE NAME IS SUBSCRIBED TO THE FOREGOING INSTRUMENT, IT HAS BEEN ACKNOWLEDGED TO ME THAT HE EXECUTED THE FOREGOING INSTRUMENT, ACTING AS OWNER OF THE PROPERTY DESCRIBED HEREON FOR THE PURPOSES STATED.

Date 5-8-18 Andy E. Slowbe
 NOTARY PUBLIC IN AND FOR THE STATE OF TEXAS

PRINTED NAME OF NOTARY AND STAMP
1-26-20
 DATE NOTARY COMMISSION EXPIRES

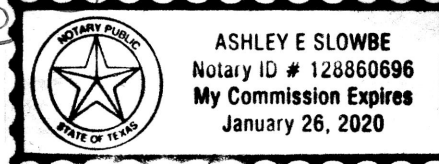

BEFORE ME, THE UNDERSIGNED AUTHORITY, ON THIS DAY PERSONALLY APPEARED R. SHAWN BREEDLOVE, KNOWN BY ME TO BE THE PERSON WHOSE NAME IS SUBSCRIBED TO THE FOREGOING INSTRUMENT, IT HAS BEEN ACKNOWLEDGED TO ME THAT SHE EXECUTED THE FOREGOING INSTRUMENT, ACTING AS OWNER OF THE PROPERTY DESCRIBED HEREON FOR THE PURPOSES STATED.

Date May 10, 2018 Misty Mckamie Gonzales
 NOTARY PUBLIC IN AND FOR THE STATE OF TEXAS

PRINTED NAME OF NOTARY AND STAMP
4-2-21
 DATE NOTARY COMMISSION EXPIRES

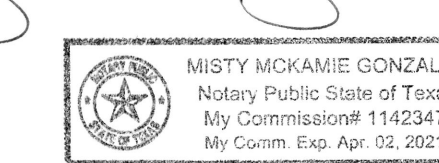

BEFORE ME, THE UNDERSIGNED AUTHORITY, ON THIS DAY PERSONALLY APPEARED TOM SLOWBE, KNOWN BY ME TO BE THE PERSON WHOSE NAME IS SUBSCRIBED TO THE FOREGOING INSTRUMENT, IT HAS BEEN ACKNOWLEDGED TO ME THAT SHE EXECUTED THE FOREGOING INSTRUMENT, ACTING AS OWNER OF THE PROPERTY DESCRIBED HEREON FOR THE PURPOSES STATED.

Date 5-8-18 Andy E. Slowbe
 NOTARY PUBLIC IN AND FOR THE STATE OF TEXAS

PRINTED NAME OF NOTARY AND STAMP
1-26-20
 DATE NOTARY COMMISSION EXPIRES

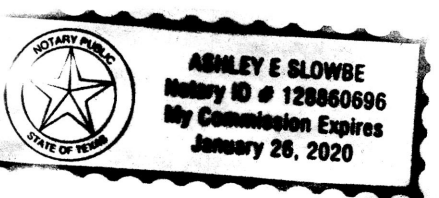
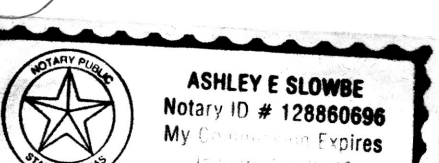

ENGINEER'S STATEMENT

STATE OF TEXAS
 COUNTY OF WILLIAMSON

THIS TRACT IS NOT LOCATED WITHIN THE EDWARDS AQUIFER RECHARGE ZONE.

I, JENNIFER RYKEN, AM AUTHORIZED UNDER THE LAW OF THE STATE OF TEXAS TO PRACTICE THE PROFESSION OF ENGINEERING AND DO HEREBY STATE THAT THIS PLAT CONFORMS WITH THE APPLICABLE ORDINANCES OF WILLIAMSON CO., TX. AND THAT NO PORTION OF THIS SUBDIVISION IS CONTAINED WITHIN THE LIMITS OF A 100 YEAR FLOOD PLAIN RECOGNIZED BY THE FEDERAL EMERGENCY MANAGEMENT AGENCY (FEMA) PER FLOOD INSURANCE RATE MAP (FIRM) NO. 48491C0050C, EFFECTIVE DATE SEPTEMBER 28, 1991. TO CERTIFY WHICH, WITNESS MY HAND AND SEAL AT AUSTIN, TEXAS, THIS DAY 3rd OF MAY, 2018 A.D.

Jennifer Ryken

JENNIFER RYKEN, P.E., J.C.F.M.
 STATE OF TEXAS NO. 106277
 TURLEY ASSOCIATES, INC.
 301 NORTH THIRD STREET
 TEMPLE, TEXAS, 76501
 (254) 773-2400 OFFICE
 (254) 773-3998 FAX

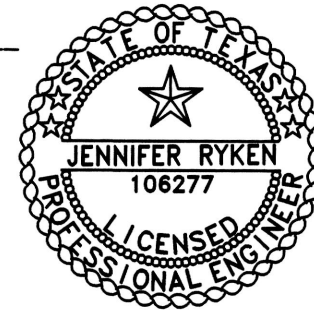

SURVEYOR'S STATEMENT

THE UNDERSIGNED DOES HEREBY CERTIFY THAT THIS PLAT IS TRUE AND CORRECT AND PREPARED FROM AN ACTUAL SURVEY MADE ON THE GROUND UNDER MY SUPERVISION OF THE PROPERTY LEGALLY DESCRIBED HEREON. ALL CORNER MONUMENTS WERE FOUND OR SET AS SHOWN HEREON.

Michael E. Alvis 5/3/18

MICHAEL E. ALVIS, R.P.L.S. No. 5402
 TURLEY ASSOCIATES, INC.
 301 NORTH THIRD STREET
 TEMPLE, TEXAS 76501
 (254) 773-2400 OFFICE
 (254) 773-3998 FAX

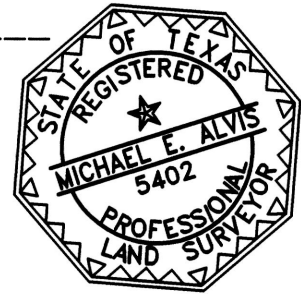

APPROVED BY:

Cindy Bridges 5/7/18
 THERESA BAKER
 WILLIAMSON COUNTY ADDRESSING COORDINATOR

Cindy Bridges

OWNERS RESPONSIBILITY

IN APPROVING THIS PLAT BY THE COMMISSIONERS' COURT OF WILLIAMSON COUNTY, TEXAS, IT IS UNDERSTOOD THAT THE BUILDING OF ALL STREETS, ROADS AND OTHER PUBLIC THOROUGHFARES AND ANY BRIDGES OR CULVERTS NECESSARY TO BE CONSTRUCTED OR PLACED IS THE RESPONSIBILITY OF THE OWNERS OF THE TRACT OF LAND COVERED BY THIS PLAT, IN ACCORDANCE WITH PLANS AND SPECIFICATIONS PRESCRIBED BY THE COMMISSIONERS' COURT OF WILLIAMSON COUNTY, TEXAS. SAID COMMISSIONERS' COURT ASSUMES NO OBLIGATION TO BUILD ANY OF THE STREETS, ROADS OR OTHER PUBLIC THOROUGHFARES SHOWN ON THIS PLAT OR OF CONSTRUCTING ANY OF THE BRIDGES OR DRAINAGE IMPROVEMENTS IN CONNECTION THEREWITH. THE COUNTY WILL ASSUME NO RESPONSIBILITY FOR DRAINAGE WAYS OR EASEMENTS IN THE SUBDIVISION, OTHER THAN THOSE DRAINING OR PROTECTING THE ROAD SYSTEM AND STREETS.

THE COUNTY ASSUMES NO RESPONSIBILITY FOR THE ACCURACY OF REPRESENTATIONS BY OTHER PARTIES IN THIS PLAT. FLOOD PLAIN DATA, IN PARTICULAR, MAY CHANGE DEPENDING ON SUBSEQUENT DEVELOPMENT.

IT IS FURTHER UNDERSTOOD THAT THE OWNERS OF THE TRACT OF LAND COVERED BY THIS PLAT MUST INSTALL, AT THEIR OWN EXPENSE, ALL TRAFFIC CONTROL DEVICES AND SIGNAGE THAT MAY BE REQUIRED BEFORE THE STREETS IN THE SUBDIVISION HAVE FINALLY BEEN ACCEPTED FOR MAINTENANCE BY THE COUNTY.

STATE OF TEXAS *
 COUNTY OF WILLIAMSON * KNOW ALL MEN BY THESE PRESENTS;

I, DAN A. GATTIS, COUNTY JUDGE OF WILLIAMSON COUNTY, TEXAS, DO HEREBY CERTIFY THAT THIS MAP OR PLAT, WITH FIELD NOTES HEREON, THAT A SUBDIVISION HAVING BEEN FULLY PRESENTED TO THE COMMISSIONERS' COURT OF WILLIAMSON COUNTY, TEXAS, AND BY THE SAID COURT DULY CONSIDERED, WERE ON THIS DAY APPROVED AND PLAT IS AUTHORIZED TO BE REGISTERED AND RECORDED IN THE PROPER RECORDS OF THE COUNTY CLERK OF WILLIAMSON COUNTY, TEXAS.

DAN A. GATTIS, COUNTY JUDGE
 WILLIAMSON COUNTY, TEXAS

STATE OF TEXAS *
 COUNTY OF WILLIAMSON * KNOW ALL MEN BY THESE PRESENTS;

I, NANCY RISTER, CLERK OF THE COUNTY COURT OF SAID COUNTY, DO HEREBY CERTIFY THAT THE FOREGOING INSTRUMENT IN WRITING, WITH ITS CERTIFICATE OF AUTHENTICATION WAS FILED FOR RECORD IN MY OFFICE ON THE _____ DAY OF _____, 2008 A.D., AT O'CLOCK _____, AND DULY RECORDED THIS THE _____ DAY OF _____, 2008 A.D., AT _____ O'CLOCK _____, AND

IN THE PLAT RECORDS OF SAID COUNTY IN CABINET _____, SLIDES _____.

TO CERTIFY WHICH, WITNESS MY HAND AND SEAL AT THE COUNTY COURT OF SAID COUNTY, AT MY OFFICE IN GEORGETOWN, TEXAS, THE DATE LAST SHOWN ABOVE WRITTEN.

NANCY RISTER, CLERK COUNTY COURT
 OF WILLIAMSON COUNTY, TEXAS

BY: _____
 DEPUTY

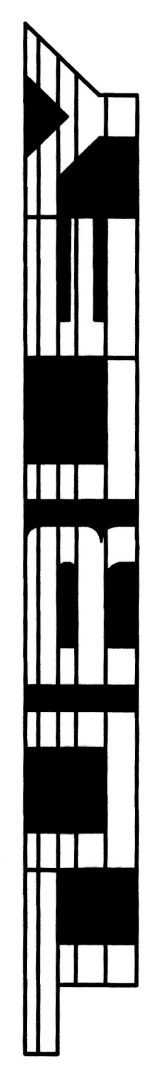

ENGINEERING • PLANNING • SURVEYING
 CONSTRUCTION MANAGEMENT
TURLEY ASSOCIATES, INC.
 301 N. 3rd ST. TEMPLE, TEXAS
 E-MAIL: VDTURLEY@AOL.COM
 (254) 773-2400
 (254) 773-3998 FAX NO.

AMENDING FINAL PLAT of:
SONTERRA SECTION III COMMERCIAL, PHASE I
 ISAAC BUNKER SURVEY, ABSTRACT #54
 A SUBDIVISION IN
 WILLIAMSON COUNTY, TEXAS
 DEVELOPED BY:
SONTERRA DEVELOPMENT, LLC.
 P.O. BOX 54
 11900 IH-35
 JARRELL, TEXAS, 76537

REVISIONS	

DATE: **MATCH 13, 2018**
 DRN. BY: **MEA**
 REF.:
 FIELD BOOK **SONTERRA 1**
 JOB NO.: **18-471**
 SHEET **3** OF **3**
 COMPUTER DWG. NO. **SEC3PHICOMM**

18471-C
 DRAWING NUMBER