

FILE: P:\22000-22999\22503-WA4 Wilco Culvert Replacement\CAD\Plans\Traffic Control.dgn
 PRINTED: 3/26/2021 @ 2:27:39 PM
 C:\ProgramData\Bentley\MicroStation\Bentley\Workspace\System\PLT\ColorLgo.tbl
 C:\ProgramData\Bentley\MicroStation\Bentley\Workspace\System\PLT\ColorLgo.tbl

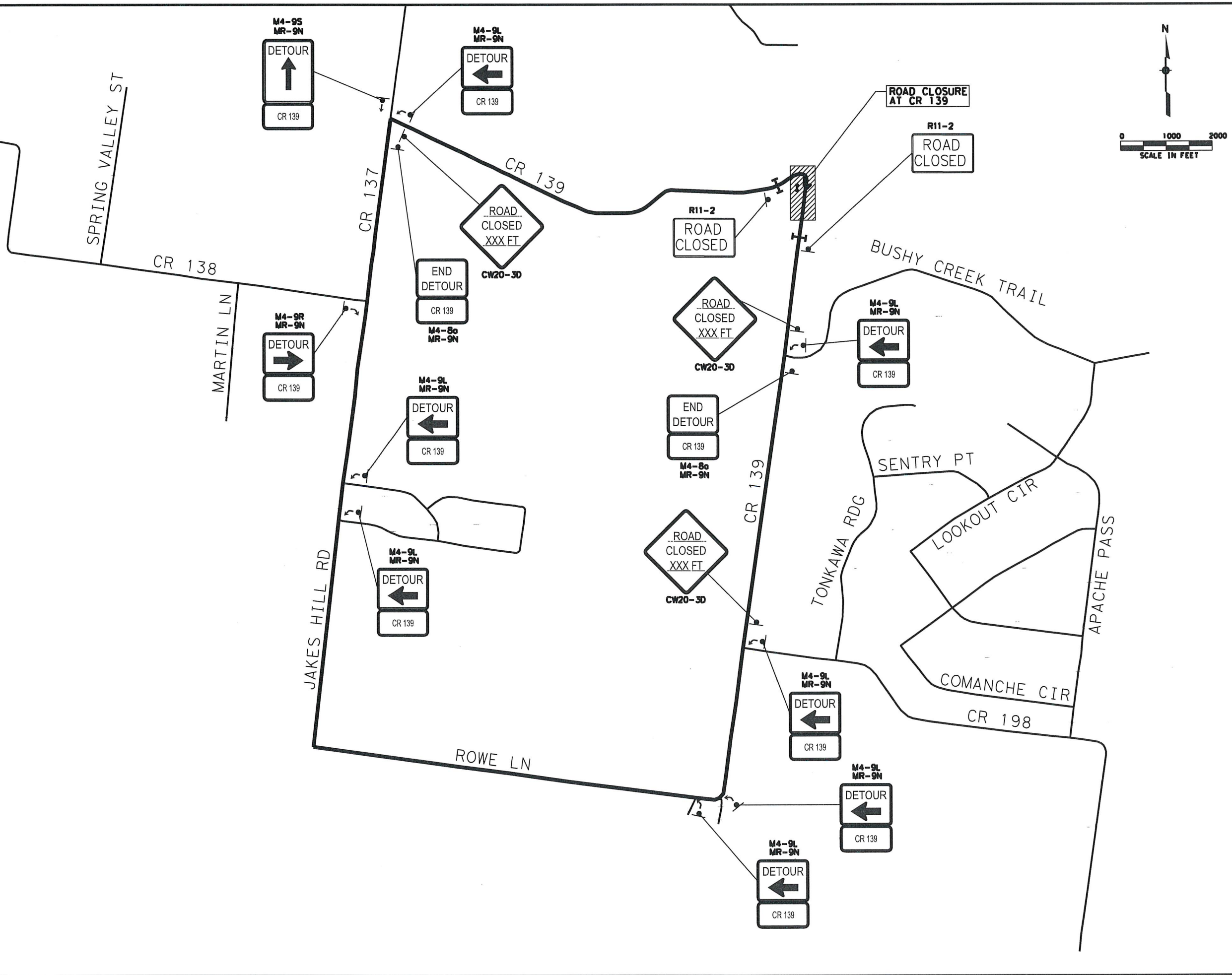

- LEGEND:**
- COG City Limits
 - TYPE III BARRICADE
 - SIGN POST
 - DETOUR TRAFFIC FLOW
- TRAFFIC CONTROL PHASING:**
1. INSTALL TRAFFIC CONTROL MEASURES AND DETOUR SIGNING
 2. CLOSE CR 139
 3. DEMOLISH EXISTING PAVEMENT AND EXISTING CULVERTS
 4. CONSTRUCT CULVERTS AND PAVE STREET
 5. REMOVE TRAFFIC CONTROL MEASURES AND DETOUR SIGNING
 6. OPEN CR 139 FOR TRAFFIC
- NOTES:**
1. THE CONTRACTOR SHALL PROVIDE ACCESS TO ALL ADJACENT PROPERTY ALONG CR 139 AT ALL TIMES.

03/24/21

WILLIAMSON COUNTY
1848 © 2020

STEGER BIZZELL
TYPE FIRM NO. 187

WILLIAMSON COUNTY
FY21 CROSS CULVERT REPLACEMENTS

TRAFFIC CONTROL PLAN
(C-2173-A AT CR 139)

SHEET 5 OF 13

DATE: 3/26/2021	DN: PH DW: PH CK: BEM AP: BEM
FED. RD. DIV. NO. 6	FEDERAL AID PROJECT NO. ----
STATE TEXAS	DIST. --- COUNTY WILLIAMSON
CONT. ----	SECT. -- JOB --- HIGHWAY NO. 29

3/26/2021 @ 2:27:42 PM
 PRINTED: C:\ProgramData\Bentley\MicroStation\Projects\WorkSpace\System\DWG\PROJECTS\I-10\CR 469\Traffic Control.dgn
 FILE: P:\22000-22999\22503-WA4\W1\ico\Culvert Replacement\CAD\Plans\Traffic Control.dgn
 PENTABLE: S:\Software\Bentley\MicroStation\Projects\WorkSpace\System\DWG\PROJECTS\I-10\CR 469\Traffic Control.dgn

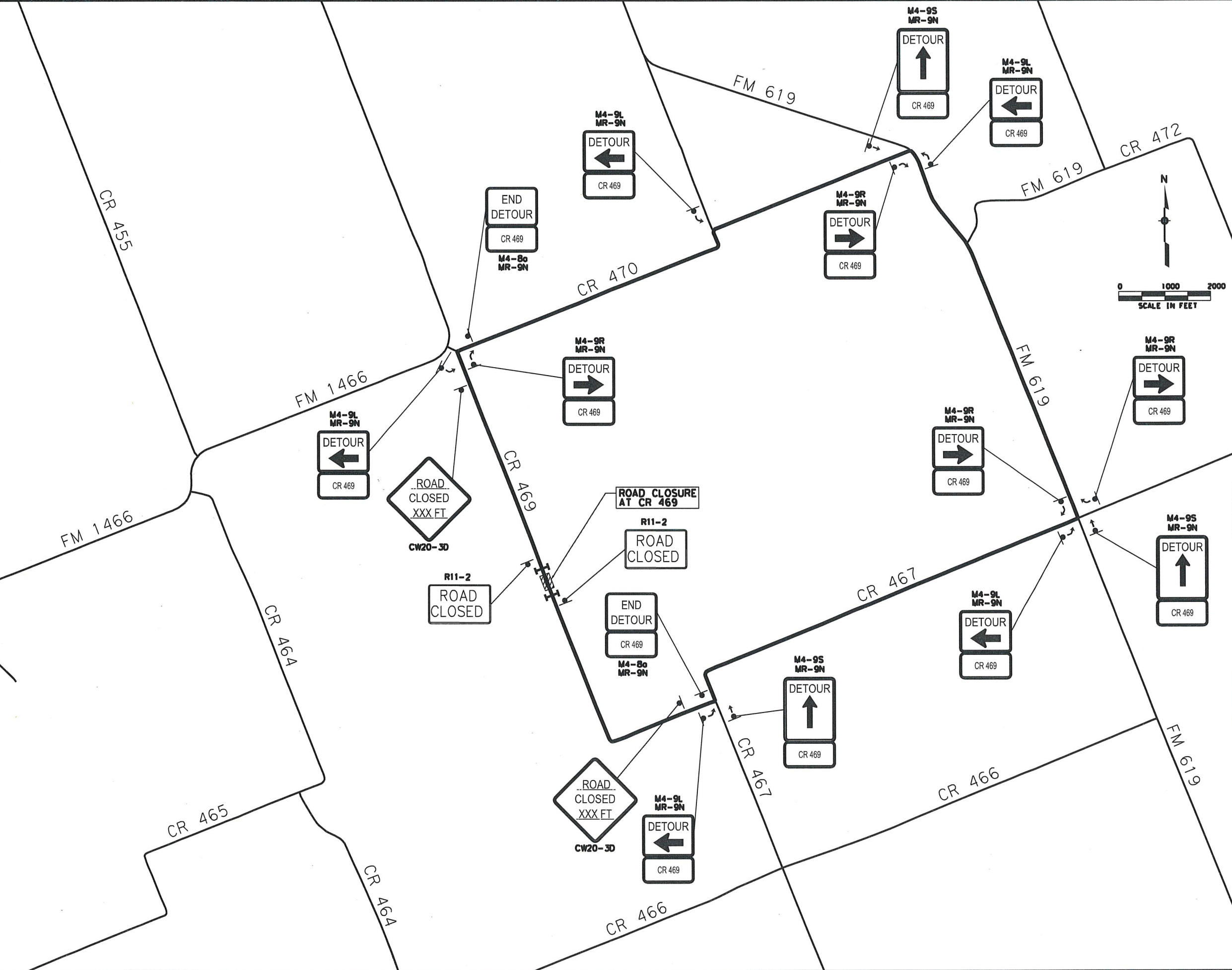

LEGEND:
 COG City Limits
 TYPE III BARRICADE
 SIGN POST
 DETOUR TRAFFIC FLOW

TRAFFIC CONTROL PHASING:
 1. INSTALL TRAFFIC CONTROL MEASURES AND DETOUR SIGNING
 2. CLOSE CR 469
 3. DEMOLISH EXISTING PAVEMENT AND EXISTING CULVERTS
 4. CONSTRUCT CULVERTS AND PAVE STREET
 5. REMOVE TRAFFIC CONTROL MEASURES AND DETOUR SIGNING
 6. OPEN CR 469 FOR TRAFFIC

NOTES:
 1. THE CONTRACTOR SHALL PROVIDE ACCESS TO ALL ADJACENT PROPERTY ALONG CR 469 AT ALL TIMES.

STATE OF TEXAS
 BRYAN ERIC MOORE
 LICENSED PROFESSIONAL ENGINEER
 792 03.24.21

WILLIAMSON COUNTY
 1848 © 2020

STEGER BIZZELL
 TYPE FIRM NO. 115

WILLIAMSON COUNTY
 FY21 CROSS CULVERT REPLACEMENTS

TRAFFIC CONTROL PLAN
 (C-2555-A AT CR 469)

SHEET 7 OF 13

DATE: 3/26/2021	DN:	PH:	DW:	PH:	CK:	BEM:	AP:	BEM:
FED. RD. DIV. NO.	FEDERAL AID PROJECT NO.		SHEET NO.					
6	----		31					
STATE	DIST.	COUNTY						
TEXAS	---	WILLIAMSON						
CONT.	SECT.	JOB	HIGHWAY NO.					
----	--	---						

FILE: P:\22000-22999\22503-WA4 W1100 Culvert Replacement\CAD\Plans\Traffic Control.dgn
 PRINTED: 3/26/2021 @ 2:27:43 PM
 C:\ProgramData\Bentley\MicroStation\Bentley\Workspace\System\Printer.ctb

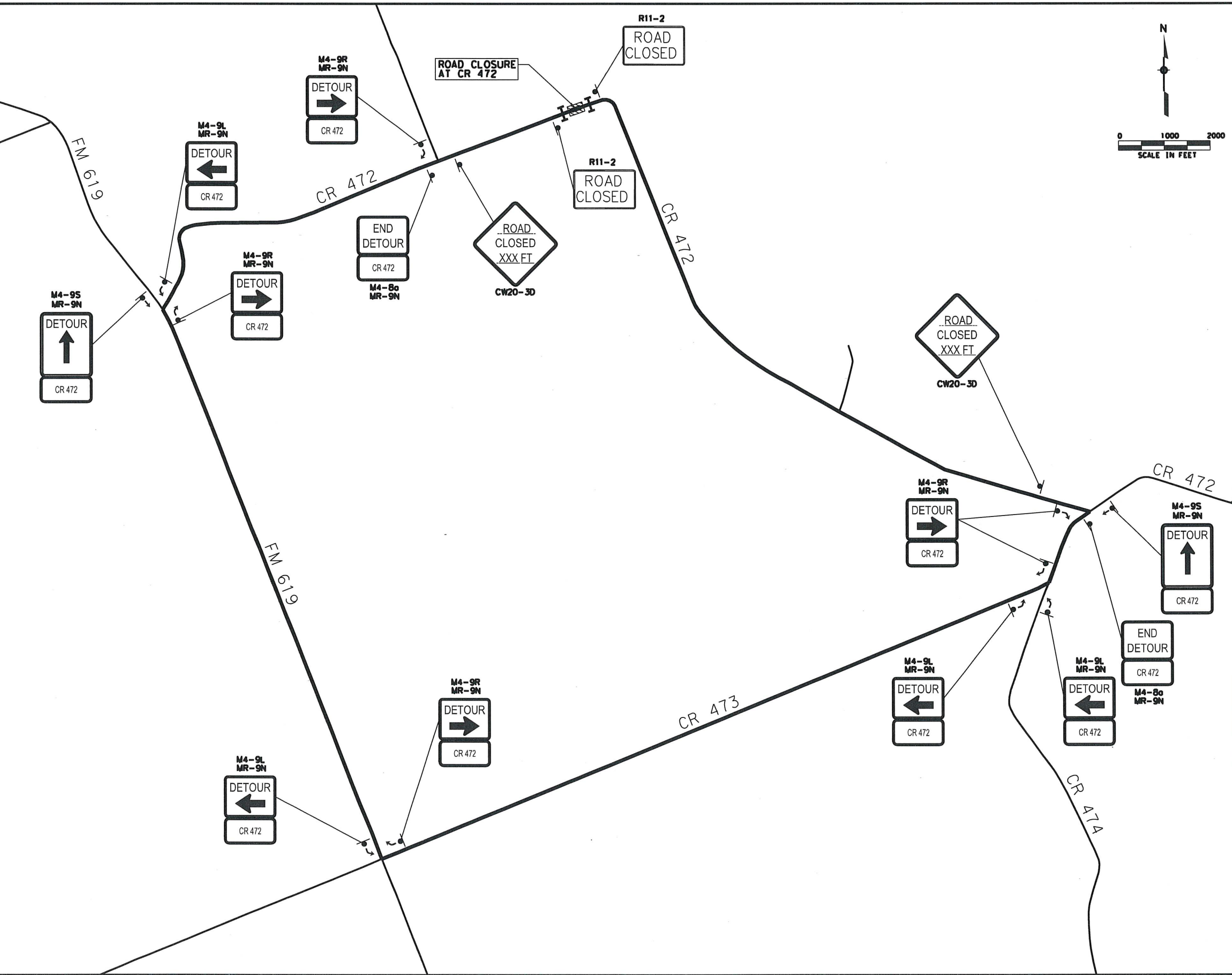

- LEGEND:**
- COG City Limits
 - TYPE III BARRICADE
 - SIGN POST
 - ← DETOUR TRAFFIC FLOW
- TRAFFIC CONTROL PHASING:**
1. INSTALL TRAFFIC CONTROL MEASURES AND DETOUR SIGNING
 2. CLOSE CR 472
 3. DEMOLISH EXISTING PAVEMENT AND EXISTING CULVERTS
 4. CONSTRUCT CULVERTS AND PAVE STREET
 5. REMOVE TRAFFIC CONTROL MEASURES AND DETOUR SIGNING
 6. OPEN CR 472 FOR TRAFFIC
- NOTES:**
1. THE CONTRACTOR SHALL PROVIDE ACCESS TO ALL ADJACENT PROPERTY ALONG CR 472 AT ALL TIMES.

WILLIAMSON COUNTY
FY21 CROSS CULVERT REPLACEMENTS

TRAFFIC CONTROL PLAN
(C-2616-A AT CR 472)

SHEET 8 OF 13

DATE: 3/26/2021				DN: PH DW: PH CK: BEM AP: BEM			
FED. RD. DIV. NO.		FEDERAL AID PROJECT NO.		SHEET NO.			
6		----		32			
STATE	DIST.	COUNTY					
TEXAS	---	WILLIAMSON					
CONT.	SECT.	JOB	HIGHWAY NO.				
----	--	---					

3/26/2021 @ 2:27:48 PM
 PRINTED: C:\ProgramData\Bentley\MicroStation\Projects\WorkSpace\system\pl\ctg\pr\inter.pl.ctg
 FILE: P:\22000-22999\22503-WA4\W1100\Culvert Replacement\CAD\Plans\Traffic Control.dgn
 PENTABLE: S:\Software\Bentley\Standards\Tables\Pen\gray\scale.ctb

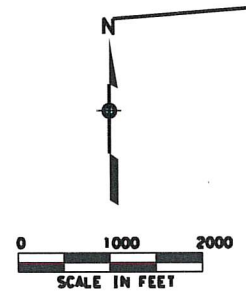
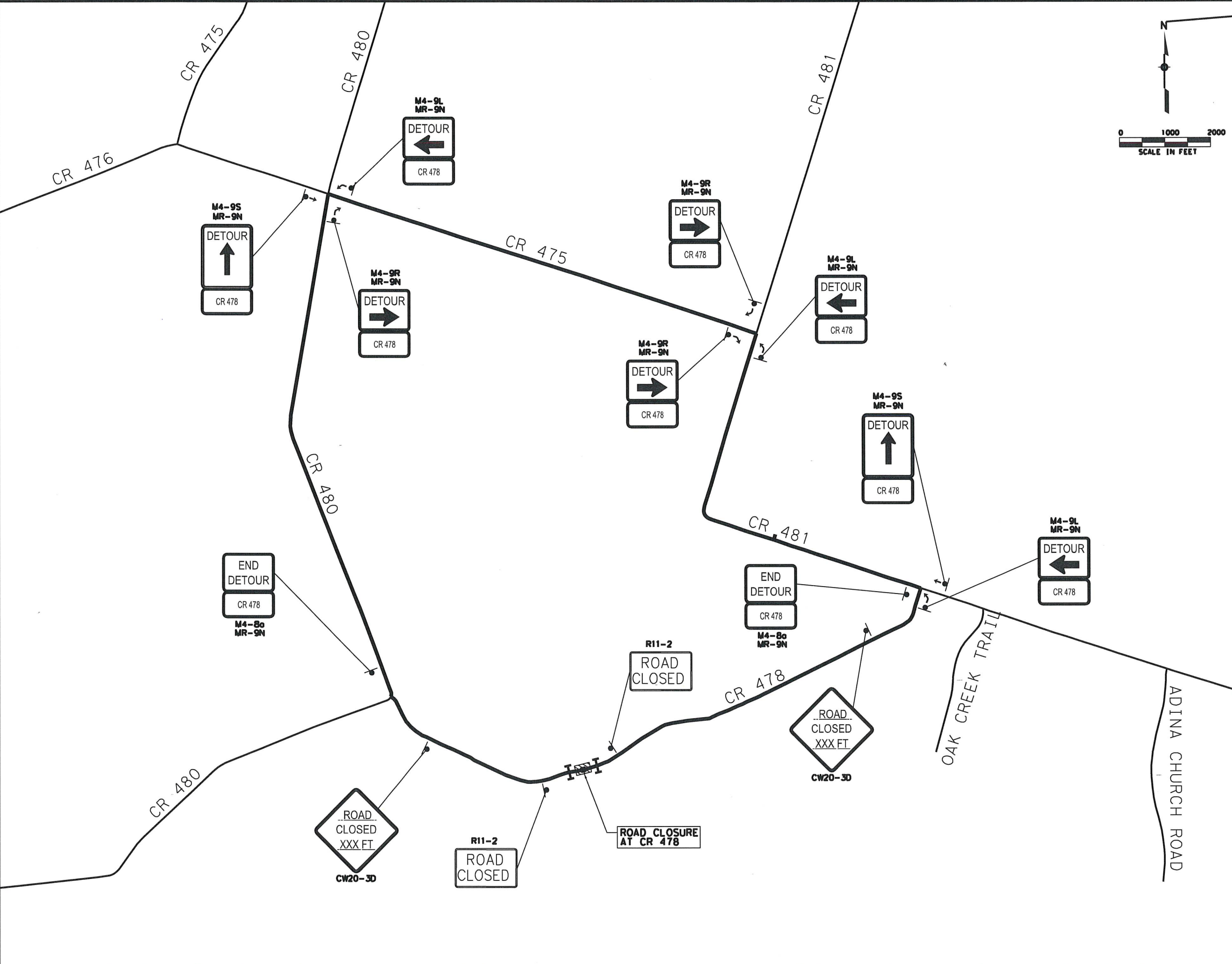

- LEGEND:**
- COG City Limits
 - TYPE III BARRICADE
 - SIGN POST
 - ← DETOUR TRAFFIC FLOW
- TRAFFIC CONTROL PHASING:**
1. INSTALL TRAFFIC CONTROL MEASURES AND DETOUR SIGNING
 2. CLOSE CR 478
 3. DEMOLISH EXISTING PAVEMENT AND EXISTING CULVERTS
 4. CONSTRUCT CULVERTS AND PAVE STREET
 5. REMOVE TRAFFIC CONTROL MEASURES AND DETOUR SIGNING
 6. OPEN CR 478 FOR TRAFFIC
- NOTES:**
1. THE CONTRACTOR SHALL PROVIDE ACCESS TO ALL ADJACENT PROPERTY ALONG CR 478 AT ALL TIMES.

03-24-21

WILLIAMSON COUNTY
1848 © 2020

STEGER BIZZELL
TYPE FIRM NO. 191

WILLIAMSON COUNTY
FY21 CROSS CULVERT REPLACEMENTS

TRAFFIC CONTROL PLAN
(C-2775-A AT CR 478)

SHEET 10 OF 13

DATE: 3/26/2021				DN:	PH:	DW:	PH:	CK:	BEM:	AP:	BEM:	
FED. RD. DIV. NO.	FEDERAL AID PROJECT NO.						SHEET NO.					
6	----						34					
STATE	DIST.	COUNTY										
TEXAS	---	WILLIAMSON										
CONT.	SECT.	JOB	HIGHWAY NO.									
----	--	---										