

SANTA RITA RANCH PHASE 5, SECTION 3C
FINAL PLAT

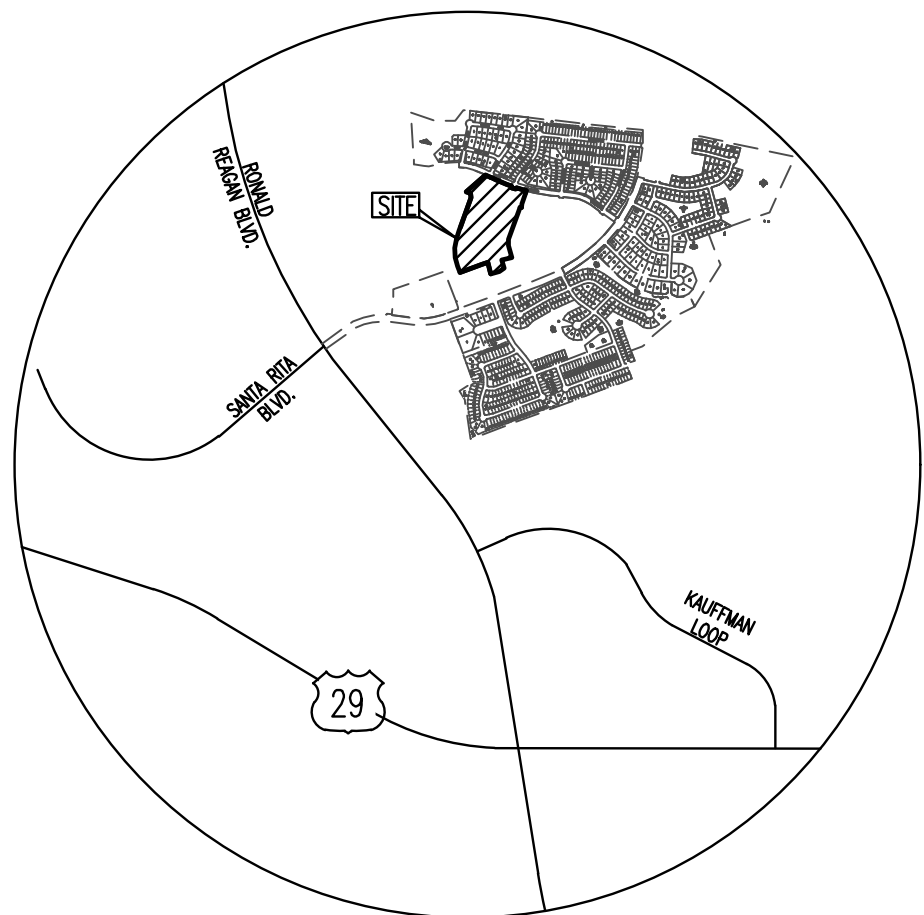

VICINITY MAP
APPROX. SCALE:
1"=2000'

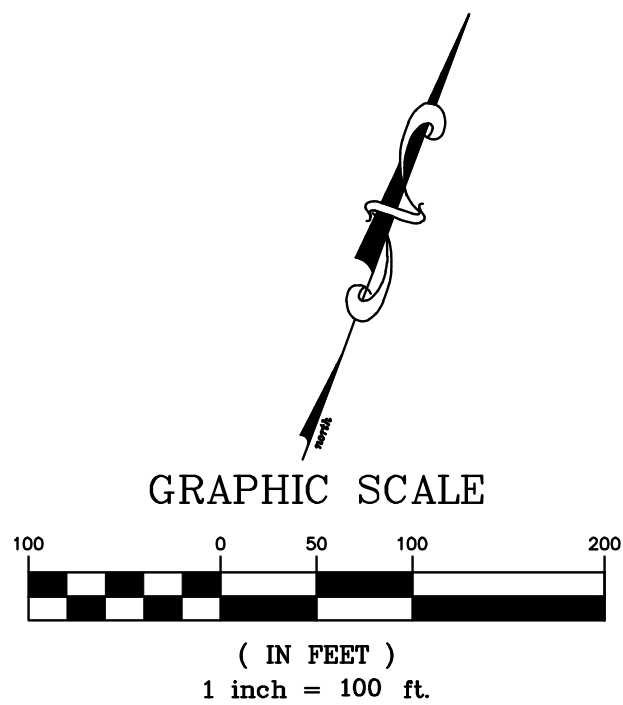

- LEGEND**
- 1/2" IRON ROD FOUND WITH "CBD SETSTONE" CAP
 - 1/2" CAPPED IRON ROD SET WITH "CBD SETSTONE" CAP
 - B.L. BUILDING SETBACK LINE
 - L.S.E. LANDSCAPE EASEMENT
 - O.S. OPEN SPACE
 - P.U.E. PUBLIC UTILITY EASEMENT
 - O.P.R.W.C.T.X. OFFICIAL PUBLIC RECORDS, WILLIAMSON COUNTY, TEXAS
 - 1 LOT NUMBER
 - Ⓐ BLOCK DESIGNATION



DATE: MAY 30, 2023

OWNER:
SANTA RITA KC, LLC
1700 CROSS CREEK LANE, STE. 100
LIBERTY HILL, TX 78642

DEVELOPER:
SANTA RITA KC, LLC
1700 CROSS CREEK LANE, STE. 100
LIBERTY HILL, TX 78642

ENGINEER & SURVEYOR:
CARLSON, BRIGANCE & DOERING, INC.
5501 WEST WILLIAM CANNON DRIVE
AUSTIN, TEXAS 78749
(512) 280-5160 PHONE

TOTAL ACREAGE: 17.534 ACRES
SURVEY: GREENLEAF FISK SURVEY,
ABSTRACT NO. 5

F.E.M.A. MAP NO. 48491C0275E
WILLIAMSON COUNTY, TEXAS AND
INCORPORATED AREAS.
DATED: SEPTEMBER 26, 2008

TOTAL OF LOTS	75
SINGLE FAMILY LOTS:	73
O.S., L.S.E. & P.U.E. LOTS:	2

ROAD TABLE						
STREET NAMES	LINEAR FOOTAGE	R.O.W. WIDTH	PAVEMENT WIDTH	DESIGN SPEED	DESIGNATION	CLASSIFICATION
ECHO PASS	1,313'	50' R.O.W.	33' FOC-FOC	25 M.P.H.	PUBLIC	LOCAL
HOLLISTER DRIVE	1,105'	50' R.O.W.	33' FOC-FOC	25 M.P.H.	PUBLIC	LOCAL
RANCHLAND PASS	482'	50' R.O.W.	33' FOC-FOC	25 M.P.H.	PUBLIC	LOCAL
VENTURA DRIVE	160'	50' R.O.W.	33' FOC-FOC	25 M.P.H.	PUBLIC	LOCAL
TOTAL	3,060'					

SHEET NO. 1 OF 4



Carlson, Brigance & Doering, Inc.

FIRM ID #F3791 REG. # 10024900

Civil Engineering Surveying
5501 West William Cannon Austin, Texas 78749
Phone No. (512) 280-5160 Fax No. (512) 280-5165

SANTA RITA RANCH PHASE 5, SECTION 3C
FINAL PLAT

Curve Table						
Curve #	Length	Radius	Chord Direction	Chord Length	Tangent	DELTA
C1	290.63	2300.00	S66°53'10"E	290.44	145.51	7°14'24"
C2	23.66	15.00	S25°18'34"E	21.29	15.10	90°23'36"
C3	22.94	15.00	N63°42'01"E	20.77	14.39	87°37'33"
C4	123.95	2300.00	S74°01'51"E	123.93	61.99	3°05'16"
C5	20.53	525.00	N82°34'59"W	20.52	10.26	2°14'24"
C6	23.56	15.00	N64°53'14"E	21.21	15.00	90°00'00"
C7	112.67	475.00	S76°54'29"E	112.40	56.60	1°35'25"
C8	23.56	15.00	S25°06'46"E	21.21	15.00	90°00'00"
C9	21.03	25.00	S46°01'05"E	20.41	11.18	48°11'23"
C10	162.65	50.00	S64°53'14"W	99.85	897.21	186°22'46"
C11	9.88	50.00	N27°34'59"W	9.86	4.96	1°19'11"
C12	46.39	50.00	N59°49'13"W	44.74	25.01	5°09'18"
C13	34.79	50.00	S73°40'14"W	34.09	18.13	39°51'48"
C14	40.07	50.00	S30°46'46"W	39.01	21.18	45°55'09"
C15	31.52	50.00	S10°14'29"E	31.00	16.30	36°07'20"
C16	21.03	25.00	N04°12'28"W	20.41	11.18	48°11'23"
C17	23.56	15.00	N64°53'14"E	21.21	15.00	90°00'00"
C18	124.53	525.00	S76°54'29"E	124.24	62.56	1°35'25"
C19	104.00	525.00	S75°47'17"E	103.83	52.17	1°21'01"
C20	23.56	15.00	S64°53'14"W	21.21	15.00	90°00'00"
C21	23.56	15.00	S25°06'46"E	21.21	15.00	90°00'00"

Curve Table						
Curve #	Length	Radius	Chord Direction	Chord Length	Tangent	DELTA
C22	23.56	15.00	S25°06'46"E	21.21	15.00	90°00'00"
C23	39.27	25.00	S64°53'14"W	35.36	25.00	90°00'00"
C24	23.56	15.00	N25°06'46"W	21.21	15.00	90°00'00"
C25	23.56	15.00	N64°53'14"E	21.21	15.00	90°00'00"
C26	23.56	15.00	S64°53'14"W	21.21	15.00	90°00'00"
C27	168.87	275.00	S02°17'44"W	166.23	87.19	35°10'59"
C28	63.05	275.00	S08°43'41"E	62.91	31.66	1°30'08"
C29	86.19	275.00	S06°49'06"W	85.84	43.45	1°57'28"
C30	19.63	275.00	S17°50'32"W	19.63	9.82	4°05'24"
C31	23.56	15.00	N25°06'46"W	21.21	15.00	90°00'00"
C32	139.46	255.00	S04°13'09"W	137.73	71.52	3°12'10"
C33	8.11	255.00	S18°58'34"W	8.11	4.06	1°49'20"
C34	45.60	255.00	S12°56'33"W	45.54	22.86	10°14'42"
C35	45.60	255.00	S02°41'51"W	45.54	22.86	10°14'42"
C36	40.16	255.00	S06°56'13"E	40.12	20.12	9°01'26"
C37	22.10	25.00	N13°52'25"E	21.39	11.83	50°38'43"
C38	12.28	25.00	N02°37'35"E	12.16	6.27	28°09'02"
C39	9.82	25.00	N27°56'56"E	9.75	4.97	22°29'41"
C40	301.31	60.00	N75°19'52"E	70.76	43.81	287°43'51"
C41	49.56	60.00	S15°31'53"W	48.17	26.29	47°19'49"
C42	39.83	60.00	S27°09'03"E	39.10	20.68	38°02'03"

Curve Table						
Curve #	Length	Radius	Chord Direction	Chord Length	Tangent	DELTA
C43	35.82	60.00	S63°16'22"E	35.29	18.46	34°12'33"
C44	35.82	60.00	N82°31'05"E	35.29	18.46	34°12'33"
C45	35.82	60.00	N48°18'32"E	35.29	18.46	34°12'33"
C46	35.82	60.00	N14°05'58"E	35.29	18.46	34°12'33"
C47	51.26	60.00	N27°28'44"W	49.71	27.31	48°56'50"
C48	17.36	60.00	N60°14'36"W	17.30	8.74	16°34'55"
C49	25.69	25.00	S39°05'43"E	24.57	14.11	58°52'41"
C50	105.70	205.00	S05°06'56"W	104.54	54.05	29°32'36"
C51	44.64	205.00	S03°25'07"E	44.55	22.41	1°22'31"
C52	61.07	205.00	S11°21'11"W	60.84	30.76	17°04'05"
C53	23.56	15.00	S64°53'14"W	21.21	15.00	90°00'00"
C54	23.56	15.00	N25°06'46"W	21.21	15.00	90°00'00"
C55	199.57	325.00	S02°17'44"W	196.45	103.04	35°10'59"
C56	6.60	325.00	S19°18'19"W	6.60	3.30	1°09'51"
C57	46.00	325.00	S14°40'07"W	45.96	23.04	8°06'32"
C58	46.47	325.00	S06°31'05"W	46.43	23.27	8°11'32"
C59	51.40	325.00	S02°06'30"E	51.34	25.75	9°03'39"
C60	46.47	325.00	S10°44'06"E	46.43	23.27	8°11'32"
C61	2.64	325.00	S15°03'48"E	2.64	1.32	0°27'54"
C62	21.03	25.00	N08°47'56"E	20.41	11.18	48°11'23"
C63	13.13	50.00	S25°22'11"W	13.09	6.60	15°02'54"

GENERAL:

- BEARINGS ARE BASED ON THE TEXAS COORDINATE SYSTEM, CENTRAL ZONE (4203), NAD83.
- THIS SUBDIVISION LIES WITHIN THE CITY OF LIBERTY HILL EXTRA-TERRITORIAL JURISDICTION.
- IT IS THE RESPONSIBILITY OF THE OWNER, NOT THE COUNTY, TO ASSURE COMPLIANCE WITH PROVISIONS OF ALL APPLICABLE STATE, FEDERAL AND LOCAL LAWS, AND REGULATIONS RELATING TO PLATTING AND DEVELOPMENT OF THIS PROPERTY. THE COUNTY ASSUMES NO RESPONSIBILITY FOR THE ACCURACY OF REPRESENTATIONS BY OTHER PARTIES IN THIS PLAT. FLOODPLAIN DATA, IN PARTICULAR, MAY CHANGE. IT IS FURTHER UNDERSTOOD THAT THE OWNERS OF THE TRACT OF LAND COVERED BY THIS PLAT MUST INSTALL AT THEIR OWN EXPENSE ALL TRAFFIC CONTROL DEVICES AND SIGNAGE THAT MAY BE REQUIRED BEFORE THE ROADS IN THE SUBDIVISION HAVE FINALLY BEEN ACCEPTED FOR MAINTENANCE BY THE COUNTY.
- ALL PROPOSED ROADWAYS AND EASEMENTS AS SHOWN ON THIS PLAT ARE FREE OF LIENS.

DRAINAGE AND FLOODPLAIN:

- EXCEPT IN CERTAIN ISOLATED AREAS REQUIRED TO MEET ACCESSIBILITY REQUIREMENTS, THE MINIMUM LOWEST FINISHED FLOOR ELEVATION SHALL BE ONE FOOT HIGHER THAN THE HIGHEST SPOT ELEVATION THAT IS LOCATED WITHIN FIVE FEET OUTSIDE THE PERIMETER OF THE BUILDING, OR ONE FOOT ABOVE THE BFE, WHICHEVER IS HIGHER.
- A DE FACTO CERTIFICATE OF COMPLIANCE IS HEREBY ISSUED FOR ALL LOTS WITHIN THIS SUBDIVISION. THIS CERTIFICATE IS VALID UNTIL SUCH TIME AS FEMA REVISES OR NEWLY ADOPTS FLOODPLAIN BOUNDARIES IN THIS AREA.
- THIS SUBDIVISION IS SUBJECT TO STORM-WATER MANAGEMENT CONTROLS AS REQUIRED BY WILLIAMSON COUNTY SUBDIVISION REGULATIONS, SECTION B11.1, ON NEW DEVELOPMENT THAT WOULD EVOKE SUCH CONTROLS BEYOND EXISTING CONDITIONS.
- MAINTENANCE RESPONSIBILITY OF DRAINAGE WILL NOT BE ACCEPTED BY THE COUNTY OTHER THAN THAT ACCEPTED IN CONNECTION WITH DRAINING OR PROTECTING THE ROAD SYSTEM. MAINTENANCE RESPONSIBILITY FOR STORM WATER MANAGEMENT CONTROLS WILL REMAIN WITH THE OWNER.

WATER AND WASTEWATER:

- NO LOT IN THIS SUBDIVISION SHALL BE OCCUPIED UNTIL CONNECTION IS MADE TO AN APPROVED PUBLIC SEWER SYSTEM.
- NO LOT IN THIS SUBDIVISION SHALL BE OCCUPIED UNTIL WATER SATISFACTORY FOR HUMAN CONSUMPTION IS AVAILABLE FROM A SOURCE IN ADEQUATE AND SUFFICIENT SUPPLY.
- WATER SERVICE IS PROVIDED BY: WILLIAMSON COUNTY MUD 19F/ GEORGETOWN UTILITY SYSTEMS
- WASTEWATER SERVICE IS PROVIDED BY: WILLIAMSON COUNTY MUD 19F/CITY OF LIBERTY HILL
- ELECTRIC SERVICE IS PROVIDED BY: PEC

ROADWAY AND RIGHT-OF-WAY:

- IN APPROVING THIS PLAT BY THE COMMISSIONERS COURT OF WILLIAMSON COUNTY, TEXAS, IT IS UNDERSTOOD THAT THE BUILDING OF ALL ROADS, AND OTHER PUBLIC THOROUGHFARES AND ANY BRIDGES OR CULVERTS NECESSARY TO BE CONSTRUCTED OR PLACED IS THE RESPONSIBILITY OF THE OWNER(S) OF THE TRACT OF LAND COVERED BY THIS PLAT IN ACCORDANCE WITH THE PLANS AND SPECIFICATIONS PRESCRIBED BY THE COMMISSIONERS COURT OF WILLIAMSON COUNTY, TEXAS. SAID COMMISSIONERS COURT ASSUMES NO OBLIGATION TO BUILD ANY OF THE ROADS, OR PUBLIC THOROUGHFARES SHOWN ON THIS PLAT, OR OF CONSTRUCTING ANY OF THE BRIDGES OR DRAINAGE IMPROVEMENTS IN CONNECTION THEREWITH. THE COUNTY WILL ASSUME NO RESPONSIBILITY FOR DRAINAGE WAYS OR EASEMENTS IN THE SUBDIVISION, OTHER THAN THOSE DRAINING OR PROTECTING THE ROAD SYSTEM.
- SIDEWALKS SHALL BE MAINTAINED BY THE HOMEOWNERS' ASSOCIATION.
- DRIVEWAY ACCESS TO LOTS WITHIN THIS SUBDIVISION FROM SIDE STREETS IS PROHIBITED.
- IMPROVEMENTS WITHIN THE COUNTY ROAD RIGHT-OF-WAY INCLUDING, BUT NOT LIMITED TO LANDSCAPING, IRRIGATION, LIGHTING, CUSTOM SIGNS, ARE PROHIBITED WITHOUT FIRST OBTAINING AN EXECUTED LICENSE AGREEMENT WITH WILLIAMSON COUNTY.
- NO CONSTRUCTION, PLANTING OR GRADING SHALL BE PERMITTED TO INTERFERE WITH SIGHT EASEMENTS BETWEEN THE HEIGHTS OF THREE AND EIGHT FEET AS MEASURED FROM THE CROWNS OF THE ADJACENT STREETS.
- THE OWNER SHALL CREATE A MANDATORY HOMEOWNERS' ASSOCIATION THAT SHALL BE RESPONSIBLE FOR THE MAINTENANCE AND LIABILITY OF ANY LANDSCAPING, IRRIGATION, SIDEWALKS, ILLUMINATION, SUBDIVISION IDENTIFICATION SIGNS, WATER QUALITY FEATURES, ETC. PLACED WITHIN THE WILLIAMSON COUNTY RIGHT-OF-WAY. THIS ASSOCIATION SHALL HAVE ASSESSMENT AUTHORITY TO ENSURE THE PROPER FUNDING FOR MAINTENANCE.
- A PUBLIC UTILITY EASEMENT 10 FEET WIDE IS HEREBY DEDICATED ADJACENT TO ALL STREET RIGHT-OF-WAY.

Line Table		
Line #	Length	Direction
L1	50.00	S70°06'46"E
L2	1.93	N19°53'14"E
L3	23.56	S14°25'32"W
L4	50.00	S06°17'49"W
L5	80.27	S00°09'30"W
L6	134.39	S74°42'15"W
L7	110.00	S15°17'45"E
L8	70.60	S55°58'47"W
L9	118.13	S74°42'15"W
L10	73.70	S72°52'12"W
L11	90.00	N20°29'22"W
L12	114.22	N15°46'18"W
L13	127.63	N02°59'59"W
L14	122.92	N10°19'21"E
L15	106.70	N19°28'55"E
L16	56.14	N07°09'37"W
L17	59.74	N70°06'46"W
L18	75.92	S63°15'58"E
L19	18.50	S70°06'46"E
L20	21.21	N25°06'46"W
L21	18.50	S70°06'46"E
L22	38.66	N19°53'14"E
L23	15.00	N70°06'46"W
L24	93.64	S19°53'14"W

SHEET NO. 2 OF 4



Carlson, Brigrance & Doering, Inc.

FIRM ID #F3791

Civil Engineering
5501 West William Cannon
Phone No. (512) 280-5160

REG. # 10024900

Surveying
Austin, Texas 78749
Fax No. (512) 280-5165

SANTA RITA RANCH PHASE 5, SECTION 3C
FINAL PLAT

METES AND BOUNDS

BEING A 17.534 ACRE TRACT OF LAND SITUATED IN THE GREENLEAF FISK SURVEY, ABSTRACT NUMBER 5, WILLIAMSON COUNTY, TEXAS, BEING A PORTION OF A CALLED 146.160 ACRE TRACT OF LAND CONVEYED TO SANTA RITA KC, LLC, BY DEED RECORDED IN DOCUMENT NUMBER 2021157281, OFFICIAL PUBLIC RECORDS, WILLIAMSON COUNTY, TEXAS (O.P.R.W.C.TX.), SAID 17.534 ACRE TRACT OF LAND BEING MORE FULLY DESCRIBED BY METES AND BOUNDS AS FOLLOWS:

BEGINNING, AT A CAPPED 1/2 INCH IRON ROD FOUND STAMPED "CBD SETSTONE" ON THE SOUTH LINE OF SANTA RITA RANCH PHASE 5, SECTION 2, A SUBDIVISION RECORDED IN DOCUMENT NUMBER 2022083761, O.P.R.W.C.TX., BEING THE SOUTH LINE OF LYNFIELD LANE (64' R.O.W.), SAME BEING AT THE BEGINNING OF A CURVE TO THE LEFT, FOR THE POINT OF BEGINNING OF THE HEREIN DESCRIBED TRACT OF LAND,

THENCE, OVER AND ACROSS SAID 146.160 ACRE TRACT OF LAND, WITH THE SOUTH LINE OF SAID SANTA RITA RANCH PHASE 5, SECTION 2, WITH THE SOUTH LINE OF SANTA RITA RANCH PHASE 5, SECTION 1, A SUBDIVISION RECORDED IN DOCUMENT NUMBER 2022011059, O.P.R.W.C.TX., BOTH BEING THE SOUTH LINE OF SAID LYNFIELD LANE, THE FOLLOWING SIX (6) COURSES AND DISTANCES, NUMBERED 1 THROUGH 6,

- 1) ALONG SAID CURVE TO THE LEFT, HAVING A RADIUS OF 2300.00 FEET, AN ARC LENGTH OF 290.63 FEET, AND A CHORD THAT BEARS S66°53'10"E, A DISTANCE OF 290.44 FEET TO A CAPPED 1/2 INCH IRON ROD FOUND STAMPED "CBD SETSTONE", BEING AT A POINT OF CURVATURE, FOR A CURVE TO THE RIGHT,
- 2) ALONG SAID CURVE TO THE RIGHT, HAVING A RADIUS OF 15.00 FEET, AN ARC LENGTH OF 23.66 FEET, AND A CHORD THAT BEARS S25°18'34"E, A DISTANCE OF 21.29 FEET TO A CAPPED 1/2 INCH IRON ROD FOUND STAMPED "CBD SETSTONE", FOR CORNER,
- 3) S70°06'46"E, A DISTANCE OF 50.00 FEET TO A CAPPED 1/2 INCH IRON ROD FOUND STAMPED "CBD SETSTONE", FOR CORNER,
- 4) N19°53'14"E, A DISTANCE OF 1.93 FEET TO A CAPPED 1/2 INCH IRON ROD FOUND STAMPED "CBD SETSTONE", BEING AT A POINT OF CURVATURE, FOR A CURVE TO THE RIGHT,
- 5) ALONG SAID CURVE TO THE RIGHT, HAVING A RADIUS OF 15.00 FEET, AN ARC LENGTH OF 22.94 FEET, AND A CHORD THAT BEARS N63°42'01"E, A DISTANCE OF 20.77 FEET TO A CAPPED 1/2 INCH IRON ROD FOUND STAMPED "CBD SETSTONE", BEING AT A POINT OF CURVATURE, FOR A CURVE TO THE LEFT,
- 6) ALONG SAID CURVE TO THE LEFT, HAVING A RADIUS OF 2300.00 FEET, AN ARC LENGTH OF 123.95 FEET, AND A CHORD THAT BEARS S74°01'51"E, A DISTANCE OF 123.93 FEET TO A CAPPED 1/2 INCH IRON ROD SET STAMPED "CBD SETSTONE", FOR THE NORTHEAST CORNER OF THE HEREIN DESCRIBED TRACT OF LAND,

THENCE, OVER AND ACROSS SAID 146.160 ACRE TRACT OF LAND, THE FOLLOWING TWENTY-THREE (23) COURSES AND DISTANCES, NUMBERED 1 THROUGH 23,

- 1) S14°25'32"W, A DISTANCE OF 23.56 FEET TO A CAPPED 1/2 INCH IRON ROD SET STAMPED "CBD SETSTONE", FOR CORNER,
- 2) S18°04'22"W, A DISTANCE OF 153.00 FEET TO A CAPPED 1/2 INCH IRON ROD SET STAMPED "CBD SETSTONE", FOR CORNER,
- 3) S06°17'49"W, A DISTANCE OF 50.00 FEET TO A CAPPED 1/2 INCH IRON ROD SET STAMPED "CBD SETSTONE", BEING AT A POINT OF CURVATURE, FOR A CURVE TO THE RIGHT,
- 4) ALONG SAID CURVE TO THE RIGHT, HAVING A RADIUS OF 525.00 FEET, AN ARC LENGTH OF 20.53 FEET, AND A CHORD THAT BEARS N82°34'59"W, A DISTANCE OF 20.52 FEET TO A CAPPED 1/2 INCH IRON ROD SET STAMPED "CBD SETSTONE", FOR CORNER,
- 5) S19°53'14"W, A DISTANCE OF 443.55 FEET TO A CAPPED 1/2 INCH IRON ROD SET STAMPED "CBD SETSTONE", FOR CORNER,
- 6) S00°09'30"W, A DISTANCE OF 80.27 FEET TO A CAPPED 1/2 INCH IRON ROD SET STAMPED "CBD SETSTONE", FOR CORNER,
- 7) S15°05'04"E, A DISTANCE OF 158.67 FEET TO A CAPPED 1/2 INCH IRON ROD SET STAMPED "CBD SETSTONE", BEING AT THE SOUTHEAST CORNER OF THE HEREIN DESCRIBED TRACT OF LAND,
- 8) S74°42'15"W, A DISTANCE OF 134.39 FEET TO A CAPPED 1/2 INCH IRON ROD SET STAMPED "CBD SETSTONE", FOR CORNER,
- 9) S15°17'45"E, A DISTANCE OF 110.00 FEET TO A CAPPED 1/2 INCH IRON ROD SET STAMPED "CBD SETSTONE", FOR CORNER,
- 10) S55°58'47"W, A DISTANCE OF 70.60 FEET TO A CAPPED 1/2 INCH IRON ROD SET STAMPED "CBD SETSTONE", FOR CORNER,
- 11) S74°42'15"W, A DISTANCE OF 118.13 FEET TO A CAPPED 1/2 INCH IRON ROD SET STAMPED "CBD SETSTONE", FOR CORNER,
- 12) N15°17'45"W, A DISTANCE OF 150.00 FEET TO A CAPPED 1/2 INCH IRON ROD SET STAMPED "CBD SETSTONE", FOR CORNER,
- 13) S72°52'12"W, A DISTANCE OF 73.70 FEET TO A CAPPED 1/2 INCH IRON ROD SET STAMPED "CBD SETSTONE", FOR CORNER,
- 14) S69°30'38"W, A DISTANCE OF 307.53 FEET TO A CAPPED 1/2 INCH IRON ROD SET STAMPED "CBD SETSTONE", FOR THE SOUTHWEST CORNER OF THE HEREIN DESCRIBED TRACT OF LAND,
- 15) N20°29'22"W, A DISTANCE OF 90.00 FEET TO A CAPPED 1/2 INCH IRON ROD SET STAMPED "CBD SETSTONE", FOR CORNER,
- 16) N15°46'18"W, A DISTANCE OF 114.22 FEET TO A CAPPED 1/2 INCH IRON ROD SET STAMPED "CBD SETSTONE", FOR CORNER,
- 17) N02°59'59"W, A DISTANCE OF 127.63 FEET TO A CAPPED 1/2 INCH IRON ROD SET STAMPED "CBD SETSTONE", FOR CORNER,
- 18) N10°19'21"E, A DISTANCE OF 122.92 FEET TO A CAPPED 1/2 INCH IRON ROD SET STAMPED "CBD SETSTONE", FOR CORNER,
- 19) N19°28'55"E, A DISTANCE OF 106.70 FEET TO A CAPPED 1/2 INCH IRON ROD SET STAMPED "CBD SETSTONE", FOR CORNER,
- 20) N19°53'14"E, A DISTANCE OF 460.00 FEET TO A CAPPED 1/2 INCH IRON ROD SET STAMPED "CBD SETSTONE", FOR CORNER,
- 21) N07°09'37"W, A DISTANCE OF 56.14 FEET TO A CAPPED 1/2 INCH IRON ROD SET STAMPED "CBD SETSTONE", FOR CORNER,
- 22) N70°06'46"W, A DISTANCE OF 59.74 FEET TO A CAPPED 1/2 INCH IRON ROD SET STAMPED "CBD SETSTONE", FOR CORNER, AND
- 23) N48°43'59"E, A DISTANCE OF 331.24 FEET TO A CAPPED 1/2 INCH IRON ROD SET STAMPED "CBD SETSTONE" ON THE SOUTH LINE OF SAID SANTA RITA RANCH PHASE 5, SECTION 2, BEING THE SOUTH LINE OF SAID LYNFIELD LANE, FOR THE NORTHWEST CORNER OF THE HEREIN DESCRIBED TRACT OF LAND,

THENCE, S63°15'58"E, WITH THE SOUTH LINE OF SAID SANTA RITA RANCH PHASE 5, SECTION 2, BEING THE SOUTH LINE OF SAID LYNFIELD LANE, A DISTANCE OF 75.92 FEET TO THE POINT OF BEGINNING, AND CONTAINING 17.534 ACRES OF LAND.



Carlson, Brigrance & Doering, Inc.

FIRM ID #F3791 REG. # 10024900

Civil Engineering
5501 West William Cannon
Phone No. (512) 280-5160

Surveying
Austin, Texas 78749
Fax No. (512) 280-5165

J: \AC3D\5380\Survey\PLAT – SANTA RITA RANCH 5–3C

SANTA RITA RANCH PHASE 5, SECTION 3C FINAL PLAT

STATE OF TEXAS §
COUNTY OF WILLIAMSON §

I, JAMES EDWARD HORNE, VICE PRESIDENT, SANTA RITA KC, LLC, OWNER OF THAT CERTAIN CALLED 146.160 ACRE TRACT OF LAND CONVEYED IN DOCUMENT NUMBER 2021157281, OFFICIAL PUBLIC RECORDS, WILLIAMSON COUNTY, TEXAS, SITUATED IN THE GREENLEAF FISK SURVEY, ABSTRACT NUMBER 5, WILLIAMSON COUNTY, TEXAS, AS SHOWN HEREON, AND DO HEREBY SUBDIVIDE SAID 17.534 ACRE TRACT AS SHOWN HEREON, AND DO HEREBY CONSENT TO ALL PLAT NOTE REQUIREMENTS SHOWN HEREON, AND DO HEREBY FOREVER DEDICATE TO THE PUBLIC THE ROADS, ALLEYS, RIGHTS-OF-WAY, EASEMENTS AND PUBLIC PLACES SHOWN HEREON FOR SUCH PUBLIC PURPOSES AS WILLIAMSON COUNTY MAY DEEM APPROPRIATE AND DO HEREBY STATE THAT ALL PUBLIC ROADWAYS AND EASEMENTS AS SHOWN ON THIS PLAT ARE FREE OF LIENS. THIS SUBDIVISION IS TO BE KNOWN AS,

"SANTA RITA RANCH PHASE 5, SECTION 3C FINAL PLAT"

TO CERTIFY WHICH, WITNESS BY MY HAND THIS 31 DAY OF May, 20 23.

SANTA RITA KC, LLC.
A TEXAS LIMITED PARTNERSHIP

BY: MREM TEXAS MANAGER, LLC,
A DELAWARE LIMITED LIABILITY COMPANY, ITS MANAGER

BY: James Edward Horne
JAMES EDWARD HORNE, VICE PRESIDENT
1700 CROSS CREEK LANE, STE. 100
LIBERTY HILL, TX 78642

STATE OF TEXAS §
COUNTY OF WILLIAMSON §

BEFORE ME THE UNDERSIGNED AUTHORITY, ON THIS DAY PERSONALLY APPEARED JAMES EDWARD HORNE, KNOWN TO ME TO BE THE PERSON WHOSE NAME IS SUBSCRIBED TO THE FOREGOING INSTRUMENT OF WRITING, AND HE ACKNOWLEDGED TO ME THAT HE EXECUTED THE SAME FOR THE PURPOSES AND CONSIDERATION THEREIN EXPRESSED AND IN THE CAPACITY THEREIN STATED.

WITNESS MY HAND AND SEAL OF OFFICE, THIS THE 31 DAY OF May, 20 23 A.D.

Ashley Cuellar Sousa
NOTARY PUBLIC IN AND FOR WILLIAMSON COUNTY, TEXAS

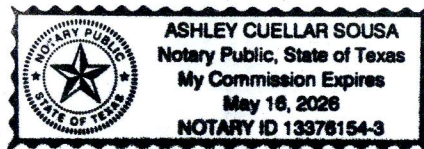

CONSENT OF MORTGAGEE

THE UNDERSIGNED, BEING THE SOLE OWNER AND HOLDER OF TWO DEED OF TRUST LIENS SECURED BY THE PROPERTY, THE FIRST DATED OCTOBER 31, 2013 RECORDED AS DOCUMENT NO. 2013103003 IN THE OFFICIAL PUBLIC RECORDS OF WILLIAMSON COUNTY, TEXAS, SECURING A NOTE OF EVEN DATE THEREWITH, AND THE SECOND DATED JANUARY 31, 2018 RECORDED AS DOCUMENT NO. 2018009177, SECURING A NOTE OF EVEN DATE THEREWITH, EXECUTES THIS DECLARATION SOLELY FOR THE PURPOSES OF EVIDENCING ITS CONSENT TO THE TERMS AND PROVISIONS HEREOF.

INTERNATIONAL BANK OF COMMERCE,
A TEXAS BANKING ASSOCIATION

BY: Jason Rangel
PRINTED NAME: Jason Rangel
TITLE: SENIOR VICE PRESIDENT

STATE OF TEXAS
COUNTY OF Travis

BEFORE ME ON THIS DAY PERSONALLY APPEARED Jason Rangel, KNOWN TO ME TO BE THE PERSON WHOSE NAME IS SUBSCRIBED TO THE FOREGOING INSTRUMENT AND ACKNOWLEDGED TO ME THAT HE EXECUTED THE SAME FOR THE PURPOSES AND CONSIDERATION THEREIN EXPRESSED.

GIVEN UNDER MY HAND AND SEAL OF OFFICE THIS THE 31 DAY OF May, A.D., 20 23.

BY: Araceli Hernandez
NOTARY PUBLIC, STATE OF TEXAS

PRINTED NAME: Araceli Hernandez

MY COMMISSION EXPIRES 6-2-2024

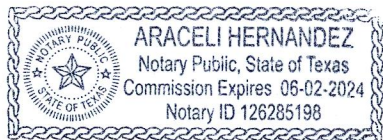

THE CITY OF LIBERTY HILL, TEXAS ACKNOWLEDGES RECEIPT OF THIS PLAT FOR REVIEW AND/OR APPROVAL IN CONJUNCTION WITH PLANNING PURPOSES AND PAYMENT OF APPLICABLE FEES FOR THE PROVISION OF WATER AND/OR WASTEWATER SERVICES.

JERRY L. MILLARD, JR. DIRECTOR OF PLANNING
CITY OF LIBERTY HILL, TEXAS

DATE

5-31-23

ROAD NAME AND ADDRESS ASSIGNMENTS VERIFIED THIS THE 31st DAY OF may, 20 23 A.D.

Teresa Baker
WILLIAMSON COUNTY ADDRESSING COORDINATOR
WILLIAMSON COUNTY, TEXAS

Teresa Baker
PRINTED NAME

STATE OF TEXAS:

COUNTY OF TRAVIS:

NO PORTION OF THIS TRACT IS WITHIN THE 100 YEAR FLOOD PLAIN AS SHOWN ON FLOOD INSURANCE RATE COMMUNITY PANEL #48491C0275E, EFFECTIVE SEPTEMBER 26, 2008 FOR WILLIAMSON COUNTY, TEXAS.

I, STEVEN P. CATES, P.E., AM AUTHORIZED UNDER THE LAWS OF THE STATE OF TEXAS, TO PRACTICE THE PROFESSION OF ENGINEERING, AND HEREBY CERTIFY THAT THIS SUBDIVISION PLAT COMPLIES WITH THE REQUIREMENTS OF WILLIAMSON COUNTY.

ENGINEERING BY: Steven P. Cates 5/31/2023
STEVEN P. CATES, P.E. NO. 93648
CARLSON, BRIGANCE & DOERING, INC.
5501 WEST WILLIAM CANNON DRIVE,
AUSTIN, TEXAS 78749

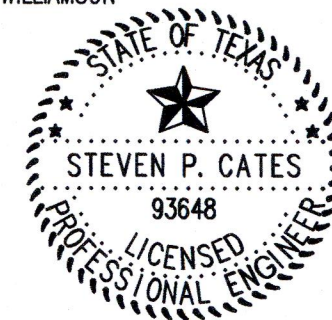

CARLSON, BRIGANCE, & DOERING, INC.
ID # F3791

THIS FLOOD STATEMENT, AS DETERMINED BY A H.U.D.-F.I.A. FLOOD INSURANCE RATE MAP, DOES NOT IMPLY THAT THE PROPERTY OR THE IMPROVEMENTS THEREON WILL BE FREE FROM FLOODING OR FLOOD DAMAGE. ON RARE OCCASIONS, GREATER FLOODS CAN AND WILL OCCUR, AND FLOOD HEIGHTS MAY INCREASE BY MAN-MADE OR NATURAL CAUSES.

THIS STATEMENT SHALL NOT CREATE LIABILITY ON THE PART OF ENGINEER OR SURVEYOR.

STATE OF TEXAS:

COUNTY OF TRAVIS:

I, AARON V. THOMASON, R.P.L.S., AM AUTHORIZED UNDER THE LAWS OF THE STATE OF TEXAS, TO PRACTICE THE PROFESSION OF SURVEYING, AND HEREBY CERTIFY THAT THIS SUBDIVISION PLAT COMPLIES WITH THE WILLIAMSON COUNTY SUBDIVISION ORDINANCE. ALL EASEMENTS-OF RECORD ARE SHOWN OR NOTED ON THE PLAT.

SURVEYED BY: Aaron V. Thomason 31 MAY 2023
AARON V. THOMASON, R.P.L.S. NO. 6214
CARLSON, BRIGANCE & DOERING, INC.
5501 WEST WILLIAM CANNON DRIVE,
AUSTIN, TEXAS 78749
aaron@cbdeng.com

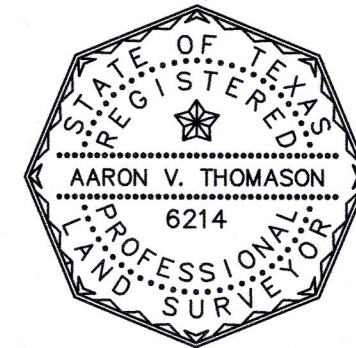

STATE OF TEXAS §
COUNTY OF WILLIAMSON §

STATE OF TEXAS
COUNTY OF WILLIAMSON

KNOW ALL MEN BY THESE PRESENTS;

I, BILL GRAVELL JR., COUNTY JUDGE OF WILLIAMSON COUNTY, TEXAS, DO HEREBY CERTIFY THAT THIS MAP OR PLAT, WITH FIELD NOTES HEREON, FOR A SUBDIVISION HAVING BEEN FULLY PRESENTED TO THE COMMISSIONERS COURT OF WILLIAMSON COUNTY, TEXAS, AND BY THE SAID COURT DULY CONSIDERED, WERE ON THIS DAY APPROVED AND THAT THIS PLAT IS AUTHORIZED TO BE REGISTERED AND RECORDED IN THE PROPER RECORDS OF THE COUNTY CLERK OF WILLIAMSON COUNTY, TEXAS.

BILL GRAVELL JR., COUNTY JUDGE
WILLIAMSON COUNTY, TEXAS

STATE OF TEXAS §
COUNTY OF WILLIAMSON §

I, NANCY RISTER, CLERK OF THE COUNTY COURT OF SAID COUNTY, DO HEREBY CERTIFY THAT THE FOREGOING INSTRUMENT IN WRITING, WITH ITS CERTIFICATE OF AUTHENTICATION WAS FILED FOR RECORD IN MY OFFICE ON THE _____ DAY OF _____, 20____ A.D., AT _____ O'CLOCK, ____M., AND DULY RECORDED THIS THE _____ DAY OF _____, 20____ A.D., AT _____ O'CLOCK, ____M. IN THE OFFICIAL PUBLIC RECORDS OF SAID COUNTY IN INSTRUMENT NO. _____.

TO CERTIFY WHICH, WITNESS MY HAND AND SEAL AT THE COUNTY COURT OF SAID COUNTY, AT MY OFFICE IN GEORGETOWN, TEXAS, THE DATE LAST SHOWN ABOVE WRITTEN.

NANCY RISTER, CLERK COUNTY COURT
OF WILLIAMSON COUNTY, TEXAS

BY: _____, DEPUTY

SHEET NO. 4 OF 4



Carlson, Brigance & Doering, Inc.

FIRM ID #F3791 REG. # 10024900

Civil Engineering Surveying
5501 West William Cannon Austin, Texas 78749
Phone No. (512) 280-5160 Fax No. (512) 280-5165

J:\AC3D\5380\Survey\PLAT - SANTA RITA RANCH 5-3C