

WILLIAMSON COUNTY, TEXAS

CHANGE ORDER NUMBER: 2

1. CONTRACTOR: Joe Bland Construction
2. Change Order Work Limits: Sta. 17+25 to Sta. 21+25
3. Type of Change (on federal-aid non-exempt projects): Minor (Major/Minor)
4. Reasons: 2I (3 Max. - In order of importance - Primary first)

Project: 22IFB110
 Roadway: SW Bypass Extension
 CSJ Number: _____

5. Describe the work being revised:

2. Differing Site Conditions (unforeseeable) 2I. Additional safety needs (unforeseeable): This Change Order compensates the contractor for adjusting the guardrail north of Wolf Ranch Parkway on Southwest Bypass due to sight distance concerns.

6. Work to be performed in accordance with Items: See attached
7. New or revised plan sheet(s) are attached and numbered: 74
8. New Special Provisions/Specifications to the contract are attached: ☐ Yes ☒ No
9. New Special Provisions to Item N/A No. N/A, Special Specification Item N/A are attached.

Each signatory hereby warrants that each has the authority to execute this Change Order (CO).

The contractor must sign the Change Order and, by doing so, agrees to waive any and all claims for additional compensation due to any and all other expenses; additional changes for time, overhead and profit; or loss of compensation as a result of this change.

THE CONTRACTOR Date 8/30/2023

By Kyle Klusmann

Typed/Printed Name Kyle Klusmann

Typed/Printed Title Project Manager

The following information must be provided

Time Ext. #: 2 Days added on this CO: 22

Amount added by this change order: \$15,802.83

RECOMMENDED FOR EXECUTION:

[Signature] 8/30/2023
 Project Manager Date

N/A
 Design Engineer Date

Christen Eschberger 9/1/2023
 Program Manager Date

Design Engineer's Seal:

County Commissioner Precinct 1 Date
☐ APPROVED ☐ REQUEST APPROVAL

County Commissioner Precinct 2 Date
☐ APPROVED ☐ REQUEST APPROVAL

County Commissioner Precinct 3 Date
☐ APPROVED ☐ REQUEST APPROVAL

County Commissioner Precinct 4 Date
☐ APPROVED ☐ REQUEST APPROVAL

County Judge Date
☐ APPROVED

WILLIAMSON COUNTY, TEXAS

CHANGE ORDER NUMBER: 2

Project # 22IFB110

TABLE A: Force Account Work and Materials Placed into Stock

	LABOR	HOURLY RATE			HOURLY RATE

TABLE B: Contract Items:

				ORIGINAL + PREVIOUSLY REVISED		ADD or (DEDUCT)	NEW		
ITEM	DESCRIPTION	UNIT	UNIT PRICE	QUANTITY	ITEM COST	QUANTITY	QUANTITY	ITEM COST	OVERRUN/ UNDERRUN
104-6054	REMOVING CONCRETE(MOW STRIP)	SY	\$12.57	0.00	\$0.00	92.00	92.00	\$1,156.44	\$1,156.44
160-WC01	FURN AND PLAC TOPSOIL	SY	\$4.67	0.00	\$0.00	92.00	92.00	\$429.64	\$429.64
164-WC05	SEEDING FOR EROSION CONTROL (TY5)(PERM)	SY	\$1.00	36,796.00	\$36,796.00	92.00	36,888.00	\$36,888.00	\$92.00
164-WC10	SEEDING FOR EROSION CONTROL (TY10)(TEMP)	SY	\$1.00	21,617.00	\$21,617.00	92.00	21,709.00	\$21,709.00	\$92.00
169-6001	SOIL RETENTION BLANKETS (CL 1) (TY A)	SY	\$2.00	23,585.00	\$47,170.00	92.00	23,677.00	\$47,354.00	\$184.00
432-6045	RIPRAP (MOW STRIP) (4IN)	CY	\$550.00	41.10	\$22,605.00	2.10	43.20	\$23,760.00	\$1,155.00
500-WC01	MOBILIZATION	LS	\$5,000.00	0.00	\$0.00	1.00	1.00	\$5,000.00	\$5,000.00
502-WC01	TRAFFIC CONTROL	LS	\$5,000.00	0.00	\$0.00	1.00	1.00	\$5,000.00	\$5,000.00
542-6001	REMOVE METAL BEAM GUARD FENCE	LF	\$10.45	0.00	\$0.00	175.00	175.00	\$1,828.75	\$1,828.75
544-6002	GUARDRAIL END TREATMENT (MOVE & RESET)	EA	\$865.00	0.00	\$0.00	1.00	1.00	\$865.00	\$865.00
TOTALS					\$128,188.00			\$143,990.83	\$15,802.83

CHANGE ORDER REASON(S) CODE CHART

1. Design Error or Omission	1A. Incorrect PS&E 1B. Other
2. Differing Site Conditions (unforeseeable)	2A. Dispute resolution (expense caused by conditions and/or resulting delay) 2B. Unavailable material 2C. New development (conditions changing after PS&E completed) 2D. Environmental remediation 2E. Miscellaneous difference in site conditions (unforeseeable)(Item 9) 2F. Site conditions altered by an act of nature 2G. Unadjusted utility (unforeseeable) 2H. Unacquired Right-of-Way (unforeseeable) 2I. Additional safety needs (unforeseeable) 2J. Other
3. County Convenience	3A. Dispute resolution (not resulting from error in plans or differing site conditions) 3B. Public relations improvement 3C. Implementation of a Value Engineering finding 3D. Achievement of an early project completion 3E. Reduction of future maintenance 3F. Additional work desired by the County 3G. Compliance requirements of new laws and/or policies 3H. Cost savings opportunity discovered during construction 3I. Implementation of improved technology or better process 3J. Price adjustment on finished work (price reduced in exchange for acceptance) 3K. Addition of stock account or material supplied by state provision 3L. Revising safety work/measures desired by the County 3M. Other
4. Third Party Accommodation	4A. Failure of a third party to meet commitment 4B. Third party requested work 4C. Compliance requirements of new laws and/or policies (impacting third party) 4D. Other
5. Contractor Convenience	5A. Contractor exercises option to change the traffic control plan 5B. Contractor requested change in the sequence and/or method of work 5C. Payment for Partnering workshop 5D. Additional safety work/measures desired by the contractor 5E. Other
6. Untimely ROW/Utilities	6A. Right-of-Way not clear (third party responsibility for ROW) 6B. Right-of-Way not clear (County responsibility for ROW) 6C. Utilities not clear 6D. Other

Williamson County Road Bond Program

Southwest Bypass Extension Williamson County Project No. 22IFB110

Change Order No. 2 Reason for Change

This Change Order compensates the Contractor for addressing a safety concern to the traveling public, regarding a guardrail in the clear zone of the roadway. The guardrail located just north of Wolf Ranch Parkway on Southwest Bypass was obstructing the view for the westbound Wolf Ranch Parkway traffic looking north on Southwest Bypass. The guardrail was shortened to address the sight distance issue.

This Change Order also adds an additional twenty-two days to the contract for utility conflicts with opening the roadway.

The following new items will be added by this Change Order.

ITEM	DESCRIPTION	QTY	UNIT
104-6054	REMOVING CONCRETE(MOW STRIP)	92	SY
160-WC01	FURN AND PLACE TOPSOIL	92	SY
500-WC01	MOBILIZATION	1	LS
502-WC01	TRAFFIC CONTROL	1	LS
542-6001	REMOVE METAL BEAM GUARD FENCE	175	LF
544-6002	GUARDRAIL END TREATMENT (MOVE & RESET)	1	EA

This Change Order results in a net increase of \$15,802.83 to the Contract amount, for an adjusted Contract total of \$4,307,786.72. The original Contract amount was \$4,288,543.00. As a result of this and all Change Orders to-date, \$19,243.72 has been added to the Contract, resulting in a .45% net increase in the overall Contract cost. As a result of this Change Order, twenty-two (22) days will be added to the contract.

HNTB Corporation

Oscar Salazar-Bueno, P.E.

Change Order #2 quantities and prices.

544-6002 Remove and Reset GET Section 1EA - ~~\$865.00~~. (This is based off of TxDOT bid averages)
542-6001 Remove MBGF – 175 LF at \$10.45 = ~~\$1,828.75~~ (This is base off of TxDOT bid averages)
432-6045 Riprap (Mow Strip) (4in) – 2.1 CY at \$550.00 = ~~\$\$1,155.00~~ (Existing bid price)
104-6054 Remove Conc (Mow Strip) – 92 SY at \$12.57 = ~~\$1,156.44~~ (This is based off of TxDOT bid averages)
160-WC01 Furn and Plac Topsoil – 92 SY at \$4.67 = ~~\$429.64~~ (This is based off of TxDOT bid averages)
164-WC05 Perm Warm Seed – 92 SY at \$1.00 = ~~\$92.00~~ (Existing bid prices)
164-WC10 Temp Warm Seed – 92 SY at \$1.00 = ~~\$92.00~~ (Existing bid prices)
169-6001 Soil Blanket – 92 SY at \$2.00 = ~~\$184.00~~ (Existing bid prices)
Traffic Control – 5 Days (Shoulder closure, Water barrier, Flaggers) – 1 LS = ~~\$5,000.00~~
Mobilization – (Sub and Prime) - 1 LS = ~~\$5,000.00~~

Grand total: ~~\$15,802.83~~

CURVE SWB_1	
PI STATION	= 21+40.75
DELTA	= 5° 11' 22.45" (RT)
DEGREE OF CURVE	= 0° 57' 17.75"
TANGENT	= 271.91
LENGTH	= 543.45
RADIUS	= 6,000.00
PC STATION	= 18+68.84
PT STATION	= 24+12.29

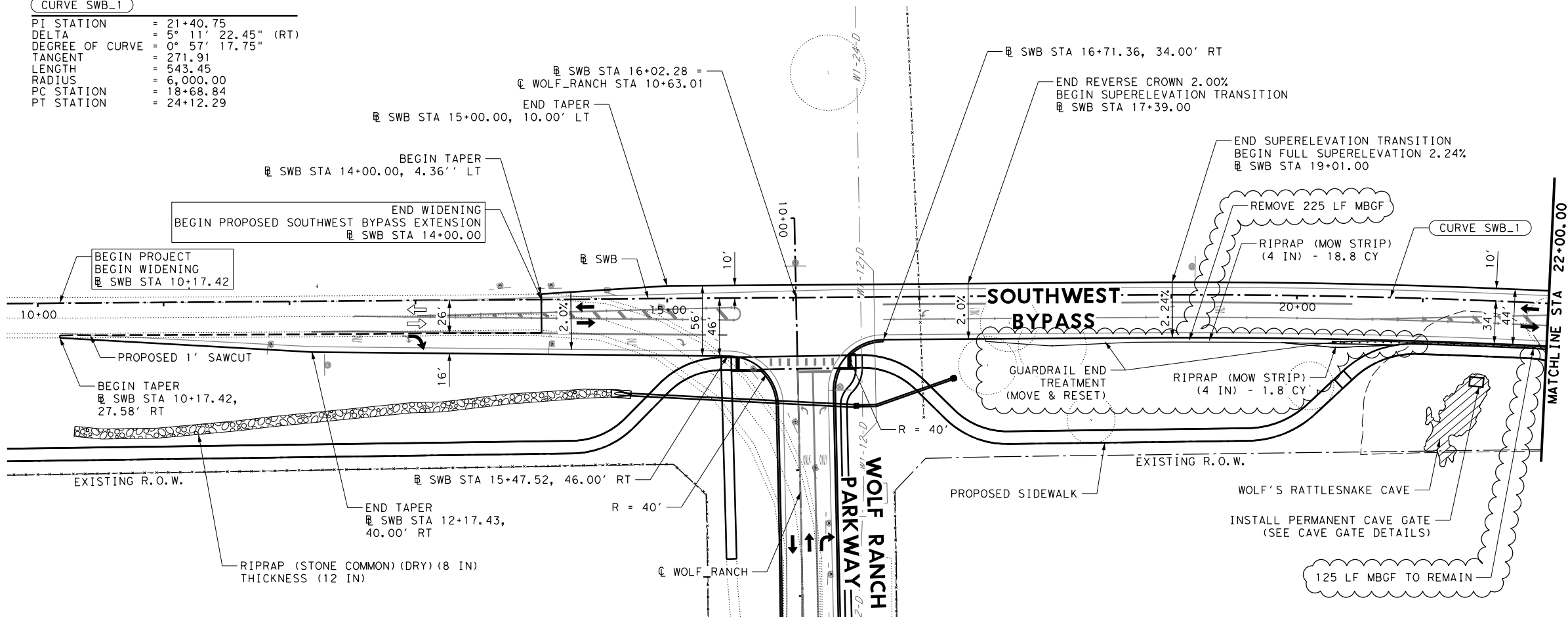

LEGEND	
	EXISTING R.O.W.
	EXISTING UTILITY
	EXISTING PLANIMETRICS
	CURVE DATA
	KARST CAVE
	CONC DIRECTIONAL ISLAND
	EXISTING TRAFFIC ARROW
	PROPOSED TRAFFIC ARROW

- NOTES:
1. ALL DIMENSIONS ARE TO EDGE OF PAVEMENT UNLESS OTHERWISE STATED.
 2. REFER TO HORIZONTAL ALIGNMENT DATA SHEET FOR SUPERELEVATION DATA.
 3. SEE DRIVEWAY SUMMARY TABLE FOR MORE INFORMATION.
 4. SEE INTERSECTION GRADING DETAIL SHEET 1 OF 2 FOR MORE INFORMATION.
 5. SEE PROPOSED SIDEWALK SHEETS FOR MORE INFORMATION.

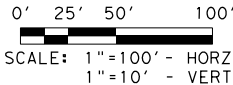

WOLF RANCH PARKWAY

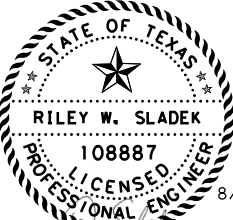
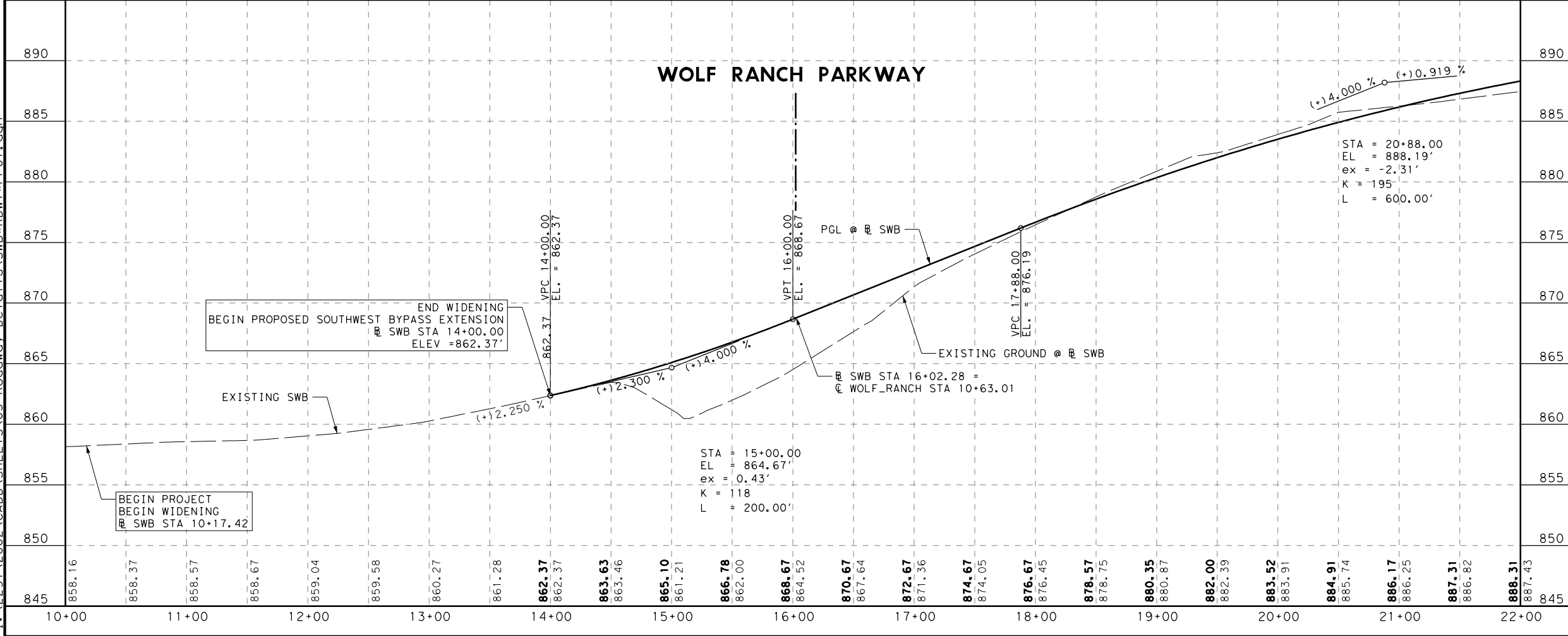

SOUTHWEST BYPASS EXTENSION
ROADWAY PLAN & PROFILE

BEGIN TO STA 22+00
SCALE HORIZONTAL: 1" = 100'
SHEET 1 OF 3

DESIGN	FED. RD. DIV. NO.	FEDERAL AID PROJECT NO.		SHEET NO.
MD	6			74
DRAWN	STATE	DIST. NO.	COUNTY	
MD	TX	AUS	WILLIAMSON	
CHECK	CONTROL	SECTION	JOB	HIGHWAY NO.
RS	0337	01	049	SWB