

**SUPPLEMENTAL WORK AUTHORIZATION NO. 04**  
**TO**  
**WORK AUTHORIZATION NO. 01**

**WILLIAMSON COUNTY ROAD BOND PROJECT:**  
**Ronald Reagan Boulevard Segment C1**  
**Ronald Reagan Boulevard Segment C2**  
**Ronald Reagan Boulevard Segment D1**

This Supplemental Work Authorization No. 04 to Work Authorization No. 01 is made pursuant to the terms and conditions of the Williamson County Contract for Surveying Services, being dated May 9, 2024 ("Contract") and entered into by and between Williamson County, Texas, a political subdivision of the State of Texas, (the "County") and **Landesign Services, Inc.** (the "Surveyor").

WHEREAS, the County and the Surveyor executed Work Authorization No. 01 dated effective May 31, 2024 (the "Work Authorization");

WHEREAS, pursuant to Article 14 of the Contract, amendments, changes and modifications to a fully executed Work Authorization shall be made in the form of a Supplemental Work Authorization; and

WHEREAS, it has become necessary to amend, change and modify the Work Authorization.

**AGREEMENT**

NOW, THEREFORE, premises considered, the County and the Surveyor agree that the Work Authorization shall be amended, changed and modified as follows:

- I. The Services to be Provided by the Surveyor that were set out in the original Attachment "B" of the Work Authorization are hereby amended, changed and modified as shown in the attached revised Attachment "B" (must be attached).
- II. The Work Authorization shall terminate on **December 31, 2026**. The Services to be Provided by the Surveyor shall be fully completed on or before said date unless extended by an additional Supplemental Work Authorization. The revised Work Schedule is attached hereto as Attachment "C" (must be attached).
- III. The maximum amount payable for services under the Work Authorization is hereby increased by **\$27,855.00** from \$267,984.00 to **\$295,839.00**. The revised Fee Schedule is attached hereto as Attachment "D" (must be attached).

Except as otherwise amended by prior or future Supplemental Work Authorizations, all other terms of the Work Authorization are unchanged and will remain in full force and effect.

This Supplemental Work Authorization does not waive the parties' responsibilities and obligations provided under the Contract.

**IN WITNESS WHEREOF**, the County and the Engineer have executed this Supplemental Work Authorization, in duplicate, to be effective as of the date of the last party's execution below.

**SURVEYOR:**

**Landesign Services, Inc.**

By: Brandy Tabor  
Signature

Brandy Tabor  
Printed Name

President  
Title

November 5, 2025  
Date

**COUNTY:**

**Williamson County, Texas**

By: \_\_\_\_\_  
Signature

\_\_\_\_\_  
Printed Name

\_\_\_\_\_  
Title

\_\_\_\_\_  
Date

LIST OF ATTACHMENTS

Attachment B - Services to be Provided by Surveyor

Attachment C - Work Schedule

Attachment D - Fee Schedule

**APPROVED**

*By Christen Eschberger at 10:22 am, Nov 10, 2025*

# ATTACHMENT B SERVICES TO BE PROVIDED BY THE SURVEYOR FOR

## WILLIAMSON COUNTY ROAD BOND PROJECT:

Ronald Reagan Boulevard Segment C1

Ronald Reagan Boulevard Segment C2

Ronald Reagan Boulevard Segment D1

### PROJECT AMENDMENT

#### 1. RIGHT-OF-WAY (ROW) MAPPING

##### a. Field Survey

- Surveyor will locate existing control (if available and provided) and reconcile any discrepancies found.
- Surveyor will establish supplemental survey control as needed to be used during the course of the survey.
- Surveyor will locate boundary monuments sufficient to determine existing right-of-way lines and parcel boundaries.
- Stake existing right of way and proposed edge of pavement with above-ground wooden lathe stakes/markers, set at 50' intervals along curves and 100' intervals along straight-aways, for approx. 3000 linear feet, on the northside of Ronald Reagan Boulevard, from approx. Station 939+00, east of Somerset Hills Drive, moving east to approx. Station 969+00.

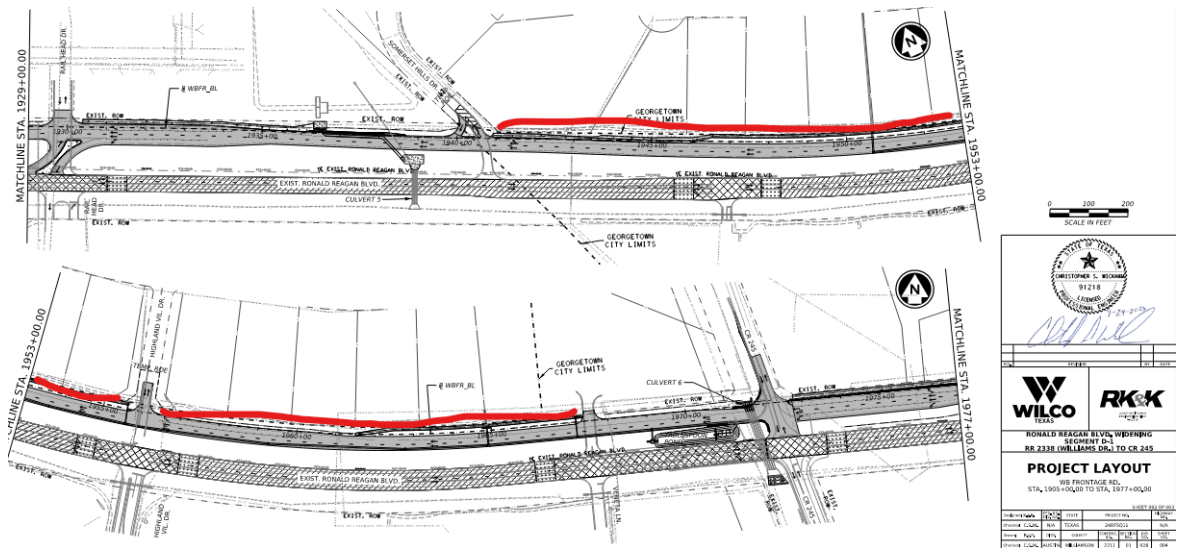

##### b. Deliverables:

- Photos of staking performance

Prime Provider Name: Landesign Services, Inc.	2025				2026											
Tasks	Sept.	Oct.	Nov.	Dec.	Jan.	Feb.	Mar.	Apr.	May	June	July	Aug.	Sept.	Oct.	Nov.	Dec.
Locate Control / Secondary Control																
Locate Boundary																
Stake ROW & Proposed Pavement																
QA/QC																
Continued - set ROW Monumentation																
WA Termination Date: December 31, 2026																

**WA01 - Road Bond = ROW Monumentation and Field ROW / Pavement Staking**

Prime Provider Name: Landesign Services, Inc.

TASK DESCRIPTION	PROJECT MANAGER (RPLS)	STAFF SURVEYOR (RPLS)	SENIOR SURVEY TECH	SURVEY TECH	GIS TECH	ABTRACTOR	CLERICAL	DELIVERY	3-PERSON SURVEY CREW	2-PERSON SURVEY CREW	1-PERSON SURVEY CREW	TOTAL LABOR HRS. & COSTS
<b>Right-of-Way Mapping</b>												
Locate Control / Secondary Control	1	2	4	2	0	0	2	0	0	6	0	\$2,350.00
Locate Boundary	2	5	12	24	0	0	3	0	0	32	0	\$10,805.00
Stake ROW & Proposed Pavement	1	5	10	24	0	0	3	0	0	45	0	\$12,810.00
QA/QC	2	4	4	4	0	0	2	0	0	0	0	\$1,890.00
<b>FC 130 - Direct Labor Subtotal</b>	<b>6</b>	<b>16</b>	<b>30</b>	<b>54</b>	<b>0</b>	<b>0</b>	<b>10</b>	<b>0</b>	<b>0</b>	<b>83</b>	<b>0</b>	<b>\$27,855.00</b>
<b>FC 130 SUB-TOTALS</b>	<b>6</b>	<b>16</b>	<b>30</b>	<b>54</b>	<b>0</b>	<b>0</b>	<b>10</b>	<b>0</b>	<b>0</b>	<b>83</b>	<b>0</b>	<b>\$27,855.00</b>
HOURS SUB-TOTALS	6	16	30	54	0	0	10	0	0	83	0	199
<b>CONTRACT RATE</b>	<b>\$180.00</b>	<b>\$140.00</b>	<b>\$110.00</b>	<b>\$95.00</b>	<b>\$85.00</b>	<b>\$75.00</b>	<b>\$75.00</b>	<b>\$50.00</b>	<b>\$220.00</b>	<b>\$185.00</b>	<b>\$140.00</b>	
	\$1,080.00	\$2,240.00	\$3,300.00	\$5,130.00	\$0.00	\$0.00	\$750.00	\$0.00	\$0.00	\$15,355.00	\$0.00	\$27,855.00

SUMMARY		
DIRECT LABOR		\$27,855.00
UNIT COST		\$0.00
<b>Total Landesign Survey (WA#01, SWA#4)</b>		<b>\$27,855.00</b>

Work Authorization #01 Summary	Date	Authorized Amount
WA#01 - Maximum Amount Payable	5/31/2024	\$168,634.00
WA#01, SWA#01 - Time Extension	10/4/2023	N/A
WA#01, SWA#02 - Time Extension	3/4/2025	N/A
WA#01, SWA#03 - Maximum Amount Payable	8/4/2025	\$99,350.00
WA#01, SWA#04 - Maximum Amount Payable		\$27,855.00
Total		\$295,839.00