

REAL ESTATE CONTRACT

SH 195 Right of Way

State of Texas
County of Williamson

THIS REAL ESTATE CONTRACT ("Contract") is made by and between MARION K. SHIPMAN (referred to in this Contract as "Seller", whether one or more) and the COUNTY OF WILLIAMSON (referred to in this Contract as "Purchaser"), upon the terms and conditions set forth in this Contract.

ARTICLE I PURCHASE AND SALE

By this Contract, Seller sells and agrees to convey, and Purchaser purchases and agrees to pay for, the tract(s) of land described as follows:

All of that certain tract of land containing a total of 3.987 acres, more or less, situated in the W. Roberts Survey, Abstract No. 524, in Williamson County, Texas, being more fully described by metes and bounds in Exhibit "A", attached hereto and incorporated herein (**Parcel 116B**);

together with all and singular the rights and appurtenances pertaining to the property, including any right, title and interest of Seller in and to adjacent streets, alleys or rights-of-way (all of such real property, rights, and appurtenances being referred to in this Contract as the "Property"), and any improvements and fixtures situated on and attached to the Property described in Exhibit "A", for the consideration and upon and subject to the terms, provisions, and conditions set forth below.

ARTICLE II PURCHASE PRICE

Purchase Price

2.01. The purchase price for the Property described in Exhibit "A", the acquisition of any improvements on the Property or for the relocation of any fencing to the new boundary of the Property and for and damages or reconfiguration to the remaining property of Seller shall be the sum of SEVEN HUNDRED SIXTY FIVE THOUSAND FOUR HUNDRED SEVENTY THREE and 00/100 Dollars (\$765,473.00).

As consideration for the execution of certain Possession and Use Agreements between the parties recorded in Document No. 2010049276 of the Real Property Records of Williamson County, Texas, Purchaser has previously paid to Seller the amount of \$516,716.00, which amounts were specifically agreed to be credited or offset against any final purchase price or condemnation acquisition payment. **Therefore, the remaining balance of the Purchase Price now due and owing from the Purchaser for this Contract is TWO HUNDRED FORTY EIGHT THOUSAND SEVEN HUNDRED FIFTY SEVEN AND 00/100 Dollars (\$248,757.00).**

Payment of Purchase Price

2.02. The Purchase Price shall be payable in cash at the Closing.

**ARTICLE III
PURCHASER'S OBLIGATIONS**

Conditions to Purchaser's Obligations

3.01. The obligations of Purchaser hereunder to consummate the transactions contemplated hereby are subject to the satisfaction of each of the following conditions (any of which may be waived in whole or in part by Purchaser at or prior to the Closing).

Miscellaneous Conditions

3.02. Seller shall have performed, observed, and complied with all of the covenants, agreements, and conditions required by this Contract to be performed, observed, and complied with by Seller prior to or as of the closing.

**ARTICLE IV
REPRESENTATIONS AND WARRANTIES
OF SELLER**

Seller hereby represents and warrants to Purchaser as follows, which representations and warranties shall be deemed made by Seller to Purchaser also as of the closing date, to the best of Seller's knowledge:

- (1) There are no parties in possession of any portion of the Property as lessees, tenants at sufferance, or trespassers, other than previously disclosed to Purchaser;
- (2) Seller has complied with all applicable laws, ordinances, regulations, statutes, rules and restrictions relating to the Property, or any part thereof;

The Property herein is being conveyed to Purchaser under threat of condemnation.

ARTICLE V CLOSING

Closing Date

5.01. The Closing shall be held at the office of Texas American Title Company on or before October 19, 2012, or at such time, date, and place as Seller and Purchaser may agree upon, or within 10 days after the completion of any title curative matters if necessary for items as shown on the Title Commitment or in the contract (which date is herein referred to as the "Closing Date").

Seller's Obligations at Closing

5.02. At the Closing Seller shall:

(1) Deliver to the State of Texas a duly executed and acknowledged Special Warranty Deed conveying good and indefeasible title in fee simple to all of the Property described in Exhibit "A", free and clear of any and all liens and restrictions, except for the following:

- (a) General real estate taxes for the year of closing and subsequent years not yet due and payable;
- (b) Any exceptions approved by Purchaser pursuant to Article III hereof; and
- (c) Any exceptions approved by Purchaser in writing.

The deed shall be in the form as shown in Exhibit "B" attached hereto.

(2) Deliver to Purchaser a Texas Owner's Title Policy at Purchaser's sole expense, issued by Title Company, in Purchaser's favor in the full amount of the Purchase Price, insuring Grantee's fee simple interest in and to the Property subject only to those title exceptions listed herein, such other exceptions as may be approved in writing by Purchaser, and the standard printed exceptions contained in the usual form of Texas Owner's Title Policy, provided, however:

- (a) The boundary and survey exceptions shall be deleted;
- (b) The exception as to restrictive covenants shall be endorsed "None of Record", if applicable; and

- (c) The exception as to the lien for taxes shall be limited to the year of closing and shall be endorsed "Not Yet Due and Payable".
- (3) Deliver to Purchaser possession of the Property if not previously done.

Purchaser's Obligations at Closing

5.03. At the Closing, Purchaser shall:

- (a) Pay the cash portion of the Purchase Price.

Prorations

5.04. General real estate taxes for the then current year relating to the Property shall be prorated as of the Closing Date and shall be adjusted in cash at the closing. If the closing shall occur before the tax rate is fixed for the then current year, the apportionment of taxes shall be upon the basis of the tax rate for the next preceding year applied to the latest assessed valuation. Agricultural roll-back taxes, if any, shall be paid by Purchaser.

Closing Costs

5.05. All costs and expenses of closing in consummating the sale and purchase of the Property shall be borne and paid as follows:

- (1) Owner's Title Policy and survey to be paid by Purchaser.
- (2) Deed, tax certificates, and title curative matters, if any, paid by Purchaser.
- (3) All other closing costs shall be paid by Purchaser.
- (4) Attorney's fees paid by each respectively.

**ARTICLE VI
BREACH BY SELLER**

In the event Seller shall fail to fully and timely perform any of its obligations hereunder or shall fail to consummate the sale of the Property for any reason, except Purchaser's default, Purchaser may: (1) enforce specific performance of this Contract; or (2) request that the Escrow Deposit, if any, shall be forthwith returned by the title company to Purchaser.

ARTICLE VII BREACH BY PURCHASER

In the event Purchaser should fail to consummate the purchase of the Property, the conditions to Purchaser's obligations set forth in Article III having been satisfied and Purchaser being in default and Seller not being in default hereunder, Seller shall have the right to receive the Escrow Deposit, if any, from the title company, the sum being agreed on as liquidated damages for the failure of Purchaser to perform the duties, liabilities, and obligations imposed upon it by the terms and provisions of this Contract, and Seller agrees to accept and take this cash payment as its total damages and relief and as Seller's sole remedy hereunder in such event. If no Escrow Deposit has been made then Seller shall receive the amount of \$500 as liquidated damages for any failure by Purchaser.

ARTICLE VIII MISCELLANEOUS

Notice

8.01. Any notice required or permitted to be delivered hereunder shall be deemed received when sent by United States mail, postage prepaid, certified mail, return receipt requested, addressed to Seller or Purchaser, as the case may be, at the address set forth opposite the signature of the party.

Texas Law to Apply

8.02. This Contract shall be construed under and in accordance with the laws of the State of Texas, and all obligations of the parties created hereunder are performable in Williamson County, Texas.

Parties Bound

8.03. This Contract shall be binding upon and inure to the benefit of the parties and their respective heirs, executors, administrators, legal representatives, successors and assigns where permitted by this Contract.

Legal Construction

8.04. In case any one or more of the provisions contained in this Contract shall for any reason be held to be invalid, illegal, or unenforceable in any respect, this invalidity, illegality, or unenforceability shall not affect any other provision hereof, and this Contract shall be construed as if the invalid, illegal, or unenforceable provision had never been contained herein.

Prior Agreements Superseded

8.05. This Contract constitutes the sole and only agreement of the parties and supersedes any prior understandings or written or oral agreements between the parties respecting the within subject matter.

Time of Essence

8.06. Time is of the essence in this Contract.

Gender

8.07. Words of any gender used in this Contract shall be held and construed to include any other gender, and words in the singular number shall be held to include the plural, and vice versa, unless the context requires otherwise.

Memorandum of Contract

8.08. Upon request of either party, the parties shall promptly execute a memorandum of this Contract suitable for filing of record.

Compliance

8.09 In accordance with the requirements of Section 20 of the Texas Real Estate License Act, Purchaser is hereby advised that it should be furnished with or obtain a policy of title insurance or Purchaser should have the abstract covering the Property examined by an attorney of Purchaser's own selection.

Effective Date

8.10 This Contract shall be effective as of the date it is approved by the Williamson County Commissioner's Court, which date is indicated beneath the Judge's signature below.

Counterparts

8.11 This Contract may be executed in any number of counterparts, which may together constitute the Contract. Signatures transmitted by facsimile or electronic mail may be considered effective as originals for purposes of this Contract.

[signature page follows]

SELLER:

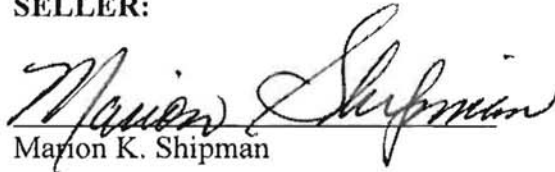
Marion K. Shipman

Date: 9-21-2012

Address: _____

PURCHASER:

COUNTY OF WILLIAMSON

By: _____

Dan A. Gaffis, County Judge

Date: 10-05-2012

Address: 710 Main Street
Suite 101

Georgetown, Texas 78626

EXHIBIT A

County: Williamson
Highway: SH 195
Limits: From 8.105 Miles South of S. H. 138 to I.H. 35
ROW CSJ: 0440-02-012

Legal Description Parcel 116B

BEING a 3.987 acre (173,674 square feet) tract of land located in the W. Roberts Survey, Abstract No. 524, of Williamson County, Texas, said 3.987 acre tract of land is out of and a part of a 5.0004 acre tract known as Lot 2 of River Road Subdivision, a plat of which is recorded in Cabinet V, Slide 123-124 of the Plat Records of Williamson County, Texas, the said Lot 2 also being part of the same land conveyed by M. S. Properties to Marion K. Shipman by deed recorded July 2, 2002 as Document No. 2002050030 of the Official Public Records of Williamson County, Texas, said 3.987 acre tract of land is further described by metes and bounds as follows:

COMMENCING at a 5/8 inch iron rod with a plastic yellow cap stamped "RODS SURVEYING, INC." set in the northeast line of a 5.00 acre tract conveyed by Mark A. Shelton and wife, Jamie L. Shelton to Ricky Shipman, by deed recorded October 16, 2003 as Document No. 2003101243 of the Official Public Records of Williamson County, Texas, said rod is a common corner of Lot 1 and Lot 2 of the above referenced River Road Subdivision and is located 445.68 feet right of Proposed State Highway 195 (SH 195) Baseline Station 1690+28.28;

THENCE North 42° 17' 52" East with the common line of said Lot 1 and Lot 2 for a distance of 149.55 feet to a 5/8 inch iron rod with Texas Department of Transportation (TxDOT) aluminum cap set, said rod being in the proposed southwest right of way line of SH 195 for the POINT OF BEGINNING of the herein described tract, said rod is located 297.16 feet right of Proposed SH 195 Baseline Station 1690+45.17;

1. THENCE North 42° 17' 52" East continuing with the common line of Lot 1 and Lot 2 for a distance of 520.61 feet to a calculated point in the existing southwest right of way line of SH 195 for the beginning of a non-tangent curve to the right, from which a 1/2 inch iron rod found for witness bears South 42° 17' 52" West a distance of 0.20 feet;
2. THENCE with the existing southwest right of way line of SH 195 in a southeasterly direction and with a curve turning to the right for an arc distance of 381.16 feet, said curve has a radius of 8135.11 feet, a delta angle of 2° 41' 04", a

EXHIBIT A

chord bearing of South 52° 44' 49" East, and a chord distance of 381.13 feet to a 1/2 inch iron rod found for the east corner of Lot 2 and for the north corner of Lot 3 of said subdivision;

3. THENCE South 51° 42' 09" West with the common line of Lot 2 and Lot 3 for a distance of 523.17 feet to a 5/8 inch iron rod with TxDOT aluminum cap set in the northeast line of the aforementioned 5.00 acre tract, said rod is located 292.49 feet right of Proposed SH 195 Baseline Station 1693+41.65;
4. THENCE North 55° 03' 31" West with the proposed west Right of Way line of SH 195, at 166.67 feet pass a 5/8" iron rod set with a TxDOT aluminum cap stamped "ADL" for the BEGINNING of an ACCESS DENIAL LINE, then continue on the same bearing with said proposed right of way line and with an ACCESS DENIAL LINE for a distance of 129.84 feet (total distance 296.52 feet) to the POINT OF BEGINNING, said described tract containing 3.987 acres (173,674 square feet) of land, more or less.

Access will be prohibited across the ACCESS DENIAL LINE as herein described to the highway facility from the remainder of the property lying adjacent to SH 195.

This survey is referenced to the National Spatial Reference System. The projection and datum are the Texas State Plane Coordinate System, Central Zone, North American Datum of 1983. All bearings are relative to National Geodetic Survey, 1993 Adjustment, monuments T27 A (PID AB2837), Austin RRP (PID AF9537) and, Georgeport (PID BM1093). All distances are surface values expressed in U. S. Survey feet and may be converted to grid by dividing by the TxDOT surface adjustment factor of 1.000120.

This description was prepared in conjunction with, and is accompanied by a plat of an even date herewith.

Surveyed by:
RODS Surveying, Inc.
6810 Lee Road, Spring Texas 77379
Phone (281) 379-6388

I, Scott Morris, hereby certify that the above description is true and correct and depicts a survey made under my supervision and on the ground and is based on data gathered from February 2001 to October 2006.

Scott Morris, Registered Professional Land Surveyor No. 5076
Date as of: 5-29-2009



LEGEND

- FOUND CONCRETE MONUMENT (TXDOT TYPE I)
- FOUND CONCRETE MONUMENT (TXDOT TYPE II)
- CONCRETE MONUMENT SET (TXDOT TYPE II)
- FOUND 1/2" IRON ROD UNLESS NOTED
- 5/8" IRON ROD SET WITH TXDOT ALUMINUM CAP (UNLESS NOTED)
- CALCULATED POINT
- FOUND CORNER (AS DESCRIBED)
- 5/8" IRON ROD SET WITH YELLOW CAP "RODS SURVEYING INC."
- PROPERTY LINE
- RECORD INFORMATION
- SURVEY LINE
- PROPOSED DRAINAGE EASEMENT
- ACCESS DENIAL LINE
- EXISTING R.O.W. LINE
- PARCEL BOUNDARY
- R.O.W.
- POINT OF BEGINNING
- P.O.C.
- PC
- POINT OF CURVATURE
- PT
- POINT OF TANGENCY
- CHB
- CHORD BEARING
- CHD
- CHORD DISTANCE
- B.L.
- BUILDING SETBACK LINE (PER PLAT)
- NOT TO SCALE
- N.T.S.
- P.U.E.
- PUBLIC UTILITY EASEMENT
- W.C.D.R.
- WILLIAMSON COUNTY DEED RECORDS
- W.C.O.R.
- WILLIAMSON COUNTY OFFICIAL RECORDS
- W.C.O.P.R.
- WILLIAMSON COUNTY OFFICIAL PUBLIC RECORDS
- W.C.P.R.
- WILLIAMSON COUNTY PLAT RECORDS
- O.S.S.F.S.
- ON SITE SEWERAGE FACILITY SETBACK

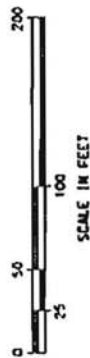
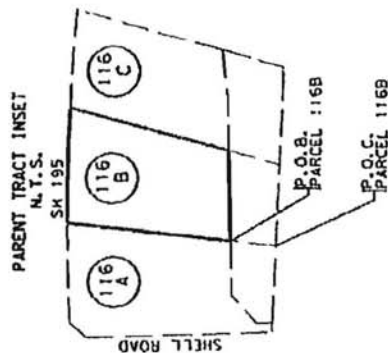

EXHIBIT A

I, SCOTT MORRIS, HEREBY CERTIFY THAT THE HEREON MAP OR PLAT IS TRUE AND CORRECT AND DEPICTS A SURVEY MADE UNDER MY SUPERVISION AND ON THE GROUND AND IS BASED ON DATA GATHERED FROM FEBRUARY 2001 TO OCTOBER 2006

Scott Morris 5-29-2009
SCOTT MORRIS, R.P.L.S. # 5076 DATE AS OF

REVISED MAY 29, 2009



RIGHT OF WAY PLAT
SHOWING PROPERTY OF
MARION K. SHIPMAN
PARCEL 116B

PAGE 3 OF 4

ROW CSJ NO. 0440-02-012
STATE HIGHWAY 195 WILLIAMSON COUNTY, TEXAS
RODS SURVEYING INC.
6810 LEE ROAD SPRING, TX 77379
(281) 379-6388
SCALE: 1"=100' MARCH 7, 2007

NOTES:

1. IMPROVEMENTS SHOWN HEREON ARE BASED UPON TXDOT AERIAL SURVEY; DIGITAL FILES DATED FEBRUARY, 2001 AND MAY, 2002 UPDATED BY ON THE GROUND SURVEYS MADE IN FEBRUARY, 2006.
2. THIS SURVEY IS REFERENCED TO THE NATIONAL SPATIAL REFERENCE SYSTEM. THE PROJECTION AND DATUM ARE THE TEXAS STATE PLANE COORDINATE SYSTEM, CENTRAL ZONE, NORTH AMERICAN DATUM OF 1983. ALL BEARINGS ARE RELATIVE TO NATIONAL GEODETIC SURVEY, 1993 ADJUSTMENT, MONUMENTS T27 A (PID AB2837), AUSTIN RRP (PID AF9537) AND, GEORGETOWN (PID BM1093). ALL DISTANCES ARE SURFACE VALUES EXPRESSED IN U.S. SURVEY FEET AND MAY BE CONVERTED TO GRID BY DIVIDING BY THE TXDOT SURFACE ADJUSTMENT FACTOR OF 1.000120.

RECORD AREA	ACQUIRED AREA		APPROXIMATE REMAINDER			
			LEFT		RIGHT	
ACRES	SO. FT.	ACRES	SO. FT.	ACRES	SO. FT.	ACRES
5.0004	217,817	3.987	173,674	1.0134	44,143	

Parcel 116B
CSJ: 0440-02-012



SPECIAL WARRANTY DEED
SH 195 Right of Way

THE STATE OF TEXAS

§
§
§

COUNTY OF WILLIAMSON

NOTICE OF CONFIDENTIALITY RIGHTS: IF YOU ARE A NATURAL PERSON, YOU MAY REMOVE OR STRIKE ANY OF THE FOLLOWING INFORMATION FROM THIS INSTRUMENT BEFORE IT IS FILED FOR RECORD IN THE PUBLIC RECORDS: YOUR SOCIAL SECURITY NUMBER OR YOUR DRIVER'S LICENSE NUMBER.

WHEREAS, Williamson County, Texas and the State of Texas, acting by and through the Texas Transportation Commission, are authorized to purchase and receive land and such other property rights deemed necessary or convenient for the construction, expansion, enlargement, extension, improvement, or operation of a portion of the proposed State Highway 195 improvements ("Project"); and,

WHEREAS, the acquisition of the hereinafter-described premises has been deemed necessary or convenient for the construction, expansion, enlargement, extension, improvement, or operation of the Project;

NOW, THEREFORE, KNOW ALL MEN BY THESE PRESENTS:

That, MARION K. SHIPMAN, hereinafter referred to as Grantor, whether one or more, for and in consideration of the sum of Ten Dollars (\$10.00) and other good and valuable consideration to Grantor in hand paid by Williamson County, Texas, receipt and sufficiency of which is hereby acknowledged, and for which no lien is retained, either expressed or implied, have this day Sold and by these presents do Grant, Bargain, Sell and Convey unto the STATE OF TEXAS, acting by and through the Texas Transportation Commission, all of that certain tract or parcel of land lying and being situated in the County of Williamson, State of Texas, along with any improvements thereon, being more particularly described as follows:

All of that certain 3.987 acre tract of land, more or less, situated in the W. Roberts Survey, Abstract No. 524 in Williamson County, Texas, being more fully described by metes and bounds in Exhibit "A", attached hereto and incorporated herein (**Parcel 11B**).

RESERVATIONS FROM AND EXCEPTIONS TO CONVEYANCE AND WARRANTY:

Easements and rights-of-way of record; all presently recorded restrictions, reservations, covenants, conditions, oil, gas or other mineral leases, mineral severances, and other instruments, other than liens and conveyances, that affect the property; rights of adjoining owners in any walls and fences situated on a common boundary; and any encroachments or overlapping of improvements.

Grantor reserves all of the oil, gas and other minerals, in and under the land herein conveyed but waives all rights of ingress and egress to the surface thereof for the purpose of exploring, developing, mining or drilling or pumping the same; provided, however, that operations for exploration or recovery of any such minerals and water shall be permissible so long as all surface operations in connection therewith are located at a point outside the acquired parcel and upon the condition that none of such operations shall be conducted so near the surface of said land as to interfere with the intended use thereof or in any way interfere with, jeopardize, or endanger the facilities of the Texas Department of Transportation or create a hazard to the public users thereof; it being intended, however, that nothing in this reservation shall affect the title and the rights of Grantee to take and use without additional compensation any, stone, earth, gravel, caliche, iron ore, gravel or any other road building material upon, in and under said land for the construction and maintenance of SH 195, but shall not be used or exported from the Property for any other purpose.

Access is prohibited across the control of access line to the transportation facility from the adjoining property as shown on the plat which accompanies the metes and bounds description in Exhibit "A".

TO HAVE AND TO HOLD the premises herein described and herein conveyed together with all and singular the rights and appurtenances thereto in any wise belonging unto the State of Texas and its assigns forever; and Grantors do hereby bind ourselves, our heirs, executors, administrators, successors and assigns to Warrant and Forever Defend all and singular the said premises herein conveyed unto the State of Texas and its assigns against every person whomsoever lawfully claiming or to claim the same or any part thereof by, through, or under Grantors, but not otherwise.

This deed is being delivered in lieu of condemnation.

IN WITNESS WHEREOF, this instrument is executed on this the ____ day of _____, 2010.

GRANTOR:

Marion K. Shipman

ACKNOWLEDGMENT

STATE OF TEXAS

§
§
§

COUNTY OF _____

This instrument was acknowledged before me on this the ____ day of _____, 2010 by Marion K. Shipman, in the capacity and for the purposes and consideration recited herein.

Notary Public, State of Texas

PREPARED IN THE OFFICE OF:

Sheets & Crossfield, P.C.
309 East Main
Round Rock, Texas

GRANTEE'S MAILING ADDRESS:

Texas Department of Transportation
Attn: Right of Way Administrator
7901 N. IH 35, Building A
Austin, Texas 78761

AFTER RECORDING RETURN TO: