

## WILLIAMSON COUNTY, TEXAS

CHANGE ORDER NUMBER: 4

RECEIVED

DEC 11 20

HNTB Corp.  
Round Rock

1. CONTRACTOR: Chasco Constructors
2. Change Order Work Limits: Sta. 1+15 to Sta. 212+20
3. Type of Change (on federal-aid non-exempt projects): Minor (Major/Minor)
4. Reasons: 2E, 3F (3 Max. - In order of importance - Primary first)

Project: 10WC822

Roadway: Chandler 3A

Purchase Order Number: \_\_\_\_\_

Receive

DEC 12 20

## 5. Describe the work being revised:

2E: Differing Site Conditions. Miscellaneous difference in site conditions (unforeseeable)(Item 9). This Change Order adds erosion control measures to the project to address locations where runoff from the adjacent fields drains into the ROW, adds guardrail from Sta. 63+50 to 68+20 along the north side of the roadway due to slopes steeper than 3:1, and adds a driveway culvert pipe at Driveway O to minimize ponding water. 3F: County Convenience. Additional work desired by the County. This Change Order also changes the seed mix to a custom County standard as directed by the County Engineer and changes the application method to drill seeding, which generates a cost savings to the County. The new seed mix contains a higher concentration of Bermuda grass seed and is much more resistant to the herbicides utilized by the adjacent farmers.

HNTB Corp.  
Round Rock

6. Work to be performed in accordance with Items: See Attached
7. New or revised plan sheet(s) are attached and numbered: 44 with Redlines
8. New Special Provisions to the contract are attached: ☐ Yes ☒ No
9. New Special Provisions to Item N/A No. N/A, Special Specification Item N/A are attached.

Each signatory hereby warrants that each has the authority to execute this Change Order (CO).

The contractor must sign the Change Order and, by doing so, agrees to waive any and all claims for additional compensation due to any and all other expenses; additional changes for time, overhead and profit; or loss of compensation as a result of this change.

THE CONTRACTOR Date 12/6/12

By Chuck Glace

Typed/Printed Name CHUCK GLACE

Typed/Printed Title PRESIDENT

## The following information must be provided

Time Ext. #: N/A Days added on this CO: 0

Amount added by this change order: \$52,634.44

## RECOMMENDED FOR EXECUTION:

[Signature] Date 12/11/12  
Project Manager  
Construction Observer

N/A  
Design Engineer Date

[Signature] Date 12/12/2012  
Program Manager

Design Engineer's Seal:

N/A

County Commissioner Precinct 1 Date  
☐ APPROVED ☐ REQUEST APPROVAL

County Commissioner Precinct 2 Date  
☐ APPROVED ☐ REQUEST APPROVAL

County Commissioner Precinct 3 Date  
☐ APPROVED ☐ REQUEST APPROVAL

County Commissioner Precinct 4 Date  
☐ APPROVED ☐ REQUEST APPROVAL

[Signature] Date 12-19-2012  
☐ APPROVED County Judge

## WILLIAMSON COUNTY, TEXAS

CHANGE ORDER NUMBER: 4Project # 10WC822**TABLE A: Force Account Work and Materials Placed into Stock**[illegible]**TABLE B: Contract Items**[illegible]

## CHANGE ORDER REASON(S) CODE CHART

1. Design Error or Omission	1A. Incorrect PS&E 1B. Other
2. Differing Site Conditions (unforeseeable)	2A. Dispute resolution (expense caused by conditions and/or resulting delay) 2B. Unavailable material 2C. New development (conditions changing after PS&E completed) 2D. Environmental remediation 2E. Miscellaneous difference in site conditions (unforeseeable)(Item 9) 2F. Site conditions altered by an act of nature 2G. Unadjusted utility (unforeseeable) 2H. Unacquired Right-of-Way (unforeseeable) 2I. Additional safety needs (unforeseeable) 2J. Other
3. County Convenience	3A. Dispute resolution (not resulting from error in plans or differing site conditions) 3B. Public relations improvement 3C. Implementation of a Value Engineering finding 3D. Achievement of an early project completion 3E. Reduction of future maintenance 3F. Additional work desired by the County 3G. Compliance requirements of new laws and/or policies 3H. Cost savings opportunity discovered during construction 3I. Implementation of improved technology or better process 3J. Price adjustment on finished work (price reduced in exchange for acceptance) 3K. Addition of stock account or material supplied by state provision 3L. Revising safety work/measures desired by the County 3M. Other
4. Third Party Accommodation	4A. Failure of a third party to meet commitment 4B. Third party requested work 4C. Compliance requirements of new laws and/or policies (impacting third party) 4D. Other
5. Contractor Convenience	5A. Contractor exercises option to change the traffic control plan 5B. Contractor requested change in the sequence and/or method of work 5C. Payment for Partnering workshop 5D. Additional safety work/measures desired by the contractor 5E. Other
6. Untimely ROW/Utilities	6A. Right-of-Way not clear (third party responsibility for ROW) 6B. Right-of-Way not clear (County responsibility for ROW) 6C. Utilities not clear 6D. Other

**Williamson County Road Bond Program**

**Chandler Road, Phase 3A  
Williamson County Project No. 10WC822**

**Change Order No. 4**

**Reason for Change**

This Change Order adds erosion control measures, guardrail and a driveway culvert pipe due to miscellaneous differences in site conditions and revises the seed mixture and application method to be used on the project.

Additional erosion control measures are needed to address locations where runoff from the adjacent field drains into the County ROW. The additional measures include both rock and concrete riprap protection to minimize erosion and reduce future maintenance. Also, additional guardrail is required from Sta. 63+50 to 68+20 along the north side of the roadway to protect from side slopes steeper than 3:1. The addition of guardrail requires adding a concrete riprap mow strip, a single guardrail terminal and a driveway terminal anchor. A culvert pipe will also be added under Driveway O at Sta. 205+96 to minimize ponding at this location.

The seed mixture type and application method has been revised per direction of the County Engineer to a custom County seed mix and will be drilled seeded, generating a cost savings to the County. The new County seed mixture will include a higher concentration of Bermuda grass seed and is much more resistant to the herbicides utilized by the adjacent farmers. Drill seeding tills the seed into the soil and will prevent the seed from drying out as quickly during establishment.

Following is a summary of new items required for this Change Order:

Item	Description	Unit	Qty
164-WC01	DRILL SEEDING (PERM) (RURAL) (CLAY) (WILCO MIX)	SY	394,128
432-2002	RIPRAP(CONC) (5IN)	CY	100
464-2005	RC PIPE (CL III) (24IN)	LF	66
467-2288	SET (TY II) (24 IN) (RCP) (6:1) (P)	EA	2
540-2025	TERMINAL ANCHOR SECTION (DRWY) (SPCL)	EA	1

This Change Order results in a net increase of \$51,034.44 to the Contract amount, for an adjusted Contract amount of \$7,015,901.05. The original contract amount was \$6,654,874.15. As a result of this and all Change Orders to-date, \$451,026.90 has been added to the Contract resulting in a 6.8% net increase in the contract cost. No

additional days will be added to or deducted from the Contract as a result of this Change Order.

**HNTB Corporation**

James Klotz, P.E.





Change Proposal Unit Cost Pricing Sheet

Chandler Rd 3A  
Chasco Project No:10182  
13 September 2012

Chasco CP No: CP 005 - Drill Seed

Prepared by: Kellin Neiman

Description: Deduct for Drill Seed with new County specified mix in lieu of txdot approved hydromulch mix.

ITEM	Cost code	DESCRIPTION	QTY	UNIT	UNIT PRICE	TOTAL
10	164-2023	CELL FBR MLCH SEED (PERM) (RURAL) (CLAY)	(394,128.00)	SY	\$0.45	(\$177,357.60)
		DRILL SEED	394,128.00	SY	\$0.43	\$169,475.04
					TOTAL	(\$7,882.56)

Exclusions: Anything not specifically listed above.

Qualifications: This a unit price proposal. Final billing will be based on installed quantities. Mix includes 24lbs/acre oats, 34lbs/acre of wheat, 25lbs/acre un-hulled bermuda, 25lbs/acre hulled bermuda as specified by County. Price includes fertilizer placed at a rate of 605LBS/ACRE per the job manual, subgrade prep and watering.

COLLA MBUF PLAN SHEETS

INSTALL DRIVEWAY (145) (END OF ROAD) BEHIND MBUF

PLAN 65-5-5

MIN STK 65-46

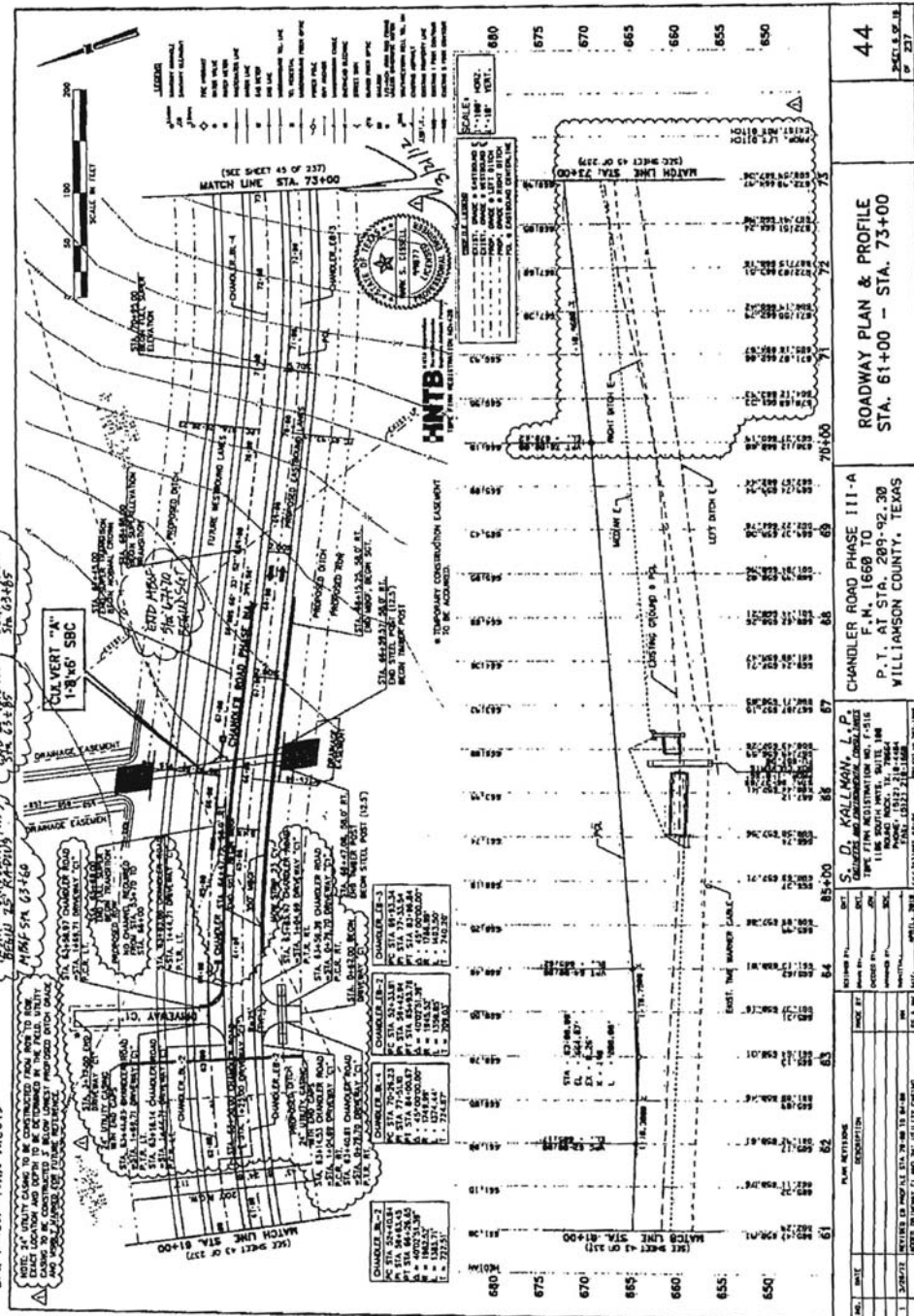

APPROVED

ROADWAY PLAN & PROFILE  
STA. 61+00 - STA. 73+00

CHANDLER ROAD PHASE III - A  
F.M. 1660 TO  
P.T. AT STA. 289+92.30  
WILLIAMSON COUNTY, TEXAS

S. D. KALLMAN, L.P.  
REGISTERED PROFESSIONAL ENGINEER  
No. 11111  
EXPIRATION DATE 12/31/2004  
PLANS 13127, 13128, 13129, 13130, 13131, 13132, 13133, 13134, 13135, 13136, 13137, 13138, 13139, 13140, 13141, 13142, 13143, 13144, 13145, 13146, 13147, 13148, 13149, 13150, 13151, 13152, 13153, 13154, 13155, 13156, 13157, 13158, 13159, 13160, 13161, 13162, 13163, 13164, 13165, 13166, 13167, 13168, 13169, 13170, 13171, 13172, 13173, 13174, 13175, 13176, 13177, 13178, 13179, 13180, 13181, 13182, 13183, 13184, 13185, 13186, 13187, 13188, 13189, 13190, 13191, 13192, 13193, 13194, 13195, 13196, 13197, 13198, 13199, 13200, 13201, 13202, 13203, 13204, 13205, 13206, 13207, 13208, 13209, 13210, 13211, 13212, 13213, 13214, 13215, 13216, 13217, 13218, 13219, 13220, 13221, 13222, 13223, 13224, 13225, 13226, 13227, 13228, 13229, 13230, 13231, 13232, 13233, 13234, 13235, 13236, 13237, 13238, 13239, 13240, 13241, 13242, 13243, 13244, 13245, 13246, 13247, 13248, 13249, 13250, 13251, 13252, 13253, 13254, 13255, 13256, 13257, 13258, 13259, 13260, 13261, 13262, 13263, 13264, 13265, 13266, 13267, 13268, 13269, 13270, 13271, 13272, 13273, 13274, 13275, 13276, 13277, 13278, 13279, 13280, 13281, 13282, 13283, 13284, 13285, 13286, 13287, 13288, 13289, 13290, 13291, 13292, 13293, 13294, 13295, 13296, 13297, 13298, 13299, 13300, 13301, 13302, 13303, 13304, 13305, 13306, 13307, 13308, 13309, 13310, 13311, 13312, 13313, 13314, 13315, 13316, 13317, 13318, 13319, 13320, 13321, 13322, 13323, 13324, 13325, 13326, 13327, 13328, 13329, 13330, 13331, 13332, 13333, 13334, 13335, 13336, 13337, 13338, 13339, 13340, 13341, 13342, 13343, 13344, 13345, 13346, 13347, 13348, 13349, 13350, 13351, 13352, 13353, 13354, 13355, 13356, 13357, 13358, 13359, 13360, 13361, 13362, 13363, 13364, 13365, 13366, 13367, 13368, 13369, 13370, 13371, 13372, 13373, 13374, 13375, 13376, 13377, 13378, 13379, 13380, 13381, 13382, 13383, 13384, 13385, 13386, 13387, 13388, 13389, 13390, 13391, 13392, 13393, 13394, 13395, 13396, 13397, 13398, 13399, 13400, 13401, 13402, 13403, 13404, 13405, 13406, 13407, 13408, 13409, 13410, 13411, 13412, 13413, 13414, 13415, 13416, 13417, 13418, 13419, 13420, 13421, 13422, 13423, 13424, 13425, 13426, 13427, 13428, 13429, 13430, 13431, 13432, 13433, 13434, 13435, 13436, 13437, 13438, 13439, 13440, 13441, 13442, 13443, 13444, 13445, 13446, 13447, 13448, 13449, 13450, 13451, 13452, 13453, 13454, 13455, 13456, 13457, 13458, 13459, 13460, 13461, 13462, 13463, 13464, 13465, 13466, 13467, 13468, 13469, 13470, 13471, 13472, 13473, 13474, 13475, 13476, 13477, 13478, 13479, 13480, 13481, 13482, 13483, 13484, 13485, 13486, 13487, 13488, 13489, 13490, 13491, 13492, 13493, 13494, 13495, 13496, 13497, 13498, 13499, 13500, 13501, 13502, 13503, 13504, 13505, 13506, 13507, 13508, 13509, 13510, 13511, 13512, 13513, 13514, 13515, 13516, 13517, 13518, 13519, 13520, 13521, 13522, 13523, 13524, 13525, 13526, 13527, 13528, 13529, 13530, 13531, 13532, 13533, 13534, 13535, 13536, 13537, 13538, 13539, 13540, 13541, 13542, 13543, 13544, 13545, 13546, 13547, 13548, 13549, 13550, 13551, 13552, 13553, 13554, 13555, 13556, 13557, 13558, 13559, 13560, 13561, 13562, 13563, 13564, 13565, 13566, 13567, 13568, 13569, 13570, 13571, 13572, 13573, 13574, 13575, 13576, 13577, 13578, 13579, 13580, 13581, 13582, 13583, 13584, 13585, 13586, 13587, 13588, 13589, 13590, 13591, 13592, 13593, 13594, 13595, 13596, 13597, 13598, 13599, 13600, 13601, 13602, 13603, 13604, 13605, 13606, 13607, 13608, 13609, 13610, 13611, 13612, 13613, 13614, 13615, 13616, 13617, 13618, 13619, 13620, 13621, 13622, 13623, 13624, 13625, 13626, 13627, 13628, 13629, 13630, 13631, 13632, 13633, 13634, 13635, 13636, 13637, 13638, 13639, 13640, 13641, 13642, 13643, 13644, 13645, 13646, 13647, 13648, 13649, 13650, 13651, 13652, 13653, 13654, 13655, 13656, 13657, 13658, 13659, 13660, 13661, 13662, 13663, 13664, 13665, 13666, 13667, 13668, 13669, 13670, 13671, 13672, 13673, 13674, 13675, 13676, 13677, 13678, 13679, 13680, 13681, 13682, 13683, 13684, 13685, 13686, 13687, 13688, 13689, 13690, 13691, 13692, 13693, 13694, 13695, 13696, 13697, 13698, 13699, 13700, 13701, 13702, 13703, 13704, 13705, 13706, 13707, 13708, 13709, 13710, 13711, 13712, 13713, 13714, 13715, 13716, 13717, 13718, 13719, 13720, 13721, 13722, 13723, 13724, 13725, 13726, 13727, 13728, 13729, 13730, 13731, 13732, 13733, 13734, 13735, 13736, 13737, 13738, 13739, 13740, 13741, 13742, 13743, 13744, 13745, 13746, 13747, 13748, 13749, 13750, 13751, 13752, 13753, 13754, 13755, 13756, 13757, 13758, 13759, 13760, 13761, 13762, 13763, 13764, 13765, 13766, 13767, 13768, 13769, 13770, 13771, 13772, 13773, 13774, 13775, 13776, 13777, 13778, 13779, 13780, 13781, 13782, 13783, 13784, 13785, 13786, 13787, 13788, 13789, 13790, 13791, 13792, 13793, 13794, 13795, 13796, 13797, 13798, 13799, 13800, 13801, 13802, 13803, 13804, 13805, 13806, 13807, 13808, 13809, 13810, 13811, 13812, 13813, 13814, 13815, 13816, 13817, 13818, 13819, 13820, 13821, 13822, 13823, 13824, 13825, 13826, 13827, 13828, 13829, 13830, 13831, 13832, 13833, 13834, 13835, 13836, 13837, 13838, 13839, 13840, 13841, 13842, 13843, 13844, 13845, 13846, 13847, 13848, 13849, 13850, 13851, 13852, 13853, 13854, 13855, 13856, 13857, 13858, 13859, 13860, 13861, 13862, 13863, 13864, 13865, 13866, 13867, 13868, 13869, 13870, 13871, 13872, 13873, 13874, 13875, 13876, 13877, 13878, 13879, 13880, 13881, 13882, 13883, 13884, 13885, 13886, 13887, 13888, 13889, 13890, 13891, 13892, 13893, 13894, 13895, 13896, 13897, 13898, 13899, 13900, 13901, 13902, 13903, 13904, 13905, 13906, 13907, 13908, 13909, 13910, 13911, 13912, 13913, 13914, 13915, 13916, 13917, 13918, 13919, 13920, 13921, 13922, 13923, 13924, 13925, 13926, 13927, 13928, 13929, 13930, 13931, 13932, 13933, 13934, 13935, 13936, 13937, 13938, 13939, 13940, 13941, 13942, 13943, 13944, 13945, 13946, 13947, 13948, 13949, 13950, 13951, 13952, 13953, 13954, 13955, 13956, 13957, 13958, 13959, 13960, 13961, 13962, 13963, 13964, 13965, 13966, 13967, 13968, 13969, 13970, 13971, 13972, 13973, 13974, 13975, 13976, 13977, 13978, 13979, 13980, 13981, 13982, 13983, 13984, 13985, 13986, 13987, 13988, 13989, 13990, 13991, 13992, 13993, 13994, 13995, 13996, 13997, 13998, 13999, 14000, 14001, 14002, 14003, 14004, 14005, 14006, 14007, 14008, 14009, 14010, 14011, 14012, 14013, 14014, 14015, 14016, 14017, 14018, 14019, 14020, 14021, 14022, 14023, 14024, 14025, 14026, 14027, 14028, 14029, 14030, 14031, 14032, 14033, 14034, 14035, 14036, 14037, 14038, 14039, 14040, 14041, 14042, 14043, 14044, 14045, 14046, 14047, 14048, 14049, 14050, 14051, 14052, 14053, 14054, 14055, 14056, 14057, 14058, 14059, 14060, 14061, 14062, 14063, 14064, 14065, 14066, 14067, 14068, 14069, 14070, 14071, 14072, 14073, 14074, 14075, 14076, 14077, 14078, 14079, 14080, 14081, 14082, 14083, 14084, 14085, 14086, 14087, 14088, 14089, 14090, 14091, 14092, 14093, 14094, 14095, 14096, 14097, 14098, 14099, 14100, 14101, 14102, 14103, 14104, 14105, 14106, 14107, 14108, 14109, 14110, 14111, 14112, 14113, 14114, 14115, 14116, 14117, 14118, 14119, 14120, 14121, 14122, 14123, 14124, 14125, 14126, 14127, 14128, 14129, 14130, 14131, 14132, 14133, 14134, 14135, 14136, 14137, 14138, 14139, 14140, 14141, 14142, 14143, 14144, 14145, 14146, 14147, 14148, 14149, 14150, 14151, 14152, 14153, 14154, 14155, 14156, 14157, 14158, 14159, 14160, 14161, 14162, 14163, 14164, 14165, 14166, 14167, 14168, 14169, 14170, 14171, 14172, 14173, 14174, 14175, 14176, 14177, 14178, 14179, 14180, 14181, 14182, 14183, 14184, 14185, 14186, 14187, 14188, 14189, 14190, 14191, 14192, 14193, 14194, 14195, 14196, 14197, 14198, 14199, 14200, 14201, 14202, 14203, 14204, 14205, 14206, 14207, 14208, 14209, 14210, 14211, 14212, 14213, 14214, 14215, 14216, 14217, 14218, 14219, 14220, 14221, 14222, 14223, 14224, 14225, 14226, 14227, 14228, 14229, 14230, 14231, 14232, 14233, 14234, 14235, 14236, 14237, 14238, 14239, 14240, 14241, 14242, 14243, 14244, 14245, 14246, 14247, 14248, 14249, 14250, 14251, 14252, 14253, 14254, 14255, 14256, 14257, 14258, 14259, 14260, 14261, 14262, 14263, 14264, 14265, 14266, 14267, 14268, 14269, 14270, 14271, 14272, 14273, 14274, 14275, 14276, 14277, 14278, 14279, 14280, 14281, 14282, 14283, 14284, 14285, 14286, 14287, 14288, 14289, 14290, 14291, 14292, 14293, 14294, 14295, 14296, 14297, 14298, 14299, 14300, 14301, 14302, 14303, 14304, 14305, 14306, 14307, 14308, 14309, 14310, 14311, 14312, 14313, 14314, 14315, 14316, 14317, 14318, 14319, 14320, 14321, 14322, 14323, 14324, 14325, 14326, 14327, 14328, 14329, 14330, 14331, 14332, 14333, 14334, 14335, 14336, 14337, 14338, 14339, 14340, 14341, 14342, 14343, 14344, 14345, 14346, 14347, 14348, 14349, 14350, 14351, 14352, 14353, 14354, 14355, 14356, 14357, 14358, 14359, 14360, 14361, 14362, 14363, 14364, 14365, 14366, 14367, 14368, 14369, 14370, 14371, 14372, 14373, 14374, 14375, 14376, 14377, 14378, 14379, 14380, 14381, 14382, 14383, 14384, 14385, 14386, 14387, 14388, 14389, 14390, 14391, 14392, 14393, 14394, 14395, 14396, 14397, 14398, 14399, 14400, 14401, 14402, 14403, 14404, 14405, 14406, 14407, 14408, 14409, 14410, 14411, 14412, 14413, 14414, 14415, 14416, 14417, 14418, 14419, 14420, 14421, 14422, 14423, 14424, 14425, 14426, 14427, 14428, 14429, 14430, 14431, 14432, 14433, 14434, 14435, 14436, 14437, 14438, 14439, 14440, 14441, 14442, 14443, 14444, 14445, 14446, 14447, 14448, 14449, 14450, 14451, 14452, 14453, 14454, 14455, 14456, 14457, 14458, 14459, 14460, 14461, 14462, 14463, 14464, 14465, 14466, 14467, 14468, 14469, 14470, 14471, 14472, 14473, 14474, 14475, 14476, 14477, 14478, 14479, 14480, 14481, 14482, 14483, 14484, 14485, 14486, 14487, 14488, 14489, 14490, 14491, 14492, 14493, 14494, 14495, 14496, 14497, 14498, 14499, 14500, 14501, 14502, 14503, 14504, 14505, 14506, 14507, 14508, 14509, 14510, 14511, 14512, 14513, 14514, 14515, 14516, 14517, 14518, 14519, 14520, 14521, 14522, 14523, 14524, 14525, 14526, 14527, 14528, 14529, 14530, 14531, 14532, 14533, 14534, 14535, 14536, 14537, 14538, 14539, 14540, 14541, 14542, 14543, 14544, 14545, 14546, 14547, 14548, 14549, 14550, 14551, 14552, 14553, 14554, 14555, 14556, 14557, 14558, 14559, 14560, 14561, 14562, 14563, 14564, 14565, 14566, 14567, 14568, 14569, 14570, 14571, 14572, 14573, 14574, 14575, 14576, 14577, 14578, 14579, 14580, 14581, 14582, 14583, 14584, 14585, 14586, 14587, 14588, 14589, 14590, 14591, 14592, 14593, 14594, 14595, 14596, 14597, 14598, 14599, 14600, 14601, 14602, 14603, 14604, 14605, 14606, 14607, 14608, 14609, 14610, 14611, 14612, 14613, 14614, 14615, 14616, 14617, 14618, 14619, 14620, 14621, 14622, 14623, 14624, 14625, 14626, 14627, 14628, 14629, 14630, 14631, 14632, 14633, 14634, 14635, 14636, 14637, 14638, 14639, 14640, 14641, 14642, 14643, 14644, 14645, 14646, 14647, 14648, 14649, 14650, 14651, 14652, 14653, 14654, 14655, 14656, 14657, 14658, 14659, 14660, 14661, 14662, 14663, 14664, 14665, 14666, 14667, 14668, 14669, 14670, 14671, 14672, 14673, 14674, 14675, 14676, 14677, 14678, 14679, 14680, 14681, 14682, 14683, 14684, 14685, 14686, 14687, 14688, 14689, 14690, 14691, 14692, 14693, 14694, 14695, 14696, 14697, 14698, 14699, 14700, 14701, 14702, 14703, 14704, 14705, 14706, 14707, 14708, 14709, 14710, 14711, 14712, 14713, 14714, 14715, 14716, 14717, 14718, 14719, 14720, 14721, 14722, 14723, 14724, 14725, 14726, 14727, 14728, 14729, 14730, 14731, 14732, 14733, 14734, 14735, 14736, 14737, 14738, 14739, 14740, 14741, 14742, 14743, 14744, 14745, 14746, 14747, 14748, 14749, 14750, 14751, 14752, 14753, 14754, 14755, 14756, 14757, 14758, 14759, 14760, 14761, 14762, 14763, 14764, 14765, 14766, 14767, 14768, 14769, 14770, 14771, 14772, 14773, 14774, 14775, 14776, 14777, 14778, 14779, 14780, 14781, 14782, 14783, 14784, 14785, 14786, 14787, 14