

WILLIAMSON COUNTY, TEXAS

CHANGE ORDER NUMBER: 1

1. CONTRACTOR: RHB Construction, Inc.
2. Change Order Work Limits: Sta. N/A to Sta. N/A
3. Type of Change (on federal-aid non-exempt projects): (Major/Minor)
4. Reasons: CODE: 2E (3 Max. - In order of importance - Primary first)

Project: 14IFB00241
 Roadway:
 Purchase Order Number:

At the Expo Center, the pavement repair areas must be cement stabilized in lieu of flex base replacement due to recently discovered soft subgrade condition.

6. Work to be performed in accordance with Items: 247, 275
7. New or revised plan sheet(s) are attached and numbered: 1, 2, 8, 9, 10
8. New Special Provisions to the contract are attached: ☐ Yes ☒ No
9. New Special Provisions to Item N/A No. N/A, Special Specification Item N/A are attached.

Each signatory hereby warrants that each has the authority to execute this Change Order (CO).

<p><small>The contractor must sign the Change Order and, by doing so, agrees to waive any and all claims for additional compensation due to any and all other expenses: additional changes for time, overhead and profit; or loss of compensation as a result of this change.</small></p>		<p>The following information must be provided</p>	
<p>THE CONTRACTOR Date <u>9/18/14</u></p>		<p>Time Ext. #: <u>N/A</u> Days added on this CO: <u>0</u></p>	
<p>Amount added by this change order: <u>\$986.00</u></p>			
<p>Typed/Printed Name <u>Bob Hummel</u></p>			
<p>Typed/Printed Title <u>VP</u></p>			

RECOMMENDED FOR EXECUTION:

[Signature] 09/18/14
 Project Manager Date
 Construction Observer

[Signature] 9/18/14
 Design Engineer Date

[Signature] 9/18/14
 Program Manager Date

Design Engineer's Seal:

See revised plan sheets

County Commissioner Precinct 1 Date
☐ APPROVED ☐ REQUEST APPROVAL

County Commissioner Precinct 2 Date
☐ APPROVED ☐ REQUEST APPROVAL

County Commissioner Precinct 3 Date
☐ APPROVED ☐ REQUEST APPROVAL

County Commissioner Precinct 4 Date
☐ APPROVED ☐ REQUEST APPROVAL

[Signature] 9-23-14
☐ APPROVED County Judge Date

CHANGE ORDER REASON(S) CODE CHART

1. Design Error or Omission	1A. Incorrect PS&E 1B. Other
2. Differing Site Conditions (unforeseeable)	2A. Dispute resolution (expense caused by conditions and/or resulting delay) 2B. Unavailable material 2C. New development (conditions changing after PS&E completed) 2D. Environmental remediation 2E. Miscellaneous difference in site conditions (unforeseeable)(Item 9) 2F. Site conditions altered by an act of nature 2G. Unadjusted utility (unforeseeable) 2H. Unacquired Right-of-Way (unforeseeable) 2I. Additional safety needs (unforeseeable) 2J. Other
3. County Convenience	3A. Dispute resolution (not resulting from error in plans or differing site conditions) 3B. Public relations improvement 3C. Implementation of a Value Engineering finding 3D. Achievement of an early project completion 3E. Reduction of future maintenance 3F. Additional work desired by the County 3G. Compliance requirements of new laws and/or policies 3H. Cost savings opportunity discovered during construction 3I. Implementation of improved technology or better process 3J. Price adjustment on finished work (price reduced in exchange for acceptance) 3K. Addition of stock account or material supplied by state provision 3L. Revising safety work/measures desired by the County 3M. Other
4. Third Party Accommodation	4A. Failure of a third party to meet commitment 4B. Third party requested work 4C. Compliance requirements of new laws and/or policies (impacting third party) 4D. Other
5. Contractor Convenience	5A. Contractor exercises option to change the traffic control plan 5B. Contractor requested change in the sequence and/or method of work 5C. Payment for Partnering workshop 5D. Additional safety work/measures desired by the contractor 5E. Other
6. Untimely ROW/Utilities	6A. Right-of-Way not clear (third party responsibility for ROW) 6B. Right-of-Way not clear (County responsibility for ROW) 6C. Utilities not clear 6D. Other

Project # 14IFB00241[illegible][illegible]

DRAWING: F:_ROADWAYS\B\ PARKS\SS\ 061014\Drawings\CP\Plans\PARKS SEAL COAT 2014 COVER.dwg

INDEX OF SHEETS	
SHEET #	DESCRIPTION
COVER	
1	TYPE SHEET
2	SUMMARY OF ESTIMATED QUANTITY
3	BERRY SPRINGS PAVE. AND STRIP.
4	BERRY SPRINGS PAVEMENT KEY MAP
5	BERRY SPRINGS PAVEMENT & REPAIR SHEET 1
6	BERRY SPRINGS PAVEMENT & REPAIR SHEET 2
7	BERRY SPRINGS PAVEMENT & REPAIR SHEET 3
8	BERRY SPRINGS STRIPING
9	EXPO CENTER PAVE. AND STRIP.
10	EXPO CENTER PAVEMENT PLAN
11	EXPO CENTER PAVEMENT REPAIR SHEET 1
12	EXPO CENTER PAVEMENT REPAIR SHEET 2
13	EXPO CENTER PAVEMENT REPAIR SHEET 3
14	EXPO CENTER STRIPING PLAN
STANDARDS	
15	PARKING BUMPER DETAIL
16	BACKFILL
17	TOP OF CURB
18	PARAPET
19	PAVEMENT MARKINGS

WILLIAMSON COUNTY
DEPARTMENT OF INFRASTRUCTURE

3151 S.E. INNER LOOP, SUITE B
GEORGETOWN, TEXAS 78626

943-3330

www.wilco.org

PLANS FOR PROPOSED
PARKS SEAL COAT
IMPROVEMENTS

Project No. 14IFB00241

JUNE 2014

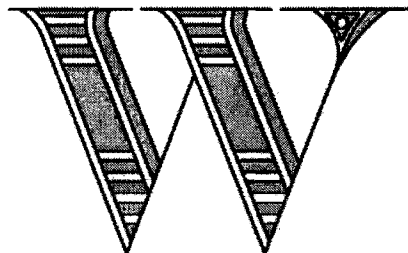

WILLIAMSON
COUNTY

1848

GENERAL PROJECT INFO:

REHAB OF PARKS SEAL COAT. PROJECT CONSISTS OF 12" REPLACEMENT BASE MATERIAL; 10" CEMENT STABILIZED BASE MATERIAL; SEAL COAT; STRIPING.

LIMITS: EXTENTS OF THE PARKS SEAL COAT AS SHOWN IN PLANS

AS SHEETS 1, 2, 8, 9 & 10

KOK 8-7-14

REFERENCED STANDARD SPECIFICATIONS:
SPECIFICATIONS ADOPTED BY THE TEXAS DEPARTMENT OF TRANSPORTATION ON JUNE 1,
2004 SHALL GOVERN THIS PROJECT.

AS SHEETS AFFECTED

BY DATE

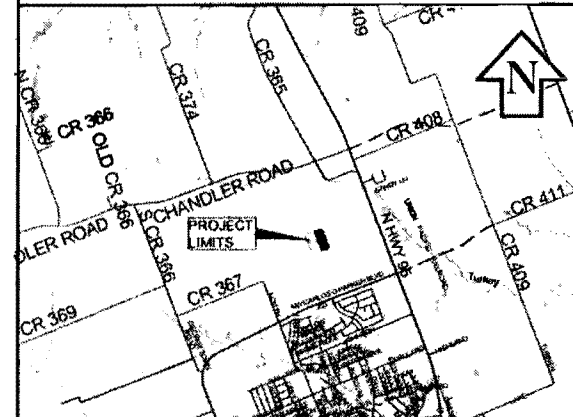
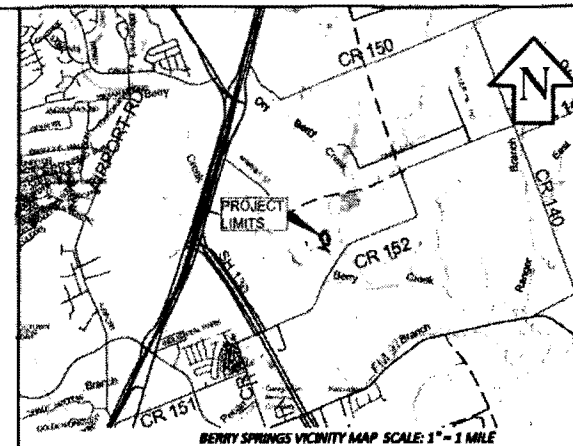

WILLIAMSON COUNTY

DESIGNED BY:

KON Q. KWAN, P.E.
DESIGN ENGINEER
THE STANDARD / DETAIL SHEETS, #12 THRU #16 HAVE BEEN
ISSUED BY ME AND ARE APPLICABLE TO THIS PROJECT.

APPROVED AND RECOMMENDED FOR LETTING:

JERRON EVERTSON, P.E.
DIRECTOR
OF ROAD & BRIDGE

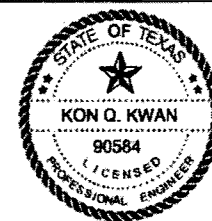

THE SEAL APPEARING ON THIS DOCUMENT
WAS AUTHORIZED BY KON Q. KWAN, P.E.
#90584 ON 08/07/2014

ITEM	NO	DESCRIPTION	UNITS	EXPO CENTER QUANTITY	BERRY SPRINGS QUANTITY	TOTAL QUANTITY
247	2042	FLBS (CMP IN PLC) (TYA GR2) (FNALPOS)	CY	0	529	529
275	2006	CEMENT TREAT (EXIST MATL) (10")	SY	204	0	204
310	2005	PRIME COAT (MC-30 OR AE-P) (0.2 GAL/SY)	GAL	41	318	358
316	2893	ASPH (CHFRS-2P, HFRS-2P OR CRS-2P) (0.43-0.50 GAL/SY)	GAL	16198	4269	20467
316	2174	AGGR (TY-B GR-4 SAC-B) (1 CY/115 SY)	CY	282	74	356
500	2001	MOBILIZATION	LS	1	1	2
666	2011	REFL PAV MKR TY I (W) 4" (SLD) (090MIL)	LF	14568	596	15164
666	2390	RE PM TY II (ACC PRK) (WHT) (SYMBOL ONLY)	EA	15	3	18

[illegible]

**WILLIAMSON COUNTY
DEPT. OF
INFRASTRUCTURE**

PARK FOG SEAL	SUMMARY OF ESTIMATE QUANTITY
---------------	------------------------------



PROJECT: PARK FOG SEAL	DATE: 12/01/03	DESIGNED: MT	CAD DWG: MT	REVIEWED: KOK
SHEET				
2				
OF 16				

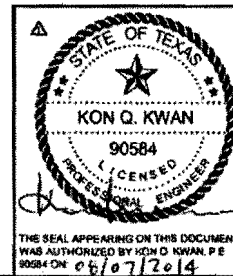

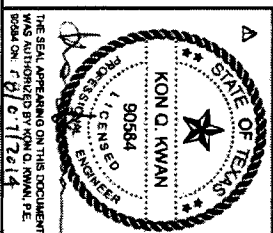
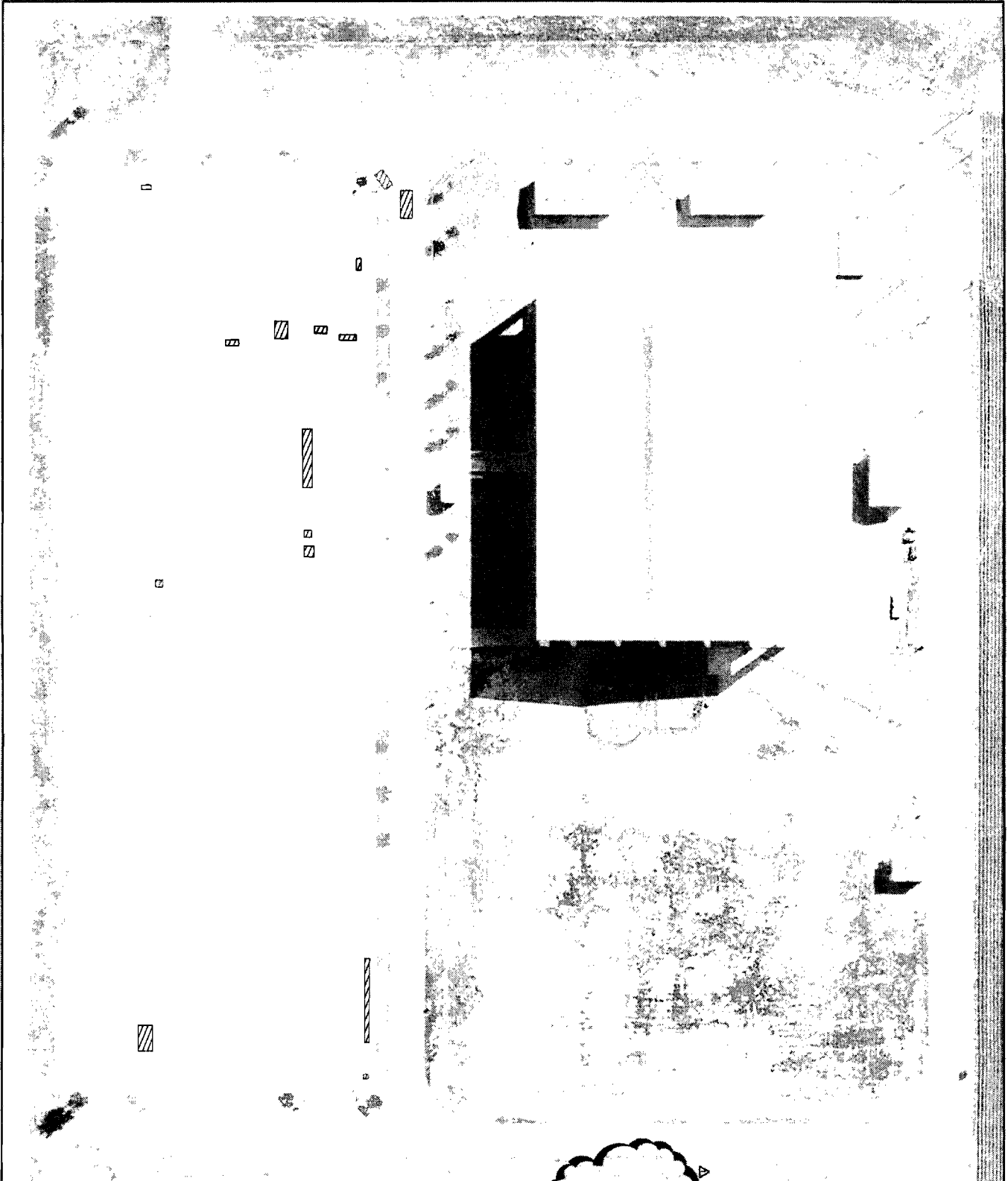

PROJECT: PARK FOG SEAL
 DATE: 7/24/2014
 DESIGNED: MT
 CAD DWG: MT
 REVIEWED: KQK



PARK FOG SEAL
 EXPO CENTER PAVEMENT PLAN

WILLIAMSON COUNTY
 DEPT. OF
 INFRASTRUCTURE
 3151 S.E. INNER LOOP, SUITE B
 GEORGETOWN, TEXAS 78626
 409-3330
 www.willco.org

LEGEND

	SEAL COAT (TOTAL EXPO CENTER AREA = 32,182 SY)		
	PLANE EXISTING SEAL COAT, CEMENT STABILIZED 10" OF EXISTING BASE MATERIAL WITH 3% CEMENT CONTENT AND APPLY PRIME COAT AND FIRST COURSE OF SEAL COAT (SEE PLAN SHEET FOR APPROXIMATE LOCATION OF AREAS)		



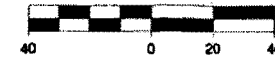
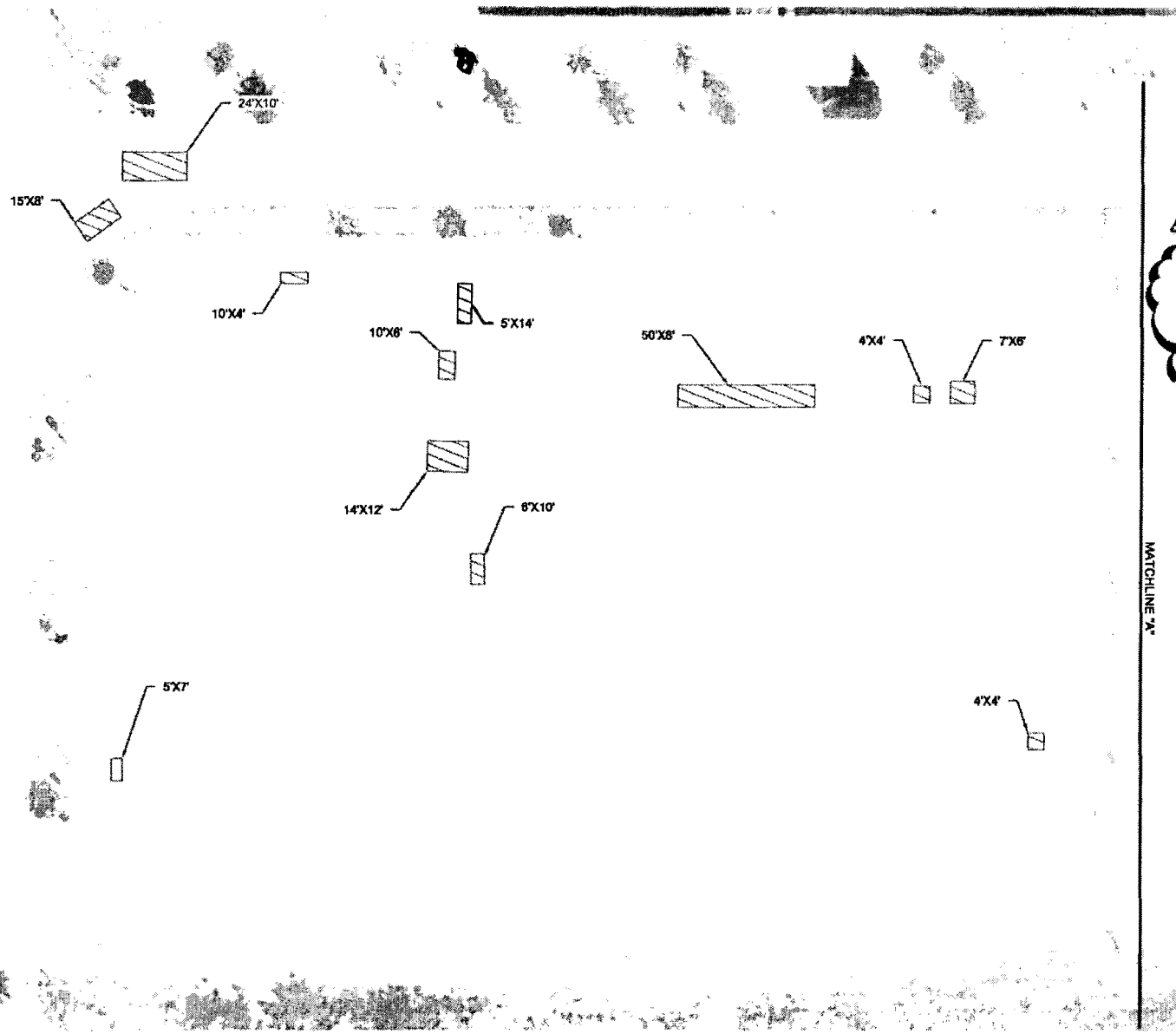

LEGEND

- SEAL COAT
 (TOTAL EXPO CENTER
 AREA = 32,192 SY)
- PLANE EXISTING SEAL
 COAT, CEMENT STABILIZED
 10" OF EXISTING BASE
 MATERIAL WITH 3% CEMENT
 CONTENT AND APPLY
 PRIME COAT AND FIRST
 COURSE OF SEAL COAT
 (SEE PLAN SHEET FOR
 APPROXIMATE LOCATION
 OF AREAS)

NO.	DESCRIPTION	BY	DATE

WILLIAMSON COUNTY
 DEPT. OF
 INFRASTRUCTURE
 3141 S.E. INNER LOOP, SUITE 8
 GEORGETOWN, TEXAS 76240
 843-3330
 www.willco.org

PARK FOG SEAL
 EXPO CENTER PAVEMENT REPAIR
 SHEET 9

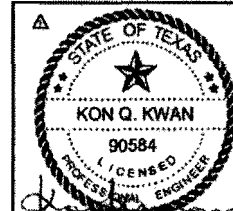

THE SEAL APPEARING ON THIS DOCUMENT
 WAS AUTHORIZED BY KON Q. KWAN, P.E.
 90584 ON 08/07/2014

PROJECT: PARK FOG SEAL	DATE: 08/07/2014	DESIGNED BY: JKH	CAD DWG. BY: JKH	REVIEWED BY: JKH
SHEET				
9				
OF 16				

MATCHLINE "A"

72'X4'

4'X4'

22'X12'



LEGEND

SEAL COAT
 (TOTAL EXPO CENTER
 AREA = 32,192 SY)

PLANE EXISTING SEAL
 COAT, CEMENT STABILIZED
 10" OF EXISTING BASE
 MATERIAL WITH 3% CEMENT
 CONTENT AND APPLY
 PRIME COAT AND FIRST
 COURSE OF SEAL COAT
 (SEE PLAN SHEET FOR
 APPROXIMATE LOCATION
 OF AREAS)

NO.	DESCRIPTION	DATE

WILLIAMSON COUNTY
 DEPT. OF
 INFRASTRUCTURE
 3151 S.E. INNER LOOP, SUITE B
 GEORGETOWN, TEXAS 78626
 843-3390
 www.wco.net

PARK FOG SEAL
 EXPO CENTER PAVEMENT REPAIR
 SHEET 10

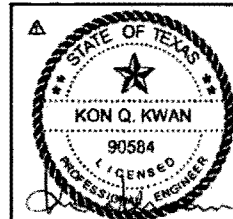

THE SEAL APPEARING ON THIS DOCUMENT
 WAS AUTHORIZED BY KON Q. KWAN, P.E.
 90584 ON 08/07/2014

PROJECT: PARK FOG SEAL
DATE: 8/6/2014
DESIGNED: MT
CAD DWG: MT
REVIEWED: KON

SHEET
 10
 OF 16