



WILLIAMSON COUNTY, TEXAS
CHANGE ORDER NUMBER: 2

Received

AUG 30 2017

1. CONTRACTOR: Chasco Constructors, Inc.
2. Change Order Work Limits: Sta. 99+40 to Sta. 217+31
3. Type of Change (on federal-aid non-exempt projects): Minor (Major/Minor)
4. Reasons: 2E & 4B (3 Max. - In order of importance - Primary first)

Project:	<u>1604-075</u>
Roadway:	<u>CR-110 South</u>
CSJ Number:	

5. Describe the work being revised:

2E: Differing Site Conditions (unforeseeable). Miscellaneous difference in site conditions (unforeseeable) (Item 9). This Change Order substitutes a wingwall with a special drop inlet due to safety slope reasons. The proposed culvert upstream flowline was approximately 4' below ditch profile grades which would have resulted in an extremely steep backslope at the end of the culvert.

4B: Third Party Accommodation. Third party requested work. This Change Order also addresses over-runs and under-runs for various waterline components and includes substituting the HDPE bore pipe for steel encasement pipe at the request of Seminole Pipeline.

6. Work to be performed in accordance with Items: See attached
7. New or revised plan sheet(s) are attached and numbered: 154
8. New Special Provisions/Specifications to the contract are attached: ☐ Yes ☒ No
9. New Special Provisions to Item N/A No. N/A, Special Specification Item N/A are attached.

Each signatory hereby warrants that each has the authority to execute this Change Order (CO).

<p><small>The contractor must sign the Change Order and, by doing so, agrees to waive any and all claims for additional compensation due to any and all other expenses, additional changes for time, overhead and profit, or loss of compensation as a result of this change.</small></p> <p>THE CONTRACTOR Date <u>8/29/17</u></p> <p>By <u>Chuck Glace</u></p> <p>Typed/Printed Name <u>CHUCK GLACE</u></p> <p>Typed/Printed Title <u>PRESIDENT</u></p>	<p>The following information must be provided</p> <p>Time Ext. #: <u>N/A</u> Days added on this CO: <u>0</u></p> <p>Amount added by this change order: <u>\$2,840.00</u></p>
---	---

RECOMMENDED FOR EXECUTION:

[Signature] 8/31/17
Project Manager Date

N/A
Design Engineer Date

[Signature] 9/1/2017
Program Manager Date

Design Engineer's Seal:

N/A

County Commissioner Precinct 1 Date
☐ APPROVED ☐ REQUEST APPROVAL

County Commissioner Precinct 2 Date
☐ APPROVED ☐ REQUEST APPROVAL

County Commissioner Precinct 3 Date
☐ APPROVED ☐ REQUEST APPROVAL

County Commissioner Precinct 4 Date
☐ APPROVED ☐ REQUEST APPROVAL

[Signature] 09-12-17
County Judge Date
☒ APPROVED

CHANGE ORDER NUMBER: 2

TABLE A: Force Account Work and Materials Placed into Stock

[illegible]

TABLE B: Contract Items:

TABLE B: Contract Items:									
ITEM	DESCRIPTION	UNIT	UNIT PRICE	ORIGINAL + PREVIOUSLY REVISED		ADD or (DEDUCT)	NEW		OVERRUN/ UNDERRUN
				QUANTITY	ITEM COST		QUANTITY	ITEM COST	
485-WC01	DROP INLET (SPECIAL)	EA	\$7,500.00	0.00	\$0.00		1.00	\$7,500.00	\$7,500.00
466-6179	WINGWALL (PW-1)(HW=4 FT)	EA	\$4,950.00	1.00	\$4,950.00	(1.00)	0.00	\$0.00	(\$4,950.00)
J101-1	16" C-905, DR-18 PVC PIPE; W/ TRACER WIRE; INSTALLED	LF	\$68.00	10,874.00	\$739,432.00	(40.00)	10,834.00	\$736,712.00	(\$2,720.00)
J101-7	24" STEEL ENC. PIPE, BORED W/ 16" C-905, DR 18 RJ CARRIER PIPE; INSTALLED	LF	\$570.00	930.00	\$530,100.00	50.00	980.00	\$558,600.00	\$28,500.00
J101-8	24" HDPE DUAL WALL ENC. PIPE; BORED W/ 16" C-905, DR 18 RJ CARRIER PIPE; INSTALLED	LF	\$525.00	50.00	\$26,250.00	(50.00)	0.00	\$0.00	(\$26,250.00)
J101-22	CONNECT EXISTING 2" TO NEW 8"; INSTALLED	EA	\$800.00	1.00	\$800.00	1.00	2.00	\$1,600.00	\$800.00
J101-40	TRENCH SAFETY	LF	\$11.00	11,478.00	\$11,478.00	(40.00)	11,438.00	\$11,438.00	(\$40.00)
TOTALS					\$1,313,010.00			\$1,315,850.00	\$2,640.00

CHANGE ORDER REASON(S) CODE CHART

1. Design Error or Omission	1A. Incorrect PS&E 1B. Other
2. Differing Site Conditions (unforeseeable)	2A. Dispute resolution (expense caused by conditions and/or resulting delay) 2B. Unavailable material 2C. New development (conditions changing after PS&E completed) 2D. Environmental remediation 2E. Miscellaneous difference in site conditions (unforeseeable)(Item 9) 2F. Site conditions altered by an act of nature 2G. Unadjusted utility (unforeseeable) 2H. Unacquired Right-of-Way (unforeseeable) 2I. Additional safety needs (unforeseeable) 2J. Other
3. County Convenience	3A. Dispute resolution (not resulting from error in plans or differing site conditions) 3B. Public relations improvement 3C. Implementation of a Value Engineering finding 3D. Achievement of an early project completion 3E. Reduction of future maintenance 3F. Additional work desired by the County 3G. Compliance requirements of new laws and/or policies 3H. Cost savings opportunity discovered during construction 3I. Implementation of improved technology or better process 3J. Price adjustment on finished work (price reduced in exchange for acceptance) 3K. Addition of stock account or material supplied by state provision 3L. Revising safety work/measures desired by the County 3M. Other
4. Third Party Accommodation	4A. Failure of a third party to meet commitment 4B. Third party requested work 4C. Compliance requirements of new laws and/or policies (impacting third party) 4D. Other
5. Contractor Convenience	5A. Contractor exercises option to change the traffic control plan 5B. Contractor requested change in the sequence and/or method of work 5C. Payment for Partnering workshop 5D. Additional safety work/measures desired by the contractor 5E. Other
6. Untimely ROW/Utilities	6A. Right-of-Way not clear (third party responsibility for ROW) 6B. Right-of-Way not clear (County responsibility for ROW) 6C. Utilities not clear 6D. Other

Williamson County Road Bond Program

**County Road 110 South
Williamson County Project No. 1604-075**

Change Order No. 2

Reason for Change

This Change Order substitutes a wingwall with a special drop inlet due to safety slope reasons. The proposed culvert upstream flowline was approximately 4' below ditch profile grades, which would have resulted in an extremely steep backslope at the end of the culvert. This Change Order also addresses over-runs and under-runs for various waterline components and includes substituting the HDPE bore pipe for steel encasement pipe at the request of Seminole Pipeline.

The following new Contract items are required for the required inlet substitution. The unit rates submitted by the Contractor are consistent with the TxDOT average low bid unit prices.

Following is a summary of new items required for this Change Order.

ITEM	DESCRIPTION	QTY	UNIT
465-WC01	DROP INLET (SPECIAL)	1	EA

This Change Order results in a net increase of \$2,840.00 to the Contract amount, for an adjusted Contract total of \$11,221,591.71. The original Contract amount was \$11,224,589.02. Because of this and all Change Orders to-date, \$2,997.31 has been deducted from the Contract, resulting in a 0.03% net decrease in the Contract cost. No additional days will be added to or deducted from the Contract as a result of this Change Order.

HNTB Corporation

James Klotz, P.E.



REQUEST FOR INFORMATION FORM

RFI NO.: 18 Culverts 4 & 5
PROJECT: CR 110 South 1604-075
TO: Tommy Levario, Dannenbaum

DATE: 6/23/17
RESPONSE REQUESTED BY
DATE: 6/28/17

REFERENCE: Plan Sheet 154 and Cross Section sheets 71 & 80

PROBLEM: Culvert Flow lines are 2 to 3' lower than ditch lines shown in the cross sections, creating much deeper back slopes. ROW location on sheet 154 for culvert 5 does not match cross sections.

RECOMMENDED SOLUTION:

Delete parallel wingwalls for Culverts 4 & 5, replace with drop inlets. Reconfigure ditch grades to accommodate drainage upstream and downstream in east ditch line.

David Boone
Originator

James Klotz
Supervisor

RESPONSE:

Please refer to culvert grading shown on sheet 156 for structure 5. Sheet 154 has been revised to show a grate inlet on upstream side of structure 4.

Rafael Beckmann
Responder

7/10/2017

Date

Sign, Date & Return to HNTB via e-mail or fax.

Mail original to: HNTB Corporation
101 E. Old Settlers Blvd.
Ste. 100
Round Rock, TX 78664
Attachments to RFI: Revised Sheet 154, Drop inlet detail
Cc:

3'-0" x 4'-6" x 4'-6" I.D.
Modified TxDOT Type 1 Drop Inlet
(Techline~CR 110 South)

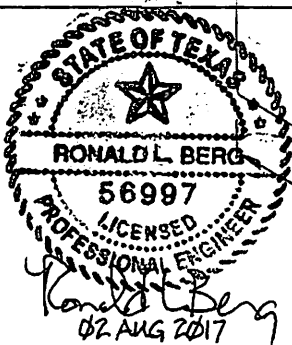
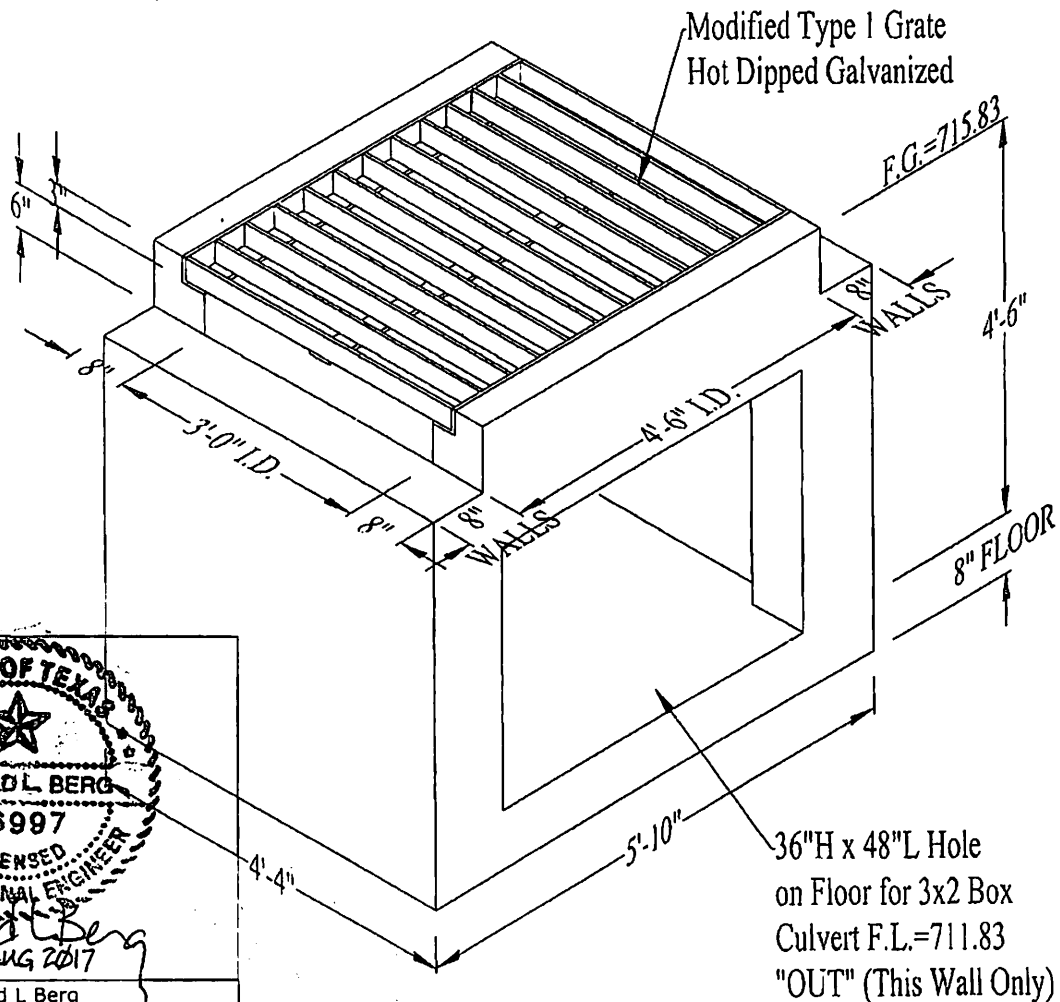

Ronald L. Berg
 Engineering Services, LLC
 Texas Registered Firm F-1507

GENERAL NOTES:

- All concrete to have 28 day compressive strength of 5,000psi.
- Reinforcing steel shall comply with ASTM A615 Grade 60.
- Bar bending and placement shall comply with latest ACI standards.
- Design based on AASHTO HS 20-44 loading.



CAPITAL PRECAST, INC.

6905 SOUTH OLD BASTROP HWY
 SAN MARCOS, TEXAS 78666
 PH. (830) 606-6200

FOR 3' x 4'-6" x 4'-6" Modified TxDOT Ty 1 Drop Inlet			
JOB Techline ~ CR 110 South (17-17894)			
DRAWN DK	DATE 07/25/17	Rev. No.	SHEET
FILE: Removable Disk(G:\ModifiedTxDOT Type1 DropInlet\Glenn.dwg)			
1 of 1			

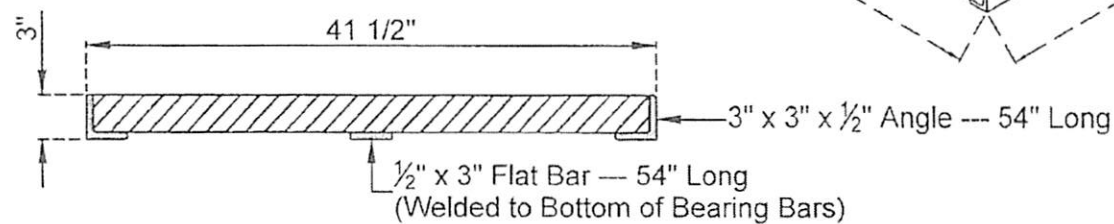
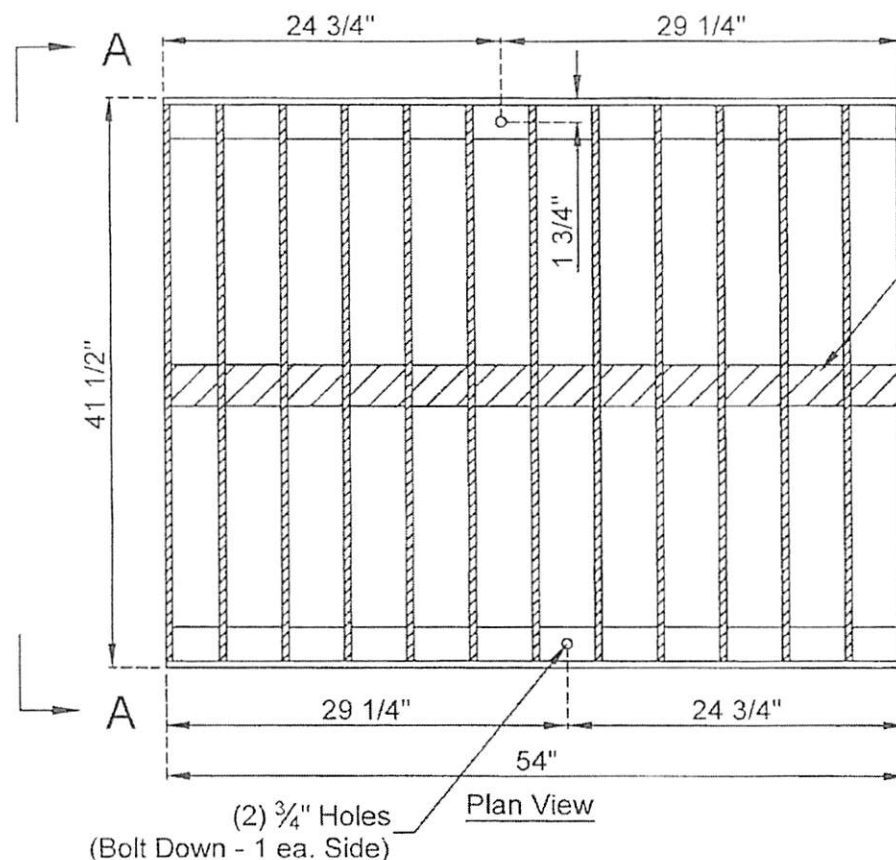

TYPE I Grate
MODIFIED
41 1/2" x 54" O.D.
Tx. D.O.T.

1/2" x 3" Flat Bar --- 54" Long
(Welded to Bottom of Bearing Bar)

(13) 1/2" x 2 1/2" Bearing Bars
(Equally Spaced)

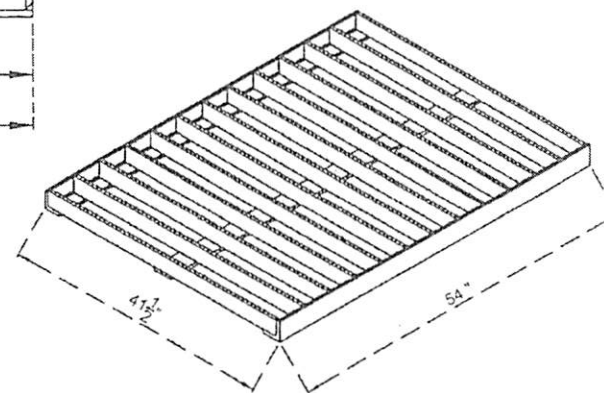

Note:
1. ASTM A-36
Steel Construction
2. Hot Dip Galvanized
(ASTM A 123/ A)

Galvanized Steel Grate
Type I Grate Modified (41 1/2" x 54" O.D.)
K&B Steel
E-Mail: kbsteel@valnet.com
525 Industrial Blvd. Clarksville, Texas 75426
Phone: (903) 427-3980 FAX: (903) 427-5817



(Date: 07-25-17)



Change Proposal Pricing Sheet

County Road 110 South
 Chasco Project No: 16169
 Engineer Project No: 4862
 17 August 2017

Chasco CP No: 06 - DROP INLET AT STRUCTURE 4

Arch. PR No: na

Prepared by:

Kellin Neiman/acr

Description: Drop inlet

ITEM	Cost code	DESCRIPTION	Qty	Unit	LABOR		MATERIALS		SUBCONTRACT		
					UNIT	TOTAL	UNIT	TOTAL	UNIT	TOTAL	TOTAL
		LABOR & EQUIPMENT	1	LS	0.00	\$0	0.00	\$0	500.00	\$500	\$500
		PRECAST INLET - TECHLINE	1	EA	0.00	\$0	4700.00	\$4,700	0.00	\$0	\$4,700
		RIP RAP APRON	1	LS	0.00	\$0	0.00	\$0	960.00	\$960	\$960
		BEDDING	1	LS	0.00	\$0	216.00	\$216	0.00	\$0	\$216
		SPOILS REMOVAL	1	LS	0.00	\$0	0.00	\$0	146.00	\$146	\$146
		SUBTOTALS				\$0	0.00	\$4,916	0.00	\$1,606	\$6,522

Further description:

Overhead & Profit
 Sales Tax Materials (only)
 Total

15.00%
 0.00%

\$978
 \$0
 \$7,500



Quoted by: Rees Winstead
rw@techlinepipe.com
512.468.1243

Techline Pipe, L.P.
2259 Innovation Blvd.
Hutto, TX 78634
www.techlinepipe.com

PROJECT: CR110 CHASCO CUSTOM INLET
JURIS:
BID DATE:
ADDENDA:
SUBMITTED: 8.17.17

Quantities and sizes represented in this quote are based on Techline Pipe's interpretation of the plans. Contractor is responsible for verifying final quantities and sizes. All pricing is FOB Jobsite. The price of PVC Pipe and steel casing is subject to change based on the market price in effect at time of shipment. Other pricing firm for 30 days from date the quote is submitted to customer unless otherwise expressly written. For complete terms and conditions please see <http://www.techlinepipe.com/disclaimer.htm>

	<u>DESCRIPTION</u>	<u>QTY</u>	<u>UNIT</u>	<u>PRICE</u>	<u>EXT PRICE</u>
1	3' X 4.5' X 4.5' CUSTOM DROP INTLET, MOD GRATE	1	EA	4696.33	4696.33

END OF QUOTE



Change Proposal Unit Cost Pricing Sheet

County Project No: 1604-076 CR110S

Chasco Project No: 16169

Engineer Project No: 4862

Chasco CP No: 06 - DROP INLET AT STRUCTURE 4

03 August 2017

Owner PR No:

Description: DELETE WINGWALL AND USE DROP INLET AT STRUCTURE 4

BASED ON DOCUMENTS: RFI 18 DATED 7/10/17, SHEET 154 DATED 7/10/17, TYPICAL DETAIL SHEET FOR TY 1 DROP INLET

BID ITEM NO	TECH SPEC	DESCRIPTION	QTY	UNIT	UNIT PRICE	TOTAL
53	466-6179	WINGWALL (PW - 1) (HW=4 FT)	-1	EA	\$4,950.00	(\$4,950.00)
		TOTAL				(\$4,950.00)

CHANGE ORDER - NEW ITEMS

CP 6		DROP INLET	1	EA	\$7,500.00	\$7,500.00
		TOTAL				\$7,500.00

TOTAL **\$2,550.00**

TIME EXTENSION REQUEST:



REQUEST FOR INFORMATION FORM

RFI NO.: 006 DATE: 4/18/17
PROJECT: Williamson County CR 110 South RESPONSE REQUESTED BY
Wilco No. 1604-075 DATE: 4/20/17
TO: Dave Thomas, Project email, Dawn Haggard, Eddie Church

REFERENCE: Sheet 21 & Excerpt from Sheet 21 with Contractor comments

PROBLEM:

1) The existing 24" Waterline is 21' further north of the gas line. 2) Enterprise Representative for gas line will allow a 5' clearance between the bottom of their pipe to the top of the proposed 24" casing. 3) The gas company requested that the casing be steel, in lieu of HDPE.

RECOMMENDED SOLUTION:

We would like to propose the following: 1) Raise the elevation of the proposed bore to within 5' clearance of the gas line. 2) Tie Straight into existing 24" waterline in lieu of using the 90 degree bends. 3) Steel can be used and installed at the contract unit price.

Kellin Neiman / acr
Originator

N/A
Supervisor

RESPONSE:

Everything shown in the below document is as how Chasco and myself have discussed.
I recommend approval.

Miles Whitney
Responder

4/19/17
Date

Sign, Date & Return to HNTB via e-mail.

Mail original to: **NA** HNTB Corporation
101 E. Old Settlers Blvd. Suite 100
Round Rock, Texas 78664

Attachments to RFI:
Cc:



Change Proposal Unit Cost Pricing Sheet

County Project No: 1604-075 CR110S

Chasco Project No: 16169

Engineer Project No: 4862

Chasco CP No: 04 - REVISIONS TO WATER LINE CROSSING UNDER GAS LINE

Owner PR No: _____

Description: DELETE 24" HDPE CASING AND USE 24" STEEL CASING. TIE-IN STRAIGHT AS SHOWN ON PLAN SHEET 21 DATED 5/5/17
(SHORTENED LENGTH OF 16" PVC FROM ORIGINAL PLAN

BASED ON DOCUMENTS: RFI #6 PLAN SHEET 21 DATED 5/5/17

BID ITEM NO	TECH SPEC	DESCRIPTION	QTY	UNIT	UNIT PRICE	TOTAL
142	J101-1	16" C-905, DR-18 PVC PIPE; W/ TRACER WIRE, INSTALLED	-40	LF	\$68.00	(\$2,720.00)
148	J101-7	24" STEEL ENC. PIPE, BORED WITH 16" C-905, DR-18 RJ CARRIER PIPE; INSTALLED	50	LF	\$570.00	\$28,500.00
149	J101-8	24" HDPE DUAL WALL ENC. PIPE; BORED WITH 16" C-905, DR-18 RJ CARRIER PIPE; INSTALLED	-50	LF	\$525.00	(\$26,250.00)
181	J101-40	TRENCH SAFETY	-40	LF	\$1.00	(\$40.00)
		TOTAL				(\$610.00)



Change Proposal Unit Cost Pricing Sheet

County Project No: 1604-075 CR110S

Chasco Project No: 16169

Engineer Project No: 4862

Chasco CP No: 05 - ADD 2" WATER CONNECTION AT STATION 106

Owner PR No:

Description: INSTALL 2" WATER CONNECTION AT STATION 106+

BASED ON DOCUMENTS: JONAH WATER PLAN SHEET 19

BID ITEM NO	TECH SPEC	DESCRIPTION	QTY	UNIT	UNIT PRICE	TOTAL
163	J101-22	CONNECT EXISTING 2" TO NEW 8"; INSTALLED	1	EA	\$800.00	\$800.00
		TOTAL				\$800.00