

Received

Received

JUL 12 2018

JUL 05 2018

WILLIAMSON COUNTY, TEXAS

CHANGE ORDER NUMBER: B 4 Corporation
Round Rock

HNTB Corporation
Round Rock

1. CONTRACTOR: Cox Commercial Construction
Oaklands Drive north of RM 620
2. Change Order Work Limits: Sta. 1+80 to Sta. 3+50
3. Type of Change (on federal-aid non-exempt projects): Minor (Major/Minor)
4. Reasons: 3F (3 Max. - In order of importance - Primary first)

Project: 1608-108

Roadway: RM 620 Ph2

CSJ
Number: 0683-01-090

5. Describe the work being revised:

3F: County Convenience. Additional work desired by the County. This Change Order adds the removal of the raised center median on Oaklands at RM 620 and lengthens the inside left turn lane. This work was requested by the County.

6. Work to be performed in accordance with Items: See attached
7. New or revised plan sheet(s) are attached and numbered: Revised Plan sheet 132, Plan Profile.
8. New Special Provisions/Specifications to the contract are attached: No
9. New Special Provisions to Item N/A No. N/A, Special Specification Item N/A are attached.

Each signatory hereby warrants that each has the authority to execute this Change Order (CO).

<p><small>The contractor must sign the Change Order and, by doing so, agrees to waive any and all claims for additional compensation due to any and all other expenses; additional changes for time, overhead and profit, or loss of compensation as a result of this change.</small></p> <p>THE CONTRACTOR <u>[Signature]</u> Date <u>7/6/18</u></p> <p>By <u>[Signature]</u></p> <p>Typed/Printed Name <u>DARREN OKENFELT</u></p> <p>Typed/Printed Title <u>SR. VP</u></p>	<p>The following information must be provided</p> <p>Time Ext. #: <u>N/A</u> Days added on this CO: <u>0</u></p> <p>Amount added by this change order: <u>\$22,736.80</u></p>
--	--

RECOMMENDED FOR EXECUTION:

[Signature] P.R. 7/10/18
Project Manager Date

County Commissioner Precinct 1 Date
☐ APPROVED ☐ REQUEST APPROVAL

N/A
Design Engineer Date

County Commissioner Precinct 2 Date
☐ APPROVED ☐ REQUEST APPROVAL

[Signature] 7/11/18
Program Manager Date

County Commissioner Precinct 3 Date
☐ APPROVED ☐ REQUEST APPROVAL

Design Engineer's Seal:

See attached plan sheets

County Commissioner Precinct 4 Date
☐ APPROVED ☐ REQUEST APPROVAL

[Signature] 07-25-18
County Judge Date
☒ APPROVED

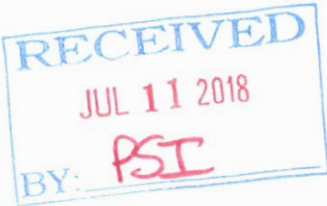

Received

Received

JUL 12 2018

JUL 06 2018

WILLIAMSON COUNTY, TEXAS

CHANGE ORDER NUMBER: 1608-108
HNTB Corporation
Round Rock

HNTB Corporation
Round Rock

1. CONTRACTOR: Cox Commercial Construction
Oaklands Drive north of RM 620
2. Change Order Work Limits: Sta. 1+80 to Sta. 3+50
3. Type of Change (on federal-aid non-exempt projects): Minor (Major/Minor)
4. Reasons: 3F (3 Max. - In order of importance - Primary first)

Project:	<u>1608-108</u>
Roadway:	<u>RM 620 Ph2</u>
CSJ Number:	<u>0683-01-090</u>

5. Describe the work being revised:

3F: County Convenience. Additional work desired by the County. This Change Order adds the removal of the raised center median on Oaklands at RM 620 and lengthens the inside left turn lane. This work was requested by the County.

6. Work to be performed in accordance with Items: See attached
7. New or revised plan sheet(s) are attached and numbered: Revised Plan sheet 132, Plan Profile.
8. New Special Provisions/Specifications to the contract are attached: No
9. New Special Provisions to Item N/A No. N/A, Special Specification Item N/A are attached.
- Each signatory hereby warrants that each has the authority to execute this Change Order (CO).

The contractor must sign the Change Order and, by doing so, agrees to waive any and all claims for additional compensation due to any and all other expenses; additional changes for time, overhead and profit; or loss of compensation as a result of this change.

The following information must be provided

Time Ext. #: N/A Days added on this CO: 0

Amount added by this change order: \$22,736.80

THE CONTRACTOR Date 7/6/18

By [Signature]

Typed/Printed Name DARREN OLSEN

Typed/Printed Title SR. VP

RECOMMENDED FOR EXECUTION:

[Signature] P.E. 7/10/18
Project Manager Date

N/A
Design Engineer Date

[Signature] 7/11/18
Program Manager Date

Design Engineer's Seal:

See attached plan sheets

County Commissioner Precinct 1 Date
☐ APPROVED ☐ REQUEST APPROVAL

County Commissioner Precinct 2 Date
☐ APPROVED ☐ REQUEST APPROVAL

County Commissioner Precinct 3 Date
☐ APPROVED ☐ REQUEST APPROVAL

County Commissioner Precinct 4 Date
☐ APPROVED ☐ REQUEST APPROVAL

County Judge Date
☐ APPROVED

WILLIAMSON COUNTY, TEXAS

CHANGE ORDER NUMBER: 4

Project # 1608-108

TABLE A: Force Account Work and Materials Placed into Stock

	LABOR	HOURLY RATE			HOURLY RATE

TABLE B: Contract Items:

				ORIGINAL + PREVIOUSLY REVISED		ADD or (DEDUCT)	NEW		
ITEM	DESCRIPTION	UNIT	UNIT PRICE	QUANTITY	ITEM COST	QUANTITY	QUANTITY	ITEM COST	OVERRUN/ UNDERRUN
104-6022	REMOVING CONC (CURB AND GUTTER)	LF	\$8.00	1,549.00	\$12,392.00	296.00	1,845.00	\$14,760.00	\$2,368.00
110-6001	EXCAVATION(ROADWAY)	CY	\$16.50	8,997.00	\$148,450.50	28.00	9,025.00	\$148,912.50	\$462.00
340-6011A	D-GR HMA (SQ) TY-B PG 64-22 (8")	TON	\$125.14	0.00	\$0.00	70.00	70.00	\$8,759.80	\$8,759.80
340-6122	D-GR HMA (SQ) TY-D PG 70-22 (2")	TON	\$191.95	0.00	\$0.00	18.00	18.00	\$3,455.10	\$3,455.10
500-WC01	MOBILIZATION (OAKLANDS)	LS	\$5,462.00	0.00	\$0.00	1.00	1.00	\$5,462.00	\$5,462.00
666-6054	REFL PAV MRK TY I (W)(ARROW)(100MIL)	EA	\$100.00	35.00	\$3,500.00	3.00	38.00	\$3,800.00	\$300.00
666-6078	REFL PAV MRK TY I (W)(WORD)(100MIL)	EA	\$120.00	33.00	\$3,960.00	3.00	36.00	\$4,320.00	\$360.00
666-6167	REFL PAV MRK TY I (W)4" (BRK)	LF	\$0.20	4,110.00	\$822.00	129.00	4,239.00	\$847.80	\$25.80
666-6178	REFL PAV MRK TY II (W)8"(SLD)	LF	\$0.30	7,203.00	\$2,160.90	159.00	7,362.00	\$2,208.60	\$47.70
666-6182	REFL PAV MRK TY II (W) 24"(SLD)	LF	\$3.00	419.00	\$1,257.00	7.00	426.00	\$1,278.00	\$21.00
666-6184	REFL PAV MRK TY II (W)(ARROW)	EA	\$70.00	37.00	\$2,590.00	3.00	40.00	\$2,800.00	\$210.00
666-6192	REFL PAV MRK TY II (W)(WORD)	EA	\$90.00	35.00	\$3,150.00	3.00	38.00	\$3,420.00	\$270.00
666-6207	REFL PAV MRK TY II (Y)4"(SLD)	LF	\$0.20	2,376.00	\$475.20	292.00	2,668.00	\$533.60	\$58.40
666-6300	RE PM W/RET REQ TY I (W)4"(BRK)(100MIL)	LF	\$1.00	4,110.00	\$4,110.00	129.00	4,239.00	\$4,239.00	\$129.00
672-6009	REFL PAV MRKR TY II-A-A	EA	\$4.00	37.00	\$148.00	10.00	47.00	\$188.00	\$40.00
672-6010	REFL PAV MRKR TY I-C-R	EA	\$4.00	459.00	\$1,836.00	18.00	477.00	\$1,908.00	\$72.00
677-6003	ELIM EXT PAV MRK & MRKR(8")	LF	\$1.00	382.00	\$382.00	96.00	478.00	\$478.00	\$96.00
677-6008	ELIM EXT PAV MRK & MRKR(ARROW)	EA	\$150.00	1.00	\$150.00	2.00	3.00	\$450.00	\$300.00
677-8012	ELIM EXT PAV MRK & MRKR(WORD)	EA	\$150.00	0.00	\$0.00	2.00	2.00	\$300.00	\$300.00
	TOTALS				\$185,383.60			\$208,120.40	\$22,736.80

CHANGE ORDER REASON(S) CODE CHART

1. Design Error or Omission	1A. Incorrect PS&E 1B. Other
2. Differing Site Conditions (unforeseeable)	2A. Dispute resolution (expense caused by conditions and/or resulting delay) 2B. Unavailable material 2C. New development (conditions changing after PS&E completed) 2D. Environmental remediation 2E. Miscellaneous difference in site conditions (unforeseeable)(Item 9) 2F. Site conditions altered by an act of nature 2G. Unadjusted utility (unforeseeable) 2H. Unacquired Right-of-Way (unforeseeable) 2I. Additional safety needs (unforeseeable) 2J. Other
3. County Convenience	3A. Dispute resolution (not resulting from error in plans or differing site conditions) 3B. Public relations improvement 3C. Implementation of a Value Engineering finding 3D. Achievement of an early project completion 3E. Reduction of future maintenance 3F. Additional work desired by the County 3G. Compliance requirements of new laws and/or policies 3H. Cost savings opportunity discovered during construction 3I. Implementation of improved technology or better process 3J. Price adjustment on finished work (price reduced in exchange for acceptance) 3K. Addition of stock account or material supplied by state provision 3L. Revising safety work/measures desired by the County 3M. Other
4. Third Party Accommodation	4A. Failure of a third party to meet commitment 4B. Third party requested work 4C. Compliance requirements of new laws and/or policies (impacting third party) 4D. Other
5. Contractor Convenience	5A. Contractor exercises option to change the traffic control plan 5B. Contractor requested change in the sequence and/or method of work 5C. Payment for Partnering workshop 5D. Additional safety work/measures desired by the contractor 5E. Other
6. Untimely ROW/Utilities	6A. Right-of-Way not clear (third party responsibility for ROW) 6B. Right-of-Way not clear (County responsibility for ROW) 6C. Utilities not clear 6D. Other

Williamson County Road Bond Program

**RM 620 Phase 2
Williamson County Project No. 1608-108**

Change Order No. 4

Reason for Change

This Change Order adds the removal of the raised center median on Oaklands at RM 620 and lengthens the inside left turn lane. This work was requested by the County.

Following is a summary of the new items required for this Change Order.

ITEM	DESCRIPTION	QTY	UNIT
340-6011A	D-GR HMA (SQ) TY B PG 64-22 (8")	70.00	TON
340-6122	D-GR HMA (SQ) TY D PG 70-22 (2")	18.00	TON
500-WC01	MOBILIZATION (OAKLANDS)	1.00	LS
677-8012	ELIM EXT PAV MRK &MRKR(WORD)	2.00	EA

This Change Order results in an increase of \$22,736.80 to the Contract amount, for an adjusted Contract total of \$6,280,578.73. The original Contract amount was \$6,082,225.70. Because of this and previous Change Orders to date, \$198,353.03 has been added to the Contract, resulting in a 3.26% net increase in the Contract cost. No days will be added to the Contract as a result of this Change Order. To date a total of Thirty (30) days have been added to the Contract.

HNTB Corporation
James Klotz, P.E.

						ORIGINAL + PREVIOUSLY REVISED		ADD or (DEDUCT)	NEW		OVERRUN/ UNDERRUN
	ITEM		DESCRIPTION	UNIT	UNIT PRICE	QUANTITY	ITEM COST	QUANTITY	QUANTITY	ITEM COST	
5	104	6022	REMOVING CONC (CURB AND GUTTER)	LF	\$ 8.00	1,702.0	\$13,616.00	296.0	1,998.0	\$15,984.00	\$2,368.00
8	110	6001	EXCAVATION (ROADWAY)	CY	\$ 16.50	8,997.0	\$148,450.50	28.0	9,025.0	\$148,912.50	\$462.00
21	340	6011	D-GR HMA(SQ) TY-B PG64-22	TON	\$ 125.14	478.2	\$59,841.95	70.0	548.2	\$68,601.75	\$8,759.80
23	341	6040	D-GR HMA TY-D PG64-22	TON	\$ 191.95	3,351.0	\$643,224.45	18.0	3,369.0	\$646,679.55	\$3,455.10
72	500	6001	MOBILIZATION	LS	\$ 1.00	406,552.0	\$406,552.00	5,462.0	412,014.0	\$412,014.00	\$5,462.00
122	666	6178	REFL PAV MRK TY II (W) 8" (SLD)	LF	\$ 0.30	7,189.0	\$2,156.70	159.0	7,348.0	\$2,204.40	\$47.70
124	666	6182	REFL PAV MRK TY II (W) 24" (SLD)	LF	\$ 3.00	419.0	\$1,257.00	7.0	426.0	\$1,278.00	\$21.00
125	666	6054	REFL PAV MRK TY I (W)(ARROW)(100MIL)	EA	\$ 100.00	35.0	\$3,500.00	3.0	38.0	\$3,800.00	\$300.00
126	666	6078	REFL PAV MRK TY I (W)(WORD)(100MIL)	EA	\$ 120.00	33.0	\$3,960.00	3.0	36.0	\$4,320.00	\$360.00
127	666	6167	REFL PAV MRK TY II (W) 4" (BRK)	LF	\$ 0.20	4,119.0	\$823.80	129.0	4,248.0	\$849.60	\$25.80
129	666	6184	REFL PAV MRK TY II (W) (ARROW)	EA	\$ 70.00	35.0	\$2,450.00	3.0	38.0	\$2,660.00	\$210.00
130	666	6192	REFL PAV MRK TY II (W) (WORD)	EA	\$ 90.00	33.0	\$2,970.00	3.0	36.0	\$3,240.00	\$270.00
131	666	6207	REFL PAV MRK TY II (Y) 4" (SLD)	LF	\$ 0.20	2,376.0	\$475.20	292.0	2,668.0	\$533.60	\$58.40
132	666	6300	RE PM W/RET REQ TY I (W)4"(BRK)(100MIL)	LF	\$ 1.00	4,119.0	\$4,119.00	129.0	4,248.0	\$4,248.00	\$129.00
134	672	6009	REFL PAV MRKR TY II-A-A	EA	\$ 4.00	37.0	\$148.00	10.0	47.0	\$188.00	\$40.00
135	672	6010	REFL PAV MRKR TY II-C-R	EA	\$ 4.00	458.0	\$1,832.00	18.0	476.0	\$1,904.00	\$72.00
137	677	6003	ELIM EXT PAV MRK & MRKS (8")	LF	\$ 1.00	70.0	\$70.00	96.0	166.0	\$166.00	\$96.00
138	677	6008	ELIM EXT PAV MRK & MRKS (ARROW)	EA	\$ 150.00	1.0	\$150.00	2.0	3.0	\$450.00	\$300.00
new	677	6012	ELIM EXT PAV MRK & MRKS (WORD)	EA	\$ 150.00	0.0	\$0.00	2.0	2.0	\$300.00	\$300.00
TOTALS							\$1,295,596.60			\$1,318,333.40	\$22,736.80

U/P FROM CO #3
U/P FROM CO #3

PROJECT: RM 620 PH. II
ITEM NUMBER/DESC.: OAKLAND MEDIAN REVISION - MOBILIZATION
ESTIMATED QUANTITY: 1 LS
Date Prepared: 6/18/2018

ITEM DESCRIPTION	QTY	UNIT COSTS						TOTAL COSTS				
		UNIT	LABOR	EQUIP	MATERIAL	SUBCT.	O.T.Factor	LABOR	EQUIP	MATERIAL	SUBCT.	MISC.
LABOR	#											
MATERIAL												
EQUIPMENT												
SUBCONTRACT												
A.M. MOBILIZATION	1.00	EA				\$ 4,500.00					\$ 4,500.00	
JD 290 EXC. - EQUIP. MOVE	1.00	EA				\$ 325.00					\$ 325.00	
JD 75 EXC. - EQUIP. MOVE	1.00	EA				\$ 325.00					\$ 325.00	
TOTALS								\$ -	\$ -	\$0.00	\$ 5,150.00	\$ -

TOTAL LABOR				\$ -	
TOTAL MATERIAL				\$ -	
TOTAL SUBCONTRACT				\$ 5,150.00	
TOTAL EQUIPMENT				\$ -	
MARKUPS					
LABOR BURDENS	\$ -	@	55%	\$ -	
LABOR MARK-UP	\$ -	@	25%	\$ -	
MATERIAL MARK-UP	\$ -	@	25%	\$ -	
EQUIPMENT MARK-UP	\$ -	@	15%	\$ -	
SUBCONTRACT MARK-UP	\$ 5,150.00	@	5%	\$ 257.50	
PERFORMANCE BOND	\$ 5,407.50	@	1%	\$ 54.08	
			TOTAL	\$ 5,461.58	
			QUANTITY	1 LS	
			UNIT COST	\$ 5,462.00 / LS	

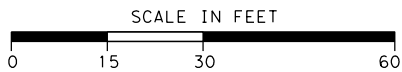
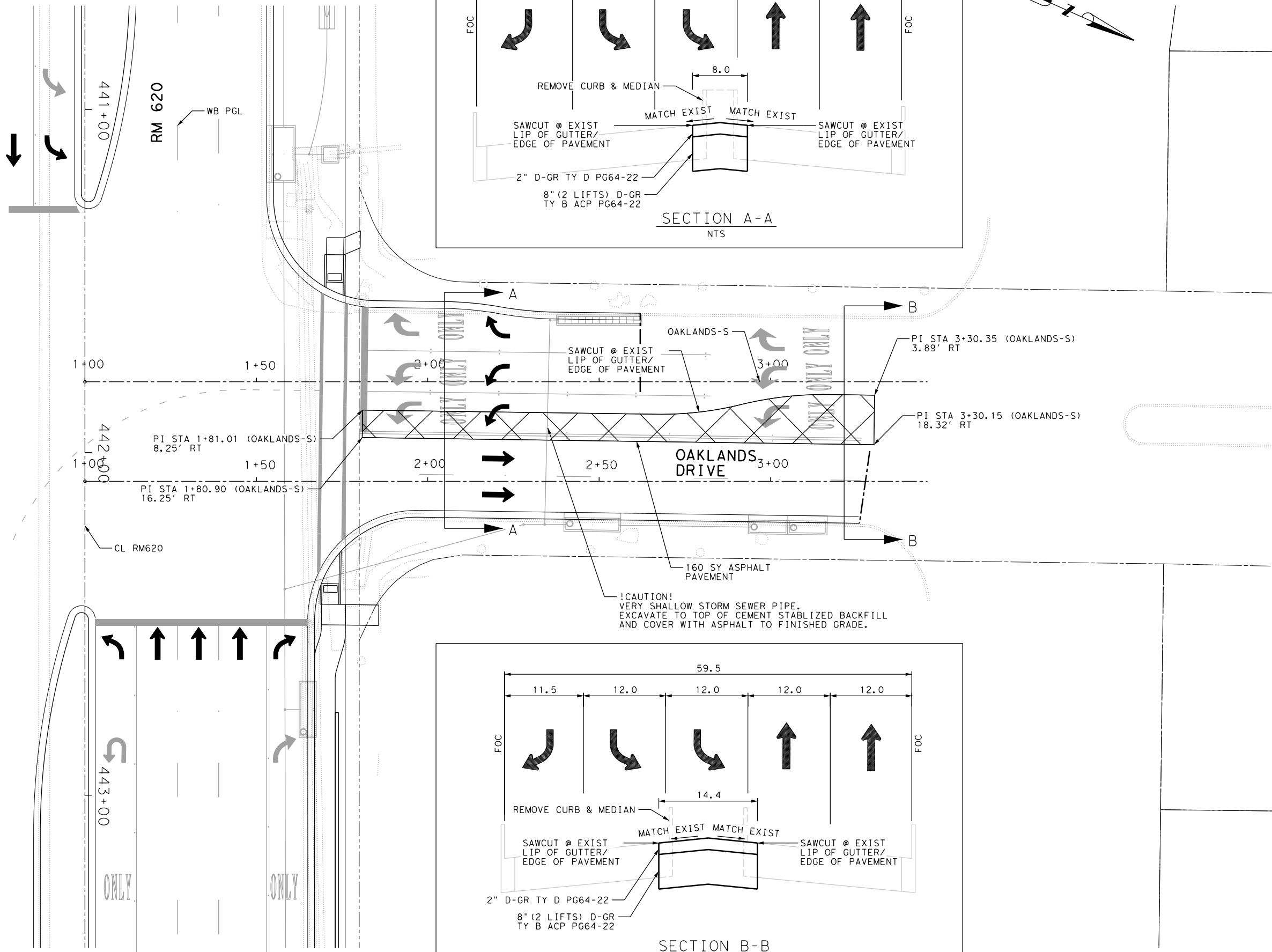

LEGEND

- EXISTING R.O.W.
- TEMPORARY CONSTRUCTION EASEMENT
- MEDIAN REMOVAL & ASPHALT REPLACEMENT

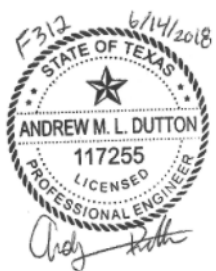

HALFF 4030 WEST BRAKER LANE, SUITE 450
AUSTIN, TEXAS 78759-5356
TEL (512) 252-8184
FAX (512) 252-8141
TBP# FIRM NO. F-312

©2016 Texas Department of Transportation



RM 620

PLAN

OAKLANDS DRIVE MODIFICATIONS

SCALE: 1"=30'				SHEET 1 OF 1			
Designed: ER	CD: NO	STATE	FEDERAL AID PROJECT NO.	HIGHWAY NO.			
Checked: ER	X	TEXAS		RM 620			
Drawn: ND	DIST.	COUNTY	CONTROL NO.	SECTION NO.	JOB NO.	SHEET NO.	
Checked: ER	AUS	WILLIAMSON	0683	01	090	132A	

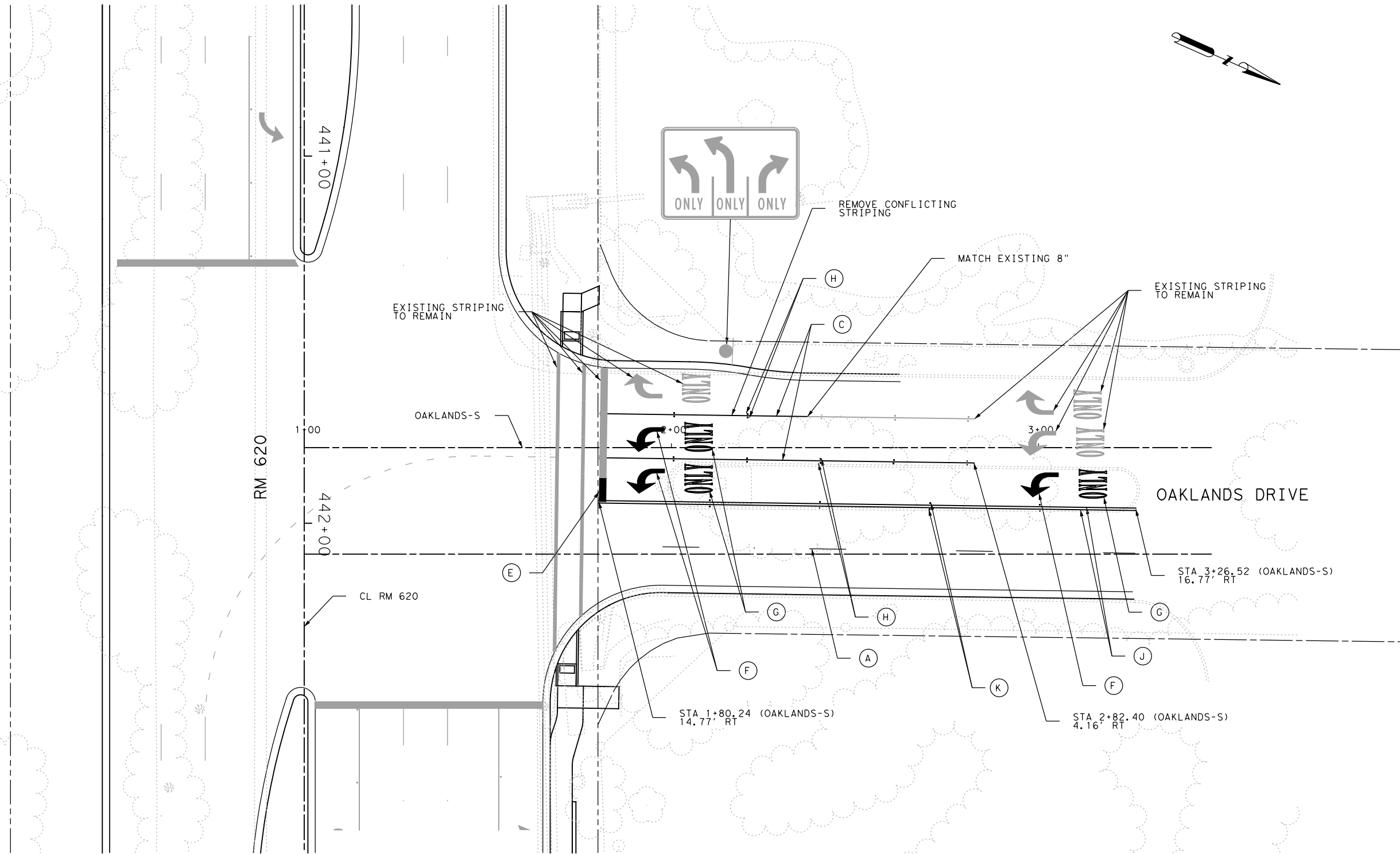

LEGEND

- (A) REFL PAV MRK TYP I (W) (BRK) (4")
- (B) REFL PAV MRK TYP I (W) (SLD) (4")
- (C) REFL PAV MRK TYP I (W) (SLD) (8")
- (D) REFL PAV MRK TYP I (W) (SLD) (12")
- (E) REFL PAV MRK TYP I (W) (SLD) (24")
- (F) REFL PAV MRK TYP I (W) (ARROW)
- (G) REFL PAV MRK TYP I (W) (WORD)
- (H) RAIS PAV MRKR TYP II-C-R
- (I) RAIS PAV MRK TYP I (W) (DOT) (4")
- (J) REFL PAV MRK TYP II (Y) (SLD) (4")
- (K) REFL PAV MRK TYP II-A-A
- (L) INSTL DEL ASSM (D-SW) S21 (FLX) SRF

← DIRECTION OF TRAFFIC

● EXISTING SIGN

● PROPOSED SIGN

— RELOCATE/REMOVE EXISTING SIGN

..... EXISTING FEATURES

--- PROPOSED ROW

--- EXISTING ROW

--- TEMPORARY CONSTRUCTION EASEMENT

NOTES:
1) THE LOCATION AND ORIENTATION OF THE PROPOSED SIGNS, PAVEMENT MARKINGS, PAVEMENT MARKERS, DELINEATORS, AND OBJECT MARKERS SHALL BE IN ACCORDANCE WITH THE STANDARD DETAILS INCLUDED HEREIN AND THE TEXAS MUTCD.



NO.	REVISION	BY	DATE
-----	----------	----	------

4030 WEST BRAKER LANE, SUITE 450
AUSTIN, TEXAS 78759-5356
TEL (512) 252-8184
FAX (512) 252-8141
TBPE FIRM NO. F-312



RM 620
SIGNING & PAVEMENT
MARKING LAYOUTS
OAKLANDS DRIVE MODIFICATIONS

SCALE: 1"=50' SHEET 1 OF 1

Designed: ER	ED. NO.	STATE	FEDERAL AID PROJECT NO.	HIGHWAY NO.
Checked: ER	X	TEXAS		RM 620
Drawn: ND	DIST.	COUNTY	CONTROL NO.	SECTION NO.
Checked: ER	AUS	WILLIAMSON	0683	01 090