

**ANTIQUITIES PERMIT APPLICATION FORM
ARCHEOLOGY****GENERAL INFORMATION**

I. PROPERTY TYPE AND LOCATION

Project Name (and/or Site Trinomial) County Road 200, from 400 Feet North of State Highway 29 to
100 Feet South of County Road 201

County (ies) Williamson

USGS Quadrangle Name and Number Liberty Hill (3097-323)

UTM Coordinates Zone 14 E 602044 N 3395033

Location Liberty Hill

Federal Involvement Yes No

Name of Federal Agency _____

Agency Representative _____

II. OWNER (OR CONTROLLING AGENCY)

Owner Williamson County

Representative Bill Gravell, Jr., County Judge

Address 710 S. Main Street, Suite 101

City/State/Zip Georgetown, TX 78626

Telephone (include area code) (512) 943-1550 Email Address bgravell@wilco.org

III. PROJECT SPONSOR (IF DIFFERENT FROM OWNER)

Sponsor _____

Representative _____

Address _____

City/State/Zip _____

Telephone (include area code) _____ Email Address _____

PROJECT INFORMATION

I. PRINCIPAL INVESTIGATOR (ARCHEOLOGIST)

Name Damon Burden

Affiliation Blanton & Associates Inc

Address 5 Lakeway Centre Court, Suite 200

City/State/Zip Austin, TX 78734

Telephone (include area code) 512-264-1095 Email Address damon.burden@blantonassociates.com

(OVER)

ANTIQUITIES PERMIT APPLICATION FORM (CONTINUED)

II. PROJECT DESCRIPTION

Proposed Starting Date of Fieldwork May 2019
Requested Permit Duration 5 Years 0 Months (1 year minimum)
Scope of Work (Provided an Outline of Proposed Work) Attached

III. CURATION & REPORT

Temporary Curatorial or Laboratory Facility Non-Collection Survey
Permanent Curatorial Facility CAR UTSA (Paperwork only)

IV. LAND OWNER'S CERTIFICATION

I, Bill Gravell, Jr., as legal representative of the Land Owner, Williamson County, do certify that I have reviewed the plans and research design, and that no investigations will be performed prior to the issuance of a permit by the Texas Historical Commission. Furthermore, I understand that the Owner, Sponsor, and Principal Investigator are responsible for completing the terms of the permit. Signature [Signature] Date 4/30/19

V. SPONSOR'S CERTIFICATION

I, _____, as legal representative of the Sponsor, _____, do certify that I have reviewed the plans and research design, and that no investigations will be performed prior to the issuance of a permit by the Texas Historical Commission. Furthermore, I understand that the Sponsor, Owner, and Principal Investigator are responsible for completing the terms of this permit. Signature _____ Date _____

VI. INVESTIGATOR'S CERTIFICATION

I, Damon Burden, as Principal Investigator employed by Blanton & Associates (Investigative Firm), do certify that I will execute this project according to the submitted plans and research design, and will not conduct any work prior to the issuance of a permit by the Texas Historical Commission. Furthermore, I understand that the Principal Investigator (and the Investigative Firm), as well as the Owner and Sponsor, are responsible for completing the terms of this permit. Signature [Signature] Date 04/24/2019

Principal Investigator must attach a research design, a copy of the USGS quadrangle showing project boundaries, and any additional pertinent information. Curriculum vita must be on file with the Archeology Division.

FOR OFFICIAL USE ONLY

Reviewer _____ Date Permit Issues _____
Permit Number _____ Permit Expiration Date _____
Type of Permit _____ Date Received for Data Entry _____

April 24, 2019

SCOPE OF WORK
INTENSIVE ARCHEOLOGICAL SURVEY OF COUNTY ROAD 200,
FROM 400 FEET NORTH OF STATE HIGHWAY 29
TO 100 FEET SOUTH OF COUNTY ROAD 201,
WILLIAMSON COUNTY, TEXAS

PROJECT DESCRIPTION

Williamson County is proposing to make improvements to County Road (CR) 200 between approximately 400 feet north of State Highway (SH) 29 to approximately 100 feet south of CR 201 by widening the existing roadway to add shoulders and a center turn lane, providing drainage improvements, and providing at-grade crossing improvements to the Capital Metropolitan Transit Authority (CMTA) railroad crossing at the southern end of the project (**Figures 1 and 2 in Appendix A**). The project drainage improvements consist of two new culvert installations. The project is approximately 0.95 mile in length and encompasses approximately 13.45 acres, including the acquisition of approximately 4.49 acres of proposed new right-of-way (ROW). The proposed roadway would accommodate two 12-foot travel lanes in each direction with a 14-foot center turn lane, and 10-foot shoulders and would be constructed within a ROW width that would vary from 110 feet to 130 feet.

Williamson County will completely fund the proposed improvements, which will not require any residential or commercial displacements. No federal funds, permits, or approvals are required. Because the project involves land owned or controlled by Williamson County (a subdivision of the state), the project is subject to the provisions of the Antiquities Code of Texas.

Based on the above data, the horizontal area of potential effects (APE) for archeological resources for the proposed project is 5,016 feet in length, varies from 110 to 130 feet in width, and encompasses 13.45 acres (8.96 acres of existing ROW and 4.49 acres of new ROW). Based on 90 percent plans, it is estimated that vertical impacts will extend 2 to 3 feet below the ground surface for roadway construction, and up to 10 feet below grade for culverts and storm drains. **Appendix B** contains the project schematic.

BACKGROUND INFORMATION

Blanton & Associates, Inc. (B&A) conducted a background review of data extracted from topographic, physiographic, geology, and soil maps and Google Earth satellite imagery. In addition, the Texas Historical Commission's (THC's) restricted-access Online Archeological Sites Atlas (Atlas) was consulted on March 28, 2019 to identify any previous archeological investigations, documented archeological sites, National Register of Historic Places (NRHP) properties, State Antiquities Landmarks (SALs), Official Texas Historical Markers (OTHMs), Recorded Texas Historic Landmarks (RTHLs), and cemeteries within 1 kilometer (km) (0.6 mile) of the project APE. Historic topographic quadrangle maps were also reviewed to check for historic structures that may or may not be extant within the 1-km study area (U.S. Geological Survey 1893, 1927, 1949, 1954, and 1962). The results of this comprehensive review are presented below.

Topography

Surface topography in the APE is characterized by undulating to gently sloping upland terrain, with elevations that range from 1,055 to 1,108 feet above mean sea level. The highest terrain is at the north end of the APE, where the roadway crosses a dissected, northwest to southeast-aligned ridgetop. Surfaces south of the ridgeline slope south and southwest toward the South San Gabriel River, which is approximately 1 mile to the southwest of the APE. The upper reaches of two southwest-draining, wet-weather tributaries of the South San Gabriel River pass through the south half of the APE.

Geomorphology and Geology

The APE is in the eastern portion of the Edwards Plateau physiographic province, along the leading edge of the Limestone Cut Plain subregion of the Cross Timbers and Prairies ecological region. The stair-stepped surface topography that grossly characterizes the cut plain consists of mesas separated by broad valleys, with flatter topography and lower drainage gradients than is typical of the dissected canyonlands to the south and west. Subsurface geology is typified by Lower Cretaceous formations such as the Glen Rose Formation and the undivided Walnut Formation. Both geologic deposits are mapped across the APE. The Glen Rose Formation mapped across the south half of the APE is characterized by alternating resistant and recessive beds of limestone, dolomite, and marl. The slightly younger Walnut Formation mapped across the north half of the APE is characterized by calcareous clay, thickly-bedded chalky to marly limestone, and thinly-bedded shales (Bureau of Economic Geology 1981, 1996; Griffith et al. 2004; McMahan et al. 1984). These ancient deposits have no potential to contain buried archeological deposits.

Soils

Soil series mapped within the project APE include Eckrant cobbly clay with 1 to 8 percent slopes, Doss silty clay with 1 to 5 percent slopes, Fairlie clay with 1 to 2 percent slopes, and Denton silty clay with 3 to 5 percent slopes. These upland soils are found on the summits, shoulders, and side slopes of ridges and on hill slopes. The Eckrant and Doss soil units are very shallow to shallow, nearly level to very steep, moderately slow to slowly permeable soils over indurated or weakly cemented limestone bedrock. Eckrant and Doss series soils form in residuum derived from marl or limestone substrate. Typical profiles consist of 30 to 48 centimeters (cm) of clays or silty clays over limestone or marlaceous limestone interbedded with silty clay. Fairlie and Denton soils are deep, nearly level to gently sloping, very slowly to slowly permeable soils that form in residuum derived from underlying chalk or weathered limestone bedrock. Typical profiles consist of 105 to 130 cm of silty clays and clay or silty clays, silt loam, and marly sediments over bedrock. Both soil series are subject to shrinking and cracking during dry periods, and cracks may extend more than 50 cm below the ground surface (Soil Web Earth 2019). The formational characteristics of the Eckrant, Doss, Fairlie, and Denton soil series mapped within the project APE, and the ages of the underlying geologic deposits from which they are derived, indicate the mapped soils have little to no potential to contain buried archeological deposits.

Austin Hybrid Potential Archeological Liability Map (HPALM) Recommendations

According to the Austin HPALM data, the following predictive scores for prehistoric site integrity occur within the APE (**Figure 3 in Appendix A**):

1-low potential

5-moderate potential

According to the HPALM, the APE's highest potential for prehistoric archeological deposits – characterized as 5-moderate potential – is in an approximately 100-meter-wide swath across the central portion of the APE. This area corresponds with a mapped unit of Doss silty clay. The remainder of the APE is considered to have a low potential for prehistoric archeological deposits.

Discussion of Previous Work and Sites

The Atlas review revealed no previous archeological investigations, documented archeological sites, or cemeteries in or within 1 kilometer of the APE. However, an OTHM for the First Baptist Church of Liberty Hill is along SH 29, about 0.7 km west of the APE, and a small NRHP District surrounds an NRHP-listed structure – the mid- to late-nineteenth century Bryson Stagecoach Stop – on SH 29 about 0.9 to 1.0 km west of the APE (**Figures 4 and 5 in Appendix A**). The stage stop was listed in the NRHP in 1978.

Review of available historic maps indicates the Austin and Northwestern Railroad (later the Southern Pacific Railroad) passed through or close to the APE (U.S. Geological Survey 1893, 1927, 1949, 1954). In all likelihood, the modern CMTA railroad alignment probably overlaps the late nineteenth-to-twentieth-century railroad alignment, and any indications of historic rail lines and associated features were probably removed/destroyed by subsequent construction and maintenance.

The 1962 Liberty Hill, Texas 7.5-minute Quadrangle depicts several residences with associated outbuildings and other types of structures along the APE. The map depicts a Church of Christ adjacent to existing ROW at the south end of the APE but review of Google Earth satellite imagery indicates the building is no longer extant. Overlay of the 1962 quadrangle map on Google Earth satellite imagery indicates none of the structures depicted on that map were within the current APE, and according to the project description, any historic-age buildings that might remain along the specified segment of CR 200 will not be impacted by the proposed project.

Description of Previous Disturbances

The once rural APE is in the rapidly developing margin of the City of Liberty Hill and will include the existing operational ROW for CR 200 and new ROW consisting of segments of existing public utility easements (PUEs) to its west and segments of privately-owned land to its east. The APE crosses the CMTA railroad ROW. Commercial properties are common along the south end of the APE; the remainder of the project is flanked by the city park and both large parcel residential properties and denser, suburban-style residential development. The APE was previously disturbed by road and railroad construction, the installation of culverts and excavation of roadside drainage ditches, fence installation, and the installation

of overhead and subsurface utilities, both in the existing ROW and in PUEs to be acquired as new ROW. However, the presence of two ephemeral drainages separated by a broad, nearly level interfluvial in the south half of the APE suggests there is some potential for surface and near surface archeological deposits in that part of the APE, particularly in the overlapping segment of new, less-disturbed ROW east of CR 200.

RESEARCH DESIGN

B&A proposes to conduct an intensive archeological survey of the APE to identify archeological sites. This investigation will consist of pedestrian survey coupled with strategic shovel testing. Survey will include careful visible inspection of sparsely vegetated surfaces along the ephemeral drainages, ditch cuts, utility corridors, fence lines, and elsewhere. Investigation of existing ROW will be judgmental due to extensive previous disturbance. New ROW segments will be surveyed in single transects since the widest of these segments is only 20 m across. Judgmental shovel testing will be primarily (if not completely) relegated to new ROW segments. All 30-cm diameter shovel tests will be excavated in arbitrary 20-cm levels when sediments allow. Tests will be excavated to culturally sterile sediments or to 1 m in depth, whichever occurs first. All excavated soil will be screened through 0.25-inch (0.63-cm) hardware cloth or carefully sorted through with a trowel when too difficult to screen efficiently. All excavated sediment will be carefully inspected for archeological materials.

Survey will be conducted within public ROW and PUEs, and in still privately-owned segments of proposed new ROW where right of entry (ROE) has been granted at the time of survey. If ROE is not granted at the time of survey, investigators will attempt to assess the APE from the public ROW and will make recommendations regarding further survey, if necessary. All field investigations will be carried out prior to the proposed construction in order to identify any potential SALs within the APE that may be affected by the project. All survey methods will comply with applicable standards outlined and defined in 13 Texas Administrative Code (TAC) 26.15(6) and policies of the THC, as well as guidelines of the Council of Texas Archeologists (CTA). Plausible justification for any deviation from these standards will be explicitly provided in the draft survey report.

Field observations will be recorded on appropriate B&A field forms and the locations of each shovel test will be plotted with a hand-held global positioning system (GPS) receiver. The survey area and examples of disturbances within it will be photo-documented. If archeological materials are discovered, systematic shovel tests within the APE may be excavated surrounding the initial find to delineate the horizontal and vertical extent of the site. The site will be recorded on a State of Texas Archeological Site Data Form, a site sketch map will be drafted, and photos of the site will be taken. This form will be submitted to the Texas Archeological Research Laboratory and a trinomial will be obtained. Each archeological site documented as a result of the survey will be evaluated according to published eligibility criteria for designation as an SAL.

Artifacts, if encountered, will not be collected during survey but will be sufficiently described and photographed in the field for further analysis. All survey records, including photographs, will be processed for curation at the Center for Archaeological Research (CAR) at The University of Texas at San Antonio

according to CAR's *Standards and Procedures for the Preparation of Archaeological Collections, Records, and Photographs* (n.d.).

Although not anticipated within the APE, if intentional human burials (historic or prehistoric) are encountered during the survey, the find will be secured, and B&A will notify local law enforcement and the Williamson County representative if the find is not clearly associated with a cemetery or otherwise marked burial or grave. In addition, the THC will be consulted to ensure work continues in accordance with provisions of the Texas Health and Safety Code Title 8 (c), Chapter 711, as amended, and associated regulations (13 TAC 22).

REPORTING REQUIREMENTS

Following fieldwork, a report of findings will be generated in accordance with standards for reports relating to archeological permits (13 TAC 26.16), and guidelines of the CTA for cultural resources management reports. This report will include discussion of the results of the field investigations, a list of identified sites if any, NRHP/SAL eligibility recommendations for each site, and the criteria under which the sites were evaluated. The report will also include recommendations for further work or no further work with appropriate justifications. The report will also include the locations of each shovel test and recorded site location, and specify land ownership in the associated areas.

A copy of the draft report will be submitted to Williamson County and THC for review and comment. A shapefile of the project location will also be submitted to the THC. Upon concurrence with the draft report, one unbound copy of the final report will be submitted to the THC in partial fulfillment of permit requirements. The unbound copy of the final report will contain at least one map with the plotted location of any and all recorded sites. At least one archival-quality CD or DVD s will be provided to THC. The CD or DVD will contain two copies of a tagged PDF format of the report. A copy of the final report will accompany all survey records and photographs to CAR for curation.

REFERENCES CITED

Atlas

- 2019 Texas Online Restricted Access Archeological Sites Atlas. <https://atlas.thc.state.tx.us/Account/Login?Length=5>. Accessed March 2019. Texas Historical Commission, Austin, Texas.

Bureau of Economic Geology

- 1981 *Geologic Atlas of Texas, Austin Sheet*. Bureau of Economic Geology, The University of Texas at Austin.

- 1996 *Physiographic Map of Texas*. Bureau of Economic Geology, University of Texas at Austin.

Center for Archaeological Research (CAR)

- n.d. *Standards and Procedures for the Preparation of Archaeological Collections, Records, and Photographs*. University of Texas at San Antonio.

Griffith, G. E., Bryce, S. A., Omernik, J. M., Comstock, J. A., Rogers, A. C., Harrison, B., Hatch, S. L., and Bezanson, D.

2004 *Ecoregions of Texas* (color poster with map, descriptive text, and photographs). U.S. Geological Survey (map scale 1:2,500,000), Reston, Virginia.

McMahan, Craig A., Roy G. Frye, and Kirby L. Brown

1984 *The Vegetation Types of Texas including Cropland*. Map and accompanying illustrated synopsis. Wildlife Division, Texas Parks and Wildlife Department, Austin.

Soil Web Earth

2019 Soil Web Network Link on Google Earth, Streaming-KMZ interface to U.S. Department of Agriculture, National Cooperative Soil Survey, Soils Survey Geographic Database (SSURGO) and Natural Resources Conservation Service, State Soil Geographic Database (STATSGO) digital soil survey products. California Soil Resource Laboratory, University of California, Davis, in collaboration with U.S. Department of Agriculture, National Cooperative Soil Survey. Electronic document, <http://casoilresource.lawr.ucdavis.edu/soilweb-apps>, accessed March 2019.

U.S. Geological Survey

1893 Georgetown, Texas, 1:125,000 Quadrangle. U.S. Geological Survey, Washington, D. C.

1927 Georgetown, Texas, 1:125,000 Quadrangle. U.S. Geological Survey, Washington, D. C.

1949 Georgetown, Texas, 1:125,000 Quadrangle. U.S. Geological Survey, Washington, D. C.

1954 Austin, Texas, 1:250,000 Quadrangle. U.S. Geological Survey, Washington, D. C.

1962 Liberty Hill, Texas, 7.5-minute Quadrangle. U.S. Geological Survey, Washington, D. C.

APPENDIX A

Figures

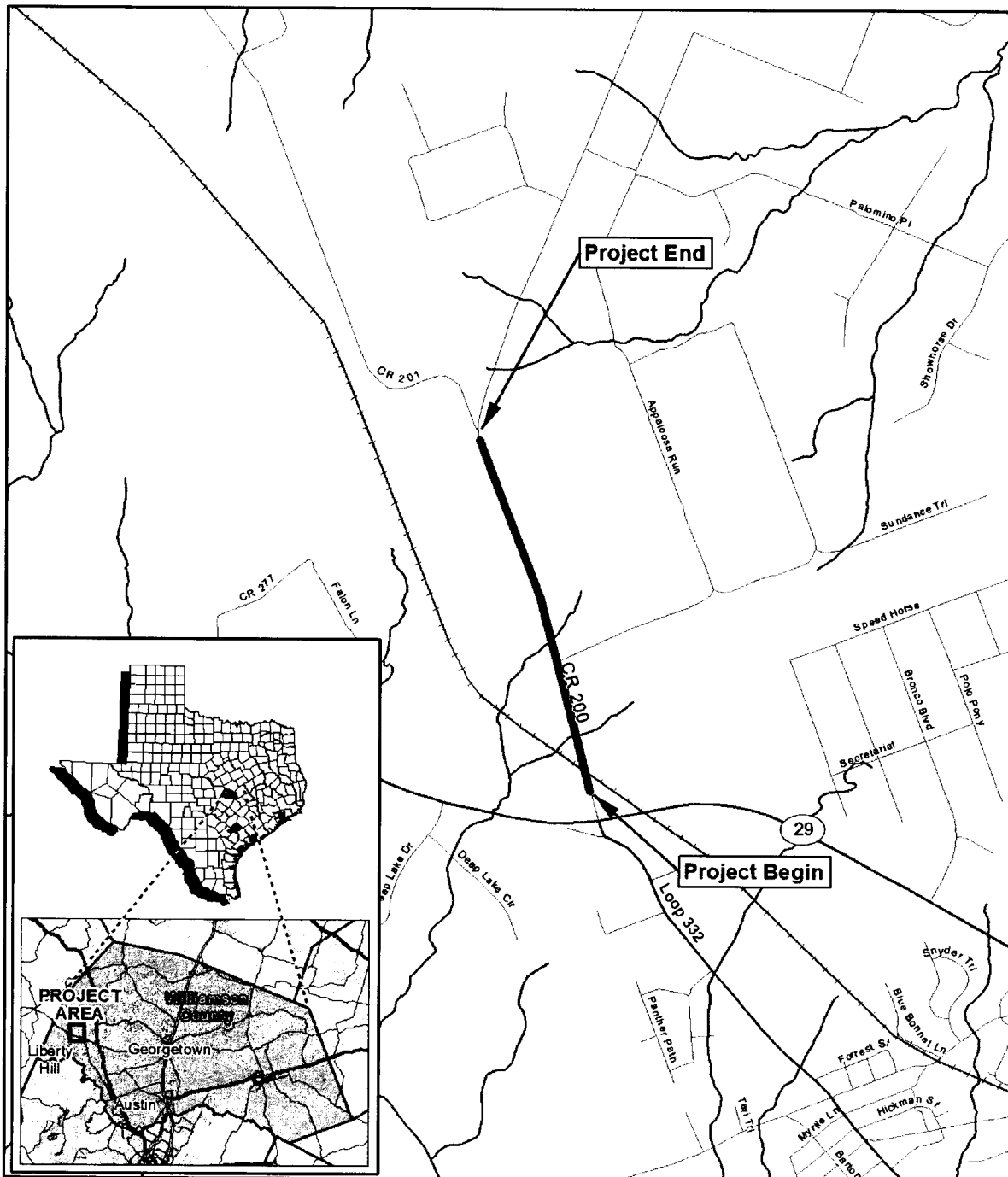

Base Map: ESRI-USA Base Map,
ESRI-U.S. and Canada Detailed Streets



1:24,000

Feet

0 2,000

— Project Location

Figure 1
Project Location on County Base
CR 200 from
400-feet North of SH 29 to
100-feet South of CR 201
Williamson County, Texas

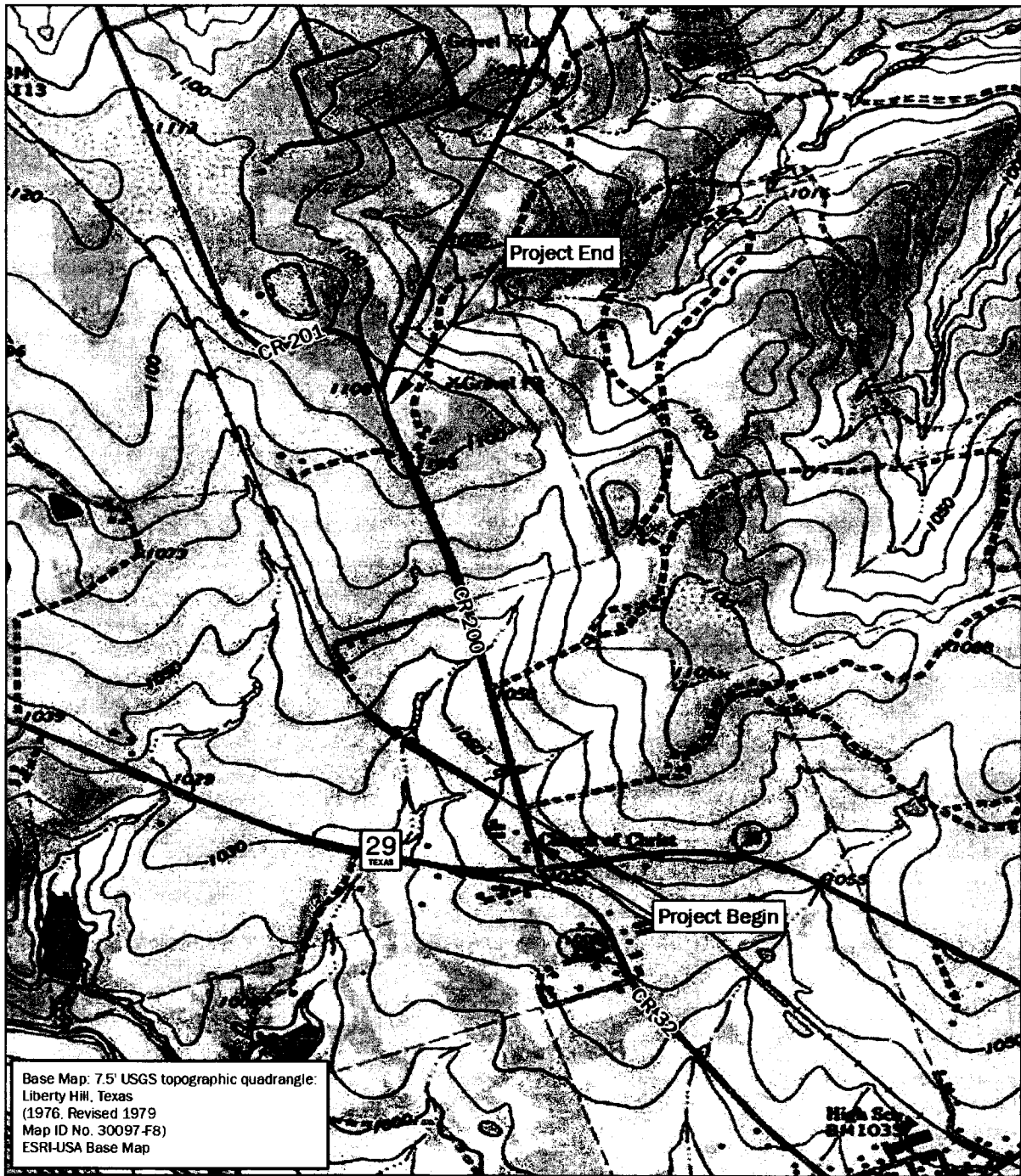

Base Map: 7.5' USGS topographic quadrangle:
 Liberty Hill, Texas
 (1976, Revised 1979
 Map ID No. 30097-F8)
 ESRI-USA Base Map

— Project Location

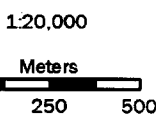
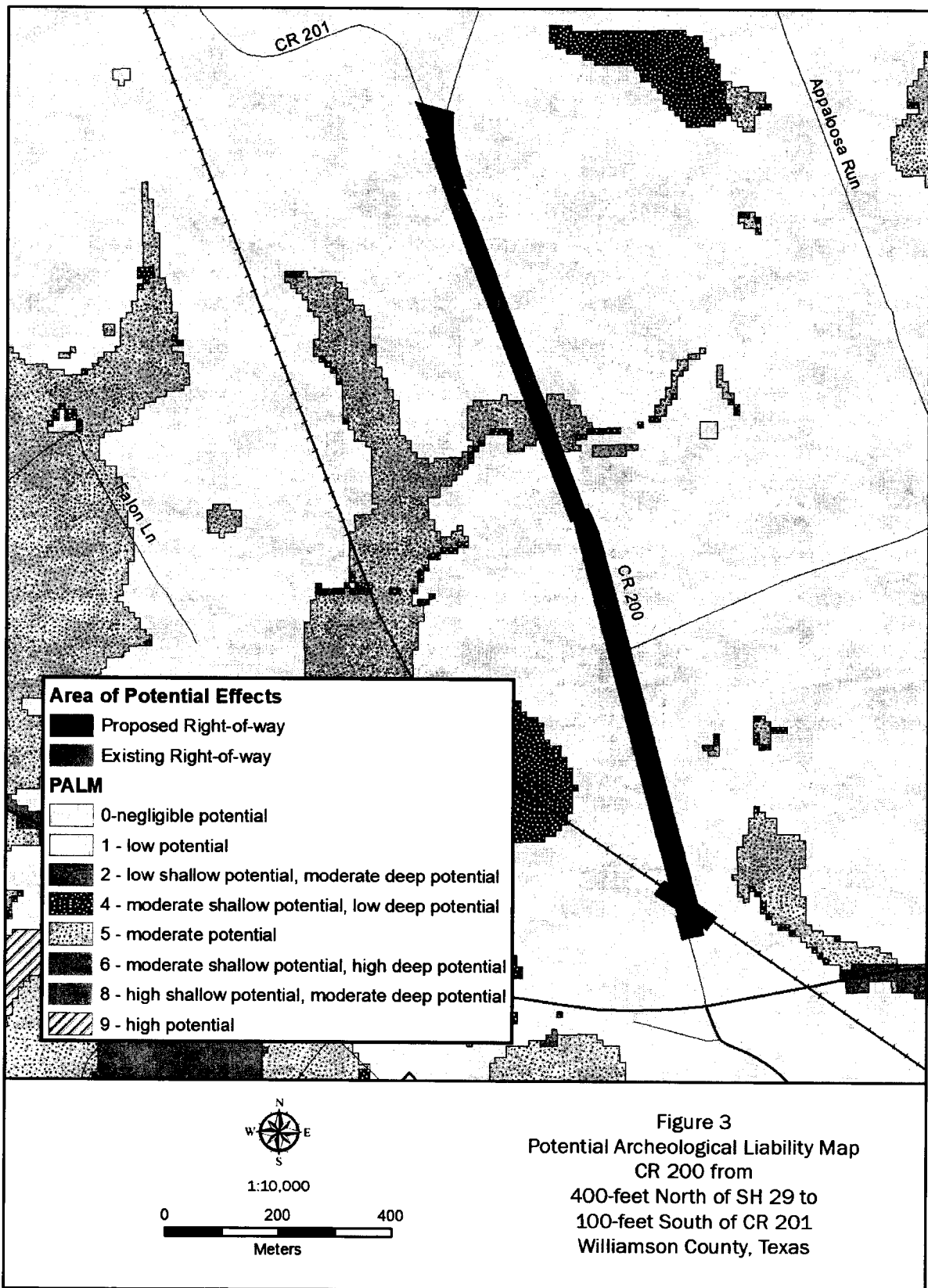
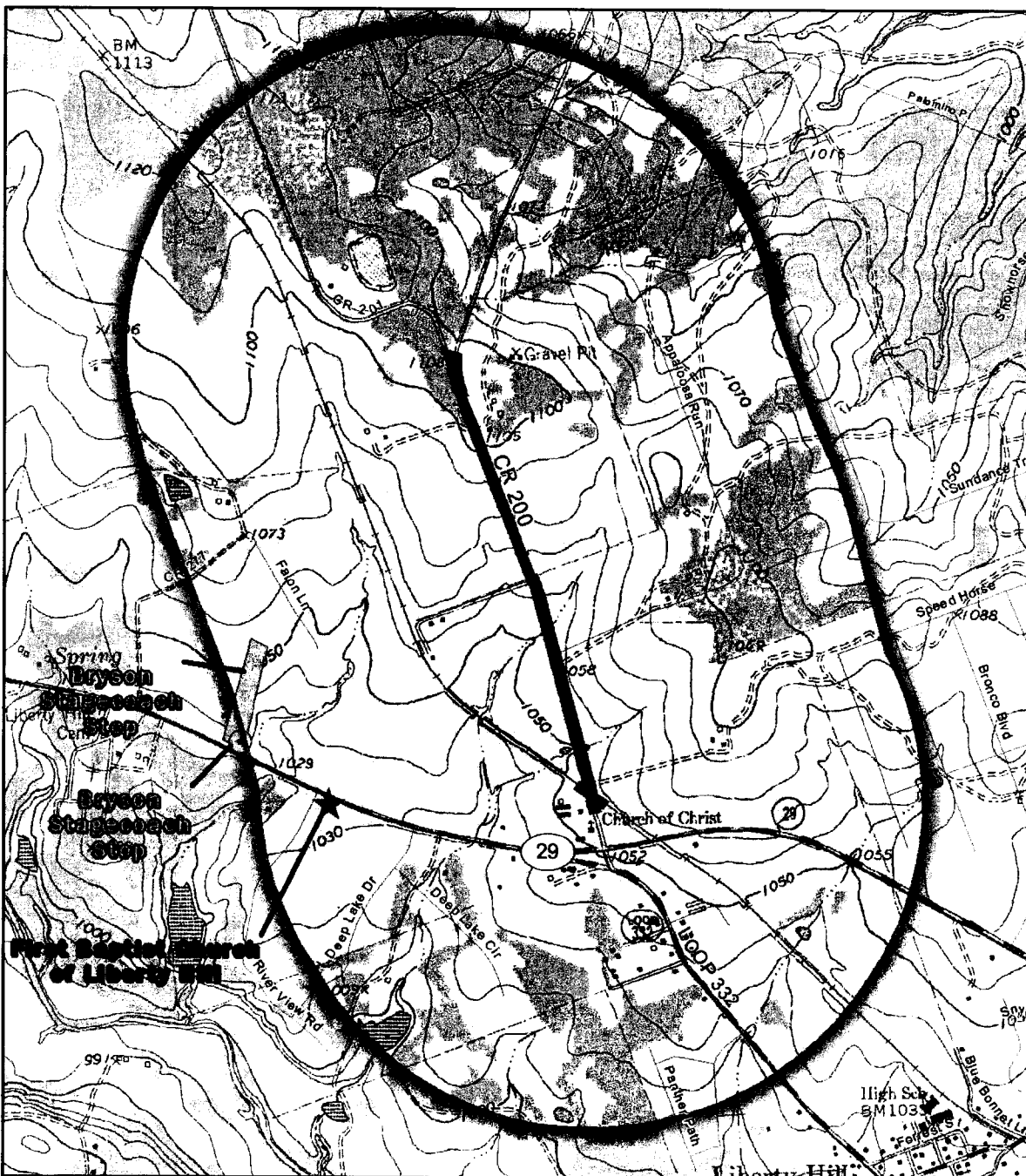

Figure 2
 Project Location on Topographic Base
 CR 200 from
 400-feet North of SH 29 to
 100-feet South of CR 201
 Williamson County, Texas





- Area of Potential Effects** 1Km Buffer
- Proposed Right-of-way
- Existing Right-of-way
- ★ Texas Historical Marker
- NRHP Property
- NRHP District

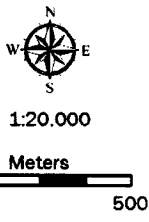

Figure 5
 Previously Recorded Sites
 CR 200 from
 400-foot North of SH 29 to
 100-foot South of CR 201
 Williamson County, Texas

Base Map: USGS 7.5' Topographic Williamson County, Texas

APPENDIX B

Schematics

WILLIAMSON COUNTY

COUNTY ROAD 200 PRECINCT NUMBER 2

ROADWAY - CR 200 CLASSIFICATION - RURAL COLLECTOR DESIGN SPEED - 45 MPH

CR 200 ADT = 6,100 (2018) ADT = 12,400 (2038)

ROADWAY DHV (CURRENT) DHV (DESIGN YEAR)

ROADWAY DIRECTIONAL DISTRIBUTION (D) PERCENT TRUCKS (T)

90%
SUBMITTAL

NET LENGTH OF ROADWAY = 5001.86 FT (0.947 MILES)
NET LENGTH OF BRIDGE = 0.00 FT (0.000 MILES)
NET LENGTH OF PROJECT = 5001.86 FT (0.947 MILES)

LIMITS: FROM APPROXIMATELY 400' NORTH OF SH 29 TO APPROXIMATELY 100' SOUTH OF CR 201

FOR THE RECONSTRUCTION OF THE EXISTING ROADWAY
CONSISTING OF GRADING, DRAINAGE IMPROVEMENTS, FLEXIBLE BASE,
IMHCP, STRIPING AND PAVEMENT MARKERS.

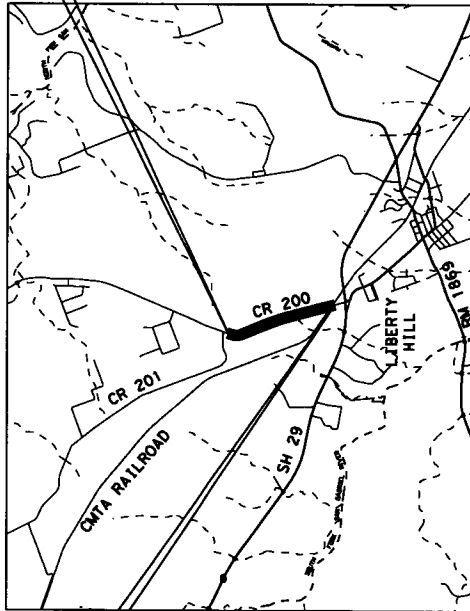

VICINITY MAP
N. T. S.

EXCEPTIONS: NONE
EQUATIONS: NONE
RAILROAD CROSSINGS: CMTA R.R. AT STA. 105+93.25 (200)
WATERSHED: _____
AREA OF DISTURBANCE: _____

PREPARED BY:
O'BRIEN ENGINEERING SERVICES -
FIRM # 14060 (DESIGN CONSULTANT)

J. KEAT O'BRIEN
P.E. 64398
DATE _____



APPROVED BY:
WILLIAMSON COUNTY
COMMISSIONER CYNTHIA LONG
WILLIAMSON COUNTY COMMISSIONER, PRECINCT 2
DATE _____

APPROVED BY:
HNTB CORPORATION
DATE _____

RICHARD L RIDINGS, PE
ROAD BOND MANAGEMENT TEAM
DATE _____

BEGIN PROJECT
STA. 104+32.50

REGISTERED ACCESSIBILITY SPECIALIST (RAS) INSPECTION NOT REQUIRED.

REQUIRED SIGNS SHALL BE PLACED IN ACCORDANCE WITH STANDARD SHEETS BC(1)-14 THRU BC(12)-14 AND THE TEXAS MANUAL ON UNIFORM TRAFFIC CONTROL DEVICES.†

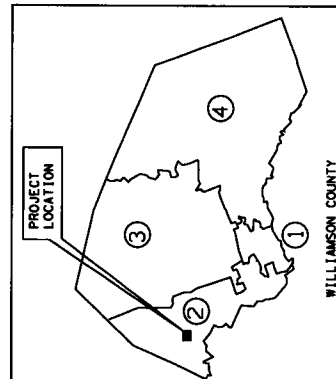

†DOT STANDARD SPECIFICATIONS FOR CONSTRUCTION OF STREETS AND BRIDGES ADOPTED ON 10/1/1997. SPECIAL PROVISIONS AND SPECIAL SPECIFICATIONS AS INDICATED IN THE BID DOCUMENTS SHALL GOVERN ON THIS PROJECT.



APPROVED BY:
WILLIAMSON COUNTY

BILL GRAVELL, JR.
WILLIAMSON COUNTY JUDGE
DATE _____

APPROVED BY:
WILLIAMSON COUNTY





COMMISSIONER CYNTHIA LONG
WILLIAMSON COUNTY COMMISSIONER, PRECINCT 2
DATE _____

APPROVED BY:
HNTB CORPORATION
DATE _____

RICHARD L RIDINGS, PE
ROAD BOND MANAGEMENT TEAM
DATE _____



0 100 200
SCALE 1"=200'

LEGEND:
 DRIVEWAY NUMBER
 DIRECTION OF TRAFFIC
 CONTROL POINTS
 n-POINT NO.

1. SEE DRIVEWAY DETAIL SHEET FOR DRIVEWAY DATA.
2. SEE DRAINAGE SHEETS FOR CULVERT AND SPECIAL DRAINAGE FEATURE DATA.

INTERIM REVIEW

THIS DOCUMENT IS RELEASED FOR THE PURPOSE OF INTERIM REVIEW UNDER THE AUTHORITY OF DONALD A. ROBERTS, P.E. 8/19/2019. IT IS NOT TO BE USED FOR CONSTRUCTION PURPOSES.

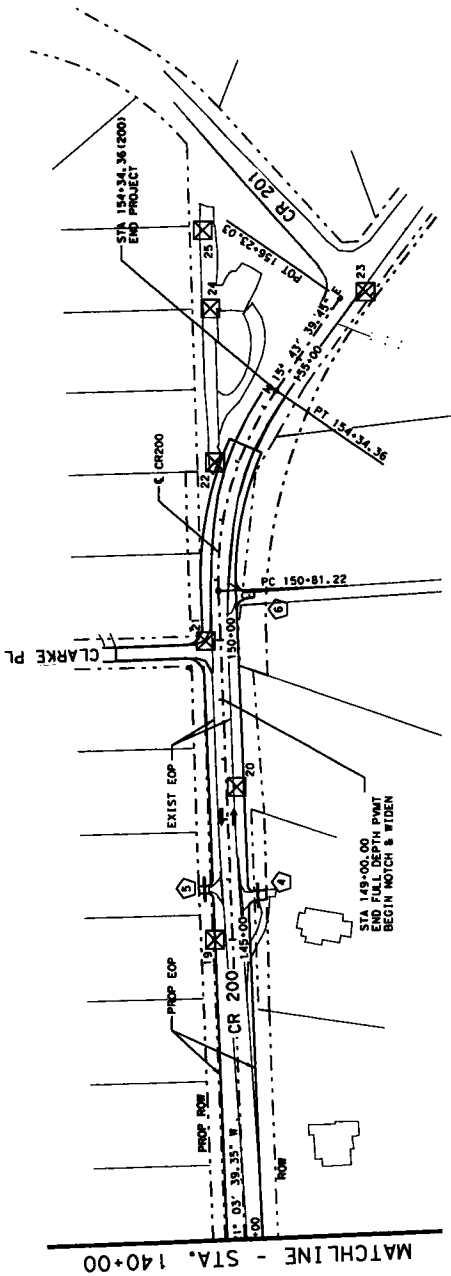

HORIZONTAL AND VERTICAL CONTROL DATA

POINT	ELEV.	DESC.
CTRL13	3,051,673.9600	10,219,454.4000 1,055.3000 IRSC
CTRL14	3,051,579.0600	10,219,870.1900 1,055.9900 IRSC
CTRL15	3,051,510.7700	10,220,298.3800 1,056.5900 IRSC
CTRL16	3,051,378.7500	10,220,804.2200 1,058.9700 MAG
CTRL17	3,051,094.4400	10,221,617.5100 1,064.9900 IRSC
CTRL18	3,050,915.5600	10,222,322.1000 1,082.7300 MAG
CTRL19	3,050,538.3900	10,223,079.0400 1,104.2700 IRSC
CTRL20	3,050,483.0900	10,223,331.9900 1,107.8000 IRSC
CTRL21	3,050,362.1000	10,223,546.0500 1,108.4600 MAGN
CTRL22	3,050,281.3100	10,223,832.8800 1,107.8500 SPIN
CTRL23	3,050,127.0800	10,224,183.6100 1,097.9500 IRSC
CTRL24	3,050,191.4600	10,224,073.9000 1,106.0700 MAG
CTRL25	3,050,138.0500	10,224,193.3400 1,106.2500 600
CTRL30	3,052,399.4500	10,234,322.2700 978.9400 IRSC
CTRL31	3,052,163.6900	10,234,768.3900 994.7300 IRSC

ALL BEARINGS ARE BASED ON THE TEXAS STATE PLANE COORDINATE SYSTEM, CENTRAL ZONE, MID-81931. ALL DISTANCES AND COORDINATES ARE ADJUSTED TO THE SURFACE BY THE PROJECT SURFACE ADJUSTMENT FACTOR OF 0.99985.

WILLIAMSON COUNTY PRECINCT 42

JONES CARTER
The Board of Professional Engineers Registered No. 1439
 202 West Loop South, Suite 100 Dallas, Texas 75219-3237

wsb WSB & ASSOCIATES, INC.
FIRM # 16849

CR 200
 FROM CMTA R.R. TO CR 201
 PROJECT LAYOUT

SHEET 2 OF 2

SHEET # 4

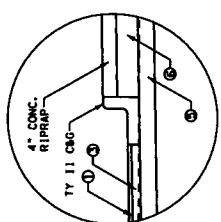

DETAIL "A"

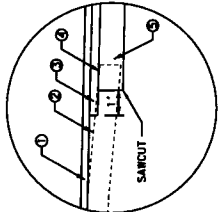

DETAIL "B"

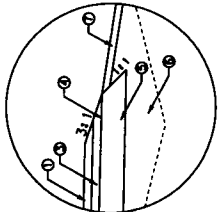

DETAIL "C"

- ① 2" HMACP (TY D) (SAC-B)
- ② HMACP (TY C) (LEVEL-UP)
- ③ 4" HMACP (TY B)
- ④ PRIME COAT / SEAL COAT
- ⑤ 12" FLEX BASE IN (2 EQUAL LIFTS)
- ⑥ TY "C" EMBANKMENT
- ⑦ TOPSOIL

INTERIM REVIEW
 THIS DOCUMENT IS RELEASED FOR THE PURPOSE OF INTERIM REVIEW UNDER THE AUTHORITY OF Daniel A. Rogge, P.E. 00134 ON 2/19/2013. IT IS NOT TO BE USED FOR CONSTRUCTION PURPOSES.

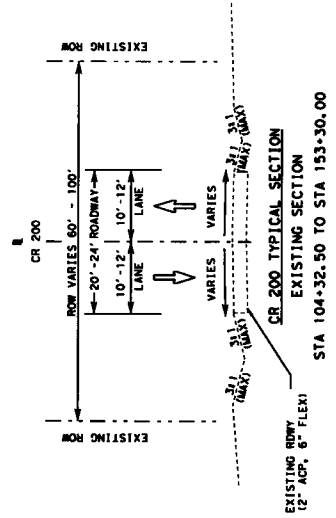

CR 200 TYPICAL SECTION
 EXISTING SECTION
 STA 104+32.50 TO STA 153+30.00

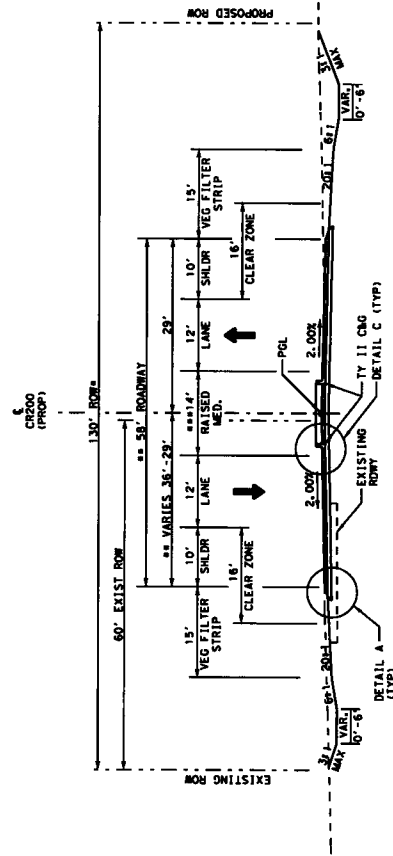

CR 200 TYPICAL SECTION
 PROPOSED SECTION
 STA 104+32.50 TO STA 107+54.00

WILLIAMSON COUNTY PRECINCT #2

WILLIAMSON COUNTY ENGINEERS

JONES CARTER

Wsb & ASSOCIATES, INC. FIRM # 16849

CR 200 FROM CMTA R.R. TO CR 201 TYPICAL SECTIONS

SHEET 1 OF 3 SHEET # 5

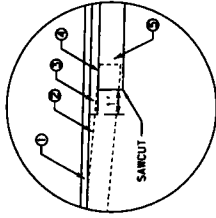

DETAIL "A"

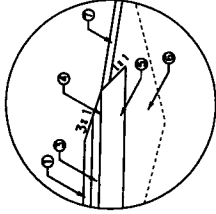

DETAIL "B"

- ① 2" HMACP (TY D) (SAC-B)
- ② HMACP (TY C) (LEVEL-UP)
- ③ 4" HMACP (TY B)
- ④ PRIME COAT / SEAL COAT
- ⑤ 12" FLEX BASE IN (2 EQUAL LIFTS)
- ⑥ TY "C" EMBANKMENT
- ⑦ TOPSOIL

INTERIM REVIEW
 THIS DOCUMENT IS RELEASED FOR THE PURPOSE OF INTERIM REVIEW UNDER THE AUTHORITY OF Daniel A. Rogers, P.E. BIRTH ON 2/19/2015. IT IS NOT TO BE USED FOR CONSTRUCTION PURPOSES.

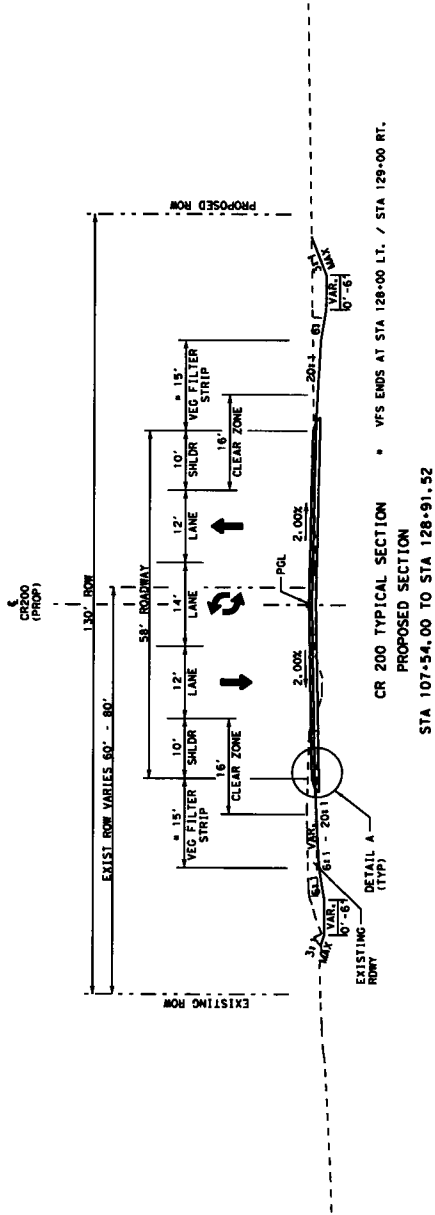

CR 200 TYPICAL SECTION
 STA 107+54.00 TO STA 128+91.52
 * VFS ENDS AT STA 128+00 LT. / STA 129+00 RT.

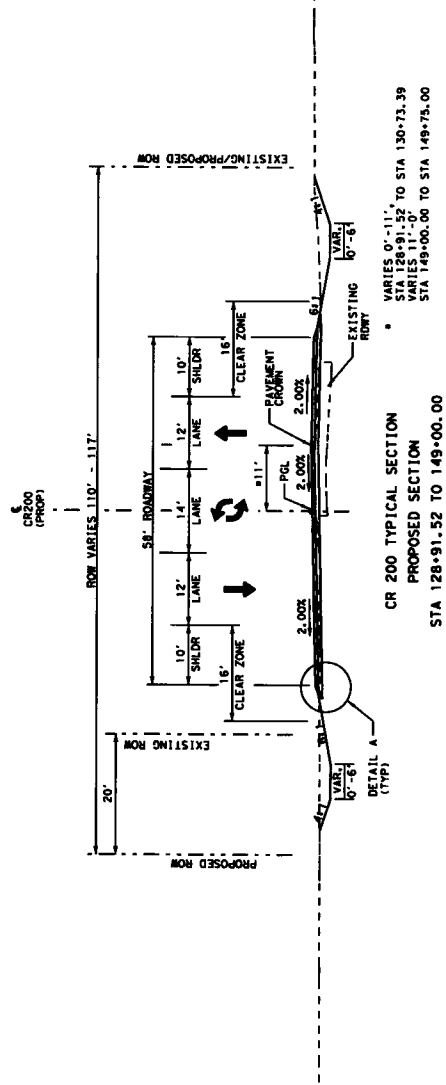

CR 200 TYPICAL SECTION
 STA 128+91.52 TO 149+00.00
 * VARIES 0'-11' TO STA 130+73.39
 * VARIES 11'-0" TO STA 149+00.00

 WILLIAMSON COUNTY PRECINCT #2	 JONES CARTER <small>Team of Professional Engineers Registration No. 7-439 820 West Loop South, Suite 1500 • Houston, Texas 77061-7317/2527</small>
 WSB & ASSOCIATES, INC. FIRM # 16849	CR 200 FROM CMTA R.R. TO CR 201 TYPICAL SECTIONS
SHEET 2 OF 3	SHEET # 6

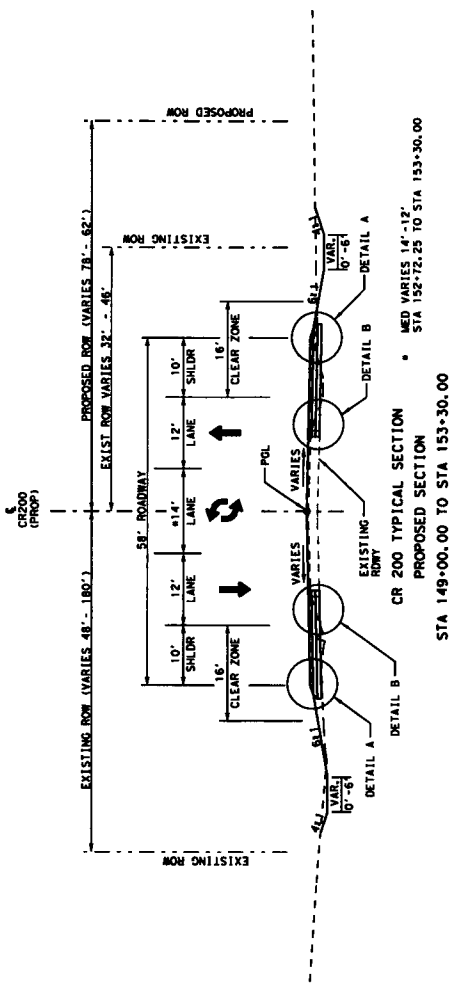

CR 200 TYPICAL SECTION
 STA 153+30.00 TO STA 154+34.36

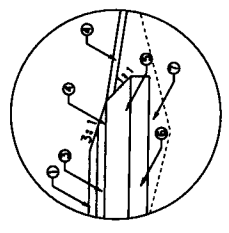
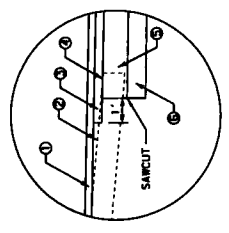
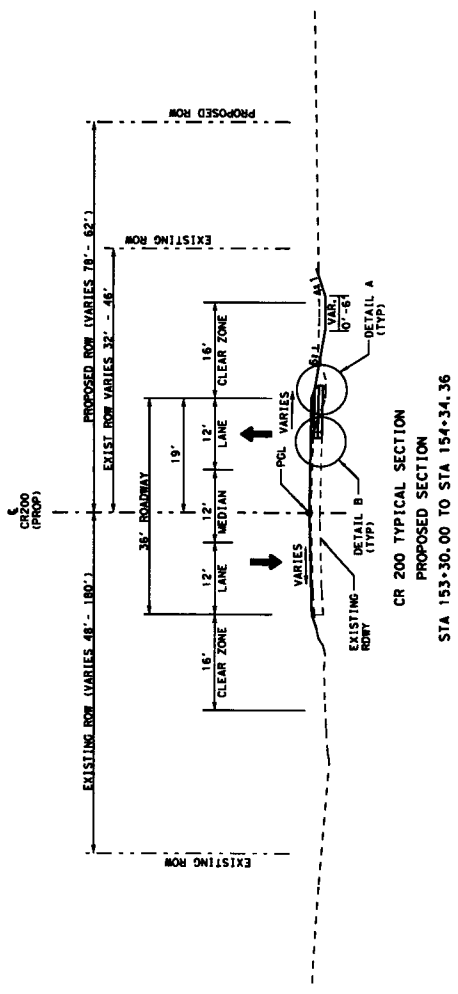

- ① 2" HMACP (TY D) (SAC-B)
- ② HMACP (TY C) (LEVEL-UP)
- ③ 4" HMACP (TY B)
- ④ PRIME COAT / SEAL COAT
- ⑤ 12" FLEX BASE (2 EQUIVALENT LIFTS)
- ⑥ 8" LIME TREATED SUBGRADE
- ⑦ TY "C" EMBANKMENT
- ⑧ TOPSOIL

INTERIM REVIEW
 THIS DOCUMENT IS RELEASED FOR THE PURPOSE OF
 INTERIM REVIEW UNDER THE AUTHORITY OF
 Daniel A. Roggero, P.E. 08174 ON 2/15/2013
 IT IS NOT TO BE USED FOR CONSTRUCTION PURPOSES.

 WILLIAMSON COUNTY PRECINCT #2	 JONES CARTER <small>Team of Professional Engineers, Registration No. 1-48 820 West Loop South, Suite 200 • Houston, Texas 77037-7337</small>	 WSB & ASSOCIATES, INC. <small>FIRM # 16849</small>
CR 200 FROM CMTA R.R. TO CR 201 TYPICAL SECTIONS		
SHEET 3 OF 3		SHEET # 7

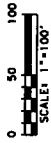

LEGEND:

- DRIVEWAY NUMBER
- DIRECTION OF TRAFFIC

NOTES:
 1-SEE DETAIL SHEETS FOR DETAILS.
 2-SEE DRIVEWAY SUMMARY SHEET FOR DETAILS.
 3-CONTRACT "A" FOR DETAILS OF IMPROVEMENTS IN CMTA ROW.

INTERIM REVIEW

THIS DOCUMENT IS RELEASED FOR THE PURPOSE OF INTERIM REVIEW UNDER THE AUTHORITY OF Daniel A. Rogers, PE 04704 ON 2/19/2019. IT IS NOT TO BE USED FOR CONSTRUCTION PURPOSES.



FROM CMTA R.R. TO CR 201
 PLAN AND PROFILE
 STA 104+32.50 TO
 STA 115+00.00

SHEET # 5

SHEET # 54

MATCHLINE - STA. 115+00

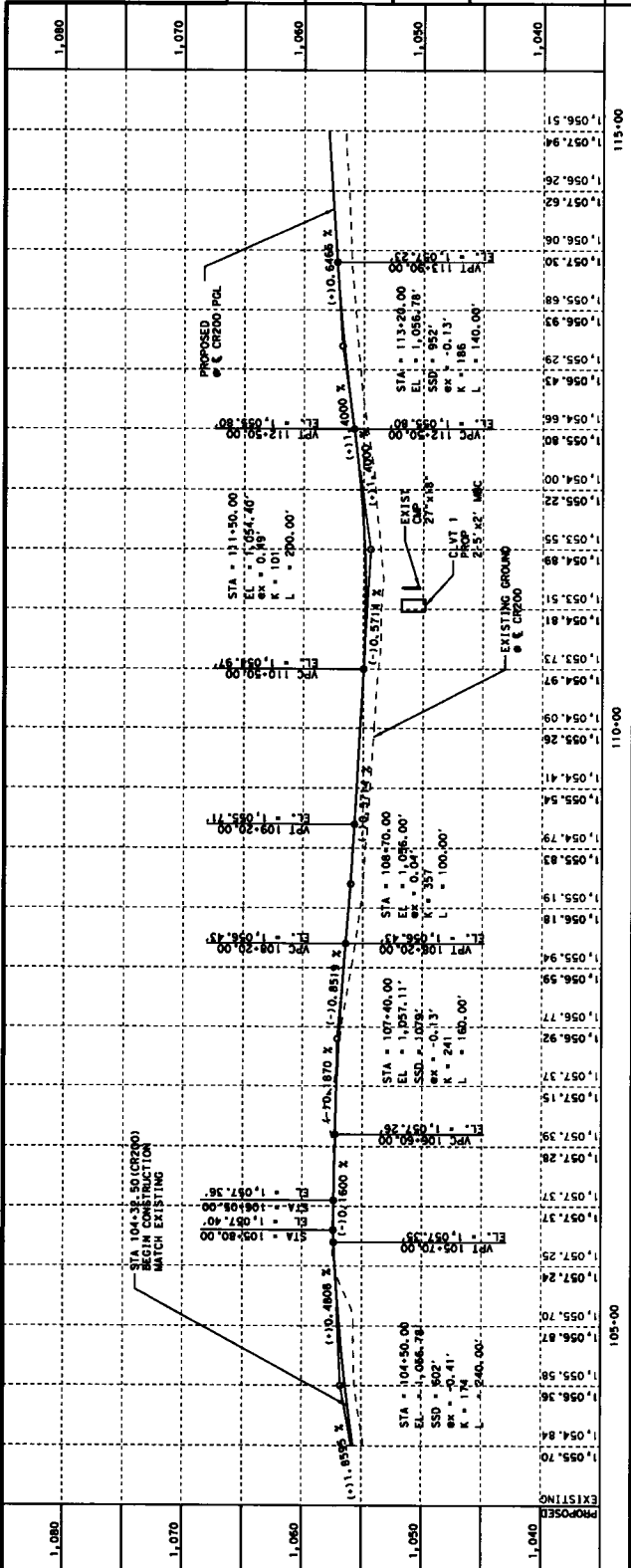
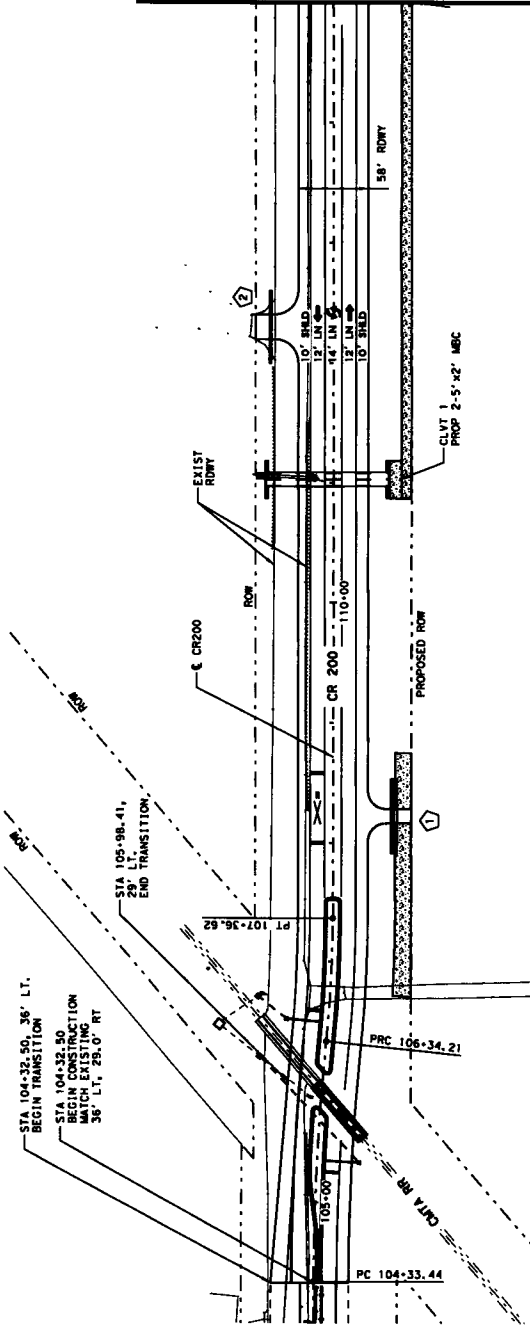

11-11-18 11:22 AM
 11-11-18 11:22 AM
 11-11-18 11:22 AM

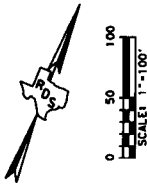

LEGEND:
 DRIVEWAY NUMBER
 DIRECTION OF TRAFFIC

NOTES:
 1. SEE DETAIL SHEETS FOR DETAILS.
 2. SEE DRIVEWAY SUMMARY SHEET FOR DETAILS.

INTERIM REVIEW
 THIS DOCUMENT IS RELEASED FOR THE PURPOSE OF INTERIM REVIEW UNDER THE AUTHORITY OF Daniel A. Rogoff, P.E. 80734 ON 2/15/2013. IT IS NOT TO BE USED FOR CONSTRUCTION PURPOSES.

MATCHLINE - STA. 137+00

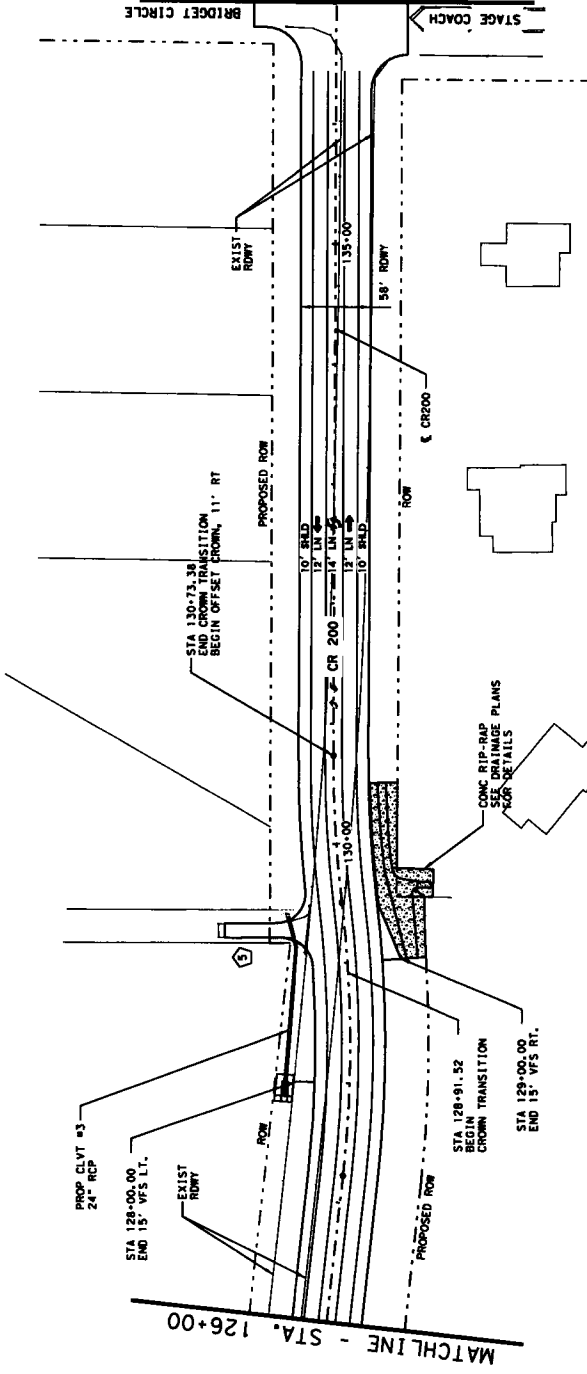

MATCHLINE - STA. 126+00

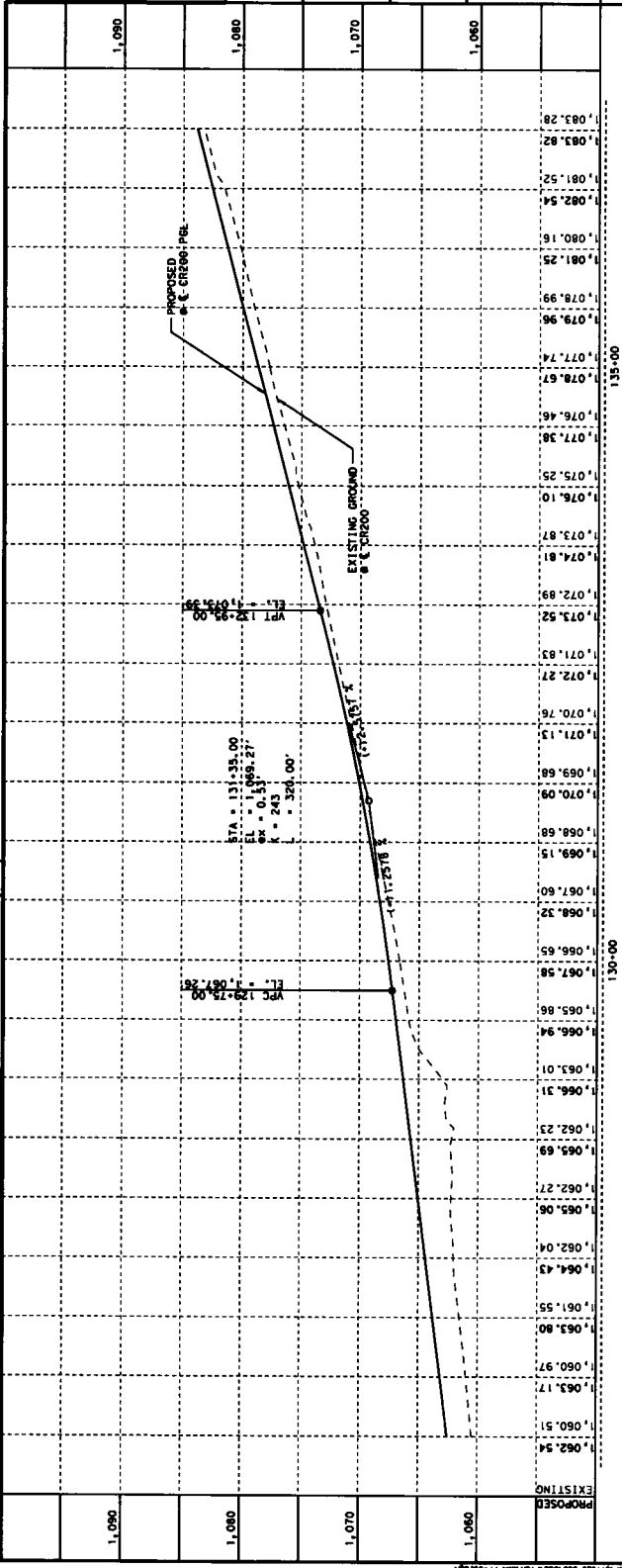

WILLIAMSON COUNTY PRECINCT #2

WILLIAMSON COUNTY

JONES CARTER
 Times Board of Professional Engineers Registration No. F-439
 550 West Loop South, Suite 230 - Houston, Texas 77057-1337

WSB & ASSOCIATES, INC.
 FIRM # 16849

CR 200
 FROM CMTA R.R. TO CR 201
 PLAN AND PROFILE
 STA 126+00.00 TO
 STA 137+00.00



LEGEND:
 DRIVEWAY NUMBER
 DIRECTION OF TRAFFIC

NOTES:
 1-SEE DETAIL SHEETS FOR DETAILS.
 2-SEE DRIVEWAY SUMMARY SHEET FOR DETAILS.

INTERIM REVIEW
 THIS DOCUMENT IS RELEASED FOR THE PURPOSE OF INTERIM REVIEW UNDER THE AUTHORITY OF Daniel A. Rogers, P.E. 08/24 ON 2/19/2019. IT IS NOT TO BE USED FOR CONSTRUCTION PURPOSES.

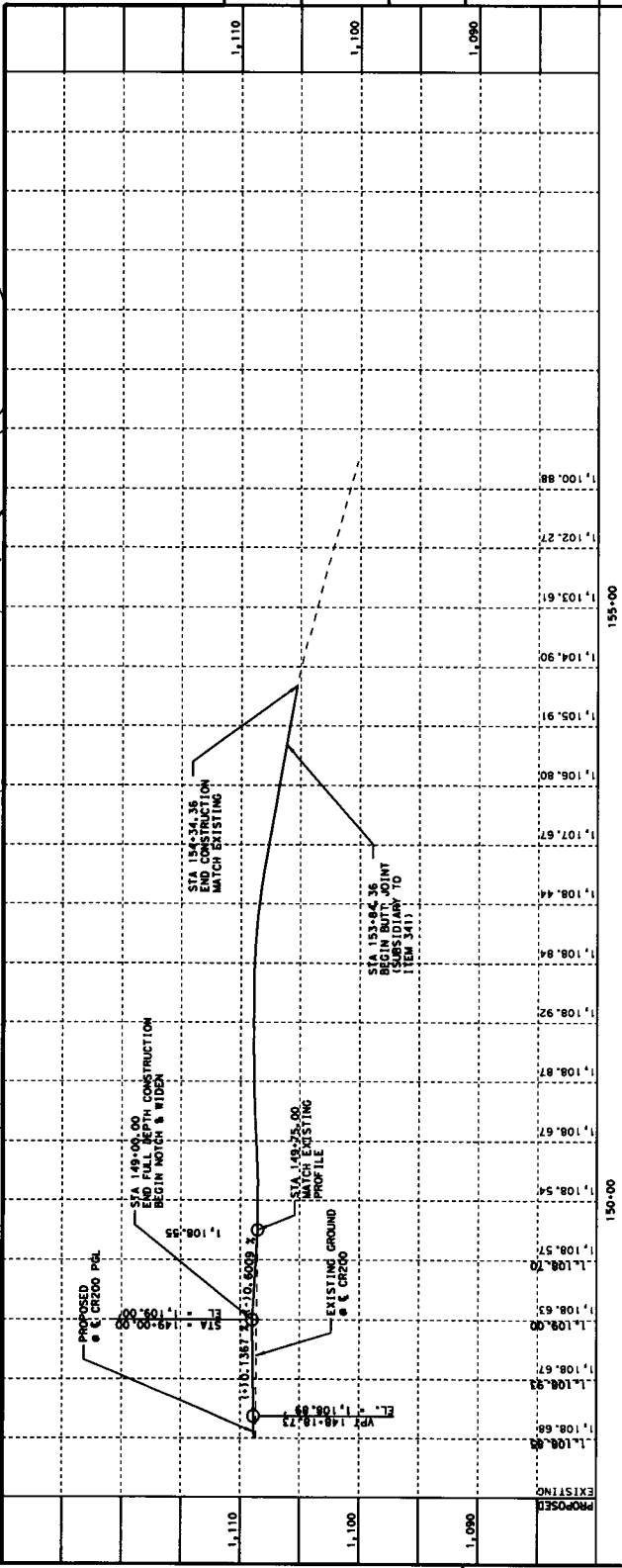
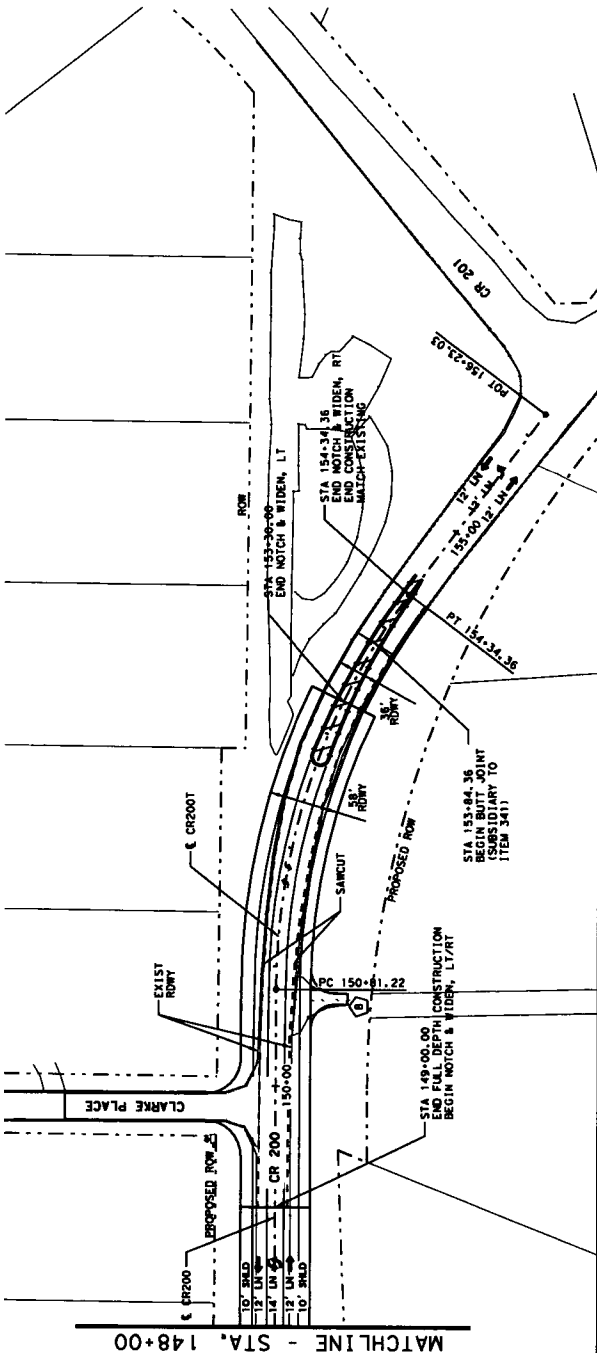

WILLIAMSON COUNTY PRECINCT #2

WILLIAMSON COUNTY

JONES CARTER
Team of Professional Engineers & Surveyors, Inc. L.P. 0287940001001, 1000 N. Loop West, Suite 200, Houston, Texas 77007-7371-3307

WSB & ASSOCIATES, INC.
FIRM # 16849

CR 200 TO CR 201
PLAN AND PROFILE
STA 148+00.00 TO
STA 154+34.36

SHEET 5 OF 5 SHEET # 5B

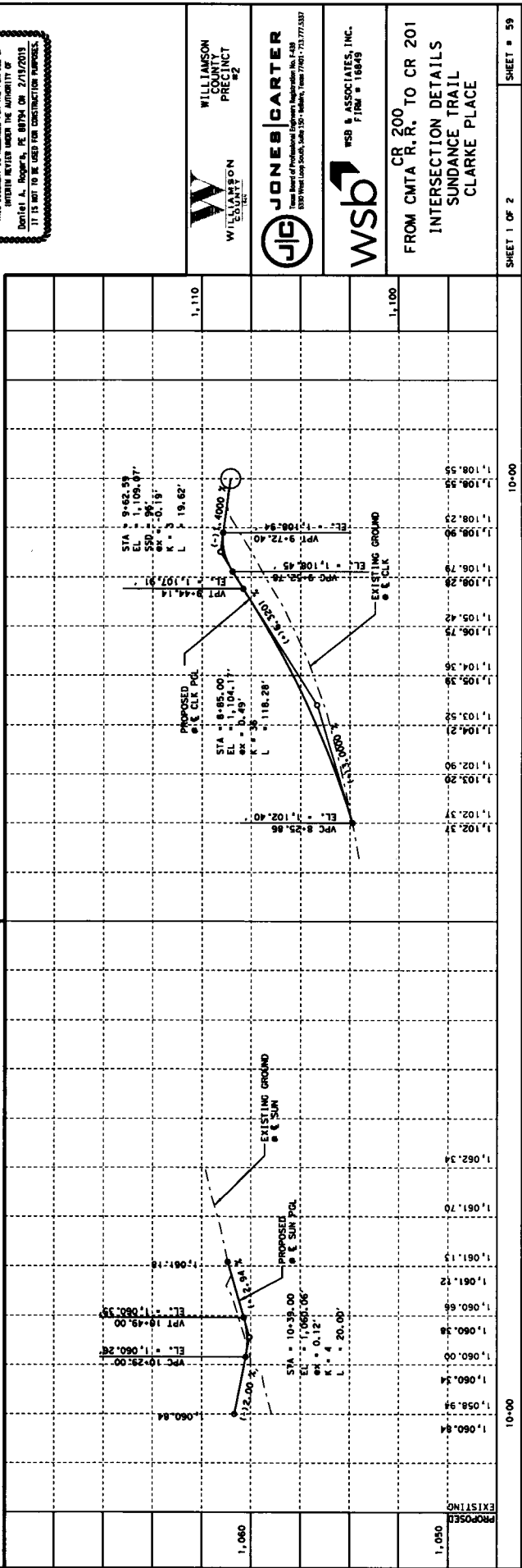
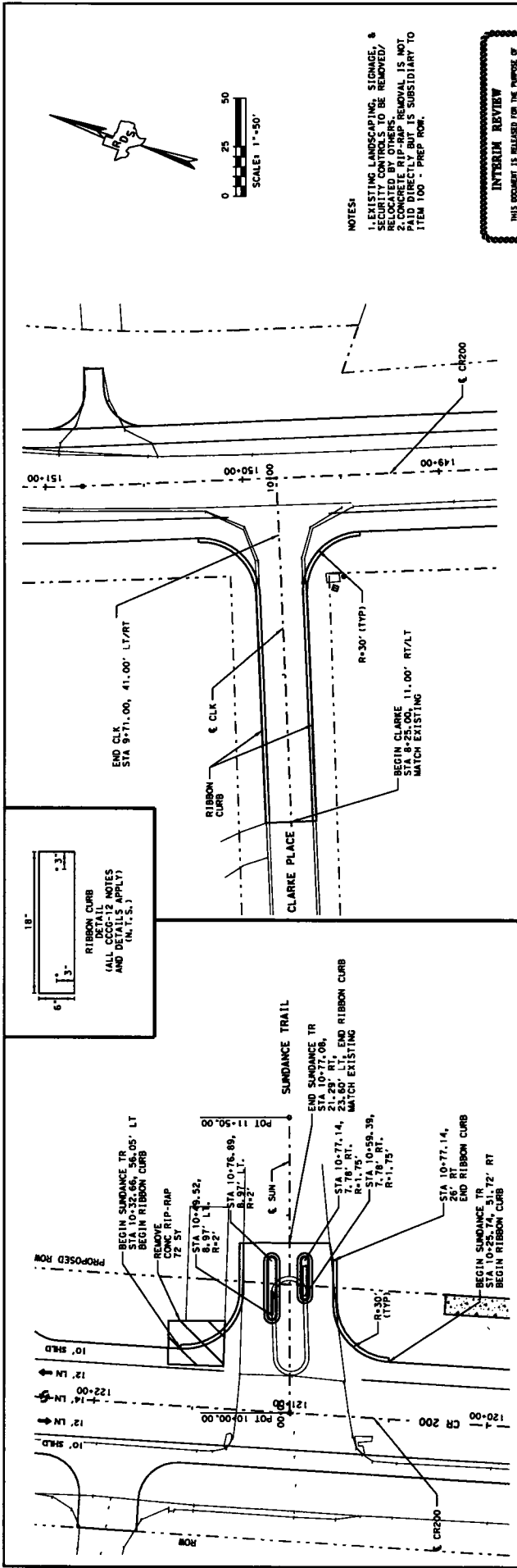



INTERIM REVIEW
 THIS DOCUMENT IS RELEASED FOR THE PURPOSE OF
 INTERIM REVIEW UNDER THE AUTHORITY OF
 DONALD A. ROGERS, PE 48794 ON 2/19/2019
 IT IS NOT TO BE USED FOR CONSTRUCTION PURPOSES.



WILLIAMSON
 COUNTY
 PRECINCT
 #2



JIG JONES CARTER
 Texas Board of Professional Engineers, Registration No. 448
 6500 West Loop South, Suite 250, Houston, Texas 77037-7327

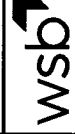

WSB FSB & ASSOCIATES, INC.
 FIRM # 166849

CR 200
 FROM CMTA R.R. TO CR 201
 INTERSECTION DETAILS
 BRIDGET CIRCLE
 STAGE COACH

SHEET # 60
 SHEET 2 OF 2

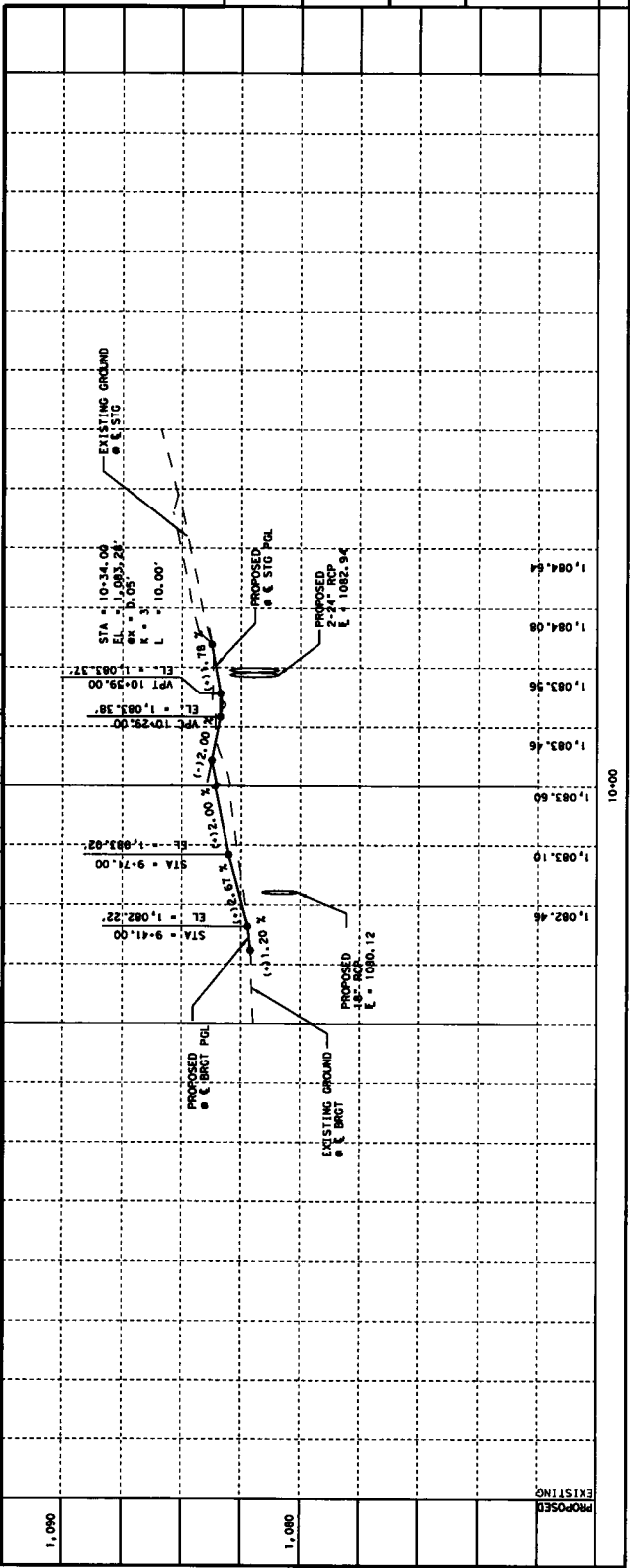
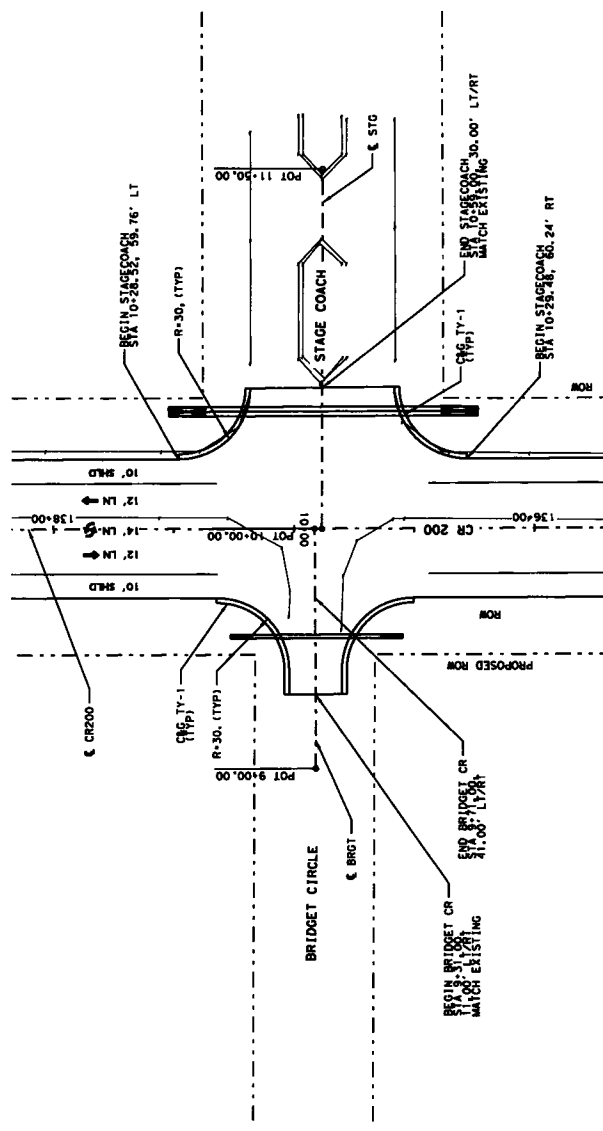

PROPOSED
 EXISTING

11-18-18
 2/19/19
 DWG: 1808-CR200-INT-02

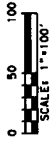

LEGEND

- OHET-2
- MI-6-D
- OHET-1
- BURIED UTILITY
- BURIED WATERLINE

THE LOCATION OF UTILITIES INDICATED ON THESE PLANS IS BASED ON RECORD PLANS, FIELD SURVEY, AND THE CONTRACTOR'S RESPONSIBILITY TO MAKE ARRANGEMENTS WITH THE UTILITY OWNERS PRIOR TO WORKING IN THE AREA, TO CONFIRM THEIR EXACT LOCATIONS, AND TO IDENTIFY ANY ADDITIONAL UTILITIES OTHER THAN THOSE SHOWN ON THESE PLANS.

THE PLANS SHOW THE STATUS OF UTILITY LOCATIONS AS OF JUNE 6, 2016.

INTERIM REVIEW

THIS DOCUMENT IS RELEASED FOR THE PURPOSE OF INTERIM REVIEW UNDER THE AUTHORITY OF DONALD A. ROBERTS, P.E. 80754 ON 2/13/2015. IT IS NOT TO BE USED FOR CONSTRUCTION PURPOSES.

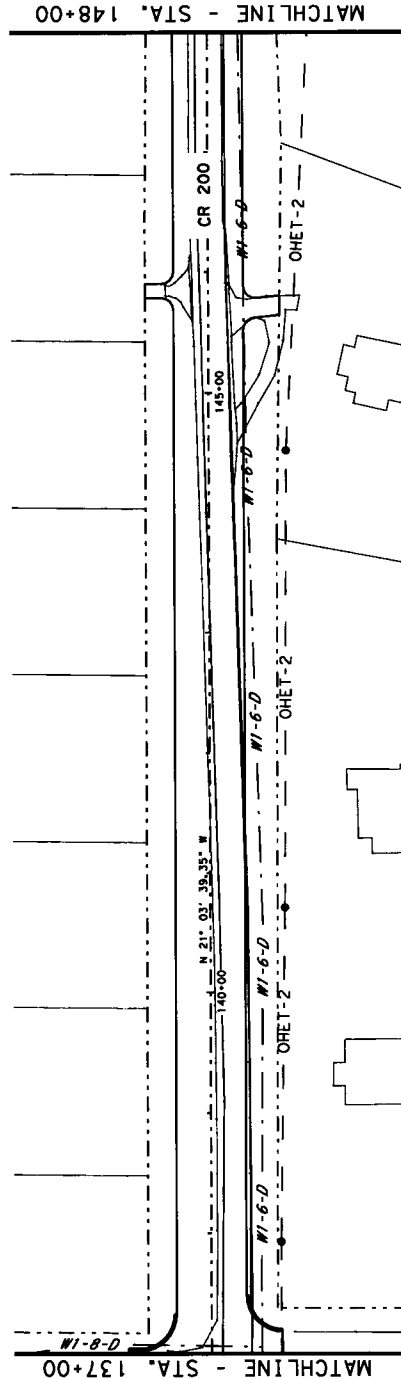
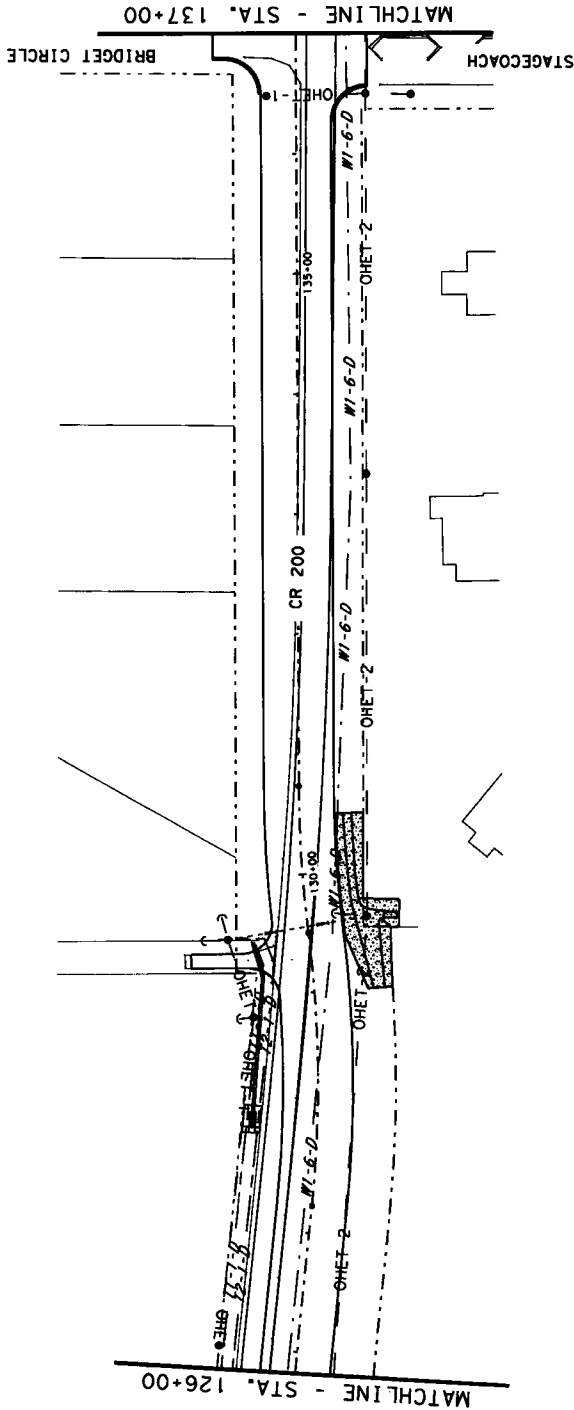

FROM CMTA R.R. TO CR 201
EXISTING UTILITIES

111694.dwg
2/13/2015 9:58:19 AM
C:\Users\jroberts\OneDrive\Documents\Projects\11-02-09



LEGEND



- OHET-2 — OVERHEAD ELECTRICITY
- T-1-1-D — BURIED UTILITY
- W-1-1-D — BURIED WATERLINE

THE LOCATION OF UTILITIES INDICATED ON THE PLANS IS APPROXIMATE AND THEIR EXACT LOCATION IS THE RESPONSIBILITY OF THE CONTRACTOR'S RESPONSIBILITY TO MAKE ARRANGEMENTS WITH THE UTILITY OWNERS PRIOR TO WORKING IN THE AREA, TO CONFIRM THEIR EXACT LOCATIONS, AND TO IDENTIFY ANY OTHER ADDITIONAL UTILITIES OTHER THAN THOSE SHOWN ON THE PLANS MAY BE PRESENT.

THE PLANS SHOW THE STATUS OF UTILITY LOCATIONS AS OF JUNE 6, 2016.

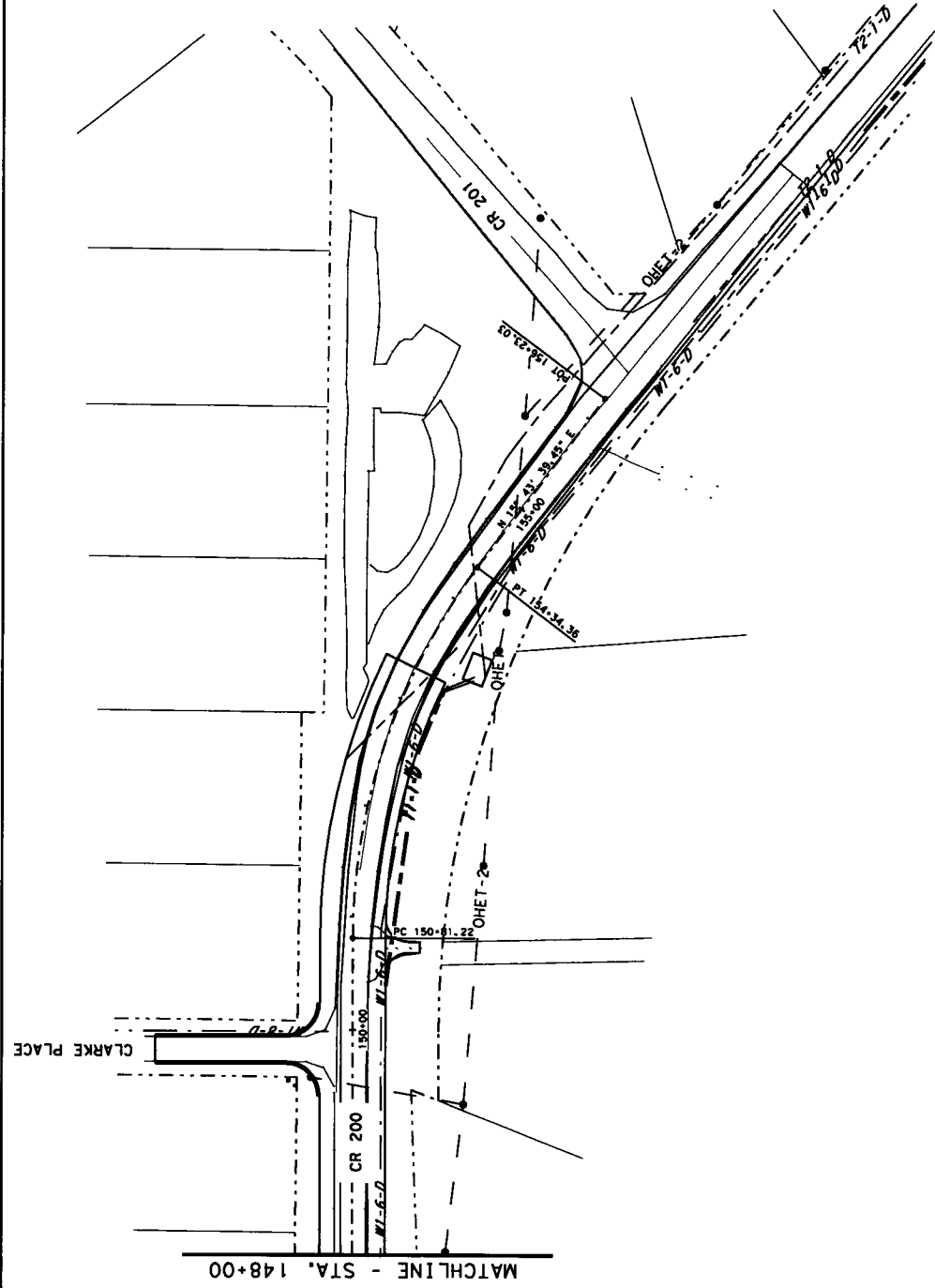
INTERIM REVIEW
 THIS DOCUMENT IS RELEASED FOR THE PURPOSE OF INTERIM REVIEW UNDER THE AUTHORITY OF Daniel A. Rogers, P.E. 081794 ON 2/19/2015. IT IS NOT TO BE USED FOR CONSTRUCTION PURPOSES.



 WILLIAMSON COUNTY PRECINCT #2	 JONES CARTER <small>Team Based Professional Engineers, Architects, Inc. #420 620 West Loop South, Suite 250, Houston, Texas 77030-7701 (281) 357-3337</small>	 WSB & ASSOCIATES, INC. <small>P.E. # 16849</small>	CR 200 FROM CMTA R.R. TO CR 201 EXISTING UTILITIES
SHEET 3 OF 3			SHEET # 117