



LOTT FENCE

P.O. Box 1597 • Round Rock, Texas 78680
 (512) 845-4719 • LottFence@aol.com
 www.LottFence.com

Date 1-16-20

CONTRACT

Name Williamson County Erected At Southeast Jones Loop
 Bill To _____ City _____ State/Zip _____

This contract is made with the understanding and agreement that the Purchaser will locate and make plainly visible all property pins or place stakes for all end, corner and gate posts for the erection or repair of the fence. The Purchaser also assumes full responsibility for same thus Lott Fence is relieved of all liability for placement of fence. The lines for the erection or repair of the fence will be cleared by the Purchaser. Lott Fence is not responsible for any damages to underground installations such as sprinklers, waterlines, cables, sewers, wiring, pipes, tubing, conduits, drains, or such unless location of said installations are plainly marked off above ground as to their exact location. Fencing and especially wood fences are not free from knots, splits, wane, spikes, checking, warps, stains, gouges, chert, spots, cracks, and other imperfections. A fence is not a substitute for landscaping. In reference to fence line grade, uneven terrain will have more grade breaks while flatter surfaces will have fewer grade changes. Ground is never "bubble level" or "straight" in dealing with fence line grade. The bottoms of fences sometimes have ground contact in areas, and fence bottoms often have gaps in other locations due to grade. Lott Fence is never responsible for closing gaps at the bottom of a fence or a gate. All information printed here is accepted by the Purchaser.

_____ FT. _____ FT. HIGH _____ FENCE @ _____ FT. \$ _____
 PICKET SIZE _____ PICKET GRADE _____ PICKET STYLE _____ @ _____ EA. \$ _____
 _____ SINGLE WALK GATE(S) @ _____ EA. \$ _____
 _____ DOUBLE DRIVE GATE(S) @ _____ EA. \$ _____
 RAILS _____ POSTS _____
 _____ FT. 6 FT. HIGH CHAIN LINK FENCE 9.0 GAUGE FABRIC @ _____ FT. \$ _____
 LINEPOST SIZE (O.D. X LENGTH) _____ x _____ GAUGE _____
 TOP RAIL SIZE (O.D. X LENGTH) _____ x _____ GAUGE _____
 TERMINALS (O.D. X LENGTH) _____ x _____ GAUGE _____ @ _____ EA. \$ _____
1-Single Swing Gate @ _____ EA. \$ _____
15/8 welded x 7 GAUGE @ _____ EA. \$ _____
FRAME SIZE 7 6 6 6 HIGH @ _____ EA. \$ _____
 GATE(S) _____ FRAME SIZE _____ OPENING _____ HIGH @ _____ EA. \$ _____
 DETAILS: Extend 2-2 3/8 lineposts by welding @ _____ PR. \$ _____
extensions so that they can be @ _____ PR. \$ _____
used for terminal posts. Pull two 6 ft @ _____ PR. \$ _____
3 strand sections into new terminals @ _____ PR. \$ _____

▲ = DENOTES FINISH SIDE

X-3 Strand Barbed Wire For top of Swing Gate.

DIAGRAM TOTAL CONTRACT \$ 1487.36
 TAX EXEMPT

Texas Prompt Payment Act Compliance: Payment for goods and services shall be governed by Chapter 2251 of the Texas Government Code. An invoice shall be deemed overdue the 31st day after the later of (1) the date Customer receives the goods under the contract; (2) the date the performance of the service under the contract is completed; or (3) the date the Williamson County Auditor receives an invoice for the goods or services. Interest charges for any overdue payments shall be paid by Customer in accordance with Texas Government Code Section 2251.025. More specifically, the rate of interest that shall accrue on a late payment is the rate in effect on September 1 of Customer's fiscal year in which the payment becomes due. The said rate in effect on September 1 shall be equal to the sum of one percent (1%); and (2) the prime rate published in the Wall Street Journal on the first day of July of the preceding fiscal year that does not fall on a Saturday or Sunday.

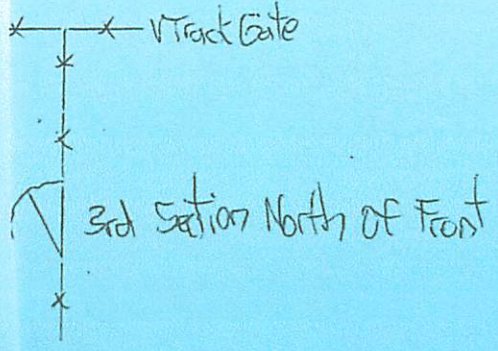

TERMS: Payment of total balance is due immediately upon completion of job.
 MECHANICS LIEN: All materials supplied shall remain the property of Lott Fence until all sums due are paid in full.

Accepted By Purchaser Bill Hummel
 Home # _____ Work # _____
 Fax # _____ Other # _____

D. Crandall
 LOTT FENCE