

WILLIAMSON COUNTY, TEXAS
CHANGE ORDER NUMBER: 13

Contractor: Capital Excavation NTP Required: ☐ Yes ☒ No
Project Name: CR 111 Westinghouse Road
Change Order Work Limits: Sta. 10+64.50 to Sta. 208+50.00
Type of Change(on federal-aid non-exempt projects): Minor (Major/Minor)
Reasons: 1B, 2I, 4B (3 Max. - In order of importance - Primary first)

Contract Award Date:	1/11/2022
Project Number:	22IFB39
Funding Source:	P292
Roadway:	CR 111
CSJ Number:	N/A

Describe the work being revised:

1B. Design Error or Omission. Other. This Change Order addresses the need for low fill post, concrete footing, and a driveway terminal section not accounted for in the plans. This Change order also addresses the incorrect called out sign post that were installed per plan. **2I. Differing Site Conditions. Additional safety needs.** This Change Order compensates the contractor for upsizing the stop signs at the new 4-way intersection. **4B. Third Party Accommodation. Third party requested work.** Eliminated the striping and created a right turn lane on northbound FM 1460 at CR 111 per TxDOT.

Work to be performed in accordance with Items: See attached
New or revised plan sheet(s) are attached and numbered: 2, 112A, 114A
New Special Provisions/Specifications to the contract are attached: ☐ Yes ☒ No
New Special Provisions to Item N/A No. N/A. Special Specification Item N/A are attached.
Each signatory hereby warrants that each has the authority to execute this Change Order (CO).

<small>The contractor must sign the Change Order and, by doing so, agrees to waive any and all claims for additional compensation due to any and all other expenses; additional changes for time, overhead and profit; or loss of compensation as a result of this change.</small>	The following information must be provided
THE CONTRACTOR Date 5/30/24	Time Ext. #: 0 Days added on this CO: 0
By [Signature]	Amount added by this change order: \$15,975.61
Typed/Printed Name [Signature]	Original Contract Amount: \$21,024,332.88
Typed/Printed Title XP	Total Change Orders To-Date: \$1,540,228.14
	Percent Change in Original Contract: 7.33%

RECOMMENDED FOR EXECUTION:

[Signature] 5/30/2024
Senior Construction Engineer Date
[Signature] 6/6/2024
GEC Project Manager Date

N/A
3rd Party Signature Date

RECOMMENDED FOR EXECUTION:

[Signature] 6/6/2024
Department of Infrastructure Date
Williamson County

APPROVED:

[Signature]
Bill Gravell (Jun 24, 2024 09:26 CDT) Jun 24, 2024
Presiding Officer of the Date
Williamson County Commissioners Court

WILLIAMSON COUNTY, TEXAS

CHANGE ORDER NUMBER: 13

Project # 22IFB39

TABLE A: Force Account Work and Materials Placed into Stock[illegible]**TABLE B: Contract Items:**

				ORIGINAL + PREVIOUSLY REVISED		ADD or (DEDUCT)	NEW		
ITEM	DESCRIPTION	UNIT	UNIT PRICE	QUANTITY	ITEM COST	QUANTITY	QUANTITY	ITEM COST	OVERRUN/ UNDERRUN
420-6043	CL C CONC (FOOTING)	CY	\$1,064.64	0.00	\$0.00	5.00	5.00	\$5,323.20	\$5,323.20
540-6015	DRIVEWAY TERMINAL ANCHOR SECTION	EA	\$1,100.00	0.00	\$0.00	1.00	1.00	\$1,100.00	\$1,100.00
540-001	LOW FILL STEEL POST	EA	\$390.00	0.00	\$0.00	10.00	10.00	\$3,900.00	\$3,900.00
644-001	ADDITIONAL SIGNS AND SIGN REPLACEMENT	LS	\$3,408.98	0.00	\$0.00	1.00	1.00	\$3,408.98	\$3,408.98
677-001	STRIPING ELIMINATION (FM 1460)	LS	\$2,243.43	0.00	\$0.00	1.00	1.00	\$2,243.43	\$2,243.43
TOTALS					\$0.00			\$15,975.61	\$15,975.61

CHANGE ORDER REASON(S) CODE CHART

1. Design Error or Omission	1A. Incorrect PS&E 1B. Other
2. Differing Site Conditions (unforeseeable)	2A. Dispute resolution (expense caused by conditions and/or resulting delay) 2B. Unavailable material 2C. New development (conditions changing after PS&E completed) 2D. Environmental remediation 2E. Miscellaneous difference in site conditions (unforeseeable)(Item 9) 2F. Site conditions altered by an act of nature 2G. Unadjusted utility (unforeseeable) 2H. Unacquired Right-of-Way (unforeseeable) 2I. Additional safety needs (unforeseeable) 2J. Other
3. County Convenience	3A. Dispute resolution (not resulting from error in plans or differing site conditions) 3B. Public relations improvement 3C. Implementation of a Value Engineering finding 3D. Achievement of an early project completion 3E. Reduction of future maintenance 3F. Additional work desired by the County 3G. Compliance requirements of new laws and/or policies 3H. Cost savings opportunity discovered during construction 3I. Implementation of improved technology or better process 3J. Price adjustment on finished work (price reduced in exchange for acceptance) 3K. Addition of stock account or material supplied by state provision 3L. Revising safety work/measures desired by the County 3M. Other
4. Third Party Accommodation	4A. Failure of a third party to meet commitment 4B. Third party requested work 4C. Compliance requirements of new laws and/or policies (impacting third party) 4D. Other
5. Contractor Convenience	5A. Contractor exercises option to change the traffic control plan 5B. Contractor requested change in the sequence and/or method of work 5C. Payment for Partnering workshop 5D. Additional safety work/measures desired by the contractor 5E. Other
6. Untimely ROW/Utilities	6A. Right-of-Way not clear (third party responsibility for ROW) 6B. Right-of-Way not clear (County responsibility for ROW) 6C. Utilities not clear 6D. Other

Change Order Worksheet

Contract Name CR 111 Westinghouse

Solicitation #: 22IFB39

Date awarded 1/11/2022

Awarded Contract Amount

\$21,024,332.88

Percentage Change

Change order #1	\$233,364.00	1.11%
Change order #2	\$7,553.84	0.04%
Change order #3	\$20,307.20	0.10%
Change order #4	\$454,267.40	2.16%
Change order #5	\$41,134.66	0.20%
Change order #6	\$24,159.20	0.11%
Change order #7	\$28,440.00	0.14%
Change order #8	\$276,200.00	1.31%
Change order #9	\$14,282.00	0.07%
Change order #10	\$39,507.50	0.19%
Change order #11	\$81,433.12	0.39%
Change order #12	\$303,603.61	1.44%
Change order #13	<u>\$15,975.61</u>	0.08%

Total changes to date

\$1,540,228.14

7.33%

(Running totals here)

Adjusted contract amount

\$22,564,561.02

Williamson County Road Bond Program

CR 111 Westinghouse Rd Williamson County Project No. 22IFB39 Change Order No. 13

Reason for Change

This Change Order compensates the contractor for installing low fill metal beam guard fence posts, concrete footing, and a driveway terminal anchor section that were not called out in the plans. Due to the lack of cover over Culvert 1, the guardrail could not be installed per plan and was switched to low fill posts with a concrete footing.

This Change Order also addresses various small sign discrepancies in the plans and added signs for additional safety measures. Several sign posts had to be changed, in order to accommodate the correct sign installation. Also, a few small signs were added that were missing from the plans and the size of the stop signs was increased to improve safety at the new 4-way intersection of CR 111 and CR 110.

Lastly, the Change Order compensates the contractor for creating a right turn lane on northbound FM 1460 at CR 111, per a request from TxDOT.

The following is a list of new items required for this Change Order.

ITEM	DESCRIPTION	QTY	UNIT
420-6043	CL C CONC (FOOTING)	5	CY
540-6015	DRIVEWAY TERMINAL ANCHOR SECTION	1	EA
540-001	LOW FILL STEEL POST	10	EA
644-001	ADDITIONAL SIGNS AND SIGN REPLACEMENT	1	LS
677-001	STRIPING ELIMINATION (FM 1460)	1	LS

This Change Order results in an increase of \$15,975.61 to the Contract amount, for an adjusted Contract total of \$22,564,561.02. The original Contract amount was \$21,024,332.88. As a result of this and previous Change Orders, \$1,540,228.14 has been added to the Contract, resulting in a 7.33% increase in the Contract cost. As a result of this Change Order, zero (0) days will be added to the Contract.

HNTB Corporation

Oscar Salazar-Bueno, P.E.



PO Box 1301
Austin, TX 78767
Email: Estimating@CapitalExcavation.com

Change Request # 29

Date: 3/6/2024

QuoteTo:

Project: CR 111 / 110 (1024)

Capital Project #: 1024

Description:

Item	Description	Quantity	Unit	Unit Price	Amount
540-6015	Driveway Terminal Anchor Section	1.00	EA	1,200.00	1,200.00 \$1,100.00
540-001	Low Fill Steel Post	10.00	EA	415.00 \$390.00	4,150.00 \$3,900.00
420-6043	Footing for MBGF CL C CONC (FOOTING)	85.00 5	LF CY	97.00 \$1,064.64	8,245.00 \$5,323.20
GRAND TOTAL					\$10,323.20 13,595.00

Scope: Pricing for low fill steel posts MBGF over a culvert which requires a footing for the installation of the MBGF.

Capital Excavation Requests an additional : TIA day(s)

Prices have been compared to recently let projects and are in line with TxDOT Bid Averages.



PO Box 1301
Austin, TX 78767
Email: Estimating@CapitalExcavation.com

Change Request # 31

Date: 4/10/2024

QuoteTo:

Project: CR 111 / 110 (1024)

Capital Project #: 1024

Description: Additional Signs

Item	Description	Quantity	Unit	Unit Price	Amount
644-001	Additional Signs	1.00	LS	3,696.00	3,696.00 \$3,381.00
677-001	Striping Elimination	1.00	LS	2,238.00	2,238.00 \$2,215.45

GRAND TOTAL

~~5,934.00~~
\$5,596.45

Scope: Permanent DO NOT ENTER signs at both sides of the driveway at sta 86+50 as appropriate and add a no left turn for the WB lane east of the driveway and additional signs. Elimination of existing striping at the driveway.

1% Bond: \$55.96
Total: \$5,652.41

Capital Excavation Requests an additional : day(s)

644-001 Additional Signs - \$3,381.00 + \$27.98 (1% Bond) = \$3,408.98

677-001 Striping Elimination - \$2,215.45 + \$27.98 (1% Bond) = \$2,243.43
\$5,652.41

CHANGE ORDER QUOTE

Job Specifications

ITEM	DESCRIPTION	UNIT	QTY	UNIT PRICE	TOTAL
	1	CHANGE OUT POST FOR CENTER LANE SIGN	EA	2	\$350.00 \$700.00
	2	ADD DO NOT ENTER SIGN (TWT) WS (P)	EA	2	\$385.00 \$770.00
	3	ADD WING CHANNEL TO 48" STOP SIGN / STREET NAME SIGN / NEW POST	EA	4	\$400.00 \$1,600.00
		*ADDITIONAL \$270.00 WILL BE BILLED FOR NEW 48" STOP SIGN.			
	4	ADD STREET NAME SIGN TO SUBDIVISION	EA	2	\$75.00 \$150.00
				PI TOTAL	\$3,220.00
				SUBTOTAL	\$3,220.00
				TAX	\$265.65

Total:	\$3,485.65
	\$3,220.00

- *Contractor shall assist in locating Utilities that may be in conflict with installations.
- *There will be a \$125.00 Coring fee PER UNIT if Signs are to be installed in Concrete surfaces.
- * Allow two weeks for manufacturing of signs and mounts prior to installation date.
- *Price is based on one mobilization. Each additional will be billed at \$950.00
- * Rate excludes flashing beacons

5% Sub Mark-up \$161.00
Total: \$3,381.00

*If the Project is Tax Exempt, please provide certificate.
 *Proposal Contingent upon both parties executing a mutually agreed upon subcontract.
 *Proposal good for (10) working days from date of this quote.

Signature Lee Vanover 3
OPERATIONS MANAGER
TRP CONSTRUCTION GROUP,LLC.

Date 4/9/2024

Accepted by

Title _____

Date _____



FLASHER Equipment Co

Main Office:
5827 W. US HWY 90
San Antonio, Tx 78227
Phone: 210-736-4251
Fax: 210-736-2084
www.flasherequipment.com

75 County Road 372
Jarrell, TX 76537
Phone: (512) 746-4441
Fx: (512) 746-4444

PROJECT: CR 111 AND CR 110 NORTH WIDENING
DATE: APRIL 15, 2024
TERMS: 30 DAYS WITH ACCOUNT / PRE PAY WITHOUT ACCOUNT
LOCATION: WILLIAMSON COUNTY

QUOTE # 18059B

CHANGE ORDER

PAVEMENT MARKINGS

ITEM	Description	Unit	Qty.	Price	Amount
	MOBILIZATION	LS	1	\$1,250.00	\$1,250.00
677-6005	ELIM EXT PAV MRK & MRKS (12")	LF	131	\$3.51	\$459.81
677-6007	ELIM EXT PAV MRK & MRKS (24")	LF	57	\$7.02	\$400.14

* CHANGE ORDER ITEMS ARE TAKEN FROM FLASHER EQUIPMENT WORK
ORDER # 75407, DATED: 04/03/2024.

TOTAL \$2,109.95

NOTES AND EXCLUSIONS

5% Sub Mark-up \$105.50
Total: \$2,215.45

PAVEMENT MARKINGS

- * All notes and exclusions from original proposal shall apply to this change order.
- * Any items not specifically noted will be additional.

GENERAL

- * FLASHER EQUIPMENT WARRANTS WORKMANSHIP AND MATERIALS ONLY. REPAIRS DUE TO NORMAL WEAR, VANDALISM, OR NEGLIGENCE WILL BE PERFORMED ON AN EXTRA WORK BASIS.
- * BILLING FOR THE PROJECT WILL BE FOR THE TERM ITEMS ARE ON SITE, REGARDLESS OF PAYMENT FROM OWNER.
- * PRICES DO NOT INCLUDE TAX.
- * PRICES QUOTED ARE GOOD FOR 30 DAYS.
- * Any discrepancy between the Flasher Equipment Company bid proposal, this document, and the contract documents, this bid proposal shall supersede and prevail.
- * IF RETAINAGE IS NOT DEFINED BELOW, THEN ALL MONEY'S WILL BE DUE AS BILLED.
- * FLASHER EQUIPMENT COMPANY DOES NOT INDEMNIFY GENERAL CONTRACTOR OR PROJECT OWNERS FOR ACCIDENTS, INJURY, OR DEATH CAUSED SOLELY BY GENERAL CONTRACTOR OR PROJECT OWNERS ACTIVE OR PASSIVE NEGLIGENCE.

SUBMITTED David McMullen
Estimator

ACCEPTED: _____
Name

Title

Date

Job/PO#

FILE: P:\22000-22999\22009.Wilco.CR111.Route.Study\Drawings\Plans\General\Supplemental.Index.of.Sheets.dgn PRINTED: 3/1/2024 @ 9:03:41 AM
PENTABLE: S:\Software\Bentley\Standards\tables\Pen\Grayscale\ColorLogo.tbl C:\ProgramData\Bentley\MicroStation\Bentley\ERSELECTseries\Workspace\system.pltcfq\printer.pltcfq

SHEET NO.	DESCRIPTION
1	GENERAL
2	TITLE SHEET
3 - 8	SUPPLEMENTAL INDEX OF SHEETS
9 - 13	PROJECT LAYOUT
14A - 14Z	TYPICAL SECTIONS
15	GENERAL NOTES AND SPECIFICATIONS
16	ESTIMATE & QUANTITIES
17	SUMMARY OF TRAFFIC CONTROL QUANTITIES
18	SUMMARY OF ROADWAY QUANTITIES
19	SUMMARY OF DRAINAGE QUANTITIES
20	SUMMARY OF SIGNING, STRIPING AND DELINEATION QUANTITIES
21	SUMMARY OF TRAFFIC SIGNAL QUANTITIES
22	SUMMARY OF EROSION CONTROL QUANTITIES
23	SUMMARY OF DRIVEWAYS
24 - 25	SUMMARY OF CROSS STREETS
	SUMMARY OF SMALL SIGNS
26	TRAFFIC CONTROL
27	TRAFFIC CONTROL PLAN CONSTRUCTION SEQUENCING NOTES
28 - 31	TRAFFIC CONTROL PLAN SIGNAGE
32 - 36	TRAFFIC CONTROL PLAN TYPICAL SECTIONS
37 - 46	TRAFFIC CONTROL PLAN PHASE I
47 - 56	TRAFFIC CONTROL PLAN PHASE II
	TRAFFIC CONTROL PLAN PHASE III
57 - 68	TRAFFIC CONTROL STANDARDS
69	BC(1)-14 THRU BC(12)-14
70	WZ(TD)-13
71	WZ(STPM)-13
72	WZ(UL)-13
73 - 74	WZ(RCD)-13
75 - 77	WZ(BTS-1)-13 THRU WZ(BTS-2)-13
78 - 80	TCP(1-1)-12 THRU TCP(1-3)-12
81 - 82	TCP(2-1)-12 THRU TCP(2-3)-12
83	TCP(3-1)-13 THRU TCP(3-2)-13
84	TCP(3-3)-14
85	TCP(3-4)-13
	TCP(7-1)-13
86 - 87	ROADWAY
88 - 105	HORIZONTAL ALIGNMENT DATA
106 - 107	CR 111 PLAN & PROFILE
108	CR 110 PLAN & PROFILE
109	CR 105 SPUR PLAN & PROFILE
110	(OMITTED)
111	INTERSECTION LAYOUT - CR 110
	DETAILS OF DRIVEWAYS
112 - 112A	ROADWAY STANDARDS
113	GF(31)-14 & CONCRETE FOOTING FOR MBGF
113A - 113C	GF(31)MS-11
114	TRAFFIC RAIL (TYPE T223)
115 - 118	SGT(8)31-14
118A	PED-12A
118B	COLOR TEXTURED CONCRETE AND LANDSCAPE PAVERS
	CITY OF GEORGETOWN RIBBON CURB DETAILS
119 - 120	DRAINAGE
121	DRAINAGE AREA MAP
122 - 125	HYDROLOGIC AND HYDRAULIC DESIGN DATA
126 - 129	HYDROLOGIC AND HYDRAULIC DESIGN DATA - PROPOSED CULVERTS
130 - 131	HYDROLOGIC AND HYDRAULIC DESIGN DATA - EXISTING CULVERTS
132 - 133	RIGHT DITCH DESIGN DATA
134 - 145	LEFT DITCH DESIGN DATA
146	CROSS-CULVERT LAYOUTS
147 - 148	ENERGY DISSIPATER DETAIL
149 - 154	STORM SEWER DRAINAGE AREAS
155	STORM SEWER PLAN & PROFILE
156	STORM SEWER DESIGN DATA
	MISCELLANEOUS DRAINAGE DETAILS
157	DRAINAGE STANDARDS
158 - 159	SCC-MD
160	SCC-5&6
161	SCP-MD
162	SCP-5
163	SCP-6
164	MC-MD
165 - 166	(OMITTED)
167	MC-5-20
168	ECD
169	(OMITTED)
170	SW-0
171	FW-S
172	PW
173	CH-PW-S
174A	CH-FW-0
174B	CH-FW-15
175	CH-FW-30
176 - 178	CH-FW-45
179	SETP-FW-0
180 - 181	SETP-PD
182	SETP-CD
183	PSET-SP
184	PSET-RP
185	PB
	PJB

SHEET NO.	DESCRIPTION
186	DRAINAGE STANDARDS (CONT.)
187 - 188	PDD
189	PCO
190 - 191	CGT-PCO
	PSL
192	EROSION CONTROL
193 - 202	STORM WATER POLLUTION PREVENTION PLAN (SW3P)
	EROSION CONTROL PLAN
203 - 205	EROSION STANDARDS
205 - A-C	EC(1)-16 THRU EC(3)-16
	EC(9)-16
206 - 215	TRAFFIC
216 - 217	SIGNING, STRIPING AND DELINEATION
218	SMALL SIGN DETAILS
219	EXISTING SIGNAL LAYOUT - CR 111 (WESTINGHOUSE RD) ● FM 1460
220	PROPOSED SIGNAL LAYOUT - CR 111 (WESTINGHOUSE RD) ● FM 1460
	PROPOSED SIGNAL ELEVATION - CR 111 (WESTINGHOUSE RD) ● FM 1460
221 - 223	TRAFFIC STANDARDS
224 - 228	PM(1)-12 THRU PM(3)-12
229 - 232	TSR(1)-13 THRU TSR(5)-13
233	D&OM(1)-15 THRU D&OM(4)-15
234	D&OM(VIA)-15
235 - 237	SMD(GEN)-08
238	SMD(SLIP-1)-08 THRU SMD(SLIP-3)-08
239 - 242	SMD(TWT)-08
243	MB-15(1)
244 - 249	ED(1)-14
250	ED(3)-14 THRU ED(8)-14
	ED(11)-14
251 - 261	UTILITIES
	EXISTING UTILITY LAYOUT
262 - 380	CROSS SECTIONS
381 - 387	PROPOSED CROSS SECTIONS
388	PROPOSED CROSS SECTIONS (CR 110)
	ADDITIONAL CROSS STREET CROSS SECTIONS - CR 111
BEGINNING OF CR 110 NORTH SHEETS	
389 - 393	GENERAL
394 - 398	GENERAL SHEETS (G1 - G5)
	QUANTITY SHEETS (Q1 - Q5)
399	TRAFFIC CONTROL SHEETS
400 - 402	TRAFFIC CONTROL PLAN SEQUENCE OF CONSTRUCTION
403 - 411	TRAFFIC CONTROL PHASE I (TCP1 - TCP3)
	TRAFFIC CONTROL STANDARD DETAILS
412 - 423	BARRICADE & CONSTRUCTION STANDARDS
	BARRICADE & CONSTRUCTION SHEETS (BC(1)-14 - BC(12)-14)
424 - 427	REMOVAL PLAN
	DEMOLITION SHEETS (R1 - R4)
428 - 434	ROADWAY PLAN
	PLAN AND PROFILE SHEETS (P1 - P7)
435 - 448	DRIVEWAY DETAILS
	DRIVEWAY DETAIL SHEETS
449	DRAINAGE
450	DRAINAGE AREA MAP (DR 2)
	DITCH CAPACITY TABLE (DT 1)
451 - 454	SIGNAGE & PAVEMENT MARKING PLAN & DETAILS
454 - 464	SIGNING & PAVEMENT MARKING PLAN (S1 - S4)
	SIGNAGE & PAVEMENT MARKING DETAILS
465	EROSION CONTROL SHEETS & DETAILS
466 - 469	STORMWATER POLLUTION PREVENTION PLAN (SW3P)
470 - 472	EROSION CONTROL PLAN (ES1 - ES4)
	EROSION CONTROL DETAILS
473 - 494	CROSS SECTIONS
	CROSS SECTION SHEETS (X1 - X22)
495	MBC MANSIONS SHEETS
496	OVERALL WATER PLAN
497	SANITARY SEWER LINE P PLAN & PROFILE STA. 1+00 - STA. 5+20
	CHANNEL PLAN & PROFILE STA. 13+80-STA. 16+23
498 - 527	JONAH WATER PLANS
	(12/22/20): CULV & CS REVS
	(06/08/22): RFI #9
	(08/26/22): RFI #27
	(03/01/24): RFI #46
528 - 538	GATEWAY WW PLANS

REVISION 2, 6, 8, & 14 ONLY



THE STANDARDS AND SPECIFICATIONS IDENTIFIED HEREIN HAVE BEEN SELECTED BY ME OR UNDER MY SUPERVISION AND ARE APPLICABLE TO THIS PROJECT.



10/12/16



© 2016



ADDRESS	1978 S. AUSTIN AVENUE	GEORGETOWN, TX 78626
TEL	512.930.9412	TSPS FIRM NO. 151
TEL	512.930.9412	TBPLS FIRM NO. 10003700
WEB	STEGERBIZZELL.COM	
SERVICES	>>ENGINEERS	>>PLANNERS >>SURVEYORS

WILLIAMSON COUNTY
CR 111 IMPROVEMENTS

SUPPLEMENTAL
INDEX OF SHEETS

DATE: 3/1/2024	DN:	DW:	CK:	AP:
FED. RD. DIV. NO. 6	FEDERAL AID PROJECT NO. ----	SHEET NO. 2		
STATE TEXAS	DIST. ---	COUNTY WILLIAMSON		
CONT. ---	SECT. --	JOB ---	HIGHWAY NO. CR 111	

SUPPORT CONCRETE GENERAL NOTES

1. DESIGNED ACCORDING TO 2017 AASHTO LRFD BRIDGE DESIGN SPECIFICATIONS (8TH EDITION) (HL93 LOADING).
2. PROVIDE CLASS "C" CONCRETE.
3. PROVIDE GRADE 60 REINFORCING STEEL
4. AT CONTRACTOR'S OPTION, SUPPORT CONCRETE FOR MBGF STEEL POST CAN BE POURED MONOLITHICALLY WITH CURB AND GUTTER TYPE II, ADJUST HORIZONTAL LEG LENGTH OF BAR L TO EXTEND THROUGH CURB AND GUTTER SECTION WITH 2" END BAR COVER.



02/29/2024

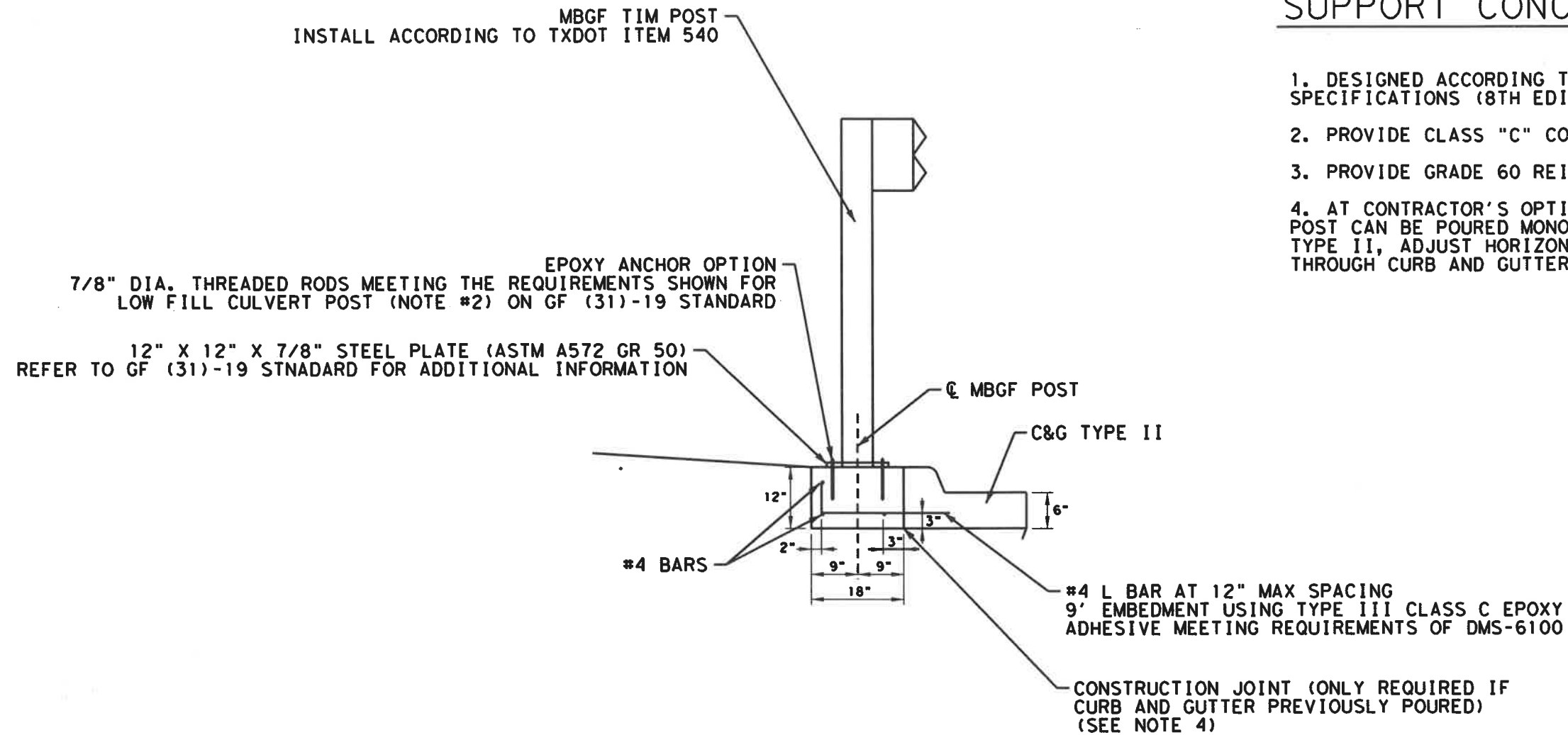

CONCRETE FOOTING FOR MBGF



BARS L

 WILLIAMSON COUNTY 1848				© 2024
<div style="border: 2px solid green; border-radius: 15px; padding: 10px; display: inline-block;">  STEGER BIZZELL </div>				
ADDRESS 1978 S. AUSTIN AVENUE		GEORGETOWN, TX 78626		
PHONE 512.930.8412	TYPE FIRM NO. 181		WEB	STEGERBIZZELL.COM
SERVICES	>>ENGINEERS	>>PLANNERS	>>SURVEYORS	
WILLIAMSON COUNTY CR 111 IMPROVEMENTS				
CONCRETE FOOTING FOR MBGF				
DATE: 2/29/2024	DN:	DW:	CK:	AP:
FED. RD. DIV. NO. 6	FEDERAL AID PROJECT NO. ----			SHEET NO. 112A
STATE	DIST.	COUNTY		
TEXAS	---	WILLIAMSON		
CONT.	SECT.	JOB	HIGHWAY NO.	
----	--	---	CR 111	

DATE:
FILE:

