

City of Woodland

300 First Street - Woodland, CA 95695 Phone - 530-661-5813 Fax: 530-666-7257

DATE: September 27, 2022

TO: Ian Evans, Adult & Aging Branch Director Yolo County HHSA
Chad Rinde, Chief Financial Officer Yolo County

RE: **American Rescue Plan Act Funding Request from the City of Woodland**

Dear Ian Evans:

The City of Woodland is formally requesting \$500,000 in County American Rescue Plan Act (ARPA) funding through the Housing & Homelessness priority category. These funds will be used towards the Phase II shelter addition that will supplement the current 100-bed shelter for individuals experiencing homeless located at the East Beamer Way Campus.

The Phase II shelter addition will consists of the following key on-site services:

- Permanent dining area and Kitchen
- Permanent Bathrooms/Showers/Laundry
- 6 units of non-congregate shelter units. Units will be used to isolate guests who are COVID-19 positive, sick, or need a level of medical respite care.
- Additional staff office space

If funded, the funding request will be utilized to cover the following project expenses:

- \$150,000 for Architectural/Engineering
- \$40,000 for additional grant and project oversight
- \$310,000 for initial infrastructure costs

The total project cost of the Phase II addition is estimated at \$5,000,000. Friends of the Mission has established a fundraising plan to pursue funding from the following sources:

- Yocha Dehe Foundation
- Homeless, Housing, and Prevention Program – Round 4
- Projects for Assistance in Transition from Homelessness (PATH)
- Friends of the Mission General Fund

To date, the City of Woodland has provided significant financial assistance to the East Beamer Way Campus in many ways including:

Gift of the Land	\$750,000
Affordable Housing Funds for Infrastructure	\$1,500,000
Affordable Housing Funds for Emergency Shelter	\$1,000,000
Funding for Predevelopment Costs	\$140,000
Recommitted Partnership Health Plans Grant	\$680,000
In-Kind Staff Time	\$100,000

Additionally, the City of Woodland has served as the applicant and pass-through agency for the Homekey grant where the City was awarded \$15.8 million for the Permanent Supportive

Housing project at the East Beamer Way Campus. Friends of the Mission, Inc. is the beneficiary of the grant.

When all current phases and planned future phases are complete, the campus will consist of an 100-bed emergency shelter, an additional shelter facility with expanded services, 61 permanent supportive housing units, shared community center, and a substance use disorder treatment facility. These amenities will continue to provide essential support services and shelter to some of the most vulnerable individuals and families in Woodland, Yolo County and the region overall.

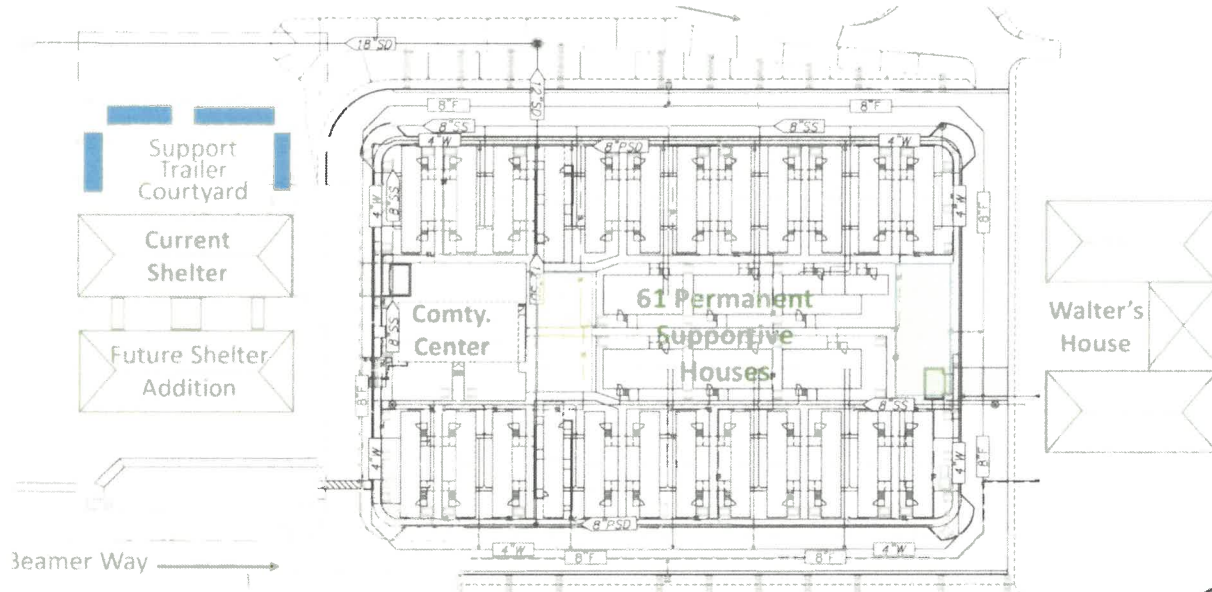

In addition, the City is also considering providing up to \$900,000 to the Freeman Garden Court affordable housing project which is a collaboration between Woodland Opportunity Village, Inc. and Friends of the Mission, Inc. The project will consist of 12 duplexed tiny homes with a common community building with laundry facilities, office space, a gathering room, and a bathroom. This project will offer housing to persons experiencing or at risk of homelessness with economic mix of very low income and low income households. This project originally sought allocation of ARP funds from the City and County. Staff advised that, due to the small size of the project, the proponents seek non-federal or state funds to avoid the constraints and administrative obligations of such funds. The City is therefore recommending that the County prioritize consideration of \$500,000 in remaining ARP funds to go toward the next phase of the Emergency Shelter at the East Beamer Way Campus.

If awarded, the City's request of \$500,000 from the County's ARPA funds will ensure the City's continued vision and goal of providing essential support services and shelter to individuals and families experiencing homelessness.

Thank you for your consideration.

Sincerely,

Ken Hiatt
City Manager