

R&R Pacific Construction

Friday, December 13, 2024
To: Yolo County
Attn: Estimating



619 1/2 Main Street
 Woodland, CA
 LIC #991942
 T: (530) 668-7525

estimating@rrpaccon.com

Bid Proposal: Sidewalk Repair - County Road 116

Referenced Plan Set: See Image Attachment

Description of Work: Price to provide labor, equipment, and material associated with site earthwork, aggregate, asphalt paving, Concrete Sidewalk, and standard jobsite clean up.

Please Note: Pricing is valid for Ninety days upon receipt of this proposal via fax or email, and is subject to change if the intended scope of work is phased or divided. Pricing is based on one (1) move-in per phase.

Prevailing Wage/Davis-Bacon: This pricing is based on Prevailing/Davis-Bacon wages.

Item#	Asphalt Paving	Quantity	Units
1	Furnish and Install AC Patch from Gutter on County Road 116	97	LF
2	Furnish and Install 12' Wide Continental Crosswalk	56	LF

Bid is based on one mobilization for scope. Additional mobilizations will be an extra cost.

Bid excludes Seal Coat *

Pricing based on \$780/TN rack rate

Total Asphalt Price: \$11,109.26

Item#	Aggregates	Quantity	Units	Size
1	Furnish and Install Class 2 AB at Sidewalk for County Road 116	435	SF	6"
2	Furnish and Install Class 2 AB at Curb and Gutter for County Road 116	97	LF	6"
3	Furnish and Install Class 2 AB at AC Patchback for County Road 116	97	LF	6"

Bid is based on one mobilization for scope. Additional mobilizations will be an extra cost.

Total Aggregate Price: \$16,249.17

Item#	Earth Work	Quantity	Units
1	Provide Equipment & Labor to Fine Grade Sidewalk Co Ro 116	97	LF
2	Provide Equipment & Labor to Fine Grade Curb and Gutter Co Ro 116	97	LF

Bid is based on one mobilization for scope. Additional mobilizations will be an extra cost.

Unsuitable/rocky soil conditions excluded from pricing, unless noted.

Dewatering and Lime Treat or GeoFabric are excluded

Total Earth Work Price: \$10,830.19

Item#	Demolition	Quantity	Units
1	Asphalt Demo (2' Gutter Buffer)	97	LF
2	Sidewalk Demo	67	LF
3	Hershey & Co Ro 116 Corner Ramp Demo	1	EA
4	Asphalt Striping Grinding at Co Ro 116	56	LF
5	Curb and Gutter Demo	97	LF
6	Sawcutting	120	LF

Bid is based on one mobilization for scope. Additional mobilizations will be an extra cost.

Total Demolition Price: \$11,524.25

Item#	Concrete	Quantity	Units	Size
1	Provide Equipment & Labor for Sidewalk on Co Ro 116 - no rebar	437	SF	6"
2	Provide Equipment & Labor for Curb and Gutter on Co Ro 116 - no rebar	97	LF	-
3	Provide Equipment & Labor for Truncated Dome on Co Ro 116	2	EA	-
4	Provide Equipment & Labor for ADA Ramp on Co Ro 116 and Hershey	1	LS	6"

Bid is based on one mobilization for scope. Additional mobilizations will be an extra cost.

Total Concrete Price: \$28,330.88

Item#	Traffic Control	Quantity	Units
1	Traffic Control on County Road 116	5	Days

Bid is based on one mobilization for scope. Additional mobilizations will be an extra cost.

Traffic Control Price: \$13,000.00

Total Earthwork, Concrete & Asphalt Price: \$91,043.75

Item#	Work Area Break Down	\$104.05	Quantity	Units
1	Area A Break Down Cost	\$20,810.00	200	SF
2	Area B Break Down Cost	\$28,613.75	275	SF
3	Area C Break Down Cost	\$29,134.00	280	SF
4	Area D Break Down Cost	\$12,486.00	120	SF

Escalation Clause: Material pricing is not guaranteed on this proposal. R&R Pacific Construction reserves the right to pass along material cost increases, dollar for dollar, for all unshipped material. Vendors increase letters, quotes referencing amount and effective date, shall be an accepted form of documentation. This shall be incorporated by a Change Order in the contract.

EXCLUSIONS:

Excluded from this pricing are all fees and permits, bonds, professional engineering and staking, additional move-ins, traffic control (unless noted), remediation of unknown surface conditions, AC pads, embeds, layout of embeds, stained concrete, joint fillers, concrete sealer, railing, grout, demo (unless noted), slurry seal, light post footing, sign relocations, any dewatering, waterproofing, suitable soil import/export (unless noted), unsuitable soils export or import including soil stabilization, lime treatment (unless noted), monument sign footing, sandblasting, sump pump, core drilling, adverse weather conditions such as (rain, snow, high winds, freezing temperatures and heat), temporary fencing, existing sub-base removal, and any BMP.

If General Contractor directs R&R Pacific Construction to commence or to continue with any work, the General Contractor will be responsible for any additional cost associated with damages to, or repair of that work. R&R Pacific Construction is not responsible for concrete cracking which is a natural occurring event, caused by factors beyond R&R Pacific's control.

CONDITIONS:

One mobilization is included in this proposal. If additional phasing or splitting of work is required please call for pricing. All work to be scheduled Monday through Sunday during normal business hours. All schedules are weather permitting. Customer to shut off landscape irrigation prior to start of work. Customer to provide and pay for suitable construction water at the work location. Customer to provide reasonable access to site for trucks and equipment, including any necessary ramps, protective covering etc. based on parking construction vehicles and equipment on site. Customer is responsible to clear vehicles and obstruction from areas of work ahead of agreed-upon schedule. R&R Pacific Construction will barricade and cone upon arrival for work around the perimeter of work areas to block traffic. Any further protection of the work area once barricaded is the responsibility of the Customer. R & R Pacific Construction is not responsible for other persons vandalizing new concrete. R & R Pacific Construction Inc. is a non-union company and will not be signatory to any labor agreements. Prior to commencement of work a contract containing terms mutually agreeable to both parties shall be prepared and executed. The Contents of this proposal document shall be inserted electronically or physically attached to become an integral part of the contract. In the event of any inconsistency between any such contract and this proposal, the terms of this proposal shall prevail.

CONTRACT TERMS:

All quoted prices are subject to change without notice, and all proposed prices automatically expire 90 days after the date of proposal, until customer signs this proposal or another contract is executed by both parties. This contract is contingent upon contractor’s approval of customer’s credit. Work to be done in accordance with specifications and quantities identified above. When the customer requests a change, or in the event of differing site conditions, errors in the plans or specifications, or other circumstances beyond the control of R & R Pacific Construction which cause additional expense and/or time an equitable adjustment to the contract price and time will be made in writing. Whenever practical, prior to commencing any additional work, R & R Pacific will provide an estimate for changes in the work for customer approval. In the event unsuitable surface conditions or any unusual conditions are encountered and the customer is not available to make a decision on how to proceed, R & R Pacific will make a decision and extra costs, will be billed at cost plus 20% for overhead and profit. Owner shall apply for and pay for all construction permits as necessary. In the event this contract should be referred to an attorney for collection and/or in the event that suit be commenced to collect any sums due hereunder, customer agrees to pay reasonable attorney’s fees, court costs, lien proceedings and collections. Should either party bring suit to enforce any other terms hereof, or to decide any controversy or claim arising out of or related to this contract it is agreed the prevailing party shall be entitled to reasonable attorney’s fees, expert fees and costs. In case one or more of the provisions of this Agreement or any application thereof shall be invalid, unenforceable or illegal, the validity, enforceability, and legality of the remaining provisions and any other application shall not in any way be impaired thereby. Any damages for which R&R Pacific Construction may be liable to, customer shall not, in any event, exceed the cash price of this contract.

For: R & R Pacific Construction

Name Title Date

Acceptance of Proposal by Customer:

The above prices, specifications, exclusions, conditions and terms are satisfactory and are hereby accepted. R & R Pacific Construction is hereby authorized to do the work as specified. My signature indicates that funds are available for this work and R&R Pacific Construction will be paid as outlined within this proposal. Acceptance represents that the owner has read and understood, and relies on this entire document.

Signature Title Date

Printed Name

SUBCONSULTANT:

REVISIONS

SYMBOL	DATE	DESCRIPTION

DESIGNED BY:	NO	
DRAWN BY:	JR	
CHECKED BY:	KW	
DATE:	7/31/2024	

KNIGHTS LANDING PARK
 DRIVEWAY/RAMP ADA
 COMPLIANCE EXHIBIT
 KNIGHTS LANDING, CA

SHEET
EXBT

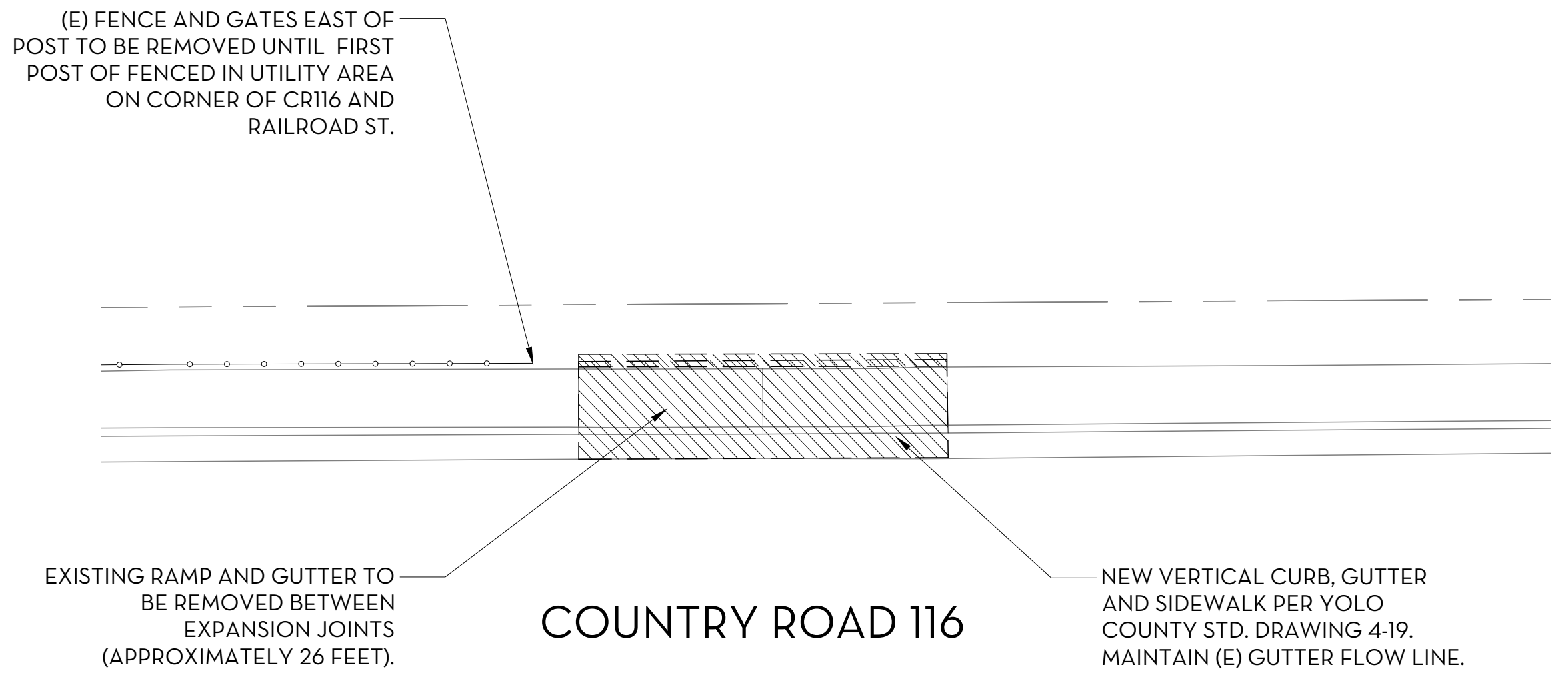

EXISTING DRIVEWAY & GATE

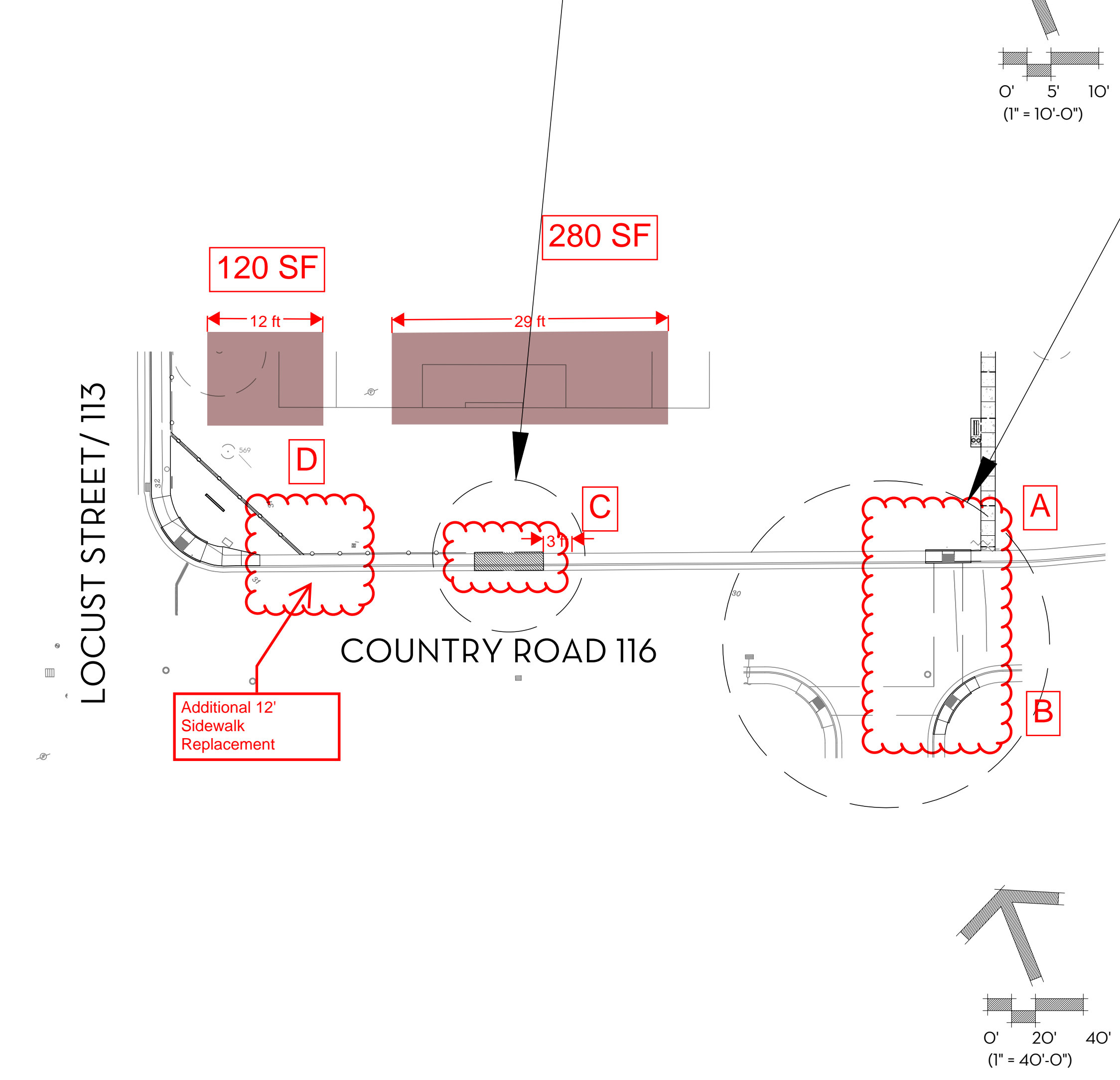

CENTER NEW CURB RAMP PER CALTRANS STANDARD PLAN A88A, CASE C. PROVIDE NEW VERTICAL CURB, GUTTER AND SIDEWALK PER YOLO COUNTY STD. DRAWING 4-19 IN EITHER DIRECTION TO JOIN EXISTING SIDEWALKS. MAINTAIN (E) GUTTER FLOW LINE.

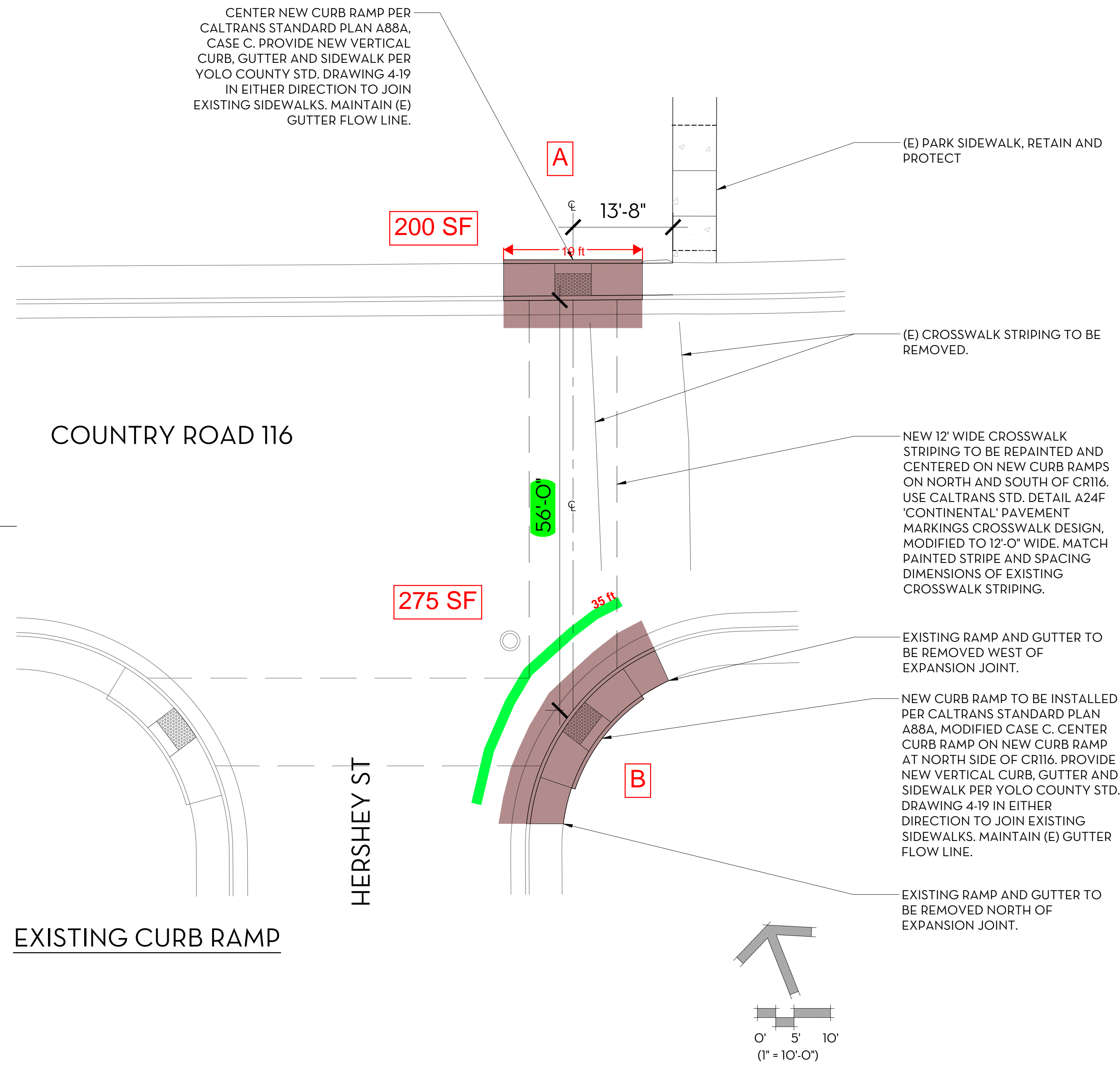

EXISTING CURB RAMP