

COUNTY OF YOLO
General Services Department

WORK AUTHORIZATION
ARCHITECTURAL/ENGINEERING SERVICES
Amendment #2

Agreement Number: 24-07

BOS Agreement Number: 24-07

General Services Number: 5608

Project: Yolo County Agriculture Offices Suite F&G

Contractor: Comstock Johnson

Contact Person: Daniel P. Eriksson **Phone:** 916-362-6303

Project Description: The project consists of demolition of the existing multi-use men's and women's restrooms in Suite G and replacing them with three single use restrooms. See Attachment.

Original Work Authorization:	\$ 46,356
Amendment #1	\$173,093
Amendment #2:	<u>\$ 16, 034</u>
Total:	\$235,483

Start Date: 4/27/2021

Completion Date: 6/30/2026

Approval: _____ Date: _____
Ryan Pistochni, Director of General Services



January 13, 2025

Ryan Pistochini
Director of General Services
Yolo County Department of General Services
120 W. Main St., Suite G
Woodland, CA 95695

Re: Proposal for:
Suite G Restroom Remodel
120 W. Main Street, Suite G
Woodland, CA
CJA Project #24065

Dear Ryan:

Thank you for the continued opportunity to offer our professional services. The project consists of demolition of the existing multi-use men's and women's restrooms in suite G and replacing them with three (3) single use restrooms, one men's, one women's and one all -gender. The plans will be included as part of the current tenant improvements for suite D, F & G. The following is a description of the tasks, breakdown of the work and associated fees. Fees include architectural, mechanical, plumbing and electrical design.

Task .11 – Construction Documents - Restrooms

Fixed Fee of \$16,034

- Up to one (1) site visit by the architect to confirm existing conditions
- Prepare construction document level floor and ceiling plans and interior elevations for obtaining a building permit
- PDF Deliverables include:
 - Floor plan, demolition plan, reflected ceiling plan, interior elevations
 - Mechanical plan, details
 - Plumbing plan, Isometric diagram, details, fixture schedule
 - Electrical power plan
 - Lighting plan

Total Proposed Fees: \$16,034

Task .20- Reimbursable Expenses

Cost plus 10%

- Large format printing
- Deliveries
- Mileage
- Permit processing to the authorities having jurisdiction (AHJ)

Qualifications

- All other design, including but not limited to structural, fire sprinkler, low voltage systems, systems furniture, Cable TV, energy studies, utility coordination, signage other than building code required accessibility signage and TV distribution are to be completed by other professionals under direct, separate contracts to the client
- Fees required by authorities with jurisdiction are the responsibility of the client

V:/24065/1_ Proposals & Contracts/24065.p03

Daniel P. Eriksson
Principal Architect

Kevin L. Wilcox
Principal Architect

Jeffrey J. Reilly
Principal Architect

Rachel M. Luhrsen
Principal
Sr. Project Manager



- Meetings other than those stated above will be billed on an hourly basis.
- Excludes services or activities not specifically noted above.

The above fees represent our understanding of the scope of work requested. If your view of the scope or fees is different from that outlined above, please contact our office and we will make any appropriate adjustment to our scope and/or fees. If acceptable, we will forward an AIA (American Institute of Architects) form agreement between Owner and Architect with our standard terms.

We look forward to our continuing work with you on this project.

Respectfully Submitted,

COMSTOCK JOHNSON ARCHITECTS, INC.

A handwritten signature in black ink, appearing to read "David Helms".

David Helms, AIA
Architect
CA License #28687

Enc. Exhibit A
Exhibit B

Daniel P. Eriksson
Principal Architect

Kevin L. Wilcox
Principal Architect

Jeffrey J. Reilly
Principal Architect

Rachel M. Luhrsen
Principal
Sr. Project Manager



EXHIBIT A

FEE SCHEDULE

Hourly Rates:

Principal	\$210.00
Sr. Architect	\$200.00
Project Architect	\$185.00
Project Manager	\$175.00
Architect	\$150.00
Project Coordinator	\$125.00
Interior Designer	\$120.00
Job Captain	\$110.00
Designer II	\$100.00
Designer I	\$95.00
Administration/Clerical	\$75.00
Intern	\$65.00

Reimbursable Expenses:

Consultants, Reimbursable Expenses (i.e. prints, copies, renderings, color copies, etc.), client invoicing software data entry and permit processing will be billed at cost, plus fifteen percent (10%). Mileage will be charged at normal IRS rates. All Reimbursable Expenses will be invoiced under Task .20.

Daniel P. Eriksson
Principal Architect

Kevin L. Wilcox
Principal Architect

Jeffrey J. Reilly
Principal Architect

Rachel M. Luhrsen
Principal
Sr. Project Manager

EXHIBIT B

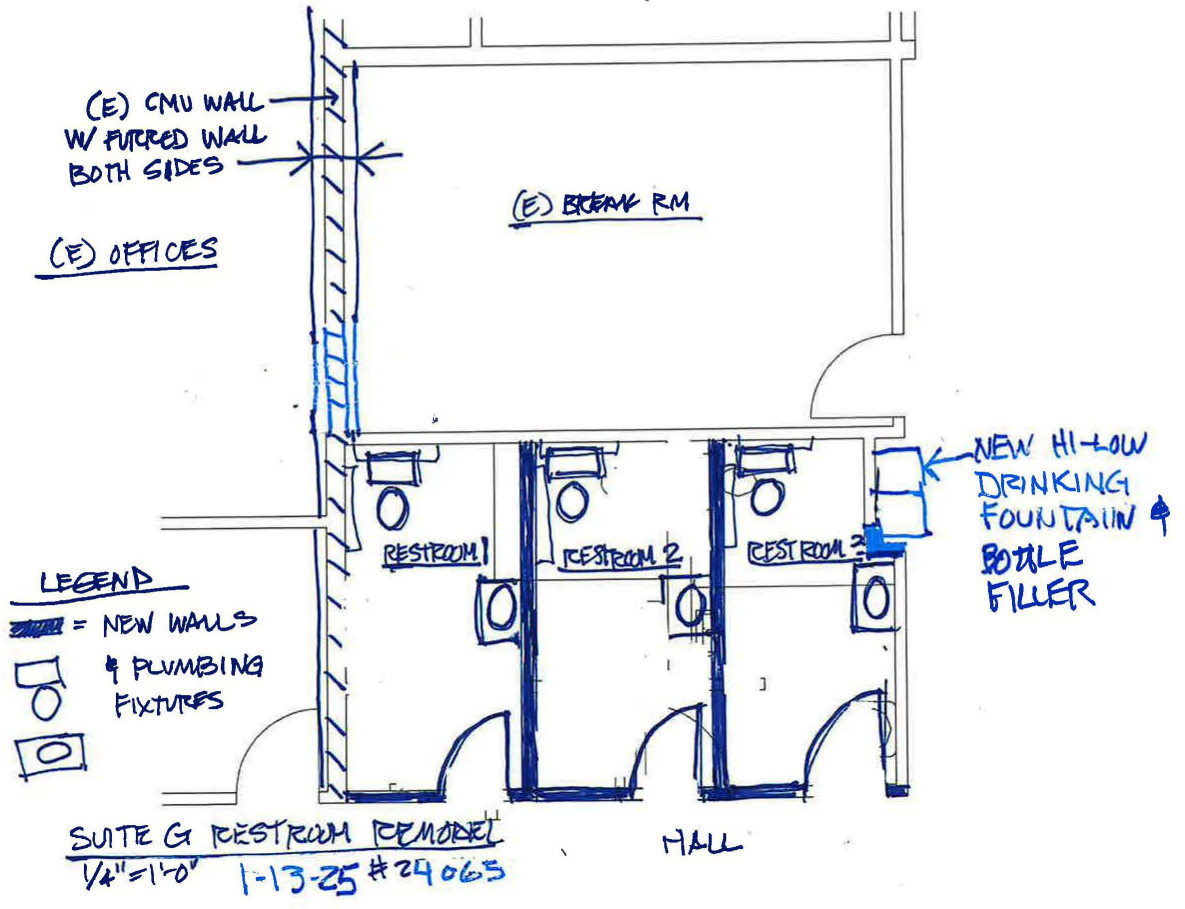

Daniel P. Eriksson
Principal Architect

Kevin L. Wilcox
Principal Architect

Jeffrey J. Reilly
Principal Architect

Rachel M. Luhrsen
Principal
Sr. Project Manager