

ATTACHMENT B

SITE ADDRESS:
36459 COUNTY ROAD 21
WOODLAND, CA 95695

APN: 025-130-027-000
ACRES: 30.7
SITE AREA: 1,337,292 SF
ZONING: A-P
USE TYPE: AGRICULTURAL

BUILDING STORIES: ONE (1)
BUILDING AREA: 2,214 SF

(E) COVERAGE: 0.17 %
= 2,214 SF / 1,337,292 SF

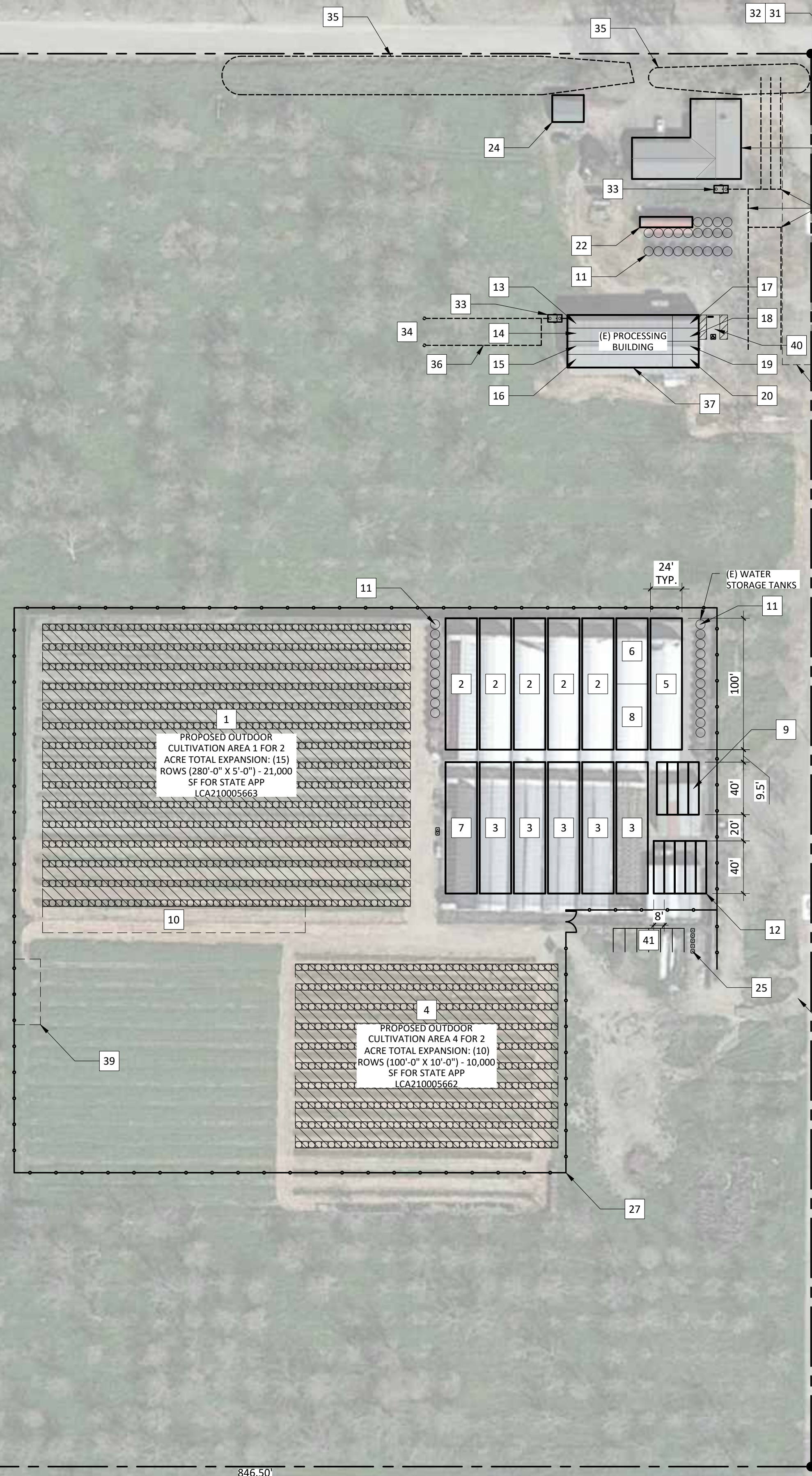

KEYNOTES: GENERAL

- 1 PROPOSED OUTDOOR CULTIVATION AREA 1 FOR 2 ACRE TOTAL (2 ACRE MAXIMUM FOR SITE) EXPANSION: (15) ROWS (280'-0" X 5'-0") - 21,000 SF FOR STATE APP LCA210005663
- 2 EXISTING CANNABIS (5) GREENHOUSES CULTIVATION AREA 2: (90'-0" X 10'-0") - 1,800 SF CANOPY X 5 = 9,000 SF. NO CHANGE. - FOR USE BY EXISTING LICENSE CCL22-0000061
- 3 EXISTING CANNABIS (5) GREENHOUSES CULTIVATION AREA 3: (90'-0" X 10'-0") - 1,800 SF CANOPY X 5 = 9,000 SF. NO CHANGE. - FOR USE BY EXISTING LICENSE CCL22-0000065
- 4 PROPOSED OUTDOOR CULTIVATION AREA 4 FOR 2 ACRE TOTAL (2 ACRE MAXIMUM FOR SITE) EXPANSION: (10) ROWS (100'-0" X 10'-0") - 10,000 SF FOR STATE APP LCA210005662
- 5 PROPOSED VEGETATION AREA 1 (1) GREENHOUSE: (100'-0" X 24'-0") - 2,400 SF FOR STATE APP LCA210005663
- 6 PROPOSED VEGETATION AREA 2 (1) GREENHOUSE (MIXED LIGHT): (50'-0" X 24'-0") - 1,200 SF FOR STATE APP LCA220000061
- 7 PROPOSED VEGETATION AREA 3 (1) GREENHOUSE (MIXED LIGHT): (100'-0" X 24'-0") - 2,400 SF FOR STATE APP LCA220000065
- 8 PROPOSED VEGETATION AREA 4 (1) GREENHOUSE: (50'-0" X 24'-0") - 1,200 SF FOR STATE APP LCA210005662
- 9 EXISTING PESTICIDE AND AGRICULTURAL CHEMICAL STORAGE CONTAINER: APPROXIMATELY (30'-0" X 10'-0") 300 SF; NO CHANGE.
- 10 SHARED COMPOSTING AREA.
- 11 EXISTING WATER STORAGE TANKS.
- 12 EXISTING (9) SHIPPING CONTAINERS: APPROXIMATELY (30'-0" X 10'-0") 300 SF EACH; NO CHANGE.
- 13 PROPOSED PROCESSING & PACKAGING AREA 1 : (10'-0" X 80'-0") - 800 SF FOR STATE APP LCA210005663
- 14 PROPOSED PROCESSING & PACKAGING AREA 2 : (10'-0" X 80'-0") - 800 SF FOR STATE APP LCA220000061
- 15 PROPOSED PROCESSING & PACKAGING AREA 3 : (10'-0" X 80'-0") - 800 SF FOR STATE APP LCA210005665
- 16 PROPOSED PROCESSING & PACKAGING AREA 4 : (10'-0" X 80'-0") - 800 SF FOR STATE APP LCA210005662
- 17 PROPOSED HARVEST STORAGE AREA 1 : (10'-0" X 20'-0") - 200 SF FOR STATE APP LCA210005663
- 18 PROPOSED HARVEST STORAGE AREA 2 : (10'-0" X 20'-0") - 200 SF FOR STATE APP LCA220000061
- 19 PROPOSED HARVEST STORAGE AREA 3 : (10'-0" X 20'-0") - 200 SF FOR STATE APP LCA220000065
- 20 PROPOSED HARVEST STORAGE AREA 4 : (10'-0" X 20'-0") - 200 SF FOR STATE APP LCA210005662
- 21 YOLO COUNTY PUBLIC WORKS NOTE: A CONSTRUCTION INSPECTOR WILL VERIFY THE DRIVEWAY APPROACH IS TO CURRENT STANDARD AND FUNCTIONING PROPERLY (CULVERT CLEAR AND IN GOOD CONDITION, SURFACE CONDITION, ETC.). IF NOT, AN ENCROACHMENT PERMIT MAY BE REQUIRED.
- 22 EXISTING (1) SHIPPING CONTAINERS: APPROXIMATELY (40'-0" X 8'-0") - 320 SF; NO CHANGE.
- 23 EXISTING FARMHOUSE: APPROXIMATELY 2,214 SF; NO CHANGE.
- 24 EXISTING SHED: APPROXIMATELY (20'-6" X 24'-0") 492 SF; NO CHANGE.
- 25 EXISTING MECHANICAL UNITS; NO CHANGE.
- 26 EXISTING PREMISES ENTRANCE/EXIT LOCATION.
- 27 EXISTING 6' HIGH CHAINLINK FENCE WITH VEHICLE GATE.
- 28 EXISTING PARCEL/ PROPERTY BOUNDARY LINE.
- 29 A FIRE ACCESS KNOX BOX SHALL BE PLACED AT THE ENTRANCE OF EACH BUILDING ONSITE, TYP.
- 30 LOCATION OF POSTED ADDRESS WITH ADHERENCE TO CALIFORNIA FIRE CODE.
- 31 EXISTING ACCESS ROAD; NO CHANGE.
- 32 EXISTING PROPERTY ENTRANCE/EXIT - 20' MINIMUM WIDTH FIRE ROAD WITH ALL WEATHER SURFACE - COMPACTED GRAVEL. DRIVEWAY APPROACHES TO COUNTY AND STATE MAINTAINED ROADS SHALL BE PER CURRENT COUNTY IMPROVEMENT STANDARDS OR CALTRANS REQUIREMENTS
- 33 EXISTING SEPTIC TANK; NO CHANGE.
- 34 EXISTING LEACH FIELD; NO CHANGE.
- 35 EXISTING DITCH; NO CHANGE.
- 36 EXISTING LEACH LINES; NO CHANGE.
- 37 EXISTING PROCESSING BUILDING: APPROXIMATELY (100'-0" X 40'-0") 4,000 SF; NO CHANGE.
- 38 EXISTING SWALE; NO CHANGE.
- 39 EXISTING TRASH ENCLOSURE AREA; NO CHANGE.
- 40 ADA PARKING.
- 41 PARKING AREA.

GRAPHIA
ARCHITECTURE
& ENGINEERING

100 GATEWAY DRIVE, SUITE 120
LINCOLN, CA 95648
(916) 209-9890
Design@GRAPHIA.com
GRAPHIA.com

These drawings are instruments of service and are the property of Sean Freitas, Architect. All design information contained in these drawings are for use only on this specified project and shall not be used otherwise without the expressed written permission by Sean Freitas, Architect.

PROJECT: 2023112001

PROJECT CONTACT:
PRODUCT MANAGER
100 GATEWAY DRIVE, SUITE 120
LINCOLN, CA 95648
PHONE: (916) 209-9890
EMAIL: DESIGN@GRAPHIA.COM

CONDITIONAL USE PERMIT FOR:
YOLO GARDENS
36459 COUNTY ROAD 21
WOODLAND, CA 95695

TITLES:
PROJECT SITE PLAN

DATE: 3/14/2024 PC: 01 03/12/2024

ARCHITECT'S APPROVAL:

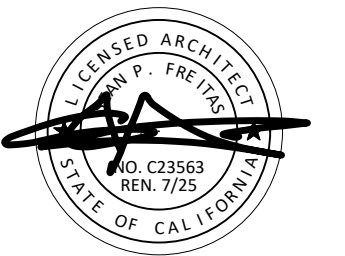

THIS PROJECT IS NOT APPROVED FOR CONSTRUCTION UNLESS THE DRAWINGS ARE STAMPED AND WET SIGNED BY THE ARCHITECT AND THE BUILDING AUTHORITY HAVING JURISDICTION.

SHEET:

A2.11

SHEET: OF SHEETS