

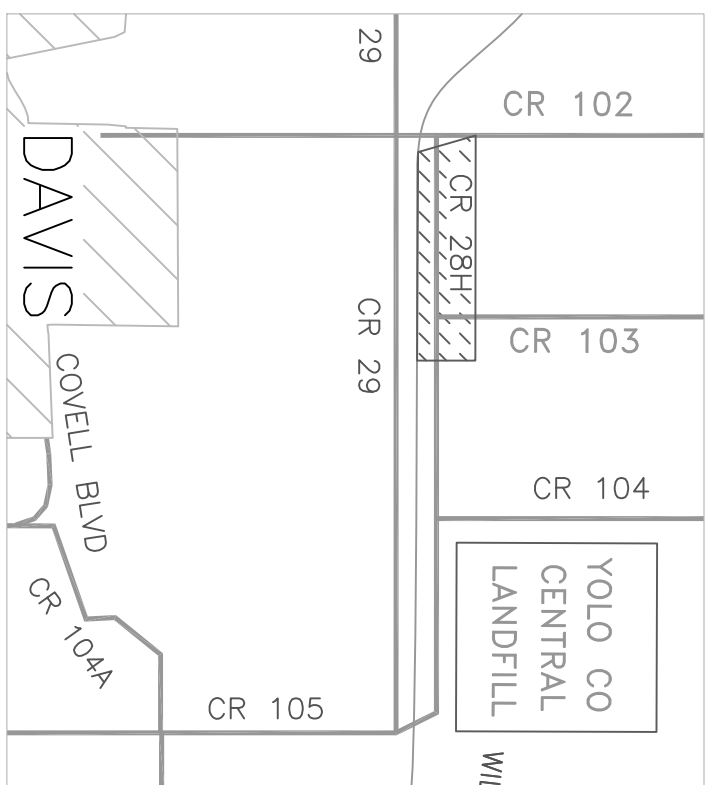

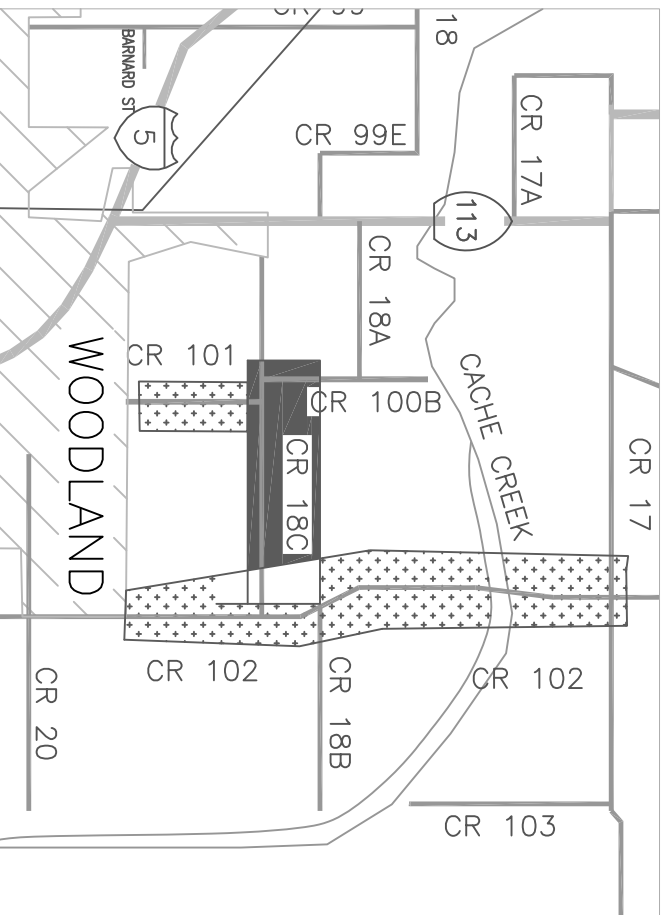



ATTACHMENT A. 2026 PAVEMENT PRESERVATION PROJECT LOCATION MAP - WO #4646



- TREATMENT LEGEND**
-  TRIPLE SEAL (MICROSURFACING III + ASPHALT RUBBER CHIP SEAL + MICROSURFACING II)
 -  PULVERIZE + HMA OVERLAY
 -  HMA OVERLAY
 -  ASPHALT RUBBER CHIP SEAL + MICROSURFACING II
 -  HMA MILL & FILL

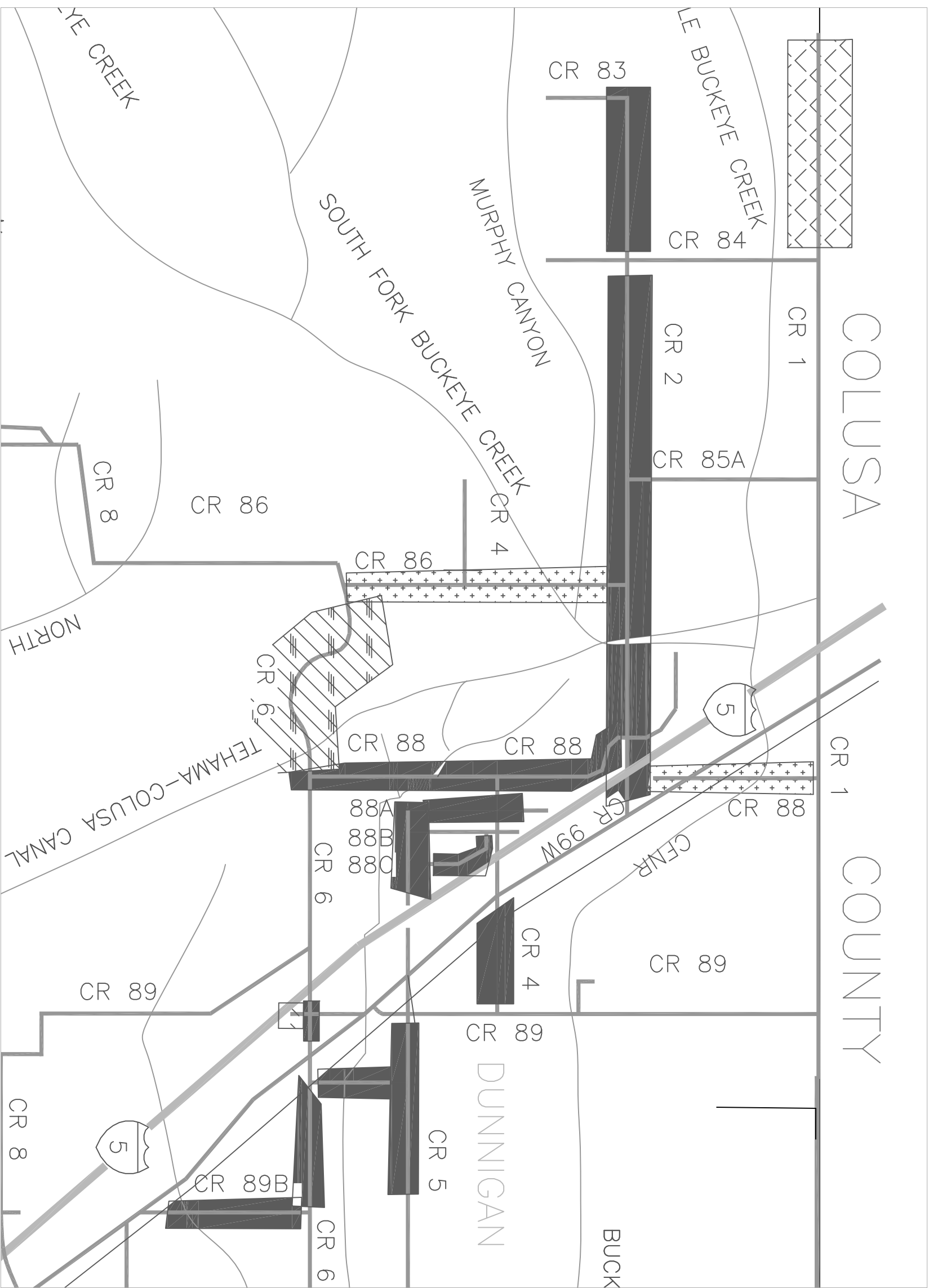

PROJECT MAP
NOT TO SCALE